

PROPERTY REPORT

From www.land.vic.gov.au at 18 March 2025 02:18 PM

PROPERTY DETAILS

Address: **15/11 OSHAUGHNESSY STREET KEW 3101**
Lot and Plan Number: **Lot 15 RP7382**
Standard Parcel Identifier (SPI): **15\RP7382**
Local Government Area (Council): **BOROONDARA**
Council Property Number: **335770**
Directory Reference: **Melway 45 B7**

www.boroondara.vic.gov.au

Note: There are 20 properties identified for this site.
These can include units (or car spaces), shops, or part or whole floors of a building.
Dimensions for these individual properties are generally not available.

SITE DIMENSIONS

All dimensions and areas are approximate. They may not agree with those shown on a title or plan.

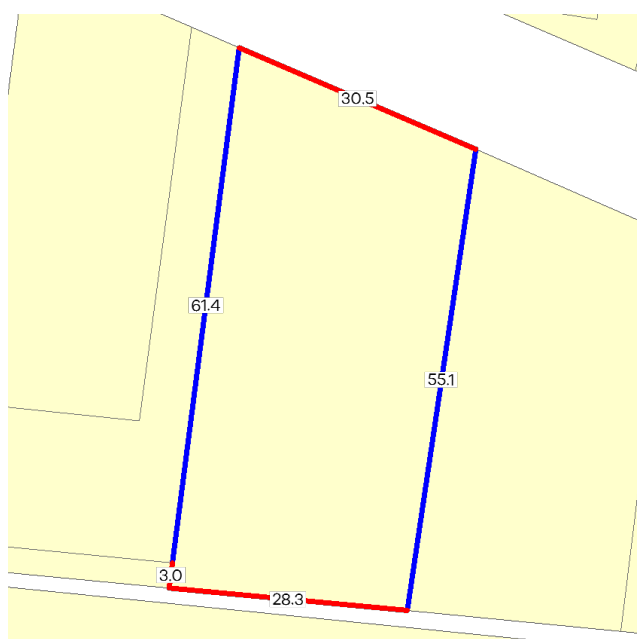

Area: 1723 sq. m

Perimeter: 178 m

For this property:

— Site boundaries

— Road frontages

Dimensions for individual parcels require a separate search, but dimensions for individual units are generally not available.

Calculating the area from the dimensions shown may give a different value to the area shown above

For more accurate dimensions get copy of plan at [Title and Property Certificates](#)

UTILITIES

Rural Water Corporation: **Southern Rural Water**
Melbourne Water Retailer: **Yarra Valley Water**
Melbourne Water: **Inside drainage boundary**
Power Distributor: **CITIPOWER**

STATE ELECTORATES

Legislative Council: **SOUTHERN METROPOLITAN**
Legislative Assembly: **KEW**

PLANNING INFORMATION

Property Planning details have been removed from the Property Reports to avoid duplication with the Planning Property Reports from the Department of Transport and Planning which are the authoritative source for all Property Planning information.

The Planning Property Report for this property can found here - [Planning Property Report](#)

Planning Property Reports can be found via these two links

Vicplan <https://mapshare.vic.gov.au/vicplan/>

Property and parcel search <https://www.land.vic.gov.au/property-and-parcel-search>

Area Map

