



Dingle Partners

- | Estate Agents
- | Sales
- | Property Management
- | Project Management
- | Consultants



1508/225 Elizabeth Street, Melbourne

2  **1**  **1** 

Additional Information

- Front corner position
- North Easterly aspect
- Iconic city views
- Central heating and cooling

Rates:

Water Rates - \$615.88 per annum approx.
Council Rates - \$1,399.83 per annum approx.
Owners Corp - \$6,364.76 per annum approx.

Chattels:

All fixed floor coverings, electric light fittings, window furnishings, fixtures, fittings and furniture as inspected

Preferred Settlement:

30/60 days – 10% deposit

Schools:

| | |
|-------------------------------------|--------|
| Carlton Gardens Primary School | 1.4 km |
| University High School | 1.9 km |
| Ozford College | 0.7 km |
| Eltham College – King Street Campus | 0.7 km |

Public Transportation:

| | |
|---------------------------------------|-------|
| Tram: 3-Bourke St Mall / Elizabeth St | 102 m |
| Bus: Elizabeth St / Lonsdale St | 96 m |
| Train: Melbourne Central | 368 m |

Other Amenities

| | |
|-----------------------|-------|
| Bourke Street Mall | 178 m |
| Chinatown Melbourne | 406 m |
| Flagstaff Gardens | 759 m |
| Queen Victoria Market | 779 m |

PRIVATE SALE

CONTACT ROBERT EGGERS

0412 329 340

Dingle Partners Pty Ltd. ABN: 67 099 681 188 Tel: 61 3 9614 6688 Fax: 61 3 9629 8811 www.dinglepartners.com.au

Directors: Malcolm Dingle FREI AAPI, Robert Eggers AREI, CEA (REIV), Paul Harberts BEng

📍 **Head Office:** 39 Queen Street, Melbourne VIC 3000 📍 Carlton 📍 Richmond 📍 St Kilda Rd

Dingle Partners

- | Estate Agents
- | Sales
- | Property Management
- | Project Management
- | Consultants

Dingle Partners

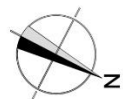
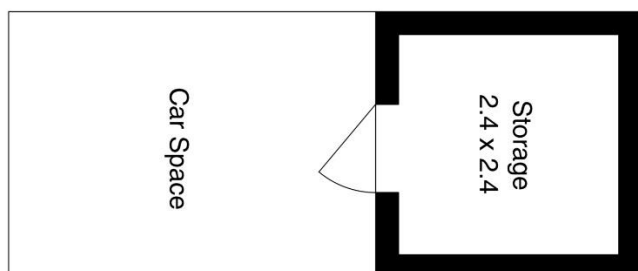
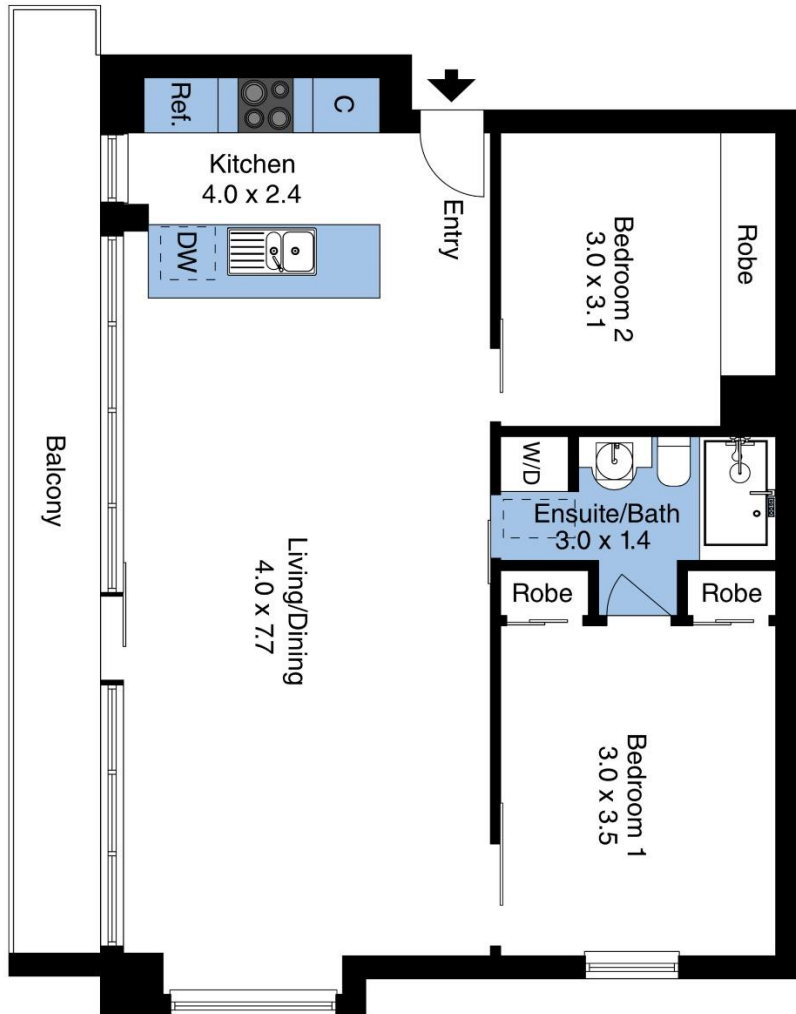

The floor plan is not to scale, measurements are indicative and in metres. Exterior elements are not in position. Plans should not be relied on. Interested parties should make and rely on their own enquiries.

Produced by DIAKRIT