



Luschwitz
REAL ESTATE

Bright and Spacious Parkside Apartment

3/1 Hipwood Street, Kirribilli

View

As advertised or by appointment



Auction

Sat 6th May (unless sold prior)



Set in the boutique 'Parkview' block of just 12, this light filled corner apartment enjoys a tranquil outlook over Milson Park. This is an ideal entry point to this sought after neighbourhood for owner occupiers and investors alike with undercover parking and the convenience of being just 550m walk to Milsons Point station, North Sydney ferry wharf plus local shops and cafes.

- Wall to wall windows to maximise the view and natural light
- Separate kitchen with gas cooking
- Generous open plan living and dining enjoying the outlook
- Spacious double bedroom with built-in robes
- Large bathroom with room for washer/dryer
- Undercover car space plus room for a guest off street



Josh Luschwitz 0412 067 676 josh@luschwitz.com.au
Dane Preston 0448 996 676 dane@luschwitz.com.au

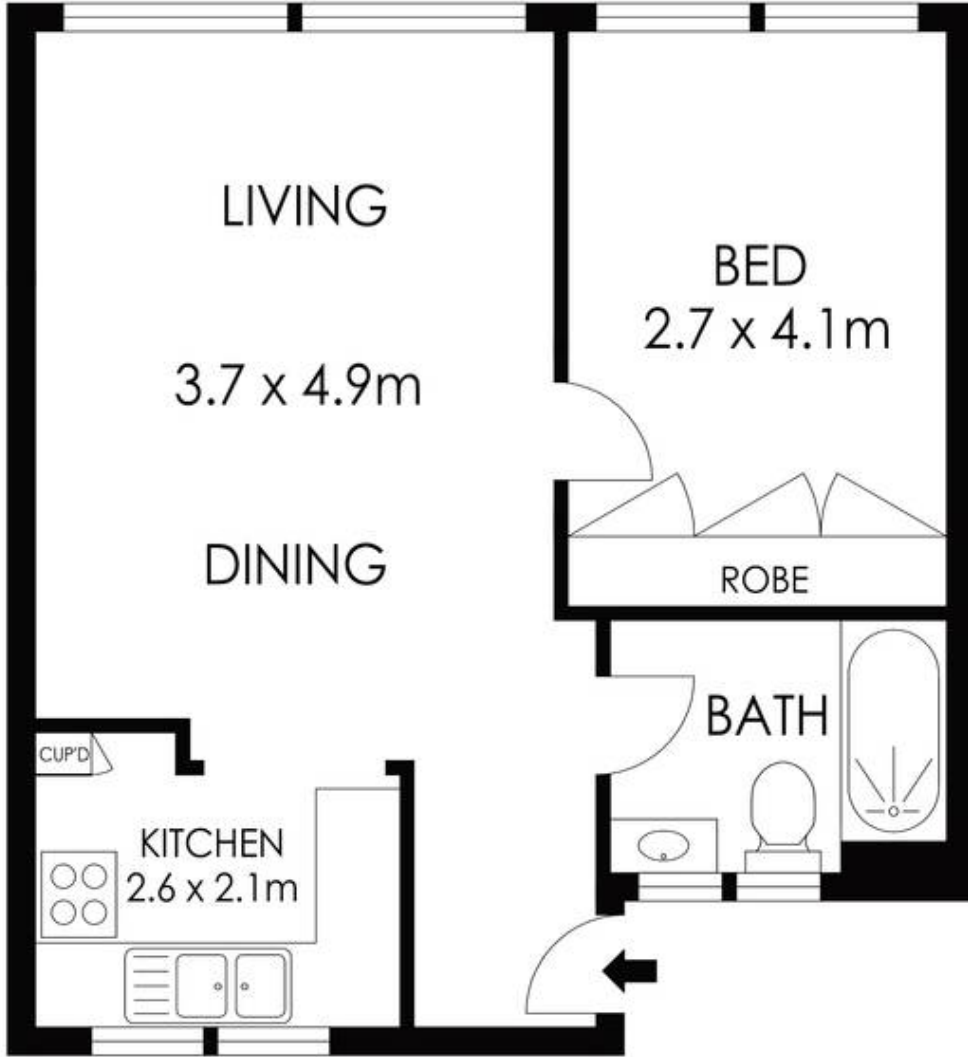

ELEVATED GROUND LEVEL

**COVERED
CARSPACE
3.0 x 5.1m**

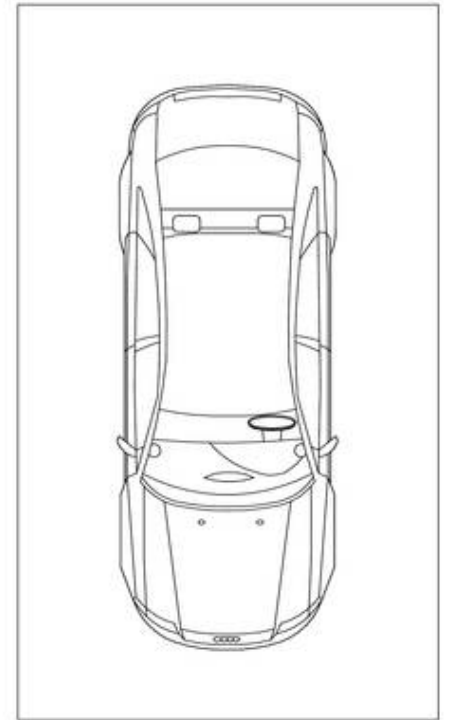

GROUND LEVEL



PLANS SHOWN ONLY INDICATIVE OF LAYOUT. DIMENSIONS ARE APPROXIMATE.

3/1 Hipwood Street, Kirribilli



Luschwitz
REAL ESTATE