



## Frankston City Council

30 Davey Street, Frankston, Victoria, Australia  
Telephone: 1300 322 322 » +613 9784 1888 » Facsimile: +613 9784 1094  
PO Box 490, Frankston VIC 3199  
info@frankston.vic.gov.au  
Website: frankston.vic.gov.au  
ABN: 49 454 768 065

Application Number 156/2024/LP  
Enquiries Michelle Thompson  
Telephone 1300 322 322  
Customer Reference

22 May 2024

Creative House Plans  
48 Bona Vista Rise  
CLYDE NORTH VIC 3978

**Application No** 156/2024/LP  
**Address** 17 Railway Parade, Seaford  
**Lot/Plan** Lot 1 LP 47803

As requested, please find attached the **location of your stormwater discharge point which is to be constructed via outfall drain and to be connect to existing pit within the laneway as per the Approved drainage plans dated 28 October 2021, Project No. 2014OM, Sheet No's C01-05, Revision 02 & 03.**

Council provides stormwater point of discharge to accommodate a single dwelling with of no more than 40% site coverage. It is advised that development of this site with a greater site coverage than 40% will require the provision of a Stormwater Detention System with a volume capable of retarding the 10-year ARI flow from the development site back to a 5-year ARI pre-development value. Water Sensitive Urban Design principles (WSUD) can be incorporated into the drainage design to reduce the site outflow to the required 5-year ARI pre-development value.

**Where a site is subject to a Planning Permit for development, the discharge location may be subject to alteration. All Planning Permit conditions must be complied with to the satisfaction of the Engineering Services Manager**

If you have further questions, please contact Michelle Thompson from the Engineering Services department on 1300 322 322

Kind regards,

Michelle Thompson  
**TECHNICAL SUPPORT OFFICER**  
**ENGINEERING SERVICES**

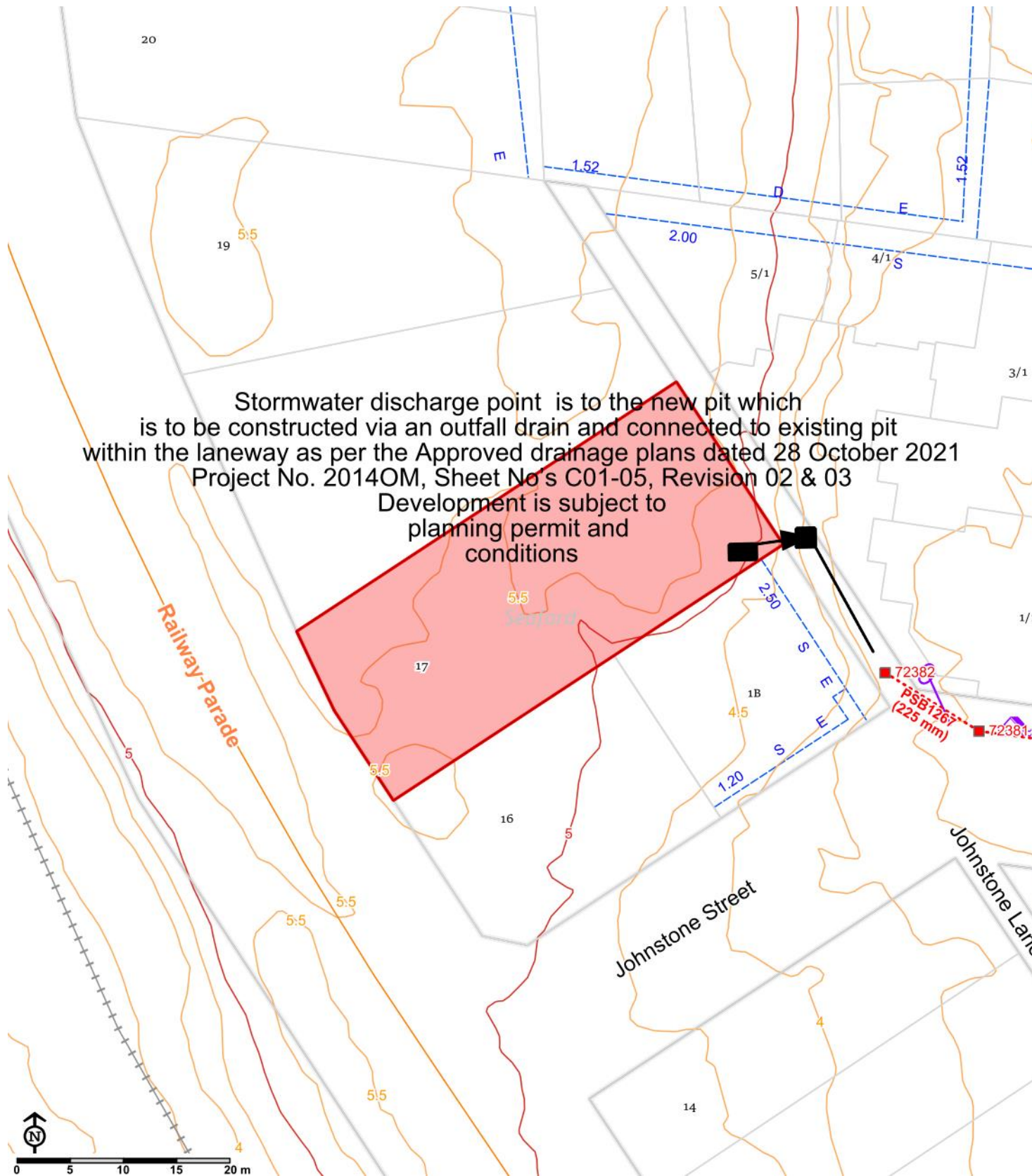

#### Disclaimer

Contains Council information © Frankston City Council, 2024. Reproduced by permission of the Information Services Department, Frankston City Council. Contains Vicmap information © State of Victoria, Department of Environment and Primary Industry, 2024. Reproduced by permission of the Department of Environment and Primary Industry. This material may be of assistance to you but Frankston City Council, the State of Victoria and their employees do not guarantee that the publication is without flaw of any kind or is wholly appropriate for your particular purposes and therefore disclaim all liability for any error, loss or consequences which may arise from your relying on any information contained in this material. You are hereby notified that any use, dissemination, distribution or reproduction of this information is prohibited and must be used for personal use only. The information contained herein must not be used in any manner that could breach any criminal, federal, state or local law.

Projection: # GDA94 / MGA zone 55

Scale: 1:500

Date Printed: 22/05/2024

Time Printed: 12:51 PM

Issued by: Michelle Thompson



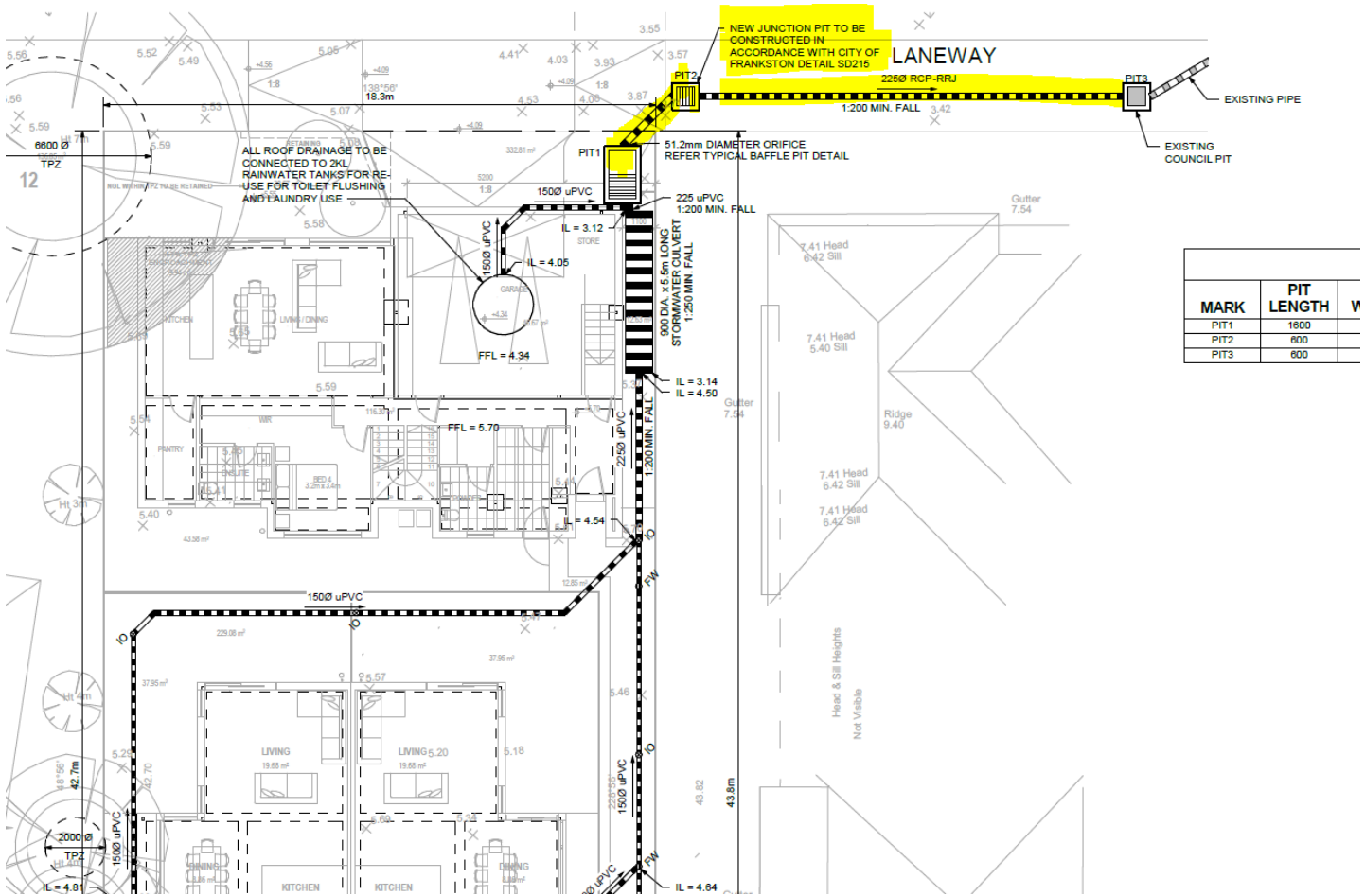
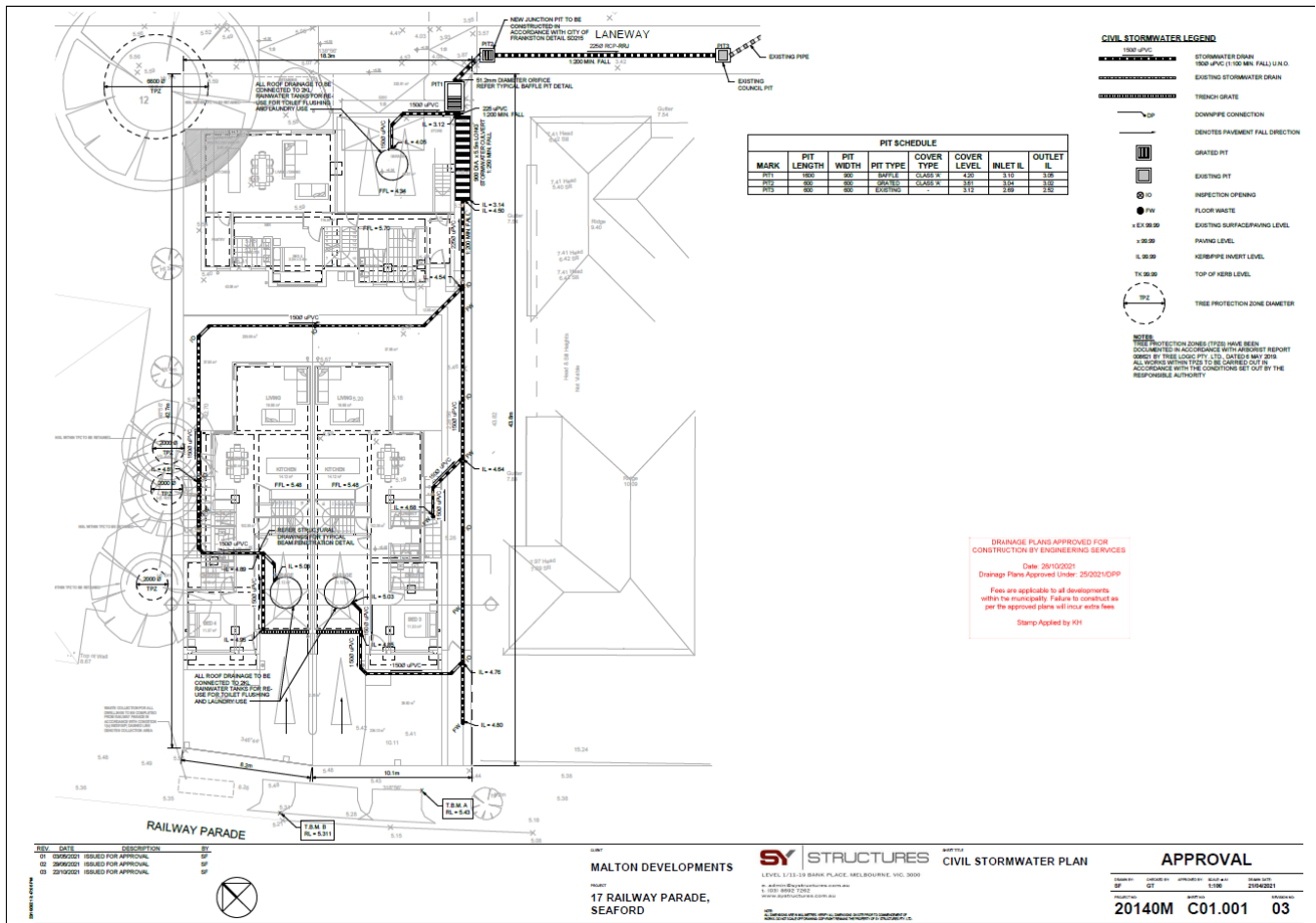

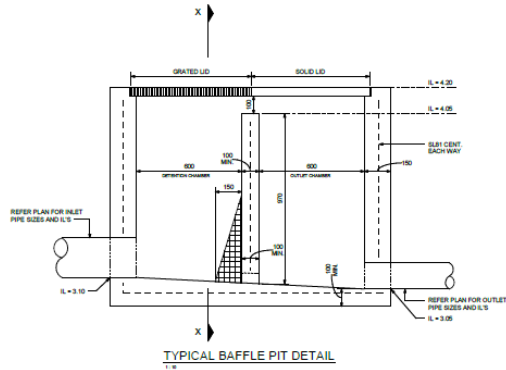

TYPICAL BAFFLE PIT DETAIL

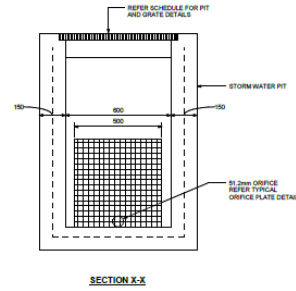

SECTION X-X

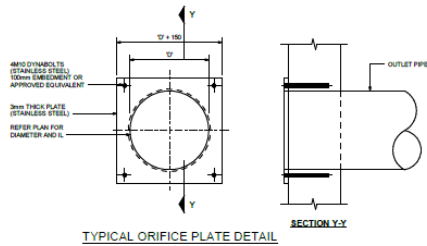

TYPICAL ORIFICE PLATE DETAIL

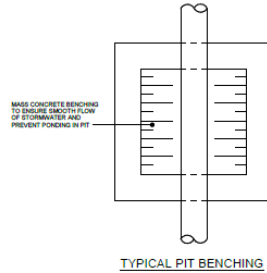

TYPICAL PIT BENCHING

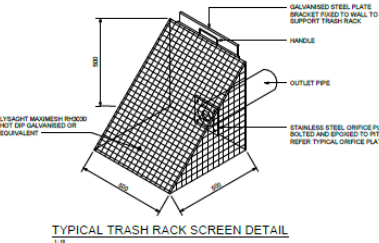

TYPICAL TRASH RACK SCREEN DETAIL

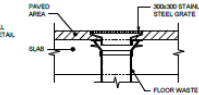

TYPICAL FLOOR WASTE (F.W.) DETAIL

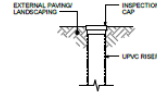

TYPICAL INSPECTION OPENING (I.O.) DETAIL

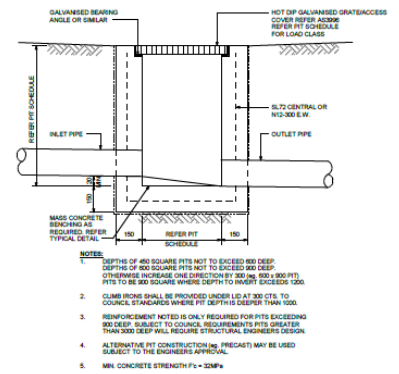

TYPICAL CONCRETE INLET PIT DETAIL (NATURAL SURFACE)

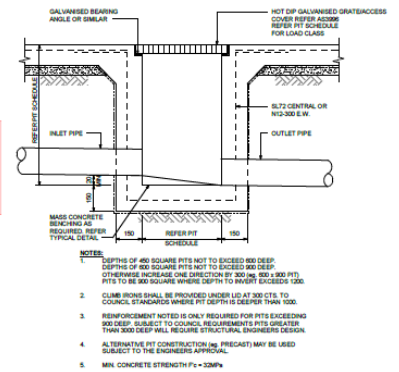

TYPICAL CONCRETE INLET PIT DETAIL (CONCRETE SURFACE)

DRAINAGE PLANS APPROVED FOR  
 CONSTRUCTION BY ENGINEERING SERVICES  
 Date: 28/10/2021  
 Drainage Plans Approved Under: 25/2001 DPP  
 Fees are applicable to all developments  
 within the municipality. Failure to construct as  
 per the approved plans will incur extra fees.  
 Stamp Applied by KH

REV	DATE	DESCRIPTION	BY
01	09/06/2021	ISSUED FOR APPROVAL	SF
02	22/10/2021	ISSUED FOR APPROVAL	SF

CLIENT  
**MALTON DEVELOPMENTS**  
 PROJECT  
**17 RAILWAY PARADE,  
 SEAFORD**

**SY STRUCTURES**  
 LEVEL 1/11-19 BANK PLACE, MELBOURNE VIC 3000  
 P. 03 9595 7200  
 E. info@systructures.com.au  
 W. www.systructures.com.au

DRAW TITLE  
**CIVIL TYPICAL  
 STORMWATER DETAILS**

APPROVAL				
Drawn By	Checked By	Approved By	Scale	Drawn Date
SF	ST		1:10	20/04/2021
20140M C02.100			02	

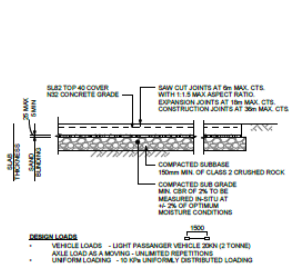

TYPICAL CONSTRUCTION JOINT (C.J.) DETAIL (PAVING)

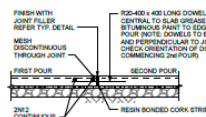

TYPICAL SAWCUT (S.C.) DETAIL (PAVING)

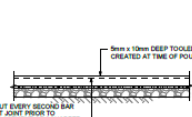

TYPICAL EXPANSION JOINT (E.J.) DETAIL (PAVING)

TYPICAL TOOLED JOINT (T.J.) DETAIL (PAVING)



TYPICAL JOINT FILLER DETAIL (PAVING)

LIGHT DUTY TRAFFICABLE EXTERNAL PAVING SLAB DETAIL

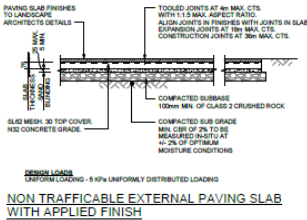

NON TRAFFICABLE EXTERNAL PAVING SLAB WITH APPLIED FINISH

TYPICAL TIMBER SLEEPER RETAINING WALL DETAIL

FOR 4000 BORED PIERS, BORED PIER DEPTH CAN BE DECREASED BY 20% IN SANDY SOILS BORED PIER DEPTH TO BE INCREASED BY 20%

DRAINAGE PLANS APPROVED FOR CONSTRUCTION BY ENGINEERING SERVICES

Date: 28/10/2021  
Drainage Plans Approved Under: 25/02/201/OPP

Fees are applicable to all developments within the municipality. Failure to construct as per the approved plans will incur extra fees.

Stamp Applied by KH

SUBBASE AND SUBGRADE DESIGN CRITERIA:

- COMPACT SUBGRADE TO 98% OF STANDARD AT 4.2% OF OPTIMUM MOISTURE CONTENT
- COMPACT BENCH MATERIAL TO 98% OF STANDARD AT 4.2% OF OPTIMUM OF MOISTURE CONTENT. COMPACT IN LAYERS OF 150 MAXIMUM LOOSE MATERIAL
- COMPACT SUB BASE MATERIAL TO 98% OF STANDARD AT 4.2% OF OPTIMUM MOISTURE CONTENT. COMPACT IN LAYERS OF 150 MAXIMUM LOOSE MATERIAL
- CONTINUE SUBBASE PREPARATIONS AND SUBBASE 500 MM BEYOND EDGE OF PAVING OR KERB

REV	DATE	DESCRIPTION	BY
01	09/05/2021	ISSUED FOR APPROVAL	SP
02	28/10/2021	ISSUED FOR APPROVAL	SP

MALTON DEVELOPMENTS

17 RAILWAY PARADE,  
SEAFORD

SY STRUCTURES

LEVEL 5/15-18 BANK PLACE, MELBOURNE, VIC 3000

E: admin@systructures.com.au

T: 03 9992 1702

W: www.systructures.com.au

SY STRUCTURES AND ASSOCIATES (Pty) Limited is a registered company in Australia

ABN 52 612 612 612 (Pty) Limited is a registered company in Australia

CIVIL TYPICAL CONCRETE PAVING SLAB DETAILS

APPROVAL

DESIGN BY	CHECKED BY	APPROVED BY	SCALE	DATE
SP	QT		1:25, 1:50	28/10/2021
PROJECT NO.			20140M	C02.200
DRAWING NO.				02



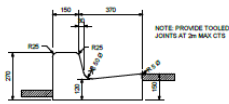

TYPICAL KERB AND GUTTER (KG)  
1:10

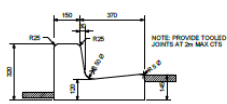

TYPICAL BARRIER KERB AND GUTTER (BKG)  
1:10

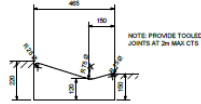

TYPICAL MODIFIED LAYBACK KERB (MLBK)  
DETAIL  
1:10

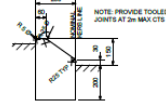

TYPICAL MOUNTABLE KERB (MK) DETAIL  
1:10

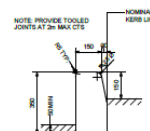

TYPICAL KERB ONLY (KO)  
1:10

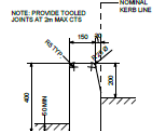

TYPICAL BARRIER KERB (BK)  
1:10

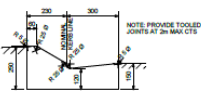

TYPICAL MOUNTABLE KERB AND GUTTER  
KERB (MKG) DETAIL  
1:10

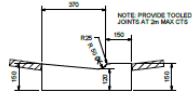

TYPICAL ROAD/PAVING TO KERB AND  
GUTTER DETAIL  
1:10

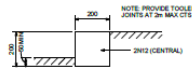

TYPICAL EDGE STRIP (ES)  
1:10

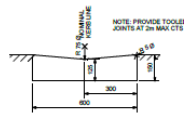

TYPICAL OPEN CONCRETE INVERT (OCI)  
1:10

DRAINAGE PLANS APPROVED FOR  
CONSTRUCTION BY ENGINEERING  
SERVICES  
Date: 20/10/2021  
Drainage Plans Approved Under: 25/02/2021/DPP  
Fees are applicable to all developments  
within the municipality. Failure to construct as  
per the approved plans will incur extra fees  
Stamp Applied by KH

REV	DATE	DESCRIPTION	BY
01	05/05/2021	ISSUED FOR APPROVAL	DP
02	22/10/2021	ISSUED FOR APPROVAL	DP

CLIENT  
MALTON DEVELOPMENTS  
PROJECT  
17 RAILWAY PARADE,  
SEAFORD

SY STRUCTURES  
LEVEL: 17-13-13 BARN PLACE, MELBOURNE, VIC 3000  
E: admin@systructures.com.au  
P: 03-9552 7252  
WWW.SYSTRUCTURES.COM.AU  
DESIGNED AND DRAWN BY: DP  
CHECKED BY: DP  
DATE: 22/10/2021

WORK TITLE  
CIVIL TYPICAL KERB  
DETAILS

APPROVAL

DESIGN BY	CHECKED BY	APPROVED BY	SCALE	DATE
DP	DP	DP	1:10	20/10/2021
20140M C02.400			02	