



Luschwitz

SERVING PYMBLE FOR OVER 50 YEARS

FOR LEASE



Apartment 2/692 Pacific Highway, Killara



'Glenburn Gardens' - Whisper quite apartment in prime location

Nestled at the rear of the building, (positioned behind Beacon Lighting Shop opposite the Greengate Hotel), this beautiful full brick, light & bright unit in 'Glenburn Gardens', provides a relaxed and easy lifestyle with all the modern comforts.

The Accommodation:

- Open plan living and dining area
- Floating floors throughout
- Generous bright bedroom, with adjoining en-suite bathroom
- Modern kitchen, gas cooking
- Covered balcony with tranquil views
- Split system air-conditioning/heating
- Newly painted
- Undercover parking

The Location:

- Across the road to the Greengate Hotel
- 140m 2 minute walk to bus stop
- 650m 9 minute walk Ravenswood Girls School
- 800m 11 minute walk to Killara Station
- 900m 12 minute walk to Gordon Station
- 900m 12 minute walk to Gordon Shopping Centre

Price : \$500 per week
View : as advertised of by appt

Lease term: 12 months with potential to renew
Available 15 June 2023
Sorry no pets allowed

tApp **Apply Online:**



Scan this QR code with your phone
or enter the following link into your browser:

<https://t-app.com.au/luschwitz>



Josh Luschwitz
josh@luschwitz.com.au
Bus 9449 5511 Mobile 0431 455 717



Leasing Team
leasing@luschwitz.com.au
Mobile 0412 224 319

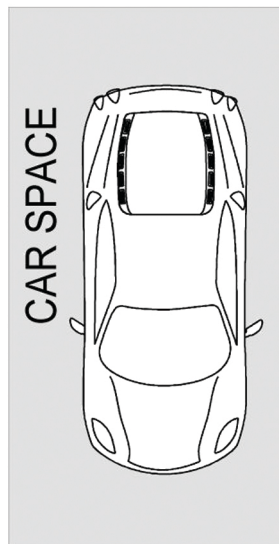
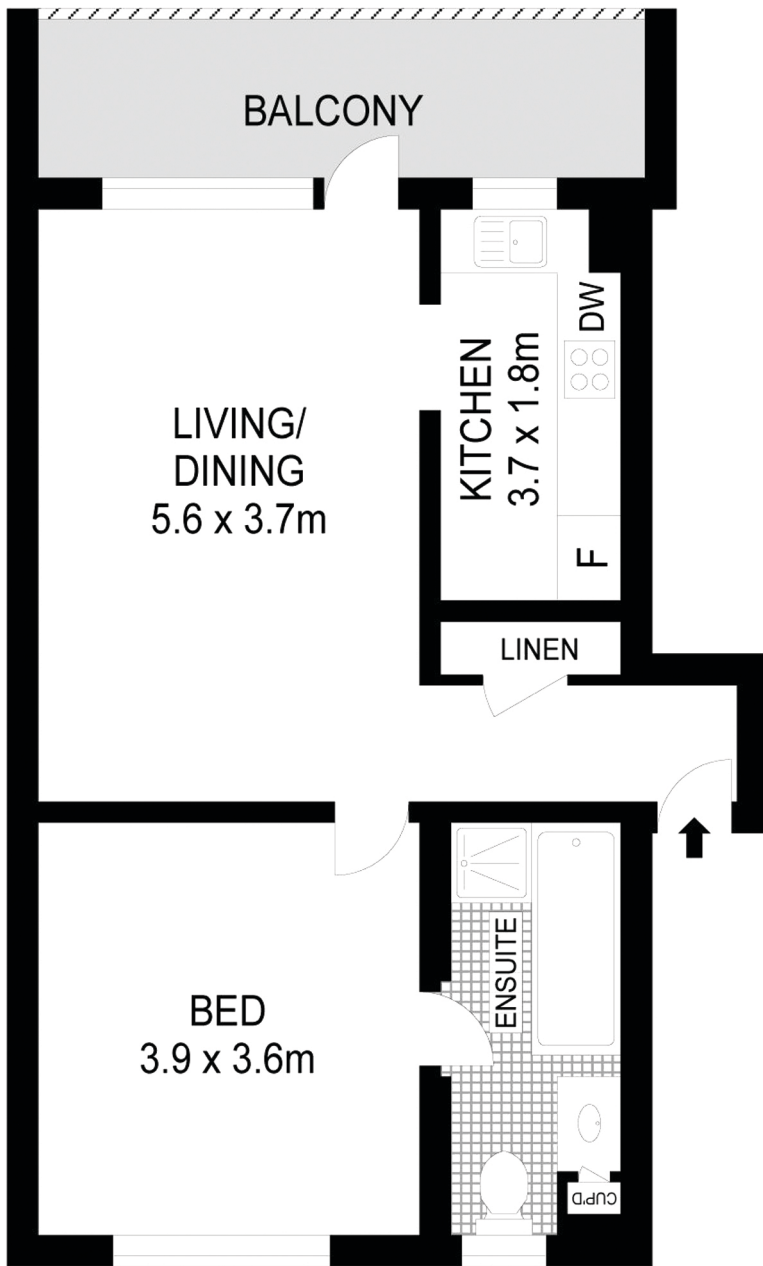

The apartment: 78m² approx



Luschwitz
REAL ESTATE

Plans are intended as a guide only. No representations or warranties of any nature whatsoever are given or intended and any person using this information should always rely on their own enquiries.

'Glenburn Gardens' Apartment 2/692 Pacific Highway, Killara