



# Dingle Partners

| Estate Agents  
| Sales  
| Property Management  
| Project Management  
| Consultants

**502/302 Collins Street, Melbourne**

1  1  .. 



## Additional Information

- The Cashmore on Collins – Art Nouveau Styling
- Secure Entry & Lift Access
- One of only 9 apartments – Boutique Building
- High Ceilings – Timber Floors
- Northerly Balcony
- Fully Tiled Ensuite Bathroom

## Rates:

Water Rates - \$615.88 per annum approx.  
Council Rates - \$981.34 per annum approx.  
Owners Corp - \$6,162.40 per annum approx.

## Chattels:

All fixed floor coverings, electric light fittings and fixtures, window furnishings

## Preferred Settlement:

30/60 days – 10% deposit

## Schools:

RMIT University Melbourne Campus	820 m
Carlton Gardens Primary School	1.6 km
University High School	2.2 km
Eltham College – Lonsdale St Campus	500 m

## Public Transportation:

Tram: 2-Collins Street / Elizabeth Street	100 m
Bus: Collins Street / Queens Street	300 m
Train: Melbourne Central Station	650 m

## Other Amenities

Galleria Melbourne	158 m
Chinatown Melbourne	478 m
Melbourne Central Shopping Mall	630 m
Treasury Gardens	990 m

**AUCTION 25<sup>th</sup> JUNE 2022**

**CONTACT ROBERT EGGERS**

**0412 329 340**

Dingle Partners Pty Ltd. ABN: 67 099 681 188 Tel: 61 3 9614 6688 Fax: 61 3 9629 8811 [www.dinglepartners.com.au](http://www.dinglepartners.com.au)

Directors: Malcolm Dingle FREI AAPI, Robert Eggers AREI, CEA (REIV), Paul Harberts BEng

Head Office: 39 Queen Street, Melbourne VIC 3000 | Carlton | Richmond | St Kilda Rd

# Dingle Partners

- | Estate Agents
- | Sales
- | Property Management
- | Project Management
- | Consultants

Dingle Partners

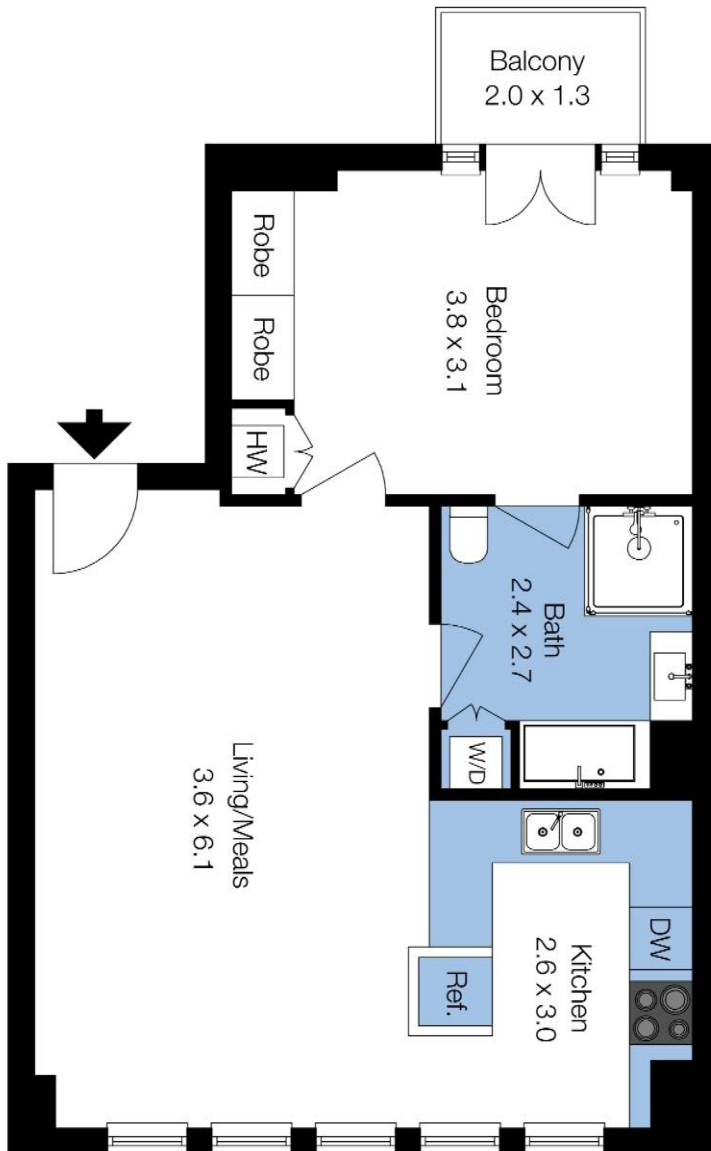

The floor plan is for a residential property. Measurements are indicated in each room. Storage dimensions are not included. Plans should not be used as a reference unless accompanied by a copy of this document.

Storage Cage  
H: 2.2  
0.8 x 1.5  
(Not In Position)

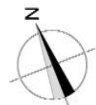

Produced by DIAKRT