

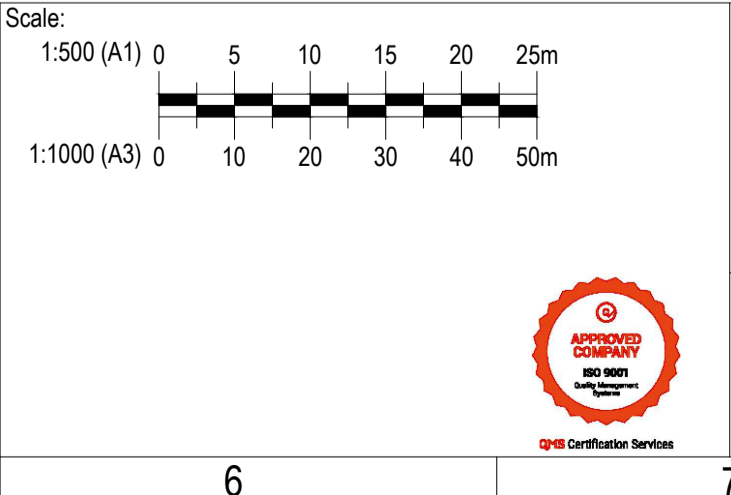

Rev.	Description	Approved	Date
1	ISSUE FOR INFORMATION	HT	2024/03/19
0	ISSUE FOR CONSTRUCTION	HT	12/10/2023
A	PRELIMINARY ISSUE	HT	05/09/2023

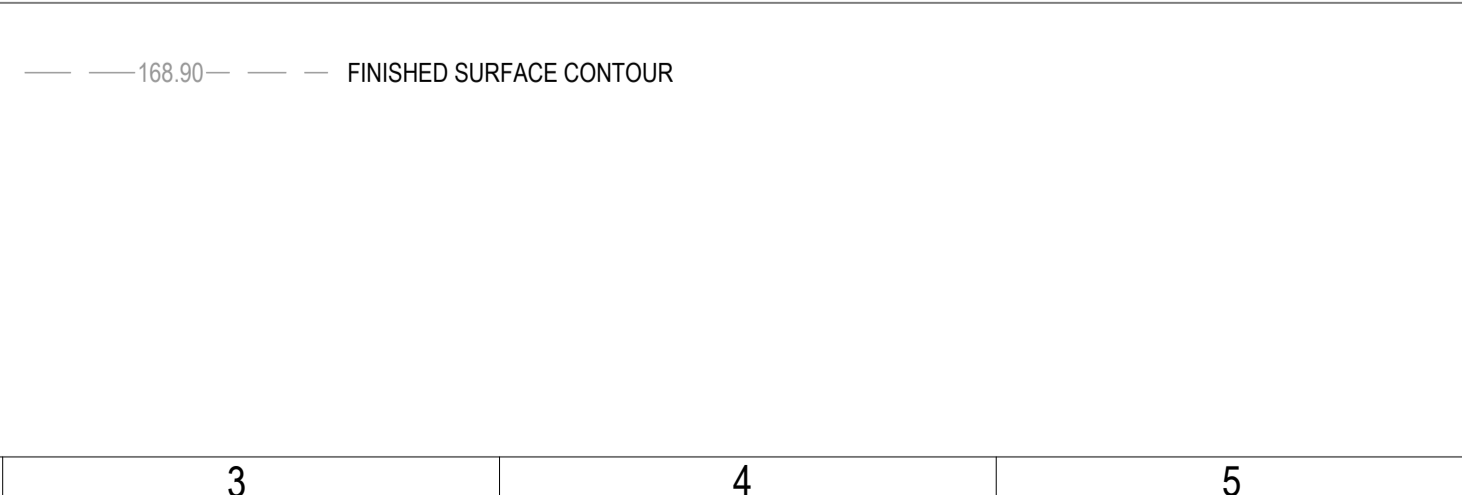

WOODWARD LAND & CIVIL PTY LTD
 ACN 637 572 466
 T: 0403 090 178
 info@woodwardcivil.com.au

North:

Drawing Status: **CONSTRUCTION ISSUE**

LENEVA VALLEY ESTATE, WODONGA
STAGE 2
DETAILED BECHING PLAN - 1

Designed : S.H.W	Date : #####
Authorised : S.H.W	Checked : ##
Drawing No. : W021012-LNVS2-SLP1	Revision : 1

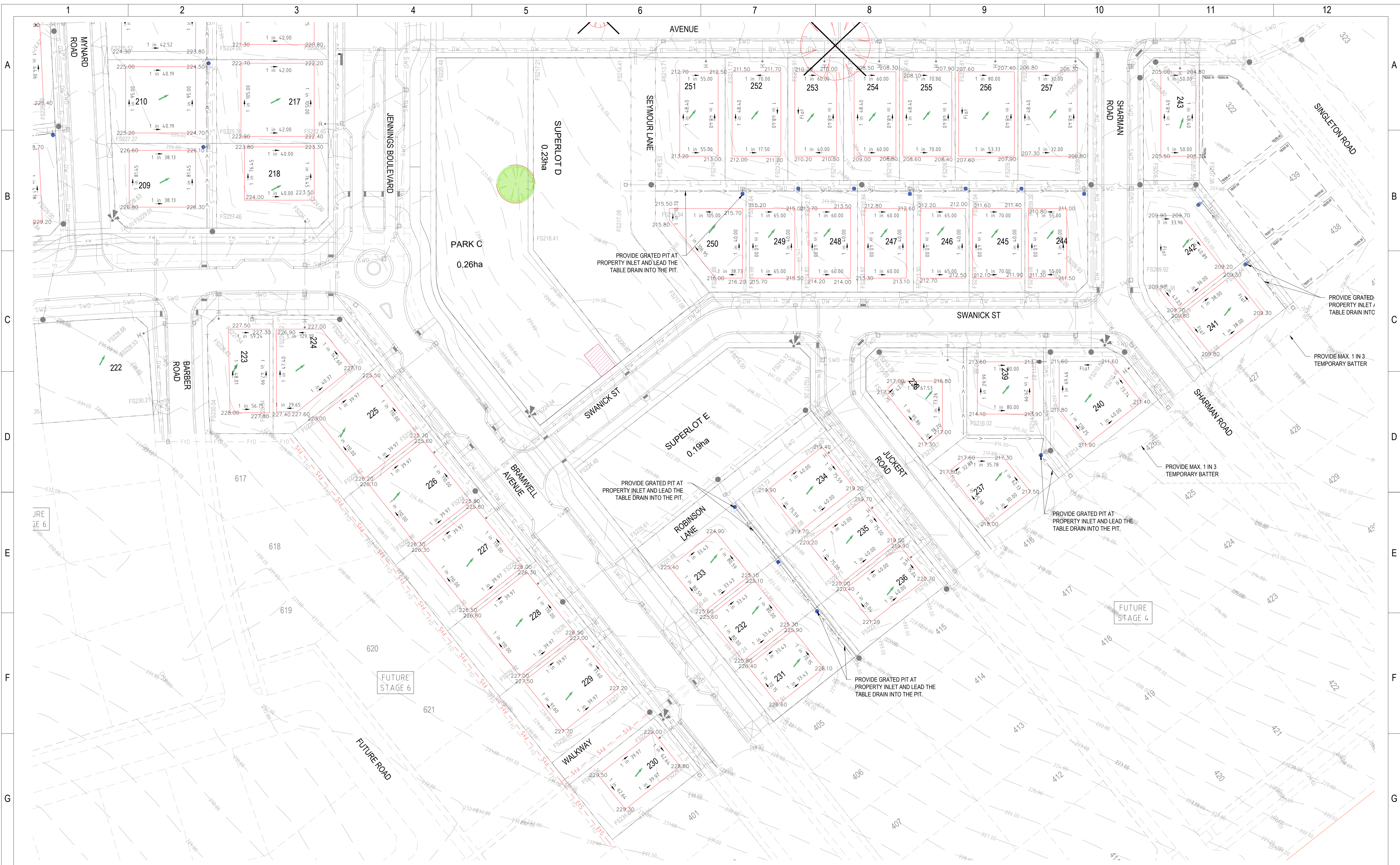

Rev.	Description	Approved	Date
1	ISSUE FOR INFORMATION	HT	2024/03/19
0	ISSUE FOR CONSTRUCTION	HT	12/10/2023
C	REMOVED RETAINING WALL	HT	05/10/2023
B	PAD DETAILING	HT	29/09/2023
A	PRELIMINARY ISSUE	HT	05/09/2023

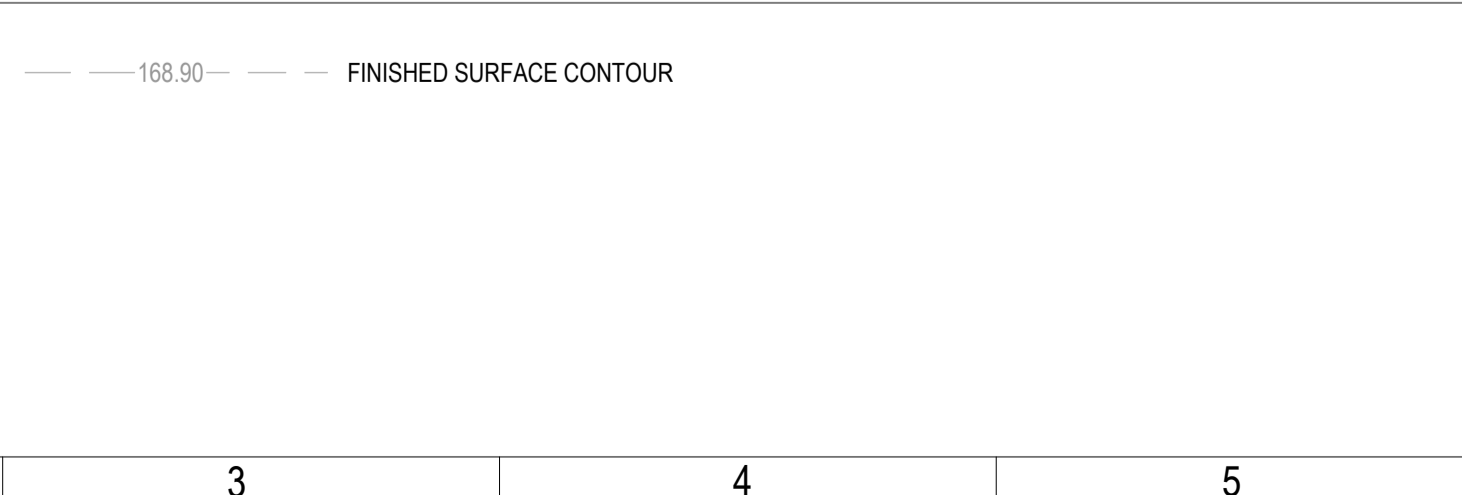

Scale:
 1:500 (A1) 0 5 10 15 20 25m
 1:1000 (A3) 0 10 20 30 40 50m

© Woodward Land & Civil Pty Ltd All Rights Reserved
 This document is produced by Woodward Land & Civil solely for the benefit of and use by the client in accordance with the terms of the retainer. Woodward Land & Civil Pty Ltd does not and shall not assume any responsibility or liability whatsoever to any third party arising out of any use or reliance by third party on the content of this documents.

WOODWARD LAND & CIVIL PTY LTD
 ACN 637 572 466
 T: 0403 090 178
 info@woodwardcivil.com.au

North:

Drawing Status: **CONSTRUCTION ISSUE**

LENEVA VALLEY ESTATE, WODONGA STAGE 2 DETAILED BENCHING PLAN - 2			
Designed :	S.H.W	Date :	####/####/####
Authorised :	S.H.W	Checked :	##
Drawing No.:	W021012-LNVS2-SLP2		Revision
			1

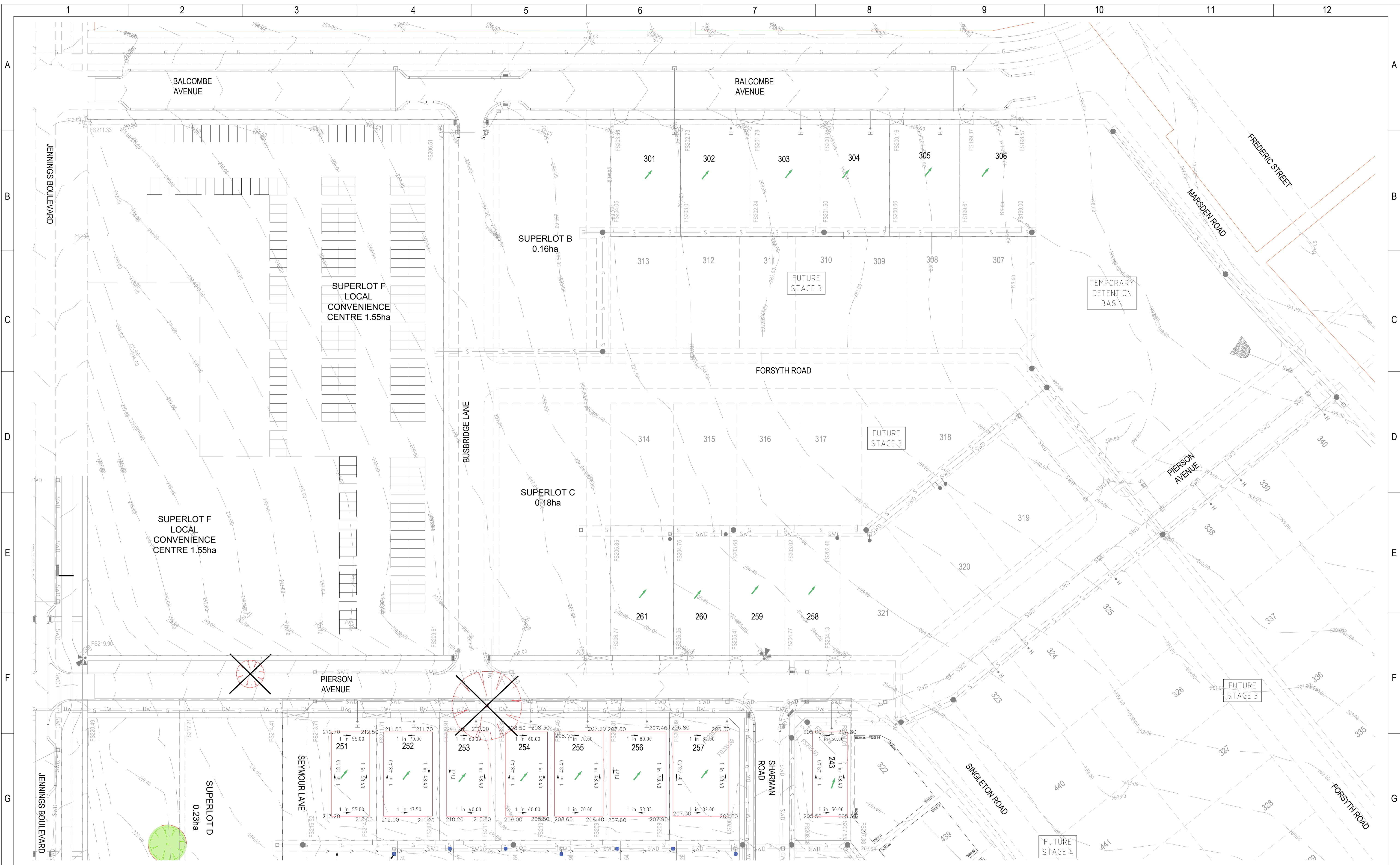

Rev.	Description	Approved	Date
1	ISSUE FOR INFORMATION	HT	2024/03/19
0	ISSUE FOR CONSTRUCTION	HT	12/10/2023
C	REMOVED RETAINING WALL	HT	05/10/2023
B	PAD DETAILING	HT	29/09/2023
A	PRELIMINARY ISSUE	HT	05/09/2023

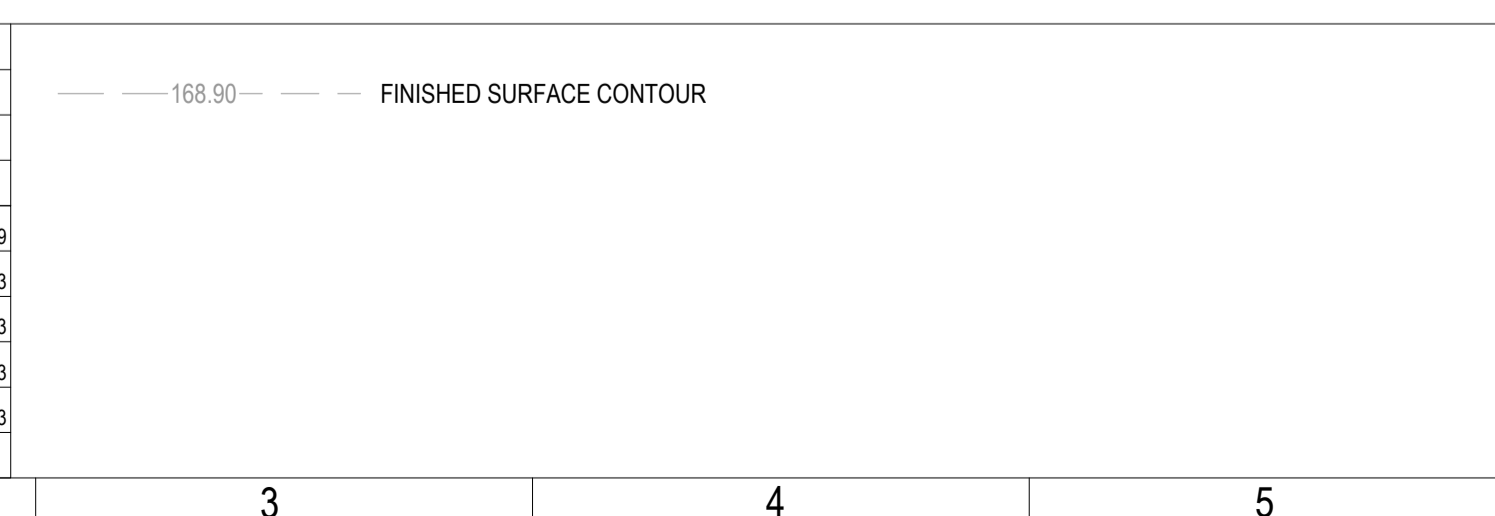

Scale:
1:500 (A1) 0 5 10 15 20 25m
1:1000 (A3) 0 10 20 30 40 50m

© Woodward Land & Civil Pty Ltd All Rights Reserved
This document is produced by Woodward Land & Civil solely for the benefit of and use by the client in accordance with the terms of the retainer. Woodward Land & Civil Pty Ltd does not and shall not assume any responsibility or liability whatsoever to any third party arising out of any use or reliance by third party on the content of this documents.

WOODWARD LAND & CIVIL PTY LTD
ACN 637 572 466
T: 0403 090 178
info@woodwardcivil.com.au

North:

Drawing Status: **CONSTRUCTION ISSUE**

LENEVA VALLEY ESTATE, WODONGA
STAGE 2
DETAILED BENCHING PLAN - 2

Designed : S.H.W	Date : #####
Authorised : S.H.W	Checked : ##
Drawing No. : W021012-LNVS2-SLP3	Revision : 1