

PROPERTY REPORT



Energy,
Environment
and Climate Action

From www.land.vic.gov.au at 15 February 2024 01:36 PM

PROPERTY DETAILS

Address: **4/8 EDNA STREET THOMASTOWN 3074**
Lot and Plan Number: **Lot 4 PS706904**
Standard Parcel Identifier (SPI): **4\PS706904**
Local Government Area (Council): **WHITTLESEA**
Council Property Number: **865600**
Directory Reference: **Melway 9 A8**

www.whittlesea.vic.gov.au

SITE DIMENSIONS

All dimensions and areas are approximate. They may not agree with those shown on a title or plan.

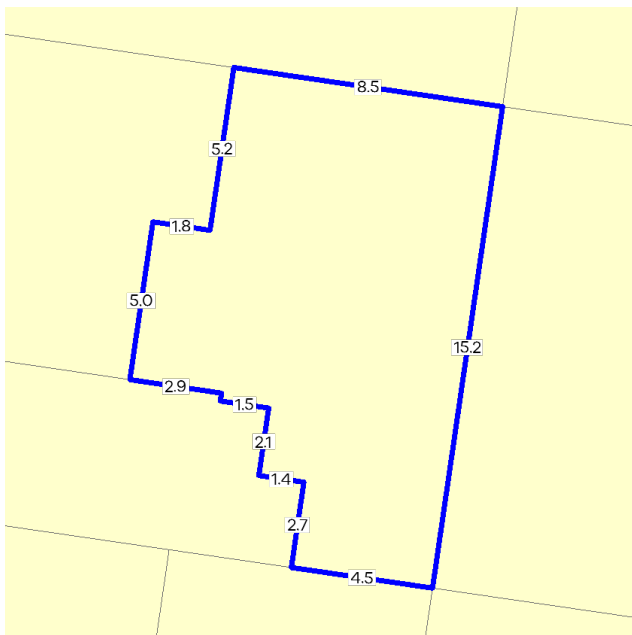

Area: 122 sq. m

Perimeter: 51 m

For this property:

— Site boundaries

— Road frontages

Dimensions for individual parcels require a separate search, but dimensions for individual units are generally not available.

1 overlapping dimension label is not being displayed

Calculating the area from the dimensions shown may give a different value to the area shown above

For more accurate dimensions get copy of plan at [Title and Property Certificates](#)

UTILITIES

Rural Water Corporation: **Southern Rural Water**
Melbourne Water Retailer: **Yarra Valley Water**
Melbourne Water: **Inside drainage boundary**
Power Distributor: **AUSNET**

STATE ELECTORATES

Legislative Council: **NORTHERN METROPOLITAN**
Legislative Assembly: **THOMASTOWN**

PLANNING INFORMATION

Property Planning details have been removed from the Property Reports to avoid duplication with the Planning Property Reports from the Department of Transport and Planning which are the authoritative source for all Property Planning information.

The Planning Property Report for this property can found here - [Planning Property Report](#)

Planning Property Reports can be found via these two links

Vicplan <https://mapshare.vic.gov.au/vicplan/>

Property and parcel search <https://www.land.vic.gov.au/property-and-parcel-search>

Area Map

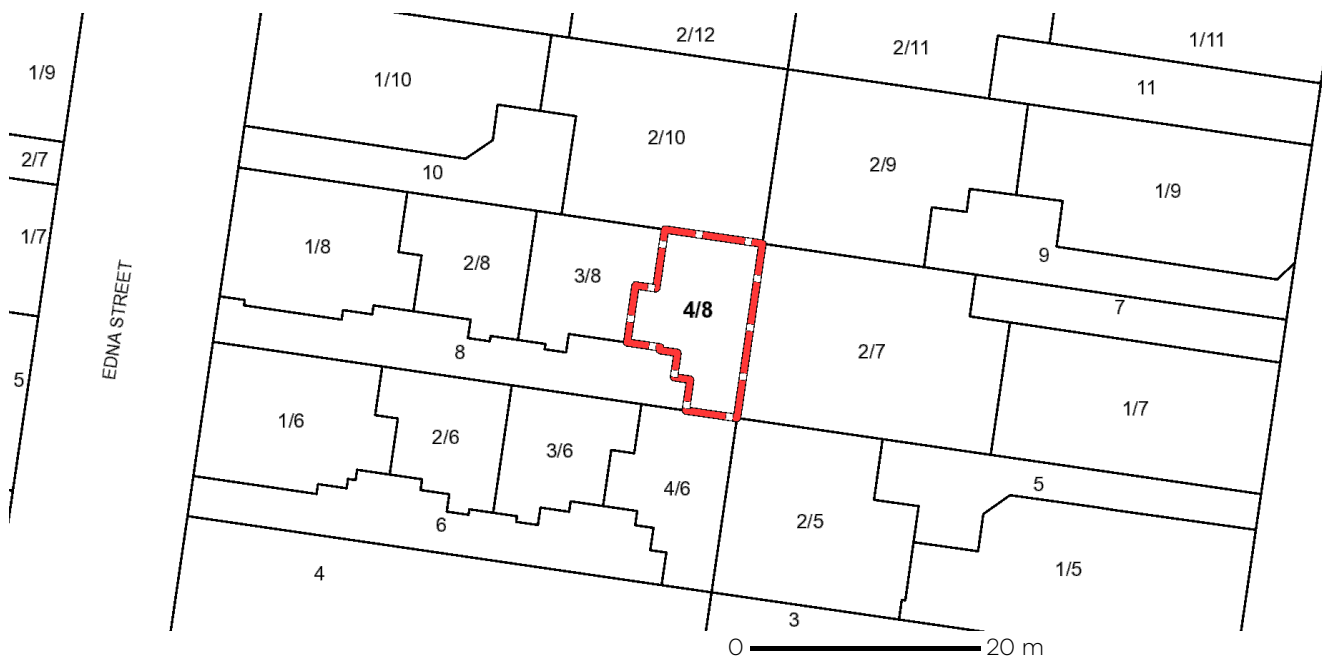

Selected Property