

© 2019 The Law Society of New South Wales ACN 000 000 699 and The Real Estate Institute of New South Wales ACN 000 012 457

You can prepare your own version of pages 1 - 3 of this contract. Except as permitted under the Copyright Act 1968 (Cth) or consented to by the copyright owners (including by way of guidelines issued from time to time), no other part of this contract may be reproduced without the specific written permission of The Law Society of New South Wales and The Real Estate Institute of New South Wales.

Contract for the sale and purchase of land 2019 edition

TERM	MEANING OF TERM	NSW DAN:
vendor's agent	UPSTATE Suite 15, Level 1, 888 Pittwater Road Dee Why NSW 2099	phone 9971 9000 / 0403 567 142 fax ref Chris Aldren
co-agent	Not Applicable	phone fax ref
vendor	MATTHEW PATRICK PRICE and NICOLA ELIZABETH PRICE 22A Grover Avenue, Cromer NSW 2099	
vendor's solicitor	MESSNER & BLUNDEN (a division of WMD LAW) 1 st Floor, 2 Hillcrest Road, Pennant Hills NSW 2120 DX 4715 Pennant Hills email: sue@wmdlaw.com.au	phone 61 2 9481 8777 fax 61 2 9542 3160 ref SAM:117329
date for completion	12 weeks day after the contract date (clause 15)	
land (address, plan details and title reference)	22A GROVER AVENUE, CROMER NSW 2099 Registered Plan: Lot 21 in Deposited Plan 877655 Folio Identifier 21/877655 <input checked="" type="checkbox"/> VACANT POSSESSION <input type="checkbox"/> subject to existing tenancies	
improvements	<input checked="" type="checkbox"/> HOUSE <input checked="" type="checkbox"/> garage <input type="checkbox"/> carport <input type="checkbox"/> home unit <input type="checkbox"/> carspace <input type="checkbox"/> storage space <input type="checkbox"/> none <input checked="" type="checkbox"/> other: garden shed	
attached copies	<input checked="" type="checkbox"/> documents in the List of Documents as marked or numbered: <input type="checkbox"/> other documents:	

A real estate agent is permitted by legislation to fill up the items in this box in a sale of residential property.

inclusions	<input checked="" type="checkbox"/> blinds <input checked="" type="checkbox"/> built-in wardrobes <input checked="" type="checkbox"/> clothes line <input checked="" type="checkbox"/> curtains	<input checked="" type="checkbox"/> dishwasher <input checked="" type="checkbox"/> fixed floor coverings <input type="checkbox"/> insect screens <input checked="" type="checkbox"/> other: remote controller for garage door, 3 x ceiling fans with remotes; built in cabinetry in living room	<input checked="" type="checkbox"/> light fittings <input checked="" type="checkbox"/> range hood <input type="checkbox"/> solar panels	<input checked="" type="checkbox"/> stove <input type="checkbox"/> pool equipment <input checked="" type="checkbox"/> TV antenna
exclusions				
purchaser				
purchaser's				
<input type="checkbox"/> solicitor	email:	phone		
<input type="checkbox"/> conveyancer		fax		
		ref		
price	\$			
deposit	\$		(10% of the price, unless otherwise stated)	
balance	\$			
contract date			(if not stated, the date this contract was made)	

buyer's agent

vendor

witness

GST AMOUNT (optional)
The price includes
GST of: \$

purchaser

☐ JOINT TENANTS ☐ tenants in common ☐ in unequal shares

witness

Choices

Vendor agrees to accept a **deposit bond** (clause 3) ☒ NO ☐ yes

Nominated Electronic Lodgment Network (ELN) (clause 30) PEXA

Electronic transaction (clause 30) ☐ no ☒ YES

(if no, vendor must provide further details, such as the proposed applicable waiver, in the space below, or serve within 14 days of the contract date):

Parties agree that the deposit be invested (clause 2.9) ☒ NO ☐ yes

Tax information (the parties promise this is correct as far as each party is aware)

Land tax is adjustable ☒ NO ☐ yes

GST: Taxable supply ☒ NO ☐ yes in full ☐ yes to an extent

Margin scheme will be used in making the taxable supply ☒ NO ☐ yes

This sale is not a taxable supply because (one or more of the following may apply) the sale is:

- ☒ not made in the course or furtherance of an enterprise that the vendor carries on (section 9-5(b))
- ☒ by a vendor who is neither registered nor required to be registered for GST (section 9-5(d))
- ☐ GST-free because the sale is the supply of a going concern under section 38-325
- ☐ GST-free because the sale is subdivided farm land or farm land supplied for farming under Subdivision 38-O
- ☒ input taxed because the sale is of eligible residential premises (sections 40-65, 40-75(2) and 195-1)

Purchaser must make an **GSTRW payment**: ☒ NO ☐ yes
(residential withholding payment) (if yes, vendor must provide further details)

If the further details below are not fully completed at the contract date, the vendor must provide all these details in a separate notice *within* 14 days of the contract date.

GSTRW payment (GST residential withholding payment) – further details

Frequently the supplier will be the vendor. However, sometimes further information will be required as to which entity is liable for GST, for example, if the supplier is a partnership, a trust, part of a GST group or a participant in a GST joint venture.

Supplier's name:

Supplier's ABN:

Supplier's GST branch number (if applicable):

Supplier's business address:

Supplier's email address:

Supplier's phone number:

Supplier's proportion of **GSTRW payment**:

If more than one supplier, provide the above details for each supplier.

Amount purchaser must pay – price multiplied by the **GSTRW rate** (residential withholding rate): \$

Amount must be paid: ☐ AT COMPLETION ☐ at another time (specify):

Is any of the consideration not expressed as an amount in money? ☐ NO ☐ yes

If "yes", the GST inclusive market value of the non-monetary consideration: \$

Other details (including those required by regulation or the ATO forms):

List of Documents

<p>General</p> <p><input checked="" type="checkbox"/> 1 property certificate for the land</p> <p><input checked="" type="checkbox"/> 2 plan of the land</p> <p><input type="checkbox"/> 3 unregistered plan of the land</p> <p><input type="checkbox"/> 4 plan of land to be subdivided</p> <p><input type="checkbox"/> 5 document that is to be lodged with a relevant plan</p> <p><input checked="" type="checkbox"/> 6 section 10.7(2) planning certificate (Environmental Planning and Assessment Act 1979)</p> <p><input checked="" type="checkbox"/> 7 additional information included in that certificate under section 10.7(5)</p> <p><input checked="" type="checkbox"/> 8 sewerage infrastructure location diagram (service location diagram)</p> <p><input checked="" type="checkbox"/> 9 sewerage lines location diagram (sewerage service diagram)</p> <p><input checked="" type="checkbox"/> 10 document that created or may have created an easement, profit à prendre, restriction on use or positive covenant disclosed in this contract</p> <p><input type="checkbox"/> 11 <i>planning agreement</i></p> <p><input type="checkbox"/> 12 section 88G certificate (positive covenant)</p> <p><input type="checkbox"/> 13 survey report</p> <p><input type="checkbox"/> 14 building information certificate or building certificate given under <i>legislation</i></p> <p><input type="checkbox"/> 15 lease (with every relevant memorandum or variation)</p> <p><input type="checkbox"/> 16 other document relevant to tenancies</p> <p><input type="checkbox"/> 17 licence benefiting the land</p> <p><input type="checkbox"/> 18 old system document</p> <p><input type="checkbox"/> 19 Crown purchase statement of account</p> <p><input type="checkbox"/> 20 building management statement</p> <p><input checked="" type="checkbox"/> 21 form of requisitions</p> <p><input type="checkbox"/> 22 <i>clearance certificate</i></p> <p><input checked="" type="checkbox"/> 23 land tax certificate</p> <p>Home Building Act 1989</p> <p><input type="checkbox"/> 24 insurance certificate</p> <p><input type="checkbox"/> 25 brochure or warning</p> <p><input type="checkbox"/> 26 evidence of alternative indemnity cover</p> <p>Swimming Pools Act 1992</p> <p><input type="checkbox"/> 27 certificate of compliance</p> <p><input type="checkbox"/> 28 evidence of registration</p> <p><input type="checkbox"/> 29 relevant occupation certificate</p> <p><input type="checkbox"/> 30 certificate of non-compliance</p> <p><input type="checkbox"/> 31 detailed reasons of non-compliance</p>	<p>Strata or community title (clause 23 of the contract)</p> <p><input type="checkbox"/> 32 property certificate for strata common property</p> <p><input type="checkbox"/> 33 plan creating strata common property</p> <p><input type="checkbox"/> 34 strata by-laws</p> <p><input type="checkbox"/> 35 strata development contract or statement</p> <p><input type="checkbox"/> 36 strata management statement</p> <p><input type="checkbox"/> 37 strata renewal proposal</p> <p><input type="checkbox"/> 38 strata renewal plan</p> <p><input type="checkbox"/> 39 leasehold strata - lease of lot and common property</p> <p><input type="checkbox"/> 40 property certificate for neighbourhood property</p> <p><input type="checkbox"/> 41 plan creating neighbourhood property</p> <p><input type="checkbox"/> 42 neighbourhood development contract</p> <p><input type="checkbox"/> 43 neighbourhood management statement</p> <p><input type="checkbox"/> 44 property certificate for precinct property</p> <p><input type="checkbox"/> 45 plan creating precinct property</p> <p><input type="checkbox"/> 46 precinct development contract</p> <p><input type="checkbox"/> 47 precinct management statement</p> <p><input type="checkbox"/> 48 property certificate for community property</p> <p><input type="checkbox"/> 49 plan creating community property</p> <p><input type="checkbox"/> 50 community development contract</p> <p><input type="checkbox"/> 51 community management statement</p> <p><input type="checkbox"/> 52 document disclosing a change of by-laws</p> <p><input type="checkbox"/> 53 document disclosing a change in a development or management contract or statement</p> <p><input type="checkbox"/> 54 document disclosing a change in boundaries</p> <p><input type="checkbox"/> 55 information certificate under Strata Schemes Management Act 2015</p> <p><input type="checkbox"/> 56 information certificate under Community Land Management Act 1989</p> <p><input type="checkbox"/> 57 disclosure statement - off the plan contract</p> <p>Other</p> <p><input type="checkbox"/> 58 Other:</p>
--	---

HOLDER OF STRATA OR COMMUNITY TITLE RECORDS – Name, address, email address and telephone number

IMPORTANT NOTICE TO VENDORS AND PURCHASERS

Before signing this contract you should ensure that you understand your rights and obligations, some of which are not written in this contract but are implied by law.

WARNING—SMOKE ALARMS

The owners of certain types of buildings and strata lots must have smoke alarms (or in certain cases heat alarms) installed in the building or lot in accordance with regulations under the *Environmental Planning and Assessment Act 1979*. It is an offence not to comply. It is also an offence to remove or interfere with a smoke alarm or heat alarm. Penalties apply.

WARNING—LOOSE-FILL ASBESTOS INSULATION

Before purchasing land that includes any residential premises (within the meaning of Division 1A of Part 8 of the *Home Building Act 1989*) built before 1985, a purchaser is strongly advised to consider the possibility that the premises may contain loose-fill asbestos insulation (within the meaning of Division 1A of Part 8 of the *Home Building Act 1989*). In particular, a purchaser should:

- (a) search the Register required to be maintained under Division 1A of Part 8 of the *Home Building Act 1989*, and
- (b) ask the relevant local council whether it holds any records showing that the residential premises contain loose-fill asbestos insulation.

For further information about loose-fill asbestos insulation (including areas in which residential premises have been identified as containing loose-fill asbestos insulation), contact NSW Fair Trading.

COOLING OFF PERIOD (PURCHASER'S RIGHTS)

1. This is the statement required by section 66X of the *Conveyancing Act 1919* and applies to a contract for the sale of residential property.
2. **EXCEPT** in the circumstances listed in paragraph 3, the purchaser may rescind the contract at any time before 5 pm on—
 - (a) the tenth business day after the day on which the contract was made—in the case of an off the plan contract, or
 - (b) the fifth business day after the day on which the contract was made—in any other case.
3. There is **NO COOLING OFF PERIOD**:
 - (a) if, at or before the time the contract is made, the purchaser gives to the vendor (or the vendor's solicitor or agent) a certificate that complies with section 66W of the Act, or
 - (b) if the property is sold by public auction, or
 - (c) if the contract is made on the same day as the property was offered for sale by public auction but passed in, or
 - (d) if the contract is made in consequence of the exercise of an option to purchase the property, other than an option that is void under section 66ZG of the Act.
4. A purchaser exercising the right to cool off by rescinding the contract will forfeit to the vendor 0.25% of the purchase price of the property. The vendor is entitled to recover the amount forfeited from any amount paid by the purchaser as a deposit under the contract and the purchaser is entitled to a refund of any balance.

DISPUTES

If you get into a dispute with the other party, the Law Society and Real Estate Institute encourage you to use informal procedures such as negotiation, independent expert appraisal, the Law Society Conveyancing Dispute Resolution Scheme or mediation (for example mediation under the Law Society Mediation Program).

AUCTIONS

Regulations made under the Property, Stock and Business Agents Act 2002 prescribe a number of conditions applying to sales by auction.

WARNINGS

1. Various Acts of Parliament and other matters can affect the rights of the parties to this contract. Some important matters are actions, claims, decisions, licences, notices, orders, proposals or rights of way involving:

APA Group Australian Taxation Office Council County Council Department of Planning, Industry and Environment Department of Primary Industries Electricity and gas Land & Housing Corporation Local Land Services	NSW Department of Education NSW Fair Trading Owner of adjoining land Privacy Public Works Advisory Subsidence Advisory NSW Telecommunications Transport for NSW Water, sewerage or drainage authority
---	--

If you think that any of these matters affects the property, tell your solicitor.
2. A lease may be affected by the Agricultural Tenancies Act 1990, the Residential Tenancies Act 2010 or the Retail Leases Act 1994.
3. If any purchase money is owing to the Crown, it will become payable before obtaining consent, or if no consent is needed, when the transfer is registered.
4. If a consent to transfer is required under legislation, see clause 27 as to the obligations of the parties.
5. The vendor should continue the vendor's insurance until completion. If the vendor wants to give the purchaser possession before completion, the vendor should first ask the insurer to confirm this will not affect the insurance.
6. The purchaser will usually have to pay transfer duty (and sometimes surcharge purchaser duty) on this contract. If duty is not paid on time, a purchaser may incur penalties.
7. If the purchaser agrees to the release of deposit, the purchaser's right to recover the deposit may stand behind the rights of others (for example the vendor's mortgagee).
8. The purchaser should arrange insurance as appropriate.
9. Some transactions involving personal property may be affected by the Personal Property Securities Act 2009.
10. A purchaser should be satisfied that finance will be available at the time of completing the purchase.
11. Where the market value of the property is at or above a legislated amount, the purchaser may have to comply with a foreign resident capital gains withholding payment obligation (even if the vendor is not a foreign resident). If so, this will affect the amount available to the vendor on completion.
12. Purchasers of some residential properties may have to withhold part of the purchase price to be credited towards the GST liability of the vendor. If so, this will also affect the amount available to the vendor. More information is available from the ATO.

The vendor sells and the purchaser buys the *property* for the price under these provisions instead of Schedule 3 Conveyancing Act 1919, subject to any *legislation* that cannot be excluded.

1 Definitions (a term in *italics* is a defined term)

In this contract, these terms (in any form) mean –

<i>adjustment date</i>	the earlier of the giving of possession to the purchaser or completion;
<i>bank</i>	the Reserve Bank of Australia or an authorised deposit-taking institution which is a bank, a building society or a credit union;
<i>business day</i>	any day except a bank or public holiday throughout NSW or a Saturday or Sunday;
<i>cheque</i>	a cheque that is not postdated or stale;
<i>clearance certificate</i>	a certificate within the meaning of s14-220 of Schedule 1 to the <i>TA Act</i> , that covers one or more days falling within the period from and including the contract date to completion;
<i>deposit-bond</i>	a deposit bond or guarantee from an issuer, with an expiry date and for an amount each approved by the vendor;
<i>depositholder</i>	vendor's agent (or if no vendor's agent is named in this contract, the vendor's <i>solicitor</i> , or if no vendor's <i>solicitor</i> is named in this contract, the buyer's agent);
<i>document of title</i>	document relevant to the title or the passing of title;
<i>FRCGW percentage</i>	the percentage mentioned in s14-200(3)(a) of Schedule 1 to the <i>TA Act</i> (12.5% as at 1 July 2017);
<i>FRCGW remittance</i>	a remittance which the purchaser must make under s14-200 of Schedule 1 to the <i>TA Act</i> , being the lesser of the <i>FRCGW percentage</i> of the price (inclusive of GST, if any) and the amount specified in a <i>variation served by a party</i> ;
<i>GST Act</i>	A New Tax System (Goods and Services Tax) Act 1999;
<i>GST rate</i>	the rate mentioned in s4 of A New Tax System (Goods and Services Tax Imposition - General) Act 1999 (10% as at 1 July 2000);
<i>GSTRW payment</i>	a payment which the purchaser must make under s14-250 of Schedule 1 to the <i>TA Act</i> (the price multiplied by the <i>GSTRW rate</i>);
<i>GSTRW rate</i>	the rate determined under ss14-250(6), (8) or (9) of Schedule 1 to the <i>TA Act</i> (as at 1 July 2018, usually 7% of the price if the margin scheme applies, 1/11 th if not);
<i>legislation</i>	an Act or a by-law, ordinance, regulation or rule made under an Act;
<i>normally</i>	subject to any other provision of this contract;
<i>party</i>	each of the vendor and the purchaser;
<i>property</i>	the land, the improvements, all fixtures and the inclusions, but not the exclusions;
<i>planning agreement</i>	a valid voluntary agreement within the meaning of s7.4 of the Environmental Planning and Assessment Act 1979 entered into in relation to the <i>property</i> ;
<i>requisition</i>	an objection, question or requisition (but the term does not include a claim);
<i>rescind</i>	rescind this contract from the beginning;
<i>serve</i>	serve in writing on the other <i>party</i> ;
<i>settlement cheque</i>	an unendorsed <i>cheque</i> made payable to the person to be paid and – <ul style="list-style-type: none"> • issued by a <i>bank</i> and drawn on itself; or • if authorised in writing by the vendor or the vendor's <i>solicitor</i>, some other <i>cheque</i>;
<i>solicitor</i>	in relation to a <i>party</i> , the <i>party's</i> solicitor or licensed conveyancer named in this contract or in a notice <i>served by the party</i> ;
<i>TA Act</i>	Taxation Administration Act 1953;
<i>terminate</i>	terminate this contract for breach;
<i>variation</i>	a variation made under s14-235 of Schedule 1 to the <i>TA Act</i> ;
<i>within</i>	in relation to a period, at any time before or during the period; and
<i>work order</i>	a valid direction, notice or order that requires work to be done or money to be spent on or in relation to the <i>property</i> or any adjoining footpath or road (but the term does not include a notice under s22E of the Swimming Pools Act 1992 or clause 22 of the Swimming Pools Regulation 2018).

2 Deposit and other payments before completion

- 2.1 The purchaser must pay the deposit to the *depositholder* as stakeholder.
- 2.2 *Normally*, the purchaser must pay the deposit on the making of this contract, and this time is essential.
- 2.3 If this contract requires the purchaser to pay any of the deposit by a later time, that time is also essential.
- 2.4 The purchaser can pay any of the deposit by giving cash (up to \$2,000) or by unconditionally giving a *cheque* to the *depositholder* or to the vendor, vendor's agent or vendor's *solicitor* for sending to the *depositholder* or by payment by electronic funds transfer to the *depositholder*.
- 2.5 If any of the deposit is not paid on time or a *cheque* for any of the deposit is not honoured on presentation, the vendor can *terminate*. This right to *terminate* is lost as soon as the deposit is paid in full.
- 2.6 If the vendor accepts a bond or guarantee for the deposit, clauses 2.1 to 2.5 do not apply.

BREACH OF COPYRIGHT MAY RESULT IN LEGAL ACTION

- 2.7 If the vendor accepts a bond or guarantee for part of the deposit, clauses 2.1 to 2.5 apply only to the balance.
- 2.8 If any of the deposit or of the balance of the price is paid before completion to the vendor or as the vendor directs, it is a charge on the land in favour of the purchaser until *termination* by the vendor or completion, subject to any existing right.
- 2.9 If each *party* tells the *depositholder* that the deposit is to be invested, the *depositholder* is to invest the deposit (at the risk of the *party* who becomes entitled to it) with a *bank*, in an interest-bearing account in NSW, payable at call, with interest to be reinvested, and pay the interest to the *parties* equally, after deduction of all proper government taxes and financial institution charges and other charges.

3 Deposit-bond

- 3.1 This clause applies only if this contract says the vendor has agreed to accept a *deposit-bond* for the deposit (or part of it).
- 3.2 The purchaser must provide the original *deposit-bond* to the vendor's *solicitor* (or if no *solicitor* the *depositholder*) at or before the making of this contract and this time is essential.
- 3.3 If the *deposit-bond* has an expiry date and completion does not occur by the date which is 14 days before the expiry date, the purchaser must *serve* a replacement *deposit-bond* at least 7 days before the expiry date. The time for service is essential.
- 3.4 The vendor must approve a replacement *deposit-bond* if –
- 3.4.1 it is from the same issuer and for the same amount as the earlier *deposit-bond*; and
- 3.4.2 it has an expiry date at least three months after its date of issue.
- 3.5 A breach of clauses 3.2 or 3.3 entitles the vendor to *terminate*. The right to *terminate* is lost as soon as –
- 3.5.1 the purchaser *serves* a replacement *deposit-bond*; or
- 3.5.2 the deposit is paid in full under clause 2.
- 3.6 Clauses 3.3 and 3.4 can operate more than once.
- 3.7 If the purchaser *serves* a replacement *deposit-bond*, the vendor must *serve* the earlier *deposit-bond*.
- 3.8 The amount of any *deposit-bond* does not form part of the price for the purposes of clause 16.7.
- 3.9 The vendor must give the purchaser the *deposit-bond* –
- 3.9.1 on completion; or
- 3.9.2 if this contract is *rescinded*.
- 3.10 If this contract is *terminated* by the vendor –
- 3.10.1 *normally*, the vendor can immediately demand payment from the issuer of the *deposit-bond*; or
- 3.10.2 if the purchaser *serves* prior to *termination* a notice disputing the vendor's right to *terminate*, the vendor must forward the *deposit-bond* (or its proceeds if called up) to the *depositholder* as stakeholder.
- 3.11 If this contract is *terminated* by the purchaser –
- 3.11.1 *normally*, the vendor must give the purchaser the *deposit-bond*; or
- 3.11.2 if the vendor *serves* prior to *termination* a notice disputing the purchaser's right to *terminate*, the vendor must forward the *deposit-bond* (or its proceeds if called up) to the *depositholder* as stakeholder.

4 Transfer

- 4.1 *Normally*, the purchaser must *serve* at least 14 days before the date for completion –
- 4.1.1 the form of transfer; and
- 4.1.2 particulars required to register any mortgage or other dealing to be lodged with the transfer by the purchaser or the purchaser's mortgagee.
- 4.2 If any information needed for the form of transfer is not disclosed in this contract, the vendor must *serve* it.
- 4.3 If the purchaser *serves* a form of transfer and the transferee is not the purchaser, the purchaser must give the vendor a direction signed by the purchaser personally for this form of transfer.
- 4.4 The vendor can require the purchaser to include a form of covenant or easement in the transfer only if this contract contains the wording of the proposed covenant or easement, and a description of the land benefited.

5 Requisitions

- 5.1 If a form of *requisitions* is attached to this contract, the purchaser is taken to have made those *requisitions*.
- 5.2 If the purchaser is or becomes entitled to make any other *requisition*, the purchaser can make it only by *serving* it –
- 5.2.1 if it arises out of this contract or it is a general question about the *property* or title - *within* 21 days after the contract date;
- 5.2.2 if it arises out of anything *served* by the vendor - *within* 21 days after the later of the contract date and that *service*; and
- 5.2.3 in any other case - *within* a reasonable time.

6 Error or misdescription

- 6.1 *Normally*, the purchaser can (but only before completion) claim compensation for an error or misdescription in this contract (as to the *property*, the title or anything else and whether substantial or not).
- 6.2 This clause applies even if the purchaser did not take notice of or rely on anything in this contract containing or giving rise to the error or misdescription.
- 6.3 However, this clause does not apply to the extent the purchaser knows the true position.

7 Claims by purchaser

Normally, the purchaser can make a claim (including a claim under clause 6) before completion only by *serving* it with a statement of the amount claimed, and if the purchaser makes one or more claims before completion –

- 7.1 the vendor can *rescind* if in the case of claims that are not claims for delay –
 - 7.1.1 the total amount claimed exceeds 5% of the price;
 - 7.1.2 the vendor *serves* notice of intention to *rescind*; and
 - 7.1.3 the purchaser does not *serve* notice waiving the claims *within* 14 days after that *service*; and
- 7.2 if the vendor does not *rescind*, the *parties* must complete and if this contract is completed –
 - 7.2.1 the lesser of the total amount claimed and 10% of the price must be paid out of the price to and held by the *depositholder* until the claims are finalised or lapse;
 - 7.2.2 the amount held is to be invested in accordance with clause 2.9;
 - 7.2.3 the claims must be finalised by an arbitrator appointed by the *parties* or, if an appointment is not made *within* 1 month of completion, by an arbitrator appointed by the President of the Law Society at the request of a *party* (in the latter case the *parties* are bound by the terms of the Conveyancing Arbitration Rules approved by the Law Society as at the date of the appointment);
 - 7.2.4 the purchaser is not entitled, in respect of the claims, to more than the total amount claimed and the costs of the purchaser;
 - 7.2.5 net interest on the amount held must be paid to the *parties* in the same proportion as the amount held is paid; and
 - 7.2.6 if the *parties* do not appoint an arbitrator and neither *party* requests the President to appoint an arbitrator *within* 3 months after completion, the claims lapse and the amount belongs to the vendor.

8 Vendor's rights and obligations

- 8.1 The vendor can *rescind* if –
 - 8.1.1 the vendor is, on reasonable grounds, unable or unwilling to comply with a *requisition*;
 - 8.1.2 the vendor *serves* a notice of intention to *rescind* that specifies the *requisition* and those grounds; and
 - 8.1.3 the purchaser does not *serve* a notice waiving the *requisition* *within* 14 days after that *service*.
- 8.2 If the vendor does not comply with this contract (or a notice under or relating to it) in an essential respect, the purchaser can *terminate* by *serving* a notice. After the *termination* –
 - 8.2.1 the purchaser can recover the deposit and any other money paid by the purchaser under this contract;
 - 8.2.2 the purchaser can sue the vendor to recover damages for breach of contract; and
 - 8.2.3 if the purchaser has been in possession a *party* can claim for a reasonable adjustment.

9 Purchaser's default

If the purchaser does not comply with this contract (or a notice under or relating to it) in an essential respect, the vendor can *terminate* by *serving* a notice. After the *termination* the vendor can –

- 9.1 keep or recover the deposit (to a maximum of 10% of the price);
- 9.2 hold any other money paid by the purchaser under this contract as security for anything recoverable under this clause –
 - 9.2.1 for 12 months after the *termination*; or
 - 9.2.2 if the vendor commences proceedings under this clause *within* 12 months, until those proceedings are concluded; and
- 9.3 sue the purchaser either –
 - 9.3.1 where the vendor has resold the *property* under a contract made *within* 12 months after the *termination*, to recover –
 - the deficiency on resale (with credit for any of the deposit kept or recovered and after allowance for any capital gains tax or goods and services tax payable on anything recovered under this clause); and
 - the reasonable costs and expenses arising out of the purchaser's non-compliance with this contract or the notice and of resale and any attempted resale; or
 - 9.3.2 to recover damages for breach of contract.

10 Restrictions on rights of purchaser

- 10.1 The purchaser cannot make a claim or *requisition* or *rescind* or *terminate* in respect of –
 - 10.1.1 the ownership or location of any fence as defined in the Dividing Fences Act 1991;
 - 10.1.2 a service for the *property* being a joint service or passing through another property, or any service for another property passing through the *property* ('service' includes air, communication, drainage, electricity, garbage, gas, oil, radio, sewerage, telephone, television or water service);
 - 10.1.3 a wall being or not being a party wall in any sense of that term or the *property* being affected by an easement for support or not having the benefit of an easement for support;
 - 10.1.4 any change in the *property* due to fair wear and tear before completion;
 - 10.1.5 a promise, representation or statement about this contract, the *property* or the title, not set out or referred to in this contract;
 - 10.1.6 a condition, exception, reservation or restriction in a Crown grant;

- 10.1.7 the existence of any authority or licence to explore or prospect for gas, minerals or petroleum;
- 10.1.8 any easement or restriction on use the substance of either of which is disclosed in this contract or any non-compliance with the easement or restriction on use; or
- 10.1.9 anything the substance of which is disclosed in this contract (except a caveat, charge, mortgage, priority notice or writ).
- 10.2 The purchaser cannot *rescind* or *terminate* only because of a defect in title to or quality of the inclusions.
- 10.3 *Normally*, the purchaser cannot make a claim or *requisition* or *rescind* or *terminate* or require the vendor to change the nature of the title disclosed in this contract (for example, to remove a caution evidencing qualified title, or to lodge a plan of survey as regards limited title).
- 11 Compliance with work orders**
- 11.1 *Normally*, the vendor must by completion comply with a *work order* made on or before the contract date and if this contract is completed the purchaser must comply with any other *work order*.
- 11.2 If the purchaser complies with a *work order*, and this contract is *rescinded* or *terminated*, the vendor must pay the expense of compliance to the purchaser.
- 12 Certificates and inspections**
- The vendor must do everything reasonable to enable the purchaser, subject to the rights of any tenant –
- 12.1 to have the *property* inspected to obtain any certificate or report reasonably required;
- 12.2 to apply (if necessary in the name of the vendor) for –
- 12.2.1 any certificate that can be given in respect of the *property* under *legislation*; or
- 12.2.2 a copy of any approval, certificate, consent, direction, notice or order in respect of the *property* given under *legislation*, even if given after the contract date; and
- 12.3 to make 1 inspection of the *property* in the 3 days before a time appointed for completion.
- 13 Goods and services tax (GST)**
- 13.1 Terms used in this clause which are not defined elsewhere in this contract and have a defined meaning in the *GST Act* have the same meaning in this clause.
- 13.2 *Normally*, if a *party* must pay the price or any other amount to the other *party* under this contract, GST is not to be added to the price or amount.
- 13.3 If under this contract a *party* must make an adjustment or payment for an expense of another party or pay an expense payable by or to a third party (for example, under clauses 14 or 20.7) –
- 13.3.1 the *party* must adjust or pay on completion any GST added to or included in the expense; but
- 13.3.2 the amount of the expense must be reduced to the extent the party receiving the adjustment or payment (or the representative member of a GST group of which that party is a member) is entitled to an input tax credit for the expense; and
- 13.3.3 if the adjustment or payment under this contract is consideration for a taxable supply, an amount for GST must be added at the *GST rate*.
- 13.4 If this contract says this sale is the supply of a going concern –
- 13.4.1 the *parties* agree the supply of the *property* is a supply of a going concern;
- 13.4.2 the vendor must, between the contract date and completion, carry on the enterprise conducted on the land in a proper and business-like way;
- 13.4.3 if the purchaser is not registered by the date for completion, the *parties* must complete and the purchaser must pay on completion, in addition to the price, an amount being the price multiplied by the *GST rate* ("the retention sum"). The retention sum is to be held by the *depositholder* and dealt with as follows –
- if *within* 3 months of completion the purchaser *serves* a letter from the Australian Taxation Office stating the purchaser is registered with a date of effect of registration on or before completion, the *depositholder* is to pay the retention sum to the purchaser; but
 - if the purchaser does not *serve* that letter *within* 3 months of completion, the *depositholder* is to pay the retention sum to the vendor; and
- 13.4.4 if the vendor, despite clause 13.4.1, *serves* a letter from the Australian Taxation Office stating the vendor has to pay GST on the supply, the purchaser must pay to the vendor on demand the amount of GST assessed.
- 13.5 *Normally*, the vendor promises the margin scheme will not apply to the supply of the *property*.
- 13.6 If this contract says the margin scheme is to apply in making the taxable supply, the *parties* agree that the margin scheme is to apply to the sale of the *property*.
- 13.7 If this contract says the sale is not a taxable supply –
- 13.7.1 the purchaser promises that the *property* will not be used and represents that the purchaser does not intend the *property* (or any part of the *property*) to be used in a way that could make the sale a taxable supply to any extent; and
- 13.7.2 the purchaser must pay the vendor on completion in addition to the price an amount calculated by multiplying the price by the *GST rate* if this sale is a taxable supply to any extent because of –
- a breach of clause 13.7.1; or
 - something else known to the purchaser but not the vendor.
- 13.8 If this contract says this sale is a taxable supply in full and does not say the margin scheme applies to the *property*, the vendor must pay the purchaser on completion an amount of one-eleventh of the price if –

- 13.8.1 this sale is not a taxable supply in full; or
- 13.8.2 the margin scheme applies to the *property* (or any part of the *property*).
- 13.9 If this contract says this sale is a taxable supply to an extent –
- 13.9.1 clause 13.7.1 does not apply to any part of the *property* which is identified as being a taxable supply; and
- 13.9.2 the payments mentioned in clauses 13.7 and 13.8 are to be recalculated by multiplying the relevant payment by the proportion of the price which represents the value of that part of the *property* to which the clause applies (the proportion to be expressed as a number between 0 and 1). Any evidence of value must be obtained at the expense of the vendor.
- 13.10 *Normally*, on completion the vendor must give the recipient of the supply a tax invoice for any taxable supply by the vendor by or under this contract.
- 13.11 The vendor does not have to give the purchaser a tax invoice if the margin scheme applies to a taxable supply.
- 13.12 If the vendor is liable for GST on rents or profits due to issuing an invoice or receiving consideration before completion, any adjustment of those amounts must exclude an amount equal to the vendor's GST liability.
- 13.13 If the purchaser must make a *GSTRW payment* the purchaser must –
- 13.13.1 at least 5 days before the date for completion, serve evidence of submission of a *GSTRW payment* notification form to the Australian Taxation Office by the purchaser or, if a direction under clause 4.3 has been served, by the transferee named in the transfer served with that direction;
- 13.13.2 produce on completion a *settlement cheque* for the *GSTRW payment* payable to the Deputy Commissioner of Taxation;
- 13.13.3 forward the *settlement cheque* to the payee immediately after completion; and
- 13.13.4 serve evidence of receipt of payment of the *GSTRW payment* and a copy of the settlement date confirmation form submitted to the Australian Taxation Office.

14 Adjustments

- 14.1 *Normally*, the vendor is entitled to the rents and profits and will be liable for all rates, water, sewerage and drainage service and usage charges, land tax, levies and all other periodic outgoings up to and including the *adjustment date* after which the purchaser will be entitled and liable.
- 14.2 The *parties* must make any necessary adjustment on completion.
- 14.3 If an amount that is adjustable under this contract has been reduced under *legislation*, the *parties* must on completion adjust the reduced amount.
- 14.4 The *parties* must not adjust surcharge land tax (as defined in the Land Tax Act 1956) but must adjust any other land tax for the year current at the *adjustment date* –
- 14.4.1 only if land tax has been paid or is payable for the year (whether by the vendor or by a predecessor in title) and this contract says that land tax is adjustable;
- 14.4.2 by adjusting the amount that would have been payable if at the start of the year –
- the person who owned the land owned no other land;
 - the land was not subject to a special trust or owned by a non-concessional company; and
 - if the land (or part of it) had no separate taxable value, by calculating its separate taxable value on a proportional area basis.
- 14.5 If any other amount that is adjustable under this contract relates partly to the land and partly to other land, the *parties* must adjust it on a proportional area basis.
- 14.6 *Normally*, the vendor can direct the purchaser to produce a *settlement cheque* on completion to pay an amount adjustable under this contract and if so –
- 14.6.1 the amount is to be treated as if it were paid; and
- 14.6.2 the *cheque* must be forwarded to the payee immediately after completion (by the purchaser if the *cheque* relates only to the *property* or by the vendor in any other case).
- 14.7 If on completion the last bill for a water, sewerage or drainage usage charge is for a period ending before the *adjustment date*, the vendor is liable for an amount calculated by dividing the bill by the number of days in the period then multiplying by the number of unbilled days up to and including the *adjustment date*.
- 14.8 The vendor is liable for any amount recoverable for work started on or before the contract date on the *property* or any adjoining footpath or road.

15 Date for completion

The *parties* must complete by the date for completion and, if they do not, a *party* can serve a notice to complete if that *party* is otherwise entitled to do so.

16 Completion

• Vendor

- 16.1 On completion the vendor must give the purchaser any *document of title* that relates only to the *property*.
- 16.2 If on completion the vendor has possession or control of a *document of title* that relates also to other property, the vendor must produce it as and where necessary.
- 16.3 *Normally*, on completion the vendor must cause the legal title to the *property* (being an estate in fee simple) to pass to the purchaser free of any mortgage or other interest, subject to any necessary registration.
- 16.4 The legal title to the *property* does not pass before completion.

- 16.5 If the vendor gives the purchaser a document (other than the transfer) that needs to be lodged for registration, the vendor must pay the lodgment fee to the purchaser.
- 16.6 If a *party serves* a land tax certificate showing a charge on any of the land, by completion the vendor must do all things and pay all money required so that the charge is no longer effective against the land.
- **Purchaser**
- 16.7 On completion the purchaser must pay to the vendor, by cash (up to \$2,000) or *settlement cheque* –
- 16.7.1 the price less any:
- deposit paid;
 - *FRCGW remittance* payable;
 - *GSTRW payment*; and
 - amount payable by the vendor to the purchaser under this contract; and
- 16.7.2 any other amount payable by the purchaser under this contract.
- 16.8 If the vendor requires more than 5 *settlement cheques*, the vendor must pay \$10 for each extra *cheque*.
- 16.9 If any of the deposit is not covered by a bond or guarantee, on completion the purchaser must give the vendor an order signed by the purchaser authorising the *depositholder* to account to the vendor for the deposit.
- 16.10 On completion the deposit belongs to the vendor.
- **Place for completion**
- 16.11 *Normally*, the *parties* must complete at the completion address, which is –
- 16.11.1 if a special completion address is stated in this contract - that address; or
- 16.11.2 if none is stated, but a first mortgagee is disclosed in this contract and the mortgagee would usually discharge the mortgage at a particular place - that place; or
- 16.11.3 in any other case - the vendor's *solicitor's* address stated in this contract.
- 16.12 The vendor by reasonable notice can require completion at another place, if it is in NSW, but the vendor must pay the purchaser's additional expenses, including any agency or mortgagee fee.
- 16.13 If the purchaser requests completion at a place that is not the completion address, and the vendor agrees, the purchaser must pay the vendor's additional expenses, including any agency or mortgagee fee.
- 17 Possession**
- 17.1 *Normally*, the vendor must give the purchaser vacant possession of the *property* on completion.
- 17.2 The vendor does not have to give vacant possession if –
- 17.2.1 this contract says that the sale is subject to existing tenancies; and
- 17.2.2 the contract discloses the provisions of the tenancy (for example, by attaching a copy of the lease and any relevant memorandum or variation).
- 17.3 *Normally*, the purchaser can claim compensation (before or after completion) or *rescind* if any of the land is affected by a protected tenancy (a tenancy affected by Schedule 2, Part 7 of the Residential Tenancies Act 2010).
- 18 Possession before completion**
- 18.1 This clause applies only if the vendor gives the purchaser possession of the *property* before completion.
- 18.2 The purchaser must not before completion –
- 18.2.1 let or part with possession of any of the *property*;
- 18.2.2 make any change or structural alteration or addition to the *property*; or
- 18.2.3 contravene any agreement between the *parties* or any direction, document, *legislation*, notice or order affecting the *property*.
- 18.3 The purchaser must until completion –
- 18.3.1 keep the *property* in good condition and repair having regard to its condition at the giving of possession; and
- 18.3.2 allow the vendor or the vendor's authorised representative to enter and inspect it at all reasonable times.
- 18.4 The risk as to damage to the *property* passes to the purchaser immediately after the purchaser enters into possession.
- 18.5 If the purchaser does not comply with this clause, then without affecting any other right of the vendor –
- 18.5.1 the vendor can before completion, without notice, remedy the non-compliance; and
- 18.5.2 if the vendor pays the expense of doing this, the purchaser must pay it to the vendor with interest at the rate prescribed under s101 Civil Procedure Act 2005.
- 18.6 If this contract is *rescinded* or *terminated* the purchaser must immediately vacate the *property*.
- 18.7 If the *parties* or their *solicitors* on their behalf do not agree in writing to a fee or rent, none is payable.
- 19 Rescission of contract**
- 19.1 If this contract expressly gives a *party* a right to *rescind*, the *party* can exercise the right –
- 19.1.1 only by *serving* a notice before completion; and
- 19.1.2 in spite of any making of a claim or *requisition*, any attempt to satisfy a claim or *requisition*, any arbitration, litigation, mediation or negotiation or any giving or taking of possession.
- 19.2 *Normally*, if a *party* exercises a right to *rescind* expressly given by this contract or any *legislation* –
- 19.2.1 the deposit and any other money paid by the purchaser under this contract must be refunded;
- 19.2.2 a *party* can claim for a reasonable adjustment if the purchaser has been in possession;
- 19.2.3 a *party* can claim for damages, costs or expenses arising out of a breach of this contract; and
- 19.2.4 a *party* will not otherwise be liable to pay the other *party* any damages, costs or expenses.

20 Miscellaneous

- 20.1 The *parties* acknowledge that anything stated in this contract to be attached was attached to this contract by the vendor before the purchaser signed it and is part of this contract.
- 20.2 Anything attached to this contract is part of this contract.
- 20.3 An area, bearing or dimension in this contract is only approximate.
- 20.4 If a *party* consists of 2 or more persons, this contract benefits and binds them separately and together.
- 20.5 A *party's solicitor* can receive any amount payable to the *party* under this contract or direct in writing that it is to be paid to another person.
- 20.6 A document under or relating to this contract is –
- 20.6.1 signed by a *party* if it is signed by the *party* or the *party's solicitor* (apart from a direction under clause 4.3);
- 20.6.2 *served* if it is *served* by the *party* or the *party's solicitor*;
- 20.6.3 *served* if it is *served* on the *party's solicitor*, even if the *party* has died or any of them has died;
- 20.6.4 *served* if it is *served* in any manner provided in s170 of the Conveyancing Act 1919;
- 20.6.5 *served* if it is sent by email or fax to the *party's solicitor*, unless in either case it is not received;
- 20.6.6 *served* on a person if it (or a copy of it) comes into the possession of the person; and
- 20.6.7 *served* at the earliest time it is *served*, if it is *served* more than once.
- 20.7 An obligation to pay an expense of another *party* of doing something is an obligation to pay –
- 20.7.1 if the *party* does the thing personally - the reasonable cost of getting someone else to do it; or
- 20.7.2 if the *party* pays someone else to do the thing - the amount paid, to the extent it is reasonable.
- 20.8 Rights under clauses 11, 13, 14, 17, 24, 30 and 31 continue after completion, whether or not other rights continue.
- 20.9 The vendor does not promise, represent or state that the purchaser has any cooling off rights.
- 20.10 The vendor does not promise, represent or state that any attached survey report is accurate or current.
- 20.11 A reference to any *legislation* (including any percentage or rate specified in *legislation*) is also a reference to any corresponding later *legislation*.
- 20.12 Each *party* must do whatever is necessary after completion to carry out the *party's* obligations under this contract.
- 20.13 Neither taking possession nor *serving* a transfer of itself implies acceptance of the *property* or the title.
- 20.14 The details and information provided in this contract (for example, on pages 1 - 3) are, to the extent of each *party's* knowledge, true, and are part of this contract.
- 20.15 Where this contract provides for choices, a choice in BLOCK CAPITALS applies unless a different choice is marked.

21 Time limits in these provisions

- 21.1 If the time for something to be done or to happen is not stated in these provisions, it is a reasonable time.
- 21.2 If there are conflicting times for something to be done or to happen, the latest of those times applies.
- 21.3 The time for one thing to be done or to happen does not extend the time for another thing to be done or to happen.
- 21.4 If the time for something to be done or to happen is the 29th, 30th or 31st day of a month, and the day does not exist, the time is instead the last day of the month.
- 21.5 If the time for something to be done or to happen is a day that is not a *business day*, the time is extended to the next *business day*, except in the case of clauses 2 and 3.2.
- 21.6 *Normally*, the time by which something must be done is fixed but not essential.

22 Foreign Acquisitions and Takeovers Act 1975

- 22.1 The purchaser promises that the Commonwealth Treasurer cannot prohibit and has not prohibited the transfer under the Foreign Acquisitions and Takeovers Act 1975.
- 22.2 This promise is essential and a breach of it entitles the vendor to *terminate*.

23 Strata or community title**• Definitions and modifications**

- 23.1 This clause applies only if the land (or part of it) is a lot in a strata, neighbourhood, precinct or community scheme (or on completion is to be a lot in a scheme of that kind).
- 23.2 In this contract –
- 23.2.1 'change', in relation to a scheme, means –
- a registered or registrable change from by-laws set out in this contract;
 - a change from a development or management contract or statement set out in this contract; or
 - a change in the boundaries of common property;
- 23.2.2 'common property' includes association property for the scheme or any higher scheme;
- 23.2.3 'contribution' includes an amount payable under a by-law;
- 23.2.4 'information certificate' includes a certificate under s184 Strata Schemes Management Act 2015 and s26 Community Land Management Act 1989;
- 23.2.5 'information notice' includes a strata information notice under s22 Strata Schemes Management Act 2015 and a notice under s47 Community Land Management Act 1989;

- 23.2.6 'normal expenses', in relation to an owners corporation for a scheme, means normal operating expenses usually payable from the administrative fund of an owners corporation for a scheme of the same kind;
- 23.2.7 'owners corporation' means the owners corporation or the association for the scheme or any higher scheme;
- 23.2.8 'the *property*' includes any interest in common property for the scheme associated with the lot; and
- 23.2.9 'special expenses', in relation to an owners corporation, means its actual, contingent or expected expenses, except to the extent they are –
- normal expenses;
 - due to fair wear and tear;
 - disclosed in this contract; or
 - covered by moneys held in the capital works fund.
- 23.3 Clauses 11, 14.8 and 18.4 do not apply to an obligation of the owners corporation, or to property insurable by it.
- 23.4 Clauses 14.4.2 and 14.5 apply but on a unit entitlement basis instead of an area basis.
- **Adjustments and liability for expenses**
- 23.5 The *parties* must adjust under clause 14.1 –
- 23.5.1 a regular periodic contribution;
- 23.5.2 a contribution which is not a regular periodic contribution but is disclosed in this contract; and
- 23.5.3 on a unit entitlement basis, any amount paid by the vendor for a normal expense of the owners corporation to the extent the owners corporation has not paid the amount to the vendor.
- 23.6 If a contribution is not a regular periodic contribution and is not disclosed in this contract –
- 23.6.1 the vendor is liable for it if it was determined on or before the contract date, even if it is payable by instalments; and
- 23.6.2 the purchaser is liable for all contributions determined after the contract date.
- 23.7 The vendor must pay or allow to the purchaser on completion the amount of any unpaid contributions for which the vendor is liable under clause 23.6.1.
- 23.8 *Normally*, the purchaser cannot make a claim or *requisition* or *rescind* or *terminate* in respect of –
- 23.8.1 an existing or future actual, contingent or expected expense of the owners corporation;
- 23.8.2 a proportional unit entitlement of the lot or a relevant lot or former lot, apart from a claim under clause 6; or
- 23.8.3 a past or future change in the scheme or a higher scheme.
- 23.9 However, the purchaser can *rescind* if –
- 23.9.1 the special expenses of the owners corporation at the later of the contract date and the creation of the owners corporation when calculated on a unit entitlement basis (and, if more than one lot or a higher scheme is involved, added together), less any contribution paid by the vendor, are more than 1% of the price;
- 23.9.2 in the case of the lot or a relevant lot or former lot in a higher scheme, a proportional unit entitlement for the lot is disclosed in this contract but the lot has a different proportional unit entitlement at the contract date or at any time before completion;
- 23.9.3 a change before the contract date or before completion in the scheme or a higher scheme materially prejudices the purchaser and is not disclosed in this contract; or
- 23.9.4 a resolution is passed by the owners corporation before the contract date or before completion to give to the owners in the scheme for their consideration a strata renewal plan that has not lapsed at the contract date and there is not attached to this contract a strata renewal proposal or the strata renewal plan.
- **Notices, certificates and inspections**
- 23.10 The purchaser must give the vendor 2 copies of an information notice addressed to the owners corporation and signed by the purchaser.
- 23.11 The vendor must complete and sign 1 copy of the notice and give it to the purchaser on completion.
- 23.12 Each *party* can sign and give the notice as agent for the other.
- 23.13 The vendor must *serve* an information certificate issued after the contract date in relation to the lot, the scheme or any higher scheme at least 7 days before the date for completion.
- 23.14 The purchaser does not have to complete earlier than 7 days after *service* of the certificate and clause 21.3 does not apply to this provision. On completion the purchaser must pay the vendor the prescribed fee for the certificate.
- 23.15 The vendor authorises the purchaser to apply for the purchaser's own certificate.
- 23.16 The vendor authorises the purchaser to apply for and make an inspection of any record or other document in the custody or control of the owners corporation or relating to the scheme or any higher scheme.
- **Meetings of the owners corporation**
- 23.17 If a general meeting of the owners corporation is convened before completion –
- 23.17.1 if the vendor receives notice of it, the vendor must immediately notify the purchaser of it; and
- 23.17.2 after the expiry of any cooling off period, the purchaser can require the vendor to appoint the purchaser (or the purchaser's nominee) to exercise any voting rights of the vendor in respect of the lot at the meeting.

24 Tenancies

- 24.1 If a tenant has not made a payment for a period preceding or current at the *adjustment date* –
- 24.1.1 for the purposes of clause 14.2, the amount is to be treated as if it were paid; and
- 24.1.2 the purchaser assigns the debt to the vendor on completion and will if required give a further assignment at the vendor's expense.
- 24.2 If a tenant has paid in advance of the *adjustment date* any periodic payment in addition to rent, it must be adjusted as if it were rent for the period to which it relates.
- 24.3 If the *property* is to be subject to a tenancy on completion or is subject to a tenancy on completion –
- 24.3.1 the vendor authorises the purchaser to have any accounting records relating to the tenancy inspected and audited and to have any other document relating to the tenancy inspected;
- 24.3.2 the vendor must *serve* any information about the tenancy reasonably requested by the purchaser before or after completion; and
- 24.3.3 *normally*, the purchaser can claim compensation (before or after completion) if
- a disclosure statement required by the Retail Leases Act 1994 was not given when required;
 - such a statement contained information that was materially false or misleading;
 - a provision of the lease is not enforceable because of a non-disclosure in such a statement; or
 - the lease was entered into in contravention of the Retail Leases Act 1994.
- 24.4 If the *property* is subject to a tenancy on completion –
- 24.4.1 the vendor must allow or transfer –
- any remaining bond money or any other security against the tenant's default (to the extent the security is transferable);
 - any money in a fund established under the lease for a purpose and compensation for any money in the fund or interest earned by the fund that has been applied for any other purpose; and
 - any money paid by the tenant for a purpose that has not been applied for that purpose and compensation for any of the money that has been applied for any other purpose;
- 24.4.2 if the security is not transferable, each *party* must do everything reasonable to cause a replacement security to issue for the benefit of the purchaser and the vendor must hold the original security on trust for the benefit of the purchaser until the replacement security issues;
- 24.4.3 the vendor must give to the purchaser –
- a proper notice of the transfer (an attornment notice) addressed to the tenant;
 - any certificate given under the Retail Leases Act 1994 in relation to the tenancy;
 - a copy of any disclosure statement given under the Retail Leases Act 1994;
 - a copy of any document served on the tenant under the lease and written details of its service, if the document concerns the rights of the landlord or the tenant after completion; and
 - any document served by the tenant under the lease and written details of its service, if the document concerns the rights of the landlord or the tenant after completion;
- 24.4.4 the vendor must comply with any obligation to the tenant under the lease, to the extent it is to be complied with by completion; and
- 24.4.5 the purchaser must comply with any obligation to the tenant under the lease, to the extent that the obligation is disclosed in this contract and is to be complied with after completion.

25 Qualified title, limited title and old system title

- 25.1 This clause applies only if the land (or part of it) –
- 25.1.1 is under qualified, limited or old system title; or
- 25.1.2 on completion is to be under one of those titles.
- 25.2 The vendor must *serve* a proper abstract of title *within* 7 days after the contract date.
- 25.3 If an abstract of title or part of an abstract of title is attached to this contract or has been lent by the vendor to the purchaser before the contract date, the abstract or part is *served* on the contract date.
- 25.4 An abstract of title can be or include a list of documents, events and facts arranged (apart from a will or codicil) in date order, if the list in respect of each document –
- 25.4.1 shows its date, general nature, names of parties and any registration number; and
- 25.4.2 has attached a legible photocopy of it or of an official or registration copy of it.
- 25.5 An abstract of title –
- 25.5.1 must start with a good root of title (if the good root of title must be at least 30 years old, this means 30 years old at the contract date);
- 25.5.2 in the case of a leasehold interest, must include an abstract of the lease and any higher lease;
- 25.5.3 *normally*, need not include a Crown grant; and
- 25.5.4 need not include anything evidenced by the Register kept under the Real Property Act 1900.
- 25.6 In the case of land under old system title –
- 25.6.1 in this contract 'transfer' means conveyance;
- 25.6.2 the purchaser does not have to *serve* the form of transfer until after the vendor has *served* a proper abstract of title; and
- 25.6.3 each vendor must give proper covenants for title as regards that vendor's interest.
- 25.7 In the case of land under limited title but not under qualified title –

- 25.7.1 *normally*, the abstract of title need not include any document which does not show the location, area or dimensions of the land (for example, by including a metes and bounds description or a plan of the land);
- 25.7.2 clause 25.7.1 does not apply to a document which is the good root of title; and
- 25.7.3 the vendor does not have to provide an abstract if this contract contains a delimitation plan (whether in registrable form or not).
- 25.8 The vendor must give a proper covenant to produce where relevant.
- 25.9 The vendor does not have to produce or covenant to produce a document that is not in the possession of the vendor or a mortgagee.
- 25.10 If the vendor is unable to produce an original document in the chain of title, the purchaser will accept a photocopy from the Registrar-General of the registration copy of that document.
- 26 Crown purchase money**
- 26.1 This clause applies only if purchase money is payable to the Crown, whether or not due for payment.
- 26.2 The vendor is liable for the money, except to the extent this contract says the purchaser is liable for it.
- 26.3 To the extent the vendor is liable for it, the vendor is liable for any interest until completion.
- 26.4 To the extent the purchaser is liable for it, the *parties* must adjust any interest under clause 14.1.
- 27 Consent to transfer**
- 27.1 This clause applies only if the land (or part of it) cannot be transferred without consent under *legislation* or a *planning agreement*.
- 27.2 The purchaser must properly complete and then *serve* the purchaser's part of an application for consent to transfer of the land (or part of it) *within 7 days* after the contract date.
- 27.3 The vendor must apply for consent *within 7 days* after *service* of the purchaser's part.
- 27.4 If consent is refused, either *party* can *rescind*.
- 27.5 If consent is given subject to one or more conditions that will substantially disadvantage a *party*, then that *party* can *rescind within 7 days* after receipt by or *service* upon the *party* of written notice of the conditions.
- 27.6 If consent is not given or refused –
- 27.6.1 *within 42 days* after the purchaser *serves* the purchaser's part of the application, the purchaser can *rescind*; or
- 27.6.2 *within 30 days* after the application is made, either *party* can *rescind*.
- 27.7 Each period in clause 27.6 becomes 90 days if the land (or part of it) is –
- 27.7.1 under a *planning agreement*; or
- 27.7.2 in the Western Division.
- 27.8 If the land (or part of it) is described as a lot in an unregistered plan, each time in clause 27.6 becomes the later of the time and 35 days after creation of a separate folio for the lot.
- 27.9 The date for completion becomes the later of the date for completion and 14 days after *service* of the notice granting consent to transfer.
- 28 Unregistered plan**
- 28.1 This clause applies only if some of the land is described as a lot in an unregistered plan.
- 28.2 The vendor must do everything reasonable to have the plan registered *within 6 months* after the contract date, with or without any minor alteration to the plan or any document to be lodged with the plan validly required or made under *legislation*.
- 28.3 If the plan is not registered *within* that time and in that manner –
- 28.3.1 the purchaser can *rescind*; and
- 28.3.2 the vendor can *rescind*, but only if the vendor has complied with clause 28.2 and with any *legislation* governing the rescission.
- 28.4 Either *party* can *serve* notice of the registration of the plan and every relevant lot and plan number.
- 28.5 The date for completion becomes the later of the date for completion and 21 days after *service* of the notice.
- 28.6 Clauses 28.2 and 28.3 apply to another plan that is to be registered before the plan is registered.
- 29 Conditional contract**
- 29.1 This clause applies only if a provision says this contract or completion is conditional on an event.
- 29.2 If the time for the event to happen is not stated, the time is 42 days after the contract date.
- 29.3 If this contract says the provision is for the benefit of a *party*, then it benefits only that *party*.
- 29.4 If anything is necessary to make the event happen, each *party* must do whatever is reasonably necessary to cause the event to happen.
- 29.5 A *party* can *rescind* under this clause only if the *party* has substantially complied with clause 29.4.
- 29.6 If the event involves an approval and the approval is given subject to a condition that will substantially disadvantage a *party* who has the benefit of the provision, the *party* can *rescind within 7 days* after either *party* *serves* notice of the condition.
- 29.7 If the *parties* can lawfully complete without the event happening –
- 29.7.1 if the event does not happen *within* the time for it to happen, a *party* who has the benefit of the provision can *rescind within 7 days* after the end of that time;
- 29.7.2 if the event involves an approval and an application for the approval is refused, a *party* who has the benefit of the provision can *rescind within 7 days* after either *party* *serves* notice of the refusal; and

- 29.7.3 the date for completion becomes the later of the date for completion and 21 days after the earliest of –
- either *party serving* notice of the event happening;
 - every *party* who has the benefit of the provision *serving* notice waiving the provision; or
 - the end of the time for the event to happen.
- 29.8 If the *parties* cannot lawfully complete without the event happening –
- 29.8.1 if the event does not happen *within* the time for it to happen, either *party* can *rescind*;
- 29.8.2 if the event involves an approval and an application for the approval is refused, either *party* can *rescind*;
- 29.8.3 the date for completion becomes the later of the date for completion and 21 days after either *party* serves notice of the event happening.
- 29.9 A *party* cannot *rescind* under clauses 29.7 or 29.8 after the event happens.
- 30 Electronic transaction**
- 30.1 This *Conveyancing Transaction* is to be conducted as an *electronic transaction* if –
- 30.1.1 this contract says that it is an *electronic transaction*;
- 30.1.2 the *parties* otherwise agree that it is to be conducted as an *electronic transaction*; or
- 30.1.3 the *conveyancing rules* require it to be conducted as an *electronic transaction*.
- 30.2 However, this *Conveyancing Transaction* is not to be conducted as an *electronic transaction* –
- 30.2.1 if the land is not *electronically tradeable* or the transfer is not eligible to be lodged electronically; or
- 30.2.2 if, at any time after the *effective date*, but at least 14 days before the date for completion, a *party* serves a notice stating a valid reason why it cannot be conducted as an *electronic transaction*.
- 30.3 If, because of clause 30.2.2, this *Conveyancing Transaction* is not to be conducted as an *electronic transaction* –
- 30.3.1 each *party* must –
- bear equally any disbursements or fees; and
 - otherwise bear that *party's* own costs;
- incurred because this *Conveyancing Transaction* was to be conducted as an *electronic transaction*; and
- 30.3.2 if a *party* has paid all of a disbursement or fee which, by reason of this clause, is to be borne equally by the *parties*, that amount must be adjusted under clause 14.2.
- 30.4 If this *Conveyancing Transaction* is to be conducted as an *electronic transaction* –
- 30.4.1 to the extent that any other provision of this contract is inconsistent with this clause, the provisions of this clause prevail;
- 30.4.2 *normally*, words and phrases used in this clause 30 (italicised and in Title Case, such as *Electronic Workspace* and *Lodgment Case*) have the same meaning which they have in the *participation rules*;
- 30.4.3 the *parties* must conduct the *electronic transaction* –
- in accordance with the *participation rules* and the *ECNL*; and
 - using the nominated *ELN*, unless the *parties* otherwise agree;
- 30.4.4 a *party* must pay the fees and charges payable by that *party* to the *ELNO* and the *Land Registry* as a result of this transaction being an *electronic transaction*;
- 30.4.5 any communication from one *party* to another *party* in the *Electronic Workspace* made –
- after the *effective date*; and
 - before the receipt of a notice given under clause 30.2.2;
- is taken to have been received by that *party* at the time determined by s13A of the *Electronic Transactions Act 2000*; and
- 30.4.6 a document which is an *electronic document* is served as soon as it is first *Digitally Signed* in the *Electronic Workspace* on behalf of the *party* required to serve it.
- 30.5 *Normally*, the vendor must *within 7 days of the effective date* –
- 30.5.1 create an *Electronic Workspace*;
- 30.5.2 *populate* the *Electronic Workspace* with *title data*, the date for completion and, if applicable, *mortgagee details*; and
- 30.5.3 invite the purchaser and any *discharging mortgagee* to the *Electronic Workspace*.
- 30.6 If the vendor has not created an *Electronic Workspace* in accordance with clause 30.5, the purchaser may create an *Electronic Workspace*. If the purchaser creates the *Electronic Workspace* the purchaser must –
- 30.6.1 *populate* the *Electronic Workspace* with *title data*;
- 30.6.2 create and *populate* an *electronic transfer*;
- 30.6.3 *populate* the *Electronic Workspace* with the date for completion and a nominated *completion time*; and
- 30.6.4 invite the vendor and any *incoming mortgagee* to join the *Electronic Workspace*.
- 30.7 *Normally*, *within 7 days of receiving an invitation from the vendor to join the Electronic Workspace*, the purchaser must –
- 30.7.1 join the *Electronic Workspace*;
- 30.7.2 create and *populate* an *electronic transfer*;
- 30.7.3 invite any *incoming mortgagee* to join the *Electronic Workspace*; and
- 30.7.4 *populate* the *Electronic Workspace* with a nominated *completion time*.

- 30.8 If the purchaser has created the *Electronic Workspace* the vendor must *within 7 days* of being invited to the *Electronic Workspace* –
- 30.8.1 join the *Electronic Workspace*;
 - 30.8.2 *populate* the *Electronic Workspace* with *mortgagee details*, if applicable; and
 - 30.8.3 invite any *discharging mortgagee* to join the *Electronic Workspace*.
- 30.9 To complete the financial settlement schedule in the *Electronic Workspace* –
- 30.9.1 the purchaser must provide the vendor with *adjustment figures* at least *2 business days* before the date for completion;
 - 30.9.2 the vendor must confirm the *adjustment figures* at least *1 business day* before the date for completion; and
 - 30.9.3 if the purchaser must make a *GSTRW payment* or an *FRCGW remittance*, the purchaser must *populate* the *Electronic Workspace* with the payment details for the *GSTRW payment* or *FRCGW remittance* payable to the Deputy Commissioner of Taxation at least *2 business days* before the date for completion.
- 30.10 Before completion, the *parties* must ensure that –
- 30.10.1 all *electronic documents* which a *party* must *Digitally Sign* to complete the *electronic transaction* are *populated* and *Digitally Signed*;
 - 30.10.2 all certifications required by the *ECNL* are properly given; and
 - 30.10.3 they do everything else in the *Electronic Workspace* which that *party* must do to enable the *electronic transaction* to proceed to completion.
- 30.11 If completion takes place in the *Electronic Workspace* –
- 30.11.1 payment electronically on completion of the price in accordance with clause 16.7 is taken to be payment by a single *settlement cheque*;
 - 30.11.2 the completion address in clause 16.11 is the *Electronic Workspace*; and
 - 30.11.3 clauses 13.13.2 to 13.13.4, 16.8, 16.12, 16.13 and 31.2.2 to 31.2.4 do not apply.
- 30.12 If the computer systems of any of the *Land Registry*, the *ELNO* or the Reserve Bank of Australia are inoperative for any reason at the *completion time* agreed by the *parties*, a failure to complete this contract for that reason is not a default under this contract on the part of either *party*.
- 30.13 If the computer systems of the *Land Registry* are inoperative for any reason at the *completion time* agreed by the *parties*, and the *parties* choose that financial settlement is to occur despite this, then on financial settlement occurring –
- 30.13.1 all *electronic documents Digitally Signed* by the vendor, the *certificate of title* and any discharge of mortgage, withdrawal of caveat or other *electronic document* forming part of the *Lodgment Case* for the *electronic transaction* shall be taken to have been unconditionally and irrevocably delivered to the purchaser or the purchaser's mortgagee at the time of financial settlement together with the right to deal with the land comprised in the *certificate of title*; and
 - 30.13.2 the vendor shall be taken to have no legal or equitable interest in the *property*.
- 30.14 A *party* who holds a *certificate of title* must act in accordance with any *Prescribed Requirement* in relation to the *certificate of title* but if there is no *Prescribed Requirement*, the vendor must *serve* the *certificate of title* after completion.
- 30.15 If the *parties* do not agree about the delivery before completion of one or more documents or things that cannot be delivered through the *Electronic Workspace*, the *party* required to deliver the documents or things –
- 30.15.1 holds them on completion in escrow for the benefit of; and
 - 30.15.2 must immediately after completion deliver the documents or things to, or as directed by; the *party* entitled to them.
- 30.16 In this clause 30, these terms (in any form) mean –
- adjustment figures* details of the adjustments to be made to the price under clause 14;
 - certificate of title* the paper duplicate of the folio of the register for the land which exists immediately prior to completion and, if more than one, refers to each such paper duplicate;
 - completion time* the time of day on the date for completion when the *electronic transaction* is to be settled;
 - conveyancing rules* the rules made under s12E of the Real Property Act 1900;
 - discharging mortgagee* any discharging mortgagee, chargee, covenant chargee or caveator whose provision of a *Digitally Signed* discharge of mortgage, discharge of charge or withdrawal of caveat is required in order for unencumbered title to the *property* to be transferred to the purchaser;
 - ECNL* the Electronic Conveyancing National Law (NSW);
 - effective date* the date on which the *Conveyancing Transaction* is agreed to be an *electronic transaction* under clause 30.1.2 or, if clauses 30.1.1 or 30.1.3 apply, the contract date;
 - electronic document* a dealing as defined in the Real Property Act 1900 which may be created and *Digitally Signed* in an *Electronic Workspace*;
 - electronic transfer* a transfer of land under the Real Property Act 1900 for the *property* to be prepared and *Digitally Signed* in the *Electronic Workspace* established for the purposes of the *parties' Conveyancing Transaction*;

<i>electronic transaction</i>	a <i>Conveyancing Transaction</i> to be conducted for the <i>parties</i> by their legal representatives as <i>Subscribers</i> using an <i>ELN</i> and in accordance with the <i>ECNL</i> and the <i>participation rules</i> ;
<i>electronically tradeable</i>	a land title that is Electronically Tradeable as that term is defined in the <i>conveyancing rules</i> ;
<i>incoming mortgagee</i>	any mortgagee who is to provide finance to the purchaser on the security of the <i>property</i> and to enable the purchaser to pay the whole or part of the price;
<i>mortgagee details</i>	the details which a <i>party</i> to the <i>electronic transaction</i> must provide about any <i>discharging mortgagee</i> of the <i>property</i> as at completion;
<i>participation rules</i>	the participation rules as determined by the <i>ECNL</i> ;
<i>populate</i>	to complete data fields in the <i>Electronic Workspace</i> ; and
<i>title data</i>	the details of the title to the <i>property</i> made available to the <i>Electronic Workspace</i> by the <i>Land Registry</i> .

31 Foreign Resident Capital Gains Withholding

- 31.1 This clause applies only if –
- 31.1.1 the sale is not an excluded transaction within the meaning of s14-215 of Schedule 1 to the *TA Act*; and
- 31.1.2 a *clearance certificate* in respect of every vendor is not attached to this contract.
- 31.2 The purchaser must –
- 31.2.1 at least 5 days before the date for completion, serve evidence of submission of a purchaser payment notification to the Australian Taxation Office by the purchaser or, if a direction under clause 4.3 has been served, by the transferee named in the transfer served with that direction;
- 31.2.2 produce on completion a *settlement cheque* for the *FRCGW remittance* payable to the Deputy Commissioner of Taxation;
- 31.2.3 forward the *settlement cheque* to the payee immediately after completion; and
- 31.2.4 serve evidence of receipt of payment of the *FRCGW remittance*.
- 31.3 The vendor cannot refuse to complete if the purchaser complies with clauses 31.2.1 and 31.2.2.
- 31.4 If the vendor serves any *clearance certificate* or *variation*, the purchaser does not have to complete earlier than 7 days after that service and clause 21.3 does not apply to this provision.
- 31.5 If the vendor serves in respect of every vendor either a *clearance certificate* or a *variation* to 0.00 percent, clauses 31.2 and 31.3 do not apply.

32 Residential off the plan contract

- 32.1 This clause applies if this contract is an off the plan contract within the meaning of Division 10 of Part 4 of the *Conveyancing Act 1919* (the Division).
- 32.2 No provision of this contract has the effect of excluding, modifying or restricting the operation of the Division.
- 32.3 If the purchaser makes a claim for compensation under the terms prescribed by clause 6A of the *Conveyancing (Sale of Land) Regulation 2017* –
- 32.3.1 the purchaser cannot make a claim under this contract about the same subject matter, including a claim under clauses 6 or 7; and
- 32.3.2 the claim for compensation is not a claim under this contract.
- 32.4 This clause does not apply to a contract made before the commencement of the amendments to the Division under the *Conveyancing Legislation Amendment Act 2018*.

33 Amendments to printed clauses, inconsistency and electronic execution

33.1 Amendments to printed clauses

The printed clauses of this Contract are amended as follows:

- (a) The following words are inserted underneath the Nominated *Electronic Lodgement Network (ELN)* Choices section at the top of page 2:

"The vendor and purchaser agree that the Nominated Electronic Lodgement Network is PEXA."

- (b) The following additional clause inserted at the end of Clause 1:

"Any term referred to in the Column headed "Term" on the first page of this Contract has the meaning set out in the Column headed "Meaning of Term" on the first page of this Contract."

- (c) Clause 2.9 is amended by the insertion of the words *"if this contract is completed and otherwise to the party entitled to the deposit"* after the word *"equally"*.
- (d) Clause 7.1.1 is amended by the deletion of the figure *"5%"* and the insertion of the figure *"1%"*.
- (e) Clause 7.2.1 is amended by the deletion of the figure *"10%"* and the insertion of the figure *"1%"*.
- (f) Clause 10.1 is amended by the insertion of the words *"or delay completion"* after the word *"requisition"*.
- (g) Clause 10.1.8 is amended by the deletion of the word *"substance"* and the insertion of the word *"existence"* and the deletion of the word *"disclosed"* and the insertion of the word *"noted"*.
- (h) Clause 10.1.9 is amended by the deletion of the word *"substance"* and the insertion of the word *"existence"* and the deletion of the word *"disclosed"* and the insertion of the word *"noted or referred to"*.
- (i) Clause 10.2 is amended by the insertion of the words *"make a claim or requisition, delay completion or"* after the word *"cannot"*.
- (j) Clause 11.2 is amended by the insertion of the words *"other than as a result of the purchaser's breach"* are inserted after the word *"terminated"*.
- (k) Clause 12.3 is amended by the deletion of the words *"in the 3 days before a time appointed for completion and the insertion of the words "before completion"*.

Additional Clauses

- (l) Clause 13.7 is amended by the insertion of the following additional clause:

“13.7.3 If, after completion, the vendor serves a letter from the Australian Taxation Office stating the vendor has to pay GST on the supply because of a breach of Clause 13.7.1 (or because of something else known to the purchaser but not known to the vendor), then the purchaser must pay to the vendor on demand the amount of GST assessed.”

- (m) A new Clause 18.8 is inserted as follows:

“18.8 As a condition of the vendor granting possession of the property to the purchaser prior to completion, the purchaser accepts the property in its state and repair as at the date the purchaser takes possession, subject to the right of the vendor to enter the property and remove any item listed as an exclusion on the front page of this Contract upon reasonable notice and at any time prior to completion”.

33.2 Inconsistency

If there is any inconsistency between the provisions of these Additional Clauses and the terms of the printed conditions of this Contract, the terms of these Additional Clauses will prevail to the extent of any such inconsistency.

33.3 Electronic execution

- (a) The vendor and purchaser each consent to this Contract being signed by any other party in accordance with an electronic communication method which is approved by the vendor.
- (b) The vendor and purchaser agree that, despite what may be considered to be the customary method of effecting exchange of contracts for the sale of land, this contract is made once it has been signed by all parties and is not required to be executed and exchanged in counterparts. The parties agree that, once signed by all parties, this contract constitutes an original document in an electronic format.

34 Agent

The purchaser warrants that the purchaser was not introduced to the property or to the vendor by any agent other than the vendor's agent (if any) and the purchaser indemnifies the vendor against any claim, costs or expenses incurred by the vendor resulting from a breach of this warranty. This Clause shall not merge on completion.

Additional Clauses

35 Death or bankruptcy

- (a) If either the vendor or the purchaser is a natural person and prior to completion, either party (or if either party consists of more than one person, any one or more of the persons comprising that party) should die, become subject to the provisions of the Mental Health Act, become bankrupt or enter into a personal insolvency agreement, become insane or become incapable of managing that party's affairs, then in any of such events the other party shall be entitled to rescind this Contract at any time before completion by written notice to that party or that party's solicitor.
- (b) If either the vendor or the purchaser is a company and prior to completion, either party or any one of the companies comprising that party should have a Receiver or Manager or Provisional Liquidator or Liquidator appointed to that party, then in any of such events the other party shall be entitled to rescind this Contract at any time before completion by written notice to that party or that party's solicitor.

36 Notice to complete

- (a) In the event that completion is not effected by 5.00 p.m. on the date provided in Clause 15, then either party is entitled at any time thereafter to serve upon the other a Notice to Complete (**Notice**) requiring the other to complete by a date being no earlier than 14 days from the date of service of the Notice.
- (b) For the purpose of this Contract, a Notice is deemed both at law and in equity sufficient to make time of the essence of this Contract.
- (c) If the vendor is required to issue a Notice in accordance with this Clause, then it is an essential term of this Contract that the purchaser must, on completion, allow to the vendor the sum of \$550 including GST on account of the vendor's additional legal costs and disbursements in relation to the issue of the Notice.

37 Service of notices

In addition to any other provision of this Contract:

- (a) if any notice is sent through the Australian Document Exchange, the date of receipt of the notice by the other party is deemed to be 2 business days after the date on which the notice was delivered to the Australian Document Exchange or any one of its branches;
- (b) if any notice is sent by post, the date of receipt of the notice by the other party is deemed to be 4 business days after the date of posting;

Additional Clauses

- (c) a notice or document is sufficiently served for the purposes of this Contract if the notice or document is sent by facsimile transmission and in any such case the notice or document is deemed to be served when the transmission has been completed except where:
 - (i) the sender's machine indicates a malfunction in the transmission or the recipient immediately notifies the sender of an incomplete transmission, in which case the notice or document is deemed not to have been served; or
 - (ii) the time of dispatch is after 5.00 p.m. on a business day, in which case the notice or document is deemed to have been served at the commencement of business on the next business day in that place; and
- (d) a notice or document is sufficiently served for the purposes of this Contract:
 - (i) if served by the purchaser, the notice or document is sent by email to the email address - sutherlandpg@wmdlaw.com.au; and
 - (ii) if served by the vendor, the notice or document is sent by email to the email address of the purchaser or the purchaser's solicitor or conveyancer.

and in any such case the notice or document is deemed to be served when the email has been received except where the time of receipt is after 5.00 p.m. on a business day, in which case the notice or document is deemed to have been served at the commencement of business on the next business day in that place. If there any dispute that the email has been received, the onus of proving receipt of the email is on the party sending the email.

38 Purchaser relies on own enquiries

- (a) The purchaser warrants that, in entering into this Contract, the purchaser does not rely upon any warranty or representation in relation to the property, in relation to the neighbourhood in which the property is situated, or in relation to whether or not any fixture, fitting or inclusion is functioning or not, made by the vendor or any person on behalf of the vendor (including the vendor's agent (if any)) except as may be expressly set out in this Contract.
- (b) The purchaser warrants that the purchaser has relied upon the purchaser's own enquiries in relation to the property and the purchaser accepts the property in its present state and condition (subject to fair wear and tear) as to which the vendor makes no warranty whatsoever and the purchaser will not be entitled to make any objections, requisitions or claims for compensation, to delay completion or to rescind or terminate this Contract with regard to the state and condition of the property.

Additional Clauses

- (c) The purchaser acknowledges that the vendor has not and has not authorised the vendor's agent or any other person to make any representations or warranties in relation to:
- (i) the property or to the neighbourhood in which the property is situated;
 - (ii) the terms of this Contract;
 - (iii) any act to be performed by the vendor;
 - (iv) the manner in which the vendor will or will not enforce the vendor's rights set out in this Contract;
 - (v) whether or not any fixture, fitting or inclusion is functioning or not, or
 - (vi) any other matter or thing regarding the sale of the property;
- in relation to which matters the purchaser relies entirely on the purchaser's own enquiries and the terms contained in this Contract.
- (d) The Purchaser acknowledges and agrees that the Vendor may be required to comply with the *Anti-Money Laundering and Counter-Terrorism Financing Act 2006* (Cth) and all other relevant regulations and rules (**AML Legislation**) and the Purchaser:
- (i) agrees to provide such information as is necessary for the Vendor to comply with any obligations pursuant to the AML Legislation; and
 - (ii) warrants that the entry by the Purchaser into this Contract and all things to be done by the Purchaser as a result of, or in order to complete, this contract does not and will not contravene the AML Legislation.
- (e) The Purchaser indemnifies the Vendor in respect of any loss, damage, penalty, fine or legal costs which may be incurred by the Vendor as a consequence of any breach of Clause 38(d) or any breach by the purchaser of any provision contained in the AML Legislation (including any loss by way of forfeiture of deposit, damages or otherwise suffered by the Vendor).

39 Interest for late completion

- (a) Subject to Clause 39(b), the purchaser agrees that it is an essential term of this Contract that the purchaser will, on the actual date of completion, pay to the vendor interest at the rate of 9% per annum, such interest to be calculated on the balance of the price from the date provided in Clause 15 until the date that the purchaser actually completes this Contract.

Additional Clauses

- (b) The vendor agrees that no interest will be payable by the purchaser if the failure to complete on the date provided in Clause 15 is due solely to the delay of the vendor and the purchaser completes this Contract on the date which is no later than 5 business days after the date on which the vendor serves notice to the purchaser that the vendor is in a position to complete this Contract (**Further Date**). If the purchaser does not complete this Contract on the Further Date, then the purchaser must pay interest to the vendor as referred to in Clause 39(a) calculated from the Further Date until the date that the purchaser actually completes this Contract.
- (c) The purchaser acknowledges and agrees that the obligation to pay interest pursuant to this Clause 39 is in addition to and does not in any way restrict or limit any other right of the vendor under this Contract or at general law.

40 Adjustments

- (a) The parties agree to adjust the usual outgoings and all amounts pursuant to this Contract on completion but if any amount is incorrectly adjusted or an error is made in such calculation at completion the parties agree to rectify the error within 7 days of receipt of evidence of the error and a request for readjustment. This Clause shall not merge on completion.
- (b) The purchaser:
 - (i) agrees that any money which is payable by the purchaser to the vendor on completion, but is not paid on or before completion for any reason (**Unpaid Money**), is not waived by the vendor and remains a capitalised debt due to the vendor;
 - (ii) agrees that in addition to the Unpaid Money, the vendor is entitled to recover from the purchaser interest at the rate of 9% per annum, calculated from the date of completion until the Unpaid Money is paid in full, and any costs incurred by the vendor in recovering the Unpaid Money;
 - (iii) hereby charges the property in favour of the vendor with payment of any Unpaid Money, interest and costs and the purchaser irrevocably authorises the vendor to lodge a caveat over the property in respect of that charge; and
 - (iv) agrees that this clause does not merge on completion.

Additional Clauses

41 Foreign purchaser

The purchaser indemnifies the vendor in respect of any loss, damage, penalty, fine or legal costs which may be incurred by the vendor as a consequence of any breach by the purchaser of Clause 22.1 (including any loss by way of forfeiture of deposit, damages or otherwise suffered by the vendor through consequential default on the purchase of another property). This Clause shall not merge on completion.

42 Removal of notations on title

- (a) Notwithstanding any other provision of this Contract, the vendor is not required to arrange for the removal of any mortgage, charge or caveat registered on the title to the property prior to completion of this Contract. The vendor will not be (and should not be deemed to be) unable or unwilling to complete this Contract by reason of the existence of any charge or other notation on the title to the property and the vendor will be entitled to serve a notice to complete on the purchaser notwithstanding that, at the time such notice is served or at any time thereafter, there is a charge or other notation on the title to the property.
- (b) If settlement does not take place on an Electronic Lodgment Network, on completion, the purchaser must accept a discharge, withdrawal or release (as the case may be) in registrable form of any mortgage, charge or other notation on the title to the property which is to be discharged, withdrawn or released (as the case may be) with effect from completion of this Contract.

43 No merger

Notwithstanding completion of this Contract and despite the registration of the transfer at Land & Property Information, any clause to which effect is not given or perfected by such completion or registration and which is capable of taking effect after completion or registration does not merge in the Transfer on completion but will remain in full force and effect.

44 Alterations to Contract

The vendor and the purchaser each authorise their lawyer (or any employee of that lawyer) to make alterations to this Contract (including the addition of annexures) at any time after this Contract has been signed by the party and up until the date of this Contract. Any such alterations or additions will be binding upon the relevant party as if the alteration or addition was made prior to the Contract being signed by that party.

45 Requisitions

The purchaser acknowledges and agrees that, for the purposes of clause 5, the purchaser will be deemed, on the date of this Contract, to have served on the vendor the requisitions in the form annexed to this Contract.

Additional Clauses

46 Survey

The vendor is not in possession of a Survey Report of the property and the purchaser will make no objection, requisition or claim for compensation nor rescind or terminate this Contract if there are any encroachments by, or upon the Property, or if there is any contravention of any applicable regulations or requirements.

47 Release of deposit

Notwithstanding any provision of this Contract, the deposit, or such part as is required, may be released to the vendor for use by the vendor in the purchase of other real estate or for the payment of duty on any such purchase. By entering into this Contract, the purchaser shall be deemed to have authorised the depositholder to release the deposit, or part thereof, to the vendor's solicitors for such purpose and the agent shall be authorised to act accordingly upon being given a copy of this Clause and without further authority from the purchaser.

48 Guarantee

- (a) For the purposes of this clause, "Guarantor" means jointly and severally, each director of the purchaser company being:
 - (i); and
 - (ii)
- (b) In consideration of the vendor entering into this Contract with the purchaser, at the request of the Guarantor, the Guarantor hereby guarantees to the vendor the due and punctual performance and observance by the purchaser of the purchaser's obligations pursuant to this Contract and indemnifies and agrees to keep indemnified the vendor against all losses, damages, liabilities, costs and expenses accruing to the vendor, resulting or arising from any failure by the purchaser to perform or observe any of the obligations on the part of the purchaser to be performed or observed.
- (c) This guarantee and indemnity is a continuing obligation and cannot be abrogated, prejudiced or discharged by reason of any deemed waiver by the vendor or by any means other than express waiver by the vendor.
- (d) Any rescission or termination of this Contract will not waive any of the obligations of the Guarantor arising pursuant to this Clause.

Additional Clauses

- (e) This guarantee and indemnity is an essential condition of this Contract and is deemed to constitute a principal obligation between the Guarantor and the vendor.

Signed, sealed and delivered by the Guarantor in the presence of:

_____	_____
Guarantor	Witness
_____	_____
Guarantor	Witness

49 Christmas Period

Notwithstanding the completion date shown on the front page of this Contract, neither party will be entitled to require completion of this Contract during the period commencing at 9:00 am on Tuesday 22 December 2020 and expiring at 5:00 pm on Thursday 14 January 2021. For the avoidance of doubt, neither party will be entitled to issue a Notice to Complete requiring completion during this period and during this period, interest pursuant to Clause 39 will not accrue.

50 Vendor may nominate early settlement date

- (a) The purchaser acknowledges that the vendor is in the process of purchasing an alternative property and that, where possible, the vendor would like to arrange settlement of that contract on the same day as settlement of this contract.
- (b) Notwithstanding the provisions of Clause 15 it is hereby expressly agreed and declared that at any time after the date of this contract, the vendor may serve upon the purchaser a notice requiring the purchaser to complete this contract on a date which is at least fourteen (14) days from the date of the notice, provided that the date for completion may not be later than the date set out on the front page of the contract.
- (c) If the vendor serves a notice as set out above, the vendor and purchaser agree that, with effect from the date of the notice, this contract is varied such that the date for completion is the date set out in the vendor's notice, as though that date were the date shown on the front page of this contract.



NEW SOUTH WALES LAND REGISTRY SERVICES - TITLE SEARCH

FOLIO: 21/877655

SEARCH DATE	TIME	EDITION NO	DATE
-----	----	-----	----
8/10/2020	4:07 PM	5	20/10/2017

NO CERTIFICATE OF TITLE HAS ISSUED FOR THE CURRENT EDITION OF THIS FOLIO.
CONTROL OF THE RIGHT TO DEAL IS HELD BY COMMONWEALTH BANK OF AUSTRALIA.

LAND

LOT 21 IN DEPOSITED PLAN 877655
AT CROMER
LOCAL GOVERNMENT AREA NORTHERN BEACHES
PARISH OF MANLY COVE COUNTY OF CUMBERLAND
TITLE DIAGRAM DP877655

FIRST SCHEDULE

MATTHEW PATRICK PRICE
NICOLA ELIZABETH PRICE
AS JOINT TENANTS (T AJ424950)

SECOND SCHEDULE (11 NOTIFICATIONS)

- 1 RESERVATIONS AND CONDITIONS IN THE CROWN GRANT(S)
- 2 EASEMENT(S) AFFECTING THE PART(S) SHOWN SO BURDENED IN THE TITLE
DIAGRAM CREATED BY:
DP814167 -EASEMENT TO DRAIN WATER 1M WIDE
DP814167 -EASEMENT FOR SEWERAGE PURPOSES OVER EXISTING
LINE OF PIPES
- 3 DP814167 RESTRICTION(S) ON THE USE OF LAND
- 4 DP877655 RIGHT OF CARRIAGEWAY 3.5 WIDE AND VARIABLE AFFECTING
THE PART(S) SHOWN SO BURDENED IN THE TITLE DIAGRAM
- 5 DP877655 EASEMENT FOR SERVICES 3.5 WIDE AND VARIABLE
AFFECTING THE PART(S) SHOWN SO BURDENED IN THE TITLE
DIAGRAM
- 6 DP877655 RIGHT OF CARRIAGEWAY 3 WIDE AND VARIABLE APPURTENANT
TO THE LAND ABOVE DESCRIBED
- 7 DP877655 EASEMENT FOR SERVICES 1 WIDE AFFECTING THE PART(S)
SHOWN SO BURDENED IN THE TITLE DIAGRAM
- 8 DP877655 EASEMENT TO DRAIN WATER 3.5 WIDE AND VARIABLE
AFFECTING THE PART(S) SHOWN SO BURDENED IN THE TITLE
DIAGRAM
- 9 DP877655 POSITIVE COVENANT
- 10 DP877655 EASEMENT TO DRAIN WATER 1 WIDE AFFECTING THE PART(S)
SHOWN SO BURDENED IN THE TITLE DIAGRAM
- 11 AM822737 MORTGAGE TO COMMONWEALTH BANK OF AUSTRALIA

END OF PAGE 1 - CONTINUED OVER

op03470043

PRINTED ON 8/10/2020

NEW SOUTH WALES LAND REGISTRY SERVICES - TITLE SEARCH

FOLIO: 21/877655

PAGE 2

NOTATIONS

UNREGISTERED DEALINGS: NIL

*** END OF SEARCH ***

op03470043

PRINTED ON 8/10/2020

Obtained from NSW LRS on 08 October 2020 03:07 PM AEST

© Office of the Registrar-General 2020

* Any entries preceded by an asterisk do not appear on the current edition of the Certificate of Title. Warning: the information appearing under notations has not been formally recorded in the Register. GlobalX hereby certifies that the information contained in this document has been provided electronically by the Registrar General in accordance with Section 96B(2) of the Real Property Act 1900. Note: Information contained in this document is provided by GlobalX Pty Ltd, ABN 35 099 032 596, www.globalx.com.au an approved NSW Information Broker.

ef:150045 /Src:M

INSTRUMENT SETTING OUT TERMS OF EASEMENTS AND RESTRICTIONS AS TO USE INTENDED TO BE
CREATED PURSUANT TO SECTION 88B OF THE CONVEYANCING ACT, 1919.

(Sheet 1 of 6 Sheets)

PART 1

DP 877655

Plan of Subdivision of Lot 2 in
Deposited Plan No. 814167 covered by
Council Clerk's Certificate 10117
No. 10117 of 14 May 1998

Full name and address
of proprietor of the
land.

Gwendolyn Verona Kirby of
22 Grover Avenue, Cromer.

1. Identity of easement
or restriction firstly
referred to in above-
mentioned plan:

Right of Carriageway 3.5 wide
and variable width

Schedule of lots, etc. affected.Lots burdened.Lots, name of road, or Authority, benefited.

21

22

2. Identity of easement
or restriction secondly
referred to in above-
mentioned plan:

Easement for Services 3.5 wide
and variable width

Schedule of lots, etc. affected.Lots burdened.Lots, name of road, or Authority, benefited.

21

22

3. Identity of easement
or restriction thirdly
referred to in above-
mentioned plan:

Right of Carriageway 3 wide and
variable width

Schedule of lots, etc. affected.Lots burdened.Lots, name of road, or Authority, benefited.

22

21

This is Sheet 1 of a 6 Sheet Instrument

WARRINGAH COUNCIL
Robert Robert
Authorised Person

ef:150045 /src:M

INSTRUMENT SETTING OUT TERMS OF EASEMENTS AND RESTRICTIONS AS TO USE INTENDED TO BE
CREATED PURSUANT TO SECTION 88B OF THE CONVEYANCING ACT, 1919.

(Sheet 2 of 6 Sheets)

PART 1. (cont.)

DP 877655

Plan of Subdivision of Lot 2 in
Deposited Plan No. 814167 covered by
Council Clerk's Certificate
No. 10117 of 14 May 1998

4. Identity of easement
or restriction fourthly
referred to in above-
mentioned plan:

Easement for Services 1 wide

Schedule of lots, etc. affected.Lots burdened.Lots, name of road, or Authority, benefited.

21

22

5. Identity of easement
or restriction fifthly
referred to in above-
mentioned plan:

Easement to Drain Water 3.5 wide and
variable width

Schedule of lots, etc. affected.Lots burdened.Lots, name of road, or Authority, benefited.

21

22

6. Identity of easement
or restriction sixthly
referred to in above-
mentioned plan:

Positive Covenant

Schedule of lots, etc. affected.Lots burdened.Lots, name of road, or Authority, benefited.

21, 22

Warringah Council

7. Identity of easement
or restriction seventhly
referred to in above-
mentioned plan:

Easement to Drain Water 1 wide

Schedule of lots, etc. affected.Lots burdened.Lots, name of road, or Authority, benefited.

21

22

This is Sheet 2 of a 6 Sheet Instrument

WARRINGAH COUNCIL

.....*Robert Burt*.....
Authorised Person

Ref:150045 /Src:M

INSTRUMENT SETTING OUT TERMS OF EASEMENTS AND RESTRICTIONS AS TO USE INTENDED TO BE
CREATED PURSUANT TO SECTION 88B OF THE CONVEYANCING ACT, 1919.

(Sheet 3 of 6 Sheets)

PART 2.

Plan: DP 877655

Plan of Subdivision of Lot 2 in
Deposited Plan No. 814167 covered by
Council Clerk's Certificate
No. 10117 of 14 May 1998

1. Terms of Easement for Services 3.5 wide and variable width secondly referred to in
abovementioned plan.

Full and free right for every person who is at any time entitled to an estate or interest in possession in the land herein benefited or any part thereof with which the right shall be capable of enjoyment and every person authorised by him to make, layout, construct, erect, install, carry, maintain and use through, above, on, under the land hereby burdened all drains, pipes, conduits, poles, wires or other equipment and materials necessary to provide and carry all or any of water, sewerage, gas, electric light, telephone and/or other domestic services to and from the land hereby benefited PROVIDED THAT the said drains, pipes, conduits, poles, wires and/or other equipment and materials shall be laid in such position so as to cause as little interference as possible with the Right of Carriageway hereby reserved TOGETHER WITH the right for the Registered Proprietor of the land hereby benefited and every person authorised by him, with any tools, implements or machinery necessary for the purpose to enter upon the land hereby burdened and to remain there for any reasonable time for the purpose of laying, inspecting, cleansing, repairing, maintaining or renewing such equipment or any part thereof to such extent as may be necessary PROVIDED THAT the said Registered Proprietor and the persons authorised by him will take all reasonable precautions to ensure as little disturbance as possible to the surface of the land hereby burdened and/or free access to the land hereby benefited and will restore without delay that surface as nearly as practicable to its original condition. This easement may not be released, varied or modified without the written consent of Sydney Water.

This is Sheet 3 of a 6 Sheet Instrument

WARRINGAH COUNCIL
.....
Authorised Person

REF:150045 /Sxc:M

**INSTRUMENT SETTING OUT TERMS OF EASEMENTS AND RESTRICTIONS AS TO USE INTENDED TO BE
CREATED PURSUANT TO SECTION 88B OF THE CONVEYANCING ACT, 1919.**

(Sheet 4 of 6 Sheets)

PART 2(cont.)

Plan: DP 877655

Plan of Subdivision of Lot 2 in
Deposited Plan No. 814167 covered by
Council Clerk's Certificate
No. 10117 of 14 May 1998

2. Terms of Easement for Services 1 wide fourthly referred to in abovementioned plan.

Full and free right for every person who is at any time entitled to an estate or interest in possession in the land herein benefited or any part thereof with which the right shall be capable of enjoyment and every person authorised by him to make, layout, construct, erect, install, carry, maintain and use through, above, on, under the land hereby burdened all drains, pipes, conduits, poles, wires or other equipment and materials necessary to provide and carry all or any of water, gas, electric light, telephone and/or other domestic services to and from the land hereby benefited TOGETHER WITH the right for the Registered Proprietor of the land hereby benefited and every person authorised by him, with any tools, implements or machinery necessary for the purpose to enter upon the land hereby burdened and to remain there for any reasonable time for the purpose of laying, inspecting, cleansing, repairing, maintaining or renewing such equipment or any part thereof to such extent as may be necessary PROVIDED THAT the said Registered Proprietor and the persons authorised by him will take all reasonable precautions to ensure as little disturbance as possible to the surface of the land hereby burdened and/or free access to the land hereby benefited and will restore without delay that surface as nearly as practicable to its original condition.

3. Terms of Positive Covenant sixthly referred to in abovementioned plan.

The registered proprietors covenant with the Warringah Council that they will maintain and repair the structure and works on the land in accordance with the following terms and conditions.

(I) The registered proprietor will:

- (a) keep the structure and works clean and free from silt, rubbish and debris.
- (b) maintain and repair at the sole expense of the registered proprietors the whole of the structure and works so that it functions in a safe and efficient manner.

- (II) For the purpose of ensuring observance of the covenant the Council may by its servants or agents at any reasonable time of the day and upon giving to the person against whom the covenant is enforceable not less than two days notice (but at any time without notice in the case of an emergency) enter the land and view the condition of the land and the state of construction maintenance or repair of the structure and works on the land.**

This is Sheet 4 of a 6 Sheet Instrument

WARRINGAH COUNCIL

.....
Authorized Person

ef:150045 /src:M

**INSTRUMENT SETTING OUT TERMS OF EASEMENTS AND RESTRICTIONS AS TO USE INTENDED TO BE
CREATED PURSUANT TO SECTION 88B OF THE CONVEYANCING ACT, 1919.**

(Sheet 5 of 6 Sheets)

PART 2(cont.)

Plan: DP 877655

Plan of Subdivision of Lot 2 in
Deposited Plan No. 814167 covered by
Council Clerk's Certificate
No. 10117 of 14 May 1998

- (III) By written notice the Council may require the registered proprietors to attend to any matter and to carry out such work within such time as the Council may require to ensure the proper and efficient performance of the structure and works and to that extent section 88F(2)(a) of the Act is hereby agreed to be amended accordingly.
- (IV) Pursuant to section 88F(3) of the Act the authority shall have the following additional powers pursuant to this covenant:
- i In the event that the registered proprietor fails to comply with the terms of any written notice issued by the Council as set out above the Council or its authorised agents may enter the land with all necessary equipment and carry out any work which the Council in its discretion considers reasonable to comply with the said notice referred to in III hereof.
 - ii The Council may recover from the registered proprietor in a Court of competent jurisdiction:
 - (a) Any expense reasonably incurred by it in exercising its powers under sub-paragraph I hereof. Such expense shall include reasonable wages for the Council's own employees engaged in effecting the said work together with costs, reasonably estimated by the Council, for the use of machinery, tools and equipment in conjunction with the said work.
 - (b) Legal costs on an indemnity basis for issue of the said notices and recovery of the said costs and expenses together with the costs and expenses of registration of a covenant charge pursuant to section 88F of the Act or providing any certificate required pursuant to section 88G of the Act or obtaining any injunction pursuant to section 88H of the Act.
- (V) This covenant shall bind all persons who claim under the registered proprietors as stipulated in section 88E(5) of the Act.

For the purposes of this covenant:

Structure and Works shall mean the on-site stormwater detention system constructed on the land as set out in plan annexed hereto and marked with the letter (J) including all gutters, pipes, drains, walls, kerbs, pits, grates, tanks, chambers, basins and surfaces designed to temporarily detain stormwater on the land.

Name or person empowered to release, vary or modify Positive Covenant thirdly referred to in abovementioned plan.

Council of Warringah.

WARRINGAH COUNCIL
.....*[Signature]*.....
Authorised Person

This is Sheet 5 of a 6 Sheet Instrument

ref:150045 /src:M

**INSTRUMENT SETTING OUT TERMS OF EASEMENTS AND RESTRICTIONS AS TO USE INTENDED TO BE
CREATED PURSUANT TO SECTION 88B OF THE CONVEYANCING ACT, 1919.**

(Sheet 6 of 6 Sheets)

PART 2(cont.)

Plan: UP 877655

Plan of Subdivision of Lot 2 in
Deposited Plan No. 814167 covered by
Council Clerk's Certificate
No. 10117 of 14 May 1998

Signed in my presence by Gwendolyn Verona Kirby
who is personally known to me.

Gwendolyn Kirby
Signature of Witness

G. Kirby
Proprietor

Colin Burdon
Name of Witness (BLOCK LETTERS)

Justice of the Peace
Qualification of Witness

Mona Jane

"SIGNED in my presence by the duly
constituted Attornies, for and on
behalf of GREATER BUILDING
SOCIETY LTD. under Registered
Book 4096 No. 706, who are
personally known to me."

Gail Smith
GAIL SMITH

103 TUDOR STREET
HAMILTON

J. R. Arnold
J. R. ARNOLD

P. W. Baker
P. W. BAKER

WARRINGAH COUNCIL

Phil Baker
General Manager

Authorised Person

This is Sheet 6 of a 6 Sheet Instrument

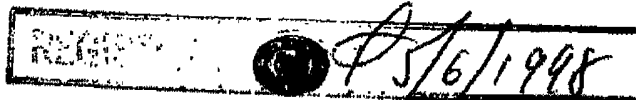

INSTRUMENT SETTING OUT TERMS OF EASEMENTS AND RESTRICTIONS AS TO USES, INTENDED TO BE CREATED PENDING TO SECTION 803 OF THE CONVEYANCING ACT, 1913.

(Sheet 1 of 3 Sheets)

Plan:

DP 814157

Plan of Subdivision of Lots 19 and 20 in D.P. 1918 covered by Council Clerk's Certificate No. 9216 of 30th October, 1991.

Full name and address of proprietor of the land.

Bliss May Jackson of 24 Grover Avenue, Croner, Geraldton Western Midy of 22 Grover Avenue, Croner.

1. Identity of easement or restriction firstly referred to in above mentioned plan:

Easement to Drain Water in wide

Schedule of lots, etc. affected.

Lots benefited.

Lots, name of road, or Authority, benefited.

2

3

2. Identity of easement or restriction secondly referred to in above mentioned plan:

Schedule of lots, etc. affected.

Lots benefited.

Lots, name of road, or Authority, benefited.

2

3

1. Identity of easement or restriction firstly referred to in above mentioned plan:

Restriction as to Drain

Schedule of lots, etc. affected.

Lots benefited.

Lots, name of road, or Authority, benefited.

2

3

This is Sheet 1 of a 3 Sheet Instrument

WARRINGAH SHIRE COUNCIL

[Signature]

REGISTERED  1/25/1991

[Signature]

10 20 30 40 50 60 70 80 90 100 110 120 130 140

This negative is a photograph made as a permanent record of a document in the custody of the Registrar General this day, 2nd December, 1991



INSTRUMENT SETTING OUT TERMS OF EASEMENTS AND RESTRICTIONS AS TO USES, INTENDED TO BE CREATED PENDING TO SECTION 803 OF THE CONVEYANCING ACT, 1913.

(Sheet 2 of 3 Sheets)

Page 2.

DP 814157

Plan of Subdivision of Lots 19 and 20 in D.P. 1918 covered by Council Clerk's Certificate No. 9216 of 30th October, 1991.

1. Terms of Easement secondly referred to in the above mentioned plan

Full and free right for every person who is at any time entitled to an estate or interest in possession in the land herein indicated as the dominant tenement or any part thereof with which the right shall be capable of enjoyment, and every person authorised by him, from time to time and at all times by means of pipes to drain sewage and other waste material and fluid in any quantities across and through the land herein indicated as the servient tenement, together with the right to use, for the purpose of the easement, any pipe of pipes already laid within the servient tenement for the purpose of draining sewage or any pipe or pipes in replacement or in substitution thereof and together with the right for the grantee and every person authorised by him, with any tools, implements, or machinery, necessary for the purpose, to enter upon the servient tenement and to remain there for any reasonable time for the purpose of laying, inspecting, cleaning, repairing, maintaining or renewing such pipe line or any part thereof and for the purpose of the easement to open the soil of the servient tenement to such extent as may be necessary for the purpose of the easement as aforesaid authorised by him will, free all reasonable provisions to secure as little disturbance as possible to the surface of the servient tenement and will restore that surface as nearly as practicable to its original condition and this easement shall not be released varied or modified without the consent of the Water Board.

2. Terms of restriction as to uses firstly referred to in the above mentioned plan
No building or other structure shall be erected, constructed or placed on the land herein indicated as the servient tenement over existing line of pipes without the consent of the Water Board and the building and structure shall not be altered or extended in any way without the consent of the Water Board and no other structure shall be erected or placed on the land herein indicated as the servient tenement over existing line of pipes without the consent of the Water Board.

WARRINGAH SHIRE COUNCIL

[Signature]

REGISTERED  1/25/1991

[Signature]

This is Sheet 2 of a 3 Sheet Instrument

INSTRUMENT SERVING CUP TERMS OF SALE AND RESERVATIONS AS TO LAND INTENDED TO BE
 CREDITED PURSUANT TO SECTION 306 OF THE CONSTITUTIONAL ACT, 1912.

(Sheet 3 of 3 Sheets)

DP814167

PART 2. (CONT.)

Plan of Subdivision of Lots 19
 and 20 in P.P. 1818 covered by
 Council Order's Certificate
 No. 9216 of 30th October, 1991.

Signed by Hilda May Jackson
 who is personally known to me.

H. May Jackson
 Signature of Witness

Robert Ernest Davies
 Name of Witness (BLOCK LETTERS)

Robert Ernest Davies
 Qualification of Witness

Wm. Jackson
 Registrar

Signed by Geraldine Veronica Kirby
 who is personally known to me.

G. V. Kirby
 Signature of Witness

Robert Ernest Davies
 Name of Witness (BLOCK LETTERS)

Robert Ernest Davies
 Qualification of Witness

S. M. Kirby
 Registrar

WESTERN SHIRE COUNCIL

S. M. Kirby
 Registrar

This is Sheet 3 of 3 Sheet Instrument

REGISTERED 1 JAN 1991

This negative is a photograph made as a permanent
 record of a document in the custody of the
 Registrar General this day, 2nd December, 1991

10 20 30 40 50 60 70 80 90 100 110 120 130 140

2



Northern Beaches Council Planning Certificate – Part 2&5

Applicant: The Search People
GPO Box 1585
SYDNEY NSW 2001

Reference: 2000N-47116
Date: 08/10/2020
Certificate No. ePLC2020/6447

Address of Property: 22A Grover Avenue CROMER NSW 2099
Description of Property: Lot 21 DP 877655

Planning Certificate – Part 2

The following certificate is issued under the provisions of Section 10.7(2) of the *Environmental Planning and Assessment Act 1979* (as amended – formerly Section 149). The information applicable to the land is accurate as at the above date.

1. Relevant planning instruments and Development Control Plans

1.1 The name of each environmental planning instrument that applies to the carrying out of development on the land:

1.1a) Local Environmental Plan

Warringah Local Environmental Plan 2011

1.1b) State Environmental Planning Policies and Regional Environmental Plans

State Environmental Planning Policy 19 – Bushland in Urban Areas
State Environmental Planning Policy 21 – Caravan Parks
State Environmental Planning Policy 33 – Hazardous and Offensive Development
State Environmental Planning Policy 50 – Canal Estate Development
State Environmental Planning Policy 55 – Remediation of Land
State Environmental Planning Policy 64 – Advertising and Signage
State Environmental Planning Policy 65 – Design Quality of Residential Apartment Development
State Environmental Planning Policy No 70—Affordable Housing (Revised Schemes)
State Environmental Planning Policy (Affordable Rental Housing) 2009
State Environmental Planning Policy (Building Sustainability Index: BASIX) 2004
State Environmental Planning Policy (Educational Establishments and Child Care Facilities) 2017
State Environmental Planning Policy (Exempt and Complying Development Codes) 2008
State Environmental Planning Policy (Housing for Seniors or People with a Disability) 2004
State Environmental Planning Policy (Infrastructure) 2007

State Environmental Planning Policy (Mining, Petroleum Production and Extractive Industries) 2007

State Environmental Planning Policy (State and Regional Development) 2011

State Environmental Planning Policy (State Significant Precincts) 2005

State Environmental Planning Policy (Vegetation in Non-Rural Areas) 2017

State Environmental Planning Policy (Primary Production and Rural Development) 2019

State Environmental Planning Policy (Koala Habitat Protection) 2019

Sydney Regional Environmental Plan No 20-Hawkesbury-Nepean River (No 2-1997)

Sydney Regional Environmental Plan (Sydney Harbour Catchment) 2005

Sydney Regional Environmental Plan No 9-Extractive Industry (No 2-1995)

1.2 Draft Environmental Planning Instruments

The name of each proposed environmental planning instrument that will apply to the carrying out of development on the land and that is or has been subject of community consultation or on public exhibition under the Act (unless the Secretary has notified the Council that the making of the proposed instrument has been deferred indefinitely or has not been approved):

1.2 a) Draft State Environmental Planning Policies

Draft State Environmental Planning Policy (Environment)

Draft State Environmental Planning Policy (Short-term Rental Accommodation) 2019

Amendment to State Environmental Planning Policy (Exempt and Complying Development Codes) 2008

Draft Remediation of Land State Environmental Planning Policy (intended to replace State Environmental Planning Policy 55)

1.2 b) Draft Local Environmental Plans

1.3 Development Control Plans

The name of each development control plan that applies to the carrying out of development on the land:

Warringah Development Control Plan 2011

2. Zoning and land use under relevant Local Environmental Plans

For each environmental planning instrument or proposed instrument referred to in Clause 1 (other than a SEPP or proposed SEPP) that includes the land in any zone (however described):

2.1 Zoning and land use under relevant Local Environmental Plans

2.1 (a), (b), (c) & (d)

The following information identifies the purposes for which development may be carried out with or without development consent and the purposes for which the carrying out of development is prohibited, for all zones (however described) affecting the land to which the relevant Local Environmental Plan applies.

EXTRACT FROM WARRINGAH LOCAL ENVIRONMENTAL PLAN 2011

Zone R2 Low Density Residential

1 Objectives of zone

- To provide for the housing needs of the community within a low density residential environment.
- To enable other land uses that provide facilities or services to meet the day to day needs of residents.
- To ensure that low density residential environments are characterised by landscaped settings that are in harmony with the natural environment of Warringah.

2 Permitted without consent

Home-based child care; Home occupations

3 Permitted with consent

Bed and breakfast accommodation; Boarding houses; Boat sheds; Building identification signs; Business identification signs; Centre-based child care facilities; Community facilities; Dwelling houses; Educational establishments; Emergency services facilities; Environmental protection works; Exhibition homes; Group homes; Health consulting rooms; Home businesses; Hospitals; Places of public worship; Recreation areas; Respite day care centres; Roads; Secondary dwellings; Veterinary hospitals

4 Prohibited

Any development not specified in item 2 or 3

Additional permitted uses

Additional permitted uses, if any, for which development is permissible with development consent pursuant to Clause 2.5 and Schedule 1 of the relevant Local Environmental Plan:

Nil

(e) Minimum land dimensions

The *Warringah Local Environmental Plan 2011* contains no development standard that fixes minimum land dimensions for the erection of a dwelling house on the land.

(f) Critical habitat

The land does not include or comprise critical habitat.

(g) Conservation areas

The land is not in a heritage conservation area.

(h) Item of environmental heritage

The land does not contain an item of environmental heritage.

2.2 Draft Local Environmental Plan - if any

For any proposed changes to zoning and land use, see Part 1.2 b)

Please contact Council's Strategic and Place Planning unit with enquiries on 1300 434 434.

2A. Zoning and land use under State Environmental Planning Policy (Sydney Region Growth Centres) 2006

The *State Environmental Planning Policy (Sydney Region Growth Centres) 2006* does not apply to the land.

3. Complying Development

The extent to which the land is land on which complying development may or may not be carried out under each of the codes for complying development because of the provisions of clauses 1.17A (1) (c) to (e), (2), (3) and (4), 1.18 (1) (c3) and 1.19 of *State Environmental Planning Policy (Exempt and Complying Development Codes) 2008*.

a) Housing Code

Complying Development under the Housing Code may be carried out on all of the land.

b) Rural Housing Code

Complying Development under the Rural Housing Code may be carried out on all of the land.

c) Low Rise Housing Diversity Code

Complying Development under the Low Rise Housing Diversity Code may be carried out on all of the land.

d) Greenfield Housing Code

Complying Development under the Greenfield Housing Code may not be carried out on all of the land.

e) Housing Alterations Code

Complying Development under the Housing Alterations Code may be carried out on all of the land.

f) General Development Code

Complying Development under the General Development Code may be carried out on all of the land.

g) Commercial and Industrial Alterations Code

Complying Development under the Commercial and Industrial Alterations Code may be carried out on all of the land.

h) Commercial and Industrial (New Buildings and Additions) Code

Complying Development under the Commercial and Industrial (New Buildings and Additions) Code may be carried out on all of the land.

i) Container Recycling Facilities Code

Complying Development under the Container Recycling Facilities Code may be carried out on all of the land.

j) Subdivisions Code

Complying Development under the Subdivisions Code may be carried out on all of the land.

k) Demolition Code

Complying Development under the Demolition Code may be carried out on all of the land.

l) Fire Safety Code

Complying Development under the Fire Safety Code may be carried out on all of the land.

m) Inland Code

Complying Development under the Inland Code does not apply to the land.

Note: Pursuant to clause 3D.1 of the *State Environmental Planning Policy (Exempt and Complying Development Codes) 2008*, the Inland Code only applies to 'inland local government areas'. Northern Beaches local government area is not defined as an 'inland local government area' by *State Environmental Planning Policy (Exempt and Complying Development Codes) 2008*.

4, 4A (Repealed)

4B. Annual charges under Local Government Act 1993 for coastal protection services that relate to existing coastal protection works

The owner of the land (or any previous owner) has not consented in writing to the land being subject to annual charges under section 496B of the *Local Government Act 1993* for coastal protection services that relate to existing coastal protection works (within the meaning of section 553B of that Act).

5. Mine Subsidence

The land has not been proclaimed to be a mine Subsidence (Mine Subsidence) district within the meaning of section 15 of the *Mine Subsidence (Mine Subsidence) Compensation Act, 1961*.

6. Road widening and road realignment

- (a) The land is not affected by a road widening or re-alignment proposal under Division 2 of Part 3 of the *Roads Act 1993*.
- (b) The land is not affected by a road widening or re-alignment proposal under an environmental planning instrument.
- (c) The land is not affected by a road widening or re-alignment proposal under a resolution of Council.

7. Council and other public authority policies on hazard risk restriction

- (a) Council has adopted a number of policies with regard to various hazards or risks which may restrict development on this land. The identified hazard or risk and the respective Council policies which affect the property, if any, are listed below (other than flooding – see 7A):

Nil

- (b) The following information applies to any policy as adopted by any other public authority and notified to the Council for the express purpose of its adoption by that authority being referred to in a planning certificate issued by the Council. The identified hazard or risk and the respective Policy which affect the property, if any, are listed below:

Nil

7A. Flood related development control Information

- (1) Development on the land or part of the land for the purposes of dwelling houses, dual occupancies, multi dwelling housing or residential flat buildings (not including development for the purposes of group homes or seniors housing) is not subject to flood related development controls.
- (2) Development on the land or part of the land for any other purpose is not subject to flood related development controls.

8. Land reserved for acquisition

Environmental planning instrument referred to in Clause 1 does not make provision in relation to the acquisition of the land by a public authority, as referred to in section 3.15 of the Act.

9. Contribution plans

The following applies to the land:

Northern Beaches Section 7.12 Contributions Plan 2019

9A. Biodiversity certified land

The land is not biodiversity certified land under Part 8 of the *Biodiversity Conservation Act 2016* (includes land certified under Part 7AA of the repealed *Threatened Species Conservation Act 1995*).

10. Biodiversity Stewardship Sites

The Council has not been notified by the Chief Executive of the Office of Environment and Heritage that the land is a biodiversity stewardship site under a biodiversity stewardship agreement under Part 5 of the *Biodiversity Conservation Act 2016* (includes land to which a biobanking agreement under Part 7A of the repealed *Threatened Species Conservation Act 1995* relates).

10A. Native vegetation clearing set asides

Council has not been notified by Local Land Services of the existence of a set aside area under section 60ZC of the *Local Land Services Act 2013*.

11. Bush fire prone land

Bush Fire Prone Land

The land is not bush fire prone land.

12. Property vegetation plans

The Council has not been notified that the land is land to which a vegetation plan under the *Native Vegetation Act 2003* applies.

13. Orders under Trees (Disputes Between Neighbours) Act 2006

Council has not been notified of the existence of an order made under the *Trees (Disputes Between Neighbours) Act 2006* to carry out work in relation to a tree on the land.

14. Directions under Part 3A

There is not a direction by the Minister in force under section 75P(2) (c1) of the Act that a provision of an environmental planning instrument prohibiting or restricting the carrying out of a project or a stage of a project on the land under Part 4 of the Act does not have effect.

15. Site compatibility certificates and conditions for seniors housing

- (a) There is not a current site compatibility certificate (seniors housing), of which the council is aware, in respect of proposed development on the land.
- (b) No condition of consent applies to the property that limits the kind of people who may occupy the premises/ development. This refers only to consents granted after 11 October 2007 with conditions made in accordance with clause 18(2) of *State Environmental Planning Policy (Housing for Seniors or People with a Disability) 2004*.

16. Site compatibility certificates for infrastructure, schools or TAFE establishments

There is not a valid site compatibility certificate (infrastructure) or site compatibility certificate (schools or TAFE establishments), of which the council is aware, in respect of proposed development on the land.

17. Site compatibility certificate and conditions for affordable rental housing

- (a) There is not a current site compatibility certificate (affordable rental housing), of which the council is aware, in respect of proposed development on the land.
- (b) There are not terms of a kind referred to in clause 17 (1) or 38 (1) of *State Environmental Planning Policy (Affordable Rental Housing) 2009* that have been imposed as a condition of consent to a development application in respect of the land.

18. Paper subdivision information

There is no current paper subdivision, of which council is aware, in respect of this land according to Part 16C of the *Environmental Planning and Assessment Regulation 2000*.

19. Site verification certificates

There is no current site verification certificate, of which council is aware, in respect of the land

according to Part 4AA of the *State Environmental Planning Policy (Mining, Petroleum Production and Extractive Industries) 2007*.

20. Loose-fill asbestos insulation

The residential dwelling erected on this land has not been identified in the Loose-Fill Asbestos Insulation Register as containing loose-fill asbestos ceiling insulation.

This clause applies to residential premises (within the meaning of Division 1A of part 8 of the Home Building Act 1989) that are listed in the register that is required to be maintained under that Division.

Contact NSW Fair Trading for more information.

21 Affected building notices and building product rectification orders

- 1) There is not an affected building notice of which the council is aware that is in force in respect of the land.
- 2) There is not a building product rectification order of which the council is aware that is in force in respect of the land and has not been fully complied with, and
- 3) There is not a notice of intention to make a building product rectification order of which the council is aware has been given in respect of the land and is outstanding.

In this clause:

affected building notice has the same meaning as in Part 4 of the *Building Products (Safety) Act 2017*.

building product rectification order has the same meaning as in the *Building Products (Safety) Act 2017*.

Additional matters under the Contaminated Land Management Act 1997

Note. The following matters are prescribed by section 59 (2) of the *Contaminated Land Management Act 1997* as additional matters to be specified in a planning certificate:

- (a) the land to which the certificate relates is not significantly contaminated land within the meaning of that Act
- (b) the land to which the certificate relates is not subject to a management order within the meaning of that Act
- (c) the land to which the certificate relates is not the subject of an approved voluntary management proposal within the meaning of that Act
- (d) the land to which the certificate relates is not subject to an ongoing maintenance order within the meaning of that Act
- (e) the land to which the certificate relates is not the subject of a site audit statement

If contamination is identified above please contact the Environmental Protection Authority (EPA) for further information.

Planning Certificate – Part 5

ePLC2020/6447

The following is information provided in good faith under the provisions of Section 10.7(5) of the *Environmental Planning and Assessment Act 1979* (as amended – formerly Section 149) and lists relevant matters affecting the land of which Council is aware. The Council shall not incur any liability in respect of any such advice.

Persons relying on this certificate should read the environmental planning instruments referred to in this certificate.

Company Title Subdivision

Clause 4.1 of the *Pittwater Local Environmental Plan 2014*, *Warringah Local Environmental Plan 2011* or *Manly Local Environmental Plan 2013* provides that land may not be subdivided except with the consent of the Council. This includes subdivision by way of company title schemes. Persons considering purchasing property in the Northern Beaches local government area the subject of a company title scheme are advised to check that the land has been subdivided with the consent of the Council.

District Planning

Under the Greater Sydney Regional Plan – A Metropolis of Three Cities 2018, the Greater Sydney Commission sets a planning framework for a metropolis of three cities across Greater Sydney which reach across five Districts. Northern Beaches is located within the 'Eastern Harbour City' area and is in the North District which forms a large part of the Eastern Harbour City. The North District Plan sets out planning priorities and actions for the growth of the North District, including Northern Beaches. Northern Beaches Council is preparing a Local Strategic Planning Statement which will give effect to the District Plan based on local characteristics and opportunities and Council's own priorities in the community.

Council Resolution To Amend Environmental Planning Instrument

The following instrument or resolution of Council proposes to vary the provisions of an environmental planning instrument, other than as referred to in the Planning Certificate – Part 2:

Planning Proposal - rezone deferred land within the Oxford Falls Valley & Belrose North area

Applies to land: Land within the B2 Oxford Falls Valley and C8 Belrose North localities of WLEP 2000 and land zoned E4 Environmental Living under WLEP 2011 at Cottage Point (Boundaries identified within the Planning Proposal)

Outline: Amends WLEP 2000 and WLEP 2011 to:

- Transfer the planning controls for land within the B2 Oxford Falls Valley and C8 Belrose North localities of WLEP 2000 into the best fit zones and land use controls under WLEP 2011
- Rezone the majority of the subject land to E3 Environmental Management under WLEP 2011

- Rezone smaller parcels of land to E4 Environmental Living, RU4 Primary Production Small Lots, SP2 Infrastructure, SP1 Special Activities, R5 Large Lot Residential and R2 Low Density Residential under WLEP 2011
- Include various parcels of land as having additional permitted uses under Schedule 1 of WLEP 2011

Council resolution: 24 February 2015

Planning Proposal - Manly Warringah War Memorial State Park (Wakehurst Parkway, Allambie Heights & 1 Kirkwood Street, North Balgowlah)

Applies to: **Crown Land:** Lots 76 and 77 DP 504237; Lot 2 DP 710023 and Lot 1 DP 1200869; and **Sydney Water Land:** Lot 1 DP 710023 and Lot 1 DP 835 123

Outline: Proposed amendment to WLEP 2011 to:

- Amend Land Zoning Map to change the zoning from R2 (Low Density Residential) to RE1 (Public Recreation) for Lots 76 and 77 DP 504237, Lots 1 and 2 DP 710023, and Lot 1 DP 1200869.
- Amend Land Zoning Map to change the zoning from R2 (Low Density Residential) to SP2 (Infrastructure) - 'Water Supply System' for Lot 1 DP 835123.
- Amend Height of Building Map and Minimum Lot Size Map to remove the residential development standards for height and minimum lot size from all of the subject lots.

Council resolution: 28 May 2019

Planning Proposal - Pittwater Road and Albert Street, Narrabeen

Applies to: 1294 - 1300 Pittwater Road and 2 - 4 Albert Street, Narrabeen

Outline: Amends WLEP 2011 to:

- Amend Height of Building Map to increase height from 8.5m to 11m (excluding lot 1 DP613544 and part lot 8C DP200030).
- Amend Schedule 1 to allow "shop top housing" on the site.
- To seek an affordable housing contribution in conjunction with future redevelopment of the land.

Council resolution: 28 May 2019

Additional Information Applying To The Land

Additional information, if any, relating to the land the subject of this certificate:

Nil

General Information

Threatened Species

Many threatened species identified under the *Biodiversity Conservation Act 2016* (NSW) and Environment Protection and Biodiversity Conservation Act 1999 (Commonwealth) are found within the former Local Government Area of Warringah (now part of Northern Beaches). Council's Natural Environment unit can be contacted to determine whether any site specific information is available for this property. Records of threatened flora and fauna are also available from the NSW Office of Environment and Heritage's Atlas of NSW Wildlife database: <http://www.bionet.nsw.gov.au>

Potential threatened species could include:

(a) threatened species as described in the final determination of the scientific committee to list endangered and vulnerable species under Schedule 1 of the *Biodiversity Conservation Act 2016*, and/or

(b) one or more of the following threatened ecological communities as described in the final determination of the scientific committee to list the ecological communities under Schedule 2 of the *Biodiversity Conservation Act 2016*:

- Duffys Forest Ecological Community in the Sydney Basin Bioregion
- Swamp Sclerophyll Forest on Coastal Floodplain
- Coastal Saltmarsh of the Sydney Basin Bioregion
- Swamp Oak Floodplain Forest
- Bangalay Sand Forest of the Sydney Basin Bioregion
- Themeda grasslands on Seacliffs and Coastal Headlands
- Sydney Freshwater Wetlands in the Sydney Basin Bioregion
- Coastal Upland Swamp in the Sydney Basin Bioregion
- River-Flat Eucalypt Forest on Coastal Floodplains of the New South Wales North Coast, Sydney Basin and South East Corner Bioregions

Bush fire

Certain development may require further consideration under section 79BA or section 91 of the Environmental Planning and Assessment Act 1979, and section 100B of the Rural Fires Act, 1997 with respect to bush fire matters. Contact NSW Rural Fire Service.

Aboriginal Heritage

Many Aboriginal objects are found within the Local Government Area. It is prudent for the purchaser of land to make an enquiry with the Office of Environment and Heritage as to whether any known Aboriginal objects are located on the subject land or whether the land has been declared as an Aboriginal place under the *National Parks and Wildlife Act 1974* (NSW). The carrying out of works may be prevented on land which is likely to significantly affect an Aboriginal object or Aboriginal place. For information relating to Aboriginal sites and objects across NSW, contact: Aboriginal Heritage Information Management System (AHIMS) on (02) 9585 6345 or email AHIMS@environment.nsw.gov.au. Alternatively visit <http://www.environment.nsw.gov.au/licences/AboriginalHeritageInformationManagementSystem.htm>.

Coastal Erosion

Information available to Council indicates coastal erosion may affect a greater number of properties and may present an increased risk to properties than that shown on published hazard maps of the Warringah coastline. Council's Natural Environment Unit can be contacted for further information.



Ray Brownlee PSM
Chief Executive Officer
08/10/2020

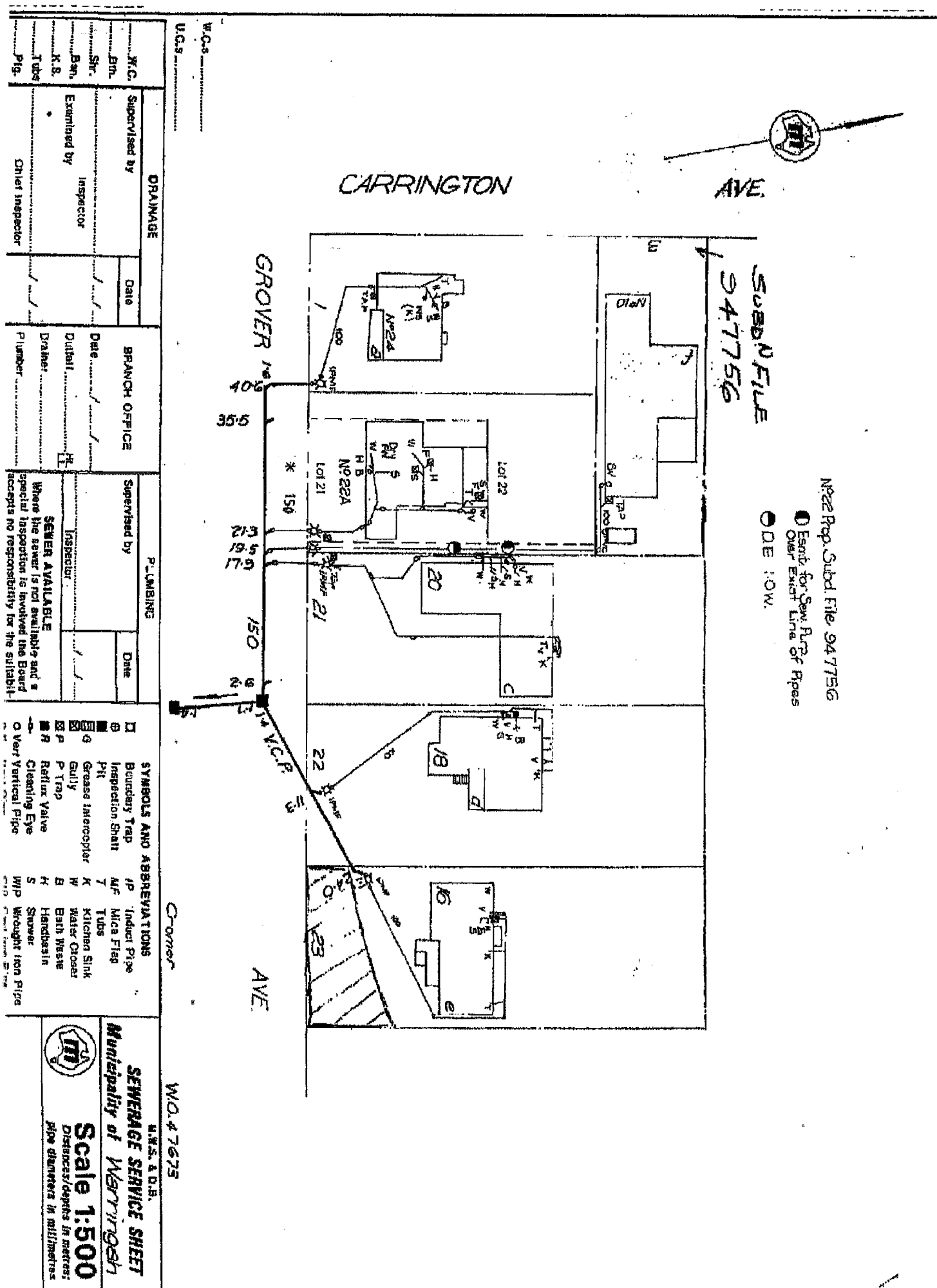

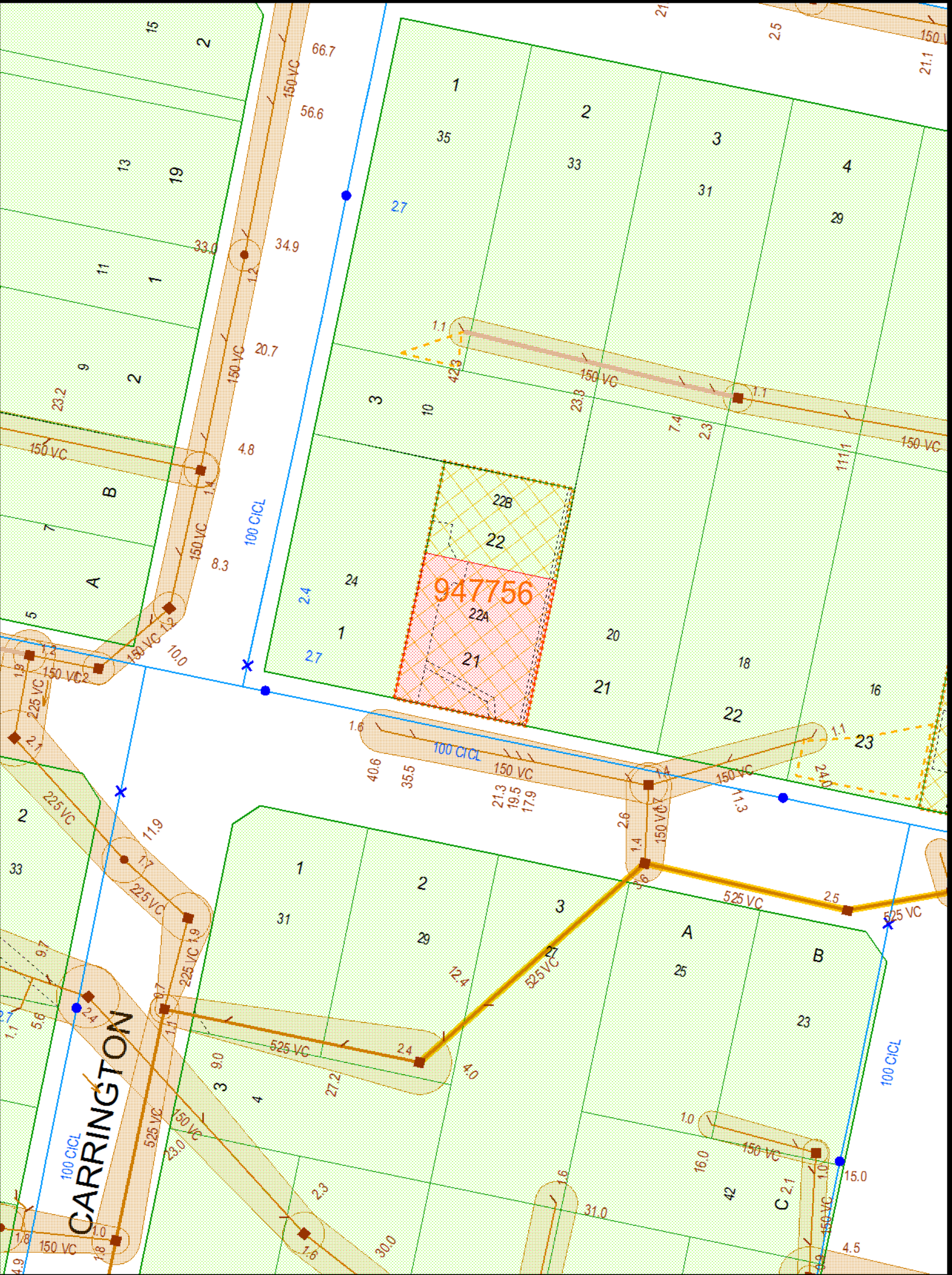

NOTE This diagram only indicates availability of a sewer and any sewerage service shown as existing in Sydney Water's records. The existence and position of Sydney Water's sewers, stormwater channels, pipes, mains and structures should be ascertained by inspection of maps available at any of Sydney Water's Customer Centres. Position of structures, boundaries, sewers and sewerage services shown hereon are approximately only.



Revenue

Enquiry ID	3337654
Agent ID	81290352
Issue Date	08 Oct 2020
Correspondence ID	1713711289
Your reference	N/F PRICE

GLOBALX INFORMATION PTY LTD
GPO Box 2746
BRISBANE QLD 4001

Land Tax Certificate under section 47 of the *Land Tax Management Act, 1956*.

This information is based on data held by Revenue NSW.

Land ID	Land address	Taxable land value
D877655/21	22A GROVER AVE CROMER 2099	\$918 000

There is **no land tax** (including surcharge land tax) charged on the land up to and including the 2020 tax year.

Yours sincerely,

A handwritten signature in black ink, appearing to read "S Johnston".

Scott Johnston

Chief Commissioner of State Revenue

Important information

Who is protected by a clearance certificate?

A clearance certificate states whether there is any land tax (including surcharge land tax) owing on a property. The certificate protects a purchaser from outstanding land tax liability by a previous owner, however it does not provide protection to the owner of the land.

When is a certificate clear from land tax?

A certificate may be issued as 'clear' if:

- the land is not liable or is exempt from land tax
- the land tax has been paid
- Revenue NSW is satisfied payment of the tax is not at risk, or
- the owner of the land failed to lodge a land tax return when it was due, and the liability was not detected at the time the certificate was issued.

Note: A clear certificate does not mean that land tax was not payable, or that there is no land tax adjustment to be made on settlement if the contract for sale allows for it.

When is a certificate not clear from land tax?

Under section 47 of the *Land Tax Management Act 1956*, land tax is a charge on land owned in NSW at midnight on 31 December of each year. The charge applies from the taxing date and does not depend on the issue of a land tax assessment notice. Land tax is an annual tax so a new charge may occur on the taxing date each year.

How do I clear a certificate?

A charge is removed for this property when the outstanding land tax amount is processed and paid in full. Payment can be made during settlement via an accepted Electronic Lodgement Network or at an approved settlement room.

To determine the land tax amount payable, you must use one of the following approved supporting documents:

- Current year land tax assessment notice. This can only be used if the settlement date is no later than the first instalment date listed on the notice. If payment is made after this date interest may apply.
- Clearance quote or settlement letter which shows the amount to clear.

The charge on the land will be considered removed upon payment of the amount shown on these documents

How do I get an updated certificate?

A certificate can be updated by re-processing the certificate through your Client Service Provider (CSP), or online at www.revenue.nsw.gov.au.

Please allow sufficient time for any payment to be processed prior to requesting a new version of the clearance certificate.

Land value, tax rates and thresholds

The taxable land value shown on the clearance certificate is the value used by Revenue NSW when assessing land tax. Details on land tax rates and thresholds are available at www.revenue.nsw.gov.au.

Contact details



Read more about Land Tax and use our online service at www.revenue.nsw.gov.au



1300 139 816*



Phone enquiries
8:30 am - 5:00 pm, Mon. to Fri.



landtax@revenue.nsw.gov.au

* Overseas customers call +61 2 7808 6906
Help in community languages is available.

RESIDENTIAL PROPERTY REQUISITIONS ON TITLE

Vendor: **Matthew Patrick Price & Nicola Elizabeth Price**
 Purchaser:
 Property: **22A Grover Avenue, Cromer NSW 2099**
 Dated:

Possession and tenancies

1. Vacant possession of the Property must be given on completion unless the Contract provides otherwise.
2. Is anyone in adverse possession of the Property or any part of it?
3.
 - (a) What are the nature and provisions of any tenancy or occupancy?
 - (b) If they are in writing, all relevant documentation should be produced, found in order and handed over on completion with notices of attornment.
 - (c) Please specify any existing breaches.
 - (d) All rent should be paid up to or beyond the date of completion.
 - (e) Please provide details of any bond together with the Rental Bond Board's reference number.
 - (f) If any bond money is held by the Rental Bond Board, the appropriate transfer documentation duly signed should be handed over on completion.
4. Is the Property affected by a protected tenancy (a tenancy affected by Schedule 2, Part 7 of the *Residential Tenancies Act 2010* (NSW))? If so, please provide details.
5. If the tenancy is subject to the *Residential Tenancies Act 2010* (NSW):
 - (a) has either the vendor or any predecessor or the tenant applied to the NSW Civil and Administrative Tribunal for an order?
 - (b) have any orders been made by the NSW Civil and Administrative Tribunal? If so, please provide details.

Title

6. Subject to the Contract, on completion the vendor should be registered as proprietor in fee simple of the Property free from all encumbrances and notations.
7. On or before completion, any mortgage, caveat, writ or priority notice must be discharged, withdrawn, cancelled or removed as the case may be or, in the case of a mortgage, caveat or priority notice, an executed discharge or withdrawal or removal handed over on completion.
8. Are there any proceedings pending or concluded that could result in the recording of any writ on the title to the Property or in the General Register of Deeds? If so, full details should be provided at least 14 days prior to completion.
9. When and where may the title documents be inspected?
10. Are any chattels or fixtures subject to any hiring or leasing agreement or charge or to any security interest under the *Personal Property Securities Act 2009* (Cth)? If so, details must be given and all indebtedness cleared and title transferred unencumbered to the vendor prior to completion.

Adjustments

11. All outgoing referred to in clause 14.1 of the Contract must be paid up to and including the date of completion.
12. Is the vendor liable to pay land tax or is the Property otherwise charged or liable to be charged with land tax? If so:
 - (a) to what year has a return been made?
 - (b) what is the taxable value of the Property for land tax purposes for the current year?
13. If any land tax certificate shows a charge for land tax on the land, the vendor must produce evidence at completion that the charge is no longer effective against the land.

Survey and building

14. Subject to the Contract, the survey should be satisfactory and show that the whole of the Property is available and that there are no encroachments by or upon the Property and that all improvements comply with local government/planning legislation.
15. Is the vendor in possession of a survey report? If so, please produce a copy for inspection prior to completion. The original should be handed over on completion.
16.
 - (a) Have the provisions of the *Local Government Act 1993* (NSW), the *Environmental Planning and Assessment Act 1979* (NSW) and their regulations been complied with?
 - (b) Is there any matter that could justify the making of an upgrading or demolition order in respect of any building or structure?
 - (c) Has the vendor a Building Information Certificate or a Building Certificate which relates to all current buildings or structures? If so, it should be handed over on completion. Please provide a copy in advance.
 - (d) Has the vendor a Final Occupation Certificate (as referred to in the former Section 109C of the *Environmental Planning and Assessment Act*) or an Occupation Certificate as referred to in Section 6.4 of that Act for all current buildings or structures? If so, it should be handed over on completion. Please provide a copy in advance.

- (e) In respect of any residential building work carried out in the last 7 years:
 - (i) please identify the building work carried out;
 - (ii) when was the building work completed?
 - (iii) please state the builder's name and licence number;
 - (iv) please provide details of insurance or any alternative indemnity product under the *Home Building Act 1989* (NSW).
- 17.
- (a) Has the vendor (or any predecessor) entered into any agreement with or granted any indemnity to the Council or any other authority concerning any development on the Property?
 - (b) Is there any planning agreement or other arrangement referred to in Section 7.4 of the Environmental Planning and Assessment Act, (registered or unregistered) affecting the Property? If so please provide details and indicate if there are any proposals for amendment or revocation?
18. If a swimming pool is included in the sale:
- (a) did its installation or construction commence before or after 1 August 1990?
 - (b) has the swimming pool been installed or constructed in accordance with approvals under the *Local Government Act 1919* (NSW) and *Local Government Act 1993* (NSW)?
 - (c) does it comply with the provisions of the *Swimming Pools Act 1992* (NSW) and regulations relating to access? If not, please provide details or the exemptions claimed;
 - (d) have any notices or orders issued or been threatened under the *Swimming Pools Act 1992* (NSW) or regulations?
 - (e) if a certificate of non-compliance has issued, please provide reasons for its issue if not disclosed in the contract;
 - (f) originals of certificate of compliance or non-compliance and occupation certificate should be handed over on settlement.
- 19.
- (a) To whom do the boundary fences belong?
 - (b) Are there any party walls?
 - (c) If the answer to Requisition 19(b) is yes, specify what rights exist in relation to each party wall and produce any agreement. The benefit of any such agreement should be assigned to the purchaser on completion.
 - (d) Is the vendor aware of any dispute regarding boundary or dividing fences or party walls?
 - (e) Has the vendor received any notice, claim or proceedings under the *Dividing Fences Act 1991* (NSW) or the *Encroachment of Buildings Act 1922* (NSW)?
- Affectations/Benefits**
- 20.
- (a) Is the vendor aware of any rights, licences, easements, covenants or restrictions as to use affecting or benefiting the Property other than those disclosed in the Contract? If a licence benefits the Property please provide a copy and indicate:
 - (i) whether there are any existing breaches by any party to it;
 - (ii) whether there are any matters in dispute; and
 - (iii) whether the licensor holds any deposit, bond or guarantee.
 - (b) In relation to such licence:
 - (i) All licence fees and other moneys payable should be paid up to and beyond the date of completion;
 - (ii) The vendor must comply with all requirements to allow the benefit to pass to the purchaser.
21. Is the vendor aware of:
- (a) any road, drain, sewer or storm water channel which intersects or runs through the land?
 - (b) any dedication to or use by the public of any right of way or other easement over any part of the land?
 - (c) any latent defects in the Property?
22. Has the vendor any notice or knowledge that the Property is affected by the following:
- (a) any resumption or acquisition or proposed resumption or acquisition?
 - (b) any notice requiring work to be done or money to be spent on the Property or any footpath or road adjoining? If so, such notice must be complied with prior to completion.
 - (c) any work done or intended to be done on the Property or the adjacent street which may create a charge on the Property or the cost of which might be or become recoverable from the purchaser?
 - (d) any sum due to any local or public authority? If so, it must be paid prior to completion.
 - (e) any realignment or proposed realignment of any road adjoining the Property?
 - (f) the existence of any contamination including, but not limited to, materials or substances dangerous to health such as asbestos and fibreglass or polyethylene or other flammable or combustible material including cladding? If the property is a building or part of a building to which external combustible cladding has been applied, has the owner provided to the Planning Secretary details of the building and the external combustible cladding and is the building recorded in the Register maintained by the Secretary?
- 23.
- (a) Does the Property have the benefit of water, sewerage, drainage, electricity, gas and telephone services?
 - (b) If so, do any of the connections for such services pass through any adjoining land?
 - (c) Do any service connections for any other Property pass through the Property?

24. Has any claim been made by any person to close, obstruct or limit access to or from the Property or to an easement over any part of the Property?

Capacity

25. If the Contract discloses that the vendor is a trustee, evidence should be produced to establish the trustee's power of sale.

Requisitions and transfer

26. If not attached to the Contract and the transaction is not an excluded transaction, any *clearance certificate* under Section 14-220 of Schedule 1 of the *Taxation Administration Act 1953* (Cth) should be served on the purchaser at least 7 days prior to completion.
27. The vendor should furnish completed details within the time specified in the contract, sufficient to enable the purchaser to make any *GSTRW* payment.
28. If the transfer or any other document to be handed over on completion is executed pursuant to a power of attorney, then at least 7 days prior to completion a copy of the registered power of attorney should be produced and found in order.
29. If the vendor has or is entitled to have possession of the title deeds the Certificate Authentication Code must be provided 7 days prior to settlement.
30. Searches, surveys, enquiries and inspection of title deeds must prove satisfactory.
31. The purchaser reserves the right to make further requisitions prior to completion.
32. Unless we are advised by you to the contrary prior to completion, it will be assumed that your replies to these requisitions remain unchanged as at the completion date.

Off the plan contract

33. If the Contract is an off the plan contract:
- (a) Is the vendor aware of any inaccuracy in the disclosure statement attached to the Contract? If so, please provide particulars.
 - (b) The vendor should before completion serve on the purchaser a copy of the registered plan and any document that was registered with the plan.
 - (c) Please provide details, if not already given, of the holding of the deposit or any instalment as trust or controlled monies by a real estate agent, licensed conveyancer or law practice.