

Contract for the sale and purchase of land 2022 edition

| TERM | MEANING OF TERM | NSW DAN: |
|--------------------|--|--|
| vendor's agent | Skyline Real Estate 3/14 Frenchs Forest Road E FRENCHS FOREST NSW 2086 | Ph: (02) 9452 3444 Fax: (02) 9452 4555 Ref: Stuart Bath – (M) 0416 207 215 |
| co-agent vendor | Peter Francis Dean | |

| | | |
|--|---|--|
| vendor's solicitor | Somerville Legal Level 10, 32 Walker Street NORTH SYDNEY NSW 2060 | Ph: (02) 9923 2321 Fax: (02) 9923 2332 Ref: ATS:VF:37088 |
| date for completion | 42nd | day after the contract date (clause 15) |
| land (address, plan details and title reference) | 69A The Esplanade, FRENCHS FOREST NSW 2086 Being Lot 131 in Registered Deposited Plan 866373 Folio Identifier: 131/866373 | |

improvements VACANT POSSESSION subject to existing tenancies
 HOUSE garage carport home unit carspace storage space
 none other:

attached copies documents in the List of Documents as marked or numbered:
 other documents:

| A real estate agent is permitted by legislation to fill up the items in this box in a sale of residential property. | | | |
|--|--|--|---|
| inclusions | <input checked="" type="checkbox"/> air conditioning | <input checked="" type="checkbox"/> clothes line | <input checked="" type="checkbox"/> fixed floor coverings |
| | <input checked="" type="checkbox"/> blinds | <input checked="" type="checkbox"/> curtains | <input checked="" type="checkbox"/> insect screens |
| | <input checked="" type="checkbox"/> built-in wardrobes | <input checked="" type="checkbox"/> dishwasher | <input checked="" type="checkbox"/> light fittings |
| | <input checked="" type="checkbox"/> ceiling fans | <input type="checkbox"/> EV charger | <input type="checkbox"/> pool equipment |
| | <input checked="" type="checkbox"/> other: Wall mirror in dining room area, gas heater in loungeroom and plant pots underneath the clothesline | | |
| exclusions | | | |
| purchaser | | | |
| purchaser's solicitor | | | |
| price | \$ | | |
| deposit | \$ | (10% of the price, unless otherwise stated) | |
| balance | \$ | | |
| contract date | (if not stated, the date this contract was made) | | |

Where there is more than one purchaser JOINT TENANTS
 tenants in common in unequal shares, specify: _____

GST AMOUNT (optional) The price includes GST of: \$

buyer's agent

Note: Clause 20.15 provides "Where this contract provides for choices, a choice in BLOCK CAPITALS applies unless a different choice is marked."

SIGNING PAGE

| VENDOR | PURCHASER |
|--|--|
| <p>Signed by</p> <p>_____</p> <p>Vendor</p> <p>_____</p> <p>Vendor</p> | <p>Signed by</p> <p>_____</p> <p>Purchaser</p> <p>_____</p> <p>Purchaser</p> |
| VENDOR (COMPANY) | PURCHASER (COMPANY) |
| <p>Signed by _____ in accordance with s127(1) of the Corporations Act 2001 by the authorised person(s) whose signature(s) appear(s) below:</p> <p>_____</p> <p>Signature of authorised person Signature of authorised person</p> <p>_____</p> <p>Name of authorised person Name of authorised person</p> <p>_____</p> <p>Office held Office held</p> | <p>Signed by _____ in accordance with s127(1) of the Corporations Act 2001 by the authorised person(s) whose signature(s) appear(s) below:</p> <p>_____</p> <p>Signature of authorised person Signature of authorised person</p> <p>_____</p> <p>Name of authorised person Name of authorised person</p> <p>_____</p> <p>Office held Office held</p> |

Choices

Vendor agrees to accept a **deposit-bond** NO yes

Nominated Electronic Lodgment Network (ELM) (clause 4): _____

Manual transaction (clause 30) NO yes
(if yes, vendor must provide further details, including any applicable exception, in the space below):

Tax information (the parties promise this is correct as far as each party is aware)

Land tax is adjustable NO yes
GST: Taxable supply NO yes in full yes to an extent
 Margin scheme will be used in making the taxable supply NO yes

This sale is not a taxable supply because (one or more of the following may apply) the sale is:

- not made in the course or furtherance of an enterprise that the vendor carries on (section 9-5(b))
- by a vendor who is neither registered nor required to be registered for GST (section 9-5(d))
- GST-free because the sale is the supply of a going concern under section 38-325
- GST-free because the sale is subdivided farm land or farm land supplied for farming under Subdivision 38-O
- input taxed because the sale is of eligible residential premises (sections 40-65, 40-75(2) and 195-1)

Purchaser must make a **GSTRW payment** (GST residential withholding payment) NO yes (if yes, vendor must provide details)

If the details below are not fully completed at the contract date, the vendor must provide all these details in a separate notice at least 7 days before the date for completion.

GSTRW payment (GST residential withholding payment) – details

Frequently the supplier will be the vendor. However, sometimes further information will be required as to which entity is liable for GST, for example, if the supplier is a partnership, a trust, part of a GST group or a participant in a GST joint venture.

Supplier's name:

Supplier's ABN:

Supplier's GST branch number (if applicable):

Supplier's business address:

Supplier's representative:

Supplier's contact phone number:

Supplier's proportion of **GSTRW payment**: \$

If more than one supplier, provide the above details for each supplier.

Amount purchaser must pay – price multiplied by the **GSTRW rate** (residential withholding rate): \$

Amount must be paid: AT COMPLETION at another time (specify):

Is any of the consideration not expressed as an amount in money? NO yes

If "yes", the GST inclusive market value of the non-monetary consideration: \$

Other details (including those required by regulation or the ATO forms):

List of Documents

| General | Strata or community title (clause 23 of the contract) |
|--|--|
| <input checked="" type="checkbox"/> 1 property certificate for the land <input checked="" type="checkbox"/> 2 plan of the land <input type="checkbox"/> 3 unregistered plan of the land <input type="checkbox"/> 4 plan of land to be subdivided <input type="checkbox"/> 5 document to be lodged with a relevant plan <input checked="" type="checkbox"/> 6 section 10.7(2) planning certificate under Environmental Planning and Assessment Act 1979 <input checked="" type="checkbox"/> 7 additional information included in that certificate under section 10.7(5) <input checked="" type="checkbox"/> 8 sewerage infrastructure location diagram (service location diagram) <input type="checkbox"/> 9 sewer lines location diagram (sewerage service diagram) <input type="checkbox"/> 10 document that created or may have created an easement, profit à prendre, restriction on use or positive covenant disclosed in this contract <input type="checkbox"/> 11 <i>planning agreement</i> <input type="checkbox"/> 12 section 88G certificate (positive covenant) <input type="checkbox"/> 13 survey report <input type="checkbox"/> 14 building information certificate or building certificate given under <i>legislation</i> <input type="checkbox"/> 15 occupation certificate <input type="checkbox"/> 16 lease (with every relevant memorandum or variation) <input type="checkbox"/> 17 other document relevant to tenancies <input type="checkbox"/> 18 licence benefiting the land <input type="checkbox"/> 19 old system document <input type="checkbox"/> 20 Crown purchase statement of account <input type="checkbox"/> 21 building management statement <input type="checkbox"/> 22 form of requisitions <input type="checkbox"/> 23 <i>clearance certificate</i> <input checked="" type="checkbox"/> 24 land tax certificate | <input type="checkbox"/> 33 property certificate for strata common property <input type="checkbox"/> 34 plan creating strata common property <input type="checkbox"/> 35 strata by-laws <input type="checkbox"/> 36 strata development contract or statement <input type="checkbox"/> 37 strata management statement <input type="checkbox"/> 38 strata renewal proposal <input type="checkbox"/> 39 strata renewal plan <input type="checkbox"/> 40 leasehold strata - lease of lot and common property <input type="checkbox"/> 41 property certificate for neighbourhood property <input type="checkbox"/> 42 plan creating neighbourhood property <input type="checkbox"/> 43 neighbourhood development contract <input type="checkbox"/> 44 neighbourhood management statement <input type="checkbox"/> 45 property certificate for precinct property <input type="checkbox"/> 46 plan creating precinct property <input type="checkbox"/> 47 precinct development contract <input type="checkbox"/> 48 precinct management statement <input type="checkbox"/> 49 property certificate for community property <input type="checkbox"/> 50 plan creating community property <input type="checkbox"/> 51 community development contract <input type="checkbox"/> 52 community management statement <input type="checkbox"/> 53 document disclosing a change of by-laws <input type="checkbox"/> 54 document disclosing a change in a development or management contract or statement <input type="checkbox"/> 55 document disclosing a change in boundaries <input type="checkbox"/> 56 information certificate under Strata Schemes Management Act 2015 <input type="checkbox"/> 57 information certificate under Community Land Management Act 2021 <input type="checkbox"/> 58 disclosure statement - off the plan contract <input type="checkbox"/> 59 other document relevant to off the plan contract |
| <p>Home Building Act 1989</p> <input type="checkbox"/> 25 insurance certificate <input type="checkbox"/> 26 brochure or warning <input type="checkbox"/> 27 evidence of alternative indemnity cover | <p>Other</p> <input type="checkbox"/> 60 |
| <p>Swimming Pools Act 1992</p> <input type="checkbox"/> 28 certificate of compliance <input type="checkbox"/> 29 evidence of registration <input type="checkbox"/> 30 relevant occupation certificate <input type="checkbox"/> 31 certificate of non-compliance <input type="checkbox"/> 32 detailed reasons of non-compliance | |

HOLDER OF STRATA OR COMMUNITY SCHEME RECORDS – Name, address, email address and telephone number

IMPORTANT NOTICE TO VENDORS AND PURCHASERS

Before signing this contract you should ensure that you understand your rights and obligations, some of which are not written in this contract but are implied by law.

WARNING—SMOKE ALARMS

The owners of certain types of buildings and strata lots must have smoke alarms, or in certain cases heat alarms, installed in the building or lot in accordance with regulations under the *Environmental Planning and Assessment Act 1979*. It is an offence not to comply. It is also an offence to remove or interfere with a smoke alarm or heat alarm. Penalties apply.

WARNING—LOOSE-FILL ASBESTOS INSULATION

Before purchasing land that includes residential premises, within the meaning of the *Home Building Act 1989*, Part 8, Division 1A, built before 1985, a purchaser is strongly advised to consider the possibility that the premises may contain loose-fill asbestos insulation, within the meaning of the *Home Building Act 1989*, Part 8, Division 1A. In particular, a purchaser should—

- (a) search the Register required to be maintained under the *Home Building Act 1989*, Part 8, Division 1A, and
- (b) ask the relevant local council whether it holds records showing that the residential premises contain loose-fill asbestos insulation.

For further information about loose-fill asbestos insulation, including areas in which residential premises have been identified as containing loose-fill asbestos insulation, contact NSW Fair Trading.

Cooling off period (purchaser's rights)

- 1** This is the statement required by the *Conveyancing Act 1919*, section 66X. This statement applies to a contract for the sale of residential property.
- 2** EXCEPT in the circumstances listed in paragraph 3, the purchaser may rescind the contract before 5pm on—
 - (a) for an off the plan contract—the tenth business day after the day on which the contract was made, or
 - (b) in any other case—the fifth business day after the day on which the contract was made.
- 3** There is NO COOLING OFF PERIOD—
 - (a) if, at or before the time the contract is made, the purchaser gives to the vendor, or the vendor's solicitor or agent, a certificate that complies with the Act, section 66W, or
 - (b) if the property is sold by public auction, or
 - (c) if the contract is made on the same day as the property was offered for sale by public auction but passed in, or
 - (d) if the contract is made in consequence of the exercise of an option to purchase the property, other than an option that is void under the Act, section 66ZG.
- 4** A purchaser exercising the right to cool off by rescinding the contract forfeits 0.25% of the purchase price of the property to the vendor.
- 5** The vendor is entitled to recover the forfeited amount from an amount paid by the purchaser as a deposit under the contract. The purchaser is entitled to a refund of any balance.

DISPUTES

If you get into a dispute with the other party, the Law Society and Real Estate Institute encourage you to use informal procedures such as negotiation, independent expert appraisal, the Law Society Conveyancing Dispute Resolution Scheme or mediation (for example mediation under the Law Society Mediation Program).

AUCTIONS

Regulations made under the Property and Stock Agents Act 2002 prescribe a number of conditions applying to sales by auction.

WARNINGS

1. Various Acts of Parliament and other matters can affect the rights of the parties to this contract. Some important matters are actions, claims, decisions, licences, notices, orders, proposals or rights of way involving:

| | |
|---|--|
| APA Group Australian Taxation Office Council County Council Department of Planning and Environment Department of Primary Industries Electricity and gas Land and Housing Corporation Local Land Services | NSW Department of Education NSW Fair Trading Owner of adjoining land Privacy Public Works Advisory Subsidence Advisory NSW Telecommunications Transport for NSW Water, sewerage or drainage authority |
|---|--|

If you think that any of these matters affects the property, tell your solicitor.
2. A lease may be affected by the Agricultural Tenancies Act 1990, the Residential Tenancies Act 2010 or the Retail Leases Act 1994.
3. If any purchase money is owing to the Crown, it will become payable before obtaining consent, or if no consent is needed, when the transfer is registered.
4. If a consent to transfer is required under legislation, see clause 27 as to the obligations of the parties.
5. The vendor should continue the vendor's insurance until completion. If the vendor wants to give the purchaser possession before completion, the vendor should first ask the insurer to confirm this will not affect the insurance.
6. Most purchasers will have to pay transfer duty (and, sometimes, if the purchaser is not an Australian citizen, surcharge purchaser duty) on this contract. Some purchasers may be eligible to choose to pay first home buyer choice property tax instead of transfer duty. If a payment is not made on time, interest and penalties may be incurred.
7. If the purchaser agrees to the release of deposit, the purchaser's right to recover the deposit may stand behind the rights of others (for example the vendor's mortgagee).
8. The purchaser should arrange insurance as appropriate.
9. Some transactions involving personal property may be affected by the Personal Property Securities Act 2009.
10. A purchaser should be satisfied that finance will be available at the time of completing the purchase.
11. Where the market value of the property is at or above a legislated amount, the purchaser may have to comply with a foreign resident capital gains withholding payment obligation (even if the vendor is not a foreign resident). If so, this will affect the amount available to the vendor on completion.
12. Purchasers of some residential properties may have to withhold part of the purchase price to be credited towards the GST liability of the vendor. If so, this will also affect the amount available to the vendor. More information is available from the ATO.

The vendor sells and the purchaser buys the *property* for the price under these provisions instead of Schedule 3 Conveyancing Act 1919, subject to any *legislation* that cannot be excluded.

1 Definitions (a term in italics is a defined term)

| | |
|-------------------------------|---|
| 1.1 | In this contract, these terms (in any form) mean – |
| <i>adjustment date</i> | the earlier of the giving of possession to the purchaser or completion; |
| <i>adjustment figures</i> | details of the adjustments to be made to the price under clause 14; |
| <i>authorised Subscriber</i> | a <i>Subscriber</i> (not being a <i>party's solicitor</i>) named in a notice served by a <i>party</i> as being authorised for the purposes of clause 20.6.8; |
| <i>bank</i> | the Reserve Bank of Australia or an authorised deposit-taking institution which is a bank, a building society or a credit union; |
| <i>business day</i> | any day except a bank or public holiday throughout NSW or a Saturday or Sunday; |
| <i>cheque</i> | a cheque that is not postdated or stale; |
| <i>clearance certificate</i> | a certificate within the meaning of s14-220 of Schedule 1 to the <i>TA Act</i> , that covers one or more days falling within the period from and including the contract date to completion; |
| <i>completion time</i> | the time of day at which completion is to occur; |
| <i>conveyancing rules</i> | the rules made under s12E of the Real Property Act 1900; |
| <i>deposit-bond</i> | a deposit bond or guarantee with each of the following approved by the vendor – <ul style="list-style-type: none"> ● the issuer; ● the expiry date (if any); and ● the amount; |
| <i>depositholder</i> | vendor's agent (or if no vendor's agent is named in this contract, the vendor's <i>solicitor</i> , or if no vendor's <i>solicitor</i> is named in this contract, the buyer's agent); |
| <i>discharging mortgagee</i> | any discharging mortgagee, chargee, covenant chargee or caveator whose provision of a <i>Digitally Signed</i> discharge of mortgage, discharge of charge or withdrawal of caveat is required in order for unencumbered title to the <i>property</i> to be transferred to the purchaser; |
| <i>document of title</i> | document relevant to the title or the passing of title; |
| <i>ECNL</i> | the Electronic Conveyancing National Law (NSW); |
| <i>electronic document</i> | a dealing as defined in the Real Property Act 1900 which may be created and <i>Digitally Signed</i> in an <i>Electronic Workspace</i> ; |
| <i>electronic transaction</i> | a <i>Conveyancing Transaction</i> to be conducted for the <i>parties</i> by their legal representatives as <i>Subscribers</i> using an <i>ELN</i> and in accordance with the <i>ECNL</i> and the <i>participation rules</i> ; |
| <i>electronic transfer</i> | a transfer of land under the Real Property Act 1900 for the <i>property</i> to be prepared and <i>Digitally Signed</i> in the <i>Electronic Workspace</i> established for the purposes of the <i>parties' Conveyancing Transaction</i> ; |
| <i>FRCGW percentage</i> | the percentage mentioned in s14-200(3)(a) of Schedule 1 to the <i>TA Act</i> (12.5% as at 1 July 2017); |
| <i>FRCGW remittance</i> | a remittance which the purchaser must make under s14-200 of Schedule 1 to the <i>TA Act</i> , being the lesser of the <i>FRCGW percentage</i> of the price (inclusive of GST, if any) and the amount specified in a <i>variation served by a party</i> ; |
| <i>GST Act</i> | A New Tax System (Goods and Services Tax) Act 1999; |
| <i>GST rate</i> | the rate mentioned in s4 of A New Tax System (Goods and Services Tax Imposition - General) Act 1999 (10% as at 1 July 2000); |
| <i>GSTRW payment</i> | a payment which the purchaser must make under s14-250 of Schedule 1 to the <i>TA Act</i> (the price multiplied by the <i>GSTRW rate</i>); |
| <i>GSTRW rate</i> | the rate determined under ss14-250(6), (8) or (9) of Schedule 1 to the <i>TA Act</i> (as at 1 July 2018, usually 7% of the price if the margin scheme applies, 1/11 th if not); |
| <i>incoming mortgagee</i> | any mortgagee who is to provide finance to the purchaser on the security of the <i>property</i> and to enable the purchaser to pay the whole or part of the price; |
| <i>legislation</i> | an Act or a by-law, ordinance, regulation or rule made under an Act; |
| <i>manual transaction</i> | a <i>Conveyancing Transaction</i> in which a dealing forming part of the <i>Lodgment Case</i> at or following completion cannot be <i>Digitally Signed</i> ; |
| <i>normally</i> | subject to any other provision of this contract; |
| <i>participation rules</i> | the participation rules as determined by the <i>ECNL</i> ; |
| <i>party</i> | each of the vendor and the purchaser; |
| <i>property</i> | the land, the improvements, all fixtures and the inclusions, but not the exclusions; |
| <i>planning agreement</i> | a valid voluntary agreement within the meaning of s7.4 of the Environmental Planning and Assessment Act 1979 entered into in relation to the <i>property</i> ; |
| <i>populate</i> | to complete data fields in the <i>Electronic Workspace</i> ; |

| | |
|--------------------------|---|
| <i>requisition</i> | an objection, question or requisition (but the term does not include a claim); |
| <i>rescind</i> | rescind this contract from the beginning; |
| <i>serve</i> | serve in writing on the other <i>party</i> ; |
| <i>settlement cheque</i> | an unendorsed <i>cheque</i> made payable to the person to be paid and – <ul style="list-style-type: none"> • issued by a <i>bank</i> and drawn on itself; or • if authorised in writing by the vendor or the vendor's <i>solicitor</i>, some other <i>cheque</i>; |
| <i>solicitor</i> | in relation to a <i>party</i> , the <i>party's</i> solicitor or licensed conveyancer named in this contract or in a notice <i>served</i> by the <i>party</i> ; |
| <i>TA Act</i> | Taxation Administration Act 1953; |
| <i>terminate</i> | terminate this contract for breach; |
| <i>title data</i> | the details of the title to the <i>property</i> made available to the <i>Electronic Workspace</i> by the <i>Land Registry</i> ; |
| <i>variation</i> | a variation made under s14-235 of Schedule 1 to the <i>TA Act</i> ; |
| <i>within</i> | in relation to a period, at any time before or during the period; and |
| <i>work order</i> | a valid direction, notice or order that requires work to be done or money to be spent on or in relation to the <i>property</i> or any adjoining footpath or road (but the term does not include a notice under s22E of the Swimming Pools Act 1992 or clause 22 of the Swimming Pools Regulation 2018). |

- 1.2 Words and phrases used in this contract (italicised and in Title Case, such as *Conveyancing Transaction*, *Digitally Signed*, *Electronic Workspace*, *ELN*, *ELNO*, *Land Registry*, *Lodgment Case* and *Subscriber*) have the meanings given in the *participation rules*.

2 Deposit and other payments before completion

- 2.1 The purchaser must pay the deposit to the *depositholder* as stakeholder.
- 2.2 *Normally*, the purchaser must pay the deposit on the making of this contract, and this time is essential.
- 2.3 If this contract requires the purchaser to pay any of the deposit by a later time, that time is also essential.
- 2.4 The purchaser can pay any of the deposit by –
- 2.4.1 giving cash (up to \$2,000) to the *depositholder*;
- 2.4.2 unconditionally giving a *cheque* to the *depositholder* or to the vendor, vendor's agent or vendor's *solicitor* for sending to the *depositholder*; or
- 2.4.3 electronic funds transfer to the *depositholder's* nominated account and, if requested by the vendor or the *depositholder*, providing evidence of that transfer.
- 2.5 The vendor can *terminate* if –
- 2.5.1 any of the deposit is not paid on time;
- 2.5.2 a *cheque* for any of the deposit is not honoured on presentation; or
- 2.5.3 a payment under clause 2.4.3 is not received in the *depositholder's* nominated account by 5.00 pm on the third *business day* after the time for payment.
- This right to *terminate* is lost as soon as the deposit is paid in full.
- 2.6 If the vendor accepts a *deposit-bond* for the deposit, clauses 2.1 to 2.5 do not apply.
- 2.7 If the vendor accepts a *deposit-bond* for part of the deposit, clauses 2.1 to 2.5 apply only to the balance.
- 2.8 If any of the deposit or of the balance of the price is paid before completion to the vendor or as the vendor directs, it is a charge on the land in favour of the purchaser until *termination* by the vendor or completion, subject to any existing right.
- 2.9 If each *party* tells the *depositholder* that the deposit is to be invested, the *depositholder* is to invest the deposit (at the risk of the *party* who becomes entitled to it) with a *bank*, in an interest-bearing account in NSW, payable at call, with interest to be reinvested, and pay the interest to the *parties* equally, after deduction of all proper government taxes and financial institution charges and other charges.

3 Deposit-bond

- 3.1 This clause applies only if the vendor accepts a *deposit-bond* for the deposit (or part of it).
- 3.2 The purchaser must provide the *deposit-bond* to the vendor's *solicitor* (or if no solicitor the *depositholder*) at or before the making of this contract and this time is essential.
- 3.3 If the *deposit-bond* has an expiry date and completion does not occur by the date which is 14 days before the expiry date, the purchaser must *serve* a replacement *deposit-bond* at least 7 days before the expiry date. The time for service is essential.
- 3.4 The vendor must approve a replacement *deposit-bond* if –
- 3.4.1 it is from the same issuer and for the same amount as the earlier *deposit-bond*; and
- 3.4.2 it has an expiry date at least three months after its date of issue.
- 3.5 A breach of clauses 3.2 or 3.3 entitles the vendor to *terminate*. The right to *terminate* is lost as soon as –
- 3.5.1 the purchaser *serves* a replacement *deposit-bond*; or
- 3.5.2 the deposit is paid in full under clause 2.
- 3.6 Clauses 3.3 and 3.4 can operate more than once.

- 3.7 If the purchaser *serves* a replacement *deposit-bond*, the vendor must *serve* the earlier *deposit-bond*.
- 3.8 The amount of any *deposit-bond* does not form part of the price for the purposes of clause 16.5.
- 3.9 The vendor must give the purchaser any original *deposit-bond* –
- 3.9.1 on completion; or
- 3.9.2 if this contract is *rescinded*.
- 3.10 If this contract is *terminated* by the vendor –
- 3.10.1 *normally*, the vendor can immediately demand payment from the issuer of the *deposit-bond*; or
- 3.10.2 if the purchaser *serves* prior to *termination* a notice disputing the vendor's right to *terminate*, the vendor must forward any original *deposit-bond* (or its proceeds if called up) to the *depositholder* as stakeholder.
- 3.11 If this contract is *terminated* by the purchaser –
- 3.11.1 *normally*, the vendor must give the purchaser any original *deposit-bond*; or
- 3.11.2 if the vendor *serves* prior to *termination* a notice disputing the purchaser's right to *terminate*, the vendor must forward any original *deposit-bond* (or its proceeds if called up) to the *depositholder* as stakeholder.
- 4 Electronic transaction**
- 4.1 This *Conveyancing Transaction* is to be conducted as an *electronic transaction* unless –
- 4.1.1 the contract says this transaction is a *manual transaction*, giving the reason, or
- 4.1.2 a *party* *serves* a notice stating why the transaction is a *manual transaction*, in which case the *parties* do not have to complete earlier than 14 days after *service* of the notice, and clause 21.3 does not apply to this provision,
- and in both cases clause 30 applies.
- 4.2 If, because of clause 4.1.2, this *Conveyancing Transaction* is to be conducted as a *manual transaction* –
- 4.2.1 each *party* must –
- bear equally any disbursements or fees; and
 - otherwise bear that *party's* own costs;
- incurred because this *Conveyancing Transaction* was to be conducted as an *electronic transaction*; and
- 4.2.2 if a *party* has paid all of a disbursement or fee which, by reason of this clause, is to be borne equally by the *parties*, that amount must be adjusted under clause 14.
- 4.3 The *parties* must conduct the *electronic transaction* –
- 4.3.1 in accordance with the *participation rules* and the *ECNL*; and
- 4.3.2 using the nominated *ELN*, unless the *parties* otherwise agree. This clause 4.3.2 does not prevent a *party* using an *ELN* which can interoperate with the nominated *ELN*.
- 4.4 A *party* must pay the fees and charges payable by that *party* to the *ELNO* and the *Land Registry*.
- 4.5 *Normally*, the vendor must *within 7* days of the contract date create and *populate* an *Electronic Workspace* with *title data* and the date for completion, and invite the purchaser to the *Electronic Workspace*.
- 4.6 If the vendor has not created an *Electronic Workspace* in accordance with clause 4.5, the purchaser may create and *populate* an *Electronic Workspace* and, if it does so, the purchaser must invite the vendor to the *Electronic Workspace*.
- 4.7 The *parties* must, as applicable to their role in the *Conveyancing Transaction* and the steps taken under clauses 4.5 or 4.6 –
- 4.7.1 promptly join the *Electronic Workspace* after receipt of an invitation;
- 4.7.2 create and *populate* an *electronic transfer*;
- 4.7.3 invite any *discharging mortgagee* or *incoming mortgagee* to join the *Electronic Workspace*; and
- 4.7.4 *populate* the *Electronic Workspace* with a nominated *completion time*.
- 4.8 If the transferee in the *electronic transfer* is not the purchaser, the purchaser must give the vendor a direction signed by the purchaser personally for that transfer.
- 4.9 The vendor can require the purchaser to include a covenant or easement in the *electronic transfer* only if this contract contains the wording of the proposed covenant or easement, and a description of the land burdened and benefited.
- 4.10 If the purchaser must make a *GSTRW payment* or an *FRCGW remittance*, the purchaser must *populate* the *Electronic Workspace* with the payment details for the *GSTRW payment* or *FRCGW remittance* payable to the Deputy Commissioner of Taxation at least 2 *business days* before the date for completion.
- 4.11 Before completion, the *parties* must ensure that –
- 4.11.1 all *electronic documents* which a *party* must *Digitally Sign* to complete the *electronic transaction* are *populated* and *Digitally Signed*;
- 4.11.2 all certifications required by the *ECNL* are properly given; and
- 4.11.3 they do everything else in the *Electronic Workspace* which that *party* must do to enable the *electronic transaction* to proceed to completion.
- 4.12 If the computer systems of any of the *Land Registry*, the *ELNO*, Revenue NSW or the Reserve Bank of Australia are inoperative for any reason at the *completion time* agreed by the *parties*, a failure to complete this contract for that reason is not a default under this contract on the part of either *party*.

- 4.13 If the computer systems of the *Land Registry* are inoperative for any reason at the *completion time* agreed by the *parties*, and the *parties* choose that financial settlement is to occur despite this, then on financial settlement occurring –
- 4.13.1 all *electronic documents Digitally Signed* by the vendor and any discharge of mortgage, withdrawal of caveat or other *electronic document* forming part of the *Lodgment Case* for the *electronic transaction* are taken to have been unconditionally and irrevocably delivered to the purchaser or the purchaser's mortgagee at the time of financial settlement together with the right to deal with the land; and
- 4.13.2 the vendor is taken to have no legal or equitable interest in the *property*.
- 4.14 If the *parties* do not agree about the delivery before completion of one or more documents or things that cannot be delivered through the *Electronic Workspace*, the *party* required to deliver the documents or things –
- 4.14.1 holds them on completion in escrow for the benefit of; and
- 4.14.2 must immediately after completion deliver the documents or things to, or as directed by; the *party* entitled to them.

5 Requisitions

- 5.1 If a form of *requisitions* is attached to this contract, the purchaser is taken to have made those *requisitions*.
- 5.2 If the purchaser is or becomes entitled to make any other *requisition*, the purchaser can make it only by *servicing* it –
- 5.2.1 if it arises out of this contract or it is a general question about the *property* or title - *within 21 days* after the contract date;
- 5.2.2 if it arises out of anything *served* by the vendor - *within 21 days* after the later of the contract date and that *service*; and
- 5.2.3 in any other case - *within* a reasonable time.

6 Error or misdescription

- 6.1 *Normally*, the purchaser can (but only before completion) claim compensation for an error or misdescription in this contract (as to the *property*, the title or anything else and whether substantial or not).
- 6.2 This clause applies even if the purchaser did not take notice of or rely on anything in this contract containing or giving rise to the error or misdescription.
- 6.3 However, this clause does not apply to the extent the purchaser knows the true position.

7 Claims by purchaser

- Normally*, the purchaser can make a claim (including a claim under clause 6) before completion only by *servicing* it with a statement of the amount claimed, and if the purchaser makes one or more claims before completion –
- 7.1 the vendor can *rescind* if in the case of claims that are not claims for delay –
- 7.1.1 the total amount claimed exceeds 5% of the price;
- 7.1.2 the vendor *serves* notice of intention to *rescind*; and
- 7.1.3 the purchaser does not *serve* notice waiving the claims *within 14 days* after that *service*; and
- 7.2 if the vendor does not *rescind*, the *parties* must complete and if this contract is completed –
- 7.2.1 the lesser of the total amount claimed and 10% of the price must be paid out of the price to and held by the *depositholder* until the claims are finalised or lapse;
- 7.2.2 the amount held is to be invested in accordance with clause 2.9;
- 7.2.3 the claims must be finalised by an arbitrator appointed by the *parties* or, if an appointment is not made *within 1 month* of completion, by an arbitrator appointed by the President of the Law Society at the request of a *party* (in the latter case the *parties* are bound by the terms of the Conveyancing Arbitration Rules approved by the Law Society as at the date of the appointment);
- 7.2.4 the purchaser is not entitled, in respect of the claims, to more than the total amount claimed and the costs of the purchaser;
- 7.2.5 net interest on the amount held must be paid to the *parties* in the same proportion as the amount held is paid; and
- 7.2.6 if the *parties* do not appoint an arbitrator and neither *party* requests the President to appoint an arbitrator *within 3 months* after completion, the claims lapse and the amount belongs to the vendor.

8 Vendor's rights and obligations

- 8.1 The vendor can *rescind* if –
- 8.1.1 the vendor is, on reasonable grounds, unable or unwilling to comply with a *requisition*;
- 8.1.2 the vendor *serves* a notice of intention to *rescind* that specifies the *requisition* and those grounds; and
- 8.1.3 the purchaser does not *serve* a notice waiving the *requisition within 14 days* after that *service*.

- 8.2 If the vendor does not comply with this contract (or a notice under or relating to it) in an essential respect, the purchaser can *terminate* by *servicing* a notice. After the *termination* –
- 8.2.1 the purchaser can recover the deposit and any other money paid by the purchaser under this contract;
- 8.2.2 the purchaser can sue the vendor to recover damages for breach of contract; and
- 8.2.3 if the purchaser has been in possession a *party* can claim for a reasonable adjustment.

9 Purchaser's default

If the purchaser does not comply with this contract (or a notice under or relating to it) in an essential respect, the vendor can *terminate* by *servicing* a notice. After the *termination* the vendor can –

- 9.1 keep or recover the deposit (to a maximum of 10% of the price);
- 9.2 hold any other money paid by the purchaser under this contract as security for anything recoverable under this clause –
- 9.2.1 for 12 months after the *termination*; or
- 9.2.2 if the vendor commences proceedings under this clause *within* 12 months, until those proceedings are concluded; and
- 9.3 sue the purchaser either –
- 9.3.1 where the vendor has resold the *property* under a contract made *within* 12 months after the *termination*, to recover –
- the deficiency on resale (with credit for any of the deposit kept or recovered and after allowance for any capital gains tax or goods and services tax payable on anything recovered under this clause); and
 - the reasonable costs and expenses arising out of the purchaser's non-compliance with this contract or the notice and of resale and any attempted resale; or
- 9.3.2 to recover damages for breach of contract.

10 Restrictions on rights of purchaser

- 10.1 The purchaser cannot make a claim or *requisition* or *rescind* or *terminate* in respect of –
- 10.1.1 the ownership or location of any fence as defined in the Dividing Fences Act 1991;
- 10.1.2 a service for the *property* being a joint service or passing through another property, or any service for another property passing through the *property* ('service' includes air, communication, drainage, electricity, garbage, gas, oil, radio, sewerage, telephone, television or water service);
- 10.1.3 a wall being or not being a party wall in any sense of that term or the *property* being affected by an easement for support or not having the benefit of an easement for support;
- 10.1.4 any change in the *property* due to fair wear and tear before completion;
- 10.1.5 a promise, representation or statement about this contract, the *property* or the title, not set out or referred to in this contract;
- 10.1.6 a condition, exception, reservation or restriction in a Crown grant;
- 10.1.7 the existence of any authority or licence to explore or prospect for gas, minerals or petroleum;
- 10.1.8 any easement or restriction on use the substance of either of which is disclosed in this contract or any non-compliance with the easement or restriction on use; or
- 10.1.9 anything the substance of which is disclosed in this contract (except a caveat, charge, mortgage, priority notice or writ).
- 10.2 The purchaser cannot *rescind* or *terminate* only because of a defect in title to or quality of the inclusions.
- 10.3 *Normally*, the purchaser cannot make a claim or *requisition* or *rescind* or *terminate* or require the vendor to change the nature of the title disclosed in this contract (for example, to remove a caution evidencing qualified title, or to lodge a plan of survey as regards limited title).

11 Compliance with work orders

- 11.1 *Normally*, the vendor must by completion comply with a *work order* made on or before the contract date and if this contract is completed the purchaser must comply with any other *work order*.
- 11.2 If the purchaser complies with a *work order*, and this contract is *rescinded* or *terminated*, the vendor must pay the expense of compliance to the purchaser.

12 Certificates and inspections

The vendor must do everything reasonable to enable the purchaser, subject to the rights of any tenant –

- 12.1 to have the *property* inspected to obtain any certificate or report reasonably required;
- 12.2 to apply (if necessary in the name of the vendor) for –
- 12.2.1 any certificate that can be given in respect of the *property* under *legislation*; or
- 12.2.2 a copy of any approval, certificate, consent, direction, notice or order in respect of the *property* given under *legislation*, even if given after the contract date; and
- 12.3 to make 1 inspection of the *property* in the 3 days before a time appointed for completion.

13 Goods and services tax (GST)

- 13.1 Terms used in this clause which are not defined elsewhere in this contract and have a defined meaning in the *GST Act* have the same meaning in this clause.
- 13.2 *Normally*, if a *party* must pay the price or any other amount to the other *party* under this contract, GST is not to be added to the price or amount.
- 13.3 If under this contract a *party* must make an adjustment or payment for an expense of another party or pay an expense payable by or to a third party (for example, under clauses 14 or 20.7) –
- 13.3.1 the *party* must adjust or pay on completion any GST added to or included in the expense; but
- 13.3.2 the amount of the expense must be reduced to the extent the party receiving the adjustment or payment (or the representative member of a GST group of which that party is a member) is entitled to an input tax credit for the expense; and
- 13.3.3 if the adjustment or payment under this contract is consideration for a taxable supply, an amount for GST must be added at the *GST rate*.
- 13.4 If this contract says this sale is the supply of a going concern –
- 13.4.1 the *parties* agree the supply of the *property* is a supply of a going concern;
- 13.4.2 the vendor must, between the contract date and completion, carry on the enterprise conducted on the land in a proper and business-like way;
- 13.4.3 if the purchaser is not registered by the date for completion, the *parties* must complete and the purchaser must pay on completion, in addition to the price, an amount being the price multiplied by the *GST rate* ("the retention sum"). The retention sum is to be held by the *depositholder* and dealt with as follows –
- if *within* 3 months of completion the purchaser *serves* a letter from the Australian Taxation Office stating the purchaser is registered with a date of effect of registration on or before completion, the *depositholder* is to pay the retention sum to the purchaser; but
 - if the purchaser does not *serve* that letter *within* 3 months of completion, the *depositholder* is to pay the retention sum to the vendor; and
- 13.4.4 if the vendor, despite clause 13.4.1, *serves* a letter from the Australian Taxation Office stating the vendor has to pay GST on the supply, the purchaser must pay to the vendor on demand the amount of GST assessed.
- 13.5 *Normally*, the vendor promises the margin scheme will not apply to the supply of the *property*.
- 13.6 If this contract says the margin scheme is to apply in making the taxable supply, the *parties* agree that the margin scheme is to apply to the sale of the *property*.
- 13.7 If this contract says the sale is not a taxable supply –
- 13.7.1 the purchaser promises that the *property* will not be used and represents that the purchaser does not intend the *property* (or any part of the *property*) to be used in a way that could make the sale a taxable supply to any extent; and
- 13.7.2 the purchaser must pay the vendor on completion in addition to the price an amount calculated by multiplying the price by the *GST rate* if this sale is a taxable supply to any extent because of –
- a breach of clause 13.7.1; or
 - something else known to the purchaser but not the vendor.
- 13.8 If this contract says this sale is a taxable supply in full and does not say the margin scheme applies to the *property*, the vendor must pay the purchaser on completion an amount of one-eleventh of the price if –
- 13.8.1 this sale is not a taxable supply in full; or
- 13.8.2 the margin scheme applies to the *property* (or any part of the *property*).
- 13.9 If this contract says this sale is a taxable supply to an extent –
- 13.9.1 clause 13.7.1 does not apply to any part of the *property* which is identified as being a taxable supply; and
- 13.9.2 the payments mentioned in clauses 13.7 and 13.8 are to be recalculated by multiplying the relevant payment by the proportion of the price which represents the value of that part of the *property* to which the clause applies (the proportion to be expressed as a number between 0 and 1). Any evidence of value must be obtained at the expense of the vendor.
- 13.10 *Normally*, on completion the vendor must give the recipient of the supply a tax invoice for any taxable supply by the vendor by or under this contract.
- 13.11 The vendor does not have to give the purchaser a tax invoice if the margin scheme applies to a taxable supply.
- 13.12 If the vendor is liable for GST on rents or profits due to issuing an invoice or receiving consideration before completion, any adjustment of those amounts must exclude an amount equal to the vendor's GST liability.
- 13.13 If the vendor *serves* details of a *GSTRW payment* which the purchaser must make, the purchaser does not have to complete earlier than 5 *business days* after that *service* and clause 21.3 does not apply to this provision.
- 13.14 If the purchaser must make a *GSTRW payment* the purchaser must, at least 2 *business days* before the date for completion, *serve* evidence of submission of a *GSTRW payment* notification form to the Australian Taxation Office by the purchaser or, if a direction under either clause 4.8 or clause 30.4 has been given, by the transferee named in the transfer the subject of that direction.

14 Adjustments

- 14.1 *Normally*, the vendor is entitled to the rents and profits and will be liable for all rates, water, sewerage and drainage service and usage charges, land tax, levies and all other periodic outgoings up to and including the *adjustment date* after which the purchaser will be entitled and liable.
- 14.2 The *parties* must make any necessary adjustment on completion, and –
- 14.2.1 the purchaser must provide the vendor with *adjustment figures* at least 2 *business days* before the date for completion; and
- 14.2.2 the vendor must confirm the *adjustment figures* at least 1 *business day* before the date for completion.
- 14.3 If an amount that is adjustable under this contract has been reduced under *legislation*, the *parties* must on completion adjust the reduced amount.
- 14.4 The *parties* must not adjust surcharge land tax (as defined in the Land Tax Act 1956) but must adjust any other land tax for the year current at the *adjustment date* –
- 14.4.1 only if land tax has been paid or is payable for the year (whether by the vendor or by a predecessor in title) and this contract says that land tax is adjustable;
- 14.4.2 by adjusting the amount that would have been payable if at the start of the year –
- the person who owned the land owned no other land;
 - the land was not subject to a special trust or owned by a non-concessional company; and
 - if the land (or part of it) had no separate taxable value, by calculating its separate taxable value on a proportional area basis.
- 14.5 The *parties* must not adjust any first home buyer choice property tax.
- 14.6 If any other amount that is adjustable under this contract relates partly to the land and partly to other land, the *parties* must adjust it on a proportional area basis.
- 14.7 If on completion the last bill for a water, sewerage or drainage usage charge is for a period ending before the *adjustment date*, the vendor is liable for an amount calculated by dividing the bill by the number of days in the period then multiplying by the number of unbilled days up to and including the *adjustment date*.
- 14.8 The vendor is liable for any amount recoverable for work started on or before the contract date on the *property* or any adjoining footpath or road.

15 Date for completion

The *parties* must complete by the date for completion and, if they do not, a *party* can serve a notice to complete if that *party* is otherwise entitled to do so.

16 Completion

• Vendor

- 16.1 *Normally*, on completion the vendor must cause the legal title to the *property* (being the estate disclosed in this contract) to pass to the purchaser free of any charge, mortgage or other interest, subject to any necessary registration.
- 16.2 The legal title to the *property* does not pass before completion.
- 16.3 If the vendor gives the purchaser a document (other than the transfer) that needs to be lodged for registration, the vendor must pay the lodgment fee to the purchaser.
- 16.4 If a *party* serves a land tax certificate showing a charge on any of the land, by completion the vendor must do all things and pay all money required so that the charge is no longer effective against the land.

• Purchaser

- 16.5 On completion the purchaser must pay to the vendor –
- 16.5.1 the price less any –
- deposit paid;
 - *FRCGW remittance* payable;
 - *GSTRW payment*; and
 - amount payable by the vendor to the purchaser under this contract; and
- 16.5.2 any other amount payable by the purchaser under this contract.
- 16.6 If any of the deposit is not covered by a *deposit-bond*, at least 1 *business day* before the date for completion the purchaser must give the vendor an order signed by the purchaser authorising the *depositholder* to account to the vendor for the deposit, to be held by the vendor in escrow until completion.
- 16.7 On completion the deposit belongs to the vendor.

17 Possession

- 17.1 *Normally*, the vendor must give the purchaser vacant possession of the *property* on completion.
- 17.2 The vendor does not have to give vacant possession if –
- 17.2.1 this contract says that the sale is subject to existing tenancies; and
- 17.2.2 the contract discloses the provisions of the tenancy (for example, by attaching a copy of the lease and any relevant memorandum or variation).
- 17.3 *Normally*, the purchaser can claim compensation (before or after completion) or *rescind* if any of the land is affected by a protected tenancy (a tenancy affected by Schedule 2, Part 7 of the Residential Tenancies Act 2010).

18 Possession before completion

- 18.1 This clause applies only if the vendor gives the purchaser possession of the *property* before completion.
- 18.2 The purchaser must not before completion –
- 18.2.1 let or part with possession of any of the *property*;
 - 18.2.2 make any change or structural alteration or addition to the *property*; or
 - 18.2.3 contravene any agreement between the *parties* or any direction, document, *legislation*, notice or order affecting the *property*.
- 18.3 The purchaser must until completion –
- 18.3.1 keep the *property* in good condition and repair having regard to its condition at the giving of possession; and
 - 18.3.2 allow the vendor or the vendor's authorised representative to enter and inspect it at all reasonable times.
- 18.4 The risk as to damage to the *property* passes to the purchaser immediately after the purchaser enters into possession.
- 18.5 If the purchaser does not comply with this clause, then without affecting any other right of the vendor –
- 18.5.1 the vendor can before completion, without notice, remedy the non-compliance; and
 - 18.5.2 if the vendor pays the expense of doing this, the purchaser must pay it to the vendor with interest at the rate prescribed under s101 Civil Procedure Act 2005.
- 18.6 If this contract is *rescinded* or *terminated* the purchaser must immediately vacate the *property*.
- 18.7 If the *parties* or their *solicitors* on their behalf do not agree in writing to a fee or rent, none is payable.

19 Rescission of contract

- 19.1 If this contract expressly gives a *party* a right to *rescind*, the *party* can exercise the right –
- 19.1.1 only by *servicing* a notice before completion; and
 - 19.1.2 in spite of any making of a claim or *requisition*, any attempt to satisfy a claim or *requisition*, any arbitration, litigation, mediation or negotiation or any giving or taking of possession.
- 19.2 *Normally*, if a *party* exercises a right to *rescind* expressly given by this contract or any *legislation* –
- 19.2.1 the deposit and any other money paid by the purchaser under this contract must be refunded;
 - 19.2.2 a *party* can claim for a reasonable adjustment if the purchaser has been in possession;
 - 19.2.3 a *party* can claim for damages, costs or expenses arising out of a breach of this contract; and
 - 19.2.4 a *party* will not otherwise be liable to pay the other *party* any damages, costs or expenses.

20 Miscellaneous

- 20.1 The *parties* acknowledge that anything stated in this contract to be attached was attached to this contract by the vendor before the purchaser signed it and is part of this contract.
- 20.2 Anything attached to this contract is part of this contract.
- 20.3 An area, bearing or dimension in this contract is only approximate.
- 20.4 If a *party* consists of 2 or more persons, this contract benefits and binds them separately and together.
- 20.5 A *party's solicitor* can receive any amount payable to the *party* under this contract or direct in writing that it is to be paid to another person.
- 20.6 A document under or relating to this contract is –
- 20.6.1 signed by a *party* if it is signed by the *party* or the *party's solicitor* (apart from a direction under clause 4.8 or clause 30.4);
 - 20.6.2 *served* if it is *served* by the *party* or the *party's solicitor*;
 - 20.6.3 *served* if it is *served* on the *party's solicitor*, even if the *party* has died or any of them has died;
 - 20.6.4 *served* if it is *served* in any manner provided in s170 of the Conveyancing Act 1919;
 - 20.6.5 *served* if it is sent by email or fax to the *party's solicitor*, unless in either case it is not received;
 - 20.6.6 *served* on a person if it (or a copy of it) comes into the possession of the person;
 - 20.6.7 *served* at the earliest time it is *served*, if it is *served* more than once; and
 - 20.6.8 *served* if it is provided to or by the *party's solicitor* or an *authorised Subscriber* by means of an *Electronic Workspace* created under clause 4. However, this does not apply to a notice making an obligation essential, or a notice of *rescission* or *termination*.
- 20.7 An obligation to pay an expense of another *party* of doing something is an obligation to pay –
- 20.7.1 if the *party* does the thing personally - the reasonable cost of getting someone else to do it; or
 - 20.7.2 if the *party* pays someone else to do the thing - the amount paid, to the extent it is reasonable.
- 20.8 Rights under clauses 4, 11, 13, 14, 17, 24, 30 and 31 continue after completion, whether or not other rights continue.
- 20.9 The vendor does not promise, represent or state that the purchaser has any cooling off rights.
- 20.10 The vendor does not promise, represent or state that any attached survey report is accurate or current.
- 20.11 A reference to any *legislation* (including any percentage or rate specified in *legislation*) is also a reference to any corresponding later *legislation*.
- 20.12 Each *party* must do whatever is necessary after completion to carry out the *party's* obligations under this contract.
- 20.13 Neither taking possession nor *servicing* a transfer of itself implies acceptance of the *property* or the title.

- 20.14 The details and information provided in this contract (for example, on pages 1 - 4) are, to the extent of each *party's* knowledge, true, and are part of this contract.
- 20.15 Where this contract provides for choices, a choice in BLOCK CAPITALS applies unless a different choice is marked.
- 20.16 Each *party* consents to –
- 20.16.1 any *party* signing this contract electronically; and
- 20.16.2 the making of this contract by the exchange of counterparts delivered by email, or by such other electronic means as may be agreed in writing by the *parties*.
- 20.17 Each *party* agrees that electronic signing by a *party* identifies that *party* and indicates that *party's* intention to be bound by this contract.

21 Time limits in these provisions

- 21.1 If the time for something to be done or to happen is not stated in these provisions, it is a reasonable time.
- 21.2 If there are conflicting times for something to be done or to happen, the latest of those times applies.
- 21.3 The time for one thing to be done or to happen does not extend the time for another thing to be done or to happen.
- 21.4 If the time for something to be done or to happen is the 29th, 30th or 31st day of a month, and the day does not exist, the time is instead the last day of the month.
- 21.5 If the time for something to be done or to happen is a day that is not a *business day*, the time is extended to the next *business day*, except in the case of clauses 2 and 3.2.
- 21.6 *Normally*, the time by which something must be done is fixed but not essential.

22 Foreign Acquisitions and Takeovers Act 1975

- 22.1 The purchaser promises that the Commonwealth Treasurer cannot prohibit and has not prohibited the transfer under the Foreign Acquisitions and Takeovers Act 1975.
- 22.2 This promise is essential and a breach of it entitles the vendor to *terminate*.

23 Strata or community title

• Definitions and modifications

- 23.1 This clause applies only if the land (or part of it) is a lot in a strata, neighbourhood, precinct or community scheme (or on completion is to be a lot in a scheme of that kind).
- 23.2 In this contract –
- 23.2.1 'change', in relation to a scheme, means –
- a registered or registrable change from by-laws set out in this contract;
 - a change from a development or management contract or statement set out in this contract; or
 - a change in the boundaries of common property;
- 23.2.2 'common property' includes association property for the scheme or any higher scheme;
- 23.2.3 'contribution' includes an amount payable under a by-law;
- 23.2.4 'information certificate' includes a certificate under s184 Strata Schemes Management Act 2015 and s171 Community Land Management Act 2021;
- 23.2.5 'interest notice' includes a strata interest notice under s22 Strata Schemes Management Act 2015 and an association interest notice under s20 Community Land Management Act 2021;
- 23.2.6 'normal expenses', in relation to an owners corporation for a scheme, means normal operating expenses usually payable from the administrative fund of an owners corporation for a scheme of the same kind;
- 23.2.7 'owners corporation' means the owners corporation or the association for the scheme or any higher scheme;
- 23.2.8 'the *property*' includes any interest in common property for the scheme associated with the lot; and
- 23.2.9 'special expenses', in relation to an owners corporation, means its actual, contingent or expected expenses, except to the extent they are –
- normal expenses;
 - due to fair wear and tear;
 - disclosed in this contract; or
 - covered by moneys held in the capital works fund.
- 23.3 Clauses 11, 14.8 and 18.4 do not apply to an obligation of the owners corporation, or to property insurable by it.
- 23.4 Clauses 14.4.2 and 14.6 apply but on a unit entitlement basis instead of an area basis.
- ### • Adjustments and liability for expenses
- 23.5 The *parties* must adjust under clause 14.1 –
- 23.5.1 a regular periodic contribution;
- 23.5.2 a contribution which is not a regular periodic contribution but is disclosed in this contract; and
- 23.5.3 on a unit entitlement basis, any amount paid by the vendor for a normal expense of the owners corporation to the extent the owners corporation has not paid the amount to the vendor.

- 23.6 If a contribution is not a regular periodic contribution and is not disclosed in this contract –
- 23.6.1 the vendor is liable for it if it was determined on or before the contract date, even if it is payable by instalments; and
- 23.6.2 the purchaser is liable for all contributions determined after the contract date.
- 23.7 The vendor must pay or allow to the purchaser on completion the amount of any unpaid contributions for which the vendor is liable under clause 23.6.1.
- 23.8 *Normally*, the purchaser cannot make a claim or *requisition* or *rescind* or *terminate* in respect of –
- 23.8.1 an existing or future actual, contingent or expected expense of the owners corporation;
- 23.8.2 a proportional unit entitlement of the lot or a relevant lot or former lot, apart from a claim under clause 6; or
- 23.8.3 a past or future change in the scheme or a higher scheme.
- 23.9 However, the purchaser can *rescind* if –
- 23.9.1 the special expenses of the owners corporation at the later of the contract date and the creation of the owners corporation when calculated on a unit entitlement basis (and, if more than one lot or a higher scheme is involved, added together), less any contribution paid by the vendor, are more than 1% of the price;
- 23.9.2 in the case of the lot or a relevant lot or former lot in a higher scheme, a proportional unit entitlement for the lot is disclosed in this contract but the lot has a different proportional unit entitlement at the contract date or at any time before completion;
- 23.9.3 a change before the contract date or before completion in the scheme or a higher scheme materially prejudices the purchaser and is not disclosed in this contract; or
- 23.9.4 a resolution is passed by the owners corporation before the contract date or before completion to give to the owners in the scheme for their consideration a strata renewal plan that has not lapsed at the contract date and there is not attached to this contract a strata renewal proposal or the strata renewal plan.
- **Notices, certificates and inspections**
- 23.10 Before completion, the purchaser must *serve* a copy of an interest notice addressed to the owners corporation and signed by the purchaser.
- 23.11 After completion, the purchaser must insert the date of completion in the interest notice and send it to the owners corporation.
- 23.12 The vendor can complete and send the interest notice as agent for the purchaser.
- 23.13 The vendor must *serve* at least 7 days before the date for completion, an information certificate for the lot, the scheme or any higher scheme which relates to a period in which the date for completion falls.
- 23.14 The purchaser does not have to complete earlier than 7 days after *service* of the information certificate and clause 21.3 does not apply to this provision. On completion the purchaser must pay the vendor the prescribed fee for the information certificate.
- 23.15 The vendor authorises the purchaser to apply for the purchaser's own information certificate.
- 23.16 The vendor authorises the purchaser to apply for and make an inspection of any record or other document in the custody or control of the owners corporation or relating to the scheme or any higher scheme.
- **Meetings of the owners corporation**
- 23.17 If a general meeting of the owners corporation is convened before completion –
- 23.17.1 if the vendor receives notice of it, the vendor must immediately notify the purchaser of it; and
- 23.17.2 after the expiry of any cooling off period, the purchaser can require the vendor to appoint the purchaser (or the purchaser's nominee) to exercise any voting rights of the vendor in respect of the lot at the meeting.

24 Tenancies

- 24.1 If a tenant has not made a payment for a period preceding or current at the *adjustment date* –
- 24.1.1 for the purposes of clause 14.2, the amount is to be treated as if it were paid; and
- 24.1.2 the purchaser assigns the debt to the vendor on completion and will if required give a further assignment at the vendor's expense.
- 24.2 If a tenant has paid in advance of the *adjustment date* any periodic payment in addition to rent, it must be adjusted as if it were rent for the period to which it relates.
- 24.3 If the *property* is to be subject to a tenancy on completion or is subject to a tenancy on completion –
- 24.3.1 the vendor authorises the purchaser to have any accounting records relating to the tenancy inspected and audited and to have any other document relating to the tenancy inspected;
- 24.3.2 the vendor must *serve* any information about the tenancy reasonably requested by the purchaser before or after completion; and
- 24.3.3 *normally*, the purchaser can claim compensation (before or after completion) if –
- a disclosure statement required by the Retail Leases Act 1994 was not given when required;
 - such a statement contained information that was materially false or misleading;
 - a provision of the lease is not enforceable because of a non-disclosure in such a statement; or
 - the lease was entered into in contravention of the Retail Leases Act 1994.

- 24.4 If the *property* is subject to a tenancy on completion –
- 24.4.1 the vendor must allow or transfer –
- any remaining bond money or any other security against the tenant's default (to the extent the security is transferable);
 - any money in a fund established under the lease for a purpose and compensation for any money in the fund or interest earned by the fund that has been applied for any other purpose; and
 - any money paid by the tenant for a purpose that has not been applied for that purpose and compensation for any of the money that has been applied for any other purpose;
- 24.4.2 if the security is not transferable, each *party* must do everything reasonable to cause a replacement security to issue for the benefit of the purchaser and the vendor must hold the original security on trust for the benefit of the purchaser until the replacement security issues;
- 24.4.3 the vendor must give to the purchaser –
- at least 2 *business days* before the date for completion, a proper notice of the transfer (an attornment notice) addressed to the tenant, to be held by the purchaser in escrow until completion;
 - any certificate given under the Retail Leases Act 1994 in relation to the tenancy;
 - a copy of any disclosure statement given under the Retail Leases Act 1994;
 - a copy of any document served on the tenant under the lease and written details of its service, if the document concerns the rights of the landlord or the tenant after completion; and
 - any document served by the tenant under the lease and written details of its service, if the document concerns the rights of the landlord or the tenant after completion;
- 24.4.4 the vendor must comply with any obligation to the tenant under the lease, to the extent it is to be complied with by completion; and
- 24.4.5 the purchaser must comply with any obligation to the tenant under the lease, to the extent that the obligation is disclosed in this contract and is to be complied with after completion.

25 Qualified title, limited title and old system title

- 25.1 This clause applies only if the land (or part of it) –
- 25.1.1 is under qualified, limited or old system title; or
- 25.1.2 on completion is to be under one of those titles.
- 25.2 The vendor must *serve* a proper abstract of title *within 7 days* after the contract date.
- 25.3 If an abstract of title or part of an abstract of title is attached to this contract or has been lent by the vendor to the purchaser before the contract date, the abstract or part is *served* on the contract date.
- 25.4 An abstract of title can be or include a list of documents, events and facts arranged (apart from a will or codicil) in date order, if the list in respect of each document –
- 25.4.1 shows its date, general nature, names of parties and any registration number; and
- 25.4.2 has attached a legible photocopy of it or of an official or registration copy of it.
- 25.5 An abstract of title –
- 25.5.1 must start with a good root of title (if the good root of title must be at least 30 years old, this means 30 years old at the contract date);
- 25.5.2 in the case of a leasehold interest, must include an abstract of the lease and any higher lease;
- 25.5.3 *normally*, need not include a Crown grant; and
- 25.5.4 need not include anything evidenced by the Register kept under the Real Property Act 1900.
- 25.6 In the case of land under old system title –
- 25.6.1 in this contract 'transfer' means conveyance;
- 25.6.2 the purchaser does not have to *serve* the transfer until after the vendor has *served* a proper abstract of title; and
- 25.6.3 each vendor must give proper covenants for title as regards that vendor's interest.
- 25.7 In the case of land under limited title but not under qualified title –
- 25.7.1 *normally*, the abstract of title need not include any document which does not show the location, area or dimensions of the land (for example, by including a metes and bounds description or a plan of the land);
- 25.7.2 clause 25.7.1 does not apply to a document which is the good root of title; and
- 25.7.3 the vendor does not have to provide an abstract if this contract contains a delimitation plan (whether in registrable form or not).
- 25.8 On completion the vendor must give the purchaser any *document of title* that relates only to the *property*.
- 25.9 If on completion the vendor has possession or control of a *document of title* that relates also to other property, the vendor must produce it as and where necessary.
- 25.10 The vendor must give a proper covenant to produce where relevant.
- 25.11 The vendor does not have to produce or covenant to produce a document that is not in the possession of the vendor or a mortgagee.
- 25.12 If the vendor is unable to produce an original document in the chain of title, the purchaser will accept a photocopy from the *Land Registry* of the registration copy of that document.

26 Crown purchase money

- 26.1 This clause applies only if purchase money is payable to the Crown, whether or not due for payment.
 26.2 The vendor is liable for the money, except to the extent this contract says the purchaser is liable for it.
 26.3 To the extent the vendor is liable for it, the vendor is liable for any interest until completion.
 26.4 To the extent the purchaser is liable for it, the *parties* must adjust any interest under clause 14.

27 Consent to transfer

- 27.1 This clause applies only if the land (or part of it) cannot be transferred without consent under *legislation* or a *planning agreement*.
 27.2 The purchaser must properly complete and then *serve* the purchaser's part of an application for consent to transfer of the land (or part of it) *within 7 days* after the contract date.
 27.3 The vendor must apply for consent *within 7 days* after *service* of the purchaser's part.
 27.4 If consent is refused, either *party* can *rescind*.
 27.5 If consent is given subject to one or more conditions that will substantially disadvantage a *party*, then that *party* can *rescind within 7 days* after receipt by or *service* upon the *party* of written notice of the conditions.
 27.6 If consent is not given or refused –
 27.6.1 *within 42 days* after the purchaser *serves* the purchaser's part of the application, the purchaser can *rescind*; or
 27.6.2 *within 30 days* after the application is made, either *party* can *rescind*.
 27.7 Each period in clause 27.6 becomes 90 days if the land (or part of it) is –
 27.7.1 under a *planning agreement*; or
 27.7.2 in the Western Division.
 27.8 If the land (or part of it) is described as a lot in an unregistered plan, each time in clause 27.6 becomes the later of the time and 35 days after creation of a separate folio for the lot.
 27.9 The date for completion becomes the later of the date for completion and 14 days after *service* of the notice granting consent to transfer.

28 Unregistered plan

- 28.1 This clause applies only if some of the land is described as a lot in an unregistered plan.
 28.2 The vendor must do everything reasonable to have the plan registered *within 6 months* after the contract date, with or without any minor alteration to the plan or any document to be lodged with the plan validly required or made under *legislation*.
 28.3 If the plan is not registered *within* that time and in that manner –
 28.3.1 the purchaser can *rescind*; and
 28.3.2 the vendor can *rescind*, but only if the vendor has complied with clause 28.2 and with any *legislation* governing the rescission.
 28.4 Either *party* can *serve* notice of the registration of the plan and every relevant lot and plan number.
 28.5 The date for completion becomes the later of the date for completion and 21 days after *service* of the notice.
 28.6 Clauses 28.2 and 28.3 apply to another plan that is to be registered before the plan is registered.

29 Conditional contract

- 29.1 This clause applies only if a provision says this contract or completion is conditional on an event.
 29.2 If the time for the event to happen is not stated, the time is 42 days after the contract date.
 29.3 If this contract says the provision is for the benefit of a *party*, then it benefits only that *party*.
 29.4 If anything is necessary to make the event happen, each *party* must do whatever is reasonably necessary to cause the event to happen.
 29.5 A *party* can *rescind* under this clause only if the *party* has substantially complied with clause 29.4.
 29.6 If the event involves an approval and the approval is given subject to a condition that will substantially disadvantage a *party* who has the benefit of the provision, the *party* can *rescind within 7 days* after either *party* *serves* notice of the condition.
 29.7 If the *parties* can lawfully complete without the event happening –
 29.7.1 if the event does not happen *within* the time for it to happen, a *party* who has the benefit of the provision can *rescind within 7 days* after the end of that time;
 29.7.2 if the event involves an approval and an application for the approval is refused, a *party* who has the benefit of the provision can *rescind within 7 days* after either *party* *serves* notice of the refusal; and
 29.7.3 the date for completion becomes the later of the date for completion and 21 days after the earliest of –
 • either *party* *serving* notice of the event happening;
 • every *party* who has the benefit of the provision *serving* notice waiving the provision; or
 • the end of the time for the event to happen.

- 29.8 If the *parties* cannot lawfully complete without the event happening –
- 29.8.1 if the event does not happen *within* the time for it to happen, either *party* can *rescind*;
- 29.8.2 if the event involves an approval and an application for the approval is refused, either *party* can *rescind*;
- 29.8.3 the date for completion becomes the later of the date for completion and 21 days after either *party* serves notice of the event happening.
- 29.9 A *party* cannot *rescind* under clauses 29.7 or 29.8 after the event happens.

30 Manual transaction

- 30.1 This clause applies if this transaction is to be conducted as a *manual transaction*.
- **Transfer**
- 30.2 *Normally*, the purchaser must *serve* the transfer at least 7 days before the date for completion.
- 30.3 If any information needed for the transfer is not disclosed in this contract, the vendor must *serve* it.
- 30.4 If the purchaser *serves* a transfer and the transferee is not the purchaser, the purchaser must give the vendor a direction signed by the purchaser personally for that transfer.
- 30.5 The vendor can require the purchaser to include a covenant or easement in the transfer only if this contract contains the wording of the proposed covenant or easement, and a description of the land burdened and benefited.
- **Place for completion**
- 30.6 *Normally*, the *parties* must complete at the completion address, which is –
- 30.6.1 if a special completion address is stated in this contract - that address; or
- 30.6.2 if none is stated, but a first mortgagee is disclosed in this contract and the mortgagee would usually discharge the mortgage at a particular place - that place; or
- 30.6.3 in any other case - the vendor's *solicitor's* address stated in this contract.
- 30.7 The vendor by reasonable notice can require completion at another place, if it is in NSW, but the vendor must pay the purchaser's additional expenses, including any agency or mortgagee fee.
- 30.8 If the purchaser requests completion at a place that is not the completion address, and the vendor agrees, the purchaser must pay the vendor's additional expenses, including any agency or mortgagee fee.
- **Payments on completion**
- 30.9 On completion the purchaser must pay to the vendor the amounts referred to in clauses 16.5.1 and 16.5.2, by cash (up to \$2,000) or *settlement cheque*.
- 30.10 *Normally*, the vendor can direct the purchaser to produce a *settlement cheque* on completion to pay an amount adjustable under this contract and if so –
- 30.10.1 the amount is to be treated as if it were paid; and
- 30.10.2 the *cheque* must be forwarded to the payee immediately after completion (by the purchaser if the *cheque* relates only to the *property* or by the vendor in any other case).
- 30.11 If the vendor requires more than 5 *settlement cheques*, the vendor must pay \$10 for each extra *cheque*.
- 30.12 If the purchaser must make a *GSTRW payment* the purchaser must –
- 30.12.1 produce on completion a *settlement cheque* for the *GSTRW payment* payable to the Deputy Commissioner of Taxation;
- 30.12.2 forward the *settlement cheque* to the payee immediately after completion; and
- 30.12.3 *serve* evidence of receipt of payment of the *GSTRW payment* and a copy of the settlement date confirmation form submitted to the Australian Taxation Office.
- 30.13 If the purchaser must pay an *FRCGW remittance*, the purchaser must –
- 30.13.1 produce on completion a *settlement cheque* for the *FRCGW remittance* payable to the Deputy Commissioner of Taxation;
- 30.13.2 forward the *settlement cheque* to the payee immediately after completion; and
- 30.13.3 *serve* evidence of receipt of payment of the *FRCGW remittance*.

31 Foreign Resident Capital Gains Withholding

- 31.1 This clause applies only if –
- 31.1.1 the sale is not an excluded transaction within the meaning of s14-215 of Schedule 1 to the *TA Act*, and
- 31.1.2 a *clearance certificate* in respect of every vendor is not attached to this contract.
- 31.2 If the vendor *serves* any *clearance certificate* or *variation*, the purchaser does not have to complete earlier than 5 *business days* after that *service* and clause 21.3 does not apply to this provision.
- 31.3 The purchaser must at least 2 *business days* before the date for completion, *serve* evidence of submission of a purchaser payment notification to the Australian Taxation Office by the purchaser or, if a direction under either clause 4.8 or clause 30.4 has been given, by the transferee named in the transfer the subject of that direction.
- 31.4 The vendor cannot refuse to complete if the purchaser complies with clause 31.3 and, as applicable, clauses 4.10 or 30.13.
- 31.5 If the vendor *serves* in respect of every vendor either a *clearance certificate* or a *variation* to 0.00 percent, clauses 31.3 and 31.4 do not apply.

32 Residential off the plan contract

- 32.1 This clause applies if this contract is an off the plan contract within the meaning of Division 10 of Part 4 of the Conveyancing Act 1919 (the Division).
- 32.2 No provision of this contract has the effect of excluding, modifying or restricting the operation of the Division.
- 32.3 If the purchaser makes a claim for compensation under the terms prescribed by sections 4 to 6 of Schedule 3 to the Conveyancing (Sale of Land) Regulation 2022 –
- 32.3.1 the purchaser cannot make a claim under this contract about the same subject matter, including a claim under clauses 6 or 7; and
 - 32.3.2 the claim for compensation is not a claim under this contract.

69A The Esplanade, Frenchs Forest NSW

CONDITIONS OF SALE BY AUCTION

If the *property* is or is intended to be sold at auction:

Bidders Record means the Bidders Record to be kept pursuant to Clause 18 of the *Property, Stock and Business Agents Regulation 2003* and Section 68 of the *Property, Stock and Business Agents Act 2002*:

- (1) The following conditions are prescribed as applicable to and in respect of the sale by auction of land:
 - (a) The principal's reserve price must be given in writing to the auctioneer before the auction commences.
 - (b) A bid for the seller cannot be made unless the auctioneer has, before the commencement of the auction, announced clearly and precisely the number of bids that may be made by or on behalf of the seller.
 - (c) The highest bidder is the purchaser, subject to any reserve price.
 - (d) In the event of a disputed bid, the auctioneer is the sole arbitrator and the auctioneer's decision is final.
 - (e) The auctioneer may refuse to accept any bid that, in the auctioneer's opinion, is not in the best interests of the seller.
 - (f) A bidder is taken to be a principal unless, before bidding, the bidder has given to the auctioneer a copy of a written authority to bid for or on behalf of another person.
 - (g) A bid cannot be made or accepted after the fall of the hammer.
 - (h) As soon as practicable after the fall of the hammer the purchaser is to sign the agreement (if any) for sale.

- (2) The following conditions, in addition to those prescribed by subclause (1), are prescribed as applicable to and in respect of the sale by auction of residential property or rural land:
 - (a) All bidders must be registered in the Bidders Record and display an identifying number when making a bid.
 - (b) One bid only may be made by or on behalf of the seller. This includes a bid made by the auctioneer on behalf of the seller.
 - (c) When making a bid on behalf of the seller or accepting a bid made by or on behalf of the seller, the auctioneer must clearly state that the bid was made by or on behalf of the seller or auctioneer.

SPECIAL CONDITIONS

33. **AMENDMENTS TO PRINTED PROVISIONS**

The printed provisions of this contract are amended as follows:-

- 33.1. Clause 7.1.1, delete the word “5%” and substitute the word “2.5%”;
- 33.2. Clause 10.1.9, delete the word “substance” and substitute the word “existence”.
- 33.3. Clause 14.4.2, delete the words “if the land (or part of it) had no separate taxable value, by calculating its separate taxable value on a proportional area basis”;

34. **ACKNOWLEDGMENTS BY PURCHASER**

34.1. Defects

The Purchaser acknowledges that the property is sold in its present condition and state of repair and subject to all dilapidation, infestation, faults, and defects of quality therein both latent and patent and the Purchaser shall raise no objection, requisition, rescission, termination or claim for compensation in respect of any such matters.

34.2. Repairs

The Purchaser cannot require the Vendor to carry out any repairs or works to the property nor delay completion due to the condition or state of repair of the property.

34.3. Representations

The Purchaser acknowledges that he has not entered into this contract as a result of any representation or warranty (except as may implied by law), made by the Vendor or any one on behalf of the Vendor other than as expressly set out in this contract and has made all such investigations and enquiries as he deems appropriate and that this contract contains the whole of the agreement between the parties with respect to the sale of the property.

35. **INCAPACITY OF A PARTY**

35.1. If either party being a natural person (or, if more than one person, any one or more of them), before completion:-

- 35.1.1. dies;
- 35.1.2. is found by a court or tribunal to be incapable of administering his or her estate or affairs;
- 35.1.3. commits an act of bankruptcy; or
- 35.1.4. is declared bankrupt;

then the other party may rescind.

35.2. If either party being a company (or, if more than one company any one or more of them), before completion:-

- 35.2.1. resolves to go into liquidation;
- 35.2.2. has an order made for its winding up;
- 35.2.3. enters into a scheme of arrangement with its creditors; or
- 35.2.4. has an official manager or receiver appointed over the whole or any part of its assets or undertaking.

then the other party may rescind.

36. VENDOR'S AGENT

- 36.1. The Purchaser warrants that he was not introduced directly or indirectly to either the Vendor or the property by a person other than the Vendor's agent (if any).
- 36.2. The Purchaser indemnifies the Vendor against any claim or demand for sales commission or other remuneration by any person other than the Vendor's agent arising from a breach of the Purchaser's warranty under clause 36.1. This clause will continue to apply after completion.

37. NOTICE TO COMPLETE

A party entitled to serve a notice to complete may serve a notice requiring completion on a day being not less than 14 days after the date of service of the notice. The notice will be (both at law and in equity) sufficient notice to make time of the essence of this contract even if the party serving the notice has not made any previous request or demand for completion.

38. INTEREST AND COSTS ON DEFAULT

- 38.1. If as a result of default by the Purchaser, completion does not take place on or before the completion date the Purchaser must pay the Vendor interest at the rate of 10% per annum on the balance of the price.
- 38.2. Interest payable under this clause shall be calculated from the day after the completion date until the date completion actually takes place (both dates inclusive).
- 38.3. Payment of interest under this clause does not affect any other rights the Vendor may have under this contract.
- 38.4. Should any delay in completion be caused solely or in part by the Vendor then the Vendor shall still be entitled to such interest but only from a date 3 working days after the Vendor notifies the Purchaser that it is ready, willing and able to complete this contract.
- 38.5. It is an essential provision of this contract that the interest (and any legal costs payable pursuant to clause 38.1) be paid on completion.
- 38.6. The Purchaser acknowledges that interest at the rate of 10% per annum is a genuine pre-estimate of the liquidated damages likely to be suffered by the Vendor as a result of completion not taking place on or before the completion date.
- 38.7. If the Vendor issues a notice to complete to the Purchaser, then in addition to any other amount payable under this contract the Purchaser shall pay the Vendor the sum of \$250.00 (including GST) to cover the Vendor's legal costs of issuing such notice.

39. INTEREST ON DEPOSIT

Despite printed provision 2.9, if this contract is rescinded or terminated, the depositholder is to pay all the interest earned on the deposit to the party entitled to the deposit, after deduction of all proper government taxes or financial institution charges or other charges.

40. ATTACHED DOCUMENTS

The Purchaser shall not be entitled to raise any objection, requisition, rescission, termination or claim for compensation in respect of any matter disclosed in any of the documents attached to this contract.

41. **SERVICES**

No objection, rescission, termination, requisition or claim for compensation shall be made by the Purchaser in respect of any of the following matters:-

- 41.1. any existing gas, electricity or telephone service to the property;
- 41.2. the presence on the property of any gas pipes, electricity wires or telephone wires;
- 41.3. any mains or pipes of any water (including storm water), sewerage or drainage authority passing through the property or any proposal for the same;
- 41.4. the presence of any sewer, manhole or vent on the property.

42. **SURVEY REPORT**

- 42.1. If a survey report of the property is annexed to the contract the Vendor gives no warranty as to the accuracy, correctness or completeness of the report.
- 42.2. The Purchaser shall make and rely on his own independent enquiries relative to survey and shall have no right of objection, requisition, rescission, termination or claim for compensation relative to any matters pertaining to or arising out of survey, including (but without limitation) the position of the improvements on the land and compliance with the relevant Local Government boundary setback requirements.

43. **CONFLICTS**

If there is any conflict between these special conditions and clauses 1-32 of this contract, these special conditions shall prevail.

44. **INVEST DEPOSIT**

- 44.1. The Parties hereby authorise and direct the depositholder to invest the deposit. The parties agree to provide their respective tax file numbers to the depositholder within 7 days of the date herein.
- 44.2. The Parties entitled to receipt of such interest bear the risk in respect of such investment and in respect of the loss of any interest and the vendor and the depositholder will not be liable for any loss.

45. **ENCUMBRANCES**

The Purchaser shall not be entitled to require the Vendor to register a discharge of any mortgage or charge, or withdrawal of any caveat, affecting the property but will accept on settlement a properly executed discharge of any mortgage or charge, or a withdrawal of any caveat in registrable form regarding the property together with the appropriate lodgment fee.

46. **REDUCED DEPOSIT**

Notwithstanding the provisions of standard condition 2 of this contract, if the vendor accepts a payment representing 5% of the purchase price on exchange of contracts, the deposit shall be payable as follows:

- a) As to 5% on or before exchange of contracts and
- b) As to the balance of the 10% deposit, on the completion date.

In the event that either of the payments referred to above are not paid by the date required, then provisions of clause 2.5 hereof shall apply.

In the event of default by the purchaser resulting in the termination of this contract and in the event that the deposit is forfeitable to the vendor, the balance of the 10% deposit, then not held by the depositholder, shall be recoverable by the vendor from the purchaser as a liquidated debt.

47. **NO SEWERAGE SERVICE DIAGRAM**

The purchaser acknowledges that there is no sewerage service diagram available for the property and the purchaser will make no objection, requisition or claim for compensation or rescind in respect thereof.



NEW SOUTH WALES LAND REGISTRY SERVICES - TITLE SEARCH

FOLIO: 131/866473

| SEARCH DATE | TIME | EDITION NO | DATE |
|-------------|---------|------------|-----------|
| 6/2/2024 | 2:07 PM | 4 | 17/9/2004 |

LAND

LOT 131 IN DEPOSITED PLAN 866473
AT FRENCHS FOREST
LOCAL GOVERNMENT AREA NORTHERN BEACHES
PARISH OF MANLY COVE COUNTY OF CUMBERLAND
TITLE DIAGRAM DP866473

FIRST SCHEDULE

PETER FRANCIS DEAN (T AA962153)

SECOND SCHEDULE (10 NOTIFICATIONS)

- 1 RESERVATIONS AND CONDITIONS IN THE CROWN GRANT(S)
- 2 M927069 COVENANT
- 3 EASEMENT(S) APPURTENANT TO THE LAND ABOVE DESCRIBED CREATED BY:
DP812623 -EASEMENT TO DRAIN WATER 3 WIDE
DP816033 -EASEMENT TO DRAIN WATER 1 WIDE
- 4 DP812623 RESTRICTION(S) ON THE USE OF LAND
- 5 DP816033 RESTRICTION(S) ON THE USE OF LAND
- 6 CROSS EASEMENTS FOR PARTY WALLS (S.88BB CONVEYANCING ACT, 1919)
AFFECTING THE PARTY WALL(S) SHOWN IN THE TITLE DIAGRAM
- 7 DP866473 RIGHT OF CARRIAGEWAY VARIABLE WIDTH AFFECTING THE
PART(S) SHOWN SO BURDENED IN THE TITLE DIAGRAM
- 8 DP866473 RIGHT OF CARRIAGEWAY VARIABLE WIDTH APPURTENANT TO
THE LAND ABOVE DESCRIBED
- 9 DP866473 EASEMENT TO DRAIN WATER 1 WIDE AFFECTING THE PART(S)
SHOWN SO BURDENED IN THE TITLE DIAGRAM
- 10 DP866473 POSITIVE COVENANT

NOTATIONS

UNREGISTERED DEALINGS: NIL

*** END OF SEARCH ***

op10300018

PRINTED ON 6/2/2024

PLAN FORM 2

SIGNATURE AND SEALS ONLY

Plan Drawing only to appear in this space

OFFICE USE ONLY

| SURVEY PRACTICE REGULATION 1994 - CLAUSE 32 (2) | | I.S.G. COORDINATES | | ZONE | ACC. |
|---|------------|--------------------|------|------|------|
| MARK | EASTING | NORTHING | | | |
| SSM 73175 | 321351.379 | 1265114.788 | 56/1 | 2 | |
| SSM 11047 | 321244.330 | 1265185.738 | 56/1 | 2 | |
| SSM 88674 | 321431.185 | 1265215.777 | 56/1 | 2 | |

SOURCE: I.S.G. COORDINATES ADOPTED FROM L.I.C.
 AT 4-4-96

SCALE FACTOR USED 0.99993

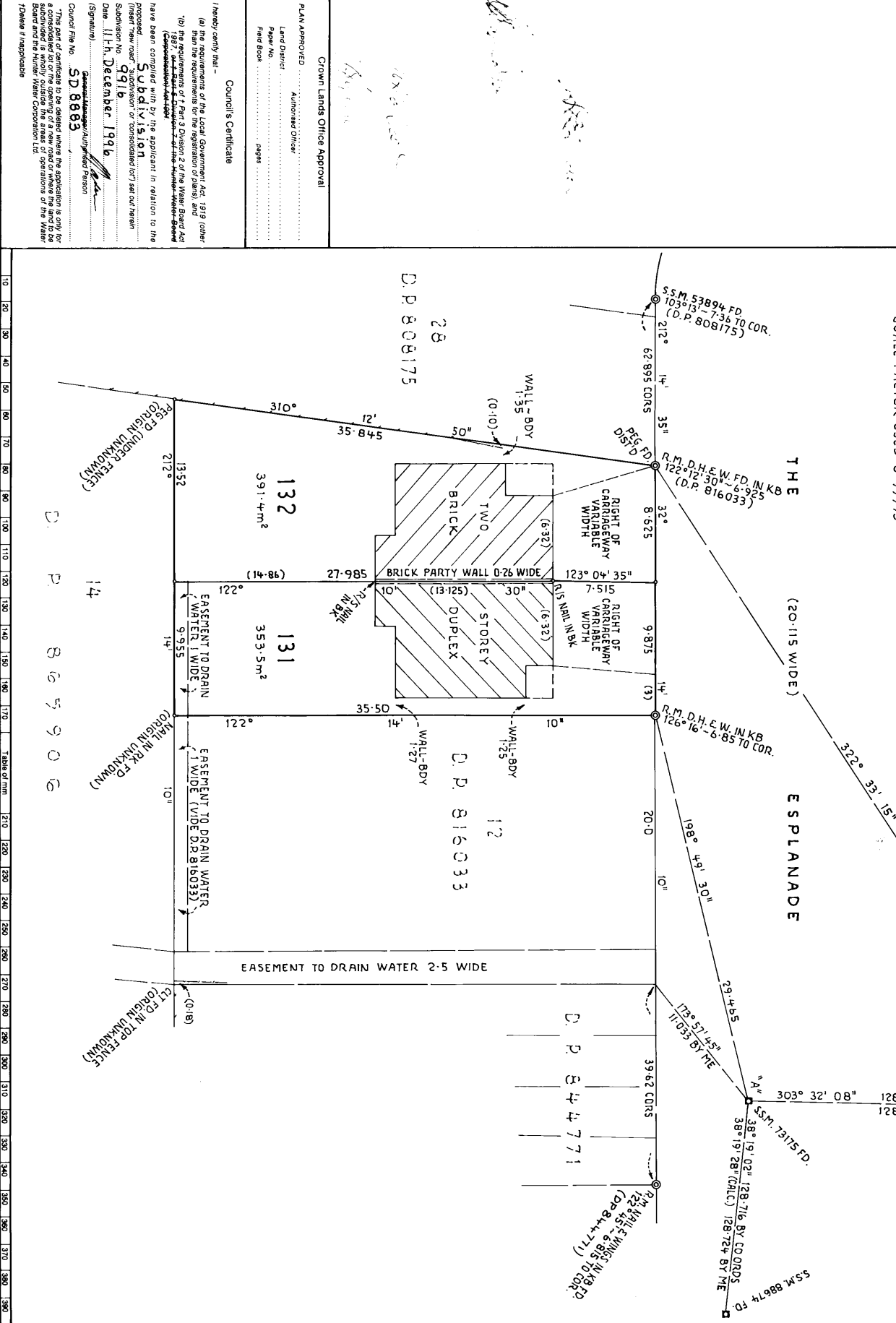

DP 866473

Registered AT 27-2-1997
 CA No 9916 OF 11/2/1996

Title System: TORRENS
 Purpose: SUBDIVISION
 Field Map: U1860-2
 Lab Plan: DP816033

PLAN OF SUBDIVISION OF LOT 13 IN D.P. 816033

Lengths are in metres. Reduction Ratio: 200

LGA: WARRINGAH
 Locality: FRENCHS FOREST
 Parish: MANLY COVE
 County: CUMBERLAND

This is a ~~technical~~ plan in sheets

1. GREGORY ROY SNEALLIE
 of HORNSBY
 a solicitor, certify that the survey represented in this plan is accurate and has been made in accordance with the Survey Practice Regulation 1990 and was completed on 9 APRIL 1996

(Signature) _____
 (Delete if inappropriate)

Datum: Line of Approx. "A" "B" "C" "D" "E" "F" "G" "H" "I" "J" "K" "L" "M" "N" "O" "P" "Q" "R" "S" "T" "U" "V" "W" "X" "Y" "Z" (I.S.G. ORIENTATION)

Plans used in preparation of survey/compilation
 D.P. 816033
 D.P. 844771
 D.P. 808175

PANEL FOR USE ONLY for statements of intention to dedicate public roads, to create public reserves, drainage reserves, easements, restrictions on the use of land or positive covenants.

PURSUANT TO SECTION 88B OF THE GOVERNMENT TITLES ACT 1919, I HEREBY INTEND TO CREATE:

1. RIGHT OF CARRIAGEWAY VARIABLE WIDTH
2. EASEMENT TO DRAIN WATER 1 WIDE
3. POSITIVE COVENANT

Card as to _____

Crown Lands Office Approval

PLANNING APPROVED: Authorised Officer

Land District: _____

Paper No: _____

Field Book: _____

pages: _____

Council's Certificate

I hereby certify that -

(a) the requirements of the Local Government Act, 1919 (other than the requirements of Part 3 Division 2 of the Water Board Act (Consolidation) 1919-1920)

(b) the requirements of Part 3 Division 2 of the Water Board Act (Consolidation) 1919-1920

have been complied with by the applicant in relation to the proposed Subdivision

Subdivision No. 9916

Date 11th December 1996

(Signature) _____
 General Manager/Authorised Person

Council File No. SD 88683

*This part of certificate is to be deleted where the application is only for a subdivided lot or the opening of a new road or where the land to be surveyed is wholly outside the areas of operations of the Water Board and the Water Board Corporation Ltd

To be deleted if inapplicable

PLAN FORM 2

PLAN DRAWING ONLY TO APPEAR IN THIS SPACE

OFFICE USE ONLY

PLAN OF SUBDIVISION OF LOT 13 IN D.P. 816033

Lengths are in metres. Reduction Ratio: 200

LGA: WARRINGAH
 Locality: FRENCHS FOREST
 Parish: MANLY COVE
 County: CUMBERLAND

This is a ~~technical~~ plan in sheets

Datum: Line of Approx. "A" "B" "C" "D" "E" "F" "G" "H" "I" "J" "K" "L" "M" "N" "O" "P" "Q" "R" "S" "T" "U" "V" "W" "X" "Y" "Z" (I.S.G. ORIENTATION)

Plans used in preparation of survey/compilation
 D.P. 816033
 D.P. 844771
 D.P. 808175

PANEL FOR USE ONLY for statements of intention to dedicate public roads, to create public reserves, drainage reserves, easements, restrictions on the use of land or positive covenants.

PURSUANT TO SECTION 88B OF THE GOVERNMENT TITLES ACT 1919, I HEREBY INTEND TO CREATE:

1. RIGHT OF CARRIAGEWAY VARIABLE WIDTH
2. EASEMENT TO DRAIN WATER 1 WIDE
3. POSITIVE COVENANT

Card as to _____

PLAN FORM 2

PLAN DRAWING ONLY TO APPEAR IN THIS SPACE

OFFICE USE ONLY

PLAN OF SUBDIVISION OF LOT 13 IN D.P. 816033

Lengths are in metres. Reduction Ratio: 200

LGA: WARRINGAH
 Locality: FRENCHS FOREST
 Parish: MANLY COVE
 County: CUMBERLAND

This is a ~~technical~~ plan in sheets

Datum: Line of Approx. "A" "B" "C" "D" "E" "F" "G" "H" "I" "J" "K" "L" "M" "N" "O" "P" "Q" "R" "S" "T" "U" "V" "W" "X" "Y" "Z" (I.S.G. ORIENTATION)

Plans used in preparation of survey/compilation
 D.P. 816033
 D.P. 844771
 D.P. 808175

PANEL FOR USE ONLY for statements of intention to dedicate public roads, to create public reserves, drainage reserves, easements, restrictions on the use of land or positive covenants.

PURSUANT TO SECTION 88B OF THE GOVERNMENT TITLES ACT 1919, I HEREBY INTEND TO CREATE:

1. RIGHT OF CARRIAGEWAY VARIABLE WIDTH
2. EASEMENT TO DRAIN WATER 1 WIDE
3. POSITIVE COVENANT

Card as to _____

PLAN FORM 2

PLAN DRAWING ONLY TO APPEAR IN THIS SPACE

OFFICE USE ONLY

PLAN OF SUBDIVISION OF LOT 13 IN D.P. 816033

Lengths are in metres. Reduction Ratio: 200

LGA: WARRINGAH
 Locality: FRENCHS FOREST
 Parish: MANLY COVE
 County: CUMBERLAND

This is a ~~technical~~ plan in sheets

Datum: Line of Approx. "A" "B" "C" "D" "E" "F" "G" "H" "I" "J" "K" "L" "M" "N" "O" "P" "Q" "R" "S" "T" "U" "V" "W" "X" "Y" "Z" (I.S.G. ORIENTATION)

Plans used in preparation of survey/compilation
 D.P. 816033
 D.P. 844771
 D.P. 808175

PANEL FOR USE ONLY for statements of intention to dedicate public roads, to create public reserves, drainage reserves, easements, restrictions on the use of land or positive covenants.

PURSUANT TO SECTION 88B OF THE GOVERNMENT TITLES ACT 1919, I HEREBY INTEND TO CREATE:

1. RIGHT OF CARRIAGEWAY VARIABLE WIDTH
2. EASEMENT TO DRAIN WATER 1 WIDE
3. POSITIVE COVENANT

Card as to _____

PLAN FORM 2

PLAN DRAWING ONLY TO APPEAR IN THIS SPACE

OFFICE USE ONLY

PLAN OF SUBDIVISION OF LOT 13 IN D.P. 816033

Lengths are in metres. Reduction Ratio: 200

LGA: WARRINGAH
 Locality: FRENCHS FOREST
 Parish: MANLY COVE
 County: CUMBERLAND

This is a ~~technical~~ plan in sheets

Datum: Line of Approx. "A" "B" "C" "D" "E" "F" "G" "H" "I" "J" "K" "L" "M" "N" "O" "P" "Q" "R" "S" "T" "U" "V" "W" "X" "Y" "Z" (I.S.G. ORIENTATION)

Plans used in preparation of survey/compilation
 D.P. 816033
 D.P. 844771
 D.P. 808175

PANEL FOR USE ONLY for statements of intention to dedicate public roads, to create public reserves, drainage reserves, easements, restrictions on the use of land or positive covenants.

PURSUANT TO SECTION 88B OF THE GOVERNMENT TITLES ACT 1919, I HEREBY INTEND TO CREATE:

1. RIGHT OF CARRIAGEWAY VARIABLE WIDTH
2. EASEMENT TO DRAIN WATER 1 WIDE
3. POSITIVE COVENANT

Card as to _____

PLAN FORM 2

PLAN DRAWING ONLY TO APPEAR IN THIS SPACE

OFFICE USE ONLY

PLAN OF SUBDIVISION OF LOT 13 IN D.P. 816033

Lengths are in metres. Reduction Ratio: 200

LGA: WARRINGAH
 Locality: FRENCHS FOREST
 Parish: MANLY COVE
 County: CUMBERLAND

This is a ~~technical~~ plan in sheets

Datum: Line of Approx. "A" "B" "C" "D" "E" "F" "G" "H" "I" "J" "K" "L" "M" "N" "O" "P" "Q" "R" "S" "T" "U" "V" "W" "X" "Y" "Z" (I.S.G. ORIENTATION)

Plans used in preparation of survey/compilation
 D.P. 816033
 D.P. 844771
 D.P. 808175

PANEL FOR USE ONLY for statements of intention to dedicate public roads, to create public reserves, drainage reserves, easements, restrictions on the use of land or positive covenants.

PURSUANT TO SECTION 88B OF THE GOVERNMENT TITLES ACT 1919, I HEREBY INTEND TO CREATE:

1. RIGHT OF CARRIAGEWAY VARIABLE WIDTH
2. EASEMENT TO DRAIN WATER 1 WIDE
3. POSITIVE COVENANT

Card as to _____

PLAN FORM 2

PLAN DRAWING ONLY TO APPEAR IN THIS SPACE

OFFICE USE ONLY

PLAN OF SUBDIVISION OF LOT 13 IN D.P. 816033

Lengths are in metres. Reduction Ratio: 200

LGA: WARRINGAH
 Locality: FRENCHS FOREST
 Parish: MANLY COVE
 County: CUMBERLAND

This is a ~~technical~~ plan in sheets

Datum: Line of Approx. "A" "B" "C" "D" "E" "F" "G" "H" "I" "J" "K" "L" "M" "N" "O" "P" "Q" "R" "S" "T" "U" "V" "W" "X" "Y" "Z" (I.S.G. ORIENTATION)

Plans used in preparation of survey/compilation
 D.P. 816033
 D.P. 844771
 D.P. 808175

PANEL FOR USE ONLY for statements of intention to dedicate public roads, to create public reserves, drainage reserves, easements, restrictions on the use of land or positive covenants.

PURSUANT TO SECTION 88B OF THE GOVERNMENT TITLES ACT 1919, I HEREBY INTEND TO CREATE:

1. RIGHT OF CARRIAGEWAY VARIABLE WIDTH
2. EASEMENT TO DRAIN WATER 1 WIDE
3. POSITIVE COVENANT

Card as to _____

PLAN FORM 2

PLAN DRAWING ONLY TO APPEAR IN THIS SPACE

OFFICE USE ONLY

PLAN OF SUBDIVISION OF LOT 13 IN D.P. 816033

Lengths are in metres. Reduction Ratio: 200

LGA: WARRINGAH
 Locality: FRENCHS FOREST
 Parish: MANLY COVE
 County: CUMBERLAND

This is a ~~technical~~ plan in sheets

Datum: Line of Approx. "A" "B" "C" "D" "E" "F" "G" "H" "I" "J" "K" "L" "M" "N" "O" "P" "Q" "R" "S" "T" "U" "V" "W" "X" "Y" "Z" (I.S.G. ORIENTATION)

Plans used in preparation of survey/compilation
 D.P. 816033
 D.P. 844771
 D.P. 808175

PANEL FOR USE ONLY for statements of intention to dedicate public roads, to create public reserves, drainage reserves, easements, restrictions on the use of land or positive covenants.

PURSUANT TO SECTION 88B OF THE GOVERNMENT TITLES ACT 1919, I HEREBY INTEND TO CREATE:

1. RIGHT OF CARRIAGEWAY VARIABLE WIDTH
2. EASEMENT TO DRAIN WATER 1 WIDE
3. POSITIVE COVENANT

Card as to _____

PLAN FORM 2

PLAN DRAWING ONLY TO APPEAR IN THIS SPACE

OFFICE USE ONLY

PLAN OF SUBDIVISION OF LOT 13 IN D.P. 816033

Lengths are in metres. Reduction Ratio: 200

LGA: WARRINGAH
 Locality: FRENCHS FOREST
 Parish: MANLY COVE
 County: CUMBERLAND

This is a ~~technical~~ plan in sheets

Datum: Line of Approx. "A" "B" "C" "D" "E" "F" "G" "H" "I" "J" "K" "L" "M" "N" "O" "P" "Q" "R" "S" "T" "U" "V" "W" "X" "Y" "Z" (I.S.G. ORIENTATION)

Plans used in preparation of survey/compilation
 D.P. 816033
 D.P. 844771
 D.P. 808175

PANEL FOR USE ONLY for statements of intention to dedicate public roads, to create public reserves, drainage reserves, easements, restrictions on the use of land or positive covenants.

PURSUANT TO SECTION 88B OF THE GOVERNMENT TITLES ACT 1919, I HEREBY INTEND TO CREATE:

1. RIGHT OF CARRIAGEWAY VARIABLE WIDTH
2. EASEMENT TO DRAIN WATER 1 WIDE
3. POSITIVE COVENANT

Card as to _____

PLAN FORM 2

PLAN DRAWING ONLY TO APPEAR IN THIS SPACE

OFFICE USE ONLY

PLAN OF SUBDIVISION OF LOT 13 IN D.P. 816033

Lengths are in metres. Reduction Ratio: 200

LGA: WARRINGAH
 Locality: FRENCHS FOREST
 Parish: MANLY COVE
 County: CUMBERLAND

This is a ~~technical~~ plan in sheets

Datum: Line of Approx. "A" "B" "C" "D" "E" "F" "G" "H" "I" "J" "K" "L" "M" "N" "O" "P" "Q" "R" "S" "T" "U" "V" "W" "X" "Y" "Z" (I.S.G. ORIENTATION)

Plans used in preparation of survey/compilation
 D.P. 816033
 D.P. 844771
 D.P. 808175

PANEL FOR USE ONLY for statements of intention to dedicate public roads, to create public reserves, drainage reserves, easements, restrictions on the use of land or positive covenants.

PURSUANT TO SECTION 88B OF THE GOVERNMENT TITLES ACT 1919, I HEREBY INTEND TO CREATE:

1. RIGHT OF CARRIAGEWAY VARIABLE WIDTH
2. EASEMENT TO DRAIN WATER 1 WIDE
3. POSITIVE COVENANT

Card as to _____

PLAN FORM 2

PLAN DRAWING ONLY TO APPEAR IN THIS SPACE

OFFICE USE ONLY

PLAN OF SUBDIVISION OF LOT 13 IN D.P. 816033

Lengths are in metres. Reduction Ratio: 200

LGA: WARRINGAH
 Locality: FRENCHS FOREST
 Parish: MANLY COVE
 County: CUMBERLAND

This is a ~~technical~~ plan in sheets

Datum: Line of Approx. "A" "B" "C" "D" "E" "F" "G" "H" "I" "J" "K" "L" "M" "N" "O" "P" "Q" "R" "S" "T" "U" "V" "W" "X" "Y" "Z" (I.S.G. ORIENTATION)

Plans used in preparation of survey/compilation
 D.P. 816033
 D.P. 844771
 D.P. 808175

PANEL FOR USE ONLY for statements of intention to dedicate public roads, to create public reserves, drainage reserves, easements, restrictions on the use of land or positive covenants.

PURSUANT TO SECTION 88B OF THE GOVERNMENT TITLES ACT 1919, I HEREBY INTEND TO CREATE:

1. RIGHT OF CARRIAGEWAY VARIABLE WIDTH
2. EASEMENT TO DRAIN WATER 1 WIDE
3. POSITIVE COVENANT

Card as to _____

PLAN FORM 2

PLAN DRAWING ONLY TO APPEAR IN THIS SPACE

OFFICE USE ONLY

PLAN OF SUBDIVISION OF LOT 13 IN D.P. 816033

Lengths are in metres. Reduction Ratio: 200

LGA: WARRINGAH
 Locality: FRENCHS FOREST
 Parish: MANLY COVE
 County: CUMBERLAND

This is a ~~technical~~ plan in sheets

Datum: Line of Approx. "A" "B" "C" "D" "E" "F" "G" "H" "I" "J" "K" "L" "M" "N" "O" "P" "Q" "R" "S" "T" "U" "V" "W" "X" "Y" "Z" (I.S.G. ORIENTATION)

Plans used in preparation of survey/compilation
 D.P. 816033
 D.P. 844771
 D.P. 808175

PANEL FOR USE ONLY for statements of intention to dedicate public roads, to create public reserves, drainage reserves, easements, restrictions on the use of land or positive covenants.

PURSUANT TO SECTION 88B OF THE GOVERNMENT TITLES ACT 1919, I HEREBY INTEND TO CREATE:

1. RIGHT OF CARRIAGEWAY VARIABLE WIDTH
2. EASEMENT TO DRAIN WATER 1 WIDE
3. POSITIVE COVENANT

Card as to _____

PLAN FORM 2

PLAN DRAWING ONLY TO APPEAR IN THIS SPACE

OFFICE USE ONLY

PLAN OF SUBDIVISION OF LOT 13 IN D.P. 816033

Lengths are in metres. Reduction Ratio: 200

LGA: WARRINGAH
 Locality: FRENCHS FOREST
 Parish: MANLY COVE
 County: CUMBERLAND

This is a ~~technical~~ plan in sheets

Datum: Line of Approx. "A" "B" "C" "D" "E" "F" "G" "H" "I" "J" "K" "L" "M" "N" "O" "P" "Q" "R" "S" "T" "U" "V" "W" "X" "Y" "Z" (I.S.G. ORIENTATION)

Plans used in preparation of survey/compilation
 D.P. 816033
 D.P. 844771
 D.P. 808175

PANEL FOR USE ONLY for statements of intention to dedicate public roads, to create public reserves, drainage reserves, easements, restrictions on the use of land or positive covenants.

PURSUANT TO SECTION 88B OF THE GOVERNMENT TITLES ACT 1919, I HEREBY INTEND TO CREATE:

"A"

THIS IS THE ANNEXURE MARKED "A" REFERRED TO IN MEMORANDUM OF TRANSFER BETWEEN REAL PROPERTY IMPROVEMENTS PTY LIMITED AS TRANSFEROR AND CAMPBELL MATTHEW EARL AS TRANSFEREE DATED 29th DAY OF September 1972

A N D the Transferee covenants with the Transferor its successors and assigns for the benefit of any adjoining land owned by the Transferor but only during the ownership thereof by the Transferor its successors and assigns other than the purchasers on sale that no fence shall be erected on the land hereby transferred to divide it from any such adjoining land without the consent of the Transferor its successors or assigns but such consent shall not be withheld if such fence is erected without expense to the Transferor its successors or assigns and in favour of any person dealing with the Transferee or his assigns such consent shall be deemed to have been given in respect of every such fence for the time being erected, and for the purpose of Section 88 of the Conveyancing Act it is hereby agreed and declared that :

- (i) the land to which the benefit of the above covenant is intended to be appurtenant is Lot 5 in Deposited Plan Number 239326.
- (ii) the land which is to be subject to the burden of the above covenant is the land hereby transferred.
- (iii) the above covenant may be released varied or modified by or with the consent of Real Property Improvements Pty Limited.

THE COMMON SEAL of REAL PROPERTY IMPROVEMENTS PTY LIMITED was hereunto affixed in the presence of:

[Handwritten Signature]
SECRETARY

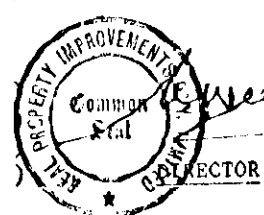

SIGNED in my presence by the transferee CAMPBELL MATTHEW EARL who is personally known to me

[Handwritten Signature]
Signature of witness
BARBARA JACKS
Name of Witness
[Handwritten text]
Qualification of witness

[Handwritten Signature]

B

PLAN FORM 2

Special Users, SALS AND STRATEGISTS of intention to
 create public roads or to create reserves, drainage reserves,
 easements, restrictions on the use of land or positive easements,
 and to set out in the accompanying
 instrument signed by the Council
 Clerk"

17/2/92
 JOAN PERCIVAL COMPTON
 17/2/92
 JOAN PERCIVAL COMPTON
 17/2/92
 JOAN PERCIVAL COMPTON

Crown Lands Office Approval
 PLM APPROVED: Automated Officer
 Land Officer: Automated Officer
 Paper No.: 10000000000000000000
 Field No.: 10000000000000000000

Council Clerk's Certificate
 I hereby certify that the application for the proposed
 (to the requirements of Part 3 Division 2 of the Resource
 Management Act 1991 and the Land Use Restriction
 Act 1987) and the proposed
 have been complied with by the applicant in relation to the
 proposed
 Date: 17/2/1992
 (Signature) [Signature]
 Council File No.: 52 8180
 "This part of certificate is to be deleted when the application is only for a
 subdivision of land and the proposed roads or reserves are not to be
 created. It is to be retained for the proposed roads or reserves and the
 Water, Sewerage and Drainage Plans and the Water, Drainage Water
 and Drainage Plans." (Section 223(2) of the Resource Management Act 1991)

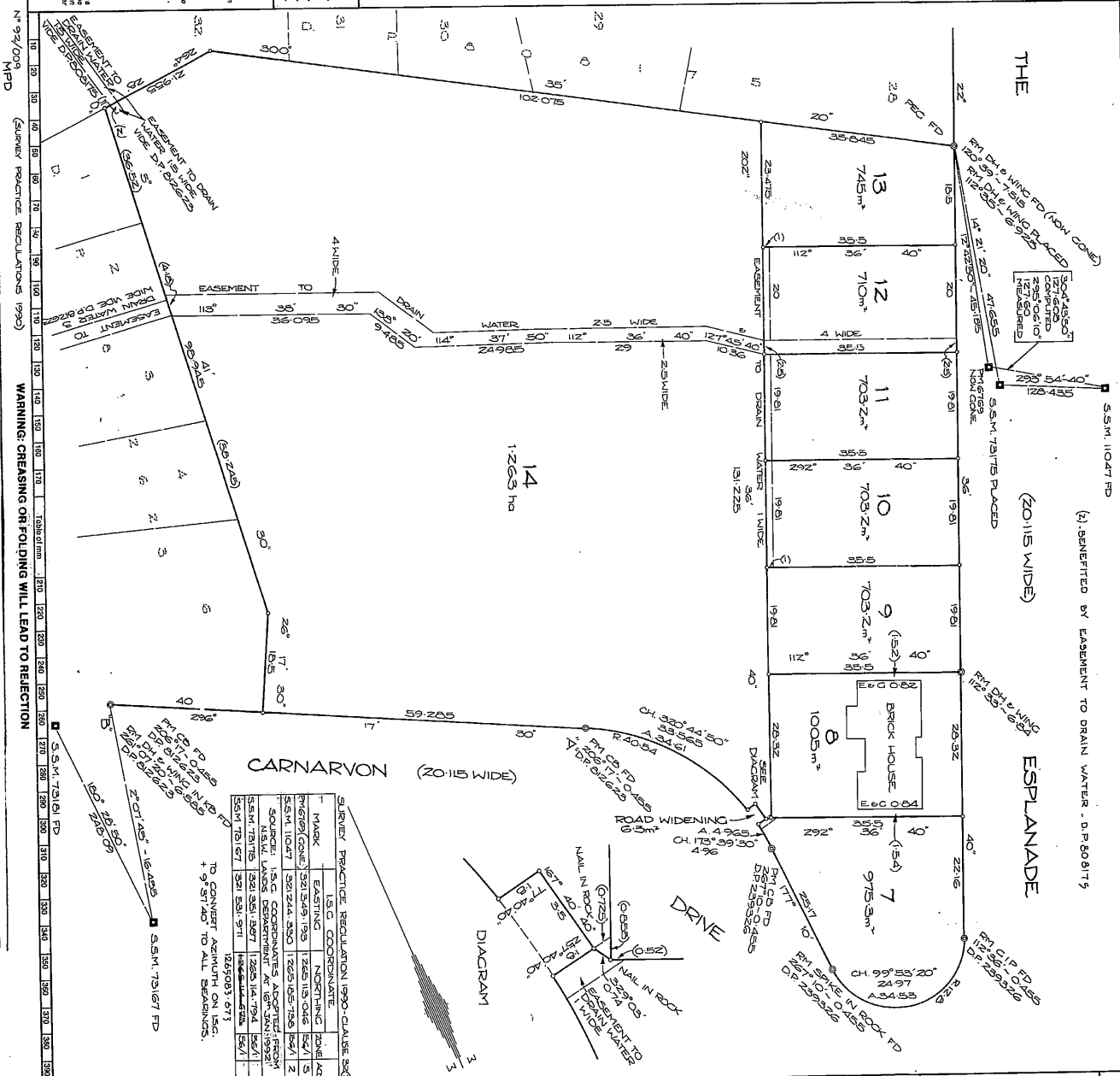

| | | | |
|---|--|------------------|---------------------------|
| 4 | DP 816033 | 18/3/1992 | CA: No 9274 of 12.2.1992. |
| 3 | Regional: | | |
| 2 | Title System: | TORRENS | |
| 1 | Purpose: | SUBDIVISION | |
| | Plan Map: | U1860-2 | |
| | Local Plan: | DP 812623 | |
| | PLAN OF SUBDIVISION OF | LOT 7 DP 812623. | |
| | Lengths are in metres. Reduction Ratio: 1:500 | | |
| | Shire: | WARINGAH | |
| | Locality: | FRENCHS FOREST | |
| | Profile: | MANLY COVE | |
| | County: | CUMBERLAND | |
| | This instrument is subject to the provisions of the Resource Management Act 1991, the Land Use Restriction Act 1987, and the Resource Management Act 1991. | | |
| | 1. DATES OF SURVEY: 17/2/1992 | | |
| | 2. SURVEYOR: JOAN PERCIVAL COMPTON | | |
| | 3. DATE OF SURVEY: 17/2/1992 | | |
| | 4. DATE OF PLAN: 17/2/1992 | | |
| | 5. DATE OF PLAN: 17/2/1992 | | |
| | 6. DATE OF PLAN: 17/2/1992 | | |
| | 7. DATE OF PLAN: 17/2/1992 | | |
| | 8. DATE OF PLAN: 17/2/1992 | | |
| | 9. DATE OF PLAN: 17/2/1992 | | |
| | 10. DATE OF PLAN: 17/2/1992 | | |
| | 11. DATE OF PLAN: 17/2/1992 | | |
| | 12. DATE OF PLAN: 17/2/1992 | | |
| | 13. DATE OF PLAN: 17/2/1992 | | |
| | 14. DATE OF PLAN: 17/2/1992 | | |
| | 15. DATE OF PLAN: 17/2/1992 | | |
| | 16. DATE OF PLAN: 17/2/1992 | | |
| | 17. DATE OF PLAN: 17/2/1992 | | |
| | 18. DATE OF PLAN: 17/2/1992 | | |
| | 19. DATE OF PLAN: 17/2/1992 | | |
| | 20. DATE OF PLAN: 17/2/1992 | | |
| | 21. DATE OF PLAN: 17/2/1992 | | |
| | 22. DATE OF PLAN: 17/2/1992 | | |
| | 23. DATE OF PLAN: 17/2/1992 | | |
| | 24. DATE OF PLAN: 17/2/1992 | | |
| | 25. DATE OF PLAN: 17/2/1992 | | |
| | 26. DATE OF PLAN: 17/2/1992 | | |
| | 27. DATE OF PLAN: 17/2/1992 | | |
| | 28. DATE OF PLAN: 17/2/1992 | | |
| | 29. DATE OF PLAN: 17/2/1992 | | |
| | 30. DATE OF PLAN: 17/2/1992 | | |
| | 31. DATE OF PLAN: 17/2/1992 | | |
| | 32. DATE OF PLAN: 17/2/1992 | | |
| | 33. DATE OF PLAN: 17/2/1992 | | |
| | 34. DATE OF PLAN: 17/2/1992 | | |
| | 35. DATE OF PLAN: 17/2/1992 | | |
| | 36. DATE OF PLAN: 17/2/1992 | | |
| | 37. DATE OF PLAN: 17/2/1992 | | |
| | 38. DATE OF PLAN: 17/2/1992 | | |
| | 39. DATE OF PLAN: 17/2/1992 | | |
| | 40. DATE OF PLAN: 17/2/1992 | | |
| | 41. DATE OF PLAN: 17/2/1992 | | |
| | 42. DATE OF PLAN: 17/2/1992 | | |
| | 43. DATE OF PLAN: 17/2/1992 | | |
| | 44. DATE OF PLAN: 17/2/1992 | | |
| | 45. DATE OF PLAN: 17/2/1992 | | |
| | 46. DATE OF PLAN: 17/2/1992 | | |
| | 47. DATE OF PLAN: 17/2/1992 | | |
| | 48. DATE OF PLAN: 17/2/1992 | | |
| | 49. DATE OF PLAN: 17/2/1992 | | |
| | 50. DATE OF PLAN: 17/2/1992 | | |
| | 51. DATE OF PLAN: 17/2/1992 | | |
| | 52. DATE OF PLAN: 17/2/1992 | | |
| | 53. DATE OF PLAN: 17/2/1992 | | |
| | 54. DATE OF PLAN: 17/2/1992 | | |
| | 55. DATE OF PLAN: 17/2/1992 | | |
| | 56. DATE OF PLAN: 17/2/1992 | | |
| | 57. DATE OF PLAN: 17/2/1992 | | |
| | 58. DATE OF PLAN: 17/2/1992 | | |
| | 59. DATE OF PLAN: 17/2/1992 | | |
| | 60. DATE OF PLAN: 17/2/1992 | | |
| | 61. DATE OF PLAN: 17/2/1992 | | |
| | 62. DATE OF PLAN: 17/2/1992 | | |
| | 63. DATE OF PLAN: 17/2/1992 | | |
| | 64. DATE OF PLAN: 17/2/1992 | | |
| | 65. DATE OF PLAN: 17/2/1992 | | |
| | 66. DATE OF PLAN: 17/2/1992 | | |
| | 67. DATE OF PLAN: 17/2/1992 | | |
| | 68. DATE OF PLAN: 17/2/1992 | | |
| | 69. DATE OF PLAN: 17/2/1992 | | |
| | 70. DATE OF PLAN: 17/2/1992 | | |
| | 71. DATE OF PLAN: 17/2/1992 | | |
| | 72. DATE OF PLAN: 17/2/1992 | | |
| | 73. DATE OF PLAN: 17/2/1992 | | |
| | 74. DATE OF PLAN: 17/2/1992 | | |
| | 75. DATE OF PLAN: 17/2/1992 | | |
| | 76. DATE OF PLAN: 17/2/1992 | | |
| | 77. DATE OF PLAN: 17/2/1992 | | |
| | 78. DATE OF PLAN: 17/2/1992 | | |
| | 79. DATE OF PLAN: 17/2/1992 | | |
| | 80. DATE OF PLAN: 17/2/1992 | | |
| | 81. DATE OF PLAN: 17/2/1992 | | |
| | 82. DATE OF PLAN: 17/2/1992 | | |
| | 83. DATE OF PLAN: 17/2/1992 | | |
| | 84. DATE OF PLAN: 17/2/1992 | | |
| | 85. DATE OF PLAN: 17/2/1992 | | |
| | 86. DATE OF PLAN: 17/2/1992 | | |
| | 87. DATE OF PLAN: 17/2/1992 | | |
| | 88. DATE OF PLAN: 17/2/1992 | | |
| | 89. DATE OF PLAN: 17/2/1992 | | |
| | 90. DATE OF PLAN: 17/2/1992 | | |
| | 91. DATE OF PLAN: 17/2/1992 | | |
| | 92. DATE OF PLAN: 17/2/1992 | | |
| | 93. DATE OF PLAN: 17/2/1992 | | |
| | 94. DATE OF PLAN: 17/2/1992 | | |
| | 95. DATE OF PLAN: 17/2/1992 | | |
| | 96. DATE OF PLAN: 17/2/1992 | | |
| | 97. DATE OF PLAN: 17/2/1992 | | |
| | 98. DATE OF PLAN: 17/2/1992 | | |
| | 99. DATE OF PLAN: 17/2/1992 | | |
| | 100. DATE OF PLAN: 17/2/1992 | | |

PLAN FOR USE ONLY for statements of intention to dedicate public roads or to create public reserves, drainage reserves, easements or restrictions as to use.
 THIS INSTRUMENT IS TO BE DELETED FROM THE PUBLIC RECORD ON THE DATE OF THE PUBLIC RECORDING ACT 1919, IT IS INTENDED TO CREATE:
 1. EASEMENT TO DRAIN WATER
 2. EASEMENT TO DRAIN WATER
 3. RESTRICTION ON THE USE OF LANDS
 4. RESTRICTION ON THE USE OF LANDS
 5. RESTRICTION ON THE USE OF LAND

10 20 30 40 50 60 70 Table of mm 110 120 130 140

WARNING: CREASING OR FOLDING WILL LEAD TO REFLECTION
 This negative is a photograph made as a permanent record of a document in the custody of the Registrar General this day, 20th March 1992



Plan Drawing only to appear in this space

OFFICE USE ONLY

Northern Beaches Council Planning Certificate – Part 2&5

Applicant: Somerville Legal
Level 10, 32 Walker Street
NORTH SYDNEY NSW 2060

Reference: ATS:VF:37088
Date: 06/02/2024
Certificate No. ePLC2024/00783

Address of Property: 69A The Esplanade FRENCHS FOREST NSW 2086
Description of Property: Lot 131 DP 866473

Planning Certificate – Part 2

The following certificate is issued under the provisions of Section 10.7(2) of the *Environmental Planning and Assessment Act 1979* (as amended – formerly Section 149). The information applicable to the land is accurate as at the above date.

1. Relevant planning instruments and Development Control Plans

(1) The name of each environmental planning instrument and development control plan that applies to the carrying out of development on the land:

(a) Local Environmental Plan

Warringah Local Environmental Plan 2011

(b) State Environmental Planning Policies and Regional Environmental Plans

State Environmental Planning Policy (Housing) 2021

State Environmental Planning Policy (Primary Production) 2021
Chapters 1,2

State Environmental Planning Policy (Resources and Energy) 2021
Chapters 1, 2

State Environmental Planning Policy (Resilience and Hazards) 2021
Chapters 1, 3, 4

State Environmental Planning Policy (Industry and Employment) 2021
Chapters 1, 3

State Environmental Planning Policy (Transport and Infrastructure) 2021
Chapters 1, 2, 3

State Environmental Planning Policy (Biodiversity and Conservation) 2021
Chapters 1, 2, 3, 4, 6, 7

State Environmental Planning Policy (Planning Systems) 2021
Chapters 1, 2

State Environmental Planning Policy (Precincts – Eastern Harbour City) 2021
Chapters 1, 2

State Environmental Planning Policy (Exempt and Complying Development Codes) 2008
SEPP 65 – Design Quality of Residential Apartment Development
SEPP (Building Sustainability Index: BASIX)

State Environmental Planning Policy (Biodiversity and Conservation) 2021
Chapters 9, 10

(c) Development Control Plans

Warringah Development Control Plan 2011

(2) Draft Environmental Planning Instruments

The name of each proposed environmental planning instrument and draft development control plan, which is or has been subject to community consultation or public exhibition under the Act, that will apply to the carrying out of development on the land.

(a) Draft Local Environmental Plans

(b) Draft State Environmental Planning Policies

Draft State Environmental Planning Policy (Environment)

Draft Remediation of Land State Environmental Planning Policy (intended to replace State Environmental Planning Policy 55)

(c) Draft Development Control Plans

2. Zoning and land use under relevant planning instruments

The following matters for each environmental planning instrument or draft environmental planning instrument that includes the land in a zone, however described—

(1) Zoning and land use under relevant Local Environmental Plans

(a), (b)

The following information identifies the purposes for which development may be carried out with or without development consent and the purposes for which the carrying out of development is prohibited, for all zones (however described) affecting the land to which the relevant Local Environmental Plan applies.

EXTRACT FROM WARRINGAH LOCAL ENVIRONMENTAL PLAN 2011

Zone R2 Low Density Residential

1 Objectives of zone

- To provide for the housing needs of the community within a low density residential environment.

- To enable other land uses that provide facilities or services to meet the day to day needs of residents.
- To ensure that low density residential environments are characterised by landscaped settings that are in harmony with the natural environment of Warringah.

2 Permitted without consent

Home-based child care; Home occupations

3 Permitted with consent

Bed and breakfast accommodation; Boat sheds; Building identification signs; Business identification signs; Centre-based child care facilities; Community facilities; Dwelling houses; Educational establishments; Emergency services facilities; Environmental protection works; Exhibition homes; Group homes; Health consulting rooms; Home businesses; Hospitals; Oyster aquaculture; Places of public worship; Pond-based aquaculture; Recreation areas; Respite day care centres; Roads; Secondary dwellings; Tank-based aquaculture; Veterinary hospitals

4 Prohibited

Any development not specified in item 2 or 3

(c) Additional permitted uses

Additional permitted uses, if any, for which development is permissible with development consent pursuant to Clause 2.5 and Schedule 1 of the relevant Local Environmental Plan:

Nil

(d) Minimum land dimensions

The *Warringah Local Environmental Plan 2011* contains no development standard that fixes minimum land dimensions for the erection of a dwelling house on the land.

(e) Outstanding biodiversity value

The land is not in an area of outstanding biodiversity value under the [Biodiversity Conservation Act 2016](#)

(f) Conservation areas

The land is not in a heritage conservation area.

(g) Item of environmental heritage

The land does not contain an item of environmental heritage.

(2) Zoning and land use under draft Local Environmental Plans

For any proposed changes to zoning and land use, see Part 1.2 (a)

Please contact Council's Strategic and Place Planning unit with enquiries on 1300 434 434.

3. Contribution plans

(1) The name of each contributions plan under the Act, Division 7.1 applying to the land, including draft contributions plans.

Northern Beaches Section 7.12 Contributions Plan 2022 - in force 1 June 2022.

(2) If the land is in a region within the meaning of the Act, Division 7.1, Subdivision 4 - the name of the region, and the name of the Ministerial planning order in which the region is identified.

Housing and Productivity Contribution

The subject land is within the Greater Sydney area to which the Environmental Planning and Assessment (Housing and Productivity Contribution) Order 2023 applies.

(3) If the land is in a special contributions area to which a continued 7.23 determination applies, the name of the area.

Nil

4. Complying Development

If the land is land on which complying development may or may not be carried out under each of the complying development codes under [State Environmental Planning Policy \(Exempt and Complying Development Codes\) 2008](#), because of that Policy, clause 1.17A(1)(c)–(e), (2), (3) or (4), 1.18(1)(c3) or 1.19.

Part 3 Housing Code

Complying Development under the Housing Code may be carried out on all of the land.

Part 3A Rural Housing Code

Complying Development under the Rural Housing Code may be carried out on all of the land.

Part 3B Low Rise Housing Diversity Code

Complying Development under the Low Rise Housing Diversity Code may be carried out on all of the land.

Part 3C Greenfield Housing Code

Complying Development under the Greenfield Housing Code may not be carried out on all of the land.

Part 3D Inland Code

Complying Development under the Inland Code does not apply to the land.

Note: Pursuant to clause 3D.1 of the *State Environmental Planning Policy (Exempt and Complying Development Codes) 2008*, the Inland Code only applies to 'inland local government areas'. Northern Beaches local government area is not defined as an 'inland local government area' by *State Environmental Planning Policy (Exempt and Complying Development Codes) 2008*.

Part 4 Housing Alterations Code

Complying Development under the Housing Alterations Code may be carried out on all of the land.

Part 4A General Development Code

Complying Development under the General Development Code may be carried out on all of the land.

Part 5 Industrial and Business Alterations Code

Complying Development under the Industrial and Business Alterations Code may be carried out on all of the land.

Part 5A Industrial and Business Buildings Code

Complying Development under the Industrial and Business Buildings Code may be carried out on all of the land.

Part 5B Container Recycling Facilities Code

Complying Development under the Container Recycling Facilities Code may be carried out on all of the land.

Part 6 Subdivisions Code

Complying Development under the Subdivisions Code may be carried out on all of the land.

Part 7 Demolition Code

Complying Development under the Demolition Code may be carried out on all of the land.

Part 8 Fire Safety Code

Complying Development under the Fire Safety Code may be carried out on all of the land.

(4) Complying Development Codes varied under Clause 1.12 of the *State Environmental Planning Policy (Exempt and Complying Development Codes) 2008*

No complying codes are varied under this clause in relation to the land.

5. Exempt Development

If the land is land on which exempt development may or may not be carried out under each of the exempt development codes under [State Environmental Planning Policy \(Exempt and Complying Development Codes\) 2008](#), because of that Policy, clause 1.16(1)(b1)–(d) or 1.16A.

Part 2 Exempt Development Codes

Exempt Development under the Exempt Development Codes may be carried out on all of the land.

(4) Exempt Development Codes varied under Clause 1.12 of the *State Environmental Planning Policy (Exempt and Complying Development Codes) 2008*

No exempt development codes are varied under this clause in relation to the land.

6. Affected building notices and building product rectification orders

(a) There is not an affected building notice of which the council is aware that is in force in respect of the land.

(b) There is not a building product rectification order of which the council is aware that is in force in respect of the land and has not been fully complied with, and

(c) There is not a notice of intention to make a building product rectification order of which the council is aware has been given in respect of the land and is outstanding.

In this section—

affected building notice has the same meaning the *Building Products (Safety) Act 2017, Part 4*.

building product rectification order has the same meaning as in the *Building Products (Safety) Act 2017*.

7. Land reserved for acquisition

Environmental planning instrument referred to in Clause 1 does not make provision in relation to the acquisition of the land by a public authority, as referred to in section 3.15 of the Act.

8. Road widening and road realignment

(a) The land is not affected by a road widening or re-alignment proposal under Division 2 of Part 3 of the *Roads Act 1993*.

(b) The land is not affected by a road widening or re-alignment proposal under an environmental planning instrument.

(c) The land is not affected by a road widening or re-alignment proposal under a resolution of Council.

9. Flood related development controls

(1) The land is not within the flood planning area and subject to flood related development controls.

(2) The land or part of the land is not between the flood planning area and the probable maximum flood and subject to flood related development controls.

In this section—

flood planning area has the same meaning as in the Flood Risk Management Manual.

Flood Risk Management Manual means the Flood Risk Management Manual, ISBN 978-1-923076-17-4, published by the NSW Government in June 2023.

probable maximum flood has the same meaning as in the Flood Risk Management Manual.

10. Council and other public authority policies on hazard risk restriction

(a) Council has adopted policies that restrict the development of the land because of the likelihood of land slip, bush fire, tidal inundation, subsidence, acid sulfate soils, contamination, aircraft noise, salinity, coastal hazards, sea level rise or another risk, other than flooding (for flooding – see 9).

The identified hazard or risk, if any, are listed below:

Nil

(b) The following information applies to any policy as adopted by any other public authority and notified to the Council for the express purpose of its adoption by that authority being referred to in a planning certificate issued by the Council. The identified hazard or risk and the respective Policy which affect the property, if any, are listed below:

Nil

11. Bush fire prone land

The land is not bush fire prone land.

12. Loose-fill asbestos insulation

The residential dwelling erected on this land has not been identified in the Loose-Fill Asbestos Insulation Register as containing loose-fill asbestos ceiling insulation.

This clause applies to residential premises (within the meaning of Division 1A of part 8 of the Home Building Act 1989) that are listed in the register that is required to be maintained under that Division.

Contact NSW Fair Trading for more information.

13. Mine Subsidence

The land is not declared to be a mine Subsidence (Mine Subsidence) district within the meaning of section 15 of the *Mine Subsidence (Mine Subsidence) Compensation Act, 1961*.

14. Paper subdivision information

There is no current paper subdivision, of which council is aware, in respect of this land according to Part 10 of the *Environmental Planning and Assessment Regulation 2021* and Schedule 7 of the *Environmental Planning & Assessment Act 1997 No 203*.

15. Property vegetation plans

The Council has not been notified that the land is land to which a vegetation plan under the *Native Vegetation Act 2003* applies.

16. Biodiversity Stewardship Sites

The Council has not been notified by the Biodiversity Conservation Trust that the land is a biodiversity stewardship site under a biodiversity stewardship agreement under Part 5 of the *Biodiversity Conservation Act 2016* (includes land to which a biobanking agreement under Part 7A of the repealed *Threatened Species Conservation Act 1995* relates).

17. Biodiversity certified land

The land is not biodiversity certified land under Part 8 of the *Biodiversity Conservation Act 2016* (includes land certified under Part 7AA of the repealed *Threatened Species Conservation Act 1995*).

18. Orders under Trees (Disputes Between Neighbours) Act 2006

Council has not been notified of the existence of an order made under the *Trees (Disputes Between Neighbours) Act 2006* to carry out work in relation to a tree on the land.

19. Annual charges under Local Government Act 1993 for coastal protection services that relate to existing coastal protection works

The owner of the land (or any previous owner) has not consented in writing to the land being subject to annual charges under section 496B of the *Local Government Act 1993* for coastal protection services that relate to existing coastal protection works (within the meaning of section 553B of that Act).

Note—

Existing coastal protection works are works to reduce the impact of coastal hazards on land, such as seawalls, revetments, groynes and beach nourishment, that existed before 1 January 2011.

20. Western Sydney Aerotropolis

Under State Environmental Planning Policy (Precincts – Western Parkland City) 2021, Chapter 4 the land is –

- (a) not in an ANEF or ANEC contour of 20 or greater, as referred to in that Chapter, section 4.17, or
- (b) not shown on the [Lighting Intensity and Wind Shear Map](#), or
- (c) not shown on the [Obstacle Limitation Surface Map](#), or
- (d) not in the “public safety area” on the [Public Safety Area Map](#), or
- (e) not in the “3 kilometre wildlife buffer zone” or the “13 kilometre wildlife buffer zone” on the [Wildlife Buffer Zone Map](#).

21. Development consent conditions for seniors housing

No condition of development consent granted after 11 October 2007 in relation to the land applies to the property that are of the kind set out in that Policy, section 88(2) of [State Environmental Planning Policy \(Housing\) 2021](#).

22. Site compatibility certificate and conditions for affordable rental housing

- (1) There is not a current site compatibility certificate of which the council is aware, in respect of proposed development on the land.

(2) No condition of development consent in relation to the land applies to the property that are of the kind set out in section 21(1) or 40(1) of [State Environmental Planning Policy \(Housing\) 2021](#).

(3) No condition of development consent in relation to the land applies to the property that are of the kind set out in clause 17(1) or 38(1) of [State Environmental Planning Policy \(Affordable Rental Housing\) 2009](#).

Additional matters under the Contaminated Land Management Act 1997

Note. The following matters are prescribed by section 59 (2) of the *Contaminated Land Management Act 1997* as additional matters to be specified in a planning certificate:

- (a) the land to which the certificate relates is not significantly contaminated land within the meaning of that Act
- (b) the land to which the certificate relates is not subject to a management order within the meaning of that Act
- (c) the land to which the certificate relates is not the subject of an approved voluntary management proposal within the meaning of that Act
- (d) the land to which the certificate relates is not subject to an ongoing maintenance order within the meaning of that Act
- (e) the land to which the certificate relates is not the subject of a site audit statement

If contamination is identified above please contact the Environmental Protection Authority (EPA) for further information.

Planning Certificate – Part 5

The following is information provided in good faith under the provisions of Section 10.7(5) of the *Environmental Planning and Assessment Act 1979* (as amended – formerly Section 149) and lists relevant matters affecting the land of which Council is aware. The Council shall not incur any liability in respect of any such advice.

Persons relying on this certificate should read the environmental planning instruments referred to in this certificate.

Company Title Subdivision

Clause 4.1 of the *Pittwater Local Environmental Plan 2014*, *Warringah Local Environmental Plan 2011* or *Manly Local Environmental Plan 2013* provides that land may not be subdivided except with the consent of the Council. This includes subdivision by way of company title schemes. Persons considering purchasing property in the Northern Beaches local government area the

subject of a company title scheme are advised to check that the land has been subdivided with the consent of the Council.

District Planning

Under the Greater Sydney Regional Plan – A Metropolis of Three Cities 2018, the Greater Sydney Commission sets a planning framework for a metropolis of three cities across Greater Sydney which reach across five Districts. Northern Beaches is located within the 'Eastern Harbour City' area and is in the North District which forms a large part of the Eastern Harbour City. The North District Plan sets out planning priorities and actions for the growth of the North District, including Northern Beaches. Northern Beaches Council's Local Strategic Planning Statement gives effect to the District Plan based on local characteristics and opportunities and Council's own priorities in the community. The Local Strategic Planning Statement came into effect on 26 March 2020.

Council Resolution To Amend Environmental Planning Instrument

The following instrument or resolution of Council proposes to vary the provisions of an environmental planning instrument, other than as referred to in the Planning Certificate – Part 2:

Planning Proposal - rezone deferred land within the Oxford Falls Valley & Belrose North area

Applies to land: Land within the B2 Oxford Falls Valley and C8 Belrose North localities of WLEP 2000 and land zoned E4 Environmental Living under WLEP 2011 at Cottage Point (Boundaries identified within the Planning Proposal)

Outline: Amends WLEP 2000 and WLEP 2011 to:

- Transfer the planning controls for land within the B2 Oxford Falls Valley and C8 Belrose North localities of WLEP 2000 into the best fit zones and land use controls under WLEP 2011
- Rezone the majority of the subject land to E3 Environmental Management under WLEP 2011
- Rezone smaller parcels of land to E4 Environmental Living, RU4 Primary Production Small Lots, SP2 Infrastructure, SP1 Special Activities, R5 Large Lot Residential and R2 Low Density Residential under WLEP 2011
- Include various parcels of land as having additional permitted uses under Schedule 1 of WLEP 2011

Council resolution: 24 February 2015

Planning Proposal - add permitted use of "registered club" on the site of the proposed new Warringah Golf Club

Applies to land: Lot 2742 DP 752038

Outline: Amends WLEP 2011 to:

- Permit an additional permitted use of "registered club" on the site of the proposed new Warringah Golf Club

Council resolution: 24 October 2023

Additional Information Applying To The Land

Additional information, if any, relating to the land the subject of this certificate:

Geotechnical Planning Controls

Council is currently undertaking a study to review geotechnical planning controls across the Local Government Area. Information from a draft study indicates geotechnical considerations may affect a greater number of properties and may present an increased risk to properties than that shown on published hazard maps. Council's Development Engineering & Certification team can be contacted for further information.

General Information

Threatened Species

Many threatened species identified under the *Biodiversity Conservation Act 2016* (NSW) and Environment Protection and Biodiversity Conservation Act 1999 (Commonwealth) are found within the former Local Government Area of Warringah (now part of Northern Beaches). Council's Natural Environment unit can be contacted to determine whether any site specific information is available for this property. Records of threatened flora and fauna are also available from the NSW Office of Environment and Heritage's Atlas of NSW Wildlife database: <http://www.bionet.nsw.gov.au>

Potential threatened species could include:

(a) threatened species as described in the final determination of the scientific committee to list endangered and vulnerable species under Schedule 1 of the *Biodiversity Conservation Act 2016*, and/or

(b) one or more of the following threatened ecological communities as described in the final determination of the scientific committee to list the ecological communities under Schedule 2 of the *Biodiversity Conservation Act 2016*:

- Duffys Forest Ecological Community in the Sydney Basin Bioregion
- Swamp Sclerophyll Forest on Coastal Floodplain
- Coastal Saltmarsh of the Sydney Basin Bioregion
- Swamp Oak Floodplain Forest
- Bangalay Sand Forest of the Sydney Basin Bioregion
- Themeda grasslands on Seacliffs and Coastal Headlands
- Sydney Freshwater Wetlands in the Sydney Basin Bioregion
- Coastal Upland Swamp in the Sydney Basin Bioregion
- River-Flat Eucalypt Forest on Coastal Floodplains of the New South Wales North Coast, Sydney Basin and South East Corner Bioregions

Bush fire

Certain development may require further consideration under section 79BA or section 91 of the Environmental Planning and Assessment Act 1979, and section 100B of the Rural Fires Act, 1997 with respect to bush fire matters. Contact NSW Rural Fire Service.

Aboriginal Heritage

Many Aboriginal objects are found within the Local Government Area. It is prudent for the purchaser of land to make an enquiry with the Office of Environment and Heritage as to whether any known Aboriginal objects are located on the subject land or whether the land has been declared as an Aboriginal place under the *National Parks and Wildlife Act 1974* (NSW). The carrying out of works may be prevented on land which is likely to significantly affect an Aboriginal object or Aboriginal place. For information relating to Aboriginal sites and objects across NSW, contact: Aboriginal Heritage Information Management System (AHIMS) on (02) 9585 6345 or email

AHIMS@environment.nsw.gov.au. Alternatively visit

<http://www.environment.nsw.gov.au/licences/AboriginalHeritageInformationManagementSystem.htm>.

Coastal Erosion

Information available to Council indicates coastal erosion may affect a greater number of properties and may present an increased risk to properties than that shown on published hazard maps of the Warringah coastline. Council's Natural Environment Unit can be contacted for further information.

Coastal Hazards

Information available to Council indicates properties within the suburb of Cottage Point may be affected by coastal hazards. Please contact Northern Beaches Council for further information.



Scott Phillips
Chief Executive Officer
06/02/2024

6 February 2024

Globalx-Dye & Durham Information Pty Ltd

Reference number: 8003127300

Property address: 69A The Esplanade Frenchs Forest NSW 2086

Sewer service diagram is not available

Unfortunately, we don't have a Sewer service diagram available for this property.

This may indicate that a diagram was never drawn, an inspection did not occur or that the relevant fees and charges were not paid to submit the diagram to NSW Fair Trading.

The fee you paid has been used to cover the cost of searching our records.

Yours sincerely



Jodie Gray
Manager Customer Accounts

Service Location Print
Application Number: 8003127290

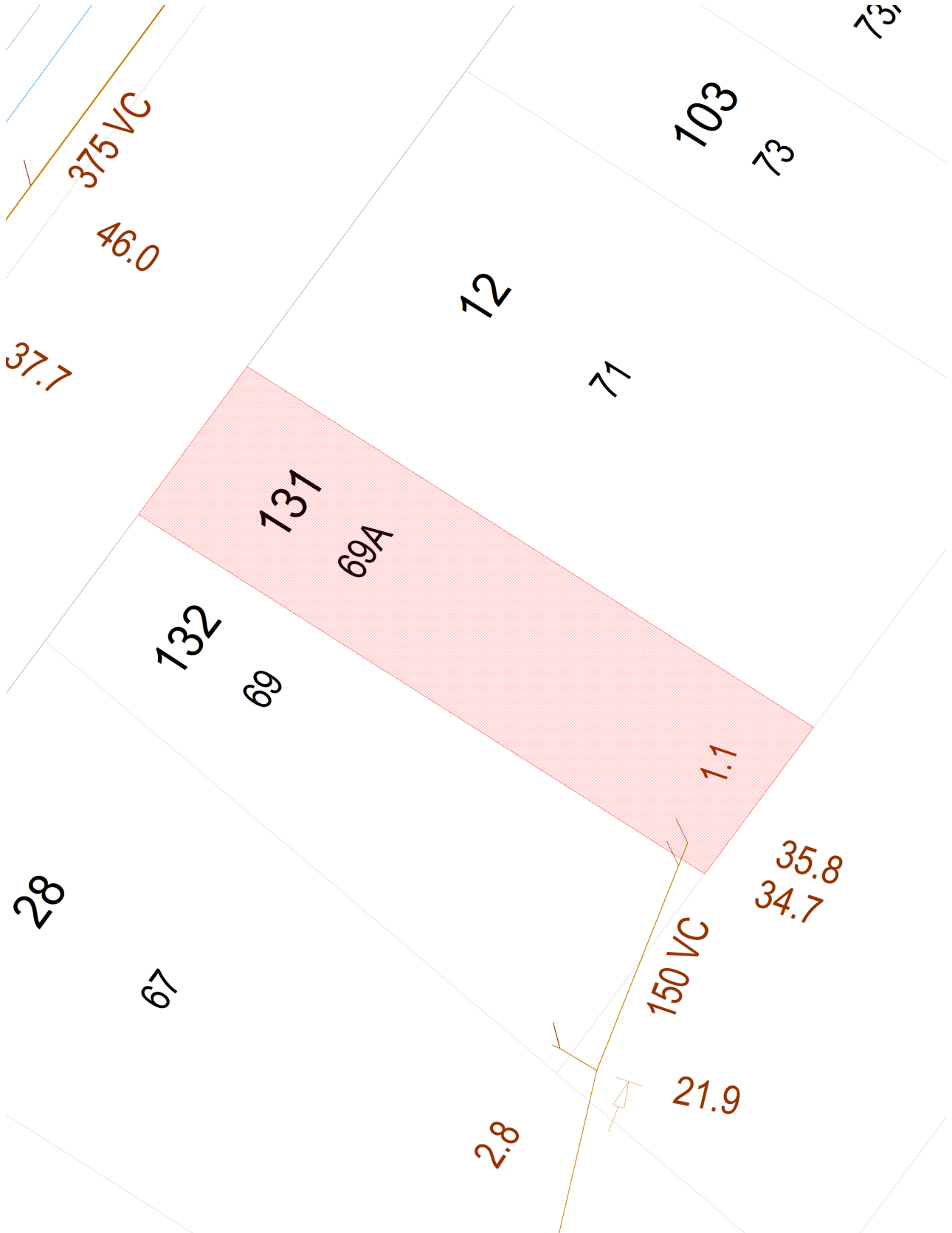

Document generated at 06-02-2024 02:30:15 PM

Disclaimer

The information on this print shows if we provide any water, wastewater or stormwater services to this property. It may not be accurate or to scale. If you'd like to see the location of private wastewater pipes on the property, please buy a **Sewer service diagram**.

Asset Information

Legend

| Sewer | | Property Details | |
|--|--|--|--|
| Sewer Main (with flow arrow & size type text) | | Boundary Line | |
| Disused Main | | Easement Line | |
| Rising Main | | House Number | |
| Maintenance Hole (with upstream depth to invert) | | Lot Number | |
| Sub-surface chamber | | Proposed Land | |
| Maintenance Hole with Overflow chamber | | Sydney Water Heritage Site (please call 132 092 and ask for the Heritage Unit) | |
| Ventshaft EDUCT | | | |
| Ventshaft INDUCT | | | |
| Property Connection Point (with chainage to downstream MH) | | | |
| Concrete Encased Section | | | |
| Terminal Maintenance Shaft | | | |
| Maintenance Shaft | | | |
| Rodding Point | | | |
| Lamphole | | | |
| Vertical | | | |
| Pumping Station | | | |
| Sewer Rehabilitation | | | |
| Pressure Sewer | | Water | |
| Pressure Sewer Main | | WaterMain - Potable (with size type text) | |
| Pump Unit (Alarm, Electrical Cable, Pump Unit) | | Disconnected Main - Potable | |
| Property Valve Boundary Assembly | | Proposed Main - Potable | |
| Stop Valve | | Water Main - Recycled | |
| Reducer / Taper | | Special Supply Conditions - Potable | |
| Flushing Point | | Special Supply Conditions - Recycled | |
| | | Restrained Joints - Potable | |
| | | Restrained Joints - Recycled | |
| | | Hydrant | |
| | | Maintenance Hole | |
| | | Stop Valve | |
| | | Stop Valve with By-pass | |
| | | Stop Valve with Tapers | |
| | | Closed Stop Valve | |
| | | Air Valve | |
| | | Valve | |
| | | Scour | |
| | | Reducer / Taper | |
| | | Vertical Bends | |
| | | Reservoir | |
| | | Recycled Water is shown as per Potable above. Colour as indicated | |
| Vacuum Sewer | | Private Mains | |
| Pressure Sewer Main | | Potable Water Main | |
| Division Valve | | Recycled Water Main | |
| Vacuum Chamber | | Sewer Main | |
| Clean Out Point | | Symbols for Private Mains shown grey | |
| Stormwater | | | |
| Stormwater Pipe | | | |
| Stormwater Channel | | | |
| Stormwater Gully | | | |
| Stormwater Maintenance Hole | | | |

Disclaimer

The information on this print shows if we provide any water, wastewater or stormwater services to this property. It may not be accurate or to scale. If you'd like to see the location of private wastewater pipes on the property, please buy a **Sewer service diagram**.

Pipe Types

| | | | |
|----------------|------------------------------------|----------------|---|
| ABS | Acrylonitrile Butadiene Styrene | AC | Asbestos Cement |
| BRICK | Brick | CI | Cast Iron |
| CICL | Cast Iron Cement Lined | CONC | Concrete |
| COPPER | Copper | DI | Ductile Iron |
| DICL | Ductile Iron Cement (mortar) Lined | DIPL | Ductile Iron Polymeric Lined |
| EW | Earthenware | FIBG | Fibreglass |
| FL BAR | Forged Locking Bar | GI | Galvanised Iron |
| GRP | Glass Reinforced Plastics | HDPE | High Density Polyethylene |
| MS | Mild Steel | MSCL | Mild Steel Cement Lined |
| PE | Polyethylene | PC | Polymer Concrete |
| PP | Polypropylene | PVC | Polyvinylchloride |
| PVC - M | Polyvinylchloride, Modified | PVC - O | Polyvinylchloride, Oriented |
| PVC - U | Polyvinylchloride, Unplasticised | RC | Reinforced Concrete |
| RC-PL | Reinforced Concrete Plastics Lined | S | Steel |
| SCL | Steel Cement (mortar) Lined | SCL IBL | Steel Cement Lined Internal Bitumen Lined |
| SGW | Salt Glazed Ware | SPL | Steel Polymeric Lined |
| SS | Stainless Steel | STONE | Stone |
| VC | Vitrified Clay | WI | Wrought Iron |
| WS | Woodstave | | |

Further Information

Please consult the Dial Before You Dig enquiries page on the Sydney Water website.

For general enquiries please call the Customer Contact Centre on 132 092

In an emergency, or to notify Sydney Water of damage or threats to its structures, call 13 20 90 (24 hours, 7 days)

Disclaimer

The information on this print shows if we provide any water, wastewater or stormwater services to this property. It may not be accurate or to scale. If you'd like to see the location of private wastewater pipes on the property, please buy a **Sewer service diagram**.



Revenue

Enquiry ID 4056741
Agent ID 81290352
Issue Date 06 Feb 2024
Correspondence ID 1779463338
Your reference 37088

DYE & DURHAM PTY LTD
GPO Box 2746
BRISBANE QLD 4001

Land Tax Certificate under section 47 of the *Land Tax Management Act, 1956.*

Property Tax status Certificate under section 49 of the *Property Tax (First Home Buyer Choice) Act, 2022.*

This information is based on data held by Revenue NSW.

| Land ID | Land address | Taxable land value | Property Tax Status |
|-------------|--|--------------------|---------------------|
| D866473/131 | 69A THE ESPLANADE FRENCHS FOREST 2086 | \$863 000 | Not Opted In |

There is **no land tax** (including surcharge land tax) charged on the land up to and including the 2024 tax year.

If the property is opted in, the owner of the land will need to arrange for the charge to be removed. Please call us on 1300 135 195.

Yours sincerely,

Scott Johnston
Chief Commissioner of State Revenue

Important information

Who is protected by a clearance certificate?

A clearance certificate states whether there is any land tax (including surcharge land tax) owing on a property. The certificate protects a purchaser from outstanding land tax liability by a previous owner, however it does not provide protection to the owner of the land.

When is a certificate clear from land tax?

A certificate may be issued as 'clear' if:

- the land is not liable or is exempt from land tax
- the land tax has been paid
- Revenue NSW is satisfied payment of the tax is not at risk, or
- the owner of the land failed to lodge a land tax return when it was due, and the liability was not detected at the time the certificate was issued.

Note: A clear certificate does not mean that land tax was not payable, or that there is no land tax adjustment to be made on settlement if the contract for sale allows for it.

When is a certificate not clear from land tax?

Under section 47 of the *Land Tax Management Act 1956*, land tax is a charge on land owned in NSW at midnight on 31 December of each year. The charge applies from the taxing date and does not depend on the issue of a land tax assessment notice. Land tax is an annual tax so a new charge may occur on the taxing date each year.

How do I clear a certificate?

A charge is removed for this property when the outstanding land tax amount is processed and paid in full. Payment can be made during settlement via an accepted Electronic Lodgement Network or at an approved settlement room.

To determine the land tax amount payable, you must use one of the following approved supporting documents:

- Current year land tax assessment notice. This can only be used if the settlement date is no later than the first instalment date listed on the notice. If payment is made after this date interest may apply.
- Clearance quote or settlement letter which shows the amount to clear.

The charge on the land will be considered removed upon payment of the amount shown on these documents

How do I get an updated certificate?

A certificate can be updated by re-processing the certificate through your Client Service Provider (CSP), or online at www.revenue.nsw.gov.au/taxes/land/clearance.

Please allow sufficient time for any payment to be processed prior to requesting a new version of the clearance certificate.

Land value, tax rates and thresholds

The taxable land value shown on the clearance certificate is the value used by Revenue NSW when assessing land tax. Details on land tax rates and thresholds are available at www.revenue.nsw.gov.au.

Contact details



Read more about Land Tax and use our online service at www.revenue.nsw.gov.au



1300 139 816*



Phone enquiries
8:30 am - 5:00 pm, Mon. to Fri.

* Overseas customers call +61 2 7808 6906
Help in community languages is available.

RP 13

M 927069 OCT 3 AM 11 51



NEW SOUTH WALES

MEMORANDUM OF TRANSFER

REAL PROPERTY ACT, 1900

OFFICE USE ONLY

BEH
- \$ 12.00

Where new restrictive covenants are imposed, or covenants created, or where the form is otherwise unutilisable, Form 13A should be used.
Typewriting and hand-writing should be clear, legible and in permanent black non-copping ink. No alterations should be made by erasure; the words rejected must be ruled through and verified by signature or initials in the margin.
(a) Full name, address and occupation of transferor.
(b) If less estate strike out in the simple and add appropriate estate.
(c) A short note will suffice. If an encumbrance is not registered particular sufficient for identification must be furnished.

(a) REAL PROPERTY IMPROVEMENTS PTY, LIMITED
hereinafter referred to as the TRANSFEROR

being registered proprietor of an estate in fee simple^(b) in the land hereinafter described, subject to the following encumbrances and interests

(c) NIL

In consideration of SIXTY EIGHT THOUSAND DOLLARS ----- (\$ 68,000.00)
(the receipt whereof is hereby acknowledged), paid to the transferor by^(d)

CAMPBELL MATTHEW EARL hereby transfers to

(e) CAMPBELL MATTHEW EARL of 2 Federal Parade, Brookvale, Engineer
hereinafter referred to as the TRANSFeree

an estate in fee simple^(b) in the land described in the following schedule

| Reference to title | | Whole or Part | Description of land if part only ^(f) | County | Parish |
|---|-------|---------------|---|------------|------------|
| Volume | Folio | | | | |
| 11435 | 73 | WHOLE | | CUMBERLAND | MANLY COVE |
| Subject to covenant annexed hereto and marked with the letter "A" ✓ | | | | | |

(d) Insert appropriate words. If desired, this may be used in the case of a transfer by direction.
(e) Full name, address and occupation of transferee. If more than one transferee state whether joint tenants or tenants in common. Unless otherwise stated tenants in common will be presumed to hold in equal shares.
(f) Insert lot and plan number, portion etc. See also sections 227 and 227A Local Government Act, 1919.
(g) Further proof of execution will not normally be required if signed or acknowledged before any of the following persons, not being a party to the dealing to whom the transferor is known:

Where executed in New South Wales - bank manager, bailiff, clerk of petty sessions, commissioned officer in the Defence Force of the Commonwealth of Australia, commissioner for taking affidavits, headmaster of a school, judge, justice of the peace, magistrate, mayor, or other chief officer of any local government corporation, medical practitioner, member of parliament of the Commonwealth or of a State, member of the police force of the Commonwealth or of a State or a Territory, minister of religion, notary public, postmaster, police-constable or shire clerk or other executive officer administering local government.
Where executed in any part of the Commonwealth of Australia or its Territories or in any part of the British Commonwealth - any of the persons referred to above, and in addition an official or British Consular Officer exercising his functions in the part, Governor, Government Resident, Chief Justice, or Registrar of Titles of the part.
Where executed in foreign country - an Australian or British Consular Officer exercising his functions in that country, commissioned officer in the Defence Force of the Commonwealth of Australia, commissioner for taking affidavits, justice of the peace, magistrate, mayor, or other chief officer of any local government corporation, officer in charge of a police station, notary public, town or shire clerk or other executive officer administering local government.

Dated at Sydney this 29th day of September 1972.

THE COMMON SEAL OF REAL PROPERTY IMPROVEMENTS PTY, LIMITED was hereunto affixed in the presence of:-

Signature of witness
Secretary
Name of witness (BLOCK LETTERS)
Qualification of witness



Signature of Transferor
Director

(d) Repeat attestation clause as necessary.
(e) Section 117 Real Property Act, 1900, requires that this certificate be signed by the transferee or, where his signature cannot be obtained without difficulty and delay, by his solicitor or conveyancer by his own name, which should be typewritten or printed below his signature, and not that of his firm. Any person falsely or negligently certifying is liable to the penalties provided by section 117.
(f) May be witnessed by any responsible person not being a party to this dealing.

(b) Signed in my presence by the transferee who is personally known to me

Signature of witness
Name of witness (BLOCK LETTERS)
Address of witness

^(d)Accepted and certified correct for the purposes of the Real Property Act, 1900.

Signature of R. Burridge

R. Burridge solicitor for the transferee whose signature cannot be obtained without difficulty or delay.

RULE UP ALL BLANKS

42 70 915

M927069

| | | | |
|--|--|--|--|
| DEPARTMENTAL USE ONLY | | TO BE COMPLETED BY LODGING PARTY | |
| TRANSFER | | Lodged by: FREEHILL, HOLLINGDALE & PAGE | |
| | | Address: SOLICITORS 60 MARTIN PLACE, SYDNEY 2000-359 | |
| | | Phone No.: _____ | |
| | | Documents lodged herewith | |
| | | 1. _____ | |
| | | 2. _____ | |
| | | 3. _____ | |
| | | 4. _____ | |
| | | 5. _____ | |
| Subject to Government Checked <i>R 133</i> Passed Signed <i>[Signature]</i> | | Received Documents _____ Receiving Clerk _____ | |
| REGISTERED <i>18-10-1972</i> <i>[Signature]</i> Registrar General | |  | |

AUTHORITY FOR USE OF INSTRUMENT OF TITLE^(a)

Authority is hereby given for the use of _____ lodged
(insert reference to certificates, grants or dealings)
 in connection with _____ for the
(insert number of plan or dealing)
 registration of this dealing and for delivery to _____

 (BLOCK LETTERS)

 Signature

 Name (BLOCK LETTERS)

(a) Unless the instrument of title has been lodged by the person lodging the dealing, or its use has been authorised previously, the authority must be furnished by the person otherwise entitled to delivery of the certificate of title, grant &c.

MEMORANDUM AS TO NON-REVOCATION OF POWER OF ATTORNEY
(To be signed at the time of executing the within dealing)

The undersigned states that he has no notice of the revocation of the Power of Attorney registered No. _____ Miscellaneous Register under the authority of which he has just executed the within dealing.

Signed at _____ the _____ day of _____ 19 _____

 Signature of attorney

 Signature of witness

CERTIFICATE OF J.P., &c., TAKING DECLARATION OF ATTESTING WITNESS^(b)

I certify that _____ the attesting witness to this dealing, appeared before me at _____ the _____ day of _____ 19 _____ and declared that he personally knew _____ the person signing the same, and whose signature thereto he has attested, and that the name purporting to be such signature of the said _____ is his own handwriting and that he was of sound mind and freely and voluntarily signed the same.

 Signature

 Name (BLOCK LETTERS)

 Qualification

(b) Not required where dealing effected in accordance with note (a); in other cases to be signed by one of the persons referred to in note (a).