

PLANNING PROPERTY REPORT

From www.planning.vic.gov.au at 19 August 2021 03:20 PM

PROPERTY DETAILS

Address: **1 CARTER STREET HORSHAM 3400**
Lot and Plan Number: **Lot 10 LP81785**
Standard Parcel Identifier (SPI): **10\LP81785**
Local Government Area (Council): **HORSHAM**
Council Property Number: **895**
Planning Scheme: **Horsham**
Directory Reference: **Vicroads 544 D5**

www.hrcc.vic.gov.au

[Planning Scheme - Horsham](#)

UTILITIES

Rural Water Corporation: **Grampians Wimmera Mallee Water**
Urban Water Corporation: **Grampians Wimmera Mallee Water**
Melbourne Water: **Outside drainage boundary**
Power Distributor: **POWERCOR**

STATE ELECTORATES

Legislative Council: **WESTERN VICTORIA**
Legislative Assembly: **LOWAN**

OTHER

Registered Aboriginal Party: **Barengi Gadjin Land Council**
Aboriginal Corporation

[View location in VicPlan](#)

Planning Zones

[GENERAL RESIDENTIAL ZONE \(GRZ\)](#)

[GENERAL RESIDENTIAL ZONE - SCHEDULE 1 \(GRZ1\)](#)

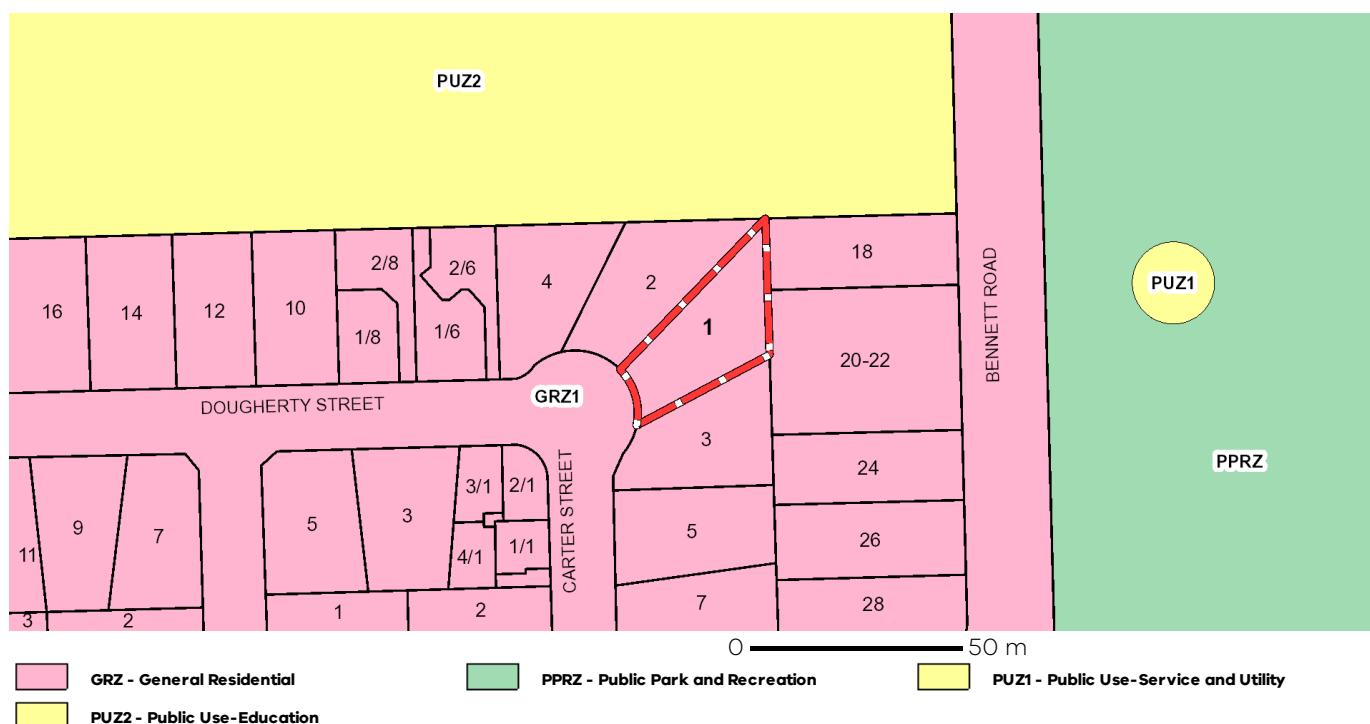

Note: labels for zones may appear outside the actual zone - please compare the labels with the legend.

Planning Overlay

[DESIGN AND DEVELOPMENT OVERLAY \(DDO\)](#)

[DESIGN AND DEVELOPMENT OVERLAY - SCHEDULE 3 \(DDO3\)](#)

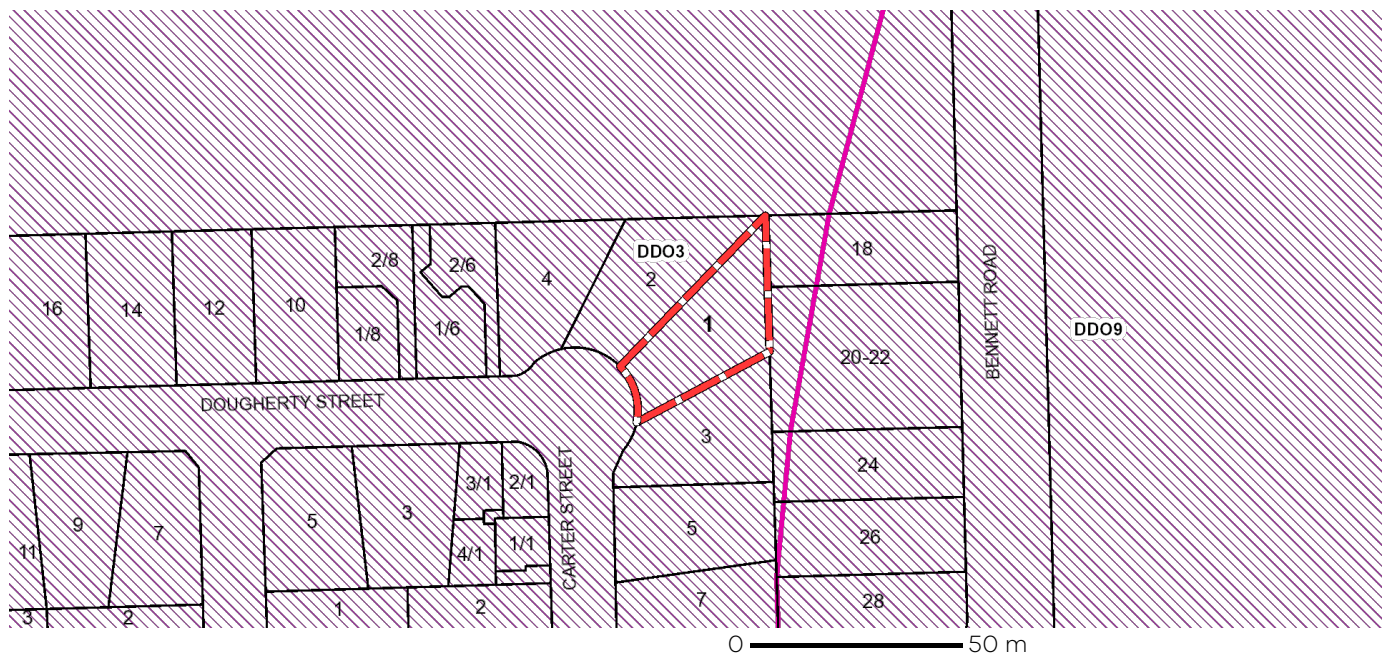

 **DDO - Design and Development**

Note: due to overlaps, some overlays may not be visible, and some colours may not match those in the legend

Further Planning Information

Planning scheme data last updated on 11 August 2021.

A **planning scheme** sets out policies and requirements for the use, development and protection of land. This report provides information about the zone and overlay provisions that apply to the selected land. Information about the State and local policy, particular, general and operational provisions of the local planning scheme that may affect the use of this land can be obtained by contacting the local council or by visiting <https://www.planning.vic.gov.au>

This report is NOT a **Planning Certificate** issued pursuant to Section 199 of the **Planning and Environment Act 1987**. It does not include information about exhibited planning scheme amendments, or zonings that may affect the land. To obtain a Planning Certificate go to Titles and Property Certificates at Landata - <https://www.landata.vic.gov.au>

For details of surrounding properties, use this service to get the Reports for properties of interest.

To view planning zones, overlay and heritage information in an interactive format visit <https://mapshare.maps.vic.gov.au/vicplan>

For other information about planning in Victoria visit <https://www.planning.vic.gov.au>

Designated Bushfire Prone Areas

This property is not in a designated bushfire prone area.
No special bushfire construction requirements apply. Planning provisions may apply.

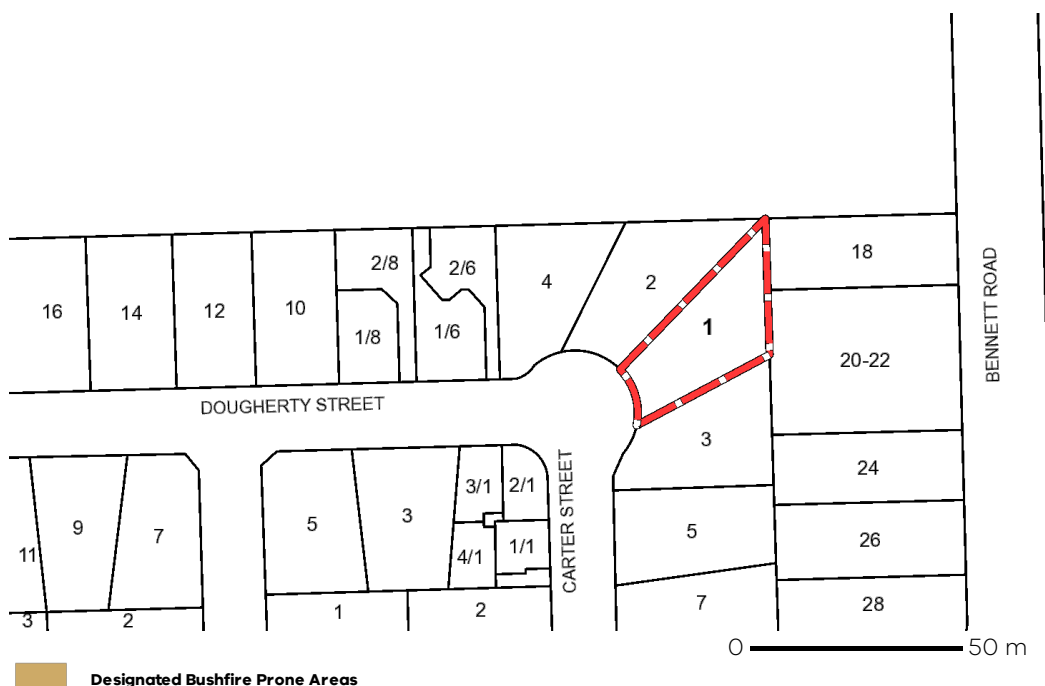

Designated bushfire prone areas as determined by the Minister for Planning are in effect from 8 September 2011 and amended from time to time.

The Building Regulations 2018 through application of the Building Code of Australia, apply bushfire protection standards for building works in designated bushfire prone areas.

Designated bushfire prone areas maps can be viewed on VicPlan at <https://mapshare.maps.vic.gov.au/vicplan> or at the relevant local council.

Note: prior to 8 September 2011, the whole of Victoria was designated as bushfire prone area for the purposes of the building control system.

Further information about the building control system and building in bushfire prone areas can be found on the Victorian Building Authority website <https://www.vba.vic.gov.au>

Copies of the Building Act and Building Regulations are available from <http://www.legislation.vic.gov.au>

For Planning Scheme Provisions in bushfire areas visit <https://www.planning.vic.gov.au>

Native Vegetation

Native plants that are indigenous to the region and important for biodiversity might be present on this property. This could include trees, shrubs, herbs, grasses or aquatic plants. There are a range of regulations that may apply including need to obtain a planning permit under Clause 52.17 of the local planning scheme. For more information see [Native Vegetation \(Clause 52.17\)](#) with local variations in [Native Vegetation \(Clause 52.17\) Schedule](#)

To help identify native vegetation on his property and the application of Clause 52.17 please visit the Native Vegetation Information Management system <https://nvim.delwp.vic.gov.au/> and [Native vegetation \(environment.vic.gov.au\)](https://environment.vic.gov.au) or please contact your relevant council.

You can find out more about the natural values on your property through NatureKit [NatureKit \(environment.vic.gov.au\)](https://environment.vic.gov.au)