



Dingle Partners

| Estate Agents
| Sales
| Property Management
| Project Management
| Consultants

12.3/201 Spring Street, Melbourne

2  **2**  **1** 



Additional Information

- Park Tower Building
- Fronting onto Spring Street & Tianjin Gardens
- Light-Filled Easterly Aspect
- Central Heating & Cooling
- Basement Car Parking Space

Rates:

Water Rates - \$615.88 per annum approx.
Council Rates - \$1,400.00 per annum approx.
Owners Corp - \$8,850.00 per annum approx.

Chattels:

All fixed floor coverings, electric light fittings and fixtures, window furnishings

Preferred Settlement:

30/60/90days – 10% deposit

Schools:

RMIT University Melbourne Campus	743 m
Carlton Gardens Primary School	900 m
Collingwood College	1.8 km
University High School	2.1 km

Public Transportation:

Tram: 10-Albert St / Nicholson St	100 m
Bus: Spring Street / Lonsdale Street	100 m
Train: Melbourne Central Station	818 m

Other Amenities

The Princess Theatre	91 m
Carlton Gardens	337 m
St Vincent's Public Hospital	405 m
Treasury Gardens	492 m

**EXPRESSIONS OF INTEREST CLOSING WEDNESDAY 13TH JULY AT 4.00 PM
(If not sold prior)**

CONTACT ROBERT EGGERS 0412 329 340

Dingle Partners Pty Ltd. ABN:67 099 681 188 Tel:61 3 9614 6688 Fax:61 3 9629 8811 www.dinglepartners.com.au

Directors: Malcolm Dingle FREI AAPI, Robert Eggers AREI, CEA (REIV), Paul Harberts BEng

Head Office: 39 Queen Street, Melbourne VIC 3000 | Carlton | Richmond | St Kilda Rd

Dingle Partners

- | Estate Agents
- | Sales
- | Property Management
- | Project Management
- | Consultants

Dingle Partners

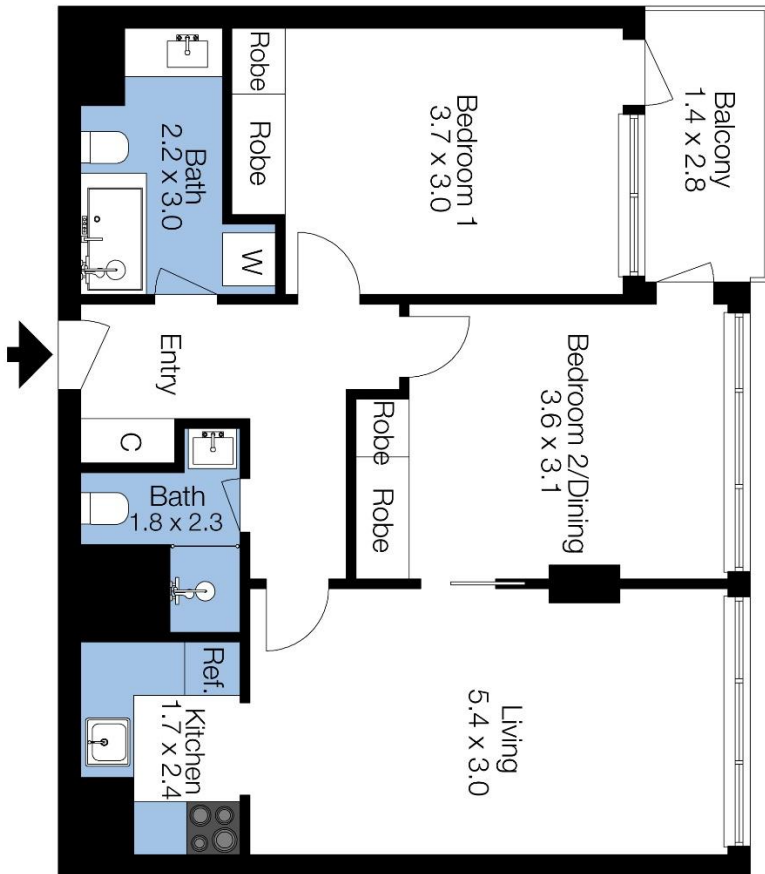
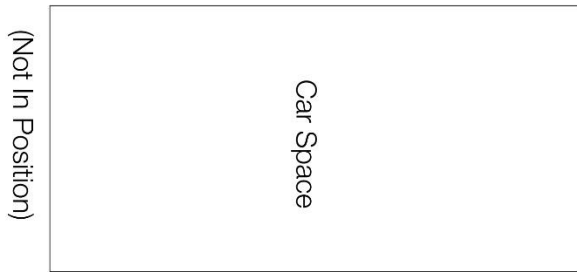

The floor plan is not to scale. Measurements are indicative and in general. Exact dimensions are not included. Plans should not be relied on. Measurements should always be verified on site.

Produced by DIAKRT



Dingle Partners Pty Ltd. ABN:67 099 681 188 Tel:61 3 9614 6688 Fax:61 3 9629 8811 www.dinglepartners.com.au

Directors: Malcolm Dingle FREI AAPI, Robert Eggers AREI, CEA (REIV), Paul Harberts BEng

Head Office: 39 Queen Street, Melbourne VIC 3000 | Carlton | Richmond | St Kilda Rd