

Contract of Sale of Land

Property address: 13 Newton Street THOMASTOWN VIC 3074

The vendor agrees to sell and the purchaser agrees to buy the property, being the land and the goods, for the price and on the terms set out in this contract.

The terms of this contract are contained in the:

- Particulars of sale; and
- Special conditions, if any; and
- General conditions

in that order of priority.

IMPORTANT NOTICE TO PURCHASERS

Cooling-off period

Section 31, Sale of Land Act 1962

You may end this contract within 3 clear business days of the day that you sign the contract if none of the exceptions listed below applies to you.

You must either give the vendor or the vendor's agent written notice that you are ending the contract or leave the notice at the address of the vendor or the vendor's agent to end this contract within this time in accordance with this cooling-off provision.

You are entitled to a refund of all the money you paid **except** for \$100 or 0.2% of the purchase price (whichever is more) if you end the contract in this way.

Exceptions

The 3-day cooling-off period does not apply if:

- you bought the property at or within 3 clear business days before or after a publicly advertised auction; or
- the property is used primarily for industrial or commercial purposes; or
- the property is more than 20 hectares in size and is used primarily for farming; or
- you and the vendor have previously signed a contract for the sale of the same land in substantially the same terms; or
- you are an estate agent or a corporate body.

Notice to purchasers of property "off-the-plan"

Section 9AA(1A), Sale of Land Act 1962

You may negotiate with the vendor about the amount of the deposit moneys payable under the contract of sale, up to 10 per cent of the purchase price.

A substantial period of time may elapse between the day on which you sign the contract of sale and the day on which you become the registered proprietor of the lot.

The value of the lot may change between the day on which you sign the contract of sale of that lot and the day on which you become the registered proprietor.

Signing of this contract

WARNING: THIS IS A LEGALLY BINDING CONTRACT. YOU SHOULD READ THIS CONTRACT BEFORE SIGNING IT.

Purchasers should ensure that prior to signing this contract, they have received:

- a copy of the section 32 statement required to be given by a vendor under section 32 of the *Sale of Land Act 1962* in accordance with Division 2 of Part II of that Act. In this contract, "section 32 statement" means the statement required to be given by a vendor under section 32 of the *Sale of Land Act 1962*.

The authority of a person signing:

- under power of attorney; or
- as director of a corporation; or
- as an agent authorised in writing by one of the parties

must be noted beneath the signature.

Any person whose signature is secured by an estate agent acknowledges being given by the agent at the time of signing a copy of the terms of this contract.

Signed by the purchaser

on
dd/mm/yyyy

Print name(s) of person(s) signing

State nature of authority if applicable
e.g. 'director', 'attorney under power
of attorney'

This offer will lapse unless accepted within [] clear business days (3 clear business days if none specified).

Signed by the vendor

on
dd/mm/yyyy

Print name(s) of person(s) signing

State nature of authority if applicable
e.g. 'director', 'attorney under power
of attorney'

The **day of sale** is the date by which both parties have signed this contract.

Table of Contents

PARTICULARS OF SALE	3
SPECIAL CONDITIONS	8
GENERAL CONDITIONS	10
1. ELECTRONIC SIGNATURE	10
2. LIABILITY OF SIGNATORY	10
3. GUARANTEE	10
4. NOMINEE	10
5. ENCUMBRANCES	10
6. VENDOR WARRANTIES	11
7. IDENTITY OF THE LAND	12
8. SERVICES	12
9. CONSENTS	12
10. TRANSFER AND DUTY	12
11. RELEASE OF SECURITY INTEREST	12
12. BUILDER WARRANTY INSURANCE	14
13. GENERAL LAND LAW	14
14. DEPOSIT	15
15. DEPOSIT BOND	16
16. BANK GUARANTEE	17
17. SETTLEMENT	17
18. ELECTRONIC SETTLEMENT	18
19. GST	19
20. LOAN	20
21. BUILDING REPORT	20
22. PEST REPORT	21
23. ADJUSTMENTS	21
24. FOREIGN RESIDENTIAL CAPITAL GAINS WITHHOLDING	21
25. GST WITHHOLDING	22
26. TIME & CO-OPERATION	25
27. SERVICE	25
28. NOTICES	25
29. INSPECTION	26
30. TERMS CONTRACT	26
31. LOSS OR DAMAGE BEFORE SETTLEMENT	26
32. BREACH	27
33. INTEREST	27
34. DEFAULT NOTICE	27
35. DEFAULT NOT REMEDIED	27

Particulars of sale

Vendor's estate agent

Name:	Harcourts
Address:	Unit 1 337 Settlement Road THOMASTOWN VIC 3074
Telephone:	
Fax:	
Email:	sold@rataandco.com.au

Vendor

Name(s):	Joseph Falvo
Address:	
Telephone:	W: H:
Email:	

Vendor's legal practitioner or conveyancer

Name:	Trang Conveyancing Pty Ltd
Address:	34 Goodman Drive NOBLE PARK VIC 3174
Telephone:	9711 6024
Fax:	
Email:	trangconveyancing@gmail.com

Purchaser

Name(s):

Address:

Telephone: W: H:

Email:

Purchaser's legal practitioner or conveyancer

Name:

Address:

Telephone:

Fax:

Email:

Land (general conditions 7 and 13)

The land is described in the following table.

Certificate of Title reference				being lot	on plan
Volume	08320	Folio	973	8	LP041097
Volume		Folio			

or

described in the copy title(s) and plan(s) as attached to the Vendor's Statement if no title or plan references are recorded in the table above or if the land is general law land.

The land includes all improvements and fixtures.

Property address
The address of the land

13 Newton Street THOMASTOWN VIC 3074

Goods sold with the land
General condition 6.3(f). List
or attach schedule.

Land includes all improvements and fixtures

Payment

Price

Deposit

by
dd/mm/yyyy

(of which [amount] has been
paid)

Balance payable at
settlement

Deposit bond

☐ General condition 15 applies only if the box is checked

Bank guarantee

☐ General condition 16 applies only if the box is checked

GST (general condition 19)

The price includes GST (if any)
unless the words '**plus GST**'
appear in this box:

If this is a sale of a 'farming
business' or 'going concern'
then add the words '**farming
business**' or '**going concern**'
in this box:

If the margin scheme will be
used to calculate GST then
add the words 'margin
scheme' in this box

Settlement (general condition 17 and 26.2)

Is due on:
dd/mm/yyyy

unless the land is a lot on an unregistered plan of subdivision, in which case settlement is due on the later of:

- the above date; or
- 14 days after the vendor gives notice in writing to the purchaser of registration of the plan of subdivision; or
- the 14 days after the vendor gives notice in writing to the purchaser of the issue of the Occupancy permit.

Lease (general condition 5.1)

At settlement the purchaser
is entitled to vacant
possession of the property
unless the words '**subject to
lease**' appear in this box:

in which case refer to general condition 4.1. If '**subject to lease**' then particulars of the lease are:

Residential tenancy agreement for a fixed term ending

Periodic residential tenancy agreement determinable by notice

Lease for a term ending.....with.....option to renew, each of..... years

Terms contract (general condition 30)

If this contract is intended to be a terms contract within the meaning of the *Sale of Land Act 1962* then add the words '**terms contract**' in this box

--

and refer to general condition 30 and add any further provisions by way of special conditions.

Loan (general condition 20) – NOT APPLICABLE AT AUCTION

The following details apply if this contract is subject to a loan being approved:

Lender	
Loan amount	
Approval date	

Building report

☐ — General condition 21 applies only if the box is checked

Pest report

☐ — General condition 22 applies only if the box is checked

Special conditions

This contract does not include any special conditions unless the words '**special conditions**' appear in this box:

SPECIAL CONDITIONS

--

Contract of Sale of Land—Special Conditions

Instructions: it is recommended that when adding special conditions:

- each special condition is numbered;
- the parties initial each page containing special conditions;
- a line is drawn through any blank space remaining on this page; and
- attach additional pages if there is not enough space and number pages accordingly (eg.5a, 5b, 5c etc.)

1. Foreign Acquisition and Takeover Acts 1975

- 1.1. The purchaser warrants that the provisions of the Foreign Acquisitions and Takeovers Act 1975 (Cth) do not require the purchaser to obtain consent to enter this contract.
- 1.2. If there is a breach of the warranty contained in Special Condition 3.1 (whether intentional or not) the purchaser must indemnify and compensate the vendor for any loss, damage or cost which the vendor incurs as a result of the breach;
- 1.3. This warranty and indemnity do not merge on completion of this contract.

2. Auction

The Rules and Information Sheet for the conduct of the auction shall be as set out in the Schedules of the Sale of Land (Public Auctions) Regulations 2014 or any rules prescribed by regulation which modify or replace those Rules.

3. Multiple Purchasers

- 3.1. If there is more than one purchaser, the agreements and obligations of the purchaser under this Contract shall bind each purchaser jointly and severally.
- 3.2. If there is more than one purchaser, it is the purchaser's responsibility to ensure the Contract correctly records at the date of sale the proportions in which they are buying the property ("the proportions").
- 3.3. If the proportions recorded in the transfer differ from those recorded in the Contract, it is the purchaser's responsibility to pay any additional duty which may be assessed as a result of the variation.
- 3.4. The purchasers fully indemnify the vendor, the vendor's agent and the vendor's legal practitioner against any claims or demands which may be made against any or all of them in relation to any additional duty payable as a result of the proportions in the transfer differing from those in the Contract.
- 3.5. This Special Condition will not merge on completion of this Contract.

4. Variation

Should the Purchaser require that the Settlement take place on any date other than the date contained in the Contract of Sale, then the Purchaser must pay the Vendor's Legal Representative a fee of \$165.00 (including GST) ("Rescheduling Fee") for each and every time the settlement date is changed. This Rescheduling Fee must be allowed by the Purchaser to the Vendor in the Statement of Adjustments. The Purchaser acknowledges that the Rescheduling fee is a reasonable pre-estimate of additional legal costs incurred by the Vendor as a result of the Vendor's Legal Representative having to reschedule settlement.

5. Purchaser's acknowledgements

Purchaser acknowledges that:

- 5.1. except for any disclosure by the vendor or the vendor's agent to the purchaser in accordance with the provisions of the Sale of Land Act 1962, no information representation or warranty of the vendor or anyone on the vendor's behalf (apart from the statements contained in the Contract) was made with the intention or knowledge that it would be relied upon and no such representation or warranty has in fact been relied upon by the purchaser and it is further agreed that this Contract and the Vendor Statement attached thereto contain the entire agreement between the parties;
- 5.2. the purchaser has conducted its own due diligence, inspections and enquiries regarding the property prior to executing this Contract and the purchaser accepts the location of all buildings on the property and the conditions and state of repair of the property as at the day of sale;
- 5.3. The purchaser acknowledges that he has inspected the goods, fittings and appliances forming part of this contract and that he is aware of their condition and any deficiencies. The purchaser shall not require the goods to be in working order at the date of settlement, nor shall he claim any compensation in relation thereto.
- 5.4. any improvements on the property may be subject to relevant building acts, regulations and by-laws and the purchaser shall not make any requisition, claim any compensation or require anything to be done by the vendor in

relation to any failure to comply with any of those laws or regulations and such failure shall not constitute a defect in the title or affect the validity of this Contract; and

- 5.5. the property is sold subject to all easements, covenants, leases, licenses, encumbrances and restrictions (if any) as set out herein or attached hereto including the restrictions imposed by the relevant Planning Scheme and all other relevant planning controls and the purchaser shall not make any requisition or claim any compensation in respect thereof and any such restriction shall not constitute a defect in the title or affect the validity of this Contract.

6. Swimming Pools and smoke alarm

- 6.1. If a swimming pool and/or spa as defined in the Building Regulations 1994 is constructed on the property and if the swimming pool and/or spa is not fenced or otherwise does not comply with the requirements of the Building Regulations 1994, the vendor will not be obliged to comply with those regulations either prior to or after settlement date and the purchaser must not make any requisition, claim compensation or delay settlement as a result of any non-compliance.
- 6.2. The purchaser acknowledges that all dwellings and units are required to be fitted with self-contained smoke alarms in accordance with regulation 5.14 of the Building Regulations 1994 within 30 days after completion of this contract.

7. Solar Panels and its accessories

The Purchaser acknowledges that if there are solar panels installed on the roof of the dwelling constructed on the property hereby sold, and the parties agree as follow:

- 7.1. Whether or not any benefits currently provided to the Vendor by agreement with the current energy supplier with respect to feed-in-tariffs pass with the sale of this property is a matter for enquiry and confirmation by the Purchaser.
- 7.2. The Purchaser agrees that they will negotiate with the current energy supplier or an energy supplier of their choice with respect to any feed-in tariffs for the electricity generated or any other benefits provided by the said solar panels and the Purchaser shall indemnify and hold harmless the Vendor against any claims for any benefits whatsoever with respect to the said solar panels; and
- 7.3. The Vendor make no representation or warranties with respect to the said solar panels in relation to their conditions, state of repair, fitness for the purposes for which they were installed, their input to the electricity grid or any benefits arising from any electricity generated by the said solar panels.

8. General Conditions

- 8.1. The purchaser and vendor acknowledge that if there is any conflict between the Special Conditions of this contract and the General Conditions, the Special Conditions shall prevail.
- 8.2. General Condition 12, 15, 16, 21, 22 and 30 do not apply to this Contract and are deleted.

9. Land Tax

- 9.1. For the purposes of general condition 23, the expression "periodic outgoings" does not include any tax payable under the *Land Tax Act 2005* to which section 10G of the *Sale of Land Act 1962* applies.
- 9.2. General condition 28.2 does not apply to any amounts to which sections 10G or 10H of the *Sale of Land Act 1962* apply.

10. Insurance

The property remains at the risk of the Vendor until final settlement, however the Purchaser acknowledges that he or she has been advised to fully insure all the improvements on the property from the date the Contract becomes unconditional.

11. General Condition 25 amended

- 11.1. General Condition 25.4 is added – the parties hereby agree that adjustments must be prepared on behalf of the Purchaser and provided to the Vendor's Solicitor not less than 4 days prior to the due date of settlement and any failure to do so will result in the Purchaser incurring an administration fee to the Vendor's Solicitor of \$220.00 for the delay in receiving the Statement of Adjustments and further more the Vendor may refuse to settle until 4 business days after the Statement of Adjustments is delivered to the Vendor's Solicitor. If this contract is not completed, the Purchaser is deemed to have defaulted in the payment of the balance of purchase monies from the due date for settlement until the date when settlement is effected.
- 11.2. The provisions of this contract shall apply and prevail over any statutory or implied conditions but only to the extent of any inconsistency and to the extent permissible at law.

Contract of Sale of Land - General Conditions

Contract Signing

1 ELECTRONIC SIGNATURE

- 1.1 In this general condition "electronic signature" means a digital signature or a visual representation of a person's handwritten signature or mark which is placed on a physical or electronic copy of this contract by electronic or mechanical means, and "electronically signed" has a corresponding meaning.
- 1.2 The parties consent to this contract being signed by or on behalf of a party by an electronic signature.
- 1.3 Where this contract is electronically signed by or on behalf of a party, the party warrants and agrees that the electronic signature has been used to identify the person signing and to indicate that the party intends to be bound by the electronic signature.
- 1.4 This contract may be electronically signed in any number of counterparts which together will constitute the one document.
- 1.5 Each party consents to the exchange of counterparts of this contract by delivery by email or such other electronic means as may be agreed in writing.
- 1.6 Each party must upon request promptly deliver a physical counterpart of this contract with the handwritten signature or signatures of the party and all written evidence of the authority of a person signing on their behalf, but a failure to comply with the request does not affect the validity of this contract.

2. LIABILITY OF SIGNATORY

Any signatory for a proprietary limited company purchaser is personally liable for the due performance of the purchaser's obligations as if the signatory were the purchaser in the case of a default by a proprietary limited company purchaser.

3. GUARANTEE

The vendor may require one or more directors of the purchaser to guarantee the purchaser's performance of this contract if the purchaser is a proprietary limited company.

4. NOMINEE

The purchaser may nominate a substitute or additional transferee, but the named purchaser remains personally liable for the due performance of all the purchaser's obligations under this contract.

Title

5. ENCUMBRANCES

- 5.1 The purchaser buys the property subject to:
 - (a) any encumbrance shown in the section 32 statement other than mortgages or caveats; and
 - (b) any reservations, exceptions and conditions in the crown grant; and
 - (c) any lease or tenancy referred to in the particulars of sale.

- 5.2 The purchaser indemnifies the vendor against all obligations under any lease or tenancy that are to be performed by the landlord after settlement.
- 5.3 In this general condition 'section 32 statement' means a statement required to be given by a vendor under **section 32** of the Sale of Land Act 1962 in accordance with Division 2 Part II of that Act.

6. VENDOR WARRANTIES

- 6.1 The vendor warrants that these general conditions 1 to 35 are identical to the general conditions 1 to 35 in the form of contract of sale of land published by the Law Institute of Victoria Limited and the Real Estate Institute of Victoria Ltd in the month and year set out the header of this page
- 6.2 The warranties in general conditions 6.3 and 6.4 replace the purchaser's right to make requisitions and inquiries.
- 6.3 The vendor warrants that the vendor:
- (a) has, or by the due date for settlement will have, the right to sell the land; and
 - (b) is under no legal disability; and
 - (c) is in possession of the land, either personally or through a tenant; and
 - (d) has not previously sold or granted any option to purchase, agreed to a lease or granted a pre-emptive right which is current over the land and which gives another party rights which have priority over the interest of the purchaser; and
 - (e) will at settlement be the holder of an unencumbered estate in fee simple in the land; and
 - (f) will at settlement be the unencumbered owner of any improvements, fixtures, fittings and goods sold with the land.
- 6.4 The vendor further warrants that the vendor has no knowledge of any of the following:
- (a) public rights of way over the land;
 - (b) easements over the land;
 - (c) lease or other possessory agreement affecting the land;
 - (d) notice or order directly and currently affecting the land which will not be dealt with at settlement, other than the usual rate notices and any land tax notices;
 - (e) legal proceedings which would render the sale of the land void or voidable or capable of being set aside.
- 6.5 The warranties in general conditions 6.3 and 6.4 are subject to any contrary provisions in this contract and disclosures in the section 32 statement.
- 6.6 If sections 137B and 137C of the *Building Act* 1993 apply to this contract, the vendor warrants that:

- (a) all domestic building work carried out in relation to the construction by or on behalf of the vendor of the home was carried out in a proper and workmanlike manner; and
- (b) all materials used in that domestic building work were good and suitable for the purpose for which they were used and that, unless otherwise stated in the contract, those materials were new; and
- (c) domestic building work was carried out in accordance with all laws and legal requirements, including, without limiting the generality of this warranty, the *Building Act 1993* and regulations made under the *Building Act 1993*.

6.7 Words and phrases used in general condition 6.6 which are defined in the *Building Act 1993* have the same meaning in general condition 6.6.

7. IDENTITY OF THE LAND

7.1 An omission or mistake in the description of the property or any deficiency in the area, description or measurements of the land does not invalidate the sale.

7.2 The purchaser may not:

- (a) make any objection or claim for compensation for any alleged misdescription of the property or any deficiency in its area or measurements; or
- (b) require the vendor to amend title or pay any cost of amending title.

8. SERVICES

8.1 The vendor does not represent that the services are adequate for the purchaser's proposed use of the property and the vendor advises the purchaser to make appropriate inquiries. The condition of the services may change between the day of sale and settlement and the vendor does not promise that the services will be in the same condition at settlement as they were on the day of sale.

8.2 The purchaser is responsible for the connection of all services to the property after settlement and the payment of any associated cost.

9. CONSENTS

The vendor must obtain any necessary consent or licence required for the vendor to sell the property. The contract will be at an end and all money paid must be refunded if any necessary consent or licence is not obtained by settlement.

10. TRANSFER & DUTY

10.1 The purchaser must prepare and deliver to the vendor at least 7 days before the due date for settlement any paper transfer of land document which is necessary for this transaction. The delivery of the transfer of land document is not acceptance of title.

10.2 The vendor must promptly initiate the Duties on Line or other form required by the State Revenue Office in respect of this transaction, and both parties must co-operate to complete it as soon as practicable.

11. RELEASE OF SECURITY INTEREST

11.1 This general condition applies if any part of the property is subject to a security interest to which the *Personal Property Securities Act 2009* (Cth) applies.

- 11.2 For the purposes of enabling the purchaser to search the Personal Property Securities Register for any security interests affecting any personal property for which the purchaser may be entitled to a release, statement, approval or correction in accordance with general condition 11.4, the purchaser may request the vendor to provide the vendor's date of birth to the purchaser. The vendor must comply with a request made by the purchaser under this condition if the purchaser makes the request at least 21 days before the due date for settlement.
- 11.3 If the purchaser is given the details of the vendor's date of birth under general condition 11.2, the purchaser must
- (a) only use the vendor's date of birth for the purposes specified in general condition 11.2; and
 - (b) keep the date of birth of the vendor secure and confidential.
- 11.4 The vendor must ensure that at or before settlement, the purchaser receives—
- (a) a release from the secured party releasing the property from the security interest; or
 - (b) a statement in writing in accordance with section 275(1)(b) of the *Personal Property Securities Act 2009* (Cth) setting out that the amount or obligation that is secured is nil at settlement; or
 - (c) a written approval or correction in accordance with section 275(1)(c) of the *Personal Property Securities Act 2009* (Cth) indicating that, on settlement, the personal property included in the contract is not or will not be property in which the security interest is granted.
- 11.5 Subject to general condition 11.6, the vendor is not obliged to ensure that the purchaser receives a release, statement, approval or correction in respect of personal property—
- (a) that—
 - (i) the purchaser intends to use predominantly for personal, domestic or household purposes; and
 - (ii) has a market value of not more than \$5000 or, if a greater amount has been prescribed for the purposes of section 47(1) of the *Personal Property Securities Act 2009* (Cth), not more than that prescribed amount; or
 - (b) that is sold in the ordinary course of the vendor's business of selling personal property of that kind.
- 11.6 The vendor is obliged to ensure that the purchaser receives a release, statement, approval or correction in respect of personal property described in general condition 11.5 if—
- (a) the personal property is of a kind that may or must be described by serial number in the Personal Property Securities Register; or
 - (b) the purchaser has actual or constructive knowledge that the sale constitutes a breach of the security agreement that provides for the security interest.
- 11.7 A release for the purposes of general condition 11.4(a) must be in writing.
- 11.8 A release for the purposes of general condition 11.4(a) must be effective in releasing the goods from the security interest and be in a form which allows the purchaser to take title to the goods free of that security interest.
- 11.9 If the purchaser receives a release under general condition 11.4(a) the purchaser must provide the vendor with a copy of the release at or as soon as practicable after settlement.
- 11.10 In addition to ensuring that a release is received under general condition 11.4(a), the vendor must ensure that at or before settlement the purchaser receives a written undertaking from a secured party

to register a financing change statement to reflect that release if the property being released includes goods of a kind that are described by serial number in the Personal Property Securities Register.

11.11 The purchaser must advise the vendor of any security interest that is registered on or before the day of sale on the Personal Property Securities Register, which the purchaser reasonably requires to be released, at least 21 days before the due date for settlement.

11.12 The vendor may delay settlement until 21 days after the purchaser advises the vendor of the security interests that the purchaser reasonably requires to be released if the purchaser does not provide an advice under general condition 11.11.

11.13 If settlement is delayed under general condition 11.12 the purchaser must pay the vendor—

- (a) interest from the due date for settlement until the date on which settlement occurs or 21 days after the vendor receives the advice, whichever is the earlier; and
- (b) any reasonable costs incurred by the vendor as a result of the delay—
as though the purchaser was in default.

11.14 The vendor is not required to ensure that the purchaser receives a release in respect of the land. This general condition 11.14 applies despite general condition 11.1.

11.15 Words and phrases which are defined in the *Personal Property Securities Act 2009* (Cth) have the same meaning in general condition 11 unless the context requires otherwise.

12. BUILDER WARRANTY INSURANCE

The vendor warrants that the vendor will provide at settlement details of any current builder warranty insurance in the vendor's possession relating to the property if requested in writing to do so at least 21 days before settlement.

13. GENERAL LAW LAND

13.1 The vendor must complete a conversion of title in accordance with section 14 of the *Transfer of Land Act 1958* before settlement if the land is the subject of a provisional folio under section 23 of that Act.

13.2 The remaining provisions of this general condition 13 only apply if any part of the land is not under the operation of the *Transfer of Land Act 1958*.

13.3 The vendor is taken to be the holder of an unencumbered estate in fee simple in the land if there is an unbroken chain of title starting at least 30 years before the day of sale proving on the face of the documents the ownership of the entire legal and equitable estate without the aid of other evidence.

13.4 The purchaser is entitled to inspect the vendor's chain of title on request at such place in Victoria as the vendor nominates.

13.5 The purchaser is taken to have accepted the vendor's title if:

- (a) 21 days have elapsed since the day of sale; and
- (b) the purchaser has not reasonably objected to the title or reasonably required the vendor to remedy a defect in the title.

13.6 The contract will be at an end if:

- (a) the vendor gives the purchaser a notice that the vendor is unable or unwilling to satisfy the purchaser's objection or requirement and that the contract will end if the objection or requirement is not withdrawn within 14 days of the giving of the notice; and
- (b) the objection or requirement is not withdrawn in that time.

13.7 If the contract ends in accordance with general condition 13.6, the deposit must be returned to the purchaser and neither party has a claim against the other in damages.

13.10 General condition 17.1 [settlement] should be read as if the reference to 'registered proprietor' is a reference to 'owner' in respect of that part of the land which is not under the operation of the *Transfer of Land Act 1958*.

Money

14. DEPOSIT

14.1 The purchaser must pay the deposit:

- (a) to the vendor's licensed estate agent; or
- (b) if there is no estate agent, to the vendor's legal practitioner or conveyancer; or
- (c) if the vendor directs, into a special purpose account in an authorised deposit-taking institution in Victoria specified by the vendor in the joint names of the purchaser and the vendor.

14.2 If the land sold is a lot on an unregistered plan of subdivision, the deposit:

- (a) must not exceed 10% of the price; and
- (b) must be paid to the vendor's estate agent, legal practitioner or conveyancer and held by the estate agent, legal practitioner or conveyancer on trust for the purchaser until the registration of the plan of subdivision.

14.3 The deposit must be released to the vendor if:

- (a) the vendor provides particulars, to the satisfaction of the purchaser, that either-
 - (i) there are no debts secured against the property; or
 - (ii) if there are any debts, the total amount of those debts together with any amounts to be withheld in accordance with general conditions 24 and 25 does not exceed 80% of the sale price; and
- (b) at least 28 days have elapsed since the particulars were given to the purchaser under paragraph (a); and
- (c) all conditions of section 27 of the *Sale of Land Act 1962* have been satisfied.

14.4 The stakeholder must pay the deposit and any interest to the party entitled when the deposit is released, the contract is settled, or the contract is ended.

14.5 The stakeholder may pay the deposit and any interest into court if it is reasonable to do so.

14.6 Where the purchaser is deemed by section 27(7) of the *Sale of Land Act 1962* to have given the deposit release authorisation referred to in section 27(1), the purchaser is also deemed to have accepted title in the absence of any prior express objection to title.

14.7 Payment of the deposit may be made or tendered:

- (a) in cash up to \$1,000 or 0.2% of the price, whichever is greater; or
- (b) by cheque drawn on an authorised deposit-taking institution; or
- (c) by electronic funds transfer to a recipient having the appropriate facilities for receipt.

However, unless otherwise agreed:

- (d) payment may not be made by credit card, debit card or any other financial transfer system that allows for any chargeback or funds reversal other than for fraud or mistaken payment, and
- (e) any financial transfer or similar fees or deductions from the funds transferred, other than any fees charged by the recipient's authorised deposit-taking institution, must be paid by the remitter.

14.8 Payment by electronic funds transfer is made when cleared funds are received in the recipient's bank account.

14.9 Before the funds are electronically transferred the intended recipient must be notified in writing and given sufficient particulars to readily identify the relevant transaction.

14.10 As soon as the funds have been electronically transferred the intended recipient must be provided with the relevant transaction number or reference details.

14.11 For the purpose of this general condition 'authorised deposit-taking institution' means a body corporate for which an authority under section 9(3) of the *Banking Act 1959 (Cth)* is in force.

15. DEPOSIT BOND

15.1 This general condition only applies if the applicable box in the particulars of sale is checked.

15.2 In this general condition "deposit bond" means an irrevocable undertaking to pay on demand an amount equal to the deposit or any unpaid part of the deposit. The issuer and the form of the deposit bond must be satisfactory to the vendor. The deposit bond must have an expiry date at least 45 days after the due date for settlement.

15.3 The purchaser may deliver a deposit bond to the vendor's estate agent, legal practitioner or conveyancer within 7 days after the day of sale.

15.4 The purchaser may at least 45 days before a current deposit bond expires deliver a replacement deposit bond on the same terms and conditions.

15.5 Where a deposit bond is delivered, the purchaser must pay the deposit to the vendor's legal practitioner or conveyancer on the first to occur of:

- (a) settlement;
- (b) the date that is 45 days before the deposit bond or any replacement deposit bond expires;
- (c) the date on which this contract ends in accordance with general condition 35.2 [default not remedied] following breach by the purchaser; and
- (d) the date on which the vendor ends this contract by accepting repudiation of it by the purchaser.

15.6 The vendor may claim on the deposit bond without prior notice if the purchaser defaults under this contract or repudiates this contract and the contract is ended. The amount paid by the issuer satisfies the obligations of the purchaser under general condition 15.5 to the extent of the payment.

15.7 Nothing in this general condition limits the rights of the vendor if the purchaser defaults under this contract or repudiates this contract, except as provided in general condition 15.6.

15.8 This general condition is subject to general condition 14.2 [deposit].

16. BANK GUARANTEE

16.1 This general condition only applies if the applicable box in the particulars of sale is checked.

16.2 In this general condition:

- (a) "bank guarantee" means an unconditional and irrevocable guarantee or undertaking by a bank in a form satisfactory to the vendor to pay on demand any amount under this contract agreed in writing, and
- (b) "bank" means an authorised deposit-taking institution under the *Banking Act 1959 (Cth)*.

16.3 The purchaser may deliver a bank guarantee to the vendor's legal practitioner or conveyancer.

16.4 The purchaser must pay the amount secured by the bank guarantee to the vendor's legal practitioner or conveyancer on the first to occur of:

- (a) settlement;
- (b) the date that is 45 days before the bank guarantee expires;
- (c) the date on which this contract ends in accordance with general condition 35.2 [default not remedied] following breach by the purchaser; and
- (d) the date on which the vendor ends this contract by accepting repudiation of it by the purchaser.

16.5 The vendor must return the bank guarantee document to the purchaser when the purchaser pays the amount secured by the bank guarantee in accordance with general condition 16.4.

16.6 The vendor may claim on the bank guarantee without prior notice if the purchaser defaults under this contract or repudiates this contract and the contract is ended. The amount paid by the bank satisfies the obligations of the purchaser under general condition 16.4 to the extent of the payment.

16.7 Nothing in this general condition limits the rights of the vendor if the purchaser defaults under this contract or repudiates this contract except as provided in general condition 16.6.

16.8 This general condition is subject to general condition 14.2 [deposit].

17. SETTLEMENT

17.1 At settlement:

- (a) the purchaser must pay the balance; and
- (b) the vendor must:
 - (i) do all things necessary to enable the purchaser to become the registered proprietor of the land; and
 - (ii) give either vacant possession or receipt of rents and profits in accordance with the particulars of sale.

17.2 Settlement must be conducted between the hours of 10.00 am and 4.00 pm unless the parties agree otherwise.

17.3 The purchaser must pay all money other than the deposit in accordance with a written direction of the vendor or the vendor's legal practitioner or conveyancer.

18. ELECTRONIC SETTLEMENT

- 18.1 Settlement and lodgement of the instruments necessary to record the purchaser as registered proprietor of the land will be conducted electronically in accordance with the Electronic Conveyancing National Law. This general condition 18 has priority over any other provision of this contract to the extent of any inconsistency.
- 18.2 A party must immediately give written notice if that party reasonably believes that settlement and lodgement can no longer be conducted electronically. General condition 18 ceases to apply from when such a notice is given.
- 18.3 Each party must:
- (a) be, or engage a representative who is, a subscriber for the purposes of the Electronic Conveyancing National Law,
 - (b) ensure that all other persons for whom that party is responsible and who are associated with this transaction are, or engage, a subscriber for the purposes of the Electronic Conveyancing National Law, and
 - (c) conduct the transaction in accordance with the Electronic Conveyancing National Law.
- 18.4 The vendor must open the electronic workspace ("workspace") as soon as reasonably practicable and nominate a date and time for settlement. The inclusion of a specific date and time for settlement in a workspace is not of itself a promise to settle on that date or at that time. The workspace is an electronic address for the service of notices and for written communications for the purposes of any electronic transactions legislation.
- 18.5 This general condition 18.5 applies if there is more than one electronic lodgement network operator in respect of the transaction. In this general condition 18.5 "the transaction" means this sale and purchase and any associated transaction involving any of the same subscribers.
- To the extent that any interoperability rules governing the relationship between electronic lodgement network operators do not provide otherwise:
- (a) the electronic lodgement network operator to conduct all the financial and lodgement aspects of the transaction after the workspace locks must be one which is willing and able to conduct such aspects of the transaction in accordance with the instructions of all the subscribers in the workspaces of all the electronic lodgement network operators after the workspace locks;
 - (b) if two or more electronic lodgement network operators meet that description, one may be selected by purchaser's incoming mortgagee having the highest priority but if there is no mortgagee of the purchaser, the vendor must make the selection.
- 18.6 Settlement occurs when the workspace records that:
- (a) there has been an exchange of funds or value between the exchange settlement account or accounts in the Reserve Bank of Australia of the relevant financial institutions or their financial settlement agents in accordance with the instructions of the parties; or
 - (b) if there is no exchange of funds or value, the documents necessary to enable the purchaser to become registered proprietor of the land have been accepted for electronic lodgement.
- 18.7 The parties must do everything reasonably necessary to effect settlement:
- (a) electronically on the next business day, or
 - (b) at the option of either party, otherwise than electronically as soon as possible –

if, after the locking of the workspace at the nominated settlement time, settlement in accordance with general condition 18.6 has not occurred by 4.00 pm, or 6.00 pm if the nominated time for settlement is after 4.00 pm.

18.8 Each party must do everything reasonably necessary to assist the other party to trace and identify the recipient of any missing or mistaken payment and to recover the missing or mistaken payment.

18.9 The vendor must before settlement:

- (a) deliver any keys, security devices and codes ("keys") to the estate agent named in the contract,
- (b) direct the estate agent to give the keys to the purchaser or the purchaser's nominee on notification of settlement by the vendor, the vendor's subscriber or the electronic lodgement network operator;
- (c) deliver all other physical documents and items (other than the goods sold by the contract) to which the purchaser is entitled at settlement, and any keys if not delivered to the estate agent, to the vendor's subscriber or, if there is no vendor's subscriber, confirm in writing to the purchaser that the vendor holds those documents, items and keys at the vendor's address set out in the contract, and

give, or direct its subscriber to give, all those documents and items and any such keys to the purchaser or the purchaser's nominee on notification by the electronic lodgement network operator of settlement.

19. GST

19.1 The purchaser does not have to pay the vendor any amount in respect of GST in addition to the price if the particulars of sale specify that the price includes GST (if any).

19.2 The purchaser must pay to the vendor any GST payable by the vendor in respect of a taxable supply made under this contract in addition to the price if:

- (a) the particulars of sale specify that GST (if any) must be paid in addition to the price; or
- (b) GST is payable solely as a result of any action taken or intended to be taken by the purchaser after the day of sale, including a change of use; or
- (c) the particulars of sale specify that the supply made under this contract is of land on which a 'farming business' is carried on and the supply (or part of it) does not satisfy the requirements of section 38-480 of the GST Act; or
- (d) the particulars of sale specify that the supply made under this contract is of a going concern and the supply (or a part of it) does not satisfy the requirements of section 38-325 of the GST Act.

19.3 The purchaser is not obliged to pay any GST under this contract until a tax invoice has been given to the purchaser.

19.4 If the particulars of sale specify that the supply made under this contract is of land on which a 'farming business' is carried on:

- (a) the vendor warrants that the property is land on which a farming business has been carried on for the period of 5 years preceding the date of supply; and
- (b) the purchaser warrants that the purchaser intends that a farming business will be carried on after settlement on the property.

19.5 If the particulars of sale specify that the supply made under this contract is a 'going concern':

- (a) the parties agree that this contract is for the supply of a going concern; and
- (b) the purchaser warrants that the purchaser is, or prior to settlement will be, registered for GST; and
- (c) the vendor warrants that the vendor will carry on the going concern until the date of supply.

19.6 If the particulars of sale specify that the supply made under this contract is a 'margin scheme' supply, the parties agree that the margin scheme applies to this contract.

19.7 In this general condition:

- (a) 'GST Act' means *A New Tax System (Goods and Services Tax) Act 1999* (Cth); and
- (b) 'GST' includes penalties and interest.

20. LOAN

20.1 If the particulars of sale specify that this contract is subject to a loan being approved, this contract is subject to the lender approving the loan on the security of the property by the approval date or any later date allowed by the vendor.

20.2 The purchaser may end the contract if the loan is not approved by the approval date, but only if the purchaser:

- (a) immediately applied for the loan; and
- (b) did everything reasonably required to obtain approval of the loan; and
- (c) serves written notice ending the contract, together with written evidence of rejection or non-approval of the loan, on the vendor within 2 clear business days after the approval date or any later date allowed by the vendor; and
- (d) is not in default under any other condition of this contract when the notice is given.

20.3 All money must be immediately refunded to the purchaser if the contract is ended.

21. BUILDING REPORT

21.1 This general condition only applies if the applicable box in the particulars of sale is checked.

21.2 The purchaser may end this contract within 14 days from the day of sale if the purchaser:

- (a) obtains a written report from a registered building practitioner or architect which discloses a current defect in a structure on the land and designates it as a major building defect;
- (b) gives the vendor a copy of the report and a written notice ending this contract; and
- (c) is not then in default.

21.3 All money paid must be immediately refunded to the purchaser if the contract ends in accordance with this general condition.

21.4 A notice under this general condition may be served on the vendor's legal practitioner, conveyancer or estate agent even if the estate agent's authority has formally expired at the time of service.

21.5 The registered building practitioner may inspect the property at any reasonable time for the purpose of preparing the report.

22. PEST REPORT

- 22.1 This general condition only applies if the applicable box in the particulars of sale is checked.
- 22.2 The purchaser may end this contract within 14 days from the day of sale if the purchaser:
- (a) obtains a written report from a pest control operator licensed under Victorian law which discloses a current pest infestation on the land and designates it as a major infestation affecting the structure of a building on the land;
 - (b) gives the vendor a copy of the report and a written notice ending this contract; and
 - (c) is not then in default.
- 22.3 All money paid must be immediately refunded to the purchaser if the contract ends in accordance with this general condition.
- 22.4 A notice under this general condition may be served on the vendor's legal practitioner, conveyancer or estate agent even if the estate agent's authority has formally expired at the time of service.
- 22.5 The pest control operator may inspect the property at any reasonable time for the purpose of preparing the report.

23. ADJUSTMENTS

- 23.1 All periodic outgoings payable by the vendor, and any rent and other income received in respect of the property must be apportioned between the parties on the settlement date and any adjustments paid and received as appropriate.
- 23.2 The periodic outgoings and rent and other income must be apportioned on the following basis:
- (a) the vendor is liable for the periodic outgoings and entitled to the rent and other income up to and including the day of settlement; and
 - (b) the land is treated as the only land of which the vendor is owner (as defined in the *Land Tax Act* 2005); and
 - (c) the vendor is taken to own the land as a resident Australian beneficial owner; and
 - (d) any personal statutory benefit available to each party is disregarded in calculating apportionment.
- 23.3 The purchaser must provide copies of all certificates and other information used to calculate the adjustments under general condition 23, if requested by the vendor.

24. FOREIGN RESIDENT CAPITAL GAINS WITHHOLDING

- 24.1 Words defined or used in Subdivision 14-D of Schedule 1 to the *Taxation Administration Act 1953 (Cth)* have the same meaning in this general condition unless the context requires otherwise.
- 24.2 Every vendor under this contract is a foreign resident for the purposes of this general condition unless the vendor gives the purchaser a clearance certificate issued by the Commissioner under section 14-220 (1) of Schedule 1 to the *Taxation Administration Act 1953 (Cth)*. The specified period in the clearance certificate must include the actual date of settlement.
- 24.3 The remaining provisions of this general condition 24 only apply if the purchaser is required to pay the Commissioner an amount in accordance with section 14-200(3) or section 14-235 of Schedule 1 to the *Taxation Administration Act 1953 (Cth)* ("the amount") because one or more of the vendors is a foreign

resident, the property has or will have a market value not less than the amount set out in section 14-215 of the legislation just after the transaction, and the transaction is not excluded under section 14-215(1) of the legislation.

24.4 The amount is to be deducted from the vendor's entitlement to the contract consideration. The vendor must pay to the purchaser at settlement such part of the amount as is represented by non-monetary consideration.

24.5 The purchaser must:

- (a) engage a legal practitioner or conveyancer ("representative") to conduct all the legal aspects of settlement, including the performance of the purchaser's obligations under the legislation and this general condition; and
- (b) ensure that the representative does so.

24.6 The terms of the representative's engagement are taken to include instructions to have regard to the vendor's interests and instructions that the representative must:

- (a) pay, or ensure payment of, the amount to the Commissioner in the manner required by the Commissioner and as soon as reasonably and practicably possible, from moneys under the control or direction of the representative in accordance with this general condition if the sale of the property settles;
- (b) promptly provide the vendor with proof of payment; and
- (c) otherwise comply, or ensure compliance, with this general condition;

despite:

- (d) any contrary instructions, other than from both the purchaser and the vendor; and
- (e) any other provision in this contract to the contrary.

24.7 The representative is taken to have complied with the requirements of general condition 24.6 if:

- (a) the settlement is conducted through an electronic lodgment network; and
- (b) the amount is included in the settlement statement requiring payment to the Commissioner in respect of this transaction.

24.8 Any clearance certificate or document evidencing variation of the amount in accordance with section 14-235(2) of Schedule 1 to the *Taxation Administration Act 1953 (Cth)* must be given to the purchaser at least 5 business days before the due date for settlement.

24.9 The vendor must provide the purchaser with such information as the purchaser requires to comply with the purchaser's obligation to pay the amount in accordance with section 14-200 of Schedule 1 to the *Taxation Administration Act 1953 (Cth)*. The information must be provided within 5 business days of request by the purchaser. The vendor warrants that the information the vendor provides is true and correct.

24.10 The purchaser is responsible for any penalties or interest payable to the Commissioner on account of late payment of the amount.

25. GST WITHHOLDING

25.1 Words and expressions defined or used in Subdivision 14-E of Schedule 1 to the *Taxation Administration Act 1953 (Cth)* or in *A New Tax System (Goods and Services Tax) Act 1999 (Cth)* have the same meaning in this general condition unless the context requires otherwise. Words and expressions

first used in this general condition and shown in italics and marked with an asterisk are defined or described in at least one of those Acts.

- 25.2 The purchaser must notify the vendor in writing of the name of the recipient of the *supply for the purposes of section 14-255 of Schedule 1 to the *Taxation Administration Act 1953 (Cth)* at least 21 days before the due date for settlement unless the recipient is the purchaser named in the contract.
- 25.3 The vendor must at least 14 days before the due date for settlement provide the purchaser and any person nominated by the purchaser under general condition 4 with a GST withholding notice in accordance with section 14-255 of Schedule 1 to the *Taxation Administration Act 1953 (Cth)*, and must provide all information required by the purchaser or any person so nominated to confirm the accuracy of the notice.
- 25.4 The remaining provisions of this general condition 25 apply if the purchaser is or may be required to pay the Commissioner an *amount in accordance with section 14-250 of Schedule 1 to the *Taxation Administration Act 1953 (Cth)* because the property is *new residential premises or *potential residential land in either case falling within the parameters of that section, and also if the sale attracts the operation of section 14-255 of the legislation. Nothing in this general condition 25 is to be taken as relieving the vendor from compliance with section 14-255.
- 25.5 The amount is to be deducted from the vendor's entitlement to the contract *consideration and is then taken to be paid to the vendor, whether or not the vendor provides the purchaser with a GST withholding notice in accordance with section 14-255 of Schedule 1 to the *Taxation Administration Act 1953 (Cth)*. The vendor must pay to the purchaser at settlement such part of the amount as is represented by non-monetary consideration.
- 25.6 The purchaser must:
- (a) engage a legal practitioner or conveyancer ("representative") to conduct all the legal aspects of settlement, including the performance of the purchaser's obligations under the legislation and this general condition; and
 - (b) ensure that the representative does so.
- 25.7 The terms of the representative's engagement are taken to include instructions to have regard to the vendor's interests relating to the payment of the amount to the Commissioner and instructions that the representative must:
- (a) pay, or ensure payment of, the amount to the Commissioner in the manner required by the Commissioner and as soon as reasonably and practicably possible, from moneys under the control or direction of the representative in accordance with this general condition on settlement of the sale of the property;
 - (b) promptly provide the vendor with evidence of payment, including any notification or other document provided by the purchaser to the Commissioner relating to payment; and
 - (c) otherwise comply, or ensure compliance, with this general condition;
- despite:
- (d) any contrary instructions, other than from both the purchaser and the vendor; and
 - (e) any other provision in this contract to the contrary.
- 25.8 The representative is taken to have complied with the requirements of general condition 25.7 if:
- (a) settlement is conducted through an electronic lodgment network; and

- (b) the amount is included in the settlement statement requiring payment to the Commissioner in respect of this transaction.

25.9 The purchaser may at settlement give the vendor a bank cheque for the amount in accordance with section 16-30 (3) of Schedule 1 to the *Taxation Administration Act 1953 (Cth)*, but only if:

- (a) so agreed by the vendor in writing; and
- (b) the settlement is not conducted through an electronic lodgment network.

However, if the purchaser gives the bank cheque in accordance with this general condition 25.9, the vendor must:

- (c) immediately after settlement provide the bank cheque to the Commissioner to pay the amount in relation to the supply; and
- (d) give the purchaser a receipt for the bank cheque which identifies the transaction and includes particulars of the bank cheque, at the same time the purchaser gives the vendor the bank cheque.

25.10 A party must provide the other party with such information as the other party requires to:

- (a) decide if an amount is required to be paid or the quantum of it, or
- (b) comply with the purchaser's obligation to pay the amount,

in accordance with section 14-250 of Schedule 1 to the *Taxation Administration Act 1953 (Cth)*. The information must be provided within 5 business days of a written request. The party providing the information warrants that it is true and correct.

25.11 The vendor warrants that:

- (a) at settlement, the property is not new residential premises or potential residential land in either case falling within the parameters of section 14-250 of Schedule 1 to the *Taxation Administration Act 1953 (Cth)* if the vendor gives the purchaser a written notice under section 14-255 to the effect that the purchaser will not be required to make a payment under section 14-250 in respect of the supply, or fails to give a written notice as required by and within the time specified in section 14-255; and
- (b) the amount described in a written notice given by the vendor to the purchaser under section 14-255 of Schedule 1 to the *Taxation Administration Act 1953 (Cth)* is the correct amount required to be paid under section 14-250 of the legislation.

25.12 The purchaser is responsible for any penalties or interest payable to the Commissioner on account of non-payment or late payment of the amount, except to the extent that:

- (a) the penalties or interest arise from any failure on the part of the vendor, including breach of a warranty in general condition 25.11; or
- (b) the purchaser has a reasonable belief that the property is neither new residential premises nor potential residential land requiring the purchaser to pay an amount to the Commissioner in accordance with section 14-250 (1) of Schedule 1 to the *Taxation Administration Act 1953 (Cth)*.

The vendor is responsible for any penalties or interest payable to the Commissioner on account of non-payment or late payment of the amount if either exception applies.

Transactional

26. TIME & CO OPERATION

- 26.1 Time is of the essence of this contract.
- 26.2 Time is extended until the next business day if the time for performing any action falls on a day which is not a business day.
- 26.3 Each party must do all things reasonably necessary to enable this contract to proceed to settlement, and must act in a prompt and efficient manner.
- 26.4 Any unfulfilled obligation will not merge on settlement.

27. SERVICE

- 27.1 Any document required to be served by or on any party may be served by or on the legal practitioner or conveyancer for that party.
- 27.2 A cooling off notice under section 31 of the *Sale of Land Act 1962* or a notice under general condition 20 [loan approval], 21 [building report] or 22 [pest report] may be served on the vendor's legal practitioner, conveyancer or estate agent even if the estate agent's authority has formally expired at the time of service.
- 27.3 A document is sufficiently served:
 - (a) personally, or
 - (b) by pre-paid post, or
 - (c) in any manner authorized by law or by the Supreme Court for service of documents, including any manner authorised for service on or by a legal practitioner, whether or not the person serving or receiving the document is a legal practitioner, or
 - (d) by email.
- 27.4 Any document properly sent by:
 - (a) express post is taken to have been served on the next business day after posting, unless proved otherwise;
 - (b) priority post is taken to have been served on the fourth business day after posting, unless proved otherwise;
 - (c) regular post is taken to have been served on the sixth business day after posting, unless proved otherwise;
 - (d) email is taken to have been served at the time of receipt within the meaning of section 13A of the *Electronic Transactions (Victoria) Act 2000*.

- 27.5 In this contract 'document' includes 'demand' and 'notice', 'serve' includes 'give', and 'served' and 'service' have corresponding meanings.

28. NOTICES

- 28.1 The vendor is responsible for any notice, order, demand or levy imposing liability on the property that is issued or made before the day of sale, and does not relate to periodic outgoings.

28.2 The purchaser is responsible for any notice, order, demand or levy imposing liability on the property that is issued or made on or after the day of sale, and does not relate to periodic outgoings.

28.3 The purchaser may enter the property to comply with that responsibility where action is required before settlement.

29. INSPECTION

The purchaser and/or another person authorised by the purchaser may inspect the property at any reasonable time during the 7 days preceding and including the settlement day.

30. TERMS CONTRACT

30.1 If this is a 'terms contract' as defined in the *Sale of Land Act 1962*:

- (a) any mortgage affecting the land sold must be discharged as to that land before the purchaser becomes entitled to possession or to the receipt of rents and profits unless the vendor satisfies section 29M of the *Sale of Land Act 1962*; and
- (b) the deposit and all other money payable under the contract (other than any money payable in excess of the amount required to so discharge the mortgage) must be paid to a legal practitioner or conveyancer or a licensed estate agent to be applied in or towards discharging the mortgage.

30.2 While any money remains owing each of the following applies:

- (a) the purchaser must maintain full damage and destruction insurance of the property and public risk insurance noting all parties having an insurable interest with an insurer approved in writing by the vendor;
- (b) the purchaser must deliver copies of the signed insurance application forms, the policies and the insurance receipts to the vendor not less than 10 days before taking possession of the property or becoming entitled to receipt of the rents and profits;
- (c) the purchaser must deliver copies of any amendments to the policies and the insurance receipts on each amendment or renewal as evidence of the status of the policies from time to time;
- (d) the vendor may pay any renewal premiums or take out the insurance if the purchaser fails to meet these obligations;
- (e) insurance costs paid by the vendor under paragraph (d) must be refunded by the purchaser on demand without affecting the vendor's other rights under this contract;
- (f) the purchaser must maintain and operate the property in good repair (fair wear and tear excepted) and keep the property safe, lawful, structurally sound, weatherproof and free from contaminations and dangerous substances;
- (g) the property must not be altered in any way without the written consent of the vendor which must not be unreasonably refused or delayed;
- (h) the purchaser must observe all obligations that affect owners or occupiers of land;
- (i) the vendor and/or other person authorised by the vendor may enter the property at any reasonable time to inspect it on giving 7 days written notice, but not more than twice in a year.

31. LOSS OR DAMAGE BEFORE SETTLEMENT

31.1 The vendor carries the risk of loss or damage to the property until settlement.

31.2 The vendor must deliver the property to the purchaser at settlement in the same condition it was in on the day of sale, except for fair wear and tear.

- 31.3 The purchaser must not delay settlement because one or more of the goods is not in the condition required by general condition 31.2 but may claim compensation from the vendor after settlement.
- 31.4 The purchaser may nominate an amount not exceeding \$5,000 to be held by a stakeholder to be appointed by the parties if the property is not in the condition required by general condition 31.2 at settlement.
- 31.5 The nominated amount may be deducted from the amount due to the vendor at settlement and paid to the stakeholder, but only if the purchaser also pays an amount equal to the nominated amount to the stakeholder.
- 31.6 The stakeholder must pay the amounts referred to in general condition 31.5 in accordance with the determination of the dispute, including any order for payment of the costs of the resolution of the dispute.

32. BREACH

A party who breaches this contract must pay to the other party on demand:

- (a) compensation for any reasonably foreseeable loss to the other party resulting from the breach; and
- (b) any interest due under this contract as a result of the breach.

Default

33. INTEREST

Interest at a rate of 2% per annum plus the rate for the time being fixed by section 2 of the *Penalty Interest Rates Act 1983* is payable at settlement on any money owing under the contract during the period of default, without affecting any other rights of the offended party.

34. DEFAULT NOTICE

- 34.1 A party is not entitled to exercise any rights arising from the other party's default, other than the right to receive interest and the right to sue for money owing, until the other party is given and fails to comply with a written default notice.
- 34.2 The default notice must:
- (a) specify the particulars of the default; and
 - (b) state that it is the offended party's intention to exercise the rights arising from the default unless, within 14 days of the notice being given -
 - (i) the default is remedied; and
 - (ii) the reasonable costs incurred as a result of the default and any interest payable are paid.

35. DEFAULT NOT REMEDIED

- 35.1 All unpaid money under the contract becomes immediately payable to the vendor if the default has been made by the purchaser and is not remedied and the costs and interest are not paid.
- 35.2 The contract immediately ends if:
- (a) the default notice also states that unless the default is remedied and the reasonable costs and interest are paid, the contract will be ended in accordance with this general condition; and
 - (b) the default is not remedied and the reasonable costs and interest are not paid by the end of the period of the default notice.

35.3 If the contract ends by a default notice given by the purchaser:

- (a) the purchaser must be repaid any money paid under the contract and be paid any interest and reasonable costs payable under the contract; and
- (b) all those amounts are a charge on the land until payment; and
- (c) the purchaser may also recover any loss otherwise recoverable.

35.4 If the contract ends by a default notice given by the vendor:

- (a) the deposit up to 10% of the price is forfeited to the vendor as the vendor's absolute property, whether the deposit has been paid or not; and
- (b) the vendor is entitled to possession of the property; and
- (c) in addition to any other remedy, the vendor may within one year of the contract ending either:
 - (i) retain the property and sue for damages for breach of contract; or
 - (ii) resell the property in any manner and recover any deficiency in the price on the resale and any resulting expenses by way of liquidated damages; and
- (d) the vendor may retain any part of the price paid until the vendor's damages have been determined and may apply that money towards those damages; and
- (e) any determination of the vendor's damages must take into account the amount forfeited to the vendor.

35.5 The ending of the contract does not affect the rights of the offended party as a consequence of the default.

GUARANTEE and INDEMNITY

I/We		of	
And		of	
being the Sole Director / Directors of			ACN

(Called the "Guarantors") IN CONSIDERATION of the Vendor selling to the Purchaser at our request the Land described in this Contract of Sale for the price and upon the terms and conditions contained therein **DO** for ourselves and our respective executors and administrators **JOINTLY AND SEVERALLY COVENANT** with the said Vendor and their assigns that if at any time default shall be made in payment of the Deposit Money or residue of Purchase Money or interest or any other moneys payable by the Purchaser to the Vendor under this Contract or in the performance or observance of any term or condition of this Contract to be performed or observed by the Purchaser I/we will immediately on demand by the Vendor pay to the Vendor the whole of the Deposit Money, residue of Purchase Money, interest or other moneys which shall then be due and payable to the Vendor and indemnify and agree to keep the Vendor indemnified against all loss of Deposit Money, residue of Purchase Money, interest and other moneys payable under the within Contract and all losses, costs, charges and expenses whatsoever which the Vendor may incur by reason of any default on the part of the Purchaser. This Guarantee shall be a continuing Guarantee and Indemnity and shall not be released by:-

- a) any neglect or forbearance on the part of the Vendor in enforcing payment of any of the moneys payable under the within Contract;
- b) the performance or observance of any of the agreements, obligations or conditions under the within Contract;
- c) by time given to the Purchaser for any such payment performance or observance;
- d) by reason of the Vendor assigning his, her or their rights under the said Contract; and
- e) by any other thing which under the law relating to sureties would but for this provision have the effect of releasing me/us, my/our executors or administrators.

IN WITNESS whereof the parties hereto have set their hands and seals

This Day of 20

SIGNED SEALED AND DELIVERED by the said

Print Name

In the presence of

Witness

Director(Sign)

SIGNED SEALED AND DELIVERED by the said

Print Name

In the presence of

Witness

Director(Sign)

SECTION 27 STATEMENT

VENDORS DEPOSIT STATEMENT TO THE PURCHASER PURSUANT TO SECTION 27 OF THE SALE OF LAND ACT, 1962.

VENDOR: Joseph Falvo

PROPERTY: 13 Newton Street THOMASTOWN VIC 3074

1. The Property is subject to Mortgage(s), particulars of which are as follows:

(a) Mortgagee (s): BANKWEST

of:..

(b) Amount secured \$.....
Instalments \$..... per.....

Amount required to discharge the Mortgage \$.....
(THIS AMOUNT INCLUDES OUTSTANDING RATES, TAXES OR CHARGES DUE TO ANY STATUTORY BODY,
OR OTHER CHARGE FOR MONEY'S OWING)

(c) Rate of interest payable% p.a.
Default rate% p.a.

(d) Due date of repayment of Mortgage(s):/...../2025
(UNLESS THE MORTGAGE DEMANDS EARLY REPAYMENT UPON BREACH OF ITS CONDITIONS.)

(e) The Mortgage does *does not provide for further advances *as follows:

.....

(f) The Vendor is not in default under the Mortgage.

(g) The Mortgagee has not consented to the Purchaser assuming the Vendor's obligations under the Mortgage.

2. There is no Caveat lodged against the title to the Property under the Transfer of Land Act, 1958.

DATE OF VENDOR'S STATEMENT/...../2025

SIGNATURE OF VENDOR(S)

ACKNOWLEDGMENT OF RECEIPT OF VENDOR'S SECTION 27 STATEMENT

The Purchaser HEREBY ACKNOWLEDGES receipt of a copy of this Statement.

DATE OF RECEIPT/...../2025

SIGNATURE OF PURCHASER(S)

RELEASE OF THE DEPOSIT BY THE PURCHASER(S)

1. The Purchaser HEREBY ACKNOWLEDGES that:

- A. The particulars provided by the Vendors in this Statement are accurate.
- B. The particulars given indicate that the purchase price is sufficient to discharge all Mortgages over the property.
- C. The Contract is not subject to any condition enuring for the benefit of the Purchaser.

2. The Purchaser FURTHER ACKNOWLEDGES that he has received satisfactory answers to
Requisitions on Title or is otherwise deemed to have accepted title.

DATE OF PURCHASER'S RELEASE/...../2025

SIGNATURE OF PURCHASER(S)

SCHEDULE 1

GENERAL RULES FOR THE CONDUCT OF PUBLIC AUCTIONS OF LAND

1. The auctioneer may make one or more bids on behalf of the vendor of the land at any time during the auction.
2. The auctioneer may refuse any bid.
3. The auctioneer may determine the amount by which the bidding is to be advanced.
4. The auctioneer may withdraw the property from sale at any time.
5. The auctioneer may refer a bid to the vendor at any time before the conclusion of the auction.
6. In the event of a dispute concerning a bid, the auctioneer may resubmit the property for sale at the last undisputed bid or start the bidding again.
7. The auctioneer must not accept any bid or offer for a property that is made after the property has been knocked down to the successful bidder, unless the vendor or successful bidder at the auction refuses to sign the contract of sale following the auction.
8. If a reserve price has been set for the property and the property is passed in below that reserve price, the vendor will first negotiate with the highest bidder for the purchase of the property.

INFORMATION CONCERNING THE CONDUCT OF PUBLIC AUCTIONS OF LAND

Meaning of Vendor

The vendor is the person who is selling the property that is being auctioned. There may be more than one vendor. Where there are two or more vendors, they are selling the property as co-owners.

Bidding by Co-owners

Where there are two or more vendors of the property, one or some or all of them may bid to purchase the property from their co-owners. The vendor or vendors intending to bid to purchase the property can make these bids themselves, or through a representative, but not through the auctioneer.

Vendor bids

The law of Victoria allows vendors to choose to have bids made for them by the auctioneer. If this is the case, it will be stated as the first rule applying to the auction. However, these bids cannot be made for a co-owner intending to bid to purchase the property from their co-owner or co-owners.

The auctioneer can only make a vendor bid if—

- the auctioneer declares before bidding starts that he or she can make bids on behalf of a vendor, and states how these bids will be made; and
- the auctioneer states when making the bid that it is a bid for the vendors. The usual way for an auctioneer to indicate that he or she is making a vendor bid is to say "vendor bid" in making the bid.

What rules and conditions apply to the auction?

Different rules apply to an auction depending upon whether there are any co-owners intending to bid to purchase the property from their co-owners, and whether vendor bids can be made. The auctioneer must display the rules that apply at the auction.

It is possible that a vendor may choose to have additional conditions apply at the auction. This is only allowed if those additional conditions do not conflict with the rules that apply to the auction or any other legal requirement. The additional conditions are usually contained in the contract of sale.

Copies of the rules

The law requires that a copy of the rules and conditions that are to apply to a public auction of land be made available for public inspection a reasonable time before the auction starts and, in any case, not less than 30 minutes before the auction starts.

Questions

A person at a public auction of land may ask the auctioneer in good faith a reasonable number of questions about the property being sold, the contract of sale, the rules under which the auction is being conducted and the conduct of the auction.

Forbidden activities at auctions

The law forbids—

- any person bidding for a vendor other than --
 - the auctioneer (who can only make bids for a vendor who does not intend to purchase the property from their co-owner or co-owners); or
 - a representative of a vendor who is a co-owner of the property wishing to purchase the property from their co-owner or co-owners.
- the auctioneer taking any bid that he or she knows was made on behalf of the vendor, unless it is made by a vendor (or their representative) who is a co-owner wishing to purchase the property.
- the auctioneer acknowledging a bid if no bid was made.
- any person asking another person to bid on behalf of the vendor, other than a vendor who is a co-owner engaging a representative to bid for them.
- any person falsely claiming or falsely acknowledging that he or she made a bid.
- an intending bidder (or a person acting on behalf of an intending bidder) harassing or interfering with other bidders at a public auction of land.

Substantial penalties apply to any person who does any of the things in this list.

Who made the bid?

At any time during a public auction of land, a person at the auction may ask the auctioneer to indicate who made a bid. Once such a request has been made, the auctioneer is obliged by law to comply with such a request before taking another bid.

It is an offence to disrupt an auction

The law forbids an intending bidder or a person acting on behalf of an intending bidder from doing anything with the intention of preventing or causing a major disruption to, or causing the cancellation of, a public auction of land.

INFORMATION ONLY

NOTICE TO PURCHASER

PURSUANT TO SECTION 14-250 SCHEDULE 1
OF THE TAXATION ADMINISTRATION ACT 1953 (CTH) (Act)
AND SPECIAL CONDITION ID

Purchaser GST Withholding Obligations

The Vendor hereby gives Notice that the Vendor warrants and confirms that the Property the subject of this Contract of Sale is NOT new residential premises or potential residential land as defined in section 14-250 of the Act and the Purchaser has no GST withholding obligations.

Due diligence checklist

What you need to know before buying a residential property

Before you buy a home, you should be aware of a range of issues that may affect that property and impose restrictions or obligations on you, if you buy it. This checklist aims to help you identify whether any of these issues will affect you. The questions are a starting point only and you may need to seek professional advice to answer some of them. You can find links to organisations and web pages that can help you learn more, by visiting the [Due diligence checklist page on the Consumer Affairs Victoria website](http://consumer.vic.gov.au/duediligencechecklist) (consumer.vic.gov.au/duediligencechecklist).

Urban living

Moving to the inner city?

High density areas are attractive for their entertainment and service areas, but these activities create increased traffic as well as noise and odours from businesses and people. Familiarising yourself with the character of the area will give you a balanced understanding of what to expect.

Is the property subject to an owners corporation?

If the property is part of a subdivision with common property such as driveways or grounds, it may be subject to an owners corporation. You may be required to pay fees and follow rules that restrict what you can do on your property, such as a ban on pet ownership.

Growth areas

Are you moving to a growth area?

You should investigate whether you will be required to pay a growth areas infrastructure contribution.

Flood and fire risk

Does this property experience flooding or bushfire?

Properties are sometimes subject to the risk of fire and flooding due to their location. You should properly investigate these risks and consider their implications for land management, buildings and insurance premiums.

Rural properties

Moving to the country?

If you are looking at property in a rural zone, consider:

- Is the surrounding land use compatible with your lifestyle expectations? Farming can create noise or odour that may be at odds with your expectations of a rural lifestyle.
- Are you considering removing native vegetation? There are regulations which affect your ability to remove native vegetation on private property.
- Do you understand your obligations to manage weeds and pest animals?

Can you build new dwellings?

Does the property adjoin crown land, have a water frontage, contain a disused government road, or are there any crown licences associated with the land?

Is there any earth resource activity such as mining in the area?

You may wish to find out more about exploration, mining and quarrying activity on or near the property and consider the issue of petroleum, geothermal and greenhouse gas sequestration permits, leases and licences, extractive industry authorisations and mineral licences.

Soil and groundwater contamination

Has previous land use affected the soil or groundwater?

You should consider whether past activities, including the use of adjacent land, may have caused contamination at the site and whether this may prevent you from doing certain things to or on the land in the future.

(04/10/2016)

Land boundaries

Do you know the exact boundary of the property?

You should compare the measurements shown on the title document with actual fences and buildings on the property, to make sure the boundaries match. If you have concerns about this, you can speak to your lawyer or conveyancer, or commission a site survey to establish property boundaries.

Planning controls

Can you change how the property is used, or the buildings on it?

All land is subject to a planning scheme, run by the local council. How the property is zoned and any overlays that may apply, will determine how the land can be used. This may restrict such things as whether you can build on vacant land or how you can alter or develop the land and its buildings over time.

The local council can give you advice about the planning scheme, as well as details of any other restrictions that may apply, such as design guidelines or bushfire safety design. There may also be restrictions – known as encumbrances – on the property's title, which prevent you from developing the property. You can find out about encumbrances by looking at the section 32 statement.

Are there any proposed or granted planning permits?

The local council can advise you if there are any proposed or issued planning permits for any properties close by. Significant developments in your area may change the local 'character' (predominant style of the area) and may increase noise or traffic near the property.

Safety

Is the building safe to live in?

Building laws are in place to ensure building safety. Professional building inspections can help you assess the property for electrical safety, possible illegal building work, adequate pool or spa fencing and the presence of asbestos, termites, or other potential hazards.

Building permits

Have any buildings or retaining walls on the property been altered, or do you plan to alter them?

There are laws and regulations about how buildings and retaining walls are constructed, which you may wish to investigate to ensure any completed or proposed building work is approved. The local council may be able to give you information about any building permits issued for recent building works done to the property, and what you must do to plan new work. You can also commission a private building surveyor's assessment.

Are any recent building or renovation works covered by insurance?

Ask the vendor if there is any owner-builder insurance or builder's warranty to cover defects in the work done to the property.

Utilities and essential services

Does the property have working connections for water, sewerage, electricity, gas, telephone and internet?

Unconnected services may not be available, or may incur a fee to connect. You may also need to choose from a range of suppliers for these services. This may be particularly important in rural areas where some services are not available.

Buyers' rights

Do you know your rights when buying a property?

The contract of sale and section 32 statement contain important information about the property, so you should request to see these and read them thoroughly. Many people engage a lawyer or conveyancer to help them understand the contracts and ensure the sale goes through correctly. If you intend to hire a professional, you should consider speaking to them before you commit to the sale. There are also important rules about the way private sales and auctions are conducted. These may include a cooling-off period and specific rights associated with 'off the plan' sales. The important thing to remember is that, as the buyer, you have rights.

Vendor Statement

The vendor makes this statement in respect of the land in accordance with section 32 of the *Sale of Land Act 1962*.

This statement must be signed by the vendor and given to the purchaser before the purchaser signs the contract.

The vendor may sign by electronic signature.

The purchaser acknowledges being given this statement signed by the vendor with the attached documents before the purchaser signed any contract.

Land	13 Newton Street THOMASTOWN VIC 3074
------	--------------------------------------

Vendor's name	Joseph Falvo	Date	24 / 6 / 25
Vendor's signature	<u>J. Falvo</u>		
Vendor's name	JOSEPH FALVO	Date	24 / 6 / 25
Vendor's signature	<u>J. Falvo</u>		

Purchaser's name	Date
Purchaser's signature	/ /
<hr/>	
Purchaser's name	Date
Purchaser's signature	/ /
<hr/>	

1. FINANCIAL MATTERS

1.1 Particulars of any Rates, Taxes, Charges or Other Similar Outgoings (and any interest on them)

- (a) ☐ Their total does not exceed:

\$

OR

- (b) ☐ Are contained in the attached certificate/s.

OR

- (c) ☒ Their amounts are:

Authority	Amount	Interest (if any)
(1) Whittlesea City Council	(1) \$ See attached	(1) \$
(2) Yarra Valley Water	(2) \$ See attached	(2) \$
(3)	(3) \$ See attached	(3) \$
(4)	(4) \$	(4) \$

- (d) ☐ There are NO amounts for which the purchaser may become liable as a consequence of the sale of which the vendor might reasonably be expected to have knowledge, which are not included in the items above; other than any amounts described in this rectangular box.

\$

1.2 Particulars of any Charge (whether registered or not) imposed by or under any Act to secure an amount due under that Act, including the amount owing under the charge

\$	To	
----	----	--

Other particulars (including dates and times of payments):

1.3 Terms Contract

This section 1.3 only applies if this vendor statement is in respect of a terms contract where the purchaser is obliged to make 2 or more payments (other than a deposit or final payment) to the vendor after the execution of the contract and before the purchaser is entitled to a conveyance or transfer of the land.

Not applicable

1.4 Sale Subject to Mortgage

This section 1.4 only applies if this vendor statement is in respect of a contract which provides that any mortgage (whether registered or unregistered), is NOT to be discharged before the purchaser becomes entitled to possession or receipts of rents and profits.

Not applicable

1.5 Commercial and Industrial Property Tax Reform Act 2024 (Vic) (CIPT Act)

a) The Australian Valuation Property Classification Code (within the meaning of the CIPT Act) most recently allocated to the land is set out in the attached Municipal rates notice or property clearance certificate or is as follows	AVPC No.
b) Is the land tax reform scheme land within the meaning of the CIPT Act?	<input type="checkbox"/> YES <input checked="" type="checkbox"/> NO
c) If the land is tax reform scheme land within the meaning of the CIPT Act, the entry date within the meaning of the CIPT Act is set out in the attached Municipal rates notice or property clearance certificate or is as follows	Date: OR <input checked="" type="checkbox"/> Not applicable

2. INSURANCE

2.1 Damage and Destruction

This section 2.1 only applies if this vendor statement is in respect of a contract which does NOT provide for the land to remain at the risk of the vendor until the purchaser becomes entitled to possession or receipt of rents and profits.

(a) Attached is a copy or extract of any policy of insurance in respect of any damage to or destruction of the land.

OR

(b) Particulars of any such policy insurance in respect of any damage to or destruction of the land are as follows:

Name of insurance company:	
Type of policy:	Policy no:
Expiry date:	Amount insured:

2.2 Owner Builder

This section 2.2 only applies where there is a residence on the land that was constructed by an owner-builder within the preceding 6 years and section 137B of the Building Act 1993 applies to the residence.

(a) ☐ Attached is a copy or extract of any policy of insurance required under the Building Act 1993.

OR

(b) ☐ Particulars of any required insurance under the Building Act 1993 are as follows:

Name of insurance company:	
Policy no:	Expiry date:

Note: There may be additional legislative obligations in respect of the sale of land on which there is a building or on which building work has been carried out.

3. LAND USE

3.1 Easements, Covenants or Other Similar Restrictions

(a) A description of any easement, covenant or other similar restriction affecting the land (whether registered or unregistered):

☒ Is in the attached copies of title document/s

OR

☐ Is as follows:

--

(b) ☒ Particulars of any existing failure to comply with that easement, covenant or other similar restriction are:

To the best of Vendors knowledge there is no existing failure to comply with the terms of an easement, covenant or other similar restriction. The Purchaser should note that there may be sewers, drains, water pipes, underground and/or overhead electricity cables, underground and/or overhead telephone cables and underground gas pipes laid outside any registered easements and which are not registered or required to be registered against the Certificate of Title.

3.2 Road Access

There is NO access to the property by road if the square box is marked with an 'X'

☐

3.3 Designated Bushfire Prone Area

The land is in a designated bushfire prone area within the meaning of regulations made under the

☐

Building Act 1993 if the square box is marked with an 'X'

3.4 Planning Scheme

☐ Attached is a certificate with the required specified information.

OR

☒ The required specified information is as follows:

(a) Name of planning scheme	See attached
(b) Name of responsible authority	See attached
(c) Zoning of the land	See attached
(d) Name of planning overlay	See attached

4. NOTICES

4.1 Notice, Order, Declaration, Report or Recommendation

Particulars of any notice, order, declaration, report or recommendation of a public authority or government department or approved proposal directly and currently affecting the land, being a notice, order, declaration, report, recommendation or approved proposal of which the vendor might reasonably be expected to have knowledge:

☐ Are contained in the attached certificates and/or statements

OR

☒ Are as follows

Vendor is not aware of nor has she/he received any notices however the Vendor has no means of knowing all decisions of the Government and other authorities unless such decisions have been communicated to the Vendor

4.2 Agricultural Chemicals

There are NO notices, property management plans, reports or orders in respect of the land issued by a government department or public authority in relation to livestock disease or contamination by agricultural chemicals affecting the ongoing use of the land for agricultural purposes. However, if this is not the case, the details of any such notices, property management plans, reports or orders, are as follows:

NIL

4.3 Compulsory Acquisition

The particulars of any notices of intention to acquire that have been served under section 6 of the *Land Acquisition and Compensation Act 1986* are as follows:

NIL

5. BUILDING PERMITS

Particulars of any building permit issued under the *Building Act 1993* in the preceding 7 years (required only where there is a residence on the land):

The Vendor provide no warranties in respect to any alteration, addition or improvements to the property which occurred prior to the Vendor becoming the registered proprietor.

☐ Are contained in the attached certificate

OR

☒ Are as follows:

NIL

6. OWNERS CORPORATION

This section 6 only applies if the land is affected by an owners corporation within the meaning of the *Owners Corporations Act 2006*.

The Land is NOT affected by an Owners Corporation within the meaning of the *Owners Corporation Act 2006*.

7. GROWTH AREAS INFRASTRUCTURE CONTRIBUTION (“GAIC”)

Words and expressions in this section 7 have the same meaning as in Part 9B of the *Planning and Environment Act 1987*.

7.1 Work-in-Kind Agreement

This section 7.1 only applies if the land is subject to a work-in-kind agreement.

- (a) The land is NOT to be transferred under the agreement unless the square box is marked with an 'X' ☐
- (b) The land is NOT land on which works are to be carried out under the agreement (other than Crown land) unless the square box is marked with an 'X' ☐
- (c) The land is NOT land in respect of which a GAIC is imposed unless the square box is marked with an 'X' ☐

7.2 GAIC Recording

This section 7.2 only applies if there is a GAIC recording.

Any of the following certificates or notices must be attached if there is a GAIC recording.

The accompanying boxes marked with an 'X' indicate that such a certificate or notice that is attached:

- (a) Any certificate of release from liability to pay a GAIC ☐
- (b) Any certificate of deferral of the liability to pay the whole or part of a GAIC ☐
- (c) Any certificate of exemption from liability to pay a GAIC ☐
- (d) Any certificate of staged payment approval ☐
- (e) Any certificate of no GAIC liability ☐
- (f) Any notice providing evidence of the grant of a reduction of the whole or part of the liability for a GAIC or an exemption from that liability ☐
- (g) A GAIC certificate issued under Part 9B of the Planning and Environment Act 1987 must be attached if there is no certificate or notice issued under any of sub-sections 7.2 (a) to (f) above ☐

8. SERVICES

The services which are marked with an 'X' in the accompanying square box are NOT connected to the land:

Electricity supply <input type="checkbox"/>	Gas supply <input type="checkbox"/>	Water supply <input type="checkbox"/>	Sewerage <input type="checkbox"/>	Telephone services <input type="checkbox"/>
---	-------------------------------------	---------------------------------------	-----------------------------------	---

Connected indicates that the service is provided by an authority and operating on the day of sale. The Purchaser should be aware that the Vendor may terminate their account with the service provider before settlement, and the Purchaser will have to have the service reconnected.

9. TITLE

Attached are copies of the following documents:

- 9.1 ☒ (a) **Registered Title**

A Register Search Statement and the document, or part of a document, referred to as the “diagram location” in that statement which identifies the land and its location.

10. SUBDIVISION

10.1 Unregistered Subdivision

This section 10.1 only applies if the land is subject to a subdivision which is not registered.

Not applicable

10.2 Staged Subdivision

This section 10.2 only applies if the land is part of a staged subdivision within the meaning of section 37 of the *Subdivision Act 1988*.

Not applicable

10.3 Further Plan of Subdivision

This section 10.3 only applies if the land is subject to a subdivision in respect of which a further plan within the meaning of the *Subdivision Act 1988* is proposed.

Not applicable

11. DISCLOSURE OF ENERGY INFORMATION

(Disclosure of this information is not required under section 32 of the Sale of Land Act 1962 but may be included in this vendor statement for convenience.)

Details of any energy efficiency information required to be disclosed regarding a disclosure affected building or disclosure area affected area of a building as defined by the *Building Energy Efficiency Disclosure Act 2010* (Cth)

- (a) to be a building or part of a building used or capable of being used as an office for administrative, clerical, professional or similar based activities including any support facilities; and
- (b) which has a net lettable area of at least 2000m²; (but does not include a building under a strata title system or if an occupancy permit was issued less than 2 years before the relevant date):

☐ Are contained in the attached building energy efficiency certificate.

OR

☒ Are as follows:

NIL

12. DUE DILIGENCE CHECKLIST

(The Sale of Land Act 1962 provides that the vendor or the vendor's licensed estate agent must make a prescribed due diligence checklist available to purchasers before offering land for sale that is vacant residential land or land on which there is a residence. The due diligence checklist is NOT required to be provided with, or attached to, this vendor statement but the checklist may be attached as a matter of convenience.)

13. ATTACHMENTS

(Any certificates, documents and other attachments may be annexed to this section 13)

(Additional information may be added to this section 13 where there is insufficient space in any of the earlier sections)

(Attached is an "Additional Vendor Statement" if section 1.3 (Terms Contract) or section 1.4 (Sale Subject to Mortgage) applies)

REGISTER SEARCH STATEMENT (Title Search) Transfer of Land Act 1958

Page 1 of 1

VOLUME 08320 FOLIO 973

Security no : 124125369137B
Produced 16/06/2025 03:45 PM

LAND DESCRIPTION

Lot 8 on Plan of Subdivision 041097.
PARENT TITLE Volume 08152 Folio 284
Created by instrument B199953 04/05/1961

REGISTERED PROPRIETOR

Estate Fee Simple
Sole Proprietor
JOSEPH FALVO of 13 NEWTON STREET THOMASTOWN VIC 3074
AV082090F 01/12/2021

ENCUMBRANCES, CAVEATS AND NOTICES

MORTGAGE AY457508G 01/10/2024
COMMONWEALTH BANK OF AUSTRALIA

Any encumbrances created by Section 98 Transfer of Land Act 1958 or Section 24 Subdivision Act 1988 and any other encumbrances shown or entered on the plan or imaged folio set out under DIAGRAM LOCATION below.

DIAGRAM LOCATION

SEE LP041097 FOR FURTHER DETAILS AND BOUNDARIES

ACTIVITY IN THE LAST 125 DAYS

NIL

-----END OF REGISTER SEARCH STATEMENT-----

Additional information: (not part of the Register Search Statement)

Street Address: 13 NEWTON STREET THOMASTOWN VIC 3074

ADMINISTRATIVE NOTICES

NIL

eCT Control 18601V BANKWEST
Effective from 01/10/2024

DOCUMENT END

Imaged Document Cover Sheet

The document following this cover sheet is an imaged document supplied by LANDATA®, Secure Electronic Registries Victoria.

Document Type	Plan
Document Identification	LP041097
Number of Pages (excluding this cover sheet)	1
Document Assembled	21/03/2024 09:31

Copyright and disclaimer notice:

© State of Victoria. This publication is copyright. No part may be reproduced by any process except in accordance with the provisions of the Copyright Act 1968 (Cth) and for the purposes of Section 32 of the Sale of Land Act 1962 or pursuant to a written agreement. The information is only valid at the time and in the form obtained from the LANDATA® System. None of the State of Victoria, LANDATA®, Secure Electronic Registries Victoria Pty Ltd (ABN 86 627 986 396) as trustee for the Secure Electronic Registries Victoria Trust (ABN 83 206 746 897) accept responsibility for any subsequent release, publication or reproduction of the information.

The document is invalid if this cover sheet is removed or altered.

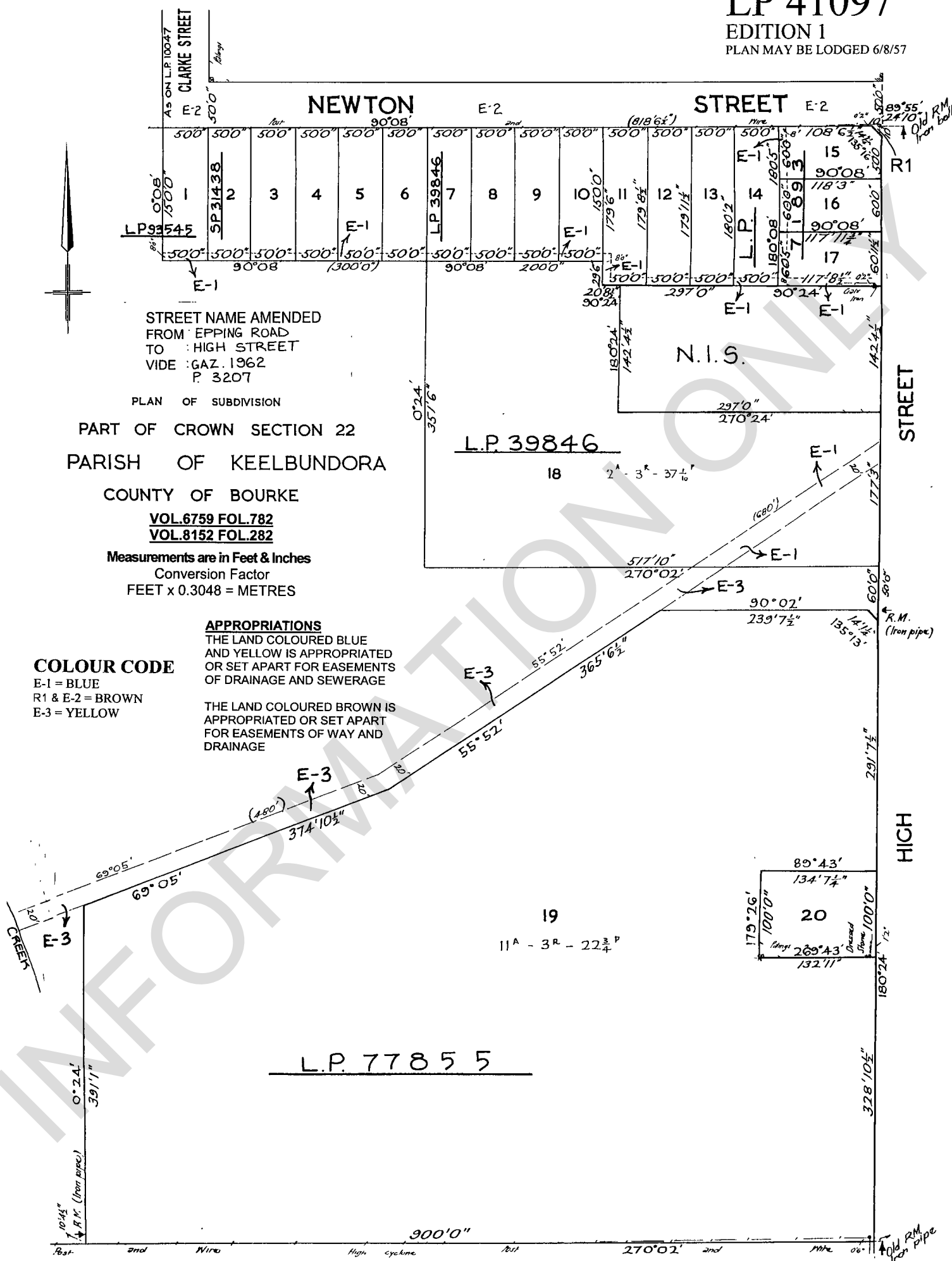

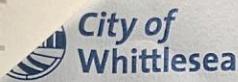

Locked Bag 1,
Bundoora 3083
ABN 72 431 091 058

Instalment notice

For the period 1 July 2024 to 30 June 2025

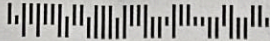

J Falvo
13 Newton Street
THOMASTOWN VIC 3074



029
I017194
DLX2_16721

Assessment number: 0315515

Property details

13 Newton Street THOMASTOWN VIC 3074
LOT 8 LP 41097
AVPCC 110 Detached Dwelling



To receive your rates notice
via email, register at
whittlesea.enotices.com.au
Reference No: 5F211EFD4Z

Issue date: 28/04/2025

Valuation details

Site Value \$550,000
Capital Improved Value \$850,000
Net Annual Value \$42,500
Valuation operative date 01/07/2024
Level of value date 01/01/2024

Rates and charges

Overdue amount	\$0.00
4th instalment	\$630.00
Total Payable by 31/05/2025	\$630.00

Instalments

Amount payable by
31/05/2025

\$630.00

Instalment 4 \$630.00
Due by 31/05/2025

Payments received after 24 April 2025 may not be included on this notice



Scan here to pay

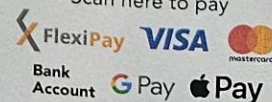

How to pay

- whittlesea.vic.gov.au
- Phone 1300 301 185
- Council Offices
See the back of this notice for
opening hours and locations

BPAY



Billers Code: 5157
Ref: 0315515
BPAY this payment via
internet or phone banking

FlexiPay

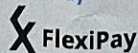

Set up your flexible payment options.
Scan the QR code or visit

whittlesea-pay.enotices.com.au

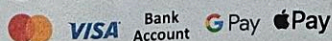

Post Billpay



Billpay Code: 0350
Ref: 3155153

Pay in person at any post office:
 131 816 or postbillpay.com.au
Scan the barcode below and pay
with your iPhone, iPad or Android device.
Download the Australia Post mobile app.



Your quarterly bill



Emailed to: proteklocksmiths@outlook.com
MR J FALVO
13 NEWTON ST
THOMASTOWN VIC 3074

Enquiries	1300 304 688
Faults (24/7)	13 27 62
Account number	11 2101 5729
Invoice number	1123 9616 89982
Issue date	12 May 2025
Property address	13 NEWTON ST THOMASTOWN
Property reference	1225756, LOT 8
Tax Invoice Yarra Valley Water ABN 93 066 902 501	

Summary

Previous bill	\$254.16
Payment received thank you	-\$254.16
Balance carried forward	\$0.00
This bill	
Usage charges	\$61.82
Service charges	
Water supply system	\$20.64
Sewerage system	\$118.19
Other authority charges	
Waterways and drainage	\$30.44
Parks	\$21.74
Total this bill (GST does not apply)	\$252.83
Total balance	\$252.83

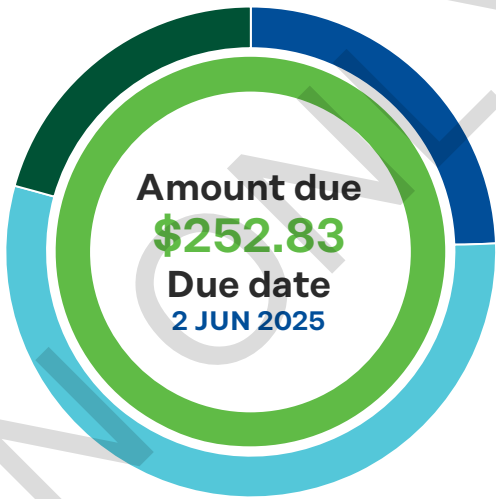

- Usage charges
- Service charges
- Other authority charges

Your household's daily water use

Target 150L of water use per person, per day.

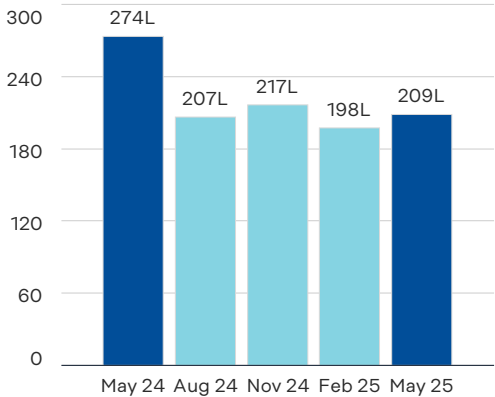

Average use in litres per day

Your daily spend

This bill compared to the same time last year.
Excludes other authority charges.

This bill
\$2.21

Last year
\$2.32



How to pay



*3042 112396168998 2



Direct debit

Sign up for Direct Debit at yvw.com.au/directdebit or call 1300 304 688.



EFT

Transfer direct from your bank account to ours by Electronic Funds Transfer (EFT).

Account name:
Yarra Valley Water
BSB: 033-885
Account number: 112192786



BPAY®

Bill code: 344366
Ref: 112 1015 7296



Centrepay

Use Centrepay to arrange regular deductions from your Centrelink payments.

Visit yvw.com.au/paying
CRN reference: 555 054 118T



Post Billpay®

Pay in person at any post office, by phone on 13 18 16 or at postbillpay.com.au
Bill code: 3042
Ref: 1123 9616 89982



Credit Card

Online: yvw.com.au/paying
Phone: 1300 362 332

MR J FALVO

Account number	11 2101 5729
Invoice number	1123 9616 89982
Total due	\$252.83
Due date	2 Jun 2025
Amount paid	\$

Your usage detail

1kL = 1,000 litres

Meter number	Current reading	Previous reading	Usage
MAF154164	5,962kL -	5,944kL =	18kL
From 11 Feb 2025 - 8 May 2025			(86 days)
Water and sewer usage charge	Usage	Price \$/kL	Amount
STEP 1 (0-440 litres per day)	18.000kL x	\$3.4342 =	\$61.82
Total	18.000kL		\$61.82
Total usage charges			\$61.82

Your charges explained

- **Water and sewer usage charge**
11 February 2025 - 8 May 2025
The cost for water used at your property. This includes capturing, treating and delivering water, and removing, treating and disposing of sewage from your property. The cost increases with the amount used (STEP tariffs).
- **Water supply system charge**
1 April 2025 - 30 June 2025
A fixed cost for maintaining and repairing pipes and other infrastructure that store, treat and deliver water to your property.
- **Sewerage system charge**
1 April 2025 - 30 June 2025
A fixed cost for running, maintaining, and repairing the sewerage system.
- **Other authority charges**
Waterways and drainage charge
1 April 2025 - 30 June 2025
Collected on behalf of Melbourne Water each quarter and used to manage and improve waterways, drainage, and flood protection. For more information visit melbournewater.com.au/wwdc
- **Parks charge**
1 April 2025 - 30 June 2025
Collected on behalf of Parks Victoria each quarter, and used to maintain and enhance Victoria's parks, zoos, the Royal Botanic Gardens, the Shrine of Remembrance and other community facilities. For more information visit parks.vic.gov.au

J150127

Financial assistance

Are you facing financial difficulty? For more time to pay, payment plans and government assistance, we can find a solution that works for you. Please call us on **1800 994 789** or visit yvw.com.au/financialhelp.
Registering your concession can also reduce the amount you need to pay. Please call us on **1800 680 824** or visit yvw.com.au/concession.

Contact us

☎	Enquiries	1300 304 688	For language assistance	
	Faults and Emergencies	13 27 62 (24hr)	العربية	1300 914 361
@	enquiry@yvw.com.au		廣東話	1300 921 362
	yvw.com.au		Ελληνικά	1300 931 364
☎	TTY Voice Calls	133 677	普通话	1300 927 363
🗣️	Speak and Listen	1300 555 727	For all other languages call our translation service on 03 9046 4173	

📅 Next meter reading:

Between 4-11 Aug 2025

Register your concession*

Save up to 50% on your water and sewer charges.

➡ yvw.com.au/concessions
☎ **1300 441 248**

*Health Care, Pension or DVA health card holders

Support when it matters

We know managing bills can be tough

That's why we offer a range of options to help take the pressure off bill payments:

- payment plans
- payment extensions
- concession discounts
- utility relief grants.

☎ **1300 441 248**
➡ yvw.com.au/financial-help



21st March 2024

TRANG DUONG
TRANG CONVEYANCING PTY LTD

Dear TRANG DUONG,

RE: Application for Water Information Statement

Property Address:	13 NEWTON STREET THOMASTOWN 3074
Applicant	TRANG DUONG TRANG CONVEYANCING PTY LTD
Information Statement	30837145
Conveyancing Account Number	7831399523
Your Reference	josephsale13

Thank you for your recent application for a Water Information Statement (WIS). We are pleased to provide you the WIS for the above property address. This statement includes:

- Yarra Valley Water Property Information Statement
- Melbourne Water Property Information Statement
- Asset Plan
- Rates Certificate

If you have any questions about Yarra Valley Water information provided, please phone us on **1300 304 688** or email us at the address enquiry@yvw.com.au. For further information you can also refer to the Yarra Valley Water website at www.yvw.com.au.

Yours sincerely,

Chris Brace
GENERAL MANAGER
RETAIL SERVICES

Yarra Valley Water Property Information Statement

Property Address	13 NEWTON STREET THOMASTOWN 3074
------------------	----------------------------------

STATEMENT UNDER SECTION 158 WATER ACT 1989

THE FOLLOWING INFORMATION RELATES TO SECTION 158(3)

Existing sewer mains will be shown on the Asset Plan.

Please note: Unless prior consent has been obtained, the Water Act prohibits:

1. The erection and/or placement of any building, wall, bridge, fence, embankment, filling, material, machinery or other structure over or under any sewer or drain.
2. The connection of any drain or sewer to, or interference with, any sewer, drain or watercourse.

Melbourne Water Property Information Statement

Property Address	13 NEWTON STREET THOMASTOWN 3074
------------------	----------------------------------

STATEMENT UNDER SECTION 158 WATER ACT 1989

THE FOLLOWING INFORMATION RELATES TO SECTION 158(4)

Information available at Melbourne Water indicates that this property is not subject to flooding from Melbourne Water's drainage system, based on a flood level that has a probability of occurrence of 1% in any one year.

Please note: Unless prior consent has been obtained, the Water Act prohibits:

1. The erection and/or placement of any building, wall, bridge, fence, embankment, filling, material, machinery or other structure over or under any sewer or drain.
2. The connection of any drain or sewer to, or interference with, any sewer, drain or watercourse.

If you have any questions regarding Melbourne Water encumbrances or advisory information, please contact Melbourne Water on 9679 7517.

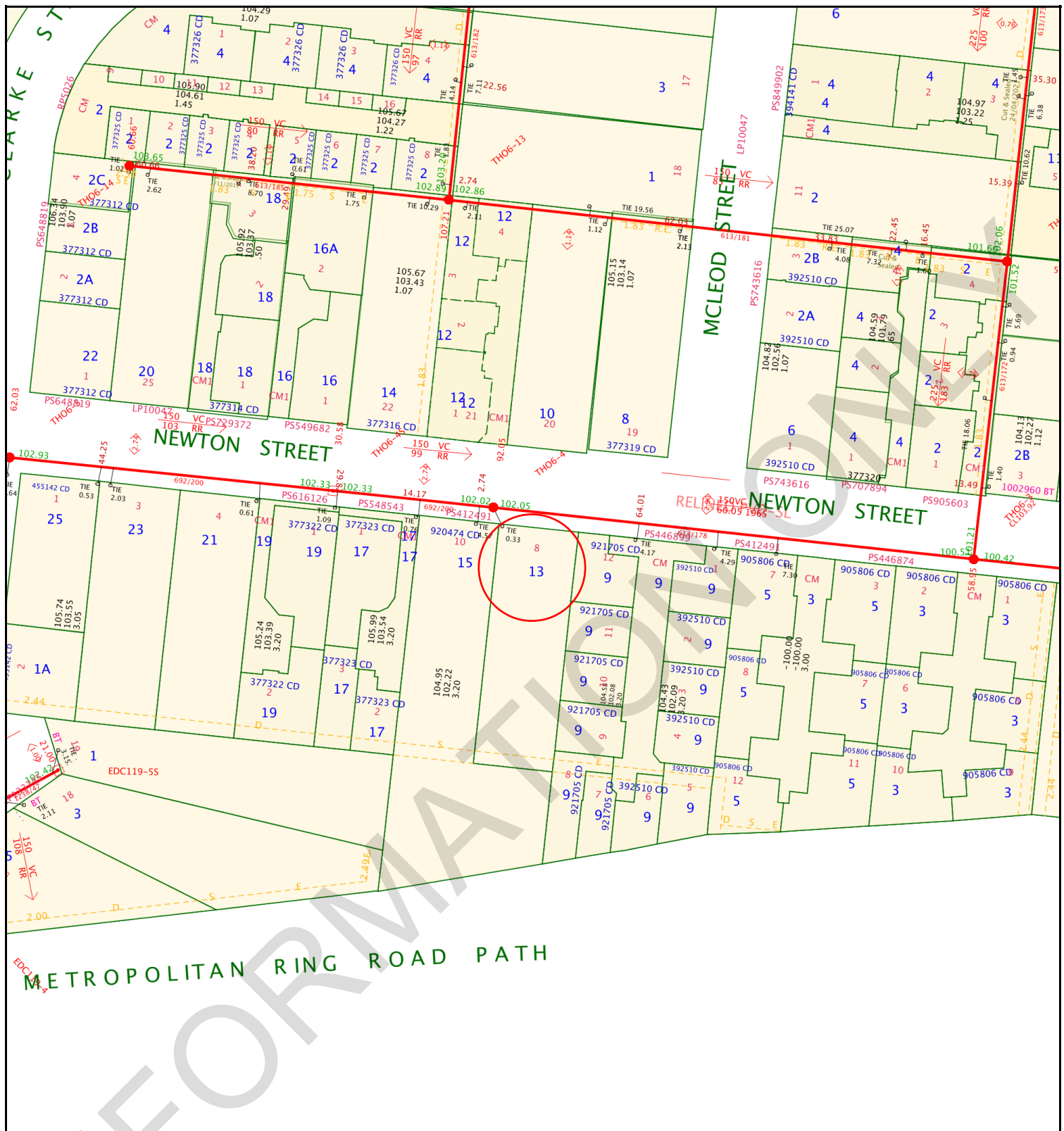

Yarra Valley Water Information Statement Number: 30837145

Address	13 NEWTON STREET THOMASTOWN 3074	
Date	21/03/2024	
Scale	1:1000	



Existing Title		Access Point Number	GLV2-42	MW Drainage Channel Centreline	
Proposed Title		Sewer Manhole		MW Drainage Underground Centreline	
Easement		Sewer Pipe Flow		MW Drainage Manhole	
Existing Sewer		Sewer Offset	<1.00>	MW Drainage Natural Waterway	
Abandoned Sewer		Sewer Branch			

Disclaimer: This information is supplied on the basis Yarra Valley Water Ltd:
- Does not warrant the accuracy or completeness of the information supplied, including, without limitation, the location of Water and Sewer Assets;
- Does not accept any liability for loss or damage of any nature, suffered or incurred by the recipient or any other persons relying on this information;
- Recommends recipients and other persons using this information make their own site investigations and accommodate their works accordingly;

TRANG DUONG
TRANG CONVEYANCING PTY LTD
TRANGCONVEYANCING@GMAIL.COM

RATES CERTIFICATE

Account No: 1121015729
Rate Certificate No: 30837145

Date of Issue: 21/03/2024
Your Ref: josephsale13

With reference to your request for details regarding:

Property Address	Lot & Plan	Property Number	Property Type
13 NEWTON ST, THOMASTOWN VIC 3074	8\LP41097	1225756	Residential

Agreement Type	Period	Charges	Outstanding
Residential Water Service Charge	01-01-2024 to 31-03-2024	\$20.04	\$0.00
Residential Water and Sewer Usage Charge <i>Step 1 – 31.000000kL x \$3.34380000 = \$103.66</i> Estimated Average Daily Usage \$1.02	03-11-2023 to 13-02-2024	\$103.66	\$0.00
Residential Sewer Service Charge	01-01-2024 to 31-03-2024	\$114.46	\$0.00
Parks Fee *	01-01-2024 to 31-03-2024	\$21.10	\$0.00
Drainage Fee	01-01-2024 to 31-03-2024	\$29.38	\$0.00
Other Charges:			
Interest	No interest applicable at this time		
	No further charges applicable to this property		
Balance Brought Forward			\$0.00
Total for This Property			\$0.00

* Please note, from 1 July 2023 the Parks fee will be charged quarterly instead of annually.



GENERAL MANAGER
RETAIL SERVICES

Note:

- From 1 July 2023, the Parks Fee will be charged quarterly instead of annually.
- From 1 July 2023, for properties that have water and sewer services, the Residential Water and Sewer Usage charge replaces the Residential Water Usage and Residential Sewer Usage charges.
- This statement details all tariffs, charges, and penalties due and payable to Yarra Valley Water as of the date of this statement and includes tariffs and charges (other than for usage charges yet to be billed) which are due and payable to the end of the current financial quarter.

4. All outstanding debts are due to be paid to Yarra Valley Water at settlement. Any debts that are unpaid at settlement will carry over onto the purchaser's first quarterly account and follow normal credit and collection activities - pursuant to section 275 of the Water Act 1989.
5. If the total due displays a (-\$ cr), this means the account is in credit. Credit amounts will be transferred to the purchaser's account at settlement.
6. Yarra Valley Water provides information in this Rates Certificate relating to waterways and drainage as an agent for Melbourne Water and relating to parks as an agent for Parks Victoria - pursuant to section 158 of the Water Act 1989.
7. The charges on this rates certificate are calculated and valid at the date of issue. To obtain up-to-date financial information, please order a Rates Settlement Statement prior to settlement.
8. From 01/07/2023, Residential Water Usage is billed using the following step pricing system: 249.56 cents per kilolitre for the first 44 kilolitres; 318.98 cents per kilolitre for 44-88 kilolitres and 472.56 cents per kilolitre for anything more than 88 kilolitres. From 1 July 2023, this charge is applicable for properties with water service only.
9. From 01/07/2023, Residential Water and Sewer Usage is billed using the following step pricing system: 334.38 cents per kilolitre for the first 44 kilolitres; 438.73 cents per kilolitre for 44-88 kilolitres and 509.73 cents per kilolitre for anything more than 88 kilolitres. From 1 July 2023, this charge is applicable for residential properties with both water and sewer services.
10. From 01/07/2023, Residential Recycled Water Usage is billed 188.71 cents per kilolitre.
11. From 01/07/2022 up to 30/06/2023, Residential Sewer Usage was calculated using the following equation: Water Usage (kl) x Seasonal Factor x Discharge Factor x Price (/kl) 1.1540 per kilolitre. From 1 July 2023, this charge will no longer be applicable for residential customers with both water and sewer services.
12. The property is a serviced property with respect to all the services, for which charges are listed in the Statement of Fees above.

To ensure you accurately adjust the settlement amount, we strongly recommend you book a Special Meter Reading:

- Special Meter Readings ensure that actual water use is adjusted for at settlement.
- Without a Special Meter Reading, there is a risk your client's settlement adjustment may not be correct.

Property No: 1225756

Address: 13 NEWTON ST, THOMASTOWN VIC 3074

Water Information Statement Number: 30837145

HOW TO PAY



Bill Code: 314567
Ref: 11210157296

**Amount
Paid**

**Date
Paid**

**Receipt
Number**

ROADS PROPERTY CERTIFICATE

The search results are as follows:

Trang Duong
34, Goodman dr
NOBLE PARK 3174

Client Reference: josephsale13

NO PROPOSALS. As at the 21th March 2024, VicRoads has no approved proposals requiring any part of the property described in your application. You are advised to check your local Council planning scheme regarding land use zoning of the property and surrounding area.

This certificate was prepared solely on the basis of the Applicant-supplied address described below, and electronically delivered by LANDATA®.

13 NEWTON STREET, THOMASTOWN 3074
CITY OF WHITTLESEA

This certificate is issued in respect of a property identified above. VicRoads expressly disclaim liability for any loss or damage incurred by any person as a result of the Applicant incorrectly identifying the property concerned.

Date of issue: 21th March 2024

Telephone enquiries regarding content of certificate: 13 11 71

PLANNING CERTIFICATE

Official certificate issued under Section 199 Planning & Environment Act 1987
and the Planning and Environment Regulations 2005

CERTIFICATE REFERENCE NUMBER

1015431

APPLICANT'S NAME & ADDRESS

TRANG DUONG C/- LANDATA
MELBOURNE

VENDOR

FALVO, JOSEPH

PURCHASER

NOT APPLICABLE, NOT APPLICABLE

REFERENCE

JOSEPHSALE13

This certificate is issued for:

LOT 8 PLAN LP41097 ALSO KNOWN AS 13 NEWTON STREET THOMASTOWN
WHITTLESEA CITY

The land is covered by the:

WHITTLESEA PLANNING SCHEME

The Minister for Planning is the responsible authority issuing the Certificate.

The land:

- is included in a GENERAL RESIDENTIAL ZONE - SCHEDULE 4
- is within a DEVELOPMENT CONTRIBUTIONS PLAN OVERLAY - SCHEDULE 3

A detailed definition of the applicable Planning Scheme is available at :
(<http://planningschemes.dpcd.vic.gov.au/schemes/whittlesea>)

Historic buildings and land protected under the Heritage Act 1995 are recorded in the Victorian
Heritage Register at:
<http://vhd.heritage.vic.gov.au/>

21 March 2024

Sonya Kilkenny
Minister for Planning

Additional site-specific controls may apply.
The Planning Scheme Ordinance should be
checked carefully.
The above information includes all
amendments to planning scheme maps
placed on public exhibition up to the date
of issue of this certificate and which are
still the subject of active consideration

Copies of Planning Schemes and
Amendments can be inspected at the
relevant municipal offices.

LANDATA®
T: (03) 9102 0402
E: landata.enquiries@servictoria.com.au

The attached certificate is issued by the Minister for Planning of the State of Victoria and is protected by statute.

The document has been issued based on the property information you provided. You should check the map below - it highlights the property identified from your information.

If this property is different to the one expected, you can phone (03) 9102 0402 or email landata.enquiries@servictoria.com.au

Please note: The map is for reference purposes only and does not form part of the certificate.

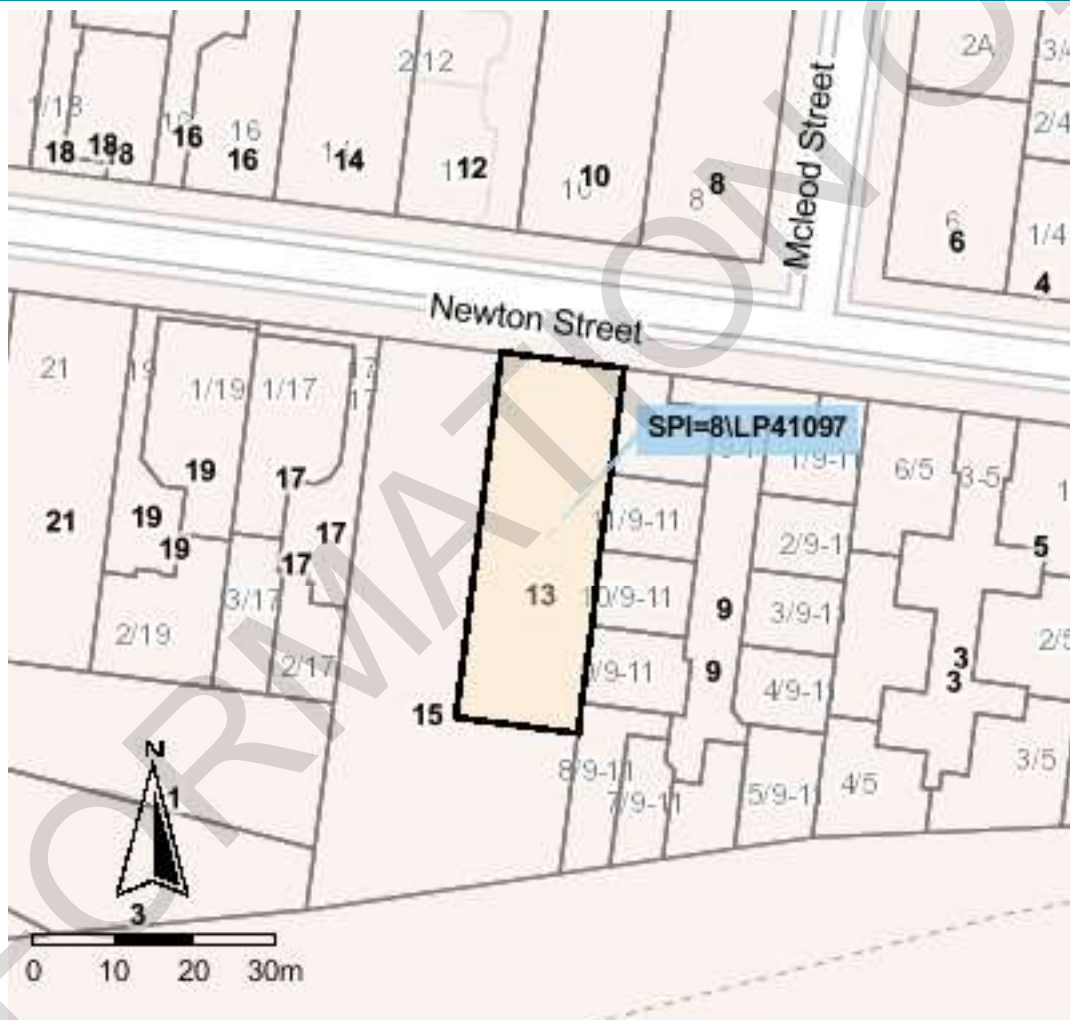

Copyright © State Government of Victoria. Service provided by maps.land.vic.gov.au

Choose the authoritative Planning Certificate

Why rely on anything less?

As part of your section 32 statement, the authoritative Planning Certificate provides you and / or your customer with the statutory protection of the State of Victoria.

Order online before 4pm to receive your authoritative Planning Certificate the same day, in most cases within the hour. Next business day delivery, if further information is required from you.

Privacy Statement

The information obtained from the applicant and used to produce this certificate was collected solely for the purpose of producing this certificate. The personal information on the certificate has been provided by the applicant and has not been verified by LANDATA®. The property information on the certificate has been verified by LANDATA®. The zoning information on the certificate is protected by statute. The information on the

PROPERTY REPORT

From www.land.vic.gov.au at 21 March 2024 09:32 PM

PROPERTY DETAILS

Address: **13 NEWTON STREET THOMASTOWN 3074**

Lot and Plan Number: **Lot 8 LP41097**

Standard Parcel Identifier (SPI): **8\LP41097**

Local Government Area (Council): **WHITTLESEA**

Council Property Number: **315515**

Directory Reference: **Melway 8 J9**

www.whittlesea.vic.gov.au

SITE DIMENSIONS

All dimensions and areas are approximate. They may not agree with those shown on a title or plan.

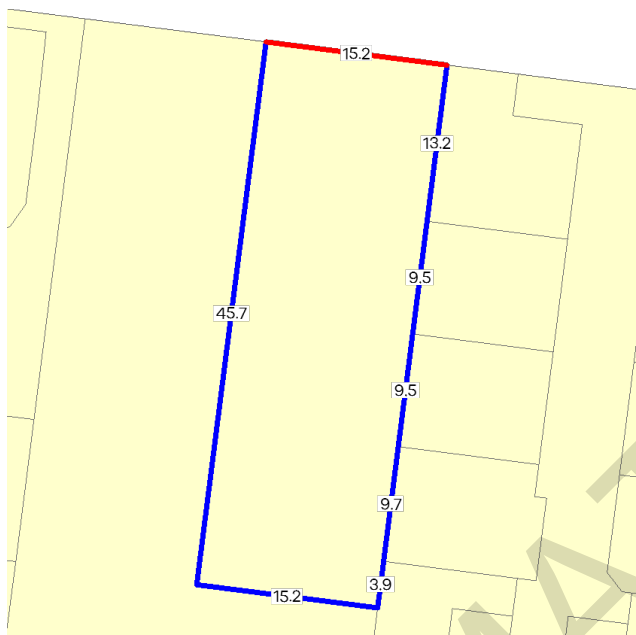

Area: 697 sq. m

Perimeter: 122 m

For this property:

— Site boundaries

— Road frontages

Dimensions for individual parcels require a separate search, but dimensions for individual units are generally not available.

Calculating the area from the dimensions shown may give a different value to the area shown above

For more accurate dimensions get copy of plan at [Title and Property Certificates](#)

UTILITIES

Rural Water Corporation: **Southern Rural Water**

Melbourne Water Retailer: **Yarra Valley Water**

Melbourne Water: **Inside drainage boundary**

Power Distributor: **AUSNET**

STATE ELECTORATES

Legislative Council: **NORTHERN METROPOLITAN**

Legislative Assembly: **THOMASTOWN**

PLANNING INFORMATION

Property Planning details have been removed from the Property Reports to avoid duplication with the Planning Property Reports from the Department of Transport and Planning which are the authoritative source for all Property Planning information.

The Planning Property Report for this property can found here - [Planning Property Report](#)

Planning Property Reports can be found via these two links

Vicplan <https://mapshare.vic.gov.au/vicplan/>

Property and parcel search <https://www.land.vic.gov.au/property-and-parcel-search>

Energy,
Environment
and Climate Action

Selected Property

0  45 m

PLANNING PROPERTY REPORT

From www.planning.vic.gov.au at 21 March 2024 09:37 PM

PROPERTY DETAILS

Address: **13 NEWTON STREET THOMASTOWN 3074**
Lot and Plan Number: **Lot 8 LP41097**
Standard Parcel Identifier (SPI): **8\LP41097**
Local Government Area (Council): **WHITTLESEA**
Council Property Number: **315515**
Planning Scheme: **Whittlesea**
Directory Reference: **Melway 8 J9**

www.whittlesea.vic.gov.au

[Planning Scheme - Whittlesea](#)

UTILITIES

Rural Water Corporation: **Southern Rural Water**
Melbourne Water Retailer: **Yarra Valley Water**
Melbourne Water: **Inside drainage boundary**
Power Distributor: **AUSNET**

STATE ELECTORATES

Legislative Council: **NORTHERN METROPOLITAN**
Legislative Assembly: **THOMASTOWN**

OTHER

Registered Aboriginal Party: **Wurundjeri Woi Wurrung Cultural
Heritage Aboriginal Corporation**

[View location in VicPlan](#)

Planning Zones

[GENERAL RESIDENTIAL ZONE \(GRZ\)](#)

[GENERAL RESIDENTIAL ZONE - SCHEDULE 4 \(GRZ4\)](#)

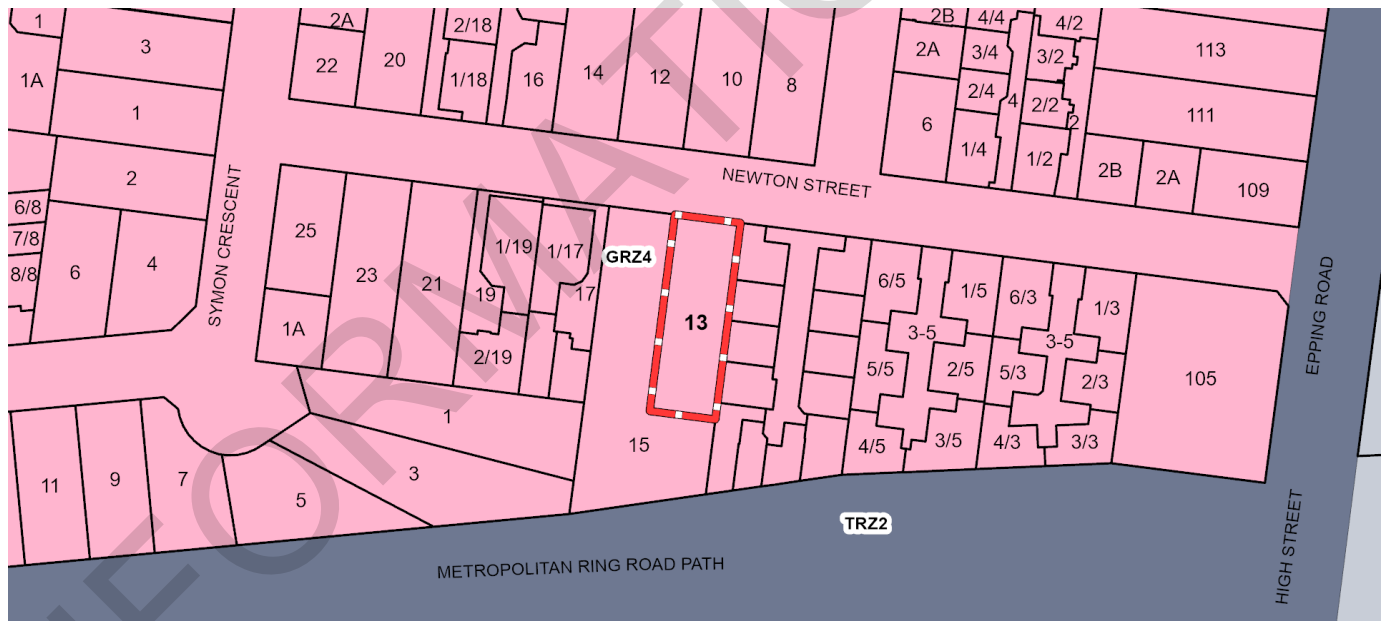

GRZ - General Residential **TRZ1 - State Transport Infrastructure** **TRZ2 - Principal Road Network**

Note: labels for zones may appear outside the actual zone - please compare the labels with the legend.

Planning Overlays

[DEVELOPMENT CONTRIBUTIONS PLAN OVERLAY \(DCPO\)](#)

[DEVELOPMENT CONTRIBUTIONS PLAN OVERLAY - SCHEDULE 3 \(DCPO3\)](#)



 **DCPO - Development Contributions Plan Overlay**

Note: due to overlaps, some overlays may not be visible, and some colours may not match those in the legend

OTHER OVERLAYS

Other overlays in the vicinity not directly affecting this land

[DESIGN AND DEVELOPMENT OVERLAY \(DDO\)](#)

[SPECIAL BUILDING OVERLAY \(SBO\)](#)

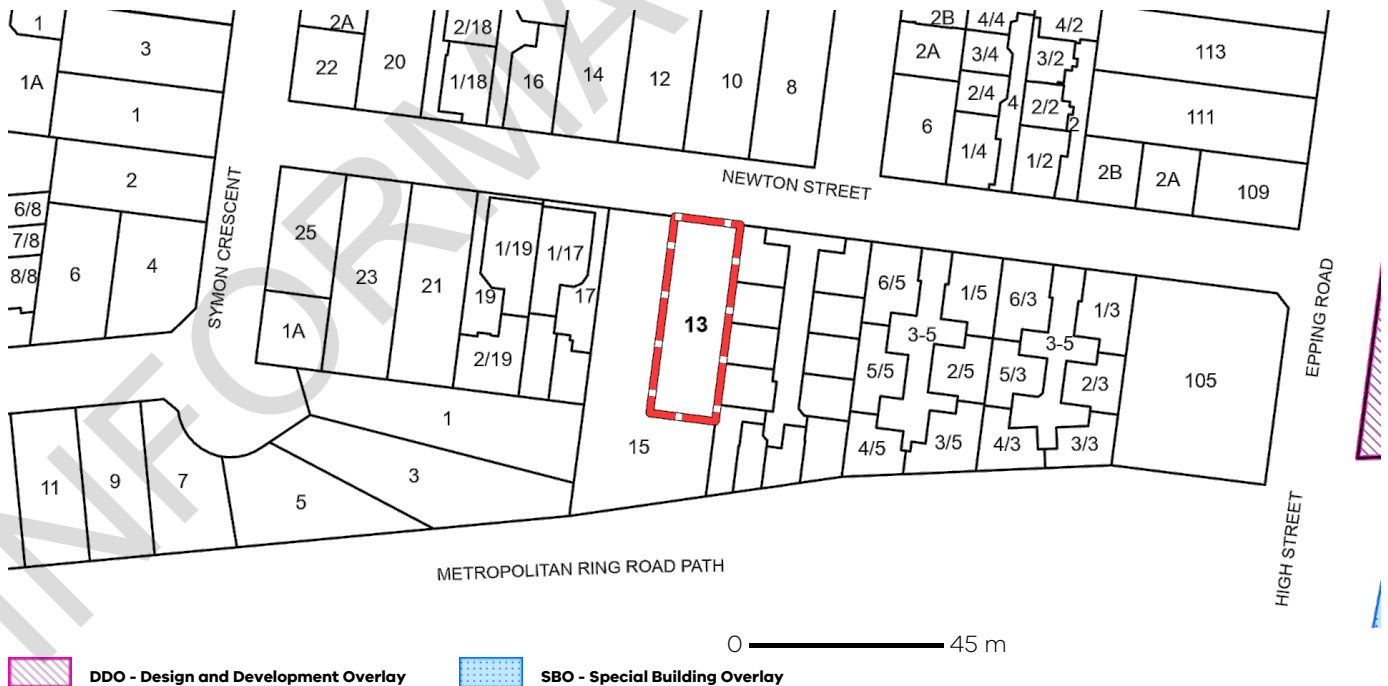

 **DDO - Design and Development Overlay**

 **SBO - Special Building Overlay**

Note: due to overlaps, some overlays may not be visible, and some colours may not match those in the legend

Further Planning Information

Planning scheme data last updated on 7 December 2023.

A **planning scheme** sets out policies and requirements for the use, development and protection of land.

This report provides information about the zone and overlay provisions that apply to the selected land.

Information about the State and local policy, particular, general and operational provisions of the local planning scheme that may affect the use of this land can be obtained by contacting the local council

or by visiting <https://www.planning.vic.gov.au>

This report is NOT a **Planning Certificate** issued pursuant to Section 199 of the **Planning and Environment Act 1987**.

It does not include information about exhibited planning scheme amendments, or zonings that may affect the land.

To obtain a Planning Certificate go to Titles and Property Certificates at Landata - <https://www.landata.vic.gov.au>

For details of surrounding properties, use this service to get the Reports for properties of interest.

To view planning zones, overlay and heritage information in an interactive format visit

<https://mapshare.maps.vic.gov.au/vicplan>

For other information about planning in Victoria visit <https://www.planning.vic.gov.au>

Designated Bushfire Prone Areas

This property is not in a designated bushfire prone area.
No special bushfire construction requirements apply. Planning provisions may apply.

Where part of the property is mapped as BPA, if no part of the building envelope or footprint falls within the BPA area, the BPA construction requirements do not apply.

Note: the relevant building surveyor determines the need for compliance with the bushfire construction requirements.



Designated BPA are determined by the Minister for Planning following a detailed review process. The Building Regulations 2018, through adoption of the Building Code of Australia, apply bushfire protection standards for building works in designated BPA.

Designated BPA maps can be viewed on VicPlan at <https://mapshare.vic.gov.au/vicplan/> or at the relevant local council.

Create a BPA definition plan in [VicPlan](#) to measure the BPA.

Information for lot owners building in the BPA is available at <https://www.planning.vic.gov.au>.

Further information about the building control system and building in bushfire prone areas can be found on the Victorian Building Authority website <https://www.vba.vic.gov.au>. Copies of the Building Act and Building Regulations are available from <http://www.legislation.vic.gov.au>. For Planning Scheme Provisions in bushfire areas visit <https://www.planning.vic.gov.au>.

Native Vegetation

Native plants that are indigenous to the region and important for biodiversity might be present on this property. This could include trees, shrubs, herbs, grasses or aquatic plants. There are a range of regulations that may apply including need to obtain a planning permit under Clause 52.17 of the local planning scheme. For more information see [Native Vegetation \(Clause 52.17\)](#) with local variations in [Native Vegetation \(Clause 52.17\) Schedule](#)

To help identify native vegetation on this property and the application of Clause 52.17 please visit the Native Vegetation Information Management system <https://nvim.delwp.vic.gov.au/> and [Native vegetation \(environment.vic.gov.au\)](https://www.environment.vic.gov.au) or please contact your relevant council.

You can find out more about the natural values on your property through NatureKit [NatureKit \(environment.vic.gov.au\)](https://www.environment.vic.gov.au)

32.08
31/07/2018
VC148

GENERAL RESIDENTIAL ZONE

Shown on the planning scheme map as **GRZ** , **R1Z** , **R2Z** or **R3Z** with a number (if shown).

Purpose

To implement the Municipal Planning Strategy and the Planning Policy Framework.

To encourage development that respects the neighbourhood character of the area.

To encourage a diversity of housing types and housing growth particularly in locations offering good access to services and transport.

To allow educational, recreational, religious, community and a limited range of other non-residential uses to serve local community needs in appropriate locations.

32.08-1 Neighbourhood character objectives

27/03/2017
VC110

A schedule to this zone may contain neighbourhood character objectives to be achieved for the area.

32.08-2 Table of uses

01/01/2024
VC250

Section 1 - Permit not required

Use	Condition
Automated collection point	Must meet the requirements of Clause 52.13-3 and 52.13-5. The gross floor area of all buildings must not exceed 50 square metres.
Bed and breakfast	No more than 10 persons may be accommodated away from their normal place of residence. At least 1 car parking space must be provided for each 2 persons able to be accommodated away from their normal place of residence.
Community care accommodation	Must meet the requirements of Clause 52.22-2.
Domestic animal husbandry (other than Domestic animal boarding)	Must be no more than 2 animals.
Dwelling (other than Bed and breakfast) Home based business Informal outdoor recreation	
Medical centre	The gross floor area of all buildings must not exceed 250 square metres. Must not require a permit under Clause 52.06-3. The site must adjoin, or have access to, a road in a Transport Zone 2 or a Transport Zone 3.

Use	Condition
Place of worship	The gross floor area of all buildings must not exceed 250 square metres. The site must adjoin, or have access to, a road in a Transport Zone 2 or a Transport Zone 3.
Racing dog husbandry	Must be no more than 2 animals.
Railway	
Residential aged care facility	
Rooming house	Must meet the requirements of Clause 52.23-2.
Small second dwelling	Must be no more than one dwelling existing on the lot. Must be the only small second dwelling on the lot. Reticulated natural gas must not be supplied to the building, or part of a building, used for the small second dwelling.
Tramway	
Any use listed in Clause 62.01	Must meet the requirements of Clause 62.01.
Section 2 - Permit required	

Use	Condition
Accommodation (other than Community care accommodation, Dwelling, Residential aged care facility, Rooming house and Small second dwelling) Agriculture (other than Animal production, Animal training, Apiculture, Domestic animal husbandry, Horse husbandry and Racing dog husbandry)	
Car park	Must be used in conjunction with another use in Section 1 or 2.
Car wash	The site must adjoin, or have access to, a road in a Transport Zone 2 or a Transport Zone 3.
Convenience restaurant	The site must adjoin, or have access to, a road in a Transport Zone 2 or a Transport Zone 3.
Convenience shop	

Use	Condition
Domestic animal husbandry (other than Domestic animal boarding) – if the Section 1 condition is not met	Must be no more than 5 animals.
Food and drink premises (other than Convenience restaurant and Take away food premises) Grazing animal production Leisure and recreation (other than Informal outdoor recreation and Motor racing track) Market	
Office (other than Medical centre)	The use must be associated with a use or development to which clause 53.23 (Significant residential development with affordable housing) applies.
Place of assembly (other than Amusement parlour, Carnival, Cinema based entertainment facility, Circus, Nightclub and Place of worship) Plant nursery	
Retail premises (other than Convenience shop, Food and drink premises, Market and Plant nursery)	The use must be associated with a use or development to which clause 53.23 (Significant residential development with affordable housing) applies.
Service station	<p>The site must either:</p> <ul style="list-style-type: none"> ▪ Adjoin a commercial zone or industrial zone. ▪ Adjoin, or have access to, a road in a Transport Zone 2 or a Transport Zone 3. <p>The site must not exceed either:</p> <ul style="list-style-type: none"> ▪ 3000 square metres. ▪ 3600 square metres if it adjoins on two boundaries a road in a Transport Zone 2 or a Transport Zone 3.
Store	Must be in a building, not a dwelling, and used to store equipment, goods, or motor vehicles used in conjunction with the occupation of a resident of a dwelling on the lot.
Take away food premises	The site must adjoin, or have access to, a road in a

Use	Condition
-----	-----------

Transport Zone 2 or a Transport Zone 3.

Utility installation (other than Minor utility installation and Telecommunications facility)

Any other use not in Section 1 or 3

Section 3 – Prohibited

Use

Amusement parlour

Animal production (other than Grazing animal production)

Animal training

Cinema based entertainment facility

Domestic animal boarding

Extractive industry

Horse husbandry

Industry (other than Automated collection point and Car wash)

Motor racing track

Nightclub

Saleyard

Small second dwelling – if the Section 1 condition is not met

Transport terminal

Warehouse (other than Store)

32.08-3

14/12/2023
VC253

Subdivision

Permit requirement

A permit is required to subdivide land.

An application to subdivide land that would create a vacant lot less than 400 square metres capable of development for a dwelling or residential building, must ensure that each vacant lot created less than 400 square metres contains at least 25 percent as garden area. This does not apply to a lot created by an application to subdivide land where that lot is created in accordance with:

- An approved precinct structure plan or an equivalent strategic plan;
- An incorporated plan or approved development plan; or
- A permit for development.

An application to subdivide land, other than an application to subdivide land into lots each containing an existing dwelling or car parking space, must meet the requirements of Clause 56 and:

- Must meet all of the objectives included in the clauses specified in the following table.
- Should meet all of the standards included in the clauses specified in the following table.

Class of subdivision	Objectives and standards to be met
60 or more lots	All except Clause 56.03-5.
16 – 59 lots	All except Clauses 56.03-1 to 56.03-3, 56.03-5, 56.06-1 and 56.06-3.
3 – 15 lots	All except Clauses 56.02-1, 56.03-1 to 56.03-4, 56.05-2, 56.06-1, 56.06-3 and 56.06-6.
2 lots	Clauses 56.03-5, 56.04-2, 56.04-3, 56.04-5, 56.06-8 to 56.09-2.

A permit must not be granted which would allow a separate lot to be created for land containing a small second dwelling.

VicSmart applications

Subject to Clause 71.06, an application under this clause for a development specified in Column 1 is a class of VicSmart application and must be assessed against the provision specified in Column 2.

Class of application	Information requirements and decision guidelines
Subdivide land to realign the common boundary between 2 lots where: <ul style="list-style-type: none"> ▪ The area of either lot is reduced by less than 15 percent. ▪ The general direction of the common boundary does not change. 	Clause 59.01
Subdivide land into lots each containing an existing building or car parking space where: <ul style="list-style-type: none"> ▪ The buildings or car parking spaces have been constructed in accordance with the provisions of this scheme or a permit issued under this scheme. ▪ An occupancy permit or a certificate of final inspection has been issued under the Building Regulations in relation to the buildings within 5 years prior to the application for a permit for subdivision. 	Clause 59.02
Subdivide land into 2 lots if: <ul style="list-style-type: none"> ▪ The construction of a building or the construction or carrying out of works on the land: <ul style="list-style-type: none"> ▪ Has been approved under this scheme or by a permit issued under this scheme and the permit has not expired. ▪ Has started lawfully. 	Clause 59.02

Class of application**Information requirements
and decision guidelines**

- The subdivision does not create a vacant lot.

32.08-4
14/12/2023
VC253

Construction or extension of a dwelling, small second dwelling or residential building**Minimum garden area requirement**

An application to construct or extend a dwelling, small second dwelling or residential building on a lot must provide a minimum garden area as set out in the following table:

Lot size	Minimum percentage of a lot set aside as garden area
400 - 500 sqm	25%
Above 500 - 650 sqm	30%
Above 650 sqm	35%

This does not apply to:

- An application to construct or extend a dwelling, small second dwelling or residential building if specified in a schedule to this zone as exempt from the minimum garden area requirement;
- An application to construct or extend a dwelling, small second dwelling or residential building on a lot if:
 - The lot is designated as a medium density housing site in an approved precinct structure plan or an approved equivalent strategic plan;
 - The lot is designated as a medium density housing site in an incorporated plan or approved development plan; or
- An application to alter or extend an existing building that did not comply with the minimum garden area requirement of Clause 32.08-4 on the approval date of Amendment VC110.

32.08-5
14/12/2023
VC253

Construction and extension of one dwelling on a lot**Permit requirement**

A permit is required to construct or extend one dwelling on a lot less than 300 square metres.

A permit is required to construct or extend a front fence within 3 metres of a street if the fence is associated with one dwelling on a lot less than 300 square metres and the fence exceeds the maximum height specified in Clause 54.06-2.

A development must meet the requirements of Clause 54.

No permit required

No permit is required to:

- Construct or carry out works normal to a dwelling.
- Construct or extend an out-building (other than a garage or carport) on a lot provided the gross floor area of the out-

building does not exceed 10 square metres and the maximum building height is not more than 3 metres above ground level.

- Make structural changes to a dwelling provided the size of the dwelling is not increased or the number of dwellings is not increased.

VicSmart applications

Subject to Clause 71.06, an application under this clause for a development specified in Column 1 is a class of VicSmart application and must be assessed against the provision specified in Column 2.

Class of application	Information requirements and decision guidelines
<p>Construct or extend a dwelling on a lot less than 300 square metres if the development meets the requirements in the following standards of Clause 54:</p> <ul style="list-style-type: none"> ▪ A3 Street setback. ▪ A10 Side and rear setbacks. ▪ A11 Walls on boundaries. ▪ A12 Daylight to existing windows. ▪ A13 North-facing windows. ▪ A14 Overshadowing open space. ▪ A15 Overlooking. <p>For the purposes of this class of VicSmart application, the Clause 54 standards specified above are mandatory.</p> <p>If a schedule to the zone specifies a requirement of a standard different from a requirement set out in the Clause 54 standard, the requirement in the schedule to the zone applies and must be met.</p>	Clause 59.14
Construct or extend a front fence within 3 metres of a street if the fence is associated with one dwelling on a lot less than 300 square metres.	Clause 59.03

32.08-6
14/12/2023
VC253

Construction and extension of a small second dwelling on a lot

Permit requirement

A permit is required to construct or extend a small second dwelling on a lot of less than 300 square metres.

A development must meet the requirements of Clause 54.

VicSmart applications

Subject to Clause 71.06, an application under this clause for a development specified in Column 1 is a class of VicSmart application and must be assessed against the provision specified in Column 2.

Class of application	Information requirements and decision guidelines
<p>Construct or extend a small second dwelling on a lot less than 300 square metres if the development meets the requirements in the following standards of Clause 54:</p> <ul style="list-style-type: none"> ▪ A3 Street setback. ▪ A9 Building setback. ▪ A9.1 Safety and accessibility. ▪ A10 Side and rear setbacks. ▪ A11 Walls on boundaries. ▪ A12 Daylight to existing windows. ▪ A13 North-facing windows. ▪ A14 Overshadowing open space. ▪ A15 Overlooking. <p>For the purposes of this class of VicSmart application, the Clause 54 standards specified above are mandatory.</p> <p>If a schedule to the zone specifies a requirement of a standard different from a requirement set out in the Clause 54 standard, the requirement in the schedule to the zone applies and must be met.</p>	<p>Clause 59.14</p>

32.08-7
14/12/2023
VC253

Construction and extension of two or more dwellings on a lot, dwellings on common property and residential buildings

Permit requirement

A permit is required to:

- Construct a dwelling if there is at least one dwelling existing on the lot.
- Construct two or more dwellings on a lot.
- Extend a dwelling if there are two or more dwellings on the lot.
- Construct or extend a dwelling if it is on common property.
- Construct or extend a residential building.

A permit is required to construct or extend a front fence within 3 metres of a street if:

- The fence is associated with 2 or more dwellings on a lot or a residential building, and
- The fence exceeds the maximum height specified in Clause 55.06-2.

A development must meet the requirements of Clause 55. This does not apply to a development of five or more storeys, excluding a basement.

An apartment development of five or more storeys, excluding a basement, must meet the requirements of Clause 58.

VicSmart applications

Subject to Clause 71.06, an application under this clause for a development specified in Column 1 is a class of VicSmart

application and must be assessed against the provision specified in Column 2.

Class of application	Information requirements and decision guidelines
Construct or extend a front fence within 3 metres of a street if the fence is associated with 2 or more dwellings on a lot or a residential building.	Clause 59.03

Transitional provisions

Clause 55 of this scheme, as in force immediately before the approval date of Amendment VC136, continues to apply to:

- An application for a planning permit lodged before that date.
- An application for an amendment of a permit under section 72 of the Act, if the original permit application was lodged before that date.

Clause 58 does not apply to:

- An application for a planning permit lodged before the approval date of Amendment VC136.
- An application for an amendment of a permit under section 72 of the Act, if the original permit application was lodged before the approval date of Amendment VC136.

Clauses 55 and 58 of this scheme, as in force immediately before the approval date of Amendment VC174, continue to apply to:

- An application for a planning permit lodged before that date.
- An application for an amendment of a permit under section 72 of the Act, if the original permit application was lodged before that date.

32.08-8 Requirements of Clause 54 and Clause 55

14/12/2023
VC253

A schedule to this zone may specify the requirements of:

- Standards A3, A5, A6, A10, A11, A17 and A20 of Clause 54 of this scheme.
- Standards B6, B8, B9, B13, B17, B18, B28 and B32 of Clause 55 of this scheme.

If a requirement is not specified in a schedule to this zone, the requirement set out in the relevant standard of Clause 54 or Clause 55 applies.

32.08-9 Residential aged care facility

14/12/2023
VC253

Permit requirements

A permit is required to construct a building or construct or carry out works for a residential aged care facility.

A development must meet the requirements of Clause 53.17 - Residential aged care facility.

32.08-10 Buildings and works associated with a Section 2 use

14/12/2023
VC253

A permit is required to construct a building or construct or carry out works for a use in Section 2 of Clause 32.08-2.

VicSmart applications

Subject to Clause 71.06, an application under this clause for a development specified in Column 1 is a class of VicSmart application and must be assessed against the provision specified in Column 2.

Class of application	Information requirements and decision guidelines
<p>Construct a building or construct or carry out works where:</p> <ul style="list-style-type: none"> • The building or works are not associated with a dwelling, primary school or secondary school and have an estimated cost of up to \$100,000; or • The building or works are associated with a primary school or secondary school and have an estimated cost of up to \$500,000; and • The requirements in the following standards of Clause 54 are met, where the land adjoins land in a residential zone used for residential purposes: <ul style="list-style-type: none"> • A10 Side and rear setbacks. • A11 Walls on boundaries. • A12 Daylight to existing windows. • A13 North-facing windows. • A14 Overshadowing open space. • A15 Overlooking. <p>For the purposes of this class of VicSmart application, the Clause 54 standards specified above are mandatory.</p> <p>If a schedule to the zone specifies a requirement of a standard different from a requirement set out in the Clause 54 standard, the requirement in the schedule to the zone applies and must be met.</p>	<p>Clause 59.04</p>

32.08-11 Maximum building height requirement for a dwelling, small second dwelling or residential building

14/12/2023
VC253

A building must not be constructed for use as a dwelling, small second dwelling or a residential building that:

- exceeds the maximum building height specified in a schedule to this zone; or
- contains more than the maximum number of storeys specified in a schedule to this zone.

If no maximum building height or maximum number of storeys is specified in a schedule to this zone:

- the building height must not exceed 11 metres; and
- the building must contain no more than 3 storeys at any point.

A building may exceed the applicable maximum building height or contain more than the applicable maximum number of storeys if:

- It replaces an immediately pre-existing building and the new building does not exceed the building height or contain a greater number of storeys than the pre-existing building.
- There are existing buildings on both abutting allotments that face the same street and the new building does not exceed the building height or contain a greater number of storeys than the lower of the existing buildings on the

abutting allotments.

- It is on a corner lot abutted by lots with existing buildings and the new building does not exceed the building height or contain a greater number of storeys than the lower of the existing buildings on the abutting allotments.
- It is constructed pursuant to a valid building permit that was in effect prior to the introduction of this provision.

An extension to an existing building may exceed the applicable maximum building height or contain more than the applicable maximum number of storeys if it does not exceed the building height of the existing building or contain a greater number of storeys than the existing building.

A building may exceed the maximum building height by up to 1 metre if the slope of the natural ground level, measured at any cross section of the site of the building wider than 8 metres, is greater than 2.5 degrees.

A basement is not a storey for the purposes of calculating the number of storeys contained in a building.

The maximum building height and maximum number of storeys requirements in this zone or a schedule to this zone apply whether or not a planning permit is required for the construction of a building.

Building height if land is subject to inundation

If the land is in a Special Building Overlay, Land Subject to Inundation Overlay or is land liable to inundation the maximum building height specified in the zone or schedule to the zone is the vertical distance from the minimum floor level determined by the relevant drainage authority or floodplain management authority to the roof or parapet at any point.

32.08-12 Application requirements

14/12/2023
VC253

An application must be accompanied by the following information, as appropriate:

- For a residential development of four storeys or less, the neighbourhood and site description and design response as required in Clause 54 and Clause 55.
- For an apartment development of five or more storeys, an urban context report and design response as required in Clause 58.01.
- For an application for subdivision, a site and context description and design response as required in Clause 56.
- Plans drawn to scale and dimensioned which show:
 - Site shape, size, dimensions and orientation.
 - The siting and use of existing and proposed buildings.
 - Adjacent buildings and uses.
 - The building form and scale.
 - Setbacks to property boundaries.
- The likely effects, if any, on adjoining land, including noise levels, traffic, the hours of delivery and despatch of goods and materials, hours of operation and light spill, solar access and glare.
- Any other application requirements specified in a schedule to this zone.

If in the opinion of the responsible authority an application requirement is not relevant to the evaluation of an application, the responsible authority may waive or reduce the requirement.

32.08-13 Exemption from notice and review

14/12/2023
VC253

Subdivision

An application to subdivide land into lots each containing an existing dwelling or car parking space is exempt from the notice requirements of section 52(1)(a), (b) and (d), the decision requirements of section 64(1), (2) and (3) and the review rights of section 82(1) of the Act.

32.08-14 Decision guidelines14/12/2023
VC253

Before deciding on an application, in addition to the decision guidelines in Clause 65, the responsible authority must consider, as appropriate:

General

- The Municipal Planning Strategy and the Planning Policy Framework.
- The purpose of this zone.
- The objectives set out in a schedule to this zone.
- Any other decision guidelines specified in a schedule to this zone.
- The impact of overshadowing on existing rooftop solar energy systems on dwellings on adjoining lots in a General Residential Zone, Mixed Use Zone, Neighbourhood Residential Zone, Residential Growth Zone or Township Zone.

Subdivision

- The pattern of subdivision and its effect on the spacing of buildings.
- For subdivision of land for residential development, the objectives and standards of Clause 56.

Dwellings, small second dwellings and residential buildings

- For the construction and extension of one dwelling on a lot and a small second dwelling, the applicable objectives, standards and decision guidelines of Clause 54.
- For the construction and extension of two or more dwellings on a lot, dwellings on common property and residential buildings, the objectives, standards and decision guidelines of Clause 55. This does not apply to an apartment development of five or more storeys, excluding a basement.
- For the construction and extension of an apartment development of five or more storeys, excluding a basement, the objectives, standards and decisions guidelines of Clause 58.

Non-residential use and development

- Whether the use or development is compatible with residential use.
- Whether the use generally serves local community needs.
- The scale and intensity of the use and development.
- The design, height, setback and appearance of the proposed buildings and works.
- The proposed landscaping.
- The provision of car and bicycle parking and associated accessways.
- Any proposed loading and refuse collection facilities.
- The safety, efficiency and amenity effects of traffic to be generated by the proposal.

32.08-15 Signs14/12/2023
VC253

Sign requirements are at Clause 52.05. This zone is in Category 3.

32.08-16 Transitional provisions14/12/2023
VC253

The minimum garden area requirements of Clause 32.08-4 and the maximum building height and number of storeys requirements of Clause 32.08-9 introduced by Amendment VC110 do not apply to:

- A planning permit application for the construction or extension of a dwelling or residential building lodged before the approval date of Amendment VC110.
- Where a planning permit is not required for the construction or extension of a dwelling or residential building:
 - A building permit issued for the construction or extension of a dwelling or residential building before the approval date of Amendment VC110.
 - A building surveyor has been appointed to issue a building permit for the construction or extension of a dwelling or residential building before the approval date of Amendment VC110. A building permit must be issued within 12 months of the approval date of Amendment VC110.
 - A building surveyor is satisfied, and certifies in writing, that substantial progress was made on the design of the construction or extension of a dwelling or residential building before the approval date of Amendment VC110. A building permit must be issued within 12 months of the approval date of Amendment VC110.

The minimum garden area requirement of Clause 32.08-3 introduced by Amendment VC110 does not apply to a planning permit application to subdivide land for a dwelling or a residential building lodged before the approval date of Amendment VC110.

09/05/2019
C200**SCHEDULE 4 TO CLAUSE 32.08 GENERAL RESIDENTIAL ZONE**Shown on the planning scheme map as **GRZ4**.**NEIGHBOURHOOD INTERFACE AREAS****1.0**09/05/2019
C200**Neighbourhood character objectives**

To support a preferred neighbourhood character that balances the scale of development with landscaping and ensures sensitive transitions in height from existing dwellings.

To encourage contemporary building designs with variation and breaks in building form to soften the visual bulk of development through elements such as eaves, hipped or gabled roof forms and setbacks at upper floors.

To improve landscape character by providing generous landscaping including canopy trees in front and rear setbacks to soften the visual impact of development.

To encourage functional secluded private open space at the rear of the dwelling through its orientation and design.

2.009/05/2019
C200**Permit requirement for the construction or extension of one dwelling or a fence associated with a dwelling on a lot**

Is a permit required to construct or extend one dwelling on a lot of between 300 and 500 square metres?

No

Is a permit required to construct or extend a front fence within 3 metres of a street associated with a dwelling on a lot of between 300 and 500 square metres?

No

3.009/05/2019
C200**Requirements of Clause 54 and Clause 55**

	Standard	Requirement
Minimum street setback	A3 and B6	None specified
Site coverage	A5 and B8	None specified
Permeability	A6 and B9	None specified
Landscaping	B13	<p>Provide one canopy tree in both the front and rear setbacks. Each canopy tree must achieve a minimum six metres mature height and be accommodated in a pervious area of at least 5 metres by 5 metres, that does not contain driveways or car parking. This area is to be provided in addition to secluded private open space.</p> <p>Incorporate additional canopy trees at a ratio of one canopy tree for every two dwellings on development sites of 1,000 square metres or more.</p>

Standard Requirement		
Side and rear setbacks	A10 and B17	None specified
Walls on boundaries	A11 and B18	None specified
Private open space	A17	None specified
	B28	<p>An area of 40 square metres, with one part of the private open space to consist of secluded private open space at the side or rear of the dwelling or residential building with a minimum area of 25 square metres, a minimum dimension of 4 metres and convenient access from a living room, or</p> <p>A balcony of 12 square metres with a minimum width of 2.4 metres and convenient access from a living room, or</p> <p>A roof-top area of 10 square metres with a minimum width of 2 metres and convenient access from a living room.</p>
Front fence height	A20 and B32	None specified

4.0 Maximum building height requirement for a dwelling or residential building

09/05/2019
C200

None specified.

5.0 Application requirements

09/05/2019
C200

The following application requirements apply to an application for a permit under Clause 32.08, in addition to those specified in Clause 32.08 and elsewhere in the scheme and must accompany an application, as appropriate, to the satisfaction of the responsible authority:

- Applications for developments of two or more dwellings on a lot must include a Landscape Plan to demonstrate compliance with the relevant requirements of Clause 3.0 of this schedule.

6.0 Decision guidelines

09/05/2019
C200

None specified.

45.0631/07/2018
VC148**DEVELOPMENT CONTRIBUTIONS PLAN OVERLAY**

Shown on the planning scheme map as **DCPO** with a number.

Purpose

To implement the Municipal Planning Strategy and the Planning Policy Framework.

To identify areas which require the preparation of a development contributions plan for the purpose of levying contributions for the provision of works, services and facilities before development can commence.

45.06-119/01/2006
VC37**Development contributions plan**

A permit must not be granted to subdivide land, construct a building or construct or carry out works until a development contributions plan has been incorporated into this scheme.

This does not apply to the construction of a building, the construction or carrying out of works or a subdivision specifically excluded by a schedule to this overlay.

A permit granted must:

- Be consistent with the provisions of the relevant development contributions plan.
- Include any conditions required to give effect to any contributions or levies imposed, conditions or requirements set out in the relevant schedule to this overlay.

45.06-219/01/2006
VC37**Preparation of a development contributions plan**

The development contributions plan may consist of plans or other documents and may, with the agreement of the planning authority, be prepared and implemented in stages.

The development contributions plan must:

- Specify the area to which the plan applies.
- Set out the works, services and facilities to be funded through the plan, including the staging of the provision of those works, services and facilities.
- Relate the need for the works, services or facilities to the proposed development of land in the area.
- Specify the estimated costs of each of the works, services and facilities.
- Specify the proportion of the total estimated costs of the works, services and facilities which is to be funded by a development infrastructure levy or community infrastructure levy or both.
- Specify the land in the area and the types of development in respect of which a levy is payable and the method for determining the levy payable in respect of any development of land.
- Provide for the procedures for the collection of a development infrastructure levy in respect to any development for which a permit is not required.

The development contributions plan may:

- Exempt certain land or certain types of development from payment of a development infrastructure levy or community infrastructure levy or both.
- Provide for different rates or amounts of levy to be payable in respect of different types of development of land or different parts of the area.

27/05/2019
C239wsea

SCHEDULE 3 TO CLAUSE 45.06 DEVELOPMENT CONTRIBUTIONS PLAN OVERLAY

Shown on the planning scheme map as **DCPO3** .

DRAINAGE INFRASTRUCTURE DEVELOPMENT CONTRIBUTIONS PLAN

1.0
19/01/2006
VC37

Area covered by this development contributions plan

The area affected by this Development Contributions Plan is the land to which the DCPO3 has been applied in the Whittlesea Planning Scheme maps.

2.0
19/01/2006
VC37

Summary of costs

Facility	Total cost \$	Time of provision	Actual cost contribution attributable to development \$	Proportion of cost attributable to development %
Drainage	\$152,000 per annum	As Required	\$152,000	100
TOTAL	\$152,000 per annum	-	\$152,000	100

Note: The above figures will be annually indexed in accordance with movements in the Consumer Price Index (CPI).

3.0
19/01/2006
VC37

Summary of contributions

FACILITY	LEVIES PAYABLE BY THE DEVELOPMENT					
	Development Infrastructure		Community infrastructure		All infrastructure	
	Residential	Non-residential	Residential	Non-residential	Residential	Non-residential
<i>Drainage</i>	\$1.90 per square metre of total site area	\$3.50 per square metre of additional impervious floor area			\$1.90 per square metre of total site area	\$3.50 per square metre of additional impervious floor area
TOTAL	\$1.90 per square metre of total site area	\$3.50 per square metre of additional impervious floor area			\$1.90 per square metre of total site area	\$3.50 per square metre of additional impervious floor area

Note: The above figures will be annually indexed in accordance with movements in the Consumer Price Index (CPI).

4.0

15/01/2024
VC249

Land or development excluded from Development Contributions Plan

- All development with the exception of the multi-unit residential, retail, industrial and business/commercial buildings.
- The development of land for a small second dwelling.
- Other land or development as nominated by Council.