



# Dingle Partners

- | Estate Agents
- | Sales
- | Property Management
- | Project Management
- | Consultants

**201/350 La Trobe Street, Melbourne**

**2**  **1**  **1** 



## Additional Information

- Secure Intercom Entry
- Art Deco Appeal
- Central Heating & Cooling
- Polished Timber Floors
- Storage Cage on Apartment Level
- Secure Car Parking Space
- Resident Gym

## Rates:

Water Rates - \$636.28 per annum approx.  
Council Rates - \$1,196.54 per annum approx.  
Owners Corp - \$7,095.16 per annum approx.

## Chattels:

All fixed floor coverings, electric light fittings and fixtures, window furnishings

## Preferred Settlement:

30/60 days – 10% deposit

## Schools:

|                                    |         |
|------------------------------------|---------|
| Eltham College – Lonsdale Campus   | 200 m   |
| RMIT University – Melbourne Campus | 469 m   |
| Carlton Gardens Primary School     | 1.3 km  |
| University of Melbourne            | 1.32 km |
| University High School             | 1.6 km  |

## Public Transportation:

|  |       |
|--|-------|
| Tram: 4-Queen Street / La Trobe Street | 20 m  |
| Bus: La Trobe Street / Queen Street    | 20 m  |
| Train: Melbourne Central Station       | 315 m |

## Other Amenities

|                                 |       |
|---------------------------------|-------|
| Melbourne Central Shopping Mall | 320 m |
| Flagstaff Gardens               | 380 m |
| Queen Victoria Market           | 395 m |
| Chinatown Melbourne             | 680 m |

**PRIVATE SALE**

**CONTACT ROBERT EGGERS**

**0412 329 340**

**Dingle Partners Pty Ltd.** ABN: 67 099 681 188 Tel: 61 3 9614 6688 Fax: 61 3 9629 8811 [www.dinglepartners.com.au](http://www.dinglepartners.com.au)

Directors: Malcolm Dingle FREI AAPI, Robert Eggers AREI, CEA (REIV), Paul Harberts BEng

• **Head Office:** 39 Queen Street, Melbourne VIC 3000 • Carlton • Richmond • St Kilda Rd

# Dingle Partners

- | Estate Agents
- | Sales
- | Property Management
- | Project Management
- | Consultants

Dingle Partners

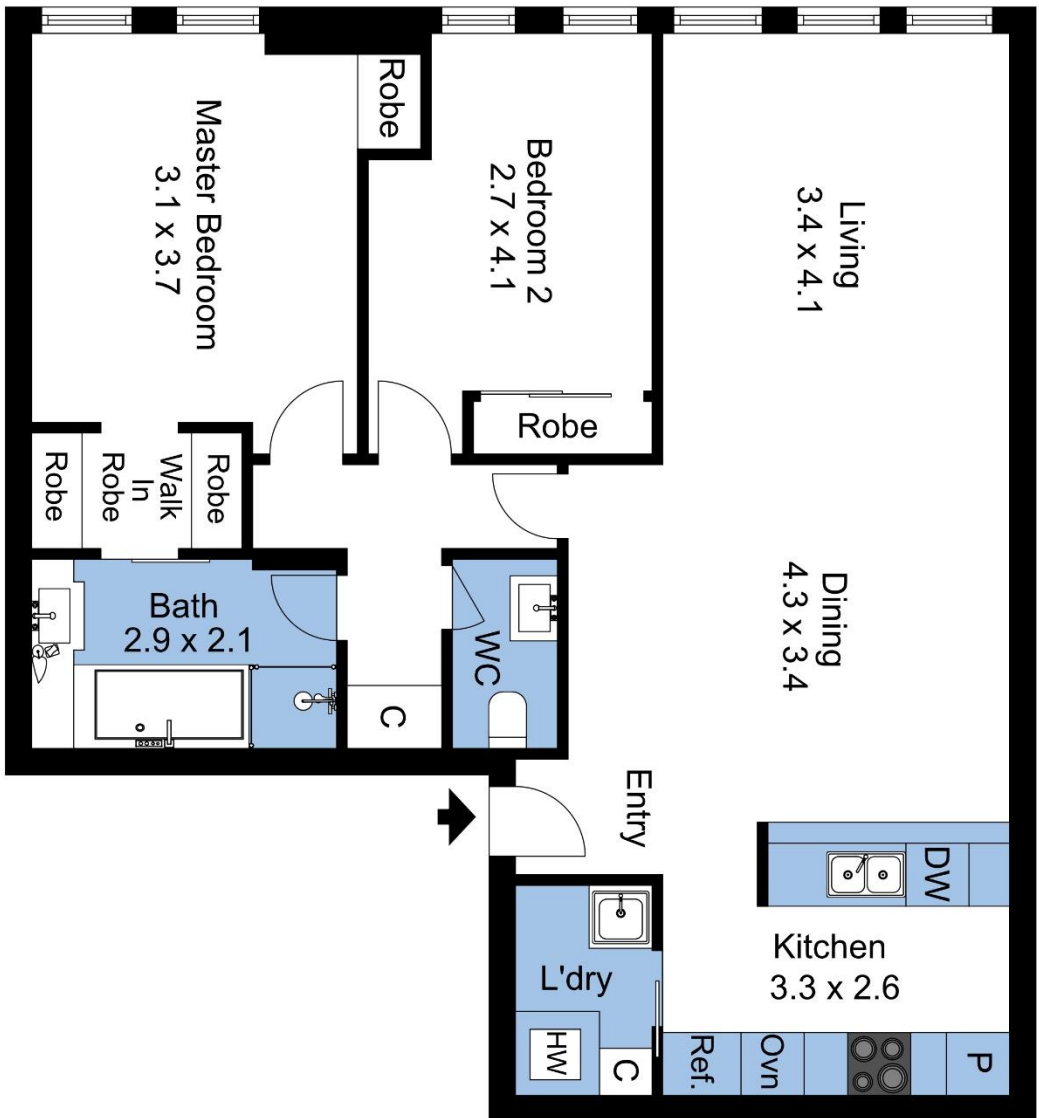

The floor plan is not to scale; measurements are indicative and in metres. Exterior elements are not in position. Plans should not be relied on. Interested parties should make and rely on their own enquiries.



(Not In Position)



(Not In Position)

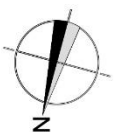

Produced by DIAKRIT