

Contract for the sale and purchase of land 2019 edition

TERM	MEANING OF TERM	NSW DAN:
vendor's agent	Skyline Real Estate 3/14 Frenchs Forest Road FRENCHS FOREST NSW 2086	Phone: 02 9452 3444 Fax: (M) 0416 207 275 Ref: Stuart Bath
co-agent		
vendor	Damien Mark Dwyer & Lucy Victoria Osborne 7 Stirling Place BELROSE NSW 2085	
vendor's solicitor	Sharon Moss Legal Pty Ltd Suite 4124, Level 1, 834 Pittwater Road DEE WHY NSW 2099 (PO Box 1142, Dee Why NSW 2099)	Phone: 02 9981 1211 Fax: 02 9981 1010 Ref: Renee Hill/Lisa Sinclair Email: renee@smosslegal.com.au
date for completion	42nd day after the contract date (clause 15)	
land (address, plan details and title reference)	7 STIRLING PL BELROSE NSW 2085 Lot 32 in Deposited Plan 240704 32/240704	
improvements	<input checked="" type="checkbox"/> VACANT POSSESSION <input type="checkbox"/> subject to existing tenancies <input checked="" type="checkbox"/> HOUSE <input checked="" type="checkbox"/> garage <input type="checkbox"/> carport <input type="checkbox"/> home unit <input type="checkbox"/> carspace <input type="checkbox"/> storage space <input type="checkbox"/> none <input checked="" type="checkbox"/> other: swimming pool	
attached copies	documents in the List of Documents as marked or numbered: other documents:	

A real estate agent is permitted by legislation to fill up the items in this box in a sale of residential property.

inclusions	<input checked="" type="checkbox"/> blinds <input checked="" type="checkbox"/> dishwasher <input checked="" type="checkbox"/> light fittings <input checked="" type="checkbox"/> stove <input checked="" type="checkbox"/> built-in wardrobes <input checked="" type="checkbox"/> fixed floor coverings <input checked="" type="checkbox"/> range hood <input checked="" type="checkbox"/> pool equipment <input checked="" type="checkbox"/> clothes line <input checked="" type="checkbox"/> insect screens <input type="checkbox"/> solar panels <input checked="" type="checkbox"/> TV antenna <input checked="" type="checkbox"/> curtains <input type="checkbox"/> other: air-conditioner, smoke detector
exclusions	mounted TV's x 4, clothes dryer, fridge, gas heater, mirrors
purchaser's solicitor	Phone: Fax: Ref: Email:
price	\$
deposit	\$
balance	\$ (10% of the price, unless otherwise stated)
contract date	(if not stated, the date this contract was made)

buyer's agent

vendor

GST AMOUNT (optional)

The price includes
GST of: \$

witness

purchaser JOINT TENANTS tenants in common in unequal shares

witness

Choices

Vendor agrees to accept a **deposit-bond** (clause 3) NO yes

Nominated Electronic Lodgment Network (ELN) (clause 30): PEXA

Electronic transaction (clause 30) no YES
(if no, vendor must provide further details, such as the proposed applicable waiver, in the space below, or *serve within* 14 days of the contract date):

Tax information (the parties promise this is correct as far as each party is aware)

Land tax is adjustable NO yes
GST: Taxable supply NO yes in full yes to an extent
 Margin scheme will be used in making the taxable supply NO yes

This sale is not a taxable supply because (one or more of the following may apply) the sale is:

- not made in the course or furtherance of an enterprise that the vendor carries on (section 9-5(b))
- by a vendor who is neither registered nor required to be registered for GST (section 9-5(d))
- GST-free because the sale is the supply of a going concern under section 38-325
- GST-free because the sale is subdivided farm land or farm land supplied for farming under Subdivision 38-O
- input taxed because the sale is of eligible residential premises (sections 40-65, 40-75(2) and 195-1)

Purchaser must make a **GSTRW payment** (GST residential withholding payment) NO yes (if yes, vendor must provide further details)

If the further details below are not fully completed at the contract date, the vendor must provide all these details in a separate notice *within* 14 days of the contract date.

GSTRW payment (GST residential withholding payment) – further details

Frequently the supplier will be the vendor. However, sometimes further information will be required as to which entity is liable for GST, for example, if the supplier is a partnership, a trust, part of a GST group or a participant in a GST joint venture.

Supplier's name:

Supplier's ABN:

Supplier's GST branch number (if applicable):

Supplier's business address:

Supplier's email address:

Supplier's phone number:

Supplier's proportion of **GSTRW payment**: \$

If more than one supplier, provide the above details for each supplier.

Amount purchaser must pay – price multiplied by the **GSTRW rate** (residential withholding rate): \$

Amount must be paid: AT COMPLETION at another time (specify):

Is any of the consideration not expressed as an amount in money? NO yes

If "yes", the GST inclusive market value of the non-monetary consideration: \$

Other details (including those required by regulation or the ATO forms):

List of Documents

General	Strata or community title (clause 23 of the contract)
<input checked="" type="checkbox"/> 1 property certificate for the land <input checked="" type="checkbox"/> 2 plan of the land <input type="checkbox"/> 3 unregistered plan of the land <input type="checkbox"/> 4 plan of land to be subdivided <input type="checkbox"/> 5 document to be lodged with a relevant plan <input checked="" type="checkbox"/> 6 section 10.7(2) planning certificate under Environmental Planning and Assessment Act 1979 <input checked="" type="checkbox"/> 7 additional information included in that certificate under section 10.7(5) <input checked="" type="checkbox"/> 8 sewerage infrastructure location diagram (service location diagram) <input checked="" type="checkbox"/> 9 sewer lines location diagram (sewerage service diagram) <input type="checkbox"/> 10 document that created or may have created an easement, profit à prendre, restriction on use or positive covenant disclosed in this contract <input type="checkbox"/> 11 <i>planning agreement</i> <input type="checkbox"/> 12 section 88G certificate (positive covenant) <input type="checkbox"/> 13 survey report <input type="checkbox"/> 14 building information certificate or building certificate given under <i>legislation</i> <input type="checkbox"/> 15 lease (with every relevant memorandum or variation) <input type="checkbox"/> 16 other document relevant to tenancies <input type="checkbox"/> 17 licence benefiting the land <input type="checkbox"/> 18 old system document <input type="checkbox"/> 19 Crown purchase statement of account <input type="checkbox"/> 20 building management statement <input checked="" type="checkbox"/> 21 form of requisitions <input checked="" type="checkbox"/> 22 <i>clearance certificate</i> <input type="checkbox"/> 23 land tax certificate	<input type="checkbox"/> 32 property certificate for strata common property <input type="checkbox"/> 33 plan creating strata common property <input type="checkbox"/> 34 strata by-laws <input type="checkbox"/> 35 strata development contract or statement <input type="checkbox"/> 36 strata management statement <input type="checkbox"/> 37 strata renewal proposal <input type="checkbox"/> 38 strata renewal plan <input type="checkbox"/> 39 leasehold strata - lease of lot and common property <input type="checkbox"/> 40 property certificate for neighbourhood property <input type="checkbox"/> 41 plan creating neighbourhood property <input type="checkbox"/> 42 neighbourhood development contract <input type="checkbox"/> 43 neighbourhood management statement <input type="checkbox"/> 44 property certificate for precinct property <input type="checkbox"/> 45 plan creating precinct property <input type="checkbox"/> 46 precinct development contract <input type="checkbox"/> 47 precinct management statement <input type="checkbox"/> 48 property certificate for community property <input type="checkbox"/> 49 plan creating community property <input type="checkbox"/> 50 community development contract <input type="checkbox"/> 51 community management statement <input type="checkbox"/> 52 document disclosing a change of by-laws <input type="checkbox"/> 53 document disclosing a change in a development or management contract or statement <input type="checkbox"/> 54 document disclosing a change in boundaries <input type="checkbox"/> 55 information certificate under Strata Schemes Management Act 2015 <input type="checkbox"/> 56 information certificate under Community Land Management Act 1989 <input type="checkbox"/> 57 disclosure statement - off the plan contract <input type="checkbox"/> 58 other document relevant to off the plan contract Other <input type="checkbox"/> 59
Home Building Act 1989 <input type="checkbox"/> 24 insurance certificate <input type="checkbox"/> 25 brochure or warning <input type="checkbox"/> 26 evidence of alternative indemnity cover Swimming Pools Act 1992 <input type="checkbox"/> 27 certificate of compliance <input checked="" type="checkbox"/> 28 evidence of registration <input type="checkbox"/> 29 relevant occupation certificate <input type="checkbox"/> 30 certificate of non-compliance <input type="checkbox"/> 31 detailed reasons of non-compliance	

HOLDER OF STRATA OR COMMUNITY TITLE RECORDS – Name, address, email address and telephone number

IMPORTANT NOTICE TO VENDORS AND PURCHASERS

Before signing this contract you should ensure that you understand your rights and obligations, some of which are not written in this contract but are implied by law.

WARNING—SMOKE ALARMS

The owners of certain types of buildings and strata lots must have smoke alarms (or in certain cases heat alarms) installed in the building or lot in accordance with regulations under the *Environmental Planning and Assessment Act 1979*. It is an offence not to comply. It is also an offence to remove or interfere with a smoke alarm or heat alarm. Penalties apply.

WARNING—LOOSE-FILL ASBESTOS INSULATION

Before purchasing land that includes any residential premises (within the meaning of Division 1A of Part 8 of the *Home Building Act 1989*) built before 1985, a purchaser is strongly advised to consider the possibility that the premises may contain loose-fill asbestos insulation (within the meaning of Division 1A of Part 8 of the *Home Building Act 1989*). In particular, a purchaser should:

- (a) search the Register required to be maintained under Division 1A of Part 8 of the *Home Building Act 1989*, and
- (b) ask the relevant local council whether it holds any records showing that the residential premises contain loose-fill asbestos insulation.

For further information about loose-fill asbestos insulation (including areas in which residential premises have been identified as containing loose-fill asbestos insulation), contact NSW Fair Trading.

COOLING OFF PERIOD (PURCHASER'S RIGHTS)

1. This is the statement required by section 66X of the *Conveyancing Act 1919* and applies to a contract for the sale of residential property.
2. EXCEPT in the circumstances listed in paragraph 3, the purchaser may rescind the contract at any time before 5 pm on—
 - (a) the tenth business day after the day on which the contract was made—in the case of an off the plan contract, or
 - (b) the fifth business day after the day on which the contract was made—in any other case.
3. There is NO COOLING OFF PERIOD:
 - (a) if, at or before the time the contract is made, the purchaser gives to the vendor (or the vendor's solicitor or agent) a certificate that complies with section 66W of the Act, or
 - (b) if the property is sold by public auction, or
 - (c) if the contract is made on the same day as the property was offered for sale by public auction but passed in, or
 - (d) if the contract is made in consequence of the exercise of an option to purchase the property, other than an option that is void under section 66ZG of the Act.
4. A purchaser exercising the right to cool off by rescinding the contract will forfeit to the vendor 0.25% of the purchase price of the property. The vendor is entitled to recover the amount forfeited from any amount paid by the purchaser as a deposit under the contract and the purchaser is entitled to a refund of any balance.

DISPUTES

If you get into a dispute with the other party, the Law Society and Real Estate Institute encourage you to use informal procedures such as negotiation, independent expert appraisal, the Law Society Conveyancing Dispute Resolution Scheme or mediation (for example mediation under the Law Society Mediation Program).

AUCTIONS

Regulations made under the Property, Stock and Business Agents Act 2002 prescribe a number of conditions applying to sales by auction.

WARNINGS

1. **Various Acts of Parliament and other matters can affect the rights of the parties to this contract. Some important matters are actions, claims, decisions, licences, notices, orders, proposals or rights of way involving:**

APA Group Australian Taxation Office Council County Council Department of Planning, Industry and Environment Department of Primary Industries Electricity and gas Land & Housing Corporation Local Land Services	NSW Department of Education NSW Fair Trading Owner of adjoining land Privacy Public Works Advisory Subsidence Advisory NSW Telecommunications Transport for NSW Water, sewerage or drainage authority
---	--

If you think that any of these matters affects the property, tell your solicitor.
2. **A lease may be affected by the Agricultural Tenancies Act 1990, the Residential Tenancies Act 2010 or the Retail Leases Act 1994.**
3. **If any purchase money is owing to the Crown, it will become payable before obtaining consent, or if no consent is needed, when the transfer is registered.**
4. **If a consent to transfer is required under legislation, see clause 27 as to the obligations of the parties.**
5. **The vendor should continue the vendor's insurance until completion. If the vendor wants to give the purchaser possession before completion, the vendor should first ask the insurer to confirm this will not affect the insurance.**
6. **The purchaser will usually have to pay transfer duty (and sometimes surcharge purchaser duty) on this contract. If duty is not paid on time, a purchaser may incur penalties.**
7. **If the purchaser agrees to the release of deposit, the purchaser's right to recover the deposit may stand behind the rights of others (for example the vendor's mortgagee).**
8. **The purchaser should arrange insurance as appropriate.**
9. **Some transactions involving personal property may be affected by the Personal Property Securities Act 2009.**
10. **A purchaser should be satisfied that finance will be available at the time of completing the purchase.**
11. **Where the market value of the property is at or above a legislated amount, the purchaser may have to comply with a foreign resident capital gains withholding payment obligation (even if the vendor is not a foreign resident). If so, this will affect the amount available to the vendor on completion.**
12. **Purchasers of some residential properties may have to withhold part of the purchase price to be credited towards the GST liability of the vendor. If so, this will also affect the amount available to the vendor. More information is available from the ATO.**

The vendor sells and the purchaser buys the *property* for the price under these provisions instead of Schedule 3 Conveyancing Act 1919, subject to any *legislation* that cannot be excluded.

1 Definitions (a term in italics is a defined term)

In this contract, these terms (in any form) mean –

<i>adjustment date</i>	the earlier of the giving of possession to the purchaser or completion;
<i>bank</i>	the Reserve Bank of Australia or an authorised deposit-taking institution which is a bank, a building society or a credit union;
<i>business day</i>	any day except a bank or public holiday throughout NSW or a Saturday or Sunday;
<i>cheque</i>	a cheque that is not postdated or stale;
<i>clearance certificate</i>	a certificate within the meaning of s14-220 of Schedule 1 to the <i>TA Act</i> , that covers one or more days falling within the period from and including the contract date to completion;
<i>deposit-bond</i>	a deposit bond or guarantee from an issuer, with an expiry date and for an amount each approved by the vendor;
<i>depositholder</i>	vendor's agent (or if no vendor's agent is named in this contract, the vendor's <i>solicitor</i> , or if no vendor's <i>solicitor</i> is named in this contract, the buyer's agent);
<i>document of title</i>	document relevant to the title or the passing of title;
<i>FRCGW percentage</i>	the percentage mentioned in s14-200(3)(a) of Schedule 1 to the <i>TA Act</i> (12.5% as at 1 July 2017);
<i>FRCGW remittance</i>	a remittance which the purchaser must make under s14-200 of Schedule 1 to the <i>TA Act</i> , being the lesser of the <i>FRCGW percentage</i> of the price (inclusive of GST, if any) and the amount specified in a <i>variation served by a party</i> ;
<i>GST Act</i>	A New Tax System (Goods and Services Tax) Act 1999;
<i>GST rate</i>	the rate mentioned in s4 of A New Tax System (Goods and Services Tax Imposition - General) Act 1999 (10% as at 1 July 2000);
<i>GSTRW payment</i>	a payment which the purchaser must make under s14-250 of Schedule 1 to the <i>TA Act</i> (the price multiplied by the <i>GSTRW rate</i>);
<i>GSTRW rate</i>	the rate determined under ss14-250(6), (8) or (9) of Schedule 1 to the <i>TA Act</i> (as at 1 July 2018, usually 7% of the price if the margin scheme applies, 1/11 th if not);
<i>legislation</i>	an Act or a by-law, ordinance, regulation or rule made under an Act;
<i>normally</i>	subject to any other provision of this contract;
<i>party</i>	each of the vendor and the purchaser;
<i>property</i>	the land, the improvements, all fixtures and the inclusions, but not the exclusions;
<i>planning agreement</i>	a valid voluntary agreement within the meaning of s7.4 of the Environmental Planning and Assessment Act 1979 entered into in relation to the <i>property</i> ;
<i>requisition</i>	an objection, question or requisition (but the term does not include a claim);
<i>rescind</i>	rescind this contract from the beginning;
<i>serve</i>	serve in writing on the other <i>party</i> ;
<i>settlement cheque</i>	an unendorsed <i>cheque</i> made payable to the person to be paid and – <ul style="list-style-type: none"> • issued by a <i>bank</i> and drawn on itself; or • if authorised in writing by the vendor or the vendor's <i>solicitor</i>, some other <i>cheque</i>.
<i>solicitor</i>	in relation to a <i>party</i> , the <i>party's</i> solicitor or licensed conveyancer named in this contract or in a notice <i>served by the party</i> ;
<i>TA Act</i>	Taxation Administration Act 1953;
<i>terminate</i>	terminate this contract for breach;
<i>variation</i>	a variation made under s14-235 of Schedule 1 to the <i>TA Act</i> ;
<i>within</i>	in relation to a period, at any time before or during the period; and
<i>work order</i>	a valid direction, notice or order that requires work to be done or money to be spent on or in relation to the <i>property</i> or any adjoining footpath or road (but the term does not include a notice under s22E of the Swimming Pools Act 1992 or clause 22 of the Swimming Pools Regulation 2018).

2 Deposit and other payments before completion

- 2.1 The purchaser must pay the deposit to the *depositholder* as stakeholder.
- 2.2 *Normally*, the purchaser must pay the deposit on the making of this contract, and this time is essential.
- 2.3 If this contract requires the purchaser to pay any of the deposit by a later time, that time is also essential.
- 2.4 The purchaser can pay any of the deposit by giving cash (up to \$2,000) or by unconditionally giving a *cheque* to the *depositholder* or to the vendor, vendor's agent or vendor's *solicitor* for sending to the *depositholder* or by payment by electronic funds transfer to the *depositholder*.
- 2.5 If any of the deposit is not paid on time or a *cheque* for any of the deposit is not honoured on presentation, the vendor can *terminate*. This right to *terminate* is lost as soon as the deposit is paid in full.
- 2.6 If the vendor accepts a bond or guarantee for the deposit, clauses 2.1 to 2.5 do not apply.

BREACH OF COPYRIGHT MAY RESULT IN LEGAL ACTION

- 2.7 If the vendor accepts a bond or guarantee for part of the deposit, clauses 2.1 to 2.5 apply only to the balance.
- 2.8 If any of the deposit or of the balance of the price is paid before completion to the vendor or as the vendor directs, it is a charge on the land in favour of the purchaser until *termination* by the vendor or completion, subject to any existing right.
- 2.9 If each *party* tells the *depositholder* that the deposit is to be invested, the *depositholder* is to invest the deposit (at the risk of the *party* who becomes entitled to it) with a *bank*, in an interest-bearing account in NSW, payable at call, with interest to be reinvested, and pay the interest to the *parties* equally, after deduction of all proper government taxes and financial institution charges and other charges.

3 Deposit-bond

- 3.1 This clause applies only if this contract says the vendor has agreed to accept a *deposit-bond* for the deposit (or part of it).
- 3.2 The purchaser must provide the original *deposit-bond* to the vendor's *solicitor* (or if no *solicitor* the *depositholder*) at or before the making of this contract and this time is essential.
- 3.3 If the *deposit-bond* has an expiry date and completion does not occur by the date which is 14 days before the expiry date, the purchaser must *serve* a replacement *deposit-bond* at least 7 days before the expiry date. The time for service is essential.
- 3.4 The vendor must approve a replacement *deposit-bond* if –
- 3.4.1 it is from the same issuer and for the same amount as the earlier *deposit-bond*; and
- 3.4.2 it has an expiry date at least three months after its date of issue.
- 3.5 A breach of clauses 3.2 or 3.3 entitles the vendor to *terminate*. The right to *terminate* is lost as soon as –
- 3.5.1 the purchaser *serves* a replacement *deposit-bond*; or
- 3.5.2 the deposit is paid in full under clause 2.
- 3.6 Clauses 3.3 and 3.4 can operate more than once.
- 3.7 If the purchaser *serves* a replacement *deposit-bond*, the vendor must *serve* the earlier *deposit-bond*.
- 3.8 The amount of any *deposit-bond* does not form part of the price for the purposes of clause 16.7.
- 3.9 The vendor must give the purchaser the *deposit-bond* –
- 3.9.1 on completion; or
- 3.9.2 if this contract is *rescinded*.
- 3.10 If this contract is *terminated* by the vendor –
- 3.10.1 *normally*, the vendor can immediately demand payment from the issuer of the *deposit-bond*; or
- 3.10.2 if the purchaser *serves* prior to *termination* a notice disputing the vendor's right to *terminate*, the vendor must forward the *deposit-bond* (or its proceeds if called up) to the *depositholder* as stakeholder.
- 3.11 If this contract is *terminated* by the purchaser –
- 3.11.1 *normally*, the vendor must give the purchaser the *deposit-bond*; or
- 3.11.2 if the vendor *serves* prior to *termination* a notice disputing the purchaser's right to *terminate*, the vendor must forward the *deposit-bond* (or its proceeds if called up) to the *depositholder* as stakeholder.

4 Transfer

- 4.1 *Normally*, the purchaser must *serve* at least 14 days before the date for completion –
- 4.1.1 the form of transfer; and
- 4.1.2 particulars required to register any mortgage or other dealing to be lodged with the transfer by the purchaser or the purchaser's mortgagee.
- 4.2 If any information needed for the form of transfer is not disclosed in this contract, the vendor must *serve* it.
- 4.3 If the purchaser *serves* a form of transfer and the transferee is not the purchaser, the purchaser must give the vendor a direction signed by the purchaser personally for this form of transfer.
- 4.4 The vendor can require the purchaser to include a form of covenant or easement in the transfer only if this contract contains the wording of the proposed covenant or easement, and a description of the land benefited.

5 Requisitions

- 5.1 If a form of *requisitions* is attached to this contract, the purchaser is taken to have made those *requisitions*.
- 5.2 If the purchaser is or becomes entitled to make any other *requisition*, the purchaser can make it only by *servicing* it –
- 5.2.1 if it arises out of this contract or it is a general question about the *property* or title - *within* 21 days after the contract date;
- 5.2.2 if it arises out of anything *served* by the vendor - *within* 21 days after the later of the contract date and that *service*; and
- 5.2.3 in any other case - *within* a reasonable time.

6 Error or misdescription

- 6.1 *Normally*, the purchaser can (but only before completion) claim compensation for an error or misdescription in this contract (as to the *property*, the title or anything else and whether substantial or not).
- 6.2 This clause applies even if the purchaser did not take notice of or rely on anything in this contract containing or giving rise to the error or misdescription.
- 6.3 However, this clause does not apply to the extent the purchaser knows the true position.

7 Claims by purchaser

Normally, the purchaser can make a claim (including a claim under clause 6) before completion only by *servicing* it with a statement of the amount claimed, and if the purchaser makes one or more claims before completion –

- 7.1 the vendor can *rescind* if in the case of claims that are not claims for delay –
- 7.1.1 the total amount claimed exceeds 5% of the price;
- 7.1.2 the vendor *serves* notice of intention to *rescind*; and
- 7.1.3 the purchaser does not *serve* notice waiving the claims *within* 14 days after that *service*; and
- 7.2 if the vendor does not *rescind*, the *parties* must complete and if this contract is completed –
- 7.2.1 the lesser of the total amount claimed and 10% of the price must be paid out of the price to and held by the *depositholder* until the claims are finalised or lapse;
- 7.2.2 the amount held is to be invested in accordance with clause 2.9;
- 7.2.3 the claims must be finalised by an arbitrator appointed by the *parties* or, if an appointment is not made *within* 1 month of completion, by an arbitrator appointed by the President of the Law Society at the request of a *party* (in the latter case the *parties* are bound by the terms of the Conveyancing Arbitration Rules approved by the Law Society as at the date of the appointment);
- 7.2.4 the purchaser is not entitled, in respect of the claims, to more than the total amount claimed and the costs of the purchaser;
- 7.2.5 net interest on the amount held must be paid to the *parties* in the same proportion as the amount held is paid; and
- 7.2.6 if the *parties* do not appoint an arbitrator and neither *party* requests the President to appoint an arbitrator *within* 3 months after completion, the claims lapse and the amount belongs to the vendor.

8 Vendor's rights and obligations

- 8.1 The vendor can *rescind* if –
- 8.1.1 the vendor is, on reasonable grounds, unable or unwilling to comply with a *requisition*;
- 8.1.2 the vendor *serves* a notice of intention to *rescind* that specifies the *requisition* and those grounds; and
- 8.1.3 the purchaser does not *serve* a notice waiving the *requisition* *within* 14 days after that *service*.
- 8.2 If the vendor does not comply with this contract (or a notice under or relating to it) in an essential respect, the purchaser can *terminate* by *servicing* a notice. After the *termination* –
- 8.2.1 the purchaser can recover the deposit and any other money paid by the purchaser under this contract;
- 8.2.2 the purchaser can sue the vendor to recover damages for breach of contract; and
- 8.2.3 if the purchaser has been in possession a *party* can claim for a reasonable adjustment.

9 Purchaser's default

If the purchaser does not comply with this contract (or a notice under or relating to it) in an essential respect, the vendor can *terminate* by *servicing* a notice. After the *termination* the vendor can –

- 9.1 keep or recover the deposit (to a maximum of 10% of the price);
- 9.2 hold any other money paid by the purchaser under this contract as security for anything recoverable under this clause –
- 9.2.1 for 12 months after the *termination*; or
- 9.2.2 if the vendor commences proceedings under this clause *within* 12 months, until those proceedings are concluded; and
- 9.3 sue the purchaser either –
- 9.3.1 where the vendor has resold the *property* under a contract made *within* 12 months after the *termination*, to recover –
- the deficiency on resale (with credit for any of the deposit kept or recovered and after allowance for any capital gains tax or goods and services tax payable on anything recovered under this clause); and
 - the reasonable costs and expenses arising out of the purchaser's non-compliance with this contract or the notice and of resale and any attempted resale; or
- 9.3.2 to recover damages for breach of contract.

10 Restrictions on rights of purchaser

- 10.1 The purchaser cannot make a claim or *requisition* or *rescind* or *terminate* in respect of –
- 10.1.1 the ownership or location of any fence as defined in the Dividing Fences Act 1991;
- 10.1.2 a service for the *property* being a joint service or passing through another property, or any service for another property passing through the *property* ('service' includes air, communication, drainage, electricity, garbage, gas, oil, radio, sewerage, telephone, television or water service);
- 10.1.3 a wall being or not being a party wall in any sense of that term or the *property* being affected by an easement for support or not having the benefit of an easement for support;
- 10.1.4 any change in the *property* due to fair wear and tear before completion;
- 10.1.5 a promise, representation or statement about this contract, the *property* or the title, not set out or referred to in this contract;
- 10.1.6 a condition, exception, reservation or restriction in a Crown grant;

- 10.1.7 the existence of any authority or licence to explore or prospect for gas, minerals or petroleum;
- 10.1.8 any easement or restriction on use the substance of either of which is disclosed in this contract or any non-compliance with the easement or restriction on use; or
- 10.1.9 anything the substance of which is disclosed in this contract (except a caveat, charge, mortgage, priority notice or writ).
- 10.2 The purchaser cannot *rescind* or *terminate* only because of a defect in title to or quality of the inclusions.
- 10.3 *Normally*, the purchaser cannot make a claim or *requisition* or *rescind* or *terminate* or require the vendor to change the nature of the title disclosed in this contract (for example, to remove a caution evidencing qualified title, or to lodge a plan of survey as regards limited title).
- 11 Compliance with work orders**
- 11.1 *Normally*, the vendor must by completion comply with a *work order* made on or before the contract date and if this contract is completed the purchaser must comply with any other *work order*.
- 11.2 If the purchaser complies with a *work order*, and this contract is *rescinded* or *terminated*, the vendor must pay the expense of compliance to the purchaser.
- 12 Certificates and inspections**
- The vendor must do everything reasonable to enable the purchaser, subject to the rights of any tenant –
- 12.1 to have the *property* inspected to obtain any certificate or report reasonably required;
- 12.2 to apply (if necessary in the name of the vendor) for –
- 12.2.1 any certificate that can be given in respect of the *property* under *legislation*; or
- 12.2.2 a copy of any approval, certificate, consent, direction, notice or order in respect of the *property* given under *legislation*, even if given after the contract date; and
- 12.3 to make 1 inspection of the *property* in the 3 days before a time appointed for completion.
- 13 Goods and services tax (GST)**
- 13.1 Terms used in this clause which are not defined elsewhere in this contract and have a defined meaning in the *GST Act* have the same meaning in this clause.
- 13.2 *Normally*, if a *party* must pay the price or any other amount to the other *party* under this contract, GST is not to be added to the price or amount.
- 13.3 If under this contract a *party* must make an adjustment or payment for an expense of another party or pay an expense payable by or to a third party (for example, under clauses 14 or 20.7) –
- 13.3.1 the *party* must adjust or pay on completion any GST added to or included in the expense; but
- 13.3.2 the amount of the expense must be reduced to the extent the party receiving the adjustment or payment (or the representative member of a GST group of which that party is a member) is entitled to an input tax credit for the expense; and
- 13.3.3 if the adjustment or payment under this contract is consideration for a taxable supply, an amount for GST must be added at the *GST rate*.
- 13.4 If this contract says this sale is the supply of a going concern –
- 13.4.1 the *parties* agree the supply of the *property* is a supply of a going concern;
- 13.4.2 the vendor must, between the contract date and completion, carry on the enterprise conducted on the land in a proper and business-like way;
- 13.4.3 if the purchaser is not registered by the date for completion, the *parties* must complete and the purchaser must pay on completion, in addition to the price, an amount being the price multiplied by the *GST rate* ("the retention sum"). The retention sum is to be held by the *depositholder* and dealt with as follows –
- if *within* 3 months of completion the purchaser *serves* a letter from the Australian Taxation Office stating the purchaser is registered with a date of effect of registration on or before completion, the *depositholder* is to pay the retention sum to the purchaser; but
 - if the purchaser does not *serve* that letter *within* 3 months of completion, the *depositholder* is to pay the retention sum to the vendor; and
- 13.4.4 if the vendor, despite clause 13.4.1, *serves* a letter from the Australian Taxation Office stating the vendor has to pay GST on the supply, the purchaser must pay to the vendor on demand the amount of GST assessed.
- 13.5 *Normally*, the vendor promises the margin scheme will not apply to the supply of the *property*.
- 13.6 If this contract says the margin scheme is to apply in making the taxable supply, the *parties* agree that the margin scheme is to apply to the sale of the *property*.
- 13.7 If this contract says the sale is not a taxable supply –
- 13.7.1 the purchaser promises that the *property* will not be used and represents that the purchaser does not intend the *property* (or any part of the *property*) to be used in a way that could make the sale a taxable supply to any extent; and
- 13.7.2 the purchaser must pay the vendor on completion in addition to the price an amount calculated by multiplying the price by the *GST rate* if this sale is a taxable supply to any extent because of –
- a breach of clause 13.7.1; or
 - something else known to the purchaser but not the vendor.
- 13.8 If this contract says this sale is a taxable supply in full and does not say the margin scheme applies to the *property*, the vendor must pay the purchaser on completion an amount of one-eleventh of the price if –

- 13.8.1 this sale is not a taxable supply in full; or
- 13.8.2 the margin scheme applies to the *property* (or any part of the *property*).
- 13.9 If this contract says this sale is a taxable supply to an extent –
- 13.9.1 clause 13.7.1 does not apply to any part of the *property* which is identified as being a taxable supply; and
- 13.9.2 the payments mentioned in clauses 13.7 and 13.8 are to be recalculated by multiplying the relevant payment by the proportion of the price which represents the value of that part of the *property* to which the clause applies (the proportion to be expressed as a number between 0 and 1). Any evidence of value must be obtained at the expense of the vendor.
- 13.10 *Normally*, on completion the vendor must give the recipient of the supply a tax invoice for any taxable supply by the vendor by or under this contract.
- 13.11 The vendor does not have to give the purchaser a tax invoice if the margin scheme applies to a taxable supply.
- 13.12 If the vendor is liable for GST on rents or profits due to issuing an invoice or receiving consideration before completion, any adjustment of those amounts must exclude an amount equal to the vendor's GST liability.
- 13.13 If the purchaser must make a *GSTRW payment* the purchaser must –
- 13.13.1 at least 5 days before the date for completion, *serve* evidence of submission of a *GSTRW payment* notification form to the Australian Taxation Office by the purchaser or, if a direction under clause 4.3 has been *served*, by the transferee named in the transfer *served* with that direction;
- 13.13.2 produce on completion a *settlement cheque* for the *GSTRW payment* payable to the Deputy Commissioner of Taxation;
- 13.13.3 forward the *settlement cheque* to the payee immediately after completion; and
- 13.13.4 *serve* evidence of receipt of payment of the *GSTRW payment* and a copy of the settlement date confirmation form submitted to the Australian Taxation Office.
- 14 Adjustments**
- 14.1 *Normally*, the vendor is entitled to the rents and profits and will be liable for all rates, water, sewerage and drainage service and usage charges, land tax, levies and all other periodic outgoings up to and including the *adjustment date* after which the purchaser will be entitled and liable.
- 14.2 The *parties* must make any necessary adjustment on completion.
- 14.3 If an amount that is adjustable under this contract has been reduced under *legislation*, the *parties* must on completion adjust the reduced amount.
- 14.4 The *parties* must not adjust surcharge land tax (as defined in the Land Tax Act 1956) but must adjust any other land tax for the year current at the *adjustment date* –
- 14.4.1 only if land tax has been paid or is payable for the year (whether by the vendor or by a predecessor in title) and this contract says that land tax is adjustable;
- 14.4.2 by adjusting the amount that would have been payable if at the start of the year –
- the person who owned the land owned no other land;
 - the land was not subject to a special trust or owned by a non-concessional company; and
 - if the land (or part of it) had no separate taxable value, by calculating its separate taxable value on a proportional area basis.
- 14.5 If any other amount that is adjustable under this contract relates partly to the land and partly to other land, the *parties* must adjust it on a proportional area basis.
- 14.6 *Normally*, the vendor can direct the purchaser to produce a *settlement cheque* on completion to pay an amount adjustable under this contract and if so –
- 14.6.1 the amount is to be treated as if it were paid; and
- 14.6.2 the *cheque* must be forwarded to the payee immediately after completion (by the purchaser if the *cheque* relates only to the *property* or by the vendor in any other case).
- 14.7 If on completion the last bill for a water, sewerage or drainage usage charge is for a period ending before the *adjustment date*, the vendor is liable for an amount calculated by dividing the bill by the number of days in the period then multiplying by the number of unbilled days up to and including the *adjustment date*.
- 14.8 The vendor is liable for any amount recoverable for work started on or before the contract date on the *property* or any adjoining footpath or road.
- 15 Date for completion**
- The *parties* must complete by the date for completion and, if they do not, a *party* can *serve* a notice to complete if that *party* is otherwise entitled to do so.
- 16 Completion**
- **Vendor**
- 16.1 On completion the vendor must give the purchaser any *document of title* that relates only to the *property*.
- 16.2 If on completion the vendor has possession or control of a *document of title* that relates also to other property, the vendor must produce it as and where necessary.
- 16.3 *Normally*, on completion the vendor must cause the legal title to the *property* (being an estate in fee simple) to pass to the purchaser free of any mortgage or other interest, subject to any necessary registration.
- 16.4 The legal title to the *property* does not pass before completion.

- 16.5 If the vendor gives the purchaser a document (other than the transfer) that needs to be lodged for registration, the vendor must pay the lodgment fee to the purchaser.
- 16.6 If a *party serves* a land tax certificate showing a charge on any of the land, by completion the vendor must do all things and pay all money required so that the charge is no longer effective against the land.
- **Purchaser**
- 16.7 On completion the purchaser must pay to the vendor, by cash (up to \$2,000) or *settlement cheque* –
- 16.7.1 the price less any:
- deposit paid;
 - *FRCGW remittance payable*;
 - *GSTRW payment*; and
 - amount payable by the vendor to the purchaser under this contract; and
- 16.7.2 any other amount payable by the purchaser under this contract.
- 16.8 If the vendor requires more than 5 *settlement cheques*, the vendor must pay \$10 for each extra *cheque*.
- 16.9 If any of the deposit is not covered by a bond or guarantee, on completion the purchaser must give the vendor an order signed by the purchaser authorising the *depositholder* to account to the vendor for the deposit.
- 16.10 On completion the deposit belongs to the vendor.
- **Place for completion**
- 16.11 *Normally*, the *parties* must complete at the completion address, which is –
- 16.11.1 if a special completion address is stated in this contract - that address; or
- 16.11.2 if none is stated, but a first mortgagee is disclosed in this contract and the mortgagee would usually discharge the mortgage at a particular place - that place; or
- 16.11.3 in any other case - the vendor's *solicitor's* address stated in this contract.
- 16.12 The vendor by reasonable notice can require completion at another place. If it is in NSW, but the vendor must pay the purchaser's additional expenses, including any agency or mortgagee fee.
- 16.13 If the purchaser requests completion at a place that is not the completion address, and the vendor agrees, the purchaser must pay the vendor's additional expenses, including any agency or mortgagee fee.
- 17 Possession**
- 17.1 *Normally*, the vendor must give the purchaser vacant possession of the *property* on completion.
- 17.2 The vendor does not have to give vacant possession if –
- 17.2.1 this contract says that the sale is subject to existing tenancies; and
- 17.2.2 the contract discloses the provisions of the tenancy (for example, by attaching a copy of the lease and any relevant memorandum or variation).
- 17.3 *Normally*, the purchaser can claim compensation (before or after completion) or *rescind* if any of the land is affected by a protected tenancy (a tenancy affected by Schedule 2, Part 7 of the Residential Tenancies Act 2010).
- 18 Possession before completion**
- 18.1 This clause applies only if the vendor gives the purchaser possession of the *property* before completion.
- 18.2 The purchaser must not before completion
- 18.2.1 let or part with possession of any of the *property*;
- 18.2.2 make any change or structural alteration or addition to the *property*; or
- 18.2.3 contravene any agreement between the *parties* or any direction, document, *legislation*, notice or order affecting the *property*.
- 18.3 The purchaser must until completion
- 18.3.1 keep the *property* in good condition and repair having regard to its condition at the giving of possession; and
- 18.3.2 allow the vendor or the vendor's authorised representative to enter and inspect it at all reasonable times.
- 18.4 The risk as to damage to the *property* passes to the purchaser immediately after the purchaser enters into possession.
- 18.5 If the purchaser does not comply with this clause, then without affecting any other right of the vendor –
- 18.5.1 the vendor can, before completion, without notice, remedy the non-compliance; and
- 18.5.2 if the vendor pays the expense of doing this, the purchaser must pay it to the vendor with interest at the rate prescribed under s101 Civil Procedure Act 2005.
- 18.6 If this contract is *rescinded* or *terminated* the purchaser must immediately vacate the *property*.
- 18.7 If the *parties* or their *solicitors* on their behalf do not agree in writing to a fee or rent, none is payable.
- 19 Rescission of contract**
- 19.1 If this contract expressly gives a *party* a right to *rescind*, the *party* can exercise the right –
- 19.1.1 only by *servicing* a notice before completion; and
- 19.1.2 in spite of any making of a claim or *requisition*, any attempt to satisfy a claim or *requisition*, any arbitration, litigation, mediation or negotiation or any giving or taking of possession.
- 19.2 *Normally*, if a *party* exercises a right to *rescind* expressly given by this contract or any *legislation* –
- 19.2.1 the deposit and any other money paid by the purchaser under this contract must be refunded;
- 19.2.2 a *party* can claim for a reasonable adjustment if the purchaser has been in possession;
- 19.2.3 a *party* can claim for damages, costs or expenses arising out of a breach of this contract; and
- 19.2.4 a *party* will not otherwise be liable to pay the other *party* any damages, costs or expenses.

20 Miscellaneous

- 20.1 The *parties* acknowledge that anything stated in this contract to be attached was attached to this contract by the vendor before the purchaser signed it and is part of this contract.
- 20.2 Anything attached to this contract is part of this contract.
- 20.3 An area, bearing or dimension in this contract is only approximate.
- 20.4 If a *party* consists of 2 or more persons, this contract benefits and binds them separately and together.
- 20.5 A *party's solicitor* can receive any amount payable to the *party* under this contract or direct in writing that it is to be paid to another person.
- 20.6 A document under or relating to this contract is –
- 20.6.1 signed by a *party* if it is signed by the *party* or the *party's solicitor* (apart from a direction under clause 4.3);
- 20.6.2 served if it is served by the *party* or the *party's solicitor*;
- 20.6.3 served if it is served on the *party's solicitor*, even if the *party* has died or any of them has died;
- 20.6.4 served if it is served in any manner provided in s170 of the Conveyancing Act 1919;
- 20.6.5 served if it is sent by email or fax to the *party's solicitor*, unless in either case it is not received;
- 20.6.6 served on a person if it (or a copy of it) comes into the possession of the person; and
- 20.6.7 served at the earliest time it is served, if it is served more than once.
- 20.7 An obligation to pay an expense of another *party* of doing something is an obligation to pay –
- 20.7.1 if the *party* does the thing personally - the reasonable cost of getting someone else to do it; or
- 20.7.2 if the *party* pays someone else to do the thing - the amount paid, to the extent it is reasonable.
- 20.8 Rights under clauses 11, 13, 14, 17, 24, 30 and 31 continue after completion, whether or not other rights continue.
- 20.9 The vendor does not promise, represent or state that the purchaser has any cooling off rights.
- 20.10 The vendor does not promise, represent or state that any attached survey report is accurate or current.
- 20.11 A reference to any *legislation* (including any percentage or rate specified in *legislation*) is also a reference to any corresponding later *legislation*.
- 20.12 Each *party* must do whatever is necessary after completion to carry out the *party's* obligations under this contract.
- 20.13 Neither taking possession nor *servicing* a transfer of itself implies acceptance of the *property* or the title.
- 20.14 The details and information provided in this contract (for example, on pages 1 - 3) are, to the extent of each *party's* knowledge, true, and are part of this contract.
- 20.15 Where this contract provides for choices, a choice in BLOCK CAPITALS applies unless a different choice is marked.

21 Time limits in these provisions

- 21.1 If the time for something to be done or to happen is not stated in these provisions, it is a reasonable time.
- 21.2 If there are conflicting times for something to be done or to happen, the latest of those times applies.
- 21.3 The time for one thing to be done or to happen does not extend the time for another thing to be done or to happen.
- 21.4 If the time for something to be done or to happen is the 29th, 30th or 31st day of a month, and the day does not exist, the time is instead the last day of the month.
- 21.5 If the time for something to be done or to happen is a day that is not a *business day*, the time is extended to the next *business day*, except in the case of clauses 2 and 3.2.
- 21.6 *Normally*, the time by which something must be done is fixed but not essential.

22 Foreign Acquisitions and Takeovers Act 1975

- 22.1 The purchaser promises that the Commonwealth Treasurer cannot prohibit and has not prohibited the transfer under the Foreign Acquisitions and Takeovers Act 1975.
- 22.2 This promise is essential and a breach of it entitles the vendor to *terminate*.

23 Strata or community title**• Definitions and modifications**

- 23.1 This clause applies only if the land (or part of it) is a lot in a strata, neighbourhood, precinct or community scheme (or on completion is to be a lot in a scheme of that kind).
- 23.2 In this contract –
- 23.2.1 'change', in relation to a scheme, means –
- a registered or registrable change from by-laws set out in this contract;
 - a change from a development or management contract or statement set out in this contract; or
 - a change in the boundaries of common property;
- 23.2.2 'common property' includes association property for the scheme or any higher scheme;
- 23.2.3 'contribution' includes an amount payable under a by-law;
- 23.2.4 'information certificate' includes a certificate under s184 Strata Schemes Management Act 2015 and s26 Community Land Management Act 1989;
- 23.2.5 'information notice' includes a strata information notice under s22 Strata Schemes Management Act 2015 and a notice under s47 Community Land Management Act 1989;

- 23.2.6 'normal expenses', in relation to an owners corporation for a scheme, means normal operating expenses usually payable from the administrative fund of an owners corporation for a scheme of the same kind;
- 23.2.7 'owners corporation' means the owners corporation or the association for the scheme or any higher scheme;
- 23.2.8 'the *property*' includes any interest in common property for the scheme associated with the lot; and
- 23.2.9 'special expenses', in relation to an owners corporation, means its actual, contingent or expected expenses, except to the extent they are –
- normal expenses;
 - due to fair wear and tear;
 - disclosed in this contract; or
 - covered by moneys held in the capital works fund.
- 23.3 Clauses 11, 14.8 and 18.4 do not apply to an obligation of the owners corporation, or to property insurable by it.
- 23.4 Clauses 14.4.2 and 14.5 apply but on a unit entitlement basis instead of an area basis.
- **Adjustments and liability for expenses**
- 23.5 The *parties* must adjust under clause 14.1 –
- 23.5.1 a regular periodic contribution;
- 23.5.2 a contribution which is not a regular periodic contribution but is disclosed in this contract; and
- 23.5.3 on a unit entitlement basis, any amount paid by the vendor for a normal expense of the owners corporation to the extent the owners corporation has not paid the amount to the vendor.
- 23.6 If a contribution is not a regular periodic contribution and is not disclosed in this contract –
- 23.6.1 the vendor is liable for it if it was determined on or before the contract date, even if it is payable by instalments; and
- 23.6.2 the purchaser is liable for all contributions determined after the contract date.
- 23.7 The vendor must pay or allow to the purchaser on completion the amount of any unpaid contributions for which the vendor is liable under clause 23.6.1.
- 23.8 *Normally*, the purchaser cannot make a claim or *requisition* or *rescind* or *terminate* in respect of –
- 23.8.1 an existing or future actual, contingent or expected expense of the owners corporation;
- 23.8.2 a proportional unit entitlement of the lot or a relevant lot or former lot, apart from a claim under clause 6; or
- 23.8.3 a past or future change in the scheme or a higher scheme.
- 23.9 However, the purchaser can *rescind* if –
- 23.9.1 the special expenses of the owners corporation at the later of the contract date and the creation of the owners corporation when calculated on a unit entitlement basis (and, if more than one lot or a higher scheme is involved, added together), less any contribution paid by the vendor, are more than 1% of the price;
- 23.9.2 in the case of the lot or a relevant lot or former lot in a higher scheme, a proportional unit entitlement for the lot is disclosed in this contract but the lot has a different proportional unit entitlement at the contract date or at any time before completion;
- 23.9.3 a change before the contract date or before completion in the scheme or a higher scheme materially prejudices the purchaser and is not disclosed in this contract; or
- 23.9.4 a resolution is passed by the owners corporation before the contract date or before completion to give to the owners in the scheme for their consideration a strata renewal plan that has not lapsed at the contract date and there is not attached to this contract a strata renewal proposal or the strata renewal plan.
- **Notices, certificates and inspections**
- 23.10 The purchaser must give the vendor 2 copies of an information notice addressed to the owners corporation and signed by the purchaser.
- 23.11 The vendor must complete and sign 1 copy of the notice and give it to the purchaser on completion.
- 23.12 Each *party* can sign and give the notice as agent for the other.
- 23.13 The vendor must *serve* an information certificate issued after the contract date in relation to the lot, the scheme or any higher scheme at least 7 days before the date for completion.
- 23.14 The purchaser does not have to complete earlier than 7 days after *service* of the certificate and clause 21.3 does not apply to this provision. On completion the purchaser must pay the vendor the prescribed fee for the certificate.
- 23.15 The vendor authorises the purchaser to apply for the purchaser's own certificate.
- 23.16 The vendor authorises the purchaser to apply for and make an inspection of any record or other document in the custody or control of the owners corporation or relating to the scheme or any higher scheme.
- **Meetings of the owners corporation**
- 23.17 If a general meeting of the owners corporation is convened before completion –
- 23.17.1 if the vendor receives notice of it, the vendor must immediately notify the purchaser of it; and
- 23.17.2 after the expiry of any cooling off period, the purchaser can require the vendor to appoint the purchaser (or the purchaser's nominee) to exercise any voting rights of the vendor in respect of the lot at the meeting.

24 Tenancies

- 24.1 If a tenant has not made a payment for a period preceding or current at the *adjustment date* –
- 24.1.1 for the purposes of clause 14.2, the amount is to be treated as if it were paid; and
- 24.1.2 the purchaser assigns the debt to the vendor on completion and will if required give a further assignment at the vendor's expense.
- 24.2 If a tenant has paid in advance of the *adjustment date* any periodic payment in addition to rent, it must be adjusted as if it were rent for the period to which it relates.
- 24.3 If the *property* is to be subject to a tenancy on completion or is subject to a tenancy on completion –
- 24.3.1 the vendor authorises the purchaser to have any accounting records relating to the tenancy inspected and audited and to have any other document relating to the tenancy inspected;
- 24.3.2 the vendor must *serve* any information about the tenancy reasonably requested by the purchaser before or after completion; and
- 24.3.3 *normally*, the purchaser can claim compensation (before or after completion) if –
- a disclosure statement required by the Retail Leases Act 1994 was not given when required;
 - such a statement contained information that was materially false or misleading;
 - a provision of the lease is not enforceable because of a non-disclosure in such a statement; or
 - the lease was entered into in contravention of the Retail Leases Act 1994.
- 24.4 If the *property* is subject to a tenancy on completion –
- 24.4.1 the vendor must allow or transfer –
- any remaining bond money or any other security against the tenant's default (to the extent the security is transferable);
 - any money in a fund established under the lease for a purpose and compensation for any money in the fund or interest earned by the fund that has been applied for any other purpose; and
 - any money paid by the tenant for a purpose that has not been applied for that purpose and compensation for any of the money that has been applied for any other purpose;
- 24.4.2 if the security is not transferable, each *party* must do everything reasonable to cause a replacement security to issue for the benefit of the purchaser and the vendor must hold the original security on trust for the benefit of the purchaser until the replacement security issues;
- 24.4.3 the vendor must give to the purchaser –
- a proper notice of the transfer (an attornment notice) addressed to the tenant;
 - any certificate given under the Retail Leases Act 1994 in relation to the tenancy;
 - a copy of any disclosure statement given under the Retail Leases Act 1994;
 - a copy of any document served on the tenant under the lease and written details of its service, if the document concerns the rights of the landlord or the tenant after completion; and
 - any document served by the tenant under the lease and written details of its service, if the document concerns the rights of the landlord or the tenant after completion;
- 24.4.4 the vendor must comply with any obligation to the tenant under the lease, to the extent it is to be complied with by completion; and
- 24.4.5 the purchaser must comply with any obligation to the tenant under the lease, to the extent that the obligation is disclosed in this contract and is to be complied with after completion.

25 Qualified title, limited title and old system title

- 25.1 This clause applies only if the land (or part of it) –
- 25.1.1 is under qualified, limited or old system title; or
- 25.1.2 on completion is to be under one of those titles.
- 25.2 The vendor must *serve* a proper abstract of title *within 7 days* after the contract date.
- 25.3 If an abstract of title or part of an abstract of title is attached to this contract or has been lent by the vendor to the purchaser before the contract date, the abstract or part is *served* on the contract date.
- 25.4 An abstract of title can be or include a list of documents, events and facts arranged (apart from a will or codicil) in date order, if the list in respect of each document –
- 25.4.1 shows its date, general nature, names of parties and any registration number; and
- 25.4.2 has attached a legible photocopy of it or of an official or registration copy of it.
- 25.5 An abstract of title –
- 25.5.1 must start with a good root of title (if the good root of title must be at least 30 years old, this means 30 years old at the contract date);
- 25.5.2 in the case of a leasehold interest, must include an abstract of the lease and any higher lease;
- 25.5.3 *normally*, need not include a Crown grant; and
- 25.5.4 need not include anything evidenced by the Register kept under the Real Property Act 1900.
- 25.6 In the case of land under old system title –
- 25.6.1 in this contract 'transfer' means conveyance;
- 25.6.2 the purchaser does not have to *serve* the form of transfer until after the vendor has *served* a proper abstract of title; and
- 25.6.3 each vendor must give proper covenants for title as regards that vendor's interest.
- 25.7 In the case of land under limited title but not under qualified title –

- 25.7.1 normally, the abstract of title need not include any document which does not show the location, area or dimensions of the land (for example, by including a metes and bounds description or a plan of the land);
- 25.7.2 clause 25.7.1 does not apply to a document which is the good root of title; and
- 25.7.3 the vendor does not have to provide an abstract if this contract contains a delimitation plan (whether in registrable form or not).
- 25.8 The vendor must give a proper covenant to produce where relevant.
- 25.9 The vendor does not have to produce or covenant to produce a document that is not in the possession of the vendor or a mortgagee.
- 25.10 If the vendor is unable to produce an original document in the chain of title, the purchaser will accept a photocopy from the Registrar-General of the registration copy of that document.
- 26 Crown purchase money**
- 26.1 This clause applies only if purchase money is payable to the Crown, whether or not due for payment.
- 26.2 The vendor is liable for the money, except to the extent this contract says the purchaser is liable for it.
- 26.3 To the extent the vendor is liable for it, the vendor is liable for any interest until completion.
- 26.4 To the extent the purchaser is liable for it, the *parties* must adjust any interest under clause 14.1.
- 27 Consent to transfer**
- 27.1 This clause applies only if the land (or part of it) cannot be transferred without consent under *legislation* or a *planning agreement*.
- 27.2 The purchaser must properly complete and then *serve* the purchaser's part of an application for consent to transfer of the land (or part of it) *within 7 days* after the contract date.
- 27.3 The vendor must apply for consent *within 7 days* after *service* of the purchaser's part.
- 27.4 If consent is refused, either *party* can *rescind*.
- 27.5 If consent is given subject to one or more conditions that will substantially disadvantage a *party*, then that *party* can *rescind* *within 7 days* after receipt by or *service* upon the *party* of written notice of the conditions.
- 27.6 If consent is not given or refused –
- 27.6.1 *within 42 days* after the purchaser *serves* the purchaser's part of the application, the purchaser can *rescind*; or
- 27.6.2 *within 30 days* after the application is made, either *party* can *rescind*.
- 27.7 Each period in clause 27.6 becomes 90 days if the land (or part of it) is –
- 27.7.1 under a *planning agreement*; or
- 27.7.2 in the Western Division.
- 27.8 If the land (or part of it) is described as a lot in an unregistered plan, each time in clause 27.6 becomes the later of the time and 35 days after creation of a separate folio for the lot.
- 27.9 The date for completion becomes the later of the date for completion and 14 days after *service* of the notice granting consent to transfer.
- 28 Unregistered plan**
- 28.1 This clause applies only if some of the land is described as a lot in an unregistered plan.
- 28.2 The vendor must do everything reasonable to have the plan registered *within 6 months* after the contract date, with or without any minor alteration to the plan or any document to be lodged with the plan validly required or made under *legislation*.
- 28.3 If the plan is not registered *within* that time and in that manner –
- 28.3.1 the purchaser can *rescind*; and
- 28.3.2 the vendor can *rescind*, but only if the vendor has complied with clause 28.2 and with any *legislation* governing the rescission.
- 28.4 Either *party* can *serve* notice of the registration of the plan and every relevant lot and plan number.
- 28.5 The date for completion becomes the later of the date for completion and 21 days after *service* of the notice.
- 28.6 Clauses 28.2 and 28.3 apply to another plan that is to be registered before the plan is registered.
- 29 Conditional contract**
- 29.1 This clause applies only if a provision says this contract or completion is conditional on an event.
- 29.2 If the time for the event to happen is not stated, the time is 42 days after the contract date.
- 29.3 If this contract says the provision is for the benefit of a *party*, then it benefits only that *party*.
- 29.4 If anything is necessary to make the event happen, each *party* must do whatever is reasonably necessary to cause the event to happen.
- 29.5 A *party* can *rescind* under this clause only if the *party* has substantially complied with clause 29.4.
- 29.6 If the event involves an approval and the approval is given subject to a condition that will substantially disadvantage a *party* who has the benefit of the provision, the *party* can *rescind* *within 7 days* after either *party* *serves* notice of the condition.
- 29.7 If the *parties* can lawfully complete without the event happening –
- 29.7.1 if the event does not happen *within* the time for it to happen, a *party* who has the benefit of the provision can *rescind* *within 7 days* after the end of that time;
- 29.7.2 if the event involves an approval and an application for the approval is refused, a *party* who has the benefit of the provision can *rescind* *within 7 days* after either *party* *serves* notice of the refusal; and

- 29.7.3 the date for completion becomes the later of the date for completion and 21 days after the earliest of –
- either *party serving* notice of the event happening;
 - every *party* who has the benefit of the provision *serving* notice waiving the provision; or
 - the end of the time for the event to happen.
- 29.8 If the *parties* cannot lawfully complete without the event happening –
- 29.8.1 if the event does not happen *within* the time for it to happen, either *party* can *rescind*;
- 29.8.2 if the event involves an approval and an application for the approval is refused, either *party* can *rescind*;
- 29.8.3 the date for completion becomes the later of the date for completion and 21 days after either *party* serves notice of the event happening.
- 29.9 A *party* cannot *rescind* under clauses 29.7 or 29.8 after the event happens.
- 30 Electronic transaction**
- 30.1 This *Conveyancing Transaction* is to be conducted as an *electronic transaction* if –
- 30.1.1 this contract says that it is an *electronic transaction*;
- 30.1.2 the *parties* otherwise agree that it is to be conducted as an *electronic transaction*; or
- 30.1.3 the *conveyancing rules* require it to be conducted as an *electronic transaction*.
- 30.2 However, this *Conveyancing Transaction* is not to be conducted as an *electronic transaction* –
- 30.2.1 if the land is not *electronically tradeable* or the transfer is not eligible to be lodged electronically; or
- 30.2.2 if, at any time after the *effective date*, but at least 14 days before the date for completion, a *party* serves a notice stating a valid reason why it cannot be conducted as an *electronic transaction*.
- 30.3 If, because of clause 30.2.2, this *Conveyancing Transaction* is not to be conducted as an *electronic transaction* –
- 30.3.1 each *party* must –
- bear equally any disbursements or fees; and
 - otherwise bear that *party's* own costs;
- incurred because this *Conveyancing Transaction* was to be conducted as an *electronic transaction*; and
- 30.3.2 if a *party* has paid all of a disbursement or fee which, by reason of this clause, is to be borne equally by the *parties*, that amount must be adjusted under clause 14.2.
- 30.4 If this *Conveyancing Transaction* is to be conducted as an *electronic transaction* –
- 30.4.1 to the extent that any other provision of this contract is inconsistent with this clause, the provisions of this clause prevail;
- 30.4.2 *normally*, words and phrases used in this clause 30 (italicised and in Title Case, such as *Electronic Workspace* and *Lodgment Case*) have the same meaning which they have in the *participation rules*;
- 30.4.3 the *parties* must conduct the *electronic transaction* –
- in accordance with the *participation rules* and the *ECNL*; and
 - using the nominated *ELN*, unless the *parties* otherwise agree;
- 30.4.4 a *party* must pay the fees and charges payable by that *party* to the *ELNO* and the *Land Registry* as a result of this transaction being an *electronic transaction*;
- 30.4.5 any communication from one *party* to another *party* in the *Electronic Workspace* made –
- after the *effective date*; and
 - before the receipt of a notice given under clause 30.2.2;
- is taken to have been received by that *party* at the time determined by s13A of the *Electronic Transactions Act 2000*; and
- 30.4.6 a document which is an *electronic document* is served as soon as it is first *Digitally Signed* in the *Electronic Workspace* on behalf of the *party* required to serve it.
- 30.5 *Normally*, the vendor must *within 7 days* of the *effective date* –
- 30.5.1 create an *Electronic Workspace*;
- 30.5.2 *populate* the *Electronic Workspace* with *title data*, the date for completion and, if applicable, *mortgagee details*; and
- 30.5.3 invite the purchaser and any *discharging mortgagee* to the *Electronic Workspace*.
- 30.6 If the vendor has not created an *Electronic Workspace* in accordance with clause 30.5, the purchaser may create an *Electronic Workspace*. If the purchaser creates the *Electronic Workspace* the purchaser must –
- 30.6.1 *populate* the *Electronic Workspace* with *title data*;
- 30.6.2 create and *populate* an *electronic transfer*;
- 30.6.3 *populate* the *Electronic Workspace* with the date for completion and a nominated *completion time*; and
- 30.6.4 invite the vendor and any *incoming mortgagee* to join the *Electronic Workspace*.
- 30.7 *Normally*, *within 7 days* of receiving an invitation from the vendor to join the *Electronic Workspace*, the purchaser must –
- 30.7.1 join the *Electronic Workspace*;
- 30.7.2 create and *populate* an *electronic transfer*;
- 30.7.3 invite any *incoming mortgagee* to join the *Electronic Workspace*; and
- 30.7.4 *populate* the *Electronic Workspace* with a nominated *completion time*.

- 30.8 If the purchaser has created the *Electronic Workspace* the vendor must *within 7 days* of being invited to the *Electronic Workspace* –
- 30.8.1 join the *Electronic Workspace*;
 - 30.8.2 *populate* the *Electronic Workspace* with *mortgagee details*, if applicable; and
 - 30.8.3 invite any *discharging mortgagee* to join the *Electronic Workspace*.
- 30.9 To complete the financial settlement schedule in the *Electronic Workspace* –
- 30.9.1 the purchaser must provide the vendor with *adjustment figures* at least *2 business days* before the date for completion;
 - 30.9.2 the vendor must confirm the *adjustment figures* at least *1 business day* before the date for completion; and
 - 30.9.3 if the purchaser must make a *GSTRW payment* or an *FRCGW remittance*, the purchaser must *populate* the *Electronic Workspace* with the payment details for the *GSTRW payment* or *FRCGW remittance* payable to the Deputy Commissioner of Taxation at least *2 business days* before the date for completion.
- 30.10 Before completion, the *parties* must ensure that –
- 30.10.1 all *electronic documents* which a *party* must *Digitally Sign* to complete the *electronic transaction* are *populated* and *Digitally Signed*;
 - 30.10.2 all certifications required by the *ECNL* are properly given; and
 - 30.10.3 they do everything else in the *Electronic Workspace* which that *party* must do to enable the *electronic transaction* to proceed to completion.
- 30.11 If completion takes place in the *Electronic Workspace* –
- 30.11.1 payment electronically on completion of the price in accordance with clause 16.7 is taken to be payment by a *single settlement cheque*;
 - 30.11.2 the completion address in clause 16.11 is the *Electronic Workspace*; and
 - 30.11.3 clauses 13.13.2 to 13.13.4, 16.8, 16.12, 16.13 and 31.2.2 to 31.2.4 do not apply.
- 30.12 If the computer systems of any of the *Land Registry*, the *ELNO* or the Reserve Bank of Australia are inoperative for any reason at the *completion time* agreed by the *parties*, a failure to complete this contract for that reason is not a default under this contract on the part of either *party*.
- 30.13 If the computer systems of the *Land Registry* are inoperative for any reason at the *completion time* agreed by the *parties*, and the *parties* choose that financial settlement is to occur despite this, then on financial settlement occurring –
- 30.13.1 all *electronic documents Digitally Signed* by the vendor, the *certificate of title* and any discharge of mortgage, withdrawal of caveat or other *electronic document* forming part of the *Lodgment Case* for the *electronic transaction* shall be taken to have been unconditionally and irrevocably delivered to the purchaser or the purchaser's mortgagee at the time of financial settlement together with the right to deal with the land comprised in the *certificate of title*; and
 - 30.13.2 the vendor shall be taken to have no legal or equitable interest in the *property*.
- 30.14 A *party* who holds a *certificate of title* must act in accordance with any *Prescribed Requirement* in relation to the *certificate of title* but if there is no *Prescribed Requirement*, the vendor must *serve* the *certificate of title* after completion.
- 30.15 If the *parties* do not agree about the delivery before completion of one or more documents or things that cannot be delivered through the *Electronic Workspace*, the *party* required to deliver the documents or things –
- 30.15.1 holds them on completion in escrow for the benefit of; and
 - 30.15.2 must immediately after completion deliver the documents or things to, or as directed by; the *party* entitled to them.
- 30.16 In this clause 30, these terms (in any form) mean –
- adjustment figures* details of the adjustments to be made to the price under clause 14;
 - certificate of title* the paper duplicate of the folio of the register for the land which exists immediately prior to completion and, if more than one, refers to each such paper duplicate;
 - completion time* the time of day on the date for completion when the *electronic transaction* is to be settled;
 - conveyancing rules* the rules made under s12E of the Real Property Act 1900;
 - discharging mortgagee* any discharging mortgagee, chargee, covenant chargee or caveator whose provision of a *Digitally Signed* discharge of mortgage, discharge of charge or withdrawal of caveat is required in order for unencumbered title to the *property* to be transferred to the purchaser;
 - ECNL* the Electronic Conveyancing National Law (NSW);
 - effective date* the date on which the *Conveyancing Transaction* is agreed to be an *electronic transaction* under clause 30.1.2 or, if clauses 30.1.1 or 30.1.3 apply, the contract date;
 - electronic document* a dealing as defined in the Real Property Act 1900 which may be created and *Digitally Signed* in an *Electronic Workspace*;
 - electronic transfer* a transfer of land under the Real Property Act 1900 for the *property* to be prepared and *Digitally Signed* in the *Electronic Workspace* established for the purposes of the *parties'* *Conveyancing Transaction*;

<i>electronic transaction</i>	a <i>Conveyancing Transaction</i> to be conducted for the <i>parties</i> by their legal representatives as <i>Subscribers</i> using an <i>ELN</i> and in accordance with the <i>ECNL</i> and the <i>participation rules</i> ;
<i>electronically tradeable</i>	a land title that is Electronically Tradeable as that term is defined in the <i>conveyancing rules</i> ;
<i>incoming mortgagee</i>	any mortgagee who is to provide finance to the purchaser on the security of the <i>property</i> and to enable the purchaser to pay the whole or part of the price;
<i>mortgagee details</i>	the details which a <i>party</i> to the <i>electronic transaction</i> must provide about any <i>discharging mortgagee</i> of the <i>property</i> as at completion;
<i>participation rules</i>	the participation rules as determined by the <i>ECNL</i> ;
<i>populate</i>	to complete data fields in the <i>Electronic Workspace</i> ; and
<i>title data</i>	the details of the title to the <i>property</i> made available to the <i>Electronic Workspace</i> by the <i>Land Registry</i> .

31 Foreign Resident Capital Gains Withholding

- 31.1 This clause applies only if –
- 31.1.1 the sale is not an excluded transaction within the meaning of s14-215 of Schedule 1 to the *TA Act*; and
- 31.1.2 a *clearance certificate* in respect of every vendor is not attached to this contract.
- 31.2 The purchaser must –
- 31.2.1 at least 5 days before the date for completion, *serve* evidence of submission of a purchaser payment notification to the Australian Taxation Office by the purchaser or, if a direction under clause 4.3 has been *served*, by the transferee named in the transfer *served* with that direction;
- 31.2.2 produce on completion a *settlement cheque* for the *FRCGW remittance* payable to the Deputy Commissioner of Taxation;
- 31.2.3 forward the *settlement cheque* to the payee immediately after completion; and
- 31.2.4 *serve* evidence of receipt of payment of the *FRCGW remittance*.
- 31.3 The vendor cannot refuse to complete if the purchaser complies with clauses 31.2.1 and 31.2.2.
- 31.4 If the vendor *serves* any *clearance certificate* or *variation*, the purchaser does not have to complete earlier than 7 days after that *service* and clause 21.3 does not apply to this provision.
- 31.5 If the vendor *serves* in respect of every vendor either a *clearance certificate* or a *variation* to 0.00 percent, clauses 31.2 and 31.3 do not apply.

32 Residential off the plan contract

- 32.1 This clause applies if this contract is an off the plan contract within the meaning of Division 10 of Part 4 of the *Conveyancing Act 1919* (the *Division*).
- 32.2 No provision of this contract has the effect of excluding, modifying or restricting the operation of the *Division*.
- 32.3 If the purchaser makes a claim for compensation under the terms prescribed by clause 6A of the *Conveyancing (Sale of Land) Regulation 2017* –
- 32.3.1 the purchaser cannot make a claim under this contract about the same subject matter, including a claim under clauses 6 or 7; and
- 32.3.2 the claim for compensation is not a claim under this contract.
- 32.4 This clause does not apply to a contract made before the commencement of the amendments to the *Division* under the *Conveyancing Legislation Amendment Act 2018*.

THESE ARE THE ANNEXED SPECIAL CONDITIONS, COMMENCING WITH SPECIAL CONDITION 33, REFERRED TO IN THE WITHIN CONTRACT FOR THE SALE OF LAND HEREINBEFORE SPECIFIED:-

If there is any inconsistency between any clauses in the printed form and any typed clauses in the special conditions in this contract, the typed special conditions will prevail.

33. AMENDMENTS TO PRINTED CLAUSES:

The form of contract is amended as follows:

- (a) Clause 2.9 is amended by adding the following additional words at the end:-
“... provided that the depositholder shall only be required to invest the deposit if the parties supply to the depositholder their tax file number/s.”
- (b) Clause 7 is amended as follows:-
- (i) 7.1.1 delete 5% and replace with \$1.00; and
 - (ii) 7.2.1 delete 10% and replace with \$1.00.
- (c) Clause 8.1.1 is amended by the deletion of the words “on reasonable grounds”.
- (d) Clause 10.1.8 and 10.1.9 are amended by the deletion of the word substance where it appears and substituting that word with the word “existence”.
- (e) Clause 14.4.2 deleted and replaced with:
14.4.2 by adjusting the amount that would have been payable if at the start of the year :-
- the person who owned the land owned the land on a single holding basis;
 - the full taxable land value was applied without taking into account any land tax threshold provisions;
 - the land was not subject to a special trust or owned by a non-concessional company; and

- if the land (or part of it) had no separate taxable value, by calculating its separate taxable value on a proportional area basis.
- (f) Clause 16.5 delete the words in the second line “plus another 20% of that fee”.
- (g) Clause 16.8 is amended by the deletion of “settlement” where it appears and substituting with “bank” and the deletion of “\$10” where it appears and substituting with “\$5”.
- (h) Clause 16.12 and 16.13 are amended by adding at the end the words “to a maximum sum of \$55.00”.
- (i) Clause 17.3 is amended by the deletion of the words “...claim compensation (before or after completion) or...”.
- (j) Clause 23.13 is amended by deleting “7 days” and replacing with “3 days”.
- (k) Clause 23.14 is amended by deleting “7 days” and replacing with “3 days”.
- (l) Clause 23.17.1 is amended by deletion of the words “must immediately” where it appears and substituting those words with the words “shall as soon as practicable”.

34. CLAIMS BY PURCHASER

Notwithstanding the provisions of Clause 7 of this Agreement to the contrary or any rule of law or equity to the contrary, any claim for compensation made by the Purchaser under this Agreement shall be deemed to be an objection or requisition entitling the Vendor to rescind this Agreement (by notice in writing served on the Purchaser prior to completion) in which event the provisions of Clause 19 shall apply.

35. DEATH, INSOLVENCY, ETC

1) Death or Mental Capacity

If before completion any individual being a party to this Contract dies or becomes mentally ill, then either party may rescind this Contract by service of notice, and the provisions of Clause 19 are to apply.

2) Financial Incapacity of Purchaser

If the Purchaser, being a corporation:-

- (a) goes into liquidation or provisional liquidation;

- (b) has a receiver, manager, receiver and manager, controller (as defined in Section 9 of the *Corporations Law*) or similar officer appointed to it or any of its assets;
- (c) makes an assignment for the benefit of or enters into an arrangement or composition with its creditors;
- (d) stops payment or is unable to pay its debts within the meaning of the *Corporations Law*; or
- (e) if any order is made or a resolution is effectively passed for the winding up of the Purchaser

then the Purchaser is in breach of an essential obligation of this Contract, and the Vendor may terminate this Contract by service of notice, and the provisions of Clause 9 are to prevail.

3) **Bankruptcy**

If the Purchaser is a natural person, the Purchaser warrants to the Vendor that the Purchaser:-

- (a) is not an undischarged bankrupt;
- (b) has not entered into a Deed of Arrangement or called a meeting of creditors under Part X of the *Bankruptcy Act 1966*; and
- (c) has not committed an act of bankruptcy.

36. **AGENT'S COMMISSION**

Purchaser's Warranty and Indemnity

The Purchaser (and if more than one each of them) warrants to the Vendor that he was not introduced to the property by any agent other than the agent referred to herein (if any), nor was any other agent the effective cause of the sale herein provided for.

The Purchaser hereby agrees to indemnify and keep indemnified the Vendor against any claim for commission by any agent (other than the agent referred to herein) arising out of any claim by such agent that such agent introduced the Purchaser to the property or was the effective cause of the sale herein provided for. This condition shall not merge on completion hereof.

37. REPRESENTATIONS, WARRANTIES AND ACKNOWLEDGEMENTS BY PURCHASER

37.1 The Purchaser acknowledges that the Purchaser, when entering into this Contract, relied exclusively on the following matters independently of any statements, inducements or representations made by or on behalf of the Vendor (including by any estate agent acting on behalf of the Vendor):-

- (i) the inspection of and investigations relating to the land made by or on behalf of the Purchaser;
- (ii) the warranties and representations expressly contained in the Contract;
- (iii) the skill and judgment of the Purchaser, its consultants and representatives;
- (iv) opinions or advice obtained by the Purchaser independently of the Vendor or of the Vendor's agents or employees.

37.2 The Purchaser acknowledges that no representations, inducements or warranties have been made by the Vendor or its agents or representatives relating to the present state or condition of the property, its suitability for the purposes of the Purchaser, any patent or latent defects, any and all services to the property including but not limited to water or sewerage main, any underground or surface stormwater pipe or drain passing through or over or under the property, any sewer, manhole or vent which is on the property, the downpipes on the property, improvements erected on the property, any contamination relating to, caused by, or affecting the property or any proposed work to be done to the property. The Purchaser purchases the property and inclusions in their existing condition and state of repair and the Purchaser shall not call upon the Vendor to carry out any repairs whatsoever in relation to the property or inclusions sold.

37.3 The Purchaser acknowledges that they are purchasing the property:

- (a) Subject to all defects latent and patent;
- (b) Subject to any infestations or dilapidations;
- (c) subject to all existing water, sewerage, drainage and plumbing services and connections passing through or over the property;

- (d) Subject to all telephone or electricity lines whether the property of any Local Authority or third party or any posts, fittings or fixtures therefore erected on or passing over or through the property or to any easements in respect thereof or the absence of any such easements.
- (e) Subject to any non-compliance, that is disclosed herein, with the Local Government Act or any Ordinance under the Act in respect of any building, improvement or fixture on the land.
- (f) Subject to any encroachments by or upon the property.
- (g) Subject to any asbestos in the improvements to the property whether disclosed by the vendor or not.

The Purchaser agrees not to seek, terminate rescind or make any objection requisition or claim for compensation arising out of any of the matters covered by this clause.

37.4 The Purchaser acquire the property with the fences, as they are whether on the correct boundary lines or not and whether give and take fences and in their present condition and state of repair. The Vendor is under no obligation to fence or repair fencing before completion.

37.5 If the property is a strata title lot, for the purposes of this clause property includes the common property and all lots in the strata scheme.

38. NOTICE TO COMPLETE

If either party is unable or unwilling to complete or has failed to complete on the completion date specified in this Agreement, then the other party shall be entitled at any time thereafter to serve a Notice to Complete upon the other party making the time for completion an essential term of the Agreement and a fourteen (14) day notice shall be regarded as reasonable and sufficient for that purpose.

39. LATE COMPLETION

39.1 If this contract is not completed on or before the completion date because of the Purchaser's default then, without prejudice to any other rights or remedies of the Vendor, the Purchaser must pay in cash to the Vendor on the eventual date of completion interest on the balance of the price.

- 39.2 Any such interest shall be calculated at the rate of 10% per annum from the completion date to the date on which the Purchaser completes this Contract, including only one of those dates, but in making this calculation there shall be omitted any part of that period during which completion has been delayed because of the Vendor's default.
- 39.3 If in the circumstances described in clause 39.1 above, a notice to complete is served on behalf of the Vendor then, without prejudice to any other rights or remedies of the Vendor, the Purchaser must pay to the Vendor's solicitors, on the eventual date of completion, the sum of \$275.00 inclusive of GST in respect of the Vendor's additional legal costs.
- 39.4 The parties agree that the calculation of interest and legal costs as above represents a genuine pre-estimate of the Vendor's damages by way of lost interest on the unpaid purchase money, the Vendor's continuing liability for rates, taxes and other outgoings and additional legal costs.
- 39.5 The parties agree that the stipulation for the payment of interest and legal costs in the above circumstances is an essential term of this contract and the Purchaser shall not be entitled to require the Vendor to complete this Contract unless all such amounts are paid on completion.

40. RELEASE OF DEPOSIT

Notwithstanding anything to the contrary hereinbefore contained the Purchaser shall forthwith authorise the release to the Vendor of the deposit paid by the Purchaser herein such sum to be used by the Vendor in the payment of:

- a) deposit for the purchase by the Vendor of another property; or
- b) in the payment of stamp duty on the purchase by the Vendor of another property.

The Vendor warrants that the said deposit will be only paid to an Agent's or Solicitor's Trust Account to be held in trust by such Agent or Solicitor as stakeholder pending the completion of the Vendor's purchase. The Vendor further warrants that he will notify the Purchaser's Solicitor of the name of the Agent or Solicitor to whom the deposit is paid.

41. PURCHASER WARRANTY AS TO FINANCE

The purchaser warrants that:-

- (a) the purchaser does not require finance to purchase the property; or
- (b) the purchaser has obtained approval for such finance as is required to purchase the property.

The purchaser acknowledges that as a result of making the disclosure under this clause, the purchaser cannot terminate this Contract pursuant to the National Credit Code.

42. ADJUSTMENTS FOLLOWING SETTLEMENT

Should any apportionment of outgoings required to be made under this Contract be overlooked or incorrectly calculated on completion, the Vendor and the Purchaser agree that upon being requested by the other party make the correct calculation and pay such amount required to the party to whom it is payable within seven (7) days of such request. This clause shall not merge upon completion.

43. NO SETTLEMENT IN HOLIDAY PERIOD

- (a) The parties agree that any day falling between 21 December 2019 and 10 January 2020 inclusive (the "holiday period") is not a business day and clause 21.5 applies.
- (b) Neither party may require the other party to complete during the holiday period.
- (c) Neither party may serve a notice to complete:-
 - (i) less than 14 days before holiday period; or
 - (ii) during the holiday period.

44. REQUISITIONS ON TITLE

For the purpose for printed clause 5 of this contract the vendor will be deemed to have complied with its obligations if it furnishes to the purchaser replies to requisitions contained in the printed form, a copy of which is attached to the contract.

45. SWIMMING POOL

The Purchasers have inspected the property and are aware that the Swimming Pool has been issued with a Certificate of Non-compliance, a copy of which is annexed to this Contract.

The Vendors agree to carry out such works necessary to make the pool compliant and supply the purchaser with a Pool Certificate of Compliance in accordance with Section 22D of the Swimming Pools Act 1992 prior to completion.

The Vendors agree to consult the purchaser before works are carried out, and that the works will be carried out in a proper and workmanlike manner, and at the vendor's sole expense.

RESIDENTIAL PROPERTY REQUISITIONS ON TITLE

Vendor: **Damian Mark Dwyer, Lucy Victoria Osborne**
Purchaser:
Property: 7 Stirling Place, BELROSE, NSW 2085
Dated:

Possession and tenancies

1. Vacant possession of the Property must be given on completion unless the Contract provides otherwise.
2. Is anyone in adverse possession of the Property or any part of it?
3.
 - (a) What are the nature and provisions of any tenancy or occupancy?
 - (b) If they are in writing, all relevant documentation should be produced, found in order and handed over on completion with notices of attornment.
 - (c) Please specify any existing breaches.
 - (d) All rent should be paid up to or beyond the date of completion.
 - (e) Please provide details of any bond together with the Rental Bond Board's reference number.
 - (f) If any bond money is held by the Rental Bond Board, the appropriate transfer documentation duly signed should be handed over on completion.
4. Is the Property affected by a protected tenancy (a tenancy affected by Parts 2, 3, 4 or 5 of the *Landlord and Tenant (Amendment) Act 1948 (NSW)*)? If so, please provide details.
5. If the tenancy is subject to the *Residential Tenancies Act 2010 (NSW)*:
 - (a) has either the vendor or any predecessor or the tenant applied to the NSW Civil and Administrative Tribunal for an order?
 - (b) have any orders been made by the NSW Civil and Administrative Tribunal? If so, please provide details.

Title

6. Subject to the Contract, on completion the vendor should be registered as proprietor in fee simple of the Property free from all encumbrances and notations.
7. On or before completion, any mortgage, caveat, writ or priority notice must be discharged, withdrawn, cancelled or removed as the case may be or, in the case of a mortgage, caveat or priority notice, an executed discharge or withdrawal or removal handed over on completion.
8. Are there any proceedings pending or concluded that could result in the recording of any writ on the title to the Property or in the General Register of Deeds? If so, full details should be provided at least 14 days prior to completion.
9. When and where may the title documents be inspected?
10. Are any chattels or fixtures subject to any hiring or leasing agreement or charge or to any security interest under the *Personal Properties Securities Act 2009 (Cth)*? If so, details must be given and all indebtedness cleared and title transferred unencumbered to the vendor prior to completion.

Adjustments

11. All outgoings referred to in clause 14.1 of the Contract must be paid up to and including the date of completion.
12. Is the vendor liable to pay land tax or is the Property otherwise charged or liable to be charged with land tax? If so:
 - (a) to what year has a return been made?
 - (b) what is the taxable value of the Property for land tax purposes for the current year?
13. The vendor must serve on the purchaser a current land tax certificate (issued under Section 47 of the *Land Tax Management Act 1956 (NSW)*) at least 14 days before completion.

Survey and building

14. Subject to the Contract, survey should be satisfactory and show that the whole of the Property is available and that there are no encroachments by or upon the Property and that all improvements comply with local government/planning legislation.
15. Is the vendor in possession of a survey report? If so, please produce a copy for inspection prior to completion. The original should be handed over on completion.
16.
 - (a) Have the provisions of the *Local Government Act (NSW)*, the *Environmental Planning and Assessment Act 1979 (NSW)* and their regulations been complied with?
 - (b) Is there any matter that could justify the making of an upgrading or demolition order in respect of any building or structure?
 - (c) Has the vendor a Building Certificate which relates to all current buildings or structures? If so, it should be handed over on completion. Please provide a copy in advance.
 - (d) Has the vendor a Final Occupation Certificate issued under the *Environmental Planning and Assessment Act 1979 (NSW)* for all current buildings or structures? If so, it should be handed over on completion. Please provide a copy in advance.
 - (e) In respect of any residential building work carried out in the last 7 years:
 - (i) please identify the building work carried out;
 - (ii) when was the building work completed?

- (iii) please state the builder's name and licence number;
 - (iv) please provide details of insurance under the *Home Building Act 1989 (NSW)*.
17. Has the vendor (or any predecessor) entered into any agreement with or granted any indemnity to the Council or any other authority concerning any development on the Property?
18. If a swimming pool is included in the sale:
- (a) did its installation or construction commence before or after 1 August 1990?
 - (b) has the swimming pool been installed or constructed in accordance with approvals under the *Local Government Act 1919 (NSW)* and *Local Government Act 1993 (NSW)*?
 - (c) does it comply with the provisions of the *Swimming Pools Act 1992 (NSW)* and regulations relating to access? If not, please provide details or the exemptions claimed;
 - (d) have any notices or orders issued or been threatened under the *Swimming Pools Act 1992 (NSW)* or regulations?
 - (e) if a certificate of non-compliance has issued, please provide reasons for its issue if not disclosed in the contract;
 - (f) originals of certificate of compliance or non-compliance and occupation certificate should be handed over on settlement.
- 19.
- (a) To whom do the boundary fences belong?
 - (b) Are there any party walls?
 - (c) If the answer to Requisition 19(b) is yes, specify what rights exist in relation to each party wall and produce any agreement. The benefit of any such agreement should be assigned to the purchaser on completion.
 - (d) Is the vendor aware of any dispute regarding boundary or dividing fences or party walls?
 - (e) Has the vendor received any notice, claim or proceedings under the *Dividing Fences Act 1991 (NSW)* or the *Encroachment of Buildings Act 1922 (NSW)*?

Affectations

20. Is the vendor aware of any rights, licences, easements, covenants or restrictions as to use other than those disclosed in the Contract?
21. Is the vendor aware of:
- (a) any road, drain, sewer or storm water channel which intersects or runs through the land?
 - (b) any dedication to or use by the public of any right of way or other easement over any part of the land?
 - (c) any latent defects in the Property?
22. Has the vendor any notice or knowledge that the Property is affected by the following:
- (a) any resumption or acquisition or proposed resumption or acquisition?
 - (b) any notice requiring work to be done or money to be spent on the Property or any footpath or road adjoining? If so, such notice must be complied with prior to completion.
 - (c) any work done or intended to be done on the Property or the adjacent street which may create a charge on the Property or the cost of which might be or become recoverable from the purchaser?
 - (d) any sum due to any local or public authority? If so, it must be paid prior to completion.
 - (e) any realignment or proposed realignment of any road adjoining the Property?
 - (f) any contamination including, but not limited to, materials or substances dangerous to health such as asbestos and fibreglass?
- 23.
- (a) Does the Property have the benefit of water, sewerage, drainage, electricity, gas and telephone services?
 - (b) If so, do any of the connections for such services pass through any adjoining land?
 - (c) Do any service connections for any other Property pass through the Property?
24. Has any claim been made by any person to close, obstruct or limit access to or from the Property or to an easement over any part of the Property?

Capacity

25. If the Contract discloses that the vendor is a trustee, evidence should be produced to establish the trustee's power of sale.

Requisitions and transfer

26. If not attached to the Contract and the transaction is not an excluded transaction, any *clearance certificate* under Section 14-220 of Schedule 1 of the *Taxation Administration Act 1953 (Cth)* should be served on the purchaser at least 7 days prior to completion.
27. If the transfer or any other document to be handed over on completion is executed pursuant to a power of attorney, then at least 7 days prior to completion a copy of the registered power of attorney should be produced and found in order.
28. If the vendor has or is entitled to have possession of the title deeds the Certificate Authentication Code must be provided 7 days prior to settlement.
29. Searches, surveys, enquiries and inspection of title deeds must prove satisfactory.
30. The purchaser reserves the right to make further requisitions prior to completion.
31. Unless we are advised by you to the contrary prior to completion, it will be assumed that your replies to these requisitions remain unchanged as at the completion date.



NEW SOUTH WALES LAND REGISTRY SERVICES - TITLE SEARCH

FOLIO: 32/240704

SEARCH DATE	TIME	EDITION NO	DATE
-----	-----	-----	-----
14/11/2019	12:19 PM	7	27/2/2019

NO CERTIFICATE OF TITLE HAS ISSUED FOR THE CURRENT EDITION OF THIS FOLIO.
CONTROL OF THE RIGHT TO DEAL IS HELD BY SUNCORP-METWAY LIMITED.

LAND

LOT 32 IN DEPOSITED PLAN 240704
AT BELROSE
LOCAL GOVERNMENT AREA NORTHERN BEACHES
PARISH OF MANLY COVE COUNTY OF CUMBERLAND
TITLE DIAGRAM DP240704

FIRST SCHEDULE

DAMIEN MARK DWYER
LUCY VICTORIA OSBORNE
AS JOINT TENANTS

(T AE871078)

SECOND SCHEDULE (4 NOTIFICATIONS)

- 1 LAND EXCLUDES MINERALS AND IS SUBJECT TO RESERVATIONS AND
CONDITIONS IN FAVOUR OF THE CROWN - SEE CROWN GRANT(S)
- 2 L400623 COVENANT
- 3 DP240704 RESTRICTION(S) ON THE USE OF LAND
- 4 AP89935 MORTGAGE TO SUNCORP-METWAY LIMITED

NOTATIONS

UNREGISTERED DEALINGS: NIL

*** END OF SEARCH ***

glssmoss02

PRINTED ON 14/11/2019

Obtained from NSW LRS on 14 November 2019 11:19 AM AEST

© Office of the Registrar-General 2019

* Any entries preceded by an asterisk do not appear on the current edition of the Certificate of Title. Warning: the information appearing under notations has not been formally recorded in the Register. GlobalX hereby certifies that the information contained in this document has been provided electronically by the Registrar General in accordance with Section 96B(2) of the Real Property Act 1900. Note: Information contained in this document is provided by GlobalX Pty Ltd, ABN 35 099 032 596, www.globalx.com.au an approved NSW Information Broker.

Form 3-10 BE USED WHEN

FEET INCHES	METRES
0 1/2	0.125
1 0	0.25
1 1/2	0.375
2 0	0.5
2 1/2	0.625
3 0	0.75
3 1/2	0.875
4 0	1.0
4 1/2	1.125
5 0	1.25
5 1/2	1.375
6 0	1.5
6 1/2	1.625
7 0	1.75
7 1/2	1.875
8 0	2.0
8 1/2	2.125
9 0	2.25
9 1/2	2.375
10 0	2.5
10 1/2	2.625
11 0	2.75
11 1/2	2.875
12 0	3.0
12 1/2	3.125
13 0	3.25
13 1/2	3.375
14 0	3.5
14 1/2	3.625
15 0	3.75
15 1/2	3.875
16 0	4.0
16 1/2	4.125
17 0	4.25
17 1/2	4.375
18 0	4.5
18 1/2	4.625
19 0	4.75
19 1/2	4.875
20 0	5.0
20 1/2	5.125
21 0	5.25
21 1/2	5.375
22 0	5.5
22 1/2	5.625
23 0	5.75
23 1/2	5.875
24 0	6.0
24 1/2	6.125
25 0	6.25
25 1/2	6.375
26 0	6.5
26 1/2	6.625
27 0	6.75
27 1/2	6.875
28 0	7.0
28 1/2	7.125
29 0	7.25
29 1/2	7.375
30 0	7.5
30 1/2	7.625
31 0	7.75
31 1/2	7.875
32 0	8.0
32 1/2	8.125
33 0	8.25
33 1/2	8.375
34 0	8.5
34 1/2	8.625
35 0	8.75
35 1/2	8.875
36 0	9.0
36 1/2	9.125
37 0	9.25
37 1/2	9.375
38 0	9.5
38 1/2	9.625
39 0	9.75
39 1/2	9.875
40 0	10.0

CONVERSION TABLE ADDED IN REGISTERAL CONTACT DEPARTMENT

DP 240704

DP 240704

DP 240704

DP 240704

DP 240704

DP 240704

DP 240704

DP 240704

DP 240704

DP 240704

DP 240704

DP 240704

DP 240704

DP 240704

DP 240704

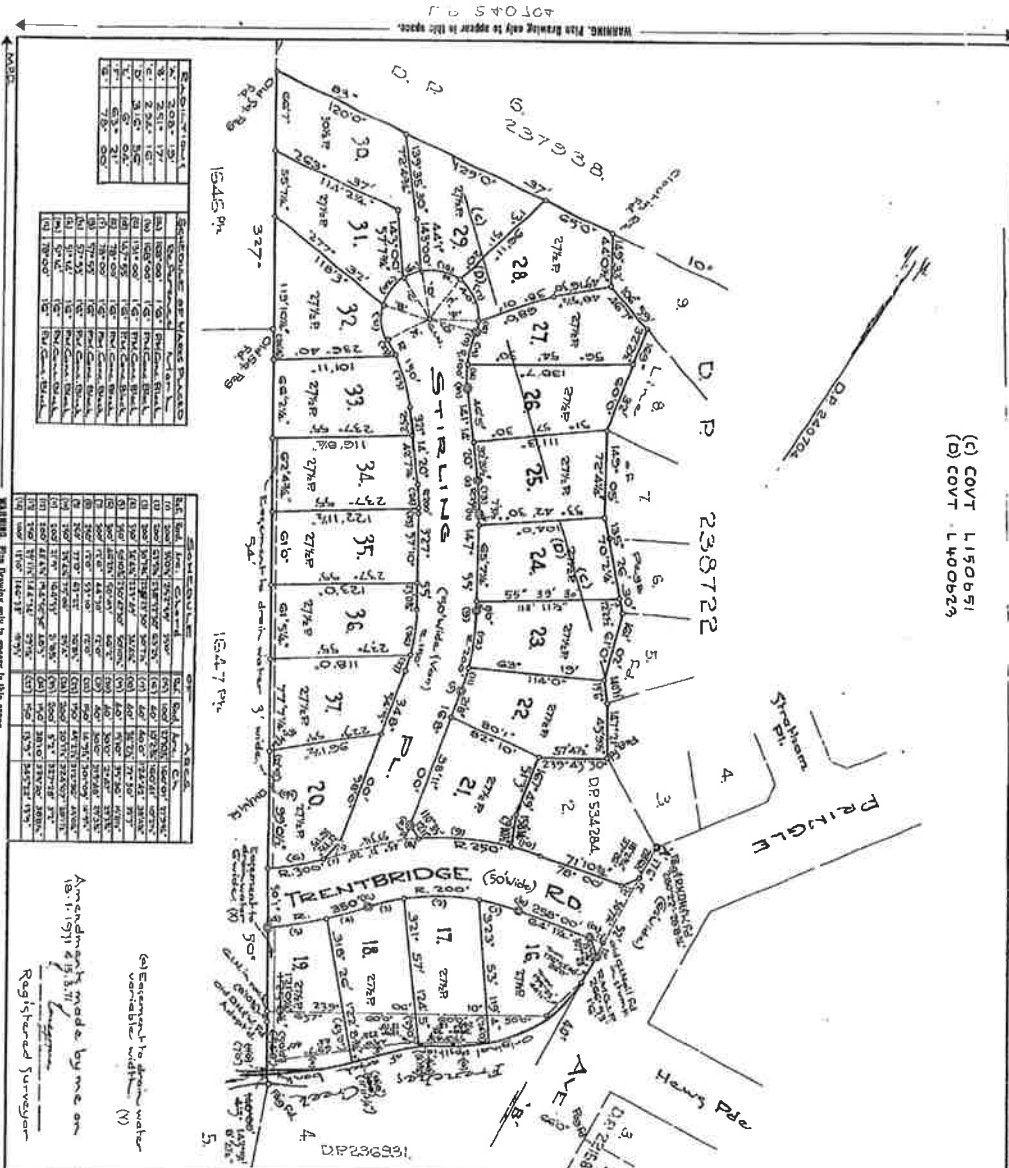

DP 240704
 (C) GOVT L150691
 (D) GOVT L400629

DP 240704
 DP 240704
 DP 240704

DP 240704
 DP 240704
 DP 240704

DP 240704
 DP 240704
 DP 240704

DP 240704
 DP 240704
 DP 240704

DP 240704
 DP 240704
 DP 240704

DP 240704
 DP 240704
 DP 240704

DP 240704
 DP 240704
 DP 240704

DP 240704
 DP 240704
 DP 240704

APPROPRIATIONS ON ADVERTISEMENTS NOTED ON PLAN AT REGISTERAL GENERAL'S OFFICE.

1. I, Bruce Richard Davies, Registrar General for New South Wales, certify that the information contained in this document is in my custody this 9th day of August, 1997.

1

DP 240704
 AC NO P
 SS H
 27 1/2 695.46
 30 1/2 771.8

CONVERSION TABLE ADDED IN REGISTERAL CONTACT DEPARTMENT

DP 240704

2

10	20	30	40	50	60	70	Table of mm	110	120	130	140
----	----	----	----	----	----	----	-------------	-----	-----	-----	-----

AMENDMENTS AND/OR ADDITIONS MADE ON PLAN IN THE LAND TITLES OFFICE

This negative is a photograph made as a permanent record of a document in the custody of the Registrar General this day 2nd May, 1990

M 219992

3

INSTRUMENT SETTING OUT TERMS OF EASEMENTS AND RESTRICTIONS AS TO USER INTENDED TO BE CREATED PURSUANT TO SECTION 88B OF THE CONVEYANCING ACT, 1919.

(Sheet 2 of 3 Sheets)

Plan: DP240704

Subdivision of land covered by Council Clerk's Certificate No. 75702 of 1971.

3. Terms of restriction as to user thirdly referred to in the above-mentioned plan:

- (a) That no main building shall be erected or permitted to remain on the land the subject of this restriction having a minimum over-all floor area (excluding any attached garage, carport or patio) of less than 1,200 square feet.
- (b) That no garage, carport, toilet, shed or other outbuilding shall be erected on the land unless it attaches to and forms part of the main building and is under the main roof of such main building.
- (c) That the total of the external wall area of any building erected on the land the subject of this restriction shall not be of any material other than 80 per centum of brick brick veneer stone or concrete masonry or 80 per centum of any two or more of any such materials or such other materials as may be approved by Planned Projects Pty. Limited and The North Shore Gas Company Limited provided however that no such approval shall in any case be given to the use of asbestos cement or for the use of more than 20 per centum of weatherboards and provided however that eaves or fascias shall not be counted as part of the external wall area.
- (d) That no paling fence will be erected or permitted to remain on the land without the consent in writing of Planned Projects Pty. Limited and The North Shore Gas Company Limited. A paling fence shall not mean a timber lapped and capped fence.
- (e) That no fence shall be erected or permitted to remain along the street frontage of any lot or along or within any side boundary extending from the front boundary to the front alignment of the main building or to the front alignment of any main building on the land immediately adjoining and having a common side boundary with the land hereby ~~restricted~~ provided however that this restriction shall not preclude the erection of brick or masonry screen walls attaching to and forming a part or extension of any such main building upon the lot the subject of this covenant.
- (f) That for the benefit of the lots benefited by this restriction but only during the ownership thereof by Planned Projects Pty. Limited and The North Shore Gas Company Limited that no fence shall be erected on the land the subject of this restriction without the consent of Planned Projects Pty. Limited and The North Shore Gas Company Limited but such consent shall not be withheld if such fence is erected without expense to Planned Projects Pty. Limited and The North Shore Gas Company Limited and in favour of any person dealing with the registered proprietor for the time being of the land the subject of this restriction such consent shall be deemed to have been given in respect of every such fence for the time being erected.

This is Sheet 2 of a 3 Sheet instrument

Instrument pursuant to Regulation 51D Conveyancing Act Regulations, 1961, setting out the terms of easements or restrictions as to user created by registration of the within-mentioned Deponent's Plan

240704

20.3.1971

M 219992

BURRIDGE & LEGG

L400623

21 AM 10 58



New South Wales



MEMORANDUM OF TRANSFER
 (REAL PROPERTY ACT, 1900)

R.P. 13
 Lodgment
 Endorsement

- (Trusts must not be disclosed in the transfer.)
- Typing or handwriting in this instrument should not extend into any margin. Handwriting should be clear and legible and in permanent black non-copying ink.
- a If a fee simple estate, strike out "in fee simple" and interline the required alteration.
- b State in full the name of the person who furnished the consideration monies.
- c Show in BLOCK LETTERS the full name, postal address and description of the persons taking.
- d If more than one person is taking state whether they hold as joint tenants or tenants in common.

We, **HERMAN HEINRICH VONDER**, formerly of Warriewood, but now of Belrose, Painter and **JOHANNA MARIA VONDER** his wife (herein called transferor) being registered as the proprietor of an estate in fee simple in the land hereinafter described, subject, however, to such encumbrances, liens and interests as are notified hereunder, in consideration of Forty one thousand dollars (\$41,000.00 (the receipt whereof is hereby acknowledged) paid to us by

Planned Projects Pty Limited do hereby transfer to

PLANNED PROJECTS PTY LIMITED of 14 The Centre, Forestville
 (herein called transferee)

ALL such our Estate and Interest in ALL THE land mentioned in the schedule following:—

County	Parish	Reference to Title			Description of Land (if part only)*
		Whole or Part	Vol.	Fol.	
Cumberland	Manly Cove	Part	6646	140	Being Lot 1 in Deposited Plan number 534284-534284
Subject to the Covenant annexed hereto and marked with the Letter "A"					

ENCUMBRANCES, &c., REFERRED TO
 Subject to reservations of minerals.

Signed at 1st the th day of November, 19 69.

Signed in my presence by the transferor
HERMAN HEINRICH VONDER
 WHO IS PERSONALLY KNOWN TO ME
H. J. J. J.

Herman Vonder
 Transferor*

Signed in my presence by the Transferor)
JOHANNA MARIA VONDER who is personally)
 Known to me: *H. J. J. J.*)
S. J. J. J.

Johanna Vonder
 Transferor*

THE COMMON SEAL of **PLANNED PROJECTS PTY LIMITED** was signed in my presence by the transferee hereunto affixed in the presence of:
J. J. J. J.
 Secretary,

Accepted, and I hereby certify this Transfer to be correct for the purposes of the Real Property Act.

H. J. J. J.
 Director, (Transferor(s))

The description may refer to the defined residue of the land in a certificate or grant (e.g. "and being residue after Transfer No. ") or may refer to parcels shown in Town or Parish Maps issued by the Dept of Lands or shown in plans filed in the Office of the Registrar General (e.g. "and being lot sec. D.P. "). Unless authorised by Reg. 53 of the Conveyancing Act Regulations, 1961, a plan may not be annexed to or endorsed on this transfer form.

THIS SPACE TO BE LEFT FREE FROM NOTATION

NOT TO BE ALTERED BY ERASURE—See Foot Note

A very short note will suffice.

Execution in New South Wales may be proved if this instrument is signed or acknowledged before the Registrar General, or Deputy Registrar General, or a Notary Public, a J.P., or Commissioner for Affidavits, to whom the Transferor is known, otherwise the attesting witness should appear before one of the above functionaries who having questioned the witness should sign the certificate on the back of this form.

As to instruments executed elsewhere, see Section 107 of the Real Property Act, 1900, Section 168 of the Conveyancing Act, 1919, and Section 52A of the Evidence Act, 1898.

Repeat attestation if necessary.

If the Transferor or Transferee signs by a mark, the attestation must state "that the instrument was read over and explained to him, and that he appeared fully to understand the same."

* If signed by virtue of any power of attorney, the original power must be registered in the Miscellaneous Register, and produced with each dealing, and the memorandum of non-revocation on back of form signed by the attorney before a witness.

† N.B.—Section 117 requires that the above Certificate be signed by each Transferor or his Solicitor or Conveyancer, and renders any person falsely or negligently certifying liable to a penalty; also to damages recoverable by parties injured. Acceptance by the Solicitor or Conveyancer (who must sign his own name, and not that of his firm) is permitted only when the signature of the Transferor cannot be obtained without difficulty, and when the instrument does not impose a liability on the party taking under it. When the instrument contains some special covenant by the Transferor or is subject to a mortgage, encumbrance or lease, the Transferor must accept personally.

No alterations should be made by erasure. The words rejected should be scored through with the pen, and those substituted written over them, the alteration being verified by signature or initials in the margin, or placed in the attestation.

68/11997 A.

11028 232
 2314

L400623

No. _____

Lodged by

H. SIETSONA
23 de Bulewarc
Shalfield

PARTIAL DISCHARGE OF MORTGAGE
 (N.B.—Before execution read marginal note)

Address:

Phone No.:

I,

mortgagee under Mortgage No.

release and discharge the land comprised in the within transfer from such mortgage and all claims thereunder but without prejudice to my rights and remedies as regards the balance of the land comprised in such mortgage.

This discharge is appropriate to a transfer of part of the land in the Mortgage. The mortgagee should execute a formal discharge where the land transferred is the whole of or the residuo of the land in the Certificate of Title or Crown Grant or is the whole of the land in the mortgage.

Dated at _____ this _____ day of _____ 19 _____
 Signed in my presence by _____

who is personally known to me.

Mortgagee.

MEMORANDUM AS TO NON-REVOCATION OF POWER OF ATTORNEY

(To be signed at the time of executing the within instrument)

Memorandum whereby the undersigned states that he has no notice of the revocation of the Power of Attorney registered No. _____ Miscellaneous Register under the authority of which he has just executed the within transfer.

Signed at _____ the _____ day of _____, 19 _____
 Signed in the presence of— _____

Strike out unnecessary words. Add any other matter necessary to show that the power is effective.

CERTIFICATE OF J.P., &c., TAKING DECLARATION OF ATTESTING WITNESS*

Appeared before me at _____, the _____ day of _____, one thousand nine hundred and _____ the attesting witness to this instrument and declared that he personally knew _____ the person signing the same, and whose signature thereto he has attested; and that the name purporting to be such signature of the said _____ is _____ own handwriting, and that he was of sound mind and freely and voluntarily signed the same.

To be signed by Registrar General, Deputy Registrar General, a Notary Public, J.P., Commissioner for Affidavits, or other functionary before whom the attesting witness appears. Not required if the instrument itself be signed or acknowledged before one of these parties.

LEAVE THESE SPACES FOR DEPARTMENTAL USE

INDEXED	MEMORANDUM OF TRANSFER <i>Covenant</i>	DOCUMENTS LODGED HEREWITH To be filled in by person lodging dealing
Checked by <i>H. J. J.</i>	Particulars entered in Register Book, <i>22-5-1969</i>	1. _____ 2. _____ 3. _____ 4. _____ 5. _____ 6. _____ 7. _____
Passed (in S.D.B.) by	at <i>4 pm</i>	Received Docs Nos Receiving Clerk
Signed by <i>B. J.</i>	<i>J. J. J.</i> Registrar General 	

PROGRESS RECORD

	Initials	Date
Sent to Survey Branch		
Received from Records		
Draft written		
Draft examined		
Diagram prepared		
Diagram examined		
Draft forwarded		
Supt. of Engrossers		
Cancellation Clerk		
Vol.	Fol.	

THIS IS THE ANNEXURE MARKED "A" REFERRED TO IN MEMORANDUM OF TRANSFER
BETWEEN HERMAN HEINRICH VONDER and JOHANNA MARIA VONDER to PLANNED
PROJECTS PTY LIMITED DATED THE 1st DAY OF November 1968.

AND the Transferee for itself, its successors and assigns doth hereby covenant with the transferors and their executors, administrators and assigns other than purchasers on sale for the benefit of the adjoining land but only during the ownership thereof by the transferors or their executors, administrators and assigns that no fence shall be erected on the land hereby transferred to divide it from such adjoining land without the consent of the transferors or their executors, administrators and assigns but such consent shall not be withheld if such fence is erected without expense to the transferors and their executors, administrators and assigns and in favour of any person dealing with the transferee or its successors and assigns such consent shall be deemed to have been given in respect of every such fence for the time being erected. The land to which the benefit of the above covenant is intended to be appurtenant is Lot 2 in Deposited Plan number 534284. The land which is to be subject to the burden of the above covenant is the land hereby transferred. The above covenant may be released varied or modified by or with the consent of the transferors or their executors, administrators and assigns.

SIGNED in my presence by Herman
Heinrich Vonder and Johanna Maria
Vonder who are personally known
to me:

H. Himmels

J. W. Vonder
J. M. Vonder

THE COMMON SEAL of PLANNED
PROJECTS PTY LIMITED was hereunto
affixed by Order of the Board of
Directors in the presence of :

J. A. R. Raby
Secretary



L400623

7 days notice re
use of C.T. to

Curridger Legg
23 Apr 1999

M.P.D.

Northern Beaches Council Planning Certificate – Part 2&5

Applicant: The Search People
GPO Box 1585
SYDNEY NSW 2001

Reference: 2000N-35185
Date: 14/11/2019
Certificate No. ePLC2019/6604

Address of Property: 7 Stirling Place BELROSE NSW 2085
Description of Property: Lot 32 DP 240704

Planning Certificate – Part 2

The following certificate is issued under the provisions of Section 10.7(2) of the *Environmental Planning and Assessment Act 1979* (as amended – formerly Section 149). The information applicable to the land is accurate as at the above date.

1. Relevant planning instruments and Development Control Plans

1.1 The name of each environmental planning instrument that applies to the carrying out of development on the land:

1.1a) Local Environmental Plan

Warringah Local Environmental Plan 2011

1.1b) State Environmental Planning Policies and Regional Environmental Plans

State Environmental Planning Policy 1—Development Standards
State Environmental Planning Policy 19 – Bushland in Urban Areas
State Environmental Planning Policy 21 – Caravan Parks
State Environmental Planning Policy 33 – Hazardous and Offensive Development
State Environmental Planning Policy 50 – Canal Estate Development
State Environmental Planning Policy 55 – Remediation of Land
State Environmental Planning Policy 64 – Advertising and Signage
State Environmental Planning Policy 65 – Design Quality of Residential Apartment Development
State Environmental Planning Policy No 70—Affordable Housing (Revised Schemes)
State Environmental Planning Policy (Affordable Rental Housing) 2009
State Environmental Planning Policy (Building Sustainability Index: BASIX) 2004
State Environmental Planning Policy (Educational Establishments and Child Care Facilities) 2017
State Environmental Planning Policy (Exempt and Complying Development Codes) 2008
State Environmental Planning Policy (Housing for Seniors or People with a Disability) 2004

State Environmental Planning Policy (Infrastructure) 2007
State Environmental Planning Policy (Mining, Petroleum Production and Extractive Industries) 2007
State Environmental Planning Policy (Miscellaneous Consent Provisions) 2007
State Environmental Planning Policy (State and Regional Development) 2011
State Environmental Planning Policy (State Significant Precincts) 2005
State Environmental Planning Policy (Vegetation in Non-Rural Areas) 2017
State Environmental Planning Policy (Primary Production and Rural Development) 2019
Sydney Regional Environmental Plan No 20-Hawkesbury-Nepean River (No 2-1997)
State Environmental Planning Policy No 44-Koala Habitat Protection
Sydney Regional Environmental Plan (Sydney Harbour Catchment) 2005
Sydney Regional Environmental Plan No 9-Extractive Industry (No 2-1995)

1.2 Draft Environmental Planning Instruments

The name of each proposed environmental planning instrument that will apply to the carrying out of development on the land and that is or has been subject of community consultation or on public exhibition under the Act (unless the Secretary has notified the Council that the making of the proposed instrument has been deferred indefinitely or has not been approved):

1.2 a) Draft State Environmental Planning Policies

Review of State Environmental Planning Policy 44 – Koala Habitat Protection
Draft State Environmental Planning Policy (Environment)
Draft State Environmental Planning Policy (Short-term Rental Accommodation) 2019
Amendment to State Environmental Planning Policy (Exempt and Complying Development Codes) 2008
Draft Remediation of Land State Environmental Planning Policy (intended to replace State Environmental Planning Policy 55)

1.2 b) Draft Local Environmental Plans

Planning Proposal - Dee Why Town Centre Planning Controls (PEX2018/0002)

Applies to land: Dee Why Town Centre (boundaries identified within the Planning Proposal)

Outline: Amends WLEP 2011 to:

- Increase maximum permissible building heights
- Introduce floor space ratio controls
- Provide development standards in relation to car parking, building setbacks and building proportion
- Identify additional "Key Sites"
- Implement a delivery mechanism for key infrastructure and public domain improvements

Council resolution: 23 September 2014

Gateway Determination: 1 April 2015 amended 22 September 2016

Planning Proposal - Manly Creek Riparian Lands, Manly Vale (in the vicinity of "Mermaid Pool")

Applies to: Crown Land:

- Part Lot 7370 DP1165551 being land adjoining 102 King Street, Manly Vale
- Part Lot 7369 DP1165551 Wandella Road, Allambie Heights, south of Jenna Close, Allambie heights
- Lot 7371 DP1165577
- Part unmade road at the southern end of Wandella Road, King Street, Manly Vale

Outline: Proposed amendment to WLEP 2011 to:

- Amend Land Zoning Map to change the zoning from R2 (Low Density Residential) to RE1 (Public Recreation).
- Amend Height of Building Map and Minimum Lot Size Map to remove the residential development standards for height and minimum lot size from all of the subject lots.

Council resolution: 27 November 2018

Gateway Determination: 9 August 2019

1.3 Development Control Plans

The name of each development control plan that applies to the carrying out of development on the land:

Warringah Development Control Plan 2011

2. Zoning and land use under relevant Local Environmental Plans

For each environmental planning instrument or proposed instrument referred to in Clause 1 (other than a SEPP or proposed SEPP) that includes the land in any zone (however described):

2.1 Zoning and land use under relevant Local Environmental Plans

2.1 (a), (b), (c) & (d)

The following information identifies the purposes for which development may be carried out with or without development consent and the purposes for which the carrying out of development is prohibited, for all zones (however described) affecting the land to which the relevant Local Environmental Plan applies.

EXTRACT FROM WARRINGAH LOCAL ENVIRONMENTAL PLAN 2011

Zone R2 Low Density Residential

1 Objectives of zone

- To provide for the housing needs of the community within a low density residential environment.
- To enable other land uses that provide facilities or services to meet the day to day needs of residents.
- To ensure that low density residential environments are characterised by landscaped settings that are in harmony with the natural environment of Warringah.

2 Permitted without consent

Home-based child care; Home occupations

3 Permitted with consent

Bed and breakfast accommodation; Boarding houses; Boat sheds; Building identification signs; Business identification signs; Centre-based child care facilities; Community facilities; Dwelling houses; Educational establishments; Emergency services facilities; Environmental protection works; Exhibition homes; Group homes; Health consulting rooms; Home businesses; Hospitals; Places of public worship; Recreation areas; Respite day care centres; Roads; Secondary dwellings; Veterinary hospitals

4 Prohibited

Any development not specified in item 2 or 3

Additional permitted uses

Additional permitted uses, if any, for which development is permissible with development consent pursuant to Clause 2.5 and Schedule 1 of the relevant Local Environmental Plan:

Nil

(e) Minimum land dimensions

The *Warringah Local Environmental Plan 2011* contains no development standard that fixes minimum land dimensions for the erection of a dwelling house on the land.

(f) Critical habitat

The land does not include or comprise critical habitat.

(g) Conservation areas

The land is not in a heritage conservation area.

(h) Item of environmental heritage

The land does not contain an item of environmental heritage.

2.2 Draft Local Environmental Plan - if any

For any proposed changes to zoning and land use, see Part 1.2 b)

Please contact Council's Strategic and Place Planning unit with enquiries on 1300 434 434.

2A. Zoning and land use under State Environmental Planning Policy (Sydney Region Growth Centres) 2006

The *State Environmental Planning Policy (Sydney Region Growth Centres) 2006* does not apply to the land.

3. Complying Development

The extent to which the land is land on which complying development may or may not be carried out under each of the codes for complying development because of the provisions of clauses 1.17A (1) (c) to (e), (2), (3) and (4), 1.18 (1) (c3) and 1.19 of *State Environmental Planning Policy (Exempt and Complying Development Codes) 2008*.

a) Housing Code

Complying Development under the Housing Code may be carried out on all of the land.

b) Rural Housing Code

Complying Development under the Rural Housing Code may be carried out on all of the land.

c) Low Rise Medium Density Code

Complying Development under the Low Rise Medium Density Code may not be carried out on all the land.

Note: Pursuant to clause 3B.63 of the *State Environmental Planning Policy (Exempt and Complying Development Codes) 2008*, all land in Northern Beaches Council is a 'deferred area' meaning that the Low Rise Medium Density Code does not apply until 31 October 2019.

d) Greenfield Housing Code

Complying Development under the Greenfield Housing Code may not be carried out on all of the land.

e) Housing Alterations Code

Complying Development under the Housing Alterations Code may be carried out on all of the land.

f) General Development Code

Complying Development under the General Development Code may be carried out on all of the land.

g) Commercial and Industrial Alterations Code

Complying Development under the Commercial and Industrial Alterations Code may be carried out on all of the land.

h) Commercial and Industrial (New Buildings and Additions) Code

Complying Development under the Commercial and Industrial (New Buildings and Additions) Code may be carried out on all of the land.

i) Container Recycling Facilities Code

Complying Development under the Container Recycling Facilities Code may be carried out on all of the land.

j) Subdivisions Code

Complying Development under the Subdivisions Code may be carried out on all of the land.

k) Demolition Code

Complying Development under the Demolition Code may be carried out on all of the land.

l) Fire Safety Code

Complying Development under the Fire Safety Code may be carried out on all of the land.

m) Inland Code

Complying Development under the Inland Code does not apply to the land.

Note: Pursuant to clause 3D.1 of the *State Environmental Planning Policy (Exempt and Complying Development Codes) 2008*, the Inland Code only applies to 'inland local government areas'. Northern Beaches local government area is not defined as an 'inland local government area' by *State Environmental Planning Policy (Exempt and Complying Development Codes) 2008*.

4, 4A (Repealed)

4B. Annual charges under Local Government Act 1993 for coastal protection services that relate to existing coastal protection works

The owner of the land (or any previous owner) has not consented in writing to the land being subject to annual charges under section 496B of the *Local Government Act 1993* for coastal protection services that relate to existing coastal protection works (within the meaning of section 553B of that Act).

5. Mine Subsidence

The land has not been proclaimed to be a mine Subsidence (Mine Subsidence) district within the meaning of section 15 of the *Mine Subsidence (Mine Subsidence) Compensation Act, 1961*.

6. Road widening and road realignment

- (a) The land is not affected by a road widening or re-alignment proposal under Division 2 of Part 3 of the *Roads Act 1993*.
- (b) The land is not affected by a road widening or re-alignment proposal under an environmental planning instrument.
- (c) The land is not affected by a road widening or re-alignment proposal under a resolution of Council.

7. Council and other public authority policies on hazard risk restriction

- (a) Council has adopted a number of policies with regard to various hazards or risks which may restrict development on this land. The identified hazard or risk and the respective Council policies which affect the property, if any, are listed below (other than flooding – see 7A):

Nil

- (b) The following information applies to any policy as adopted by any other public authority and notified to the Council for the express purpose of its adoption by that authority being referred to in a planning certificate issued by the Council. The identified hazard or risk and the respective Policy which affect the property, if any, are listed below:

Nil

7A. Flood related development control Information

- (1) Development on the land or part of the land for the purposes of dwelling houses, dual occupancies, multi dwelling housing or residential flat buildings (not including development for the purposes of group homes or seniors housing) is not subject to flood related development controls.
- (2) Development on the land or part of the land for any other purpose is not subject to flood related development controls.

8. Land reserved for acquisition

Environmental planning instrument referred to in Clause 1 does not make provision in relation to the acquisition of the land by a public authority, as referred to in section 3.15 of the Act.

9. Contribution plans

The following applies to the land:

Northern Beaches Section 7.12 Contributions Plan 2019

9A. Biodiversity certified land

The land is not biodiversity certified land under Part 8 of the *Biodiversity Conservation Act 2016* (includes land certified under Part 7AA of the repealed *Threatened Species Conservation Act 1995*).

10. Biodiversity Stewardship Sites

The Council has not been notified by the Chief Executive of the Office of Environment and Heritage that the land is a biodiversity stewardship site under a biodiversity stewardship agreement under Part 5 of the *Biodiversity Conservation Act 2016* (includes land to which a biobanking agreement under Part 7A of the repealed *Threatened Species Conservation Act 1995* relates).

10A. Native vegetation clearing set asides

Council has not been notified by Local Land Services of the existence of a set aside area under section 60ZC of the *Local Land Services Act 2013*.

11. Bush fire prone land

Bush Fire Prone Land

The land is not bush fire prone land.

Draft Northern Beaches Bush Fire Prone Land Map 2018

The land is not bush fire prone land.

12. Property vegetation plans

The Council has not been notified that the land is land to which a vegetation plan under the *Native Vegetation Act 2003* applies.

13. Orders under Trees (Disputes Between Neighbours) Act 2006

Council has not been notified of the existence of an order made under the *Trees (Disputes Between Neighbours) Act 2006* to carry out work in relation to a tree on the land.

14. Directions under Part 3A

There is not a direction by the Minister in force under section 75P(2) (c1) of the Act that a provision of an environmental planning instrument prohibiting or restricting the carrying out of a project or a stage of a project on the land under Part 4 of the Act does not have effect.

15. Site compatibility certificates and conditions for seniors housing

- (a) There is not a current site compatibility certificate (seniors housing), of which the council is aware, in respect of proposed development on the land.
- (b) No condition of consent applies to the property that limits the kind of people who may occupy the premises/ development. This refers only to consents granted after 11 October 2007 with conditions made in accordance with clause 18(2) of *State Environmental Planning Policy (Housing for Seniors or People with a Disability) 2004*.

16. Site compatibility certificates for infrastructure, schools or TAFE establishments

There is not a valid site compatibility certificate (infrastructure) or site compatibility certificate (schools or TAFE establishments), of which the council is aware, in respect of proposed development on the land.

17. Site compatibility certificate and conditions for affordable rental housing

- (a) There is not a current site compatibility certificate (affordable rental housing), of which the council is aware, in respect of proposed development on the land.
- (b) There are not terms of a kind referred to in clause 17 (1) or 38 (1) of *State Environmental Planning Policy (Affordable Rental Housing) 2009* that have been imposed as a condition of consent to a development application in respect of the land.

18. Paper subdivision information

There is no current paper subdivision, of which council is aware, in respect of this land according to Part 16C of the *Environmental Planning and Assessment Regulation 2000*.

19. Site verification certificates

There is no current site verification certificate, of which council is aware, in respect of the land according to Part 4AA of the *State Environmental Planning Policy (Mining, Petroleum Production and Extractive Industries) 2007*.

20. Loose-fill asbestos insulation

The residential dwelling erected on this land has not been identified in the Loose-Fill Asbestos Insulation Register as containing loose-fill asbestos ceiling insulation.

This clause applies to residential premises (within the meaning of Division 1A of part 8 of the Home Building Act 1989) that are listed in the register that is required to be maintained under that Division.

Contact NSW Fair Trading for more information.

21 Affected building notices and building product rectification orders

- (1) There is not an affected building notice of which the council is aware that is in force in respect of the land.
- (2) There is not a building product rectification order of which the council is aware that is in force in respect of the land and has not been fully complied with, and
- (3) There is not a notice of intention to make a building product rectification order of which the council is aware has been given in respect of the land and is outstanding.

In this clause:

affected building notice has the same meaning as in Part 4 of the *Building Products (Safety) Act 2017*.

building product rectification order has the same meaning as in the *Building Products (Safety) Act 2017*.

Additional matters under the Contaminated Land Management Act 1997

Note. The following matters are prescribed by section 59 (2) of the *Contaminated Land Management Act 1997* as additional matters to be specified in a planning certificate:

- (a) the land to which the certificate relates is not significantly contaminated land within the meaning of that Act
- (b) the land to which the certificate relates is not subject to a management order within the meaning of that Act
- (c) the land to which the certificate relates is not the subject of an approved voluntary management proposal within the meaning of that Act
- (d) the land to which the certificate relates is not subject to an ongoing maintenance order within the meaning of that Act
- (e) the land to which the certificate relates is not the subject of a site audit statement

If contamination is identified above please contact the Environmental Protection Authority (EPA) for further information.

Planning Certificate – Part 5

ePLC2019/6604

The following is information provided in good faith under the provisions of Section 10.7(5) of the *Environmental Planning and Assessment Act 1979* (as amended – formerly Section 149) and lists relevant matters affecting the land of which Council is aware. The Council shall not incur any liability in respect of any such advice.

Persons relying on this certificate should read the environmental planning instruments referred to in this certificate.

Company Title Subdivision

Clause 4.1 of the *Pittwater Local Environmental Plan 2014*, *Warringah Local Environmental Plan 2011* or *Manly Local Environmental Plan 2013* provides that land may not be subdivided except with the consent of the Council. This includes subdivision by way of company title schemes. Persons considering purchasing property in the Northern Beaches local government area the subject of a company title scheme are advised to check that the land has been subdivided with the consent of the Council.

District Planning

Under the Greater Sydney Regional Plan – A Metropolis of Three Cities 2018, the Greater Sydney Commission sets a planning framework for a metropolis of three cities across Greater Sydney which reach across five Districts. Northern Beaches is located within the ‘Eastern Harbour City’ area and is in the North District which forms a large part of the Eastern Harbour City. The North District Plan sets out planning priorities and actions for the growth of the North District, including Northern Beaches. Northern Beaches Council is preparing a Local Strategic Planning Statement which will give effect to the District Plan based on local characteristics and opportunities and Council’s own priorities in the community.

Council Resolution To Amend Environmental Planning Instrument

The following instrument or resolution of Council proposes to vary the provisions of an environmental planning instrument, other than as referred to in the Planning Certificate – Part 2:

Planning Proposal - Response to Low Rise Medium Density Code

Applies to land: Certain land in the Pittwater Local Environmental Plan 2014 (PLEP 2014) and Manly Local Environmental Plan 2013 (MLEP 2013)

Outline: Seeks to amend the PLEP 2014 and MLEP 2013 in response to issues arising from the future implementation of the NSW Governments’ SEPP (Exempt and Complying Development) Amendment (Low Rise Medium Density Code). The intent of the Planning Proposal is to prohibit:

- manor houses and multi-dwelling housing (including terraces) in zone R2 Low Density Residential zone under the Manly LEP 2013
- dual occupancy in zone R2 Low Density Residential zone under the Manly LEP 2013 and Pittwater LEP 2014
- multi-dwelling housing and dual occupancies in the R3 Zone in the Warriewood Valley under Pittwater LEP 2014

Council resolution: 26 June 2018

Planning Proposal - rezone deferred land within the Oxford Falls Valley & Belrose North area

Applies to land: Land within the B2 Oxford Falls Valley and C8 Belrose North localities of WLEP 2000 and land zoned E4 Environmental Living under WLEP 2011 at Cottage Point (Boundaries identified within the Planning Proposal)

Outline: Amends WLEP 2000 and WLEP 2011 to:

- Transfer the planning controls for land within the B2 Oxford Falls Valley and C8 Belrose North localities of WLEP 2000 into the best fit zones and land use controls under WLEP 2011
- Rezone the majority of the subject land to E3 Environmental Management under WLEP 2011

- Rezone smaller parcels of land to E4 Environmental Living, RU4 Primary Production Small Lots, SP2 Infrastructure, SP1 Special Activities, R5 Large Lot Residential and R2 Low Density Residential under WLEP 2011
- Include various parcels of land as having additional permitted uses under Schedule 1 of WLEP 2011

Council resolution: 24 February 2015

Planning Proposal - Freshwater Village Carpark Reclassification

Applies to land: Oliver Street carpark and Lawrence Street carpark, Freshwater

Outline: Amends WLEP 2011 to:

- Amend Schedule 4 Part 1 to include reference to the land
- Amend LZN_010 map to change the zoning from RE1 - Public Recreation to SP2 - Infrastructure
- Amend HOB_010 map to implement a maximum height of building of 3 metres.

Council resolution: 27 November 2018

Planning Proposal - Manly Warringah War Memorial State Park (Wakehurst Parkway, Allambie Heights & 1 Kirkwood Street, North Balgowlah)

Applies to: **Crown Land:** Lots 76 and 77 DP 504237; Lot 2 DP 710023 and Lot 1 DP 1200869; and **Sydney Water Land:** Lot 1 DP 710023 and Lot 1 DP 835 123

Outline: Proposed amendment to WLEP 2011 to:

- Amend Land Zoning Map to change the zoning from R2 (Low Density Residential) to RE1 (Public Recreation) for Lots 76 and 77 DP 504237, Lots 1 and 2 DP 710023, and Lot 1 DP 1200869.
- Amend Land Zoning Map to change the zoning from R2 (Low Density Residential) to SP2 (Infrastructure) - 'Water Supply System' for Lot 1 DP 835123.
- Amend Height of Building Map and Minimum Lot Size Map to remove the residential development standards for height and minimum lot size from all of the subject lots.

Council resolution: 28 May 2019

Planning Proposal - Pittwater Road and Albert Street, Narrabeen

Applies to: 1294 - 1300 Pittwater Road and 2 - 4 Albert Street, Narrabeen

Outline: Amends WLEP 2011 to:

- Amend Height of Building Map to increase height from 8.5m to 11m (excluding lot 1 DP613544 and part lot 8C DP200030).
- Amend Schedule 1 to allow "shop top housing" on the site.
- To seek an affordable housing contribution in conjunction with future redevelopment of the land.

Council resolution: 28 May 2019

Additional Information Applying To The Land

Additional information, if any, relating to the land the subject of this certificate:

Nil

General Information

Threatened Species

Many threatened species identified under the *Biodiversity Conservation Act 2016* (NSW) and Environment Protection and Biodiversity Conservation Act 1999 (Commonwealth) are found within

the former Local Government Area of Warringah (now part of Northern Beaches). Council's Natural Environment unit can be contacted to determine whether any site specific information is available for this property. Records of threatened flora and fauna are also available from the NSW Office of Environment and Heritage's Atlas of NSW Wildlife database: <http://www.bionet.nsw.gov.au>

Potential threatened species could include:

(a) threatened species as described in the final determination of the scientific committee to list endangered and vulnerable species under Schedule 1 of the *Biodiversity Conservation Act 2016*, and/or

(b) one or more of the following threatened ecological communities as described in the final determination of the scientific committee to list the ecological communities under Schedule 2 of the *Biodiversity Conservation Act 2016*:

- Duffys Forest Ecological Community in the Sydney Basin Bioregion
- Swamp Sclerophyll Forest on Coastal Floodplain
- Coastal Saltmarsh of the Sydney Basin Bioregion
- Swamp Oak Floodplain Forest
- Bangalay Sand Forest of the Sydney Basin Bioregion
- Themeda grasslands on Seacliffs and Coastal Headlands
- Sydney Freshwater Wetlands in the Sydney Basin Bioregion
- Coastal Upland Swamp in the Sydney Basin Bioregion
- River-Flat Eucalypt Forest on Coastal Floodplains of the New South Wales North Coast, Sydney Basin and South East Corner Bioregions

Bush fire

Certain development may require further consideration under section 79BA or section 91 of the Environmental Planning and Assessment Act 1979, and section 100B of the Rural Fires Act, 1997 with respect to bush fire matters. Contact NSW Rural Fire Service.

Aboriginal Heritage

Many Aboriginal objects are found within the Local Government Area. It is prudent for the purchaser of land to make an enquiry with the Office of Environment and Heritage as to whether any known Aboriginal objects are located on the subject land or whether the land has been declared as an Aboriginal place under the *National Parks and Wildlife Act 1974* (NSW). The carrying out of works may be prevented on land which is likely to significantly affect an Aboriginal object or Aboriginal place. For information relating to Aboriginal sites and objects across NSW, contact: Aboriginal Heritage Information Management System (AHIMS) on (02) 9585 6345 or email AHIMS@environment.nsw.gov.au. Alternatively visit <http://www.environment.nsw.gov.au/licences/AboriginalHeritageInformationManagementSystem.htm>.

Coastal Erosion

Information available to Council indicates coastal erosion may affect a greater number of properties and may present an increased risk to properties than that shown on published hazard maps of the Warringah coastline. Council's Natural Environment Unit can be contacted for further information.

A handwritten signature in black ink, appearing to read 'Ray Brownlee', with a long horizontal stroke extending to the right.

Ray Brownlee PSM
Chief Executive Officer
14/11/2019

0622513

Copy of
Diagram
No.

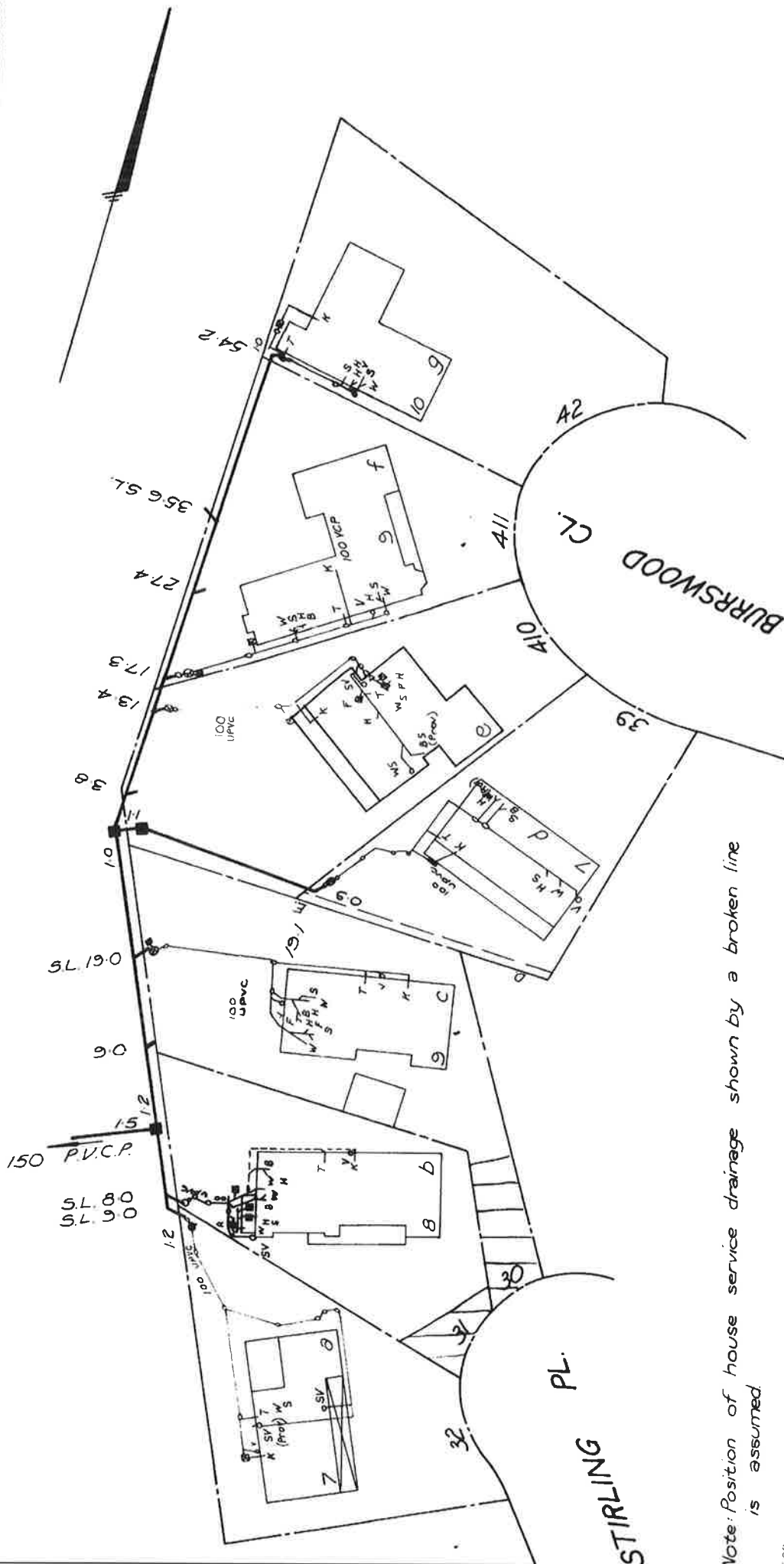

Note: Position of house service drainage shown by a broken line is assumed

SEWER AVAILABLE

Where the sewer is not available and a special inspection is involved the Board accepts no responsibility for the suitability of the drainage in relation to the eventual position of the Board's sewer.
NOTE: This diagram only indicates availability of a sewer and any sewerage service shown as existing in Board's records (By-law 8, Clause 3).
 The existence and position of Board's sewers, stormwater channels, pipes, mains and structures should be ascertained by inspection of maps available at Board's Head Office or in the case of South Coast District at Board's Wollongong Office (Section 33 of Board's Act).
 Position of structures, boundaries, sewers and sewerage services shown hereon are approximate only.

SYMBOLS AND ABBREVIATIONS

Manhole	OWS	Waste Stack
Chamber	IP	Induct Pipe
Lampole	MF	Mica Flap
Boundary Trap	T	Tubs
Inspection Shaft	K	Kitchen Sink
Pit	W	Water Closet
Grease interceptor	B	Bath Waste
Gully	H	Handbasin
P Trap	S	Shower
Reflex Valve	Jn	Junction
Cleaning Eye	DW	Dishwasher
Vertical Pipe	F	Floor Waste
Vent Pipe	M	Washing Machine
OSV	BS	Soil Vent Pipe

M. W. S. & D. B.
SEWERAGE SERVICE DIAGRAM

MUNICIPALITY OF WARRINGAH
 SUBURB OF BELROSE



Scale: Approx. 1:500
 Distances/depths in metres
 pipe diameters in millimetres

for House Services Engineer

DRAINAGE		PLUMBING	
Supervised by	Date of Issue	Supervised by	Date of Issue
Inspector	Outlet N.S.	Inspector	Drainer
Field Diagram Examined by	W.S. Ur.S.	Tracing Checked by	Plumber
Chief Inspector	W.O. 18485	Sheet No.	Gaz. on 25.9.81
Connection Dates: a 9 2 82 b 5 1 82 c 2 10 81 d 28 10 81 e 9 11 83 1 22 12 82 g 12 11 81 h 11 83 1 22 12 82	W.O. 18485	Boundary Trap is not required	

NOTE This diagram only indicates availability of a sewer and any sewerage service shown as existing in Sydney Water's records. The existence and position of Sydney Water's sewers, stormwater channels, pipes, mains and structures should be ascertained by inspection of maps available at any of Sydney Water's Customer Centres. Position of structures, boundaries, sewers and sewerage services shown hereon are approximately only.



MR DAMIEN M DWYER
7 STIRLING PLACE
BELROSE NSW 2085

Our reference: 7113329678715

Phone: 13 28 66

13 November 2019

Your foreign resident capital gains withholding clearance certificate

- › Purchasers are not required to withhold and pay an amount
- › Provide a copy to the purchaser and retain a copy for your records

Hello DAMIEN,

We have decided that purchasers are not required to withhold and pay an amount. Your certificate is below:

Notice number	2410271916308
Vendor name	DAMIEN MARK DWYER
Previous Vendor name	
Vendor address	7 STIRLING PLACE BELROSE NSW 2085
Clearance Certificate Period	12 November 2019 to 12 November 2020

The Commissioner may withdraw this clearance certificate at any time if we obtain further information indicating you are a foreign resident.

Yours sincerely,
James O'Halloran
Deputy Commissioner of Taxation

NEED HELP

Learn more about foreign resident capital gains withholding at ato.gov.au/FRCGW

CONTACT US

In Australia? Phone us on
13 28 66

If you're calling from overseas, phone **+61 2 6216 1111** and ask for **13 28 66** between 8:00am and 5:00pm Australian Eastern Standard time, Monday to Friday.



MS LUCY V OSBORNE
7 STIRLING PLACE
BELROSE NSW 2085

Our reference: 7113329687016

Phone: 13 28 66

13 November 2019

Your foreign resident capital gains withholding clearance certificate

- › Purchasers are not required to withhold and pay an amount
- › Provide a copy to the purchaser and retain a copy for your records

Hello LUCY,

We have decided that purchasers are not required to withhold and pay an amount. Your certificate is below:

Notice number	2410271916671
Vendor name	LUCY VICTORIA OSBORNE
Previous Vendor name	
Vendor address	7 STIRLING PLACE BELROSE NSW 2085
Clearance Certificate Period	12 November 2019 to 12 November 2020

The Commissioner may withdraw this clearance certificate at any time if we obtain further information indicating you are a foreign resident.

Yours sincerely,
James O'Halloran
Deputy Commissioner of Taxation

NEED HELP

Learn more about foreign resident capital gains withholding at ato.gov.au/FRCGW

CONTACT US

In Australia? Phone us on
13 28 66

If you're calling from overseas, phone **+61 2 6216 1111** and ask for **13 28 66** between 8:00am and 5:00pm Australian Eastern Standard time, Monday to Friday.



NSW SWIMMING POOL REGISTER

Certificate of Registration

Section 30C - Swimming Pools Act 1992

Pool No:	331eee3c
Property Address:	7 STIRLING PLACE BELROSE
Date of Registration:	23 August 2013
Type of Pool:	An outdoor pool that is not portable or inflatable
Description of Pool:	in ground

The swimming pool at the above premises has been registered in accordance with Section 30B of the *Swimming Pools Act 1992*.

The issue of this certificate does not negate the need for regular maintenance of the pool.

Please remember:

- **Children should be supervised by an adult at all times when using your pool**
- **Regular pool barrier maintenance**
- **Pool gates must be closed at all times**
- **Don't place climbable articles against your pool barrier**
- **Remove toys from the pool area after use**

You may be required to obtain a Pool Compliance Certificate before you lease or sell your property. Contact your council for further information.

This is NOT a Certificate of Compliance



NSW SWIMMING POOL REGISTER

Certificate of Non-compliance

Clause 21 - Swimming Pools Regulation 2018

Pool no: 331eee3c
Property address: 7 STIRLING PLACE BELROSE
Date of inspection: 18 November 2019
Expiry date: 18 November 2020
Issuing authority: Jennifer Elaine Rose - Accredited Certifier - bpb2862

The swimming pool at the above property **DOES NOT COMPLY** with Part 2 of the *Swimming Pools Act 1992*. Please refer to the accredited certifier's notice, issued under section 22E of the *Swimming Pools Act 1992*, for detailed reasons of non-compliance and rectification works required to render the swimming pool compliant with the applicable standard.

The swimming pool poses a significant risk to public safety

The swimming pool does not pose a significant risk to public safety

Non-compliance area/s:

Boundary fence	<input checked="" type="checkbox"/>	Doors	<input type="checkbox"/>
Fence height	<input checked="" type="checkbox"/>	Fence panels/gaps	<input type="checkbox"/>
Gate closure	<input type="checkbox"/>	Gate latch	<input type="checkbox"/>
Non-ancillary structure	<input type="checkbox"/>	Non-climbable zones	<input checked="" type="checkbox"/>
Signage	<input type="checkbox"/>	Window	<input type="checkbox"/>
Other (see text box below)	<input type="checkbox"/>		

This certificate expires on issuing of a certificate of compliance or 12 months after the date of issue, whichever occurs first.

Purchasers of a property with a non-compliant swimming pool barrier have 90 days from the date of settlement to fix any areas of non-compliance.