

Contract for the sale and purchase of land 2018 edition

TERM	MEANING OF TERM	NSW Duty:
vendor's agent	Up State trading as Up State Real Estate 15/888 Pittwater Road, Dee Why, NSW 2099	Phone: 9971 9000 Fax: 9982 6446
co-agent		
vendor	Bradley Webber and Kathleen Amber Giles 10/20 Clarke Street, Narrabeen, NSW 2101	
vendor's solicitor	Conveyancing at Pittwater 40/2 Forest Road, Warriewood NSW 2102 PO Box 1737, WARRIEWOOD SHOPPING SQUARE NSW 2102	Phone: (02) 9997 3460 Fax: (02) 9997 3468 Ref: MK:11770 E:maureen@conveyancingpittwater.com.au
date for completion land (address, plan details and title reference)	42nd day after the contract date 10/20 Clarke Street, Narrabeen, New South Wales 2101 Registered Plan: Lot 10 Plan SP 7013 Folio Identifier 10/SP7013	(clause 15)

improvements ☒ VACANT POSSESSION ☐ subject to existing tenancies

☐ HOUSE ☒ garage ☐ carport ☒ home unit ☐ carspace ☐ storage space

☐ none ☐ other:

attached copies ☒ documents in the List of Documents as marked or as numbered:

☐ other documents:

A real estate agent is permitted by *legislation* to fill up the items in this box in a sale of residential property.

inclusions ☒ blinds ☐ dishwasher ☒ light fittings ☒ stove

☒ built-in wardrobes ☐ fixed floor coverings ☒ range hood ☐ pool equipment

☐ clothes line ☒ insect screens ☐ solar panels ☐ TV antenna

☐ curtains ☐ other:

exclusions

purchaser

purchaser's solicitor

price \$

deposit \$ (10% of the price, unless otherwise stated)

balance \$

contract date (if not stated, the date this contract was made)

buyer's agent

vendor

GST AMOUNT (optional)

The price includes
GST of: \$

witness

purchaser

☐ JOINT TENANTS ☐ tenants in common ☐ in unequal shares

witness

ChoicesVendor agrees to accept a **deposit-bond** (clause 3)☐ NO☒ yes**Proposed electronic transaction** (clause 30)☐ no☒ YES**Tax information (the parties promise this is correct as far as each party is aware)****Land tax** is adjustable☒ NO☐ yes**GST:** Taxable supply☒ NO☐ yes in full☐ yes to an extent

Margin scheme will be used in making the taxable supply

☒ NO☐ yes

This sale is not a taxable supply because (one or more of the following may apply) the sale is:

☐ not made in the course or furtherance of an enterprise that the vendor carries on (section 9-5(b))☐ by a vendor who is neither registered nor required to be registered for GST (section 9-5(d))☐ GST-free because the sale is the supply of a going concern under section 38-325☐ GST-free because the sale is subdivided farm land or farm land supplied for farming under Subdivision 38-O☒ input taxed because the sale is of eligible residential premises (sections 40-65, 40-75(2) and 195-1)Purchaser must make an *RW payment*
(residential withholding payment)☒ NO☐ yes (if yes, vendor must provide
further details)

If the further details below are not fully completed at the contract date, the vendor must provide all these details in a separate notice within 14 days of the contract date.

RW payment (residential withholding payment) – further details

Frequently the supplier will be the vendor. However, sometimes further information will be required as to which entity is liable for GST, for example, if the vendor is part of a GST group or a participant in a GST joint venture.

Supplier's name:

Supplier's ABN:

Supplier's business address:

Supplier's email address:

Supplier's phone number:

Supplier's proportion of *RW payment*:

If more than one supplier, provide the above details for each supplier.

Amount purchaser must pay – price multiplied by the *RW rate* (residential withholding rate):Amount must be paid: ☐ AT COMPLETION ☐ at another time (specify):Is any of the consideration not expressed as an amount in money? ☐ NO ☐ yes

If "yes", the GST inclusive market value of the non-monetary consideration: \$

Other details (including those required by regulation or the ATO forms):

List of Documents

General	Strata or community title (clause 23 of the contract)
<input checked="" type="checkbox"/> 1 property certificate for the land	<input checked="" type="checkbox"/> 32 property certificate for strata common property
<input type="checkbox"/> 2 plan of the land	<input checked="" type="checkbox"/> 33 plan creating strata common property
<input type="checkbox"/> 3 unregistered plan of the land	<input checked="" type="checkbox"/> 34 strata by-laws
<input type="checkbox"/> 4 plan of land to be subdivided	<input type="checkbox"/> 35 strata development contract or statement
<input type="checkbox"/> 5 document that is to be lodged with a relevant plan	<input type="checkbox"/> 36 strata management statement
<input checked="" type="checkbox"/> 6 section 10.7(2) planning certificate under Environmental Planning and Assessment Act 1979	<input type="checkbox"/> 37 strata renewal proposal
<input type="checkbox"/> 7 additional information included in that certificate under section 10.7(5)	<input type="checkbox"/> 38 strata renewal plan
<input checked="" type="checkbox"/> 8 sewerage infrastructure location diagram (service location diagram)	<input type="checkbox"/> 39 leasehold strata - lease of lot and common property
<input checked="" type="checkbox"/> 9 sewer lines location diagram (sewerage service diagram)	<input type="checkbox"/> 40 property certificate for neighbourhood property
<input type="checkbox"/> 10 document that created or may have created an easement, profit à prendre, restriction on use or positive covenant disclosed in this contract	<input type="checkbox"/> 41 plan creating neighbourhood property
<input type="checkbox"/> 11 <i>planning agreement</i>	<input type="checkbox"/> 42 neighbourhood development contract
<input type="checkbox"/> 12 section 88G certificate (positive covenant)	<input type="checkbox"/> 43 neighbourhood management statement
<input type="checkbox"/> 13 survey report	<input type="checkbox"/> 44 property certificate for precinct property
<input type="checkbox"/> 14 building information certificate or building certificate given under <i>legislation</i>	<input type="checkbox"/> 45 plan creating precinct property
<input type="checkbox"/> 15 lease (with every relevant memorandum or variation)	<input type="checkbox"/> 46 precinct development contract
<input type="checkbox"/> 16 other document relevant to tenancies	<input type="checkbox"/> 47 precinct management statement
<input type="checkbox"/> 17 licence benefiting the land	<input type="checkbox"/> 48 property certificate for community property
<input type="checkbox"/> 18 old system document	<input type="checkbox"/> 49 plan creating community property
<input type="checkbox"/> 19 Crown purchase statement of account	<input type="checkbox"/> 50 community development contract
<input type="checkbox"/> 20 building management statement	<input type="checkbox"/> 51 community management statement
<input type="checkbox"/> 21 form of requisitions	<input checked="" type="checkbox"/> 52 document disclosing a change of by-laws
<input type="checkbox"/> 22 <i>clearance certificate</i>	<input type="checkbox"/> 53 document disclosing a change in a development or management contract or statement
<input type="checkbox"/> 23 land tax certificate	<input type="checkbox"/> 54 document disclosing a change in boundaries
Home Building Act 1989	<input type="checkbox"/> 55 information certificate under Strata Schemes Management Act 2015
<input type="checkbox"/> 24 insurance certificate	<input type="checkbox"/> 56 information certificate under Community Land Management Act 1989
<input type="checkbox"/> 25 brochure or warning	<input type="checkbox"/> 57 document relevant to off-the-plan sale
<input type="checkbox"/> 26 evidence of alternative indemnity cover	Other
Swimming Pools Act 1992	<input type="checkbox"/> 58
<input type="checkbox"/> 27 certificate of compliance	
<input type="checkbox"/> 28 evidence of registration	
<input type="checkbox"/> 29 relevant occupation certificate	
<input type="checkbox"/> 30 certificate of non-compliance	
<input type="checkbox"/> 31 detailed reasons of non-compliance	

HOLDER OF STRATA OR COMMUNITY TITLE RECORDS – Name, address, email address and telephone number

SECTION 66W CERTIFICATE

I, _____ of _____,
, certify as follows:

1. I am a _____ currently admitted to practise in New South Wales;
2. I am giving this certificate in accordance with section 66W of the Conveyancing Act 1919 with reference to a contract for the sale of property at **10/20 Clarke Street, Narrabeen**, from **Bradley Webber and Kathleen Amber Giles** to _____ in order that there is no cooling off period in relation to that contract;
3. I do not act for **Bradley Webber and Kathleen Amber Giles** and am not employed in the legal practice of a solicitor acting for **Bradley Webber and Kathleen Amber Giles** nor am I a member or employee of a firm of which a solicitor acting for **Bradley Webber and Kathleen Amber Giles** is a member or employee; and
4. I have explained to _____:
 - (a) The effect of the contract for the purchase of that property;
 - (b) The nature of this certificate; and
 - (c) The effect of giving this certificate to the vendor, i.e. that there is no cooling off period in relation to the contract.

Dated: _____

IMPORTANT NOTICE TO VENDORS AND PURCHASERS

Before signing this contract you should ensure that you understand your rights and obligations, some of which are not written in this contract but are implied by law.

WARNING—SMOKE ALARMS

The owners of certain types of buildings and strata lots must have smoke alarms (or in certain cases heat alarms) installed in the building or lot in accordance with regulations under the *Environmental Planning and Assessment Act 1979*. It is an offence not to comply. It is also an offence to remove or interfere with a smoke alarm or heat alarm. Penalties apply.

WARNING—LOOSE-FILL ASBESTOS INSULATION

Before purchasing land that includes any residential premises (within the meaning of Division 1A of Part 8 of the *Home Building Act 1989*) built before 1985, a purchaser is strongly advised to consider the possibility that the premises may contain loose-fill asbestos insulation (within the meaning of Division 1A of Part 8 of the *Home Building Act 1989*). In particular, a purchaser should:

- (a) search the Register required to be maintained under Division 1A of Part 8 of the *Home Building Act 1989*, and
- (b) ask the relevant local council whether it holds any records showing that the residential premises contain loose-fill asbestos insulation.

For further information about loose-fill asbestos insulation (including areas in which residential premises have been identified as containing loose-fill asbestos insulation), contact NSW Fair Trading.

COOLING OFF PERIOD (PURCHASER'S RIGHTS)

1. This is the statement required by section 66X of the *Conveyancing Act 1919* and applies to a contract for the sale of residential property.
2. The purchaser may rescind the contract at any time before 5 p.m. on the fifth business day after the day on which the contract was made, **EXCEPT** in the circumstances listed in paragraph 3.
3. There is **NO COOLING OFF PERIOD**:
 - (a) if, at or before the time the contract is made, the purchaser gives to the vendor (or the vendor's solicitor or agent) a certificate that complies with section 66W of the Act, or
 - (b) if the property is sold by public auction, or
 - (c) if the contract is made on the same day as the property was offered for sale by public auction but passed in, or
 - (d) if the contract is made in consequence of the exercise of an option to purchase the property, other than an option that is void under section 66ZG of the Act.
4. A purchaser exercising the right to cool off by rescinding the contract will forfeit to the vendor 0.25% of the purchase price of the property. The vendor is entitled to recover the amount forfeited from any amount paid by the purchaser as a deposit under the contract and the purchaser is entitled to a refund of any balance.

DISPUTES

If you get into a dispute with the other party, the Law Society and Real Estate Institute encourage you to use informal procedures such as negotiation, independent expert appraisal, the Law Society Conveyancing Dispute Resolution Scheme or mediation (for example mediation under the Law Society Mediation Program).

AUCTIONS

Regulations made under the Property, Stock and Business Agents Act 2002 prescribe a number of conditions applying to sales by auction.

WARNINGS

1. Various Acts of Parliament and other matters can affect the rights of the parties to this contract. Some important matters are actions, claims, decisions, licences, notices, orders, proposals or rights of way involving:

Australian Taxation Office	NSW Fair Trading
Council	NSW Public Works Advisory
County Council	Office of Environment and Heritage
Department of Planning and Environment	Owner of adjoining land
Department of Primary Industries	Privacy
East Australian Pipeline Limited	Roads and Maritime Services
Electricity and gas	Subsidence Advisory NSW
Land & Housing Corporation	Telecommunications
Local Land Services	Transport for NSW
NSW Department of Education	Water, sewerage or drainage authority

If you think that any of these matters affects the property, tell your solicitor.

2. A lease may be affected by the Agricultural Tenancies Act 1990, the Residential Tenancies Act 2010 or the Retail Leases Act 1994.
3. If any purchase money is owing to the Crown, it will become payable before obtaining consent, or if no consent is needed, when the transfer is registered.
4. If a consent to transfer is required under legislation, see clause 27 as to the obligations of the parties.
5. The vendor should continue the vendor's insurance until completion. If the vendor wants to give the purchaser possession before completion, the vendor should first ask the insurer to confirm this will not affect the insurance.
6. The purchaser will usually have to pay stamp duty (and sometimes surcharge purchaser duty) on this contract. If duty is not paid on time, a purchaser may incur penalties.
7. If the purchaser agrees to the release of deposit, the purchaser's right to recover the deposit may stand behind the rights of others (for example the vendor's mortgagee).
8. The purchaser should arrange insurance as appropriate.
9. Some transactions involving personal property may be affected by the Personal Property Securities Act 2009.
10. A purchaser should be satisfied that finance will be available at the time of completing the purchase.
11. Where the market value of the property is at or above a legislated amount, the purchaser may have to comply with a foreign resident capital gains withholding payment obligation (even if the vendor is not a foreign resident). If so, this will affect the amount available to the vendor on completion.
12. Purchasers of some residential properties may have to withhold part of the purchase price to be credited towards the GST liability of the vendor. If so, this will also affect the amount available to the vendor.

The vendor sells and the purchaser buys the *property* for the price under these provisions instead of Schedule 3 Conveyancing Act 1919, subject to any *legislation* that cannot be excluded.

1 Definitions (a term in *italics* is a defined term)

In this contract, these terms (in any form) mean –

<i>adjustment date</i>	the earlier of the giving of possession to the purchaser or completion;
<i>bank</i>	the Reserve Bank of Australia or an authorised deposit-taking institution which is a bank, a building society or a credit union;
<i>business day</i>	any day except a bank or public holiday throughout NSW or a Saturday or Sunday;
<i>cheque</i>	a cheque that is not postdated or stale;
<i>clearance certificate</i>	a certificate within the meaning of s14-220 of Schedule 1 to the <i>TA Act</i> , that covers one or more days falling within the period from and including the contract date to completion;
<i>deposit-bond</i>	a deposit bond or guarantee from an issuer, with an expiry date and for an amount each approved by the vendor;
<i>depositholder</i>	vendor's agent (or if no vendor's agent is named in this contract, the vendor's <i>solicitor</i> , or if no vendor's <i>solicitor</i> is named in this contract, the buyer's agent);
<i>document of title</i>	document relevant to the title or the passing of title;
<i>FRCGW percentage</i>	the percentage mentioned in s14-200(3)(a) of Schedule 1 to the <i>TA Act</i> (12.5% as at 1 July 2017);
<i>GST Act</i>	A New Tax System (Goods and Services Tax) Act 1999;
<i>GST rate</i>	the rate mentioned in s4 of A New Tax System (Goods and Services Tax Imposition - General) Act 1999 (10% as at 1 July 2000);
<i>legislation</i>	an Act or a by-law, ordinance, regulation or rule made under an Act;
<i>normally</i>	subject to any other provision of this contract;
<i>party</i>	each of the vendor and the purchaser;
<i>property</i>	the land, the improvements, all fixtures and the inclusions, but not the exclusions;
<i>planning agreement</i>	a valid voluntary agreement within the meaning of s7.4 of the Environmental Planning and Assessment Act 1979 entered into in relation to the <i>property</i> ;
<i>requisition</i>	an objection, question or requisition (but the term does not include a claim);
<i>remittance amount</i>	the lesser of the <i>FRCGW percentage</i> of the price (inclusive of GST, if any) and the amount specified in a <i>variation served by a party</i> ;
<i>rescind</i>	rescind this contract from the beginning;
<i>RW payment</i>	a payment which the purchaser must make under s14-250 of Schedule 1 to the <i>TA Act</i> (the price multiplied by the <i>RW rate</i>);
<i>RW rate</i>	the rate determined under ss14-250(6), (8) or (9) of Schedule 1 to the <i>TA Act</i> (as at 1 July 2018, usually 7% of the price if the margin scheme applies, 1/11 th if not);
<i>serve</i>	serve in writing on the other <i>party</i> ;
<i>settlement cheque</i>	an unendorsed <i>cheque</i> made payable to the person to be paid and – <ul style="list-style-type: none"> • issued by a <i>bank</i> and drawn on itself; or • if authorised in writing by the vendor or the vendor's <i>solicitor</i>, some other <i>cheque</i>;
<i>solicitor</i>	in relation to a <i>party</i> , the <i>party's</i> solicitor or licensed conveyancer named in this contract or in a notice <i>served by the party</i> ;
<i>TA Act</i>	Taxation Administration Act 1953;
<i>terminate</i>	terminate this contract for breach;
<i>variation</i>	a variation made under s14-235 of Schedule 1 to the <i>TA Act</i> ;
<i>within</i>	in relation to a period, at any time before or during the period; and
<i>work order</i>	a valid direction, notice or order that requires work to be done or money to be spent on or in relation to the <i>property</i> or any adjoining footpath or road (but the term does not include a notice under s22E of the Swimming Pools Act 1992 or clause 18B of the Swimming Pools Regulation 2008).

2 Deposit and other payments before completion

- 2.1 The purchaser must pay the deposit to the *depositholder* as stakeholder.
- 2.2 *Normally*, the purchaser must pay the deposit on the making of this contract, and this time is essential.
- 2.3 If this contract requires the purchaser to pay any of the deposit by a later time, that time is also essential.
- 2.4 The purchaser can pay any of the deposit by giving cash (up to \$2,000) or by unconditionally giving a *cheque* to the *depositholder* or to the vendor, vendor's agent or vendor's *solicitor* for sending to the *depositholder*.
- 2.5 If any of the deposit is not paid on time or a *cheque* for any of the deposit is not honoured on presentation, the vendor can *terminate*. This right to *terminate* is lost as soon as the deposit is paid in full.
- 2.6 If the vendor accepts a bond or guarantee for the deposit, clauses 2.1 to 2.5 do not apply.
- 2.7 If the vendor accepts a bond or guarantee for part of the deposit, clauses 2.1 to 2.5 apply only to the balance.

- 2.8 If any of the deposit or of the balance of the price is paid before completion to the vendor or as the vendor directs, it is a charge on the land in favour of the purchaser until *termination* by the vendor or completion, subject to any existing right.
- 2.9 If each *party* tells the *depositholder* that the deposit is to be invested, the *depositholder* is to invest the deposit (at the risk of the *party* who becomes entitled to it) with a *bank*, in an interest-bearing account in NSW, payable at call, with interest to be reinvested, and pay the interest to the *parties* equally, after deduction of all proper government taxes and financial institution charges and other charges.

3 Deposit-bond

- 3.1 This clause applies only if this contract says the vendor has agreed to accept a *deposit-bond* for the deposit (or part of it).
- 3.2 The purchaser must provide the original *deposit-bond* to the vendor's *solicitor* (or if no *solicitor* the *depositholder*) at or before the making of this contract and this time is essential.
- 3.3 If the *deposit-bond* has an expiry date and completion does not occur by the date which is 14 days before the expiry date, the purchaser must *serve* a replacement *deposit-bond* at least 7 days before the expiry date. The time for service is essential.
- 3.4 The vendor must approve a replacement *deposit-bond* if –
- 3.4.1 it is from the same issuer and for the same amount as the earlier *deposit-bond*; and
- 3.4.2 it has an expiry date at least three months after its date of issue.
- 3.5 A breach of clauses 3.2 or 3.3 entitles the vendor to *terminate*. The right to *terminate* is lost as soon as –
- 3.5.1 the purchaser *serves* a replacement *deposit-bond*; or
- 3.5.2 the deposit is paid in full under clause 2.
- 3.6 Clauses 3.3 and 3.4 can operate more than once.
- 3.7 If the purchaser *serves* a replacement *deposit-bond*, the vendor must *serve* the earlier *deposit-bond*.
- 3.8 The amount of any *deposit-bond* does not form part of the price for the purposes of clause 16.7.
- 3.9 The vendor must give the purchaser the *deposit-bond* –
- 3.9.1 on completion; or
- 3.9.2 if this contract is *rescinded*.
- 3.10 If this contract is *terminated* by the vendor –
- 3.10.1 *normally*, the vendor can immediately demand payment from the issuer of the *deposit-bond*; or
- 3.10.2 if the purchaser *serves* prior to *termination* a notice disputing the vendor's right to *terminate*, the vendor must forward the *deposit-bond* (or its proceeds if called up) to the *depositholder* as stakeholder.
- 3.11 If this contract is *terminated* by the purchaser –
- 3.11.1 *normally*, the vendor must give the purchaser the *deposit-bond*; or
- 3.11.2 if the vendor *serves* prior to *termination* a notice disputing the purchaser's right to *terminate*, the vendor must forward the *deposit-bond* (or its proceeds if called up) to the *depositholder* as stakeholder.

4 Transfer

- 4.1 *Normally*, the purchaser must *serve* at least 14 days before the date for completion –
- 4.1.1 the form of transfer; and
- 4.1.2 particulars required to register any mortgage or other dealing to be lodged with the transfer by the purchaser or the purchaser's mortgagee.
- 4.2 If any information needed for the form of transfer is not disclosed in this contract, the vendor must *serve* it.
- 4.3 If the purchaser *serves* a form of transfer and the transferee is not the purchaser, the purchaser must give the vendor a direction signed by the purchaser personally for this form of transfer.
- 4.4 The vendor can require the purchaser to include a form of covenant or easement in the transfer only if this contract contains the wording of the proposed covenant or easement, and a description of the land benefited.

5 Requisitions

- 5.1 If a form of *requisitions* is attached to this contract, the purchaser is taken to have made those *requisitions*.
- 5.2 If the purchaser is or becomes entitled to make any other *requisition*, the purchaser can make it only by *serving* it –
- 5.2.1 if it arises out of this contract or it is a general question about the *property* or title - *within* 21 days after the contract date;
- 5.2.2 if it arises out of anything *served* by the vendor - *within* 21 days after the later of the contract date and that *service*; and
- 5.2.3 in any other case - *within* a reasonable time.

6 Error or misdescription

- 6.1 The purchaser can (but only before completion) claim compensation for an error or misdescription in this contract (as to the *property*, the title or anything else and whether substantial or not).
- 6.2 This clause applies even if the purchaser did not take notice of or rely on anything in this contract containing or giving rise to the error or misdescription.
- 6.3 However, this clause does not apply to the extent the purchaser knows the true position.

7 Claims by purchaser

The purchaser can make a claim (including a claim under clause 6) before completion only by *serving* it with a statement of the amount claimed, and if the purchaser makes one or more claims before completion –

7.1 the vendor can *rescind* if in the case of claims that are not claims for delay –

7.1.1 the total amount claimed exceeds 5% of the price;

7.1.2 the vendor *serves* notice of intention to *rescind*; and

7.1.3 the purchaser does not *serve* notice waiving the claims *within* 14 days after that *service*; and

7.2 if the vendor does not *rescind*, the *parties* must complete and if this contract is completed –

7.2.1 the lesser of the total amount claimed and 10% of the price must be paid out of the price to and held by the *depositholder* until the claims are finalised or lapse;

7.2.2 the amount held is to be invested in accordance with clause 2.9;

7.2.3 the claims must be finalised by an arbitrator appointed by the *parties* or, if an appointment is not made *within* 1 month of completion, by an arbitrator appointed by the President of the Law Society at the request of a *party* (in the latter case the *parties* are bound by the terms of the Conveyancing Arbitration Rules approved by the Law Society as at the date of the appointment);

7.2.4 the purchaser is not entitled, in respect of the claims, to more than the total amount claimed and the costs of the purchaser;

7.2.5 net interest on the amount held must be paid to the *parties* in the same proportion as the amount held is paid; and

7.2.6 if the *parties* do not appoint an arbitrator and neither *party* requests the President to appoint an arbitrator *within* 3 months after completion, the claims lapse and the amount belongs to the vendor.

8 Vendor's rights and obligations

8.1 The vendor can *rescind* if –

8.1.1 the vendor is, on reasonable grounds, unable or unwilling to comply with a *requisition*;

8.1.2 the vendor *serves* a notice of intention to *rescind* that specifies the *requisition* and those grounds; and

8.1.3 the purchaser does not *serve* a notice waiving the *requisition within* 14 days after that *service*.

8.2 If the vendor does not comply with this contract (or a notice under or relating to it) in an essential respect, the purchaser can *terminate* by *serving* a notice. After the *termination* –

8.2.1 the purchaser can recover the deposit and any other money paid by the purchaser under this contract;

8.2.2 the purchaser can sue the vendor to recover damages for breach of contract; and

8.2.3 if the purchaser has been in possession a *party* can claim for a reasonable adjustment.

9 Purchaser's default

If the purchaser does not comply with this contract (or a notice under or relating to it) in an essential respect, the vendor can *terminate* by *serving* a notice. After the *termination* the vendor can –

9.1 keep or recover the deposit (to a maximum of 10% of the price);

9.2 hold any other money paid by the purchaser under this contract as security for anything recoverable under this clause –

9.2.1 for 12 months after the *termination*; or

9.2.2 if the vendor commences proceedings under this clause *within* 12 months, until those proceedings are concluded; and

9.3 sue the purchaser either –

9.3.1 where the vendor has resold the *property* under a contract made *within* 12 months after the *termination*, to recover –

- the deficiency on resale (with credit for any of the deposit kept or recovered and after allowance for any capital gains tax or goods and services tax payable on anything recovered under this clause); and
- the reasonable costs and expenses arising out of the purchaser's non-compliance with this contract or the notice and of resale and any attempted resale; or

9.3.2 to recover damages for breach of contract.

10 Restrictions on rights of purchaser

10.1 The purchaser cannot make a claim or *requisition* or *rescind* or *terminate* in respect of –

10.1.1 the ownership or location of any fence as defined in the Dividing Fences Act 1991;

10.1.2 a service for the *property* being a joint service or passing through another property, or any service for another property passing through the *property* ('service' includes air, communication, drainage, electricity, garbage, gas, oil, radio, sewerage, telephone, television or water service);

10.1.3 a wall being or not being a party wall in any sense of that term or the *property* being affected by an easement for support or not having the benefit of an easement for support;

10.1.4 any change in the *property* due to fair wear and tear before completion;

- 10.1.5 a promise, representation or statement about this contract, the *property* or the title, not set out or referred to in this contract;
- 10.1.6 a condition, exception, reservation or restriction in a Crown grant;
- 10.1.7 the existence of any authority or licence to explore or prospect for gas, minerals or petroleum;
- 10.1.8 any easement or restriction on use the substance of either of which is disclosed in this contract or any non-compliance with the easement or restriction on use; or
- 10.1.9 anything the substance of which is disclosed in this contract (except a caveat, charge, mortgage, priority notice or writ).
- 10.2 The purchaser cannot *rescind* or *terminate* only because of a defect in title to or quality of the inclusions.
- 10.3 *Normally*, the purchaser cannot make a claim or *requisition* or *rescind* or *terminate* or require the vendor to change the nature of the title disclosed in this contract (for example, to remove a caution evidencing qualified title, or to lodge a plan of survey as regards limited title).
- 11 Compliance with work orders**
- 11.1 *Normally*, the vendor must by completion comply with a *work order* made on or before the contract date and if this contract is completed the purchaser must comply with any other *work order*.
- 11.2 If the purchaser complies with a *work order*, and this contract is *rescinded* or *terminated*, the vendor must pay the expense of compliance to the purchaser.
- 12 Certificates and inspections**
- The vendor must do everything reasonable to enable the purchaser, subject to the rights of any tenant –
- 12.1 to have the *property* inspected to obtain any certificate or report reasonably required;
- 12.2 to apply (if necessary in the name of the vendor) for –
- 12.2.1 any certificate that can be given in respect of the *property* under *legislation*; or
- 12.2.2 a copy of any approval, certificate, consent, direction, notice or order in respect of the *property* given under *legislation*, even if given after the contract date; and
- 12.3 to make 1 inspection of the *property* in the 3 days before a time appointed for completion.
- 13 Goods and services tax (GST)**
- 13.1 Terms used in this clause which are not defined elsewhere in this contract and have a defined meaning in the *GST Act* have the same meaning in this clause.
- 13.2 *Normally*, if a *party* must pay the price or any other amount to the other *party* under this contract, GST is not to be added to the price or amount.
- 13.3 If under this contract a *party* must make an adjustment or payment for an expense of another party or pay an expense payable by or to a third party (for example, under clauses 14 or 20.7) –
- 13.3.1 the *party* must adjust or pay on completion any GST added to or included in the expense; but
- 13.3.2 the amount of the expense must be reduced to the extent the party receiving the adjustment or payment (or the representative member of a GST group of which that party is a member) is entitled to an input tax credit for the expense; and
- 13.3.3 if the adjustment or payment under this contract is consideration for a taxable supply, an amount for GST must be added at the *GST rate*.
- 13.4 If this contract says this sale is the supply of a going concern –
- 13.4.1 the *parties* agree the supply of the *property* is a supply of a going concern;
- 13.4.2 the vendor must, between the contract date and completion, carry on the enterprise conducted on the land in a proper and business-like way;
- 13.4.3 if the purchaser is not registered by the date for completion, the *parties* must complete and the purchaser must pay on completion, in addition to the price, an amount being the price multiplied by the *GST rate* ("the retention sum"). The retention sum is to be held by the *depositholder* and dealt with as follows –
- if *within* 3 months of completion the purchaser serves a letter from the Australian Taxation Office stating the purchaser is registered with a date of effect of registration on or before completion, the *depositholder* is to pay the retention sum to the purchaser; but
 - if the purchaser does not serve that letter *within* 3 months of completion, the *depositholder* is to pay the retention sum to the vendor; and
- 13.4.4 if the vendor, despite clause 13.4.1, serves a letter from the Australian Taxation Office stating the vendor has to pay GST on the supply, the purchaser must pay to the vendor on demand the amount of GST assessed.
- 13.5 *Normally*, the vendor promises the margin scheme will not apply to the supply of the *property*.
- 13.6 If this contract says the margin scheme is to apply in making the taxable supply, the *parties* agree that the margin scheme is to apply to the sale of the *property*.
- 13.7 If this contract says the sale is not a taxable supply –
- 13.7.1 the purchaser promises that the *property* will not be used and represents that the purchaser does not intend the *property* (or any part of the *property*) to be used in a way that could make the sale a taxable supply to any extent; and

- 13.7.2 the purchaser must pay the vendor on completion in addition to the price an amount calculated by multiplying the price by the *GST rate* if this sale is a taxable supply to any extent because of –
- a breach of clause 13.7.1; or
 - something else known to the purchaser but not the vendor.
- 13.8 If this contract says this sale is a taxable supply in full and does not say the margin scheme applies to the *property*, the vendor must pay the purchaser on completion an amount of one-eleventh of the price if –
- 13.8.1 this sale is not a taxable supply in full; or
- 13.8.2 the margin scheme applies to the *property* (or any part of the *property*).
- 13.9 If this contract says this sale is a taxable supply to an extent –
- 13.9.1 clause 13.7.1 does not apply to any part of the *property* which is identified as being a taxable supply; and
- 13.9.2 the payments mentioned in clauses 13.7 and 13.8 are to be recalculated by multiplying the relevant payment by the proportion of the price which represents the value of that part of the *property* to which the clause applies (the proportion to be expressed as a number between 0 and 1). Any evidence of value must be obtained at the expense of the vendor.
- 13.10 *Normally*, on completion the vendor must give the recipient of the supply a tax invoice for any taxable supply by the vendor by or under this contract.
- 13.11 The vendor does not have to give the purchaser a tax invoice if the margin scheme applies to a taxable supply.
- 13.12 If the vendor is liable for GST on rents or profits due to issuing an invoice or receiving consideration before completion, any adjustment of those amounts must exclude an amount equal to the vendor's GST liability.
- 13.13 If the purchaser must make an *RW payment* the purchaser must –
- 13.13.1 at least 5 days before the date for completion, *serve* evidence of submission of an *RW payment* notification form to the Australian Taxation Office by the purchaser or, if a direction under clause 4.3 has been *served*, by the transferee named in the transfer *served* with that direction;
- 13.13.2 produce on completion a *settlement cheque* for the *RW payment* payable to the Deputy Commissioner of Taxation;
- 13.13.3 forward the *settlement cheque* to the payee immediately after completion; and
- 13.13.4 *serve* evidence of receipt of payment of the *RW payment*.

14 Adjustments

- 14.1 *Normally*, the vendor is entitled to the rents and profits and will be liable for all rates, water, sewerage and drainage service and usage charges, land tax, levies and all other periodic outgoings up to and including the *adjustment date* after which the purchaser will be entitled and liable.
- 14.2 The *parties* must make any necessary adjustment on completion.
- 14.3 If an amount that is adjustable under this contract has been reduced under *legislation*, the *parties* must on completion adjust the reduced amount.
- 14.4 The *parties* must not adjust surcharge land tax (as defined in the Land Tax Act 1956) but must adjust any other land tax for the year current at the *adjustment date* –
- 14.4.1 only if land tax has been paid or is payable for the year (whether by the vendor or by a predecessor in title) and this contract says that land tax is adjustable;
- 14.4.2 by adjusting the amount that would have been payable if at the start of the year –
- the person who owned the land owned no other land;
 - the land was not subject to a special trust or owned by a non-concessional company; and
 - if the land (or part of it) had no separate taxable value, by calculating its separate taxable value on a proportional area basis.
- 14.5 If any other amount that is adjustable under this contract relates partly to the land and partly to other land, the *parties* must adjust it on a proportional area basis.
- 14.6 *Normally*, the vendor can direct the purchaser to produce a *settlement cheque* on completion to pay an amount adjustable under this contract and if so –
- 14.6.1 the amount is to be treated as if it were paid; and
- 14.6.2 the *cheque* must be forwarded to the payee immediately after completion (by the purchaser if the *cheque* relates only to the *property* or by the vendor in any other case).
- 14.7 If on completion the last bill for a water, sewerage or drainage usage charge is for a period ending before the *adjustment date*, the vendor is liable for an amount calculated by dividing the bill by the number of days in the period then multiplying by the number of unbilled days up to and including the *adjustment date*.
- 14.8 The vendor is liable for any amount recoverable for work started on or before the contract date on the *property* or any adjoining footpath or road.

15 Date for completion

The *parties* must complete by the date for completion and, if they do not, a *party* can *serve* a notice to complete if that *party* is otherwise entitled to do so.

16 Completion**• Vendor**

- 16.1 On completion the vendor must give the purchaser any *document of title* that relates only to the *property*.
- 16.2 If on completion the vendor has possession or control of a *document of title* that relates also to other property, the vendor must produce it as and where necessary.
- 16.3 *Normally*, on completion the vendor must cause the legal title to the *property* (being an estate in fee simple) to pass to the purchaser free of any mortgage or other interest, subject to any necessary registration.
- 16.4 The legal title to the *property* does not pass before completion.
- 16.5 If the vendor gives the purchaser a document (other than the transfer) that needs to be lodged for registration, the vendor must pay the lodgement fee to the purchaser, plus another 20% of that fee.
- 16.6 If a *party* serves a land tax certificate showing a charge on any of the land, on completion the vendor must give the purchaser a land tax certificate showing the charge is no longer effective against the land.

• Purchaser

- 16.7 On completion the purchaser must pay to the vendor, by cash (up to \$2,000) or *settlement cheque* –
- 16.7.1 the price less any:
- deposit paid;
 - *remittance amount* payable;
 - *RW payment*; and
 - amount payable by the vendor to the purchaser under this contract; and
- 16.7.2 any other amount payable by the purchaser under this contract.
- 16.8 If the vendor requires more than 5 *settlement cheques*, the vendor must pay \$10 for each extra *cheque*.
- 16.9 If any of the deposit is not covered by a bond or guarantee, on completion the purchaser must give the vendor an order signed by the purchaser authorising the *depositholder* to account to the vendor for the deposit.
- 16.10 On completion the deposit belongs to the vendor.

• Place for completion

- 16.11 *Normally*, the *parties* must complete at the completion address, which is –
- 16.11.1 if a special completion address is stated in this contract - that address; or
- 16.11.2 if none is stated, but a first mortgagee is disclosed in this contract and the mortgagee would usually discharge the mortgage at a particular place - that place; or
- 16.11.3 in any other case - the vendor's *solicitor's* address stated in this contract.
- 16.12 The vendor by reasonable notice can require completion at another place, if it is in NSW, but the vendor must pay the purchaser's additional expenses, including any agency or mortgagee fee.
- 16.13 If the purchaser requests completion at a place that is not the completion address, and the vendor agrees, the purchaser must pay the vendor's additional expenses, including any agency or mortgagee fee.

17 Possession

- 17.1 *Normally*, the vendor must give the purchaser vacant possession of the *property* on completion.
- 17.2 The vendor does not have to give vacant possession if –
- 17.2.1 this contract says that the sale is subject to existing tenancies; and
- 17.2.2 the contract discloses the provisions of the tenancy (for example, by attaching a copy of the lease and any relevant memorandum or variation).
- 17.3 *Normally*, the purchaser can claim compensation (before or after completion) or *rescind* if any of the land is affected by a protected tenancy (a tenancy affected by Part 2, 3, 4 or 5 Landlord and Tenant (Amendment) Act 1948).

18 Possession before completion

- 18.1 This clause applies only if the vendor gives the purchaser possession of the *property* before completion.
- 18.2 The purchaser must not before completion –
- 18.2.1 let or part with possession of any of the *property*;
- 18.2.2 make any change or structural alteration or addition to the *property*; or
- 18.2.3 contravene any agreement between the *parties* or any direction, document, *legislation*, notice or order affecting the *property*.
- 18.3 The purchaser must until completion –
- 18.3.1 keep the *property* in good condition and repair having regard to its condition at the giving of possession; and
- 18.3.2 allow the vendor or the vendor's authorised representative to enter and inspect it at all reasonable times.
- 18.4 The risk as to damage to the *property* passes to the purchaser immediately after the purchaser enters into possession.
- 18.5 If the purchaser does not comply with this clause, then without affecting any other right of the vendor –
- 18.5.1 the vendor can before completion, without notice, remedy the non-compliance; and

18.5.2 if the vendor pays the expense of doing this, the purchaser must pay it to the vendor with interest at the rate prescribed under s101 Civil Procedure Act 2005.

18.6 If this contract is *rescinded* or *terminated* the purchaser must immediately vacate the *property*.

18.7 If the *parties* or their *solicitors* on their behalf do not agree in writing to a fee or rent, none is payable.

19 Rescission of contract

19.1 If this contract expressly gives a *party* a right to *rescind*, the *party* can exercise the right –

19.1.1 only by *serving* a notice before completion; and

19.1.2 in spite of any making of a claim or *requisition*, any attempt to satisfy a claim or *requisition*, any arbitration, litigation, mediation or negotiation or any giving or taking of possession.

19.2 *Normally*, if a *party* exercises a right to *rescind* expressly given by this contract or any *legislation* –

19.2.1 the deposit and any other money paid by the purchaser under this contract must be refunded;

19.2.2 a *party* can claim for a reasonable adjustment if the purchaser has been in possession;

19.2.3 a *party* can claim for damages, costs or expenses arising out of a breach of this contract; and

19.2.4 a *party* will not otherwise be liable to pay the other *party* any damages, costs or expenses.

20 Miscellaneous

20.1 The *parties* acknowledge that anything stated in this contract to be attached was attached to this contract by the vendor before the purchaser signed it and is part of this contract.

20.2 Anything attached to this contract is part of this contract.

20.3 An area, bearing or dimension in this contract is only approximate.

20.4 If a *party* consists of 2 or more persons, this contract benefits and binds them separately and together.

20.5 A *party's solicitor* can receive any amount payable to the *party* under this contract or direct in writing that it is to be paid to another person.

20.6 A document under or relating to this contract is –

20.6.1 signed by a *party* if it is signed by the *party* or the *party's solicitor* (apart from a direction under clause 4.3);

20.6.2 *served* if it is *served* by the *party* or the *party's solicitor*;

20.6.3 *served* if it is *served* on the *party's solicitor*, even if the *party* has died or any of them has died;

20.6.4 *served* if it is *served* in any manner provided in s170 of the Conveyancing Act 1919;

20.6.5 *served* if it is sent by email or fax to the *party's solicitor*, unless in either case it is not received;

20.6.6 *served* on a person if it (or a copy of it) comes into the possession of the person; and

20.6.7 *served* at the earliest time it is *served*, if it is *served* more than once.

20.7 An obligation to pay an expense of another *party* of doing something is an obligation to pay –

20.7.1 if the *party* does the thing personally - the reasonable cost of getting someone else to do it; or

20.7.2 if the *party* pays someone else to do the thing - the amount paid, to the extent it is reasonable.

20.8 Rights under clauses 11, 13, 14, 17, 24, 30 and 31 continue after completion, whether or not other rights continue.

20.9 The vendor does not promise, represent or state that the purchaser has any cooling off rights.

20.10 The vendor does not promise, represent or state that any attached survey report is accurate or current.

20.11 A reference to any *legislation* (including any percentage or rate specified in *legislation*) is also a reference to any corresponding later *legislation*.

20.12 Each *party* must do whatever is necessary after completion to carry out the *party's* obligations under this contract.

20.13 Neither taking possession nor *serving* a transfer of itself implies acceptance of the *property* or the title.

20.14 The details and information provided in this contract (for example, on pages 1 - 3) are, to the extent of each *party's* knowledge, true, and are part of this contract.

20.15 Where this contract provides for choices, a choice in BLOCK CAPITALS applies unless a different choice is marked.

21 Time limits in these provisions

21.1 If the time for something to be done or to happen is not stated in these provisions, it is a reasonable time.

21.2 If there are conflicting times for something to be done or to happen, the latest of those times applies.

21.3 The time for one thing to be done or to happen does not extend the time for another thing to be done or to happen.

21.4 If the time for something to be done or to happen is the 29th, 30th or 31st day of a month, and the day does not exist, the time is instead the last day of the month.

21.5 If the time for something to be done or to happen is a day that is not a *business day*, the time is extended to the next *business day*, except in the case of clauses 2 and 3.2.

21.6 *Normally*, the time by which something must be done is fixed but not essential.

22 Foreign Acquisitions and Takeovers Act 1975

22.1 The purchaser promises that the Commonwealth Treasurer cannot prohibit and has not prohibited the transfer under the Foreign Acquisitions and Takeovers Act 1975.

22.2 This promise is essential and a breach of it entitles the vendor to *terminate*.

23 Strata or community title

• Definitions and modifications

- 23.1 This clause applies only if the land (or part of it) is a lot in a strata, neighbourhood, precinct or community scheme (or on completion is to be a lot in a scheme of that kind).
- 23.2 In this contract –
- 23.2.1 'change', in relation to a scheme, means –
- a registered or registrable change from by-laws set out in this contract;
 - a change from a development or management contract or statement set out in this contract; or
 - a change in the boundaries of common property;
- 23.2.2 'common property' includes association property for the scheme or any higher scheme;
- 23.2.3 'contribution' includes an amount payable under a by-law;
- 23.2.4 'information certificate' includes a certificate under s184 Strata Schemes Management Act 2015 and s26 Community Land Management Act 1989;
- 23.2.5 'information notice' includes a strata information notice under s22 Strata Schemes Management Act 2015 and a notice under s47 Community Land Management Act 1989;
- 23.2.6 'normal expenses', in relation to an owners corporation for a scheme, means normal operating expenses usually payable from the administrative fund of an owners corporation for a scheme of the same kind;
- 23.2.7 'owners corporation' means the owners corporation or the association for the scheme or any higher scheme;
- 23.2.8 'the *property*' includes any interest in common property for the scheme associated with the lot; and
- 23.2.9 'special expenses', in relation to an owners corporation, means its actual, contingent or expected expenses, except to the extent they are –
- normal expenses;
 - due to fair wear and tear;
 - disclosed in this contract; or
 - covered by moneys held in the capital works fund.
- 23.3 Clauses 11, 14.8 and 18.4 do not apply to an obligation of the owners corporation, or to property insurable by it.
- 23.4 Clauses 14.4.2 and 14.5 apply but on a unit entitlement basis instead of an area basis.
- ### • Adjustments and liability for expenses
- 23.5 The *parties* must adjust under clause 14.1 –
- 23.5.1 a regular periodic contribution;
- 23.5.2 a contribution which is not a regular periodic contribution but is disclosed in this contract; and
- 23.5.3 on a unit entitlement basis, any amount paid by the vendor for a normal expense of the owners corporation to the extent the owners corporation has not paid the amount to the vendor.
- 23.6 If a contribution is not a regular periodic contribution and is not disclosed in this contract –
- 23.6.1 the vendor is liable for it if it was determined on or before the contract date, even if it is payable by instalments; and
- 23.6.2 the purchaser is liable for all contributions determined after the contract date.
- 23.7 The vendor must pay or allow to the purchaser on completion the amount of any unpaid contributions for which the vendor is liable under clause 23.6.1.
- 23.8 *Normally*, the purchaser cannot make a claim or *requisition* or *rescind* or *terminate* in respect of –
- 23.8.1 an existing or future actual, contingent or expected expense of the owners corporation;
- 23.8.2 a proportional unit entitlement of the lot or a relevant lot or former lot, apart from a claim under clause 6; or
- 23.8.3 a past or future change in the scheme or a higher scheme.
- 23.9 However, the purchaser can *rescind* if –
- 23.9.1 the special expenses of the owners corporation at the later of the contract date and the creation of the owners corporation when calculated on a unit entitlement basis (and, if more than one lot or a higher scheme is involved, added together), less any contribution paid by the vendor, are more than 1% of the price;
- 23.9.2 in the case of the lot or a relevant lot or former lot in a higher scheme –
- a proportional unit entitlement for the lot is not disclosed in this contract; or
 - a proportional unit entitlement for the lot is disclosed in this contract but the lot has a different proportional unit entitlement at the contract date or at any time before completion;
- 23.9.3 a change before the contract date or before completion in the scheme or a higher scheme substantially disadvantages the purchaser and is not disclosed in this contract; or

- 23.9.4 a resolution is passed by the owners corporation before the contract date or before completion to give a strata renewal plan to the owners in the scheme for their consideration and there is not attached to this contract a strata renewal proposal or the strata renewal plan.

• **Notices, certificates and inspections**

- 23.10 The purchaser must give the vendor 2 copies of an information notice addressed to the owners corporation and signed by the purchaser.
- 23.11 The vendor must complete and sign 1 copy of the notice and give it to the purchaser on completion.
- 23.12 Each *party* can sign and give the notice as agent for the other.
- 23.13 The vendor must *serve* an information certificate issued after the contract date in relation to the lot, the scheme or any higher scheme at least 7 days before the date for completion.
- 23.14 The purchaser does not have to complete earlier than 7 days after *service* of the certificate and clause 21.3 does not apply to this provision. On completion the purchaser must pay the vendor the prescribed fee for the certificate.
- 23.15 The vendor authorises the purchaser to apply for the purchaser's own certificate.
- 23.16 The vendor authorises the purchaser to apply for and make an inspection of any record or other document in the custody or control of the owners corporation or relating to the scheme or any higher scheme.

• **Meetings of the owners corporation**

- 23.17 If a general meeting of the owners corporation is convened before completion –
- 23.17.1 if the vendor receives notice of it, the vendor must immediately notify the purchaser of it; and
- 23.17.2 after the expiry of any cooling off period, the purchaser can require the vendor to appoint the purchaser (or the purchaser's nominee) to exercise any voting rights of the vendor in respect of the lot at the meeting.

24 Tenancies

- 24.1 If a tenant has not made a payment for a period preceding or current at the *adjustment date* –
- 24.1.1 for the purposes of clause 14.2, the amount is to be treated as if it were paid; and
- 24.1.2 the purchaser assigns the debt to the vendor on completion and will if required give a further assignment at the vendor's expense.
- 24.2 If a tenant has paid in advance of the *adjustment date* any periodic payment in addition to rent, it must be adjusted as if it were rent for the period to which it relates.
- 24.3 If the *property* is to be subject to a tenancy on completion or is subject to a tenancy on completion –
- 24.3.1 the vendor authorises the purchaser to have any accounting records relating to the tenancy inspected and audited and to have any other document relating to the tenancy inspected;
- 24.3.2 the vendor must *serve* any information about the tenancy reasonably requested by the purchaser before or after completion; and
- 24.3.3 *normally*, the purchaser can claim compensation (before or after completion) if –
- a disclosure statement required by the Retail Leases Act 1994 was not given when required;
 - such a statement contained information that was materially false or misleading;
 - a provision of the lease is not enforceable because of a non-disclosure in such a statement; or
 - the lease was entered into in contravention of the Retail Leases Act 1994.
- 24.4 If the *property* is subject to a tenancy on completion –
- 24.4.1 the vendor must allow or transfer –
- any remaining bond money or any other security against the tenant's default (to the extent the security is transferable);
 - any money in a fund established under the lease for a purpose and compensation for any money in the fund or interest earned by the fund that has been applied for any other purpose; and
 - any money paid by the tenant for a purpose that has not been applied for that purpose and compensation for any of the money that has been applied for any other purpose;
- 24.4.2 if the security is not transferable, each *party* must do everything reasonable to cause a replacement security to issue for the benefit of the purchaser and the vendor must hold the original security on trust for the benefit of the purchaser until the replacement security issues;
- 24.4.3 the vendor must give to the purchaser –
- a proper notice of the transfer (an attornment notice) addressed to the tenant;
 - any certificate given under the Retail Leases Act 1994 in relation to the tenancy;
 - a copy of any disclosure statement given under the Retail Leases Act 1994;
 - a copy of any document served on the tenant under the lease and written details of its service, if the document concerns the rights of the landlord or the tenant after completion; and
 - any document served by the tenant under the lease and written details of its service, if the document concerns the rights of the landlord or the tenant after completion;
- 24.4.4 the vendor must comply with any obligation to the tenant under the lease, to the extent it is to be complied with by completion; and

- 24.4.5 the purchaser must comply with any obligation to the tenant under the lease, to the extent that the obligation is disclosed in this contract and is to be complied with after completion.

25 Qualified title, limited title and old system title

- 25.1 This clause applies only if the land (or part of it) –
- 25.1.1 is under qualified, limited or old system title; or
 - 25.1.2 on completion is to be under one of those titles.
- 25.2 The vendor must *serve* a proper abstract of title *within 7* days after the contract date.
- 25.3 If an abstract of title or part of an abstract of title is attached to this contract or has been lent by the vendor to the purchaser before the contract date, the abstract or part is *served* on the contract date.
- 25.4 An abstract of title can be or include a list of documents, events and facts arranged (apart from a will or codicil) in date order, if the list in respect of each document –
- 25.4.1 shows its date, general nature, names of parties and any registration number; and
 - 25.4.2 has attached a legible photocopy of it or of an official or registration copy of it.
- 25.5 An abstract of title –
- 25.5.1 must start with a good root of title (if the good root of title must be at least 30 years old, this means 30 years old at the contract date);
 - 25.5.2 in the case of a leasehold interest, must include an abstract of the lease and any higher lease;
 - 25.5.3 *normally*, need not include a Crown grant; and
 - 25.5.4 need not include anything evidenced by the Register kept under the Real Property Act 1900.
- 25.6 In the case of land under old system title –
- 25.6.1 in this contract 'transfer' means conveyance;
 - 25.6.2 the purchaser does not have to *serve* the form of transfer until after the vendor has *served* a proper abstract of title; and
 - 25.6.3 each vendor must give proper covenants for title as regards that vendor's interest.
- 25.7 In the case of land under limited title but not under qualified title –
- 25.7.1 *normally*, the abstract of title need not include any document which does not show the location, area or dimensions of the land (for example, by including a metes and bounds description or a plan of the land);
 - 25.7.2 clause 25.7.1 does not apply to a document which is the good root of title; and
 - 25.7.3 the vendor does not have to provide an abstract if this contract contains a delimitation plan (whether in registrable form or not).
- 25.8 The vendor must give a proper covenant to produce where relevant.
- 25.9 The vendor does not have to produce or covenant to produce a document that is not in the possession of the vendor or a mortgagee.
- 25.10 If the vendor is unable to produce an original document in the chain of title, the purchaser will accept a photocopy from the Registrar-General of the registration copy of that document.

26 Crown purchase money

- 26.1 This clause applies only if purchase money is payable to the Crown, whether or not due for payment.
- 26.2 The vendor is liable for the money, except to the extent this contract says the purchaser is liable for it.
- 26.3 To the extent the vendor is liable for it, the vendor is liable for any interest until completion.
- 26.4 To the extent the purchaser is liable for it, the *parties* must adjust any interest under clause 14.1.

27 Consent to transfer

- 27.1 This clause applies only if the land (or part of it) cannot be transferred without consent under *legislation* or a *planning agreement*.
- 27.2 The purchaser must properly complete and then *serve* the purchaser's part of an application for consent to transfer of the land (or part of it) *within 7* days after the contract date.
- 27.3 The vendor must apply for consent *within 7* days after *service* of the purchaser's part.
- 27.4 If consent is refused, either *party* can *rescind*.
- 27.5 If consent is given subject to one or more conditions that will substantially disadvantage a *party*, then that *party* can *rescind within 7* days after receipt by or *service* upon the *party* of written notice of the conditions.
- 27.6 If consent is not given or refused –
- 27.6.1 *within 42* days after the purchaser *serves* the purchaser's part of the application, the purchaser can *rescind*; or
 - 27.6.2 *within 30* days after the application is made, either *party* can *rescind*.
- 27.7 Each period in clause 27.6 becomes 90 days if the land (or part of it) is –
- 27.7.1 under a *planning agreement*; or
 - 27.7.2 in the Western Division.
- 27.8 If the land (or part of it) is described as a lot in an unregistered plan, each time in clause 27.6 becomes the later of the time and 35 days after creation of a separate folio for the lot.
- 27.9 The date for completion becomes the later of the date for completion and 14 days after *service* of the notice granting consent to transfer.

28 Unregistered plan

- 28.1 This clause applies only if some of the land is described as a lot in an unregistered plan.
- 28.2 The vendor must do everything reasonable to have the plan registered *within* 6 months after the contract date, with or without any minor alteration to the plan or any document to be lodged with the plan validly required or made under *legislation*.
- 28.3 If the plan is not registered *within* that time and in that manner –
- 28.3.1 the purchaser can *rescind*; and
- 28.3.2 the vendor can *rescind*, but only if the vendor has complied with clause 28.2 and with any *legislation* governing the rescission.
- 28.4 Either *party* can *serve* notice of the registration of the plan and every relevant lot and plan number.
- 28.5 The date for completion becomes the later of the date for completion and 21 days after *service* of the notice.
- 28.6 Clauses 28.2 and 28.3 apply to another plan that is to be registered before the plan is registered.

29 Conditional contract

- 29.1 This clause applies only if a provision says this contract or completion is conditional on an event.
- 29.2 If the time for the event to happen is not stated, the time is 42 days after the contract date.
- 29.3 If this contract says the provision is for the benefit of a *party*, then it benefits only that *party*.
- 29.4 if anything is necessary to make the event happen, each *party* must do whatever is reasonably necessary to cause the event to happen.
- 29.5 A *party* can *rescind* under this clause only if the *party* has substantially complied with clause 29.4.
- 29.6 If the event involves an approval and the approval is given subject to a condition that will substantially disadvantage a *party* who has the benefit of the provision, the *party* can *rescind within* 7 days after either *party* *serves* notice of the condition.
- 29.7 If the *parties* can lawfully complete without the event happening –
- 29.7.1 if the event does not happen *within* the time for it to happen, a *party* who has the benefit of the provision can *rescind within* 7 days after the end of that time;
- 29.7.2 if the event involves an approval and an application for the approval is refused, a *party* who has the benefit of the provision can *rescind within* 7 days after either *party* *serves* notice of the refusal; and
- 29.7.3 the date for completion becomes the later of the date for completion and 21 days after the earliest of –
- either *party* *serving* notice of the event happening;
 - every *party* who has the benefit of the provision *serving* notice waiving the provision; or
 - the end of the time for the event to happen.
- 29.8 If the *parties* cannot lawfully complete without the event happening –
- 29.8.1 if the event does not happen *within* the time for it to happen, either *party* can *rescind*;
- 29.8.2 if the event involves an approval and an application for the approval is refused, either *party* can *rescind*;
- 29.8.3 the date for completion becomes the later of the date for completion and 21 days after either *party* *serves* notice of the event happening.
- 29.9 A *party* cannot *rescind* under clauses 29.7 or 29.8 after the event happens.

30 Electronic transaction

- 30.1 This *Conveyancing Transaction* is to be conducted as an *electronic transaction* if –
- 30.1.1 this contract says that it is a proposed *electronic transaction*;
- 30.1.2 the parties otherwise agree that it is to be conducted as an *electronic transaction*; or
- 30.1.3 the *conveyancing rules* require it to be conducted as an *electronic transaction*.
- 30.2 However, this *Conveyancing Transaction* is not to be conducted as an *electronic transaction* –
- 30.2.1 if the land is not *electronically tradeable* or the transfer is not eligible to be lodged electronically; or
- 30.2.2 if, at any time after it has been agreed that it will be conducted as an *electronic transaction*, a *party* *serves* a notice that it will not be conducted as an *electronic transaction*.
- 30.3 If, because of clause 30.2.2, this *Conveyancing Transaction* is not to be conducted as an *electronic transaction* –
- 30.3.1 each *party* must –
- bear equally any disbursements or fees; and
 - otherwise bear that *party's* own costs;
- incurred because this *Conveyancing Transaction* was to be conducted as an *electronic transaction*; and
- 30.3.2 if a *party* has paid all of a disbursement or fee which, by reason of this clause, is to be borne equally by the *parties*, that amount must be adjusted under clause 14.2.

- 30.4 If this *Conveyancing Transaction* is to be conducted as an *electronic transaction* –
- 30.4.1 to the extent, but only to the extent, that any other provision of this contract is inconsistent with this clause, the provisions of this clause prevail;
- 30.4.2 *normally*, words and phrases used in this clause 30 (italicised and in Title Case, such as *Electronic Workspace* and *Lodgement Case*) have the same meaning which they have in the *participation rules*;
- 30.4.3 the *parties* must conduct the *electronic transaction* in accordance with the *participation rules* and the *ECNL*;
- 30.4.4 a *party* must pay the fees and charges payable by that *party* to the *ELNO* and the *Land Registry* as a result of this transaction being an *electronic transaction*;
- 30.4.5 any communication from one *party* to another *party* in the *Electronic Workspace* made –
- after the *effective date*; and
 - before the receipt of a notice given under clause 30.2.2;
- is taken to have been received by that *party* at the time determined by s13A of the *Electronic Transactions Act 2000*; and
- 30.4.6 a document which is an *electronic document* is *served* as soon as it is first *Digitally Signed* in the *Electronic Workspace* on behalf of the *party* required to serve it.
- 30.5 *Normally*, the vendor must *within 7 days* of the *effective date* –
- 30.5.1 create an *Electronic Workspace*;
- 30.5.2 *populate* the *Electronic Workspace* with *title data*, the date for completion and, if applicable, *mortgagee details*; and
- 30.5.3 invite the purchaser and any *discharging mortgagee* to the *Electronic Workspace*.
- 30.6 If the vendor has not created an *Electronic Workspace* in accordance with clause 30.5, the purchaser may create an *Electronic Workspace*. If the purchaser creates the *Electronic Workspace* the purchaser must –
- 30.6.1 *populate* the *Electronic Workspace* with *title data*;
- 30.6.2 create and *populate* an *electronic transfer*;
- 30.6.3 *populate* the *Electronic Workspace* with the date for completion and a nominated *completion time*; and
- 30.6.4 invite the vendor and any *incoming mortgagee* to join the *Electronic Workspace*.
- 30.7 *Normally*, *within 7 days* of receiving an invitation from the vendor to join the *Electronic Workspace*, the purchaser must –
- 30.7.1 join the *Electronic Workspace*;
- 30.7.2 create and *populate* an *electronic transfer*;
- 30.7.3 invite any *incoming mortgagee* to join the *Electronic Workspace*; and
- 30.7.4 *populate* the *Electronic Workspace* with a nominated *completion time*.
- 30.8 If the purchaser has created the *Electronic Workspace* the vendor must *within 7 days* of being invited to the *Electronic Workspace* –
- 30.8.1 join the *Electronic Workspace*;
- 30.8.2 *populate* the *Electronic Workspace* with *mortgagee details*, if applicable; and
- 30.8.3 invite any *discharging mortgagee* to join the *Electronic Workspace*.
- 30.9 To complete the financial settlement schedule in the *Electronic Workspace* –
- 30.9.1 the purchaser must provide the vendor with *adjustment figures* at least 2 *business days* before the date for completion; and
- 30.9.2 the vendor must *populate* the *Electronic Workspace* with payment details at least 1 *business day* before the date for completion.
- 30.10 At least 1 *business day* before the date for completion, the *parties* must ensure that –
- 30.10.1 all *electronic documents* which a *party* must *Digitally Sign* to complete the *electronic transaction* are *populated* and *Digitally Signed*;
- 30.10.2 all certifications required by the *ECNL* are properly given; and
- 30.10.3 they do everything else in the *Electronic Workspace* which that *party* must do to enable the *electronic transaction* to proceed to completion.
- 30.11 If completion takes place in the *Electronic Workspace* –
- 30.11.1 payment electronically on completion of the price in accordance with clause 16.7 is taken to be payment by a single *settlement cheque*;
- 30.11.2 the completion address in clause 16.11 is the *Electronic Workspace*; and
- 30.11.3 clauses 13.13.2 to 13.13.4, 16.8, 16.12, 16.13 and 31.2.2 to 31.2.4 do not apply.
- 30.12 If the computer systems of any of the *Land Registry*, the *ELNO* or the Reserve Bank of Australia are inoperative for any reason at the *completion time* agreed by the *parties*, a failure to complete this contract for that reason is not a default under this contract on the part of either *party*.
- 30.13 If the *Electronic Workspace* allows the *parties* to choose whether financial settlement is to occur despite the computer systems of the *Land Registry* being inoperative for any reason at the *completion time* agreed by the *parties* –
- 30.13.1 *normally*, the *parties* must choose that financial settlement not occur; however

- 30.13.2 if both *parties* choose that financial settlement is to occur despite such failure and financial settlement occurs –
- all *electronic documents Digitally Signed* by the vendor, the *certificate of title* and any discharge of mortgage, withdrawal of caveat or other *electronic document* forming part of the *Lodgement Case* for the *electronic transaction* shall be taken to have been unconditionally and irrevocably delivered to the purchaser or the purchaser's mortgagee at the time of financial settlement together with the right to deal with the land comprised in the *certificate of title*; and
 - the vendor shall be taken to have no legal or equitable interest in the *property*.
- 30.14 A *party* who holds a *certificate of title* must act in accordance with any *Prescribed Requirement* in relation to the *certificate of title* but if there is no *Prescribed Requirement*, the vendor must *serve* the *certificate of title* after completion.
- 30.15 If the *parties* do not agree about the delivery before completion of one or more documents or things that cannot be delivered through the *Electronic Workspace*, the *party* required to deliver the documents or things –
- 30.15.1 holds them on completion in escrow for the benefit of; and
- 30.15.2 must immediately after completion deliver the documents or things to, or as directed by; the *party* entitled to them.
- 30.16 In this clause 30, these terms (in any form) mean –
- | | |
|---------------------------------|---|
| <i>adjustment figures</i> | details of the adjustments to be made to the price under clause 14; |
| <i>certificate of title</i> | the paper duplicate of the folio of the register for the land which exists immediately prior to completion and, if more than one, refers to each such paper duplicate; |
| <i>completion time</i> | the time of day on the date for completion when the <i>electronic transaction</i> is to be settled; |
| <i>conveyancing rules</i> | the rules made under s12E of the Real Property Act 1900; |
| <i>discharging mortgagee</i> | any discharging mortgagee, chargee, covenant chargee or caveator whose provision of a <i>Digitally Signed</i> discharge of mortgage, discharge of charge or withdrawal of caveat is required in order for unencumbered title to the <i>property</i> to be transferred to the purchaser; |
| <i>ECNL</i> | the Electronic Conveyancing National Law (NSW); |
| <i>effective date</i> | the date on which the <i>Conveyancing Transaction</i> is agreed to be an <i>electronic transaction</i> under clause 30.1.2 or, if clauses 30.1.1 or 30.1.3 apply, the contract date; |
| <i>electronic document</i> | a dealing as defined in the Real Property Act 1900 which may be created and <i>Digitally Signed</i> in an <i>Electronic Workspace</i> ; |
| <i>electronic transfer</i> | a transfer of land under the Real Property Act 1900 for the <i>property</i> to be prepared and <i>Digitally Signed</i> in the <i>Electronic Workspace</i> established for the purposes of the <i>parties' Conveyancing Transaction</i> ; |
| <i>electronic transaction</i> | a <i>Conveyancing Transaction</i> to be conducted for the <i>parties</i> by their legal representatives as <i>Subscribers</i> using an <i>ELN</i> and in accordance with the <i>ECNL</i> and the <i>participation rules</i> ; |
| <i>electronically tradeable</i> | a land title that is Electronically Tradeable as that term is defined in the <i>conveyancing rules</i> ; |
| <i>incoming mortgagee</i> | any mortgagee who is to provide finance to the purchaser on the security of the <i>property</i> and to enable the purchaser to pay the whole or part of the price; |
| <i>mortgagee details</i> | the details which a <i>party</i> to the <i>electronic transaction</i> must provide about any <i>discharging mortgagee</i> of the <i>property</i> as at completion; |
| <i>participation rules</i> | the participation rules as determined by the <i>ENCL</i> ; |
| <i>populate</i> | to complete data fields in the <i>Electronic Workspace</i> ; and |
| <i>title data</i> | the details of the title to the <i>property</i> made available to the <i>Electronic Workspace</i> by the <i>Land Registry</i> . |

31 Foreign Resident Capital Gains Withholding

- 31.1 This clause applies only if –
- 31.1.1 the sale is not an excluded transaction within the meaning of s14-215 of Schedule 1 to the *TA Act*; and
- 31.1.2 a *clearance certificate* in respect of every vendor is not attached to this contract.
- 31.2 The purchaser must –
- 31.2.1 at least 5 days before the date for completion, *serve* evidence of submission of a purchaser payment notification to the Australian Taxation Office by the purchaser or, if a direction under clause 4.3 has been *served*, by the transferee named in the transfer *served* with that direction;
- 31.2.2 produce on completion a *settlement cheque* for the *remittance amount* payable to the Deputy Commissioner of Taxation;
- 31.2.3 forward the *settlement cheque* to the payee immediately after completion; and

- 31.2.4 serve evidence of receipt of payment of the *remittance amount*.
- 31.3 The vendor cannot refuse to complete if the purchaser complies with clauses 31.2.1 and 31.2.2.
- 31.4 If the vendor *serves* any *clearance certificate* or *variation*, the purchaser does not have to complete earlier than 7 days after that *service* and clause 21.3 does not apply to this provision.
- 31.5 If the vendor *serves* in respect of every vendor either a *clearance certificate* or a *variation* to 0.00 percent, clauses 31.2 and 31.3 do not apply.

10/20 CLARKE STREET NARRABEEN NSW 2101

CONDITIONS OF SALE BY AUCTION

If the property is or is intended to be sold at auction:

Bidders Record means the Bidders Record to be kept pursuant to Clause 18 of the *Property, Stock and Business Agents Regulation 2003* and Section 68 of the *Property, Stock and Business Agents Act 2002*:

- (1) The following conditions are prescribed as applicable to and in respect of the sale by auction of land or livestock:
 - (a) The principal's reserve price must be given in writing to the auctioneer before the auction commences.
 - (b) A bid for the seller cannot be made unless the auctioneer has, before the commencement of the auction, announced clearly and precisely the number of bids that may be made by or on behalf of the seller.
 - (c) The highest bidder is the purchaser, subject to any reserve price.
 - (d) In the event of a disputed bid, the auctioneer is the sole arbitrator and the auctioneer's decision is final.
 - (e) The auctioneer may refuse to accept any bid that, in the auctioneer's opinion, is not in the best interests of the seller.
 - (f) A bidder is taken to be a principal unless, before bidding, the bidder has given to the auctioneer a copy of a written authority to bid for or on behalf of another person.
 - (g) A bid cannot be made or accepted after the fall of the hammer.
 - (h) As soon as practicable after the fall of the hammer the purchaser is to sign the agreement (if any) for sale.
- (2) The following conditions, in addition to those prescribed by subclause (1), are prescribed as applicable to and in respect of the sale by auction of residential property or rural land:
 - (a) All bidders must be registered in the Bidders Record and display an identifying number when making a bid.
 - (b) Subject to subclause (2A), the auctioneer may make only one vendor bid at an auction for the sale of residential property or rural land and no other vendor bid may be made by the auctioneer or any other person.
 - (c) Immediately before making a vendor bid the auctioneer must announce that the bid is made on behalf of the seller or announce "vendor bid".
- (2A) The following conditions, in addition to those prescribed by subclauses (1) and (2), are prescribed as applicable to and in respect of the sale by auction of co-owned residential property or rural land or the sale of such land by a seller as executor or administrator:
 - (a) More than one vendor bid may be made to purchase the interest of a co-owner.
 - (b) A bid by or on behalf of an executor or administrator may be made to purchase in that capacity.
 - (c) Before the commencement of the auction, the auctioneer must announce that bids to purchase the interest of another co-owner or to purchase as executor or administrator may be made by or on behalf of the seller.
 - (d) Before the commencement of the auction, the auctioneer must announce the bidder registration number of any co-owner, executor or administrator or any person registered to bid on behalf of any co-owner, executor or administrator.
- (3) The following condition, in addition to those prescribed by subclause (1), is prescribed as applicable to and in respect of the sale by auction of livestock:
 - (a) The purchaser of livestock must pay the stock and station agent who conducted the auction (or under whose immediate and direct supervision the auction was conducted) or the vendor the full amount of the purchase price:
 - (b) if that amount can reasonably be determined immediately after the fall of the hammer – before the close of the next business day following the auction, or
 - (c) if that amount cannot reasonably be determined immediately after the fall of the hammer – before the close of the next business day following determination of that amount,unless some other time for payment is specified in a written agreement between the purchaser and the agent or the purchaser and the vendor made before the fall of the hammer.

SPECIAL CONDITIONS IN THE CONTRACT FOR SALE BETWEEN

Bradley Webber & Kathleen Amber Giles

[VENDOR]

[PURCHASER]

32 Amendments to Printed Form

- 32.1 For all purposes of this Contract the terms of the printed Contract to which these clauses are annexed are amended as follows:
- 32.1.1 Clause 2.4.- deleting "cash (up to \$2,000.00) or".
 - 32.1.2 Clause 7.1 - deleting "5% of the purchase price" and substituting '\$1,000.00'.
 - 32.1.3 Clause 14.4,2 – deleting the words "the person who owned the land owned no other land" and replace with:
"by adjusting the amount that has been paid or assessed as liable to be paid by the Vendor on the property."
 - 32.1.4 Clause 16.5 - deleting the words "plus another 20% of that fee".
 - 32.1.5 Clause 16.7 - deleting "cash (up to \$2,000.00) or".
 - 32.1.6 Clause 20.6.5 is deleted and replaced with:
"20.6.5 served if it is sent to the party's solicitor and shall be deemed to have been sent when the fax transmission has been completed except in the following situations:
(a) When the sender's machine indicates a malfunction in transmission or the recipient immediately notifies the sender of any incomplete transmission service; or
(b) The transmission is not received before 5.00 pm (recipient's time) on the business day in which case service shall be deemed to be effected at 9.00 am on the following business day."
 - 32.1.9. Clauses 23.9.1 and 23.9.2 – delete.
- 32.2 The provisions of these Special Conditions shall prevail to the extent of any inconsistency with the printed Contract.

33 Completion

- 33.1 Completion of this Contract will take place on or before 3.30 pm on the completion date.
- 33.2 If this Contract is not completed on or by the Completion Date either party will be entitled by notice in writing to the other party to issue a notice making time of the essence of this Contract. Fourteen (14) days shall be deemed to be a reasonable and sufficient period for that purpose. The time limited by such a notice for completion may, if the party issuing it so elects, expire at a specified time of day. The Vendor may at any time withdraw a Notice to Complete without prejudice to the continuing rights of the Vendor to give any further such notice.
- 33.3 If this Contract is not completed by the Completion Date for any reason not solely attributable to the Vendor, then the Purchaser must pay interest on the unpaid balance of the purchase price at the rate of 10% per annum calculated daily from the Completion Date up to and including the date on which settlement actually takes place or on the date of the Vendor's termination for the Purchaser's default, and the interest must be paid on completion and the Vendor is not obliged to complete unless the interest is paid;
- 33.4 In addition to any other monies payable by the Purchaser on completion of this contract, the Purchaser must also pay an additional amount of \$330.00 on completion to cover the legal costs and other associated legal expenses incurred by the Vendor as a consequence of the delay by the Purchaser should the Purchaser not be ready to complete on the completion date. The Purchaser acknowledges that payment of this sum is an essential term of this contract.
- 33.5 If the Transfer is submitted to the Vendor without being stamped for duty and is subsequently required to be stamped by an OSR Client Service Provider at the settlement venue, then the Vendor is entitled to charge a fee of \$77.00 to reimburse the Vendor's Agent for the protracted time involved in settlement.
- 33.6 Clause 33 is an essential term of this Contract and it is agreed by the parties that the rights to the interest and other amounts stated in Clause 33 does not limit any other rights the Vendor may have as a result of the Purchaser's failure to complete in accordance with this Contract. It is agreed by the parties that the amounts is a

genuine pre-estimate of part of the Vendor's damage as a result of the Purchaser not completing on the Date for Completion under the Contract due to the delay in completion.

34. Completion Delays

- 34.1 The Purchaser must pay to the Vendor, at completion, in addition to other moneys payable under this contract the sum of \$220.00 (inclusive of GST) (in addition to any amount set forth in other paragraphs of this clause) if the parties meet for the purpose of completing this contract but, through no fault of the Vendor, completion does not occur at this meeting; and
- 34.2 The Purchaser acknowledged that the further sums payable as aforesaid represent a genuine pre-estimate of the Vendor's loss.

35. Entire Agreement

- 35.1 Subject to Section 52A(2)(b) of the Conveyancing Act 1919 and Regulations pursuant thereto and subject to any warranty or representation expressly provided herein or which by law cannot be excluded, the Purchaser acknowledges and agrees and declares that:-
- 35.2 this Contract represents the entire agreement between the parties;
- 35.3 the Purchaser buys the property in its present state of repair and condition;
- 35.4 the Purchaser buys the property relying entirely on the Purchaser's own knowledge inspection and enquiries and the Vendor makes no statements or representations and gives no warranties in relation to the property;
- 35.5 the Purchaser does not rely on any advertising or sales promotional literature in relation to the property;
- 35.6 the Purchaser does not rely on any statements, representations or warranties made by the selling agent;
- 35.7 any warranties by or on behalf of the Vendor, express or implied, as to any purpose for which the property or as to any purpose for which the improvements erected on the property can be used are hereby negated.

36. Submission of Transfer

In the event that the Purchaser fails to deliver the Transfer to the Vendors Conveyancer in accordance with clause 4.1 of the Contract, then the Purchaser shall pay by way of an adjustment on completion the sum of \$110.00 for arranging execution of the Transfer at short notice. The Purchaser acknowledges that payment of this sum is an essential term of the contract.

37. Condition of Property and Inclusions.

- 37.1 The Purchaser acknowledges that it accepts the property and all buildings, improvements, swimming pools, retaining walls and fencing (if any) erected thereon and any furnishings, appliances and chattels included in this Contract, with any defect in regard to construction, state of repair, working order or otherwise including whether or not any of the improvements upon the property are subject to or insured under the provisions of the Builders Licensing Act 1971(NSW), the Home Building Act 1989 (NSW) or the Building Services Corporation Act 1989 (NSW),
- 37.2 The Vendor has not made and does not make any representations or warranty as to the state of repair or condition of the inclusions and the Purchaser accepts them in their state of repair and condition at the date of the Contract. The Vendor need not give formal delivery of the inclusions nor is the Vendor responsible for any loss or damage (other than loss or damage due to the negligence of the Vendor), mechanical breakdown or reasonable wear and tear occurring after the date of this Contract.
- 37.3 The Purchaser will raise no objection, requisition or claim for compensation regarding any such matter NOR shall it call upon the vendor to carry out any work, repair or replacement whatsoever in relation to the subject property or any inclusions including any key not in the possession of the Vendor;

38. Warranty as to Agent

The Purchaser warrants to the Vendor that it was not introduced to the property by any agent other than the agent (if any) named in this Contract, nor was any other agent the effective cause of the sale herein provided for. In the event that the Purchaser is in breach of such warranty the Purchaser hereby agrees to indemnify and keep indemnified the Vendor against any claim by any other agent in respect of the sale and against all claims and expenses of and incidental to the defence and determination of such claim.

39. Death or Incapacity

Without in any manner negating limiting or restricting any rights or remedies available to either party at law or in equity, had this clause not been included, should either party (or if more than one, any of them) die, become mentally ill, become insolvent or appoint or suffer the appointment of a trustee in bankruptcy, receiver, receiver/manager, voluntary administrator or liquidator then either party may rescind at any time thereafter.

40. Severability

Each of the provisions of this Contract for Sale shall be severable from each other and the invalidity, illegality or unenforceability of any provision herein contained shall not prejudice or in any way affect or impair the validity or enforceability of the remaining provisions hereof.

41. Deposit payable by instalments under a cooling off period

If the exchange of contracts takes place under a cooling off period, the parties agree that the deposit will be paid as to .25% on exchange of contracts and the balance of the 10% deposit on or before 5.00 pm on the fifth (5th) business day after the date of this contract.

42. Extensions to the Cooling Off Period

If a cooling-off period applies to this Contract then on the on each request by the Purchaser for an extension thereof and irrespective of whether the request is granted by the Vendor, the Purchaser must on completion pay a further sum of \$165.00 (inclusive of GST) for the Vendor's additional legal costs associated with dealing with the Purchaser's request(s). This fee is agreed by the parties to be a genuine and reasonable pre-estimate of the Vendor's actual costs. The payment of the fee is an essential term of Completion of this contract.

43. Corporate Purchaser

In the event of the Purchaser purporting to be a company each of the persons in the presence of whom the common seal of the Purchaser purports to have been affixed (or, in the event the contract signed under common seal, each person who signs on behalf of the Purchaser):

43.1 Warrants that the company has been incorporated and exists at law and agrees that he or she shall be personally liable under this contract, both jointly and severally, as if he or she had been named as a Purchaser; and

43.2 Guarantees (jointly and severally) the due performance of the Purchaser in relation to its obligations pursuant to the terms of this Contract in every respect as if he or she had personally entered into this contract himself/herself.

44. Release of Deposit

Further to clause 2.8, if required by the Vendor the deposit will be released for the benefit of the Vendor on the basis that it may only be used by the Vendor as a deposit on real estate to be purchased by the Vendor in NSW. Such deposit must be held in a trust account of either a Real Estate Agent, Solicitor or Conveyancer

45. Exchange on less than 10% deposit

45.1 **If the Vendor agrees** to accept a 5% deposit although a full 10% deposit is payable by the purchaser, the vendor has agreed to allow the purchaser to exchange the contract on the basis that only part of the deposit is paid at the time of exchange being 5% of the purchase price.

45.2 The balance of the deposit must be paid by the purchaser to the deposit holder as soon as possible as an earnest that the full price will be paid on completion. The full earnest of 10% of the price will be forfeited in the event that the purchaser fails to complete in accordance with the terms hereof.

45.3 If the Purchaser defaults in the observations and performance of any of the purchaser's obligations under this contract, the purchaser must pay to the vendor the balance of the 5% deposit immediately if this has not already been paid of the price upon demand by the vendor. If the purchase fails to pay the additional amount on demand by the vendor, the vendor may recover the additional amount from the purchaser as a debt.

45.4 All interest earned shall be paid to the Vendor on completion.



Title Search



NEW SOUTH WALES LAND REGISTRY SERVICES - TITLE SEARCH

FOLIO: 10/SP7013

SEARCH DATE	TIME	EDITION NO	DATE
30/3/2019	1:55 AM	6	2/9/2018

NO CERTIFICATE OF TITLE HAS ISSUED FOR THE CURRENT EDITION OF THIS FOLIO.
CONTROL OF THE RIGHT TO DEAL IS HELD BY COMMONWEALTH BANK OF AUSTRALIA.

LAND

LOT 10 IN STRATA PLAN 7013
AT WARINGAH
LOCAL GOVERNMENT AREA NORTHERN BEACHES

FIRST SCHEDULE

BRADLEY WEBBER
KATHLEEN AMBER GILES
AS JOINT TENANTS

(T AG650349)

SECOND SCHEDULE (2 NOTIFICATIONS)

- 1 INTERESTS RECORDED ON REGISTER FOLIO CP/SP7013
- 2 AG650350 MORTGAGE TO COMMONWEALTH BANK OF AUSTRALIA

NOTATIONS

UNREGISTERED DEALINGS: NIL

*** END OF SEARCH ***

InfoTrack an approved NSW Information Broker hereby certifies that the information contained in this document has been provided electronically by the Registrar General in accordance with Section 96B(2) of the Real Property Act 1900.

Copyright © Office of the Registrar-General 2019
Received: 30/03/2019 01:55:05



LAND
REGISTRY
SERVICES

Title Search



NEW SOUTH WALES LAND REGISTRY SERVICES - TITLE SEARCH

FOLIO: CP/SP7013

SEARCH DATE	TIME	EDITION NO	DATE
30/3/2019	1:53 AM	3	24/11/2008

LAND

THE COMMON PROPERTY IN THE STRATA SCHEME BASED ON STRATA PLAN 7013
WITHIN THE PARCEL SHOWN IN THE TITLE DIAGRAM

AT WARINGAH
LOCAL GOVERNMENT AREA NORTHERN BEACHES
PARISH OF MANLY COVE COUNTY OF CUMBERLAND
TITLE DIAGRAM SHEET 1 SP7013

FIRST SCHEDULE

THE OWNERS - STRATA PLAN NO. 7013
ADDRESS FOR SERVICE OF DOCUMENTS:
C/- BCS STRATA MANAGEMENT
LOCKED BAG 22
HAYMARKET NSW 1238

SECOND SCHEDULE (5 NOTIFICATIONS)

- 1 RESERVATIONS AND CONDITIONS IN THE CROWN GRANT(S)
- 2 ATTENTION IS DIRECTED TO BY-LAWS SET OUT IN SCHEDULE 2 STRATA
SCHEMES MANAGEMENT REGULATION 2016
- 3 W977093 CHANGE OF BY-LAWS
- 4 Y629675 CHANGE OF BY-LAWS
- * 5 ATTENTION IS DIRECTED TO CLAUSE 3 SCHEDULE 4 STRATA SCHEMES
(FREEHOLD DEVELOPMENT) ACT 1973 REGARDING BOUNDARIES BETWEEN
LOTS AND COMMON PROPERTY IN STRATA SCHEMES REGISTERED BEFORE
1-7-1974

SCHEDULE OF UNIT ENTITLEMENT (AGGREGATE: 10000)

STRATA PLAN 7013

LOT	ENT	LOT	ENT	LOT	ENT	LOT	ENT
1	- 970	2	- 1067	3	- 1077	4	- 975
5	- 1079	6	- 1091	7	- 738	8	- 738
9	- 1140	10	- 1125				

NOTATIONS

UNREGISTERED DEALINGS: NIL

*** END OF SEARCH ***

11770

PRINTED ON 30/3/2019

* Any entries preceded by an asterisk do not appear on the current edition of the Certificate of Title. Warning: the information appearing under notations has not been formally recorded in the Register. InfoTrack an approved NSW Information Broker hereby certifies that the information contained in this document has been provided electronically by the Registrar General in accordance with Section 96B(2) of the Real Property Act 1900.

Copyright © Office of the Registrar-General 2019

Received: 30/03/2019 01:55:10

Form 1

- (a) State if whole or part.
(b) Refer to number of Lot, Allotment, or Portion and to the Deposited Plan, Town, or as the case may be.

Parcel comprises^(a) **WHOLE** of^(b) **LOT 16 SEC. 16 D.P. 6387**
Reference to Title Vol. **3188** Fol. **11**
Municipality/Shire/City **Warringah**
Locality **NARRABEEN**
Parish **Manly Cove** County **Cumberland**
Scale **1 : 400 (Lengths are in metres)**

STRATA PLAN 7013 **(E)**

Registered:  **sm 26-2-1973**
C.A.: **NO. 715/73 OF 7-2-1973**
Ref. Map: **WARRINGAH SH 42**
Last Plan: **D.P. 6387** *

External surface boundaries of the parcel and location of the building in relation thereto to be delineated in space opposite.

CLARKE ST.

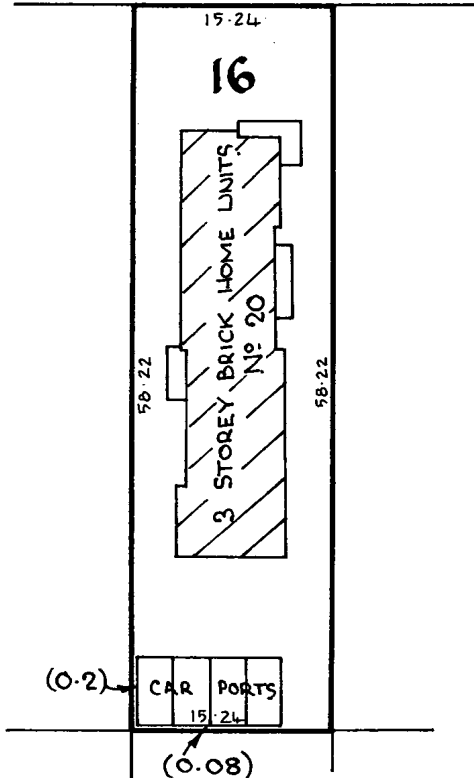

- (c) Additional lots should be shown in an annexure.

- (d) Delete if inappropriate.

Schedule of Unit Entitlement ^(c)		OFFICE USE ONLY		I, NORMAN TEMPLE BANKS of G. P. O. BOX 4495 SYDNEY a surveyor registered under the Surveyors Act, 1929, as amended, hereby certify that: (1) the building erected on the parcel described above is within the external boundaries of the parcel ^(d) subject to clause (2) of this certificate (2) roofs or gutters of the building project beyond such external boundaries and an appropriate easement has been granted as an appurtenance of the parcel by registered Transfer No. Dated 28th SEPT. 1972 Signature, <i>Norman T. Banks</i> Approved by the Council for the purposes of the Conveyancing (Strata Titles) Act, 1961. Date 7th February 1973 Subdivision No. 715/73 <i>Rev. S. S. S.</i> Council Clerk
Lot No.	Unit Entitlement	Vol.	Fol.	
		Current C's of T.		
		Resubdivision.		
1	970			
2	1067			
3	1077			
4	975			
5	1079			
6	1091			
7	738			
8	738			
9	1140			
10	1125			
AGGREGATE	10000			

The address for service of notices on the body corporate is:

20 CLARKE ST.

NARRABEEN 2101

STRATA PLAN No. 7013

**GROUND FLOOR
 UNITS GARAGES & CARPORTS**

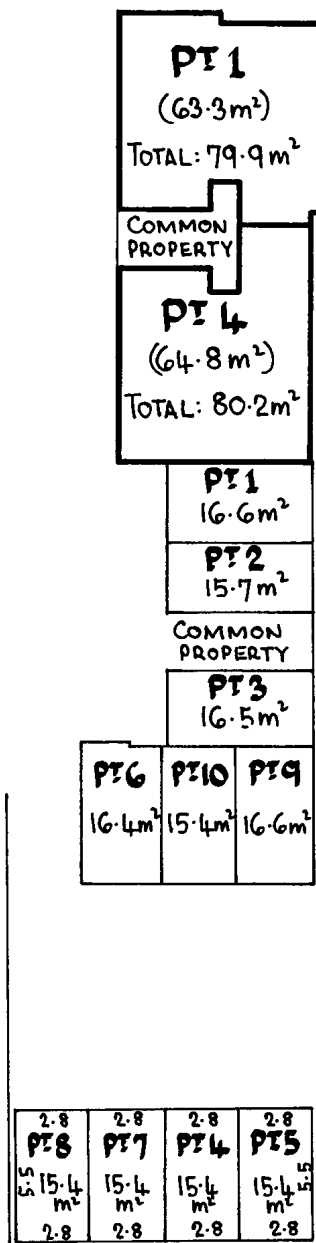

[Signature]
 Council Clerk.

STRATA PLAN No. 7013

FIRST FLOOR.

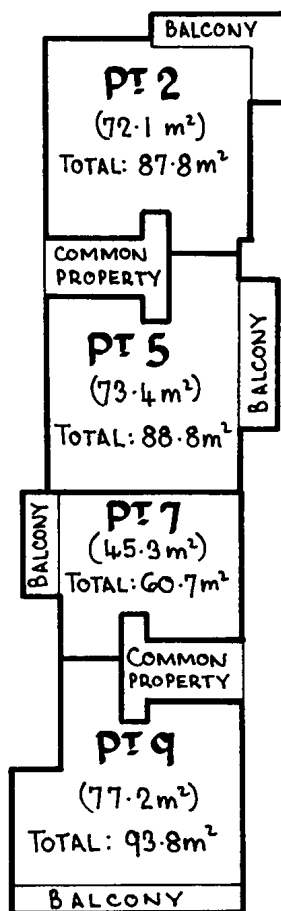

BALCONIES ARE INCLUDED IN THE
AREAS OF ADJACENT LOTS AND ARE
LIMITED TO A HEIGHT OF 2.4 METRES
ABOVE THE CONCRETE FLOOR.

R. M. M. M. M. M.
Council Clerk.

STRATA PLAN No. 7013

SECOND FLOOR

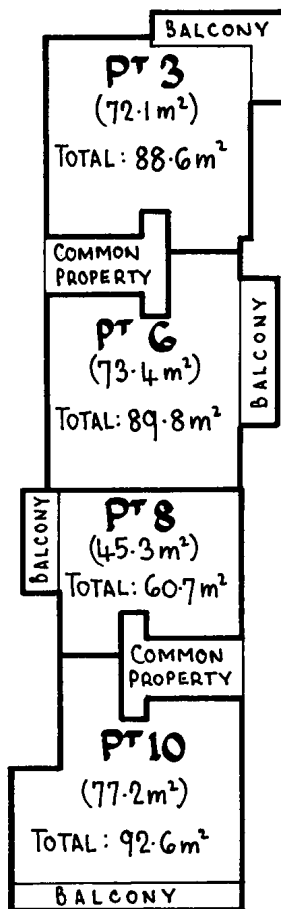

BALCONIES ARE INCLUDED IN THE
AREAS OF ADJACENT LOTS AND
ARE LIMITED TO A HEIGHT OF
2.4 METRES ABOVE THE CONCRETE
FLOOR.

R. J. J. J.
Council Clerk.

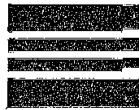

1977093

CHANGE OF BY-LAWS
 SECTION 58 (7), STRATA TITLES ACT,
 REAL PROPERTY ACT, 1900
 (See Instructions for Completion on back of form)

of 1	
37	

R10f1

REFERENCE TO
 TITLE OF
 COMMON
 PROPERTY
 Note (a)

Torrens Title Reference

φ VOLUME 8526 FOLIO 13 φ NOW BEING WHOLE OF LAND COMPRISED
 IN FOLIO/CT. C.P. 577013 ✓

NUMBER OF
 STRATA PLAN
 Note (b)

THE PROPRIETORS—STRATA PLAN No. 7013 the registered proprietor of the common property comprised in the Certificate of Title above

referred to, certifies that, by a resolution duly passed in accordance with the provisions of the Strata Titles Act, 1973, on 18th May, 1987

Note (c)

after the expiration of the initial period, it changed the by-laws as follows:

Note (b)

REPEALED BY-LAW No.
 INSERTED/ADDED BY-LAW No. 30
 as fully set out below.

OFFICE USE ONLY

ON CB.

Note (a)

SEE ANNEXURE HERETO

The common seal of The Proprietors—Strata Plan No. 7013
 was hereunto affixed on 25th JUN 1987 in the presence of
JOHN A. SCOTT
 (BLOCK LETTERS)

being the person(s) authorised by section 55 of the Strata Titles Act, 1973, to attest
 the affixing of the seal.

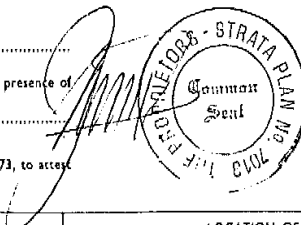

TO BE COMPLETED
 BY LODGING PARTY
 Notes (f)
 and (g)

OFFICE USE ONLY

LODGED BY		BLACKSHAW LINDSAY & BUGDEN, SOLICITORS, 19TH FLOOR, 25 BLIGH STREET, SYDNEY. N.S.W. 2000		LOCATION OF DOCUMENTS	
		CT	OTHER		
		✓	CONSENT	Herewith. <u>✓</u>	
				In R.G.O. with	
				Produced by	
Delivery Box Number		120N			
Checked	Passed	REGISTERED - -19		Secondary	
<u>✓</u>	<u>✓</u>	15 JUL 1987		Directions	
Signed	Extra Fee			Delivery	
		Registrar General		CT L.P.	

5/3

STRATA SCHEME NO. 7013

ANNEXURE TO
NOTIFICATION OF CHANGE OF BY-LAWS

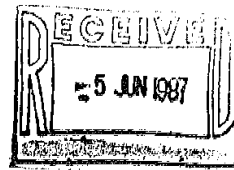

30. The proprietors for the time being of Lot 1 shall have the exclusive use, possession and enjoyment of that part of the common property adjoining Lot 1, designated in the plan annexed hereto referred to as the grassed area and forming part of this by-law, subject to the following terms and conditions:
- (a) Such proprietor shall then be entitled to erect a fence not exceeding 1.5m in height, providing that construction is carried out in a workmanlike manner and at no cost to the Body Corporate. The proprietor shall not be entitled to erect any construction, fitting or fixture upon the grassed area without written approval from the Body Corporate.
 - (b) In addition to the obligation imposed by Section 58(9) of the Act, that the proprietor shall carry out the Body Corporate duties pursuant to Section 68(1)(b) and (c) in respect of the fence and fixture.
 - (c) Such proprietor shall arrange for the registration of By-Law. All legal and registration fees shall be at the expense of the proprietor.
 - (d) In addition to any levies payable, pursuant to Section 68(1)(k) and (j), the proprietor shall pay a quarterly additional fee in an amount of 10% of such levies at the time of payment of that levy.

THIS is page 2 of a total of 3 which comprise the annexure to Notification of Change of By-Laws by THE PROPRIETORS - STRATA PLAN NO. 7013 dated the _____ day of _____, 1987.

The common seal of THE PROPRIETORS - STRATA PLAN NO. 7013 was hereunto affixed on 25th day of JUNE, 1987 in the presence of JOHN A. SCOTT being the person(s) authorised by Section 55 of the Strata Titles Act, 1973 to attest the affixing of the seal.

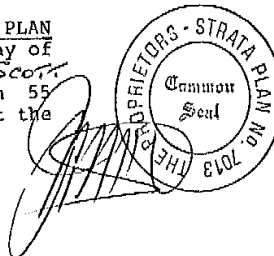

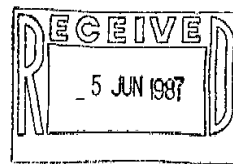

STRATA SCHEME NO. 7013

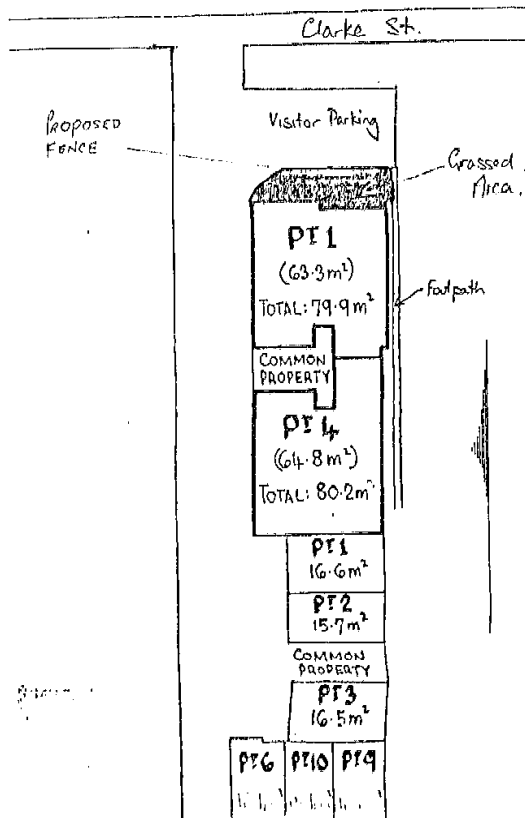

THIS is the plan annexed to Notification of Change of By-Laws in Strata Scheme No. 7013 dated the _____ day of _____, 1987 and is the plan annexed to and forming part of By-Law 30 referred to in the said Notification.

The common seal of The Proprietors - Strata Plan No. 7013 was hereunto affixed on 25th JUN 1987, 1987. in the presence of JOHN A. SCOTT being the person (s) authorised by Section 55 of the Strata Titles Act, 1973, to attest the affixing of the seal.

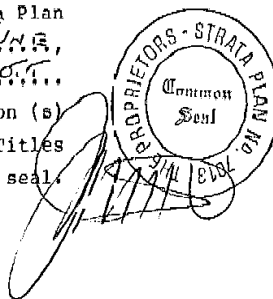

P.47



13



Y629675

CHANGE OF BY-LAWS
SECTION 58 (7), STRATA TITLES ACT, 1973
REAL PROPERTY ACT, 1900
(See Instructions for Completion on back of form)

CA	1 st	
\$	44	

R1/1

REFERENCE TO
TITLE OF
COMMON
PROPERTY

Note (a)

Torrens Title Reference

FOLIO IDENTIFIER CP/SP7013

NUMBER OF
STRATA PLAN

Note (b)

THE PROPRIETORS—STRATA PLAN No. 7013....., the registered proprietor of the common property comprised in the Certificate of Title above

referred to, certifies that, by a resolution duly passed in accordance with the provisions of the Strata Titles Act, 1973, on 27th July, 1989

Note (c)

after the expiration of the Initial period, it changed the by-laws as follows:

Note (b)

REPEALED BY-LAW No.

INSERTED/ADDED BY-LAW No. SPECIAL BY-LAW 1.....

..... as fully set out below.

OFFICE USE ONLY

ONCB

Note (e)

SPECIAL BY-LAW 1 .

The proprietors for the time being of lot 4, shall have the exclusive use, possession and enjoyment of that part of the common property adjoining lot 4, designated in the plan annexed hereto referred to as the paved area and forming part of this by-law, subject to the following terms and conditions.

The common seal of The Proprietors—Strata Plan No. 7013

was hereunto affixed on 11th SEPTEMBER '89 in the presence of

JOHN A. SCOTT
(BLOCK LETTERS)

being the person(s) authorised by section 55 of the Strata Titles Act, 1973, to attest the affixing of the seal.

TO BE COMPLETED
BY LODGING PARTY
Notes (f)
and (g)

LODGED BY BLACKSHAW LINDSAY & BUGDEN,
SOLICITORS,
36A BAY STREET,
DOUBLE BAY NSW 2028
D.X. 3601 DOUBLE BAY

Delivery Box Number 120N

OFFICE USE ONLY

Checked	Passed
Signed	Extra Fee

REGISTERED - -19

1 SEP 1989

Registrar General

LOCATION OF DOCUMENTS

CT OTHER

✓

Herewith.

In R.G.O. with

Produced by

Secondary

Directions

Delivery

Directions

CT

120N

STRATA SCHEME NO. 7013

ANNEXURE TO

NOTIFICATION OF CHANGE OF BY-LAWS

- (a) Such proprietor shall then be entitled to erect a fence not exceeding 1.5m in height, providing that construction is carried out in a workmanlike manner and at no cost to the Body Corporate. The proprietor shall not be entitled to erect any construction, fitting or fixture upon the paved area without written approval from the Body Corporate.
- (b) The proprietor shall be responsible for the maintenance and keeping in a state of good and serviceable repair of the common property the subject of this by-law, and further shall maintain and keep in a state of good and serviceable repair any fence or other improvement erected pursuant to this by-law.
- (c) The proprietor shall indemnify the Body Corporate against all expenses, including legal costs and registration fees, of or about the making of this by-law.
- (d) In addition to any contributions payable by the proprietors pursuant to provisions of the Strata Titles Act, 1973, the proprietor shall pay a quarterly fee in the amount of ten per cent of his said contributions at the time of payment of those contributions.

THIS is page 2 of a total of 3 which comprise the annexure to Notification of Change of By-Laws by THE PROPRIETORS - STRATA PLAN NO. 7013 dated the 11th day of SEPTEMBER, 1989.

The common seal of THE PROPRIETORS - STRATA PLAN NO. 7013 was hereunto affixed on 11th day of SEPTEMBER 1989 in the presence of J. W. H. Seers being the person(s) authorised by Section 55 of the Strata Titles Act, 1973 to attest the affixing of the seal.

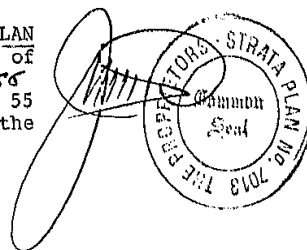

PLAN

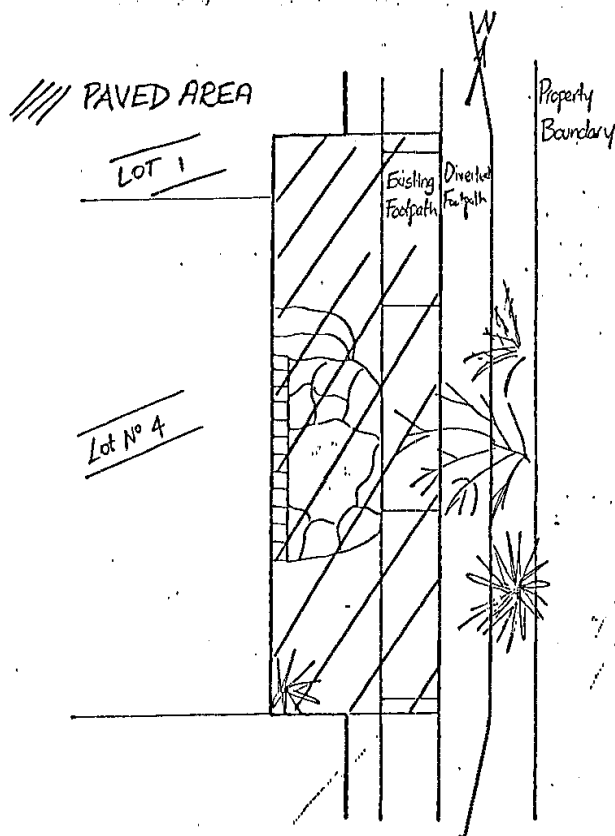

THIS is the plan annexed to Notification of Change of By-Laws in Strata Scheme No. 7013 dated the day of , 1989 and is the plan annexed to and forming part of Special by-law referred to in the said Notification.

The common seal of The Proprietors, - Strata Plan No. 7013 was hereunto affixed on 11TH SEPTEMBER, 1989, in the presence of being the person (s) authorised by Section 55 of the Strata Titles Act, 1973, to attest the affixing of the seal.

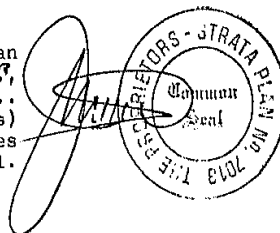

Strata Schemes Management Regulation 2016

As at 16 November 2017

Schedule 2 By-laws for pre-1996 strata schemes

(Clause 35)

1 Noise

An owner or occupier of a lot must not create any noise on the parcel likely to interfere with the peaceful enjoyment of the owner or occupier of another lot or of any person lawfully using common property.

This by-law was previously by-law 12 in Schedule 1 to the *Strata Schemes (Freehold Development) Act 1973* and by-law 13 in Schedule 3 to the *Strata Schemes (Leasehold Development) Act 1986*.

2 Vehicles

An owner or occupier of a lot must not park or stand any motor or other vehicle on common property except with the written approval of the owners corporation.

This by-law was previously by-law 13 in Schedule 1 to the *Strata Schemes (Freehold Development) Act 1973* and by-law 14 in Schedule 3 to the *Strata Schemes (Leasehold Development) Act 1986*.

3 Obstruction of common property

An owner or occupier of a lot must not obstruct lawful use of common property by any person.

This by-law was previously by-law 14 in Schedule 1 to the *Strata Schemes (Freehold Development) Act 1973* and by-law 15 in Schedule 3 to the *Strata Schemes (Leasehold Development) Act 1986*.

4 Damage to lawns and plants on common property

An owner or occupier of a lot must not:

- (a) damage any lawn, garden, tree, shrub, plant or flower being part of or situated on common property, or
- (b) use for his or her own purposes as a garden any portion of the common property.

This by-law was previously by-law 15 in Schedule 1 to the *Strata Schemes (Freehold Development) Act 1973* and by-law 16 in Schedule 3 to the *Strata Schemes (Leasehold Development) Act 1986*.

5 Damage to common property

- (1) An owner or occupier of a lot must not mark, paint, drive nails or screws or the like into, or otherwise damage or deface, any structure that forms part of the common property without the approval in writing of the owners corporation. This by-law is subject to sections 109 and 110 of the *Strata Schemes Management Act 2015*.
- (2) An approval given by the owners corporation under clause (1) cannot authorise any additions to the common property.
- (3) This by-law does not prevent an owner or person authorised by an owner from installing:
 - (a) any locking or other safety device for protection of the owner's lot against

intruders, or

(b) any screen or other device to prevent entry of animals or insects on the lot, or

(c) any structure or device to prevent harm to children.

(4) Any such locking or safety device, screen, other device or structure must be installed in a competent and proper manner and must have an appearance, after it has been installed, in keeping with the appearance of the rest of the building.

(5) Despite section 106 of the *Strata Schemes Management Act 2015*, the owner of a lot must maintain and keep in a state of good and serviceable repair any installation or structure referred to in clause (3) that forms part of the common property and that services the lot.

This by-law was previously by-law 16 in Schedule 1 to the *Strata Schemes (Freehold Development) Act 1973* and by-law 17 in Schedule 3 to the *Strata Schemes (Leasehold Development) Act 1986*.

6 Behaviour of owners and occupiers

An owner or occupier of a lot when on common property must be adequately clothed and must not use language or behave in a manner likely to cause offence or embarrassment to the owner or occupier of another lot or to any person lawfully using common property.

This by-law was previously by-law 17 in Schedule 1 to the *Strata Schemes (Freehold Development) Act 1973* and by-law 18 in Schedule 3 to the *Strata Schemes (Leasehold Development) Act 1986*.

7 Children playing on common property in building

An owner or occupier of a lot must not permit any child of whom the owner or occupier has control to play on common property within the building or, unless accompanied by an adult exercising effective control, to be or to remain on common property comprising a laundry, car parking area or other area of possible danger or hazard to children.

This by-law was previously by-law 18 in Schedule 1 to the *Strata Schemes (Freehold Development) Act 1973* and by-law 19 in Schedule 3 to the *Strata Schemes (Leasehold Development) Act 1986*.

8 Behaviour of invitees

An owner or occupier of a lot must take all reasonable steps to ensure that invitees of the owner or occupier do not behave in a manner likely to interfere with the peaceful enjoyment of the owner or occupier of another lot or any person lawfully using common property.

This by-law was previously by-law 19 in Schedule 1 to the *Strata Schemes (Freehold Development) Act 1973* and by-law 20 in Schedule 3 to the *Strata Schemes (Leasehold Development) Act 1986*.

9 Depositing rubbish and other material on common property

An owner or occupier of a lot must not deposit or throw on the common property any rubbish, dirt, dust or other material likely to interfere with the peaceful enjoyment of the owner or occupier of another lot or of any person lawfully using the common property.

This by-law was previously by-law 20 in Schedule 1 to the *Strata Schemes (Freehold Development) Act 1973* and by-law 21 in Schedule 3 to the *Strata Schemes (Leasehold Development) Act 1986*.

10 Drying of laundry items

An owner or occupier of a lot must not, except with the consent in writing of the owners corporation, hang any washing, towel, bedding, clothing or other article on any part of the parcel in such a way as to be visible from outside the building other than on any lines provided by the owners corporation for the purpose and there only for a reasonable period.

This by-law was previously by-law 21 in Schedule 1 to the *Strata Schemes (Freehold Development) Act 1973* and

by-law 22 in Schedule 3 to the *Strata Schemes (Leasehold Development) Act 1986*.

11 Cleaning windows and doors

An owner or occupier of a lot must keep clean all glass in windows and all doors on the boundary of the lot, including so much as is common property.

This by-law was previously by-law 22 in Schedule 1 to the *Strata Schemes (Freehold Development) Act 1973* and by-law 23 in Schedule 3 to the *Strata Schemes (Leasehold Development) Act 1986*.

12 Storage of inflammable liquids and other substances and materials

(1) An owner or occupier of a lot must not, except with the approval in writing of the owners corporation, use or store on the lot or on the common property any inflammable chemical, liquid or gas or other inflammable material.

(2) This by-law does not apply to chemicals, liquids, gases or other material used or intended to be used for domestic purposes, or any chemical, liquid, gas or other material in a fuel tank of a motor vehicle or internal combustion engine.

This by-law was previously by-law 23 in Schedule 1 to the *Strata Schemes (Freehold Development) Act 1973* and by-law 24 in Schedule 3 to the *Strata Schemes (Leasehold Development) Act 1986*.

13 Moving furniture and other objects on or through common property

An owner or occupier of a lot must not transport any furniture or large object through or on common property within the building unless sufficient notice has first been given to the strata committee so as to enable the strata committee to arrange for its nominee to be present at the time when the owner or occupier does so.

This by-law was previously by-law 24 in Schedule 1 to the *Strata Schemes (Freehold Development) Act 1973* and by-law 25 in Schedule 3 to the *Strata Schemes (Leasehold Development) Act 1986*.

14 Floor coverings

(1) An owner of a lot must ensure that all floor space within the lot is covered or otherwise treated to an extent sufficient to prevent the transmission from the floor space of noise likely to disturb the peaceful enjoyment of the owner or occupier of another lot.

(2) This by-law does not apply to floor space comprising a kitchen, laundry, lavatory or bathroom.

This by-law was previously by-law 25 in Schedule 1 to the *Strata Schemes (Freehold Development) Act 1973* and by-law 26 in Schedule 3 to the *Strata Schemes (Leasehold Development) Act 1986*.

15 Garbage disposal

An owner or occupier of a lot:

(a) must maintain within the lot, or on such part of the common property as may be authorised by the owners corporation, in clean and dry condition and adequately covered a receptacle for garbage, and

(b) must ensure that before refuse is placed in the receptacle it is securely wrapped or, in the case of tins or other containers, completely drained, and

(c) for the purpose of having the garbage collected, must place the receptacle within an area designated for that purpose by the owners corporation and at a time not more than 12 hours before the time at which garbage is normally collected, and

(d) when the garbage has been collected, must promptly return the receptacle to the lot or other area referred to in paragraph (a), and

(e) must not place any thing in the receptacle of the owner or occupier of any other lot except with the permission of that owner or occupier, and

(f) must promptly remove any thing which the owner, occupier or garbage collector may have spilled from the receptacle and must take such action as may be necessary to clean the area within which that thing was spilled.

This by-law was previously by-law 26 in Schedule 1 to the *Strata Schemes (Freehold Development) Act 1973* and by-law 27 in Schedule 3 to the *Strata Schemes (Leasehold Development) Act 1986*.

16 Keeping of animals

(1) Subject to section 157 of the *Strata Schemes Management Act 2015*, an owner or occupier of a lot must not, without the approval in writing of the owners corporation, keep any animal on the lot or the common property.

(2) The owners corporation must not unreasonably withhold its approval of the keeping of an animal on a lot or the common property.

This by-law was previously by-law 27 in Schedule 1 to the *Strata Schemes (Freehold Development) Act 1973* and by-law 28 in Schedule 3 to the *Strata Schemes (Leasehold Development) Act 1986*.

17 Appearance of lot

(1) The owner or occupier of a lot must not, without the written consent of the owners corporation, maintain within the lot anything visible from outside the lot that, viewed from outside the lot, is not in keeping with the rest of the building.

(2) This by-law does not apply to the hanging of any washing, towel, bedding, clothing or other article as referred to in by-law 10.

This by-law was previously by-law 29 in Schedule 1 to the *Strata Schemes (Freehold Development) Act 1973* and by-law 30 in Schedule 3 to the *Strata Schemes (Leasehold Development) Act 1986*.

18 Notice board

An owners corporation must cause a notice board to be affixed to some part of the common property.

This by-law was previously by-law 3 in Schedule 1 to the *Strata Schemes (Freehold Development) Act 1973* and by-law 3 in Schedule 3 to the *Strata Schemes (Leasehold Development) Act 1986*.

19 Change in use of lot to be notified

An occupier of a lot must notify the owners corporation if the occupier changes the existing use of the lot in a way that may affect the insurance premiums for the strata scheme (for example, if the change of use results in a hazardous activity being carried out on the lot, or results in the lot being used for commercial or industrial purposes rather than residential purposes).

Northern Beaches Council Planning Certificate – Part 2

Applicant: Conveyancing At Pittwater
PO Box 1737
WARRIEWOOD NSW 2102

Reference: GILES AND WEBBER
Date: 30/03/2019
Certificate No. ePLC2019/1830

Address of Property: 10/20 Clarke Street NARRABEEN NSW 2101
Description of Property: Lot 10 SP 7013

Planning Certificate – Part 2

The following certificate is issued under the provisions of Section 10.7(2) of the *Environmental Planning and Assessment Act 1979* (as amended – formerly Section 149). The information applicable to the land is accurate as at the above date.

1. Relevant planning instruments and Development Control Plans

1.1 The name of each environmental planning instrument that applies to the carrying out of development on the land:

1.1a) Local Environmental Plan

Warringah Local Environmental Plan 2011

1.1b) State Environmental Planning Policies and Regional Environmental Plans

State Environmental Planning Policy 1—Development Standards
State Environmental Planning Policy 19 – Bushland in Urban Areas
State Environmental Planning Policy 21 – Caravan Parks
State Environmental Planning Policy 30 – Intensive Agriculture
State Environmental Planning Policy 33 – Hazardous and Offensive Development
State Environmental Planning Policy 50 – Canal Estate Development
State Environmental Planning Policy 55 – Remediation of Land
State Environmental Planning Policy 62—Sustainable Aquaculture
State Environmental Planning Policy 64 – Advertising and Signage
State Environmental Planning Policy 65 – Design Quality of Residential Apartment Development
State Environmental Planning Policy No 70—Affordable Housing (Revised Schemes)
State Environmental Planning Policy (Affordable Rental Housing) 2009
State Environmental Planning Policy (Building Sustainability Index: BASIX) 2004

State Environmental Planning Policy (Educational Establishments and Child Care Facilities) 2017
 State Environmental Planning Policy (Exempt and Complying Development Codes) 2008
 State Environmental Planning Policy (Housing for Seniors or People with a Disability) 2004
 State Environmental Planning Policy (Infrastructure) 2007
 State Environmental Planning Policy (Mining, Petroleum Production and Extractive Industries) 2007
 State Environmental Planning Policy (Miscellaneous Consent Provisions) 2007
 State Environmental Planning Policy (State and Regional Development) 2011
 State Environmental Planning Policy (State Significant Precincts) 2005
 State Environmental Planning Policy (Vegetation in Non-Rural Areas) 2017
 Wholly Affected - State Environmental Planning Policy (Coastal Management) 2018
 Sydney Regional Environmental Plan No 20-Hawkesbury-Nepean River (No 2-1997)
 State Environmental Planning Policy No 44-Koala Habitat Protection
 Sydney Regional Environmental Plan (Sydney Harbour Catchment) 2005
 Sydney Regional Environmental Plan No 9-Extractive Industry (No 2-1995)

1.2 Draft Environmental Planning Instruments

The name of each proposed environmental planning instrument that will apply to the carrying out of development on the land and that is or has been subject of community consultation or on public exhibition under the Act (unless the Secretary has notified the Council that the making of the proposed instrument has been deferred indefinitely or has not been approved):

1.2 a) Draft State Environmental Planning Policies

Review of State Environmental Planning Policy 44 – Koala Habitat Protection
 State Environmental Planning Policy No 64— Advertising and Signage (Amendment No 3)
 Draft State Environmental Planning Policy (Environment)
 Draft State Environmental Planning Policy (Primary Production and Rural Development)
 Draft Amendment to State Environmental Planning Policy (Affordable Rental Housing) 2009

1.2 b) Draft Local Environmental Plans

Planning Proposal - Ralston Avenue (Belrose) (PEX2013/0003)

Applies to land: Lot 1 DP 1139826, Ralston Avenue, Belrose

Outline: Amends WLEP 2000 and WLEP 2011 to:

- Rezone land on Ralston Avenue Belrose from Locality C8 - Belrose North to part R2 Low Density Residential, part RE1 Public Recreation and part E3 Environmental Conservation.
- Introduce subdivision lot size and height of building controls to land proposed to be zoned R2 Low Density Residential.

Council resolution: 25 November 2014

Gateway Determination: 28 January 2015

Planning Proposal - Dee Why Town Centre Planning Controls (PEX2018/0002)

Applies to land: Dee Why Town Centre (boundaries identified within the Planning Proposal)

Outline: Amends WLEP 2011 to:

- Increase maximum permissible building heights
- Introduce floor space ratio controls
- Provide development standards in relation to car parking, building setbacks and building proportion

- Identify additional “Key Sites”
- Implement a delivery mechanism for key infrastructure and public domain improvements

Council resolution: 23 September 2014

Gateway Determination: 1 April 2015 amended 22 September 2016

1.3 Development Control Plans

The name of each development control plan that applies to the carrying out of development on the land:

Warringah Development Control Plan 2011

2. Zoning and land use under relevant Local Environmental Plans

For each environmental planning instrument or proposed instrument referred to in Clause 1 (other than a SEPP or proposed SEPP) that includes the land in any zone (however described):

2.1 Zoning and land use under relevant Local Environmental Plans

2.1 (a), (b), (c) & (d)

The following information identifies the purposes for which development may be carried out with or without development consent and the purposes for which the carrying out of development is prohibited, for all zones (however described) affecting the land to which the relevant Local Environmental Plan applies.

EXTRACT FROM WARRINGAH LOCAL ENVIRONMENTAL PLAN 2011

Zone R3 Medium Density Residential

1 Objectives of zone

- To provide for the housing needs of the community within a medium density residential environment.
- To provide a variety of housing types within a medium density residential environment.
- To enable other land uses that provide facilities or services to meet the day to day needs of residents.
- To ensure that medium density residential environments are characterised by landscaped settings that are in harmony with the natural environment of Warringah.
- To ensure that medium density residential environments are of a high visual quality in their presentation to public streets and spaces.

2 Permitted without consent

Home-based child care; Home occupations

3 Permitted with consent

Attached dwellings; Bed and breakfast accommodation; Boarding houses; Boat sheds; Building identification signs; Business identification signs; Centre-based child care facilities; Community facilities; Dual occupancies; Dwelling houses; Educational establishments; Emergency services facilities; Environmental protection works; Exhibition homes; Group homes; Home businesses; Multi dwelling housing; Neighbourhood shops; Places of public worship; Recreation areas;

Residential flat buildings; Respite day care centres; Roads; Secondary dwellings; Seniors housing; Veterinary hospitals

4 Prohibited

Any development not specified in item 2 or 3

Additional permitted uses

Additional permitted uses, if any, for which development is permissible with development consent pursuant to Clause 2.5 and Schedule 1 of the relevant Local Environmental Plan:

Nil

(e) Minimum land dimensions

The *Warringah Local Environmental Plan 2011* contains no development standard that fixes minimum land dimensions for the erection of a dwelling house on the land.

(f) Critical habitat

The land does not include or comprise critical habitat.

(g) Conservation areas

The land is not in a heritage conservation area.

(h) Item of environmental heritage

The land does not contain an item of environmental heritage.

2.2 Draft Local Environmental Plan - if any

For any proposed changes to zoning and land use, see Part 1.2 b)

Please contact Council's Strategic and Place Planning unit with enquiries on 1300 434 434.

2A. Zoning and land use under State Environmental Planning Policy (Sydney Region Growth Centres) 2006

The *State Environmental Planning Policy (Sydney Region Growth Centres) 2006* does not apply to the land.

3. Complying Development

The extent to which the land is land on which complying development may or may not be carried out under each of the codes for complying development because of the provisions of clauses 1.17A (1) (c) to (e), (2), (3) and (4), 1.18 (1) (c3) and 1.19 of *State Environmental Planning Policy (Exempt and Complying Development Codes) 2008*.

a) Housing Code

Complying Development under the Housing Code may be carried out on all of the land.

b) Rural Housing Code

Complying Development under the Rural Housing Code may be carried out on all of the land.

c) Low Rise Medium Density Code

Complying Development under the Low Rise Medium Density Code may not be carried out on all the land.

Note: Pursuant to clause 3B.63 of the *State Environmental Planning Policy (Exempt and Complying Development Codes) 2008*, all land in Northern Beaches Council is a 'deferred area' meaning that the Low Rise Medium Density Code does not apply until 1 July 2019.

d) Greenfield Housing Code

Complying Development under the Greenfield Housing Code may not be carried out on all of the land.

e) Housing Alterations Code

Complying Development under the Housing Alterations Code may be carried out on all of the land.

f) General Development Code

Complying Development under the General Development Code may be carried out on all of the land.

g) Commercial and Industrial Alterations Code

Complying Development under the Commercial and Industrial Alterations Code may be carried out on all of the land.

h) Commercial and Industrial (New Buildings and Additions) Code

Complying Development under the Commercial and Industrial (New Buildings and Additions) Code may be carried out on all of the land.

i) Container Recycling Facilities Code

Complying Development under the Container Recycling Facilities Code may be carried out on all of the land.

j) Subdivisions Code

Complying Development under the Subdivisions Code may be carried out on all of the land.

k) Demolition Code

Complying Development under the Demolition Code may be carried out on all of the land.

l) Fire Safety Code

Complying Development under the Fire Safety Code may be carried out on all of the land.

4. 4A (Repealed)

4B. Annual charges under Local Government Act 1993 for coastal protection services that relate to existing coastal protection works

The owner of the land (or any previous owner) has not consented in writing to the land being subject to annual charges under section 496B of the *Local Government Act 1993* for coastal protection services that relate to existing coastal protection works (within the meaning of section 553B of that Act).

5. Mine Subsidence

The land has not been proclaimed to be a mine Subsidence (Mine Subsidence) district within the meaning of section 15 of the *Mine Subsidence (Mine Subsidence) Compensation Act, 1961*.

6. Road widening and road realignment

- (a) The land is not affected by a road widening or re-alignment proposal under Division 2 of Part 3 of the *Roads Act 1993*.
- (b) The land is not affected by a road widening or re-alignment proposal under an environmental planning instrument.
- (c) The land is not affected by a road widening or re-alignment proposal under a resolution of Council.

7. Council and other public authority policies on hazard risk restriction

- (a) Council has adopted a number of policies with regard to various hazards or risks which may restrict development on this land. The identified hazard or risk and the respective Council policies which affect the property, if any, are listed below (other than flooding – see 7A):

Acid Sulfate Soils-Class 4

This land is identified as Acid Sulfate Soils Class 4 on the Acid Sulfate Soils Map of the *Warringah Local Environmental Plan 2011* (WLEP 2011). Restrictions apply to the carrying out of works on this land under Clause 6.1 of the WLEP 2011.

Acid Sulfate Soils-Class 5

This land is identified as Acid Sulfate Soils Class 5 on the Acid Sulfate Soils Map of the *Warringah Local Environmental Plan 2011* (WLEP 2011). Restrictions apply to the carrying out of works on this land under Clause 6.1 of the WLEP 2011.

- (b) The following information applies to any policy as adopted by any other public authority and notified to the Council for the express purpose of its adoption by that authority being referred to in a planning certificate issued by the Council. The identified hazard or risk and the respective Policy which affect the property, if any, are listed below:

Nil

7A. Flood related development control Information

- (1) Development on the land or part of the land for the purposes of dwelling houses, dual occupancies, multi dwelling housing or residential flat buildings (not including development for the purposes of group homes or seniors housing) is not subject to flood related development controls.
- (2) Development on the land or part of the land for any other purpose is not subject to flood related development controls.

8. Land reserved for acquisition

Environmental planning instrument referred to in Clause 1 does not make provision in relation to the acquisition of the land by a public authority, as referred to in section 27 of the Act.

9. Contribution plans

The following applies to the land:

Northern Beaches Contributions Plan 2018

9A. Biodiversity certified land

The land is not biodiversity certified land under Part 8 of the *Biodiversity Conservation Act 2016* (includes land certified under Part 7AA of the repealed *Threatened Species Conservation Act 1995*).

10. Biodiversity Stewardship Sites

The Council has not been notified by the Chief Executive of the Office of Environment and Heritage that the land is a biodiversity stewardship site under a biodiversity stewardship agreement under Part 5 of the *Biodiversity Conservation Act 2016* (includes land to which a biobanking agreement under Part 7A of the repealed *Threatened Species Conservation Act 1995* relates).

10A. Native vegetation clearing set asides

Council has not been notified by Local Land Services of the existence of a set aside area under section 60ZC of the *Local Land Services Act 2013*.

11. Bush fire prone land

Bush Fire Prone Land

The land is not bush fire prone land.

Draft Northern Beaches Bush Fire Prone Land Map 2018

The land is not bush fire prone land.

12. Property vegetation plans

The Council has not been notified that the land is land to which a vegetation plan under the *Native Vegetation Act 2003* applies.

13. Orders under Trees (Disputes Between Neighbours) Act 2006

Council has not been notified of the existence of an order made under the *Trees (Disputes Between Neighbours) Act 2006* to carry out work in relation to a tree on the land.

14. Directions under Part 3A

There is not a direction by the Minister in force under section 75P(2) (c1) of the Act that a provision of an environmental planning instrument prohibiting or restricting the carrying out of a project or a stage of a project on the land under Part 4 of the Act does not have effect.

15. Site compatibility certificates and conditions for seniors housing

- (a) There is not a current site compatibility certificate (seniors housing), of which the council is aware, in respect of proposed development on the land.
- (b) No condition of consent applies to the property that limits the kind of people who may occupy the premises/ development. This refers only to consents granted after 11 October 2007 with conditions made in accordance with clause 18(2) of *State Environmental Planning Policy (Housing for Seniors or People with a Disability) 2004*.

16. Site compatibility certificates for infrastructure, schools or TAFE establishments

There is not a valid site compatibility certificate (infrastructure) or site compatibility certificate (schools or TAFE establishments), of which the council is aware, in respect of proposed development on the land.

17. Site compatibility certificate and conditions for affordable rental housing

- (a) There is not a current site compatibility certificate (affordable rental housing), of which the council is aware, in respect of proposed development on the land.
- (b) There are not terms of a kind referred to in clause 17 (1) or 38 (1) of *State Environmental Planning Policy (Affordable Rental Housing) 2009* that have been imposed as a condition of consent to a development application in respect of the land.

18. Paper subdivision information

There is no current paper subdivision, of which council is aware, in respect of this land according to Part 16C of the *Environmental Planning and Assessment Regulation 2000*.

19. Site verification certificates

There is no current site verification certificate, of which council is aware, in respect of the land

according to Part 4AA of the *State Environmental Planning Policy (Mining, Petroleum Production and Extractive Industries) 2007*.

20. Loose-fill asbestos insulation

The residential dwelling erected on this land has not been identified in the Loose-Fill Asbestos Insulation Register as containing loose-fill asbestos ceiling insulation.

This clause applies to residential premises (within the meaning of Division 1A of part 8 of the Home Building Act 1989) that are listed in the register that is required to be maintained under that Division.

Contact NSW Fair Trading for more information.

21 Affected building notices and building product rectification orders

- (1) There is not an affected building notice of which the council is aware that is in force in respect of the land.
- (2) There is not a building product rectification order of which the council is aware that is in force in respect of the land and has not been fully complied with, and
- (3) There is not a notice of intention to make a building product rectification order of which the council is aware has been given in respect of the land and is outstanding.

In this clause:

affected building notice has the same meaning as in Part 4 of the *Building Products (Safety) Act 2017*.

building product rectification order has the same meaning as in the *Building Products (Safety) Act 2017*.

Additional matters under the Contaminated Land Management Act 1997

Note. The following matters are prescribed by section 59 (2) of the *Contaminated Land Management Act 1997* as additional matters to be specified in a planning certificate:

- (a) the land to which the certificate relates is not significantly contaminated land within the meaning of that Act
- (b) the land to which the certificate relates is not subject to a management order within the meaning of that Act
- (c) the land to which the certificate relates is not the subject of an approved voluntary management proposal within the meaning of that Act
- (d) the land to which the certificate relates is not subject to an ongoing maintenance order within the meaning of that Act

(e) the land to which the certificate relates is not the subject of a site audit statement

If contamination is identified above please contact the Environmental Protection Authority (EPA) for further information.

A handwritten signature in black ink, appearing to read 'Ray Brownlee', with a long horizontal stroke extending to the right.

Ray Brownlee PSM
Chief Executive Officer

30/03/2019



METROPOLITAN WATER SEWERAGE AND DRAINAGE BOARD

SEWERAGE SERVICE DIAGRAMMunicipality of *WARRINGAH*No. *692671*

SYMBOLS AND ABBREVIATIONS					
<input checked="" type="checkbox"/> Boundary Trap	<input checked="" type="checkbox"/> R.V. Reflux Valve	I.P. Induct Pipe	Bsn. Basin		
<input checked="" type="checkbox"/> Pit	<input checked="" type="checkbox"/> Cleaning Eye	M.F. Mica Flap	Shr. Shower		
<input checked="" type="checkbox"/> G.I. Grease Interceptor	<input checked="" type="checkbox"/> Vert. Vertical Pipe	T. Tubs	W.I.P. Wrought Iron Pipe		
<input checked="" type="checkbox"/> Gully	<input checked="" type="checkbox"/> V.P. Vent. Pipe	K.S. Kitchen Sink	C.I.P. Cast Iron Pipe		
<input checked="" type="checkbox"/> P.T. P. Trap	<input checked="" type="checkbox"/> S.V.P. Soil Vent. Pipe	W.C. Water Closet	F.W. Floor Waste		
<input checked="" type="checkbox"/> R.S. Reflux Sink	<input checked="" type="checkbox"/> D.C.C. Down Cast Cowl	B.W. Bath Waste	W.M. Washing Machine		

Scale: 40 Feet To An Inch

SEWER AVAILABLE

Where the sewer is not available and a special inspection is involved the Board accepts no responsibility for the suitability of the drainage in relation to the eventual position of the Board's Sewer

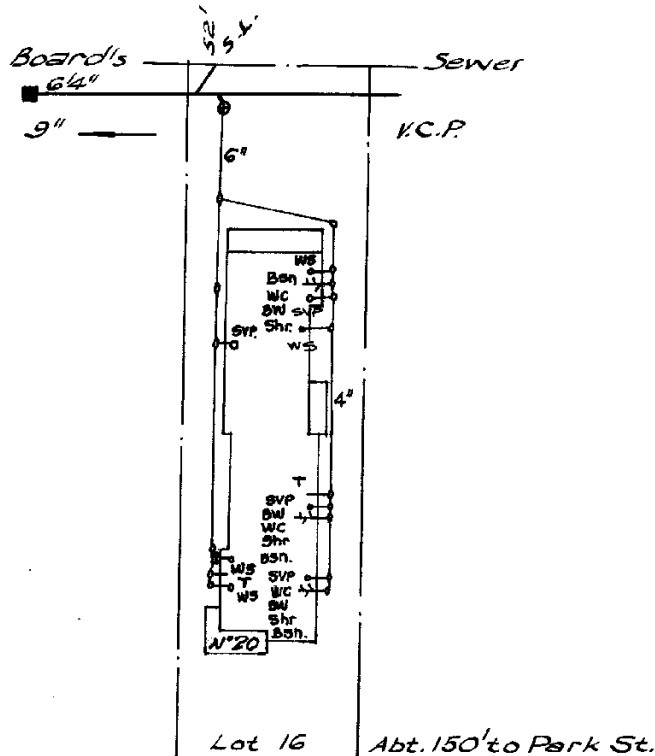
*CLARKE ST.*

RATE No. _____ W.C.s. _____ U.C.s. _____ 19____

SHEET No. *9028*

OFFICE USE ONLY

For Engineer House Services

DRAINAGE			PLUMBING		
W.C.	Supervised by	Date	BRANCH OFFICE	Supervised by	Date
Bth.	Inspector	/ /	Date / /	Inspector	/ /
Shr.			Outfall. <i>HL</i>		
Bsn.	Examined by		Drainer	<i>1078 711</i> <i>1270 200</i>	
K.S.			Plumber		
T.					
Plg.	Chief Inspector	/ /			

Disclaimer
The information in this diagram shows the private wastewater pipes on this property. It may not be accurate or to scale and may not show our pipes, structures or all property boundaries. If you'd like to see these, please buy a Service location print.