

# Statement of Information

## Single residential property located outside the Melbourne metropolitan area

### Section 47AF of the Estate Agents Act 1980

#### Property offered for sale

Address  
Including suburb or  
locality and postcode

23 Otway Park, Cape Otway Vic 3233

#### Indicative selling price

For the meaning of this price see [consumer.vic.gov.au/underquoting](http://consumer.vic.gov.au/underquoting)

Single price \$150,000

#### Median sale price\*

Median price House Unit Suburb or locality Cape Otway

Period - From to Source

#### Comparable property sales (\*Delete A or B below as applicable)

~~A\* These are the three properties sold within five kilometres of the property for sale in the last eighteen months that the estate agent or agent's representative considers to be most comparable to the property for sale.~~

Address of comparable property	Price	Date of sale
1		
2		
3		

OR

~~B\* The estate agent or agent's representative reasonably believes that fewer than three comparable properties were sold within five kilometres of the property for sale in the last eighteen months.~~

\* When this Statement of Information was prepared, publicly available information providing median sale prices of residential property in the suburb or locality in which the property offered for sale is situated, and our sales records (if any), did not provide a median sale price that met the requirements of section 47AF (2)(b) of the Estate Agents Act 1980.

Amber Nosedá

03 5237 7366

0419 540 365

amber@gopapollobay.com.au

**Indicative Selling Price**

\$150,000

**No median price available**



**Rooms:**

**Property Type:** Land

**Land Size:** 7255 sqm approx

Agent Comments

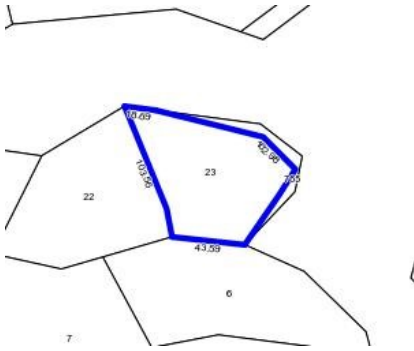

The estate agent or agent's representative reasonably believes that fewer than three comparable properties were sold within five kilometres of the property for sale in the last eighteen months.

## Comparable Properties

The estate agent or agent's representative reasonably believes that fewer than three comparable properties were sold within five kilometres of the property for sale in the last eighteen months.